

CERTIFICATE OF LOCATION OF GOVERNMENT CORNER

East Quarter _____ Corner of Section 3, Township 141 N., Range 28 W., 5th P.M.
 STATE OF MINNESOTA, County of CASS

At the corner location shown on the sketch:

- On 7/15/87 found a 1" GLO brass cap monument, 6" above ground, 10' E. of centerline road and 8' S. of centerline road.
DATE
- left monument as found, lowered monument, removed monument (explain)
- On _____ placed a _____
DATE

SKETCH OF REFERENCE TIES

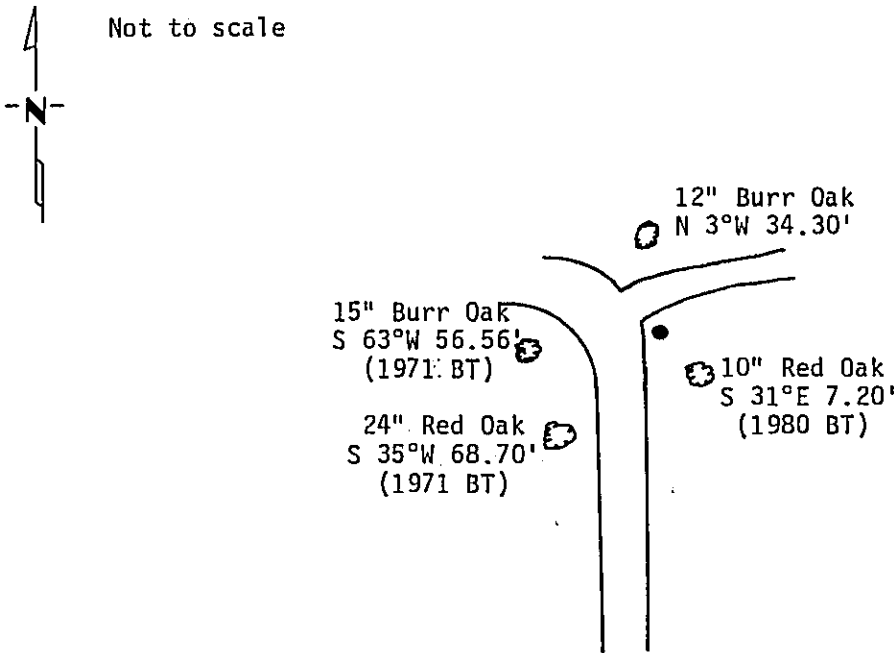

Trees double blazed, scribed, painted red and 54-3 Bearing Tree tag attached. Measurement taken to nail in side of tree.

Statement of evidence relative to this corner location is on back of page.

301672

I hereby certify that this document and the data contained herein was prepared by me or under my direct supervision.

Walter E. Cason 11-23-87
SIGNATURE DATE

Registration No. 11395

- Land Surveyor
 County Surveyor

OFFICE OF THE COUNTY RECORDER
 County of Cass

I hereby certify that this document was filed in the Co. Recorders office at 9:40 A .M. on the 16 day of Dec. A.D., 19 87

County Recorder Claudine Kayser
 By MS, Deputy

DOCUMENT NO. 301672

Statement of Evidence: East Quarter Corner Section 3, T.141 N., R.28 W., 5th P.M.

- 1874 US General Land Office survey set a wood post for this corner and marked the following bearing tree: 10" Oak S 80°W 150 lks.
- 1918 US General Land Office dependent resurvey found old Gov't BT and set a 1"x36" I.P. with marked brass cap. The following new trees were marked: 12"W.Oak N 59½°E 124 lks., 6" Bl.Oak S 33°W 32 lks.
- 1972 R.F.Schneider plats TOWNLINE SHORES and shows iron pipe at corner.
- 1972 US Forest Service personnel found iron in good condition and marked two new BT's: 15" Oak S 40°W 69.1', 11" Oak S 64°W 56.7'. Both trees scribed "¼ S3 BT"
- 1980 US Forest Service personnel marked and scribed one new BT: 9" Red Oak S 27°E 7.28'
- 1987 Walt Curo, under contract with the US Forest Service, found 1" GLO brass cap monument 6" above ground. Corner is 10' east and 8' south of roads. Bearing trees marked as shown on front of this certificate.