

CERTIFICATE OF LOCATION OF GOVERNMENT CORNER

NORTH QUARTER Corner of Section 27, Township 139, Range 29, 5th P.M.

STATE OF MINNESOTA, County of CASS

At the corner location shown on the sketch:

- On _____ found a _____
DATE
- left monument as found, lowered monument, removed monument (explain)
- On 7-8-87 placed a 2" x 2" x 36" Steel post with aluminum cap at
DATE
the lost position between NE corner and MC No. 7

SKETCH OF REFERENCE TIES

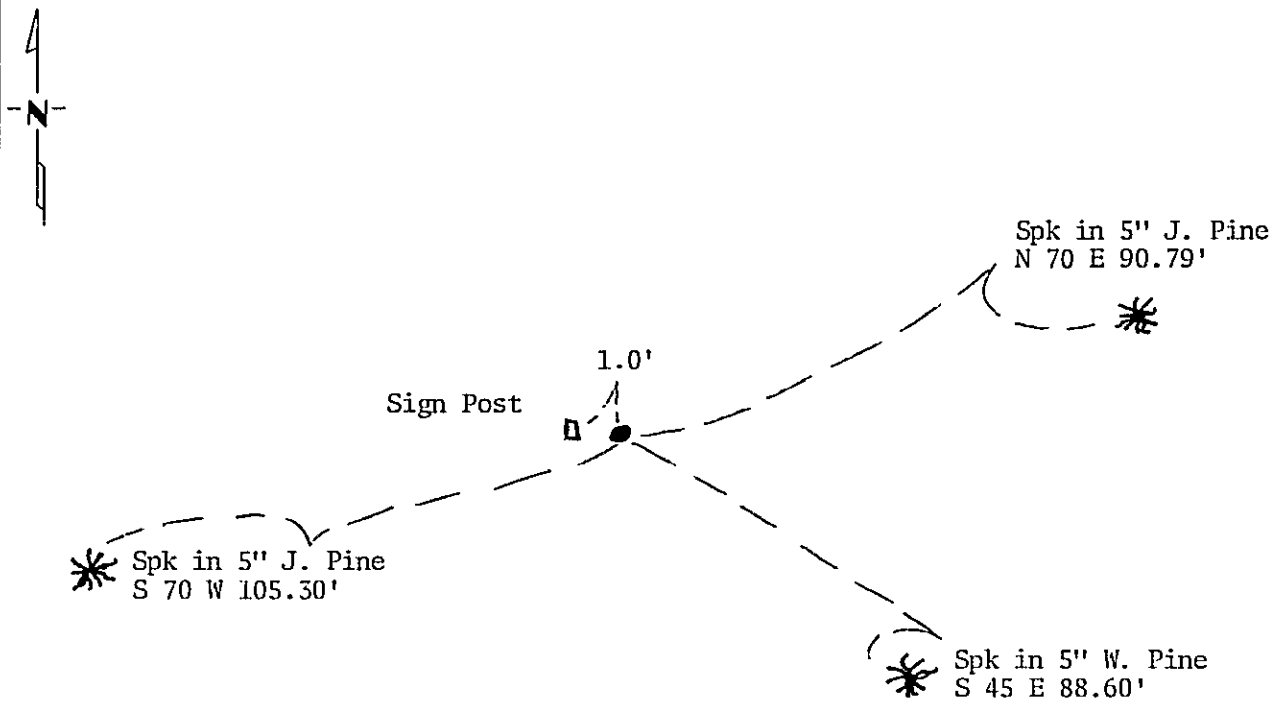

BEARINGS ARE APPROXIMATE

Statement of evidence relative to this corner location is on back of page. 300483

I hereby certify that this document and the data contained herein was prepared by me or under my direct supervision.

Mary H. Atkinson 7/11/87
SIGNATURE DATE

Registration No. 12684

- Land Surveyor, Professional Engineer
- County Surveyor, County Engineer

OFFICE OF THE COUNTY RECORDER
County of Cass

I hereby certify that this document was filed in the Co. Recorders office at 3:55 P. M. on the 20 day of Oct. A.D., 1987

County Recorder Claudine Kayle
By MS, Deputy

DOCUMENT NO. 300483

Statement of Evidence:

- 1865 U.S. General Land Office survey set wood post for this corner and marked the following bearing trees: 9" Bl. Pine S 22½ W 300 links. Notes show corner in swamp.
- 1987 County Surveyor's Records in the Recorder's Office were checked and no resurvey information was found on this corner. Survey by Horst in 1920 sets the NE corner of Sec. 27 by double proportion using MC No. 7. It can be assumed that he did not find this corner.
- 1972 - Robert F. Schneider and RCM, Inc. doing separate surveys in Section 22 es-
1973 tablished a position for this corner. Nothing is set by either survey. Information from these surveys indicate that their positions are very close and are based on establishing a position for the SW corner of Sec. 22 in the lake.
- 1987 GLO notes and plat show that no lines were run or determined across Lake Ada and no SW corner of Sec. 22 established. Therefore, I did not accept positions established in 1972 and 1973. I determined lost position between the NE corner of Sec. 27 and MC No. 7. This position falls 2633.15' west of the NE corner. Corner position falls in swamp. No evidence of corner monument was found and no evidence of the GLO BT was found.