

CERTIFICATE OF LOCATION OF GOVERNMENT CORNER

North Quarter Corner of Section 25, Township 135 N., Range 32 W., 5th P.M.

STATE OF MINNESOTA, County of CASS

At the corner location shown on the sketch:

- On _____ found a _____
DATE
- left monument as found, lowered monument, removed monument (explain)
- On 8/14/86 placed a cast iron monument in centerline of E-W rd. in line
DATE with fence N. down 0.5'

SKETCH OF REFERENCE TIES

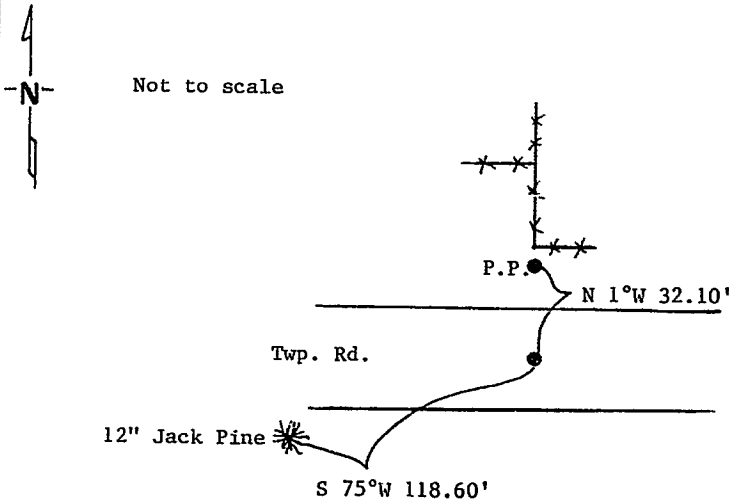

Measurements are to nail in side of object.
Bearings are assumed using 5° declination.

Statement of evidence relative to this corner location is on back of page. 297502

I hereby certify that this document and the data contained herein was prepared by me or under my direct supervision.

Walter E. Ann 1-22-87
SIGNATURE DATE

Registration No. 11395

Land Surveyor, Professional Engineer

County Surveyor, County Engineer

OFFICE OF THE REGISTER OF DEEDS

County of Cass

I hereby certify that this document was filed in the Reg. of Deeds office at 9:35 A.M. on the 12 day of June A.D., 19 87

Register of Deeds Cloudiva Kayler

By ms Deputy

DOCUMENT NO. 297502

STATEMENT OF EVIDENCE North Quarter Corner Section 25, T.135 N., R.32 W., 5th P.M.

- 1866 U.S. General Land Office survey set a wood post for this corner and marked the following bearing trees: 6" Bl.Pine S $8\frac{1}{2}^{\circ}$ W 8 lks., 6" Bl.Pine N 47° E 10 lks.
- 1985 On Sept. 16, Terry Freeman, Cass County Survey Technician and Ken Meyer, backhoe operator dug in area of E-W rd and fence N. Dug 11' N-S x 12' E-W x 4' deep. 6" class V top, 1.5' fill and dug 2' into natural sandy-loam & sandy-gravel. Found 2 small pieces of pottery at top of natural ground-nothing.
- 1986 On August 14, Terry Freeman and Norman Maunu set a cast iron monument in centerline of E-W rd and in line with fence N.