

# CERTIFICATE OF LOCATION OF GOVERNMENT CORNER

NORTH QUARTER Corner of Section 17, Township 140, Range 26, 5th P.M.

STATE OF MINNESOTA, County of CASS

At the corner location shown on the sketch:

- On 10-25-83 found a 2" iron pipe set by R.F. Schneider in 1966 at found  
DATE post.
- left monument as found,  lowered monument,  removed monument (explain)
- On 10-25-83 placed a county cast iron monument.  
DATE

### SKETCH OF REFERENCE TIES

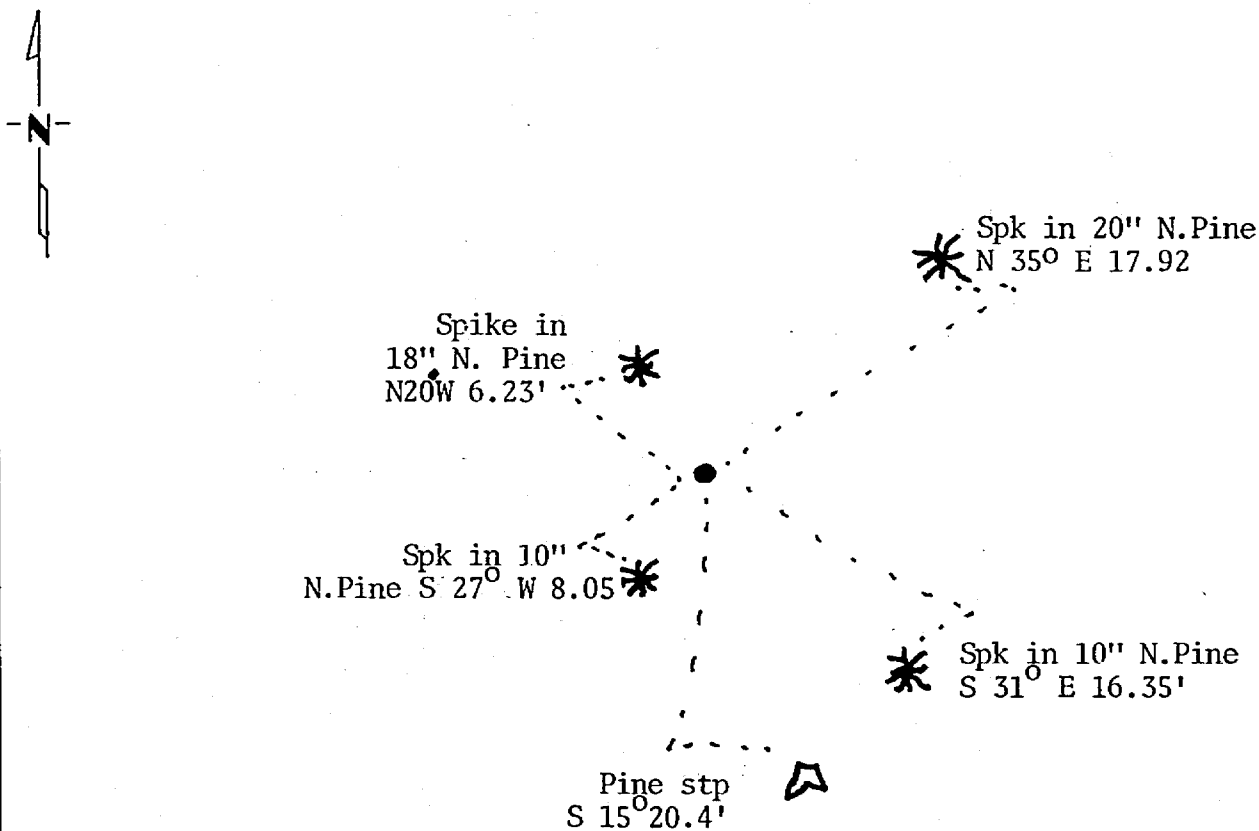

BEARINGS ARE APPROXIMATE

Statement of evidence relative to this corner location is on back of page. 295287

I hereby certify that this document and the data contained herein was prepared by me or under my direct supervision.

Nancy H. Stearns 2/7/87  
SIGNATURE DATE

Registration No. 12684

- Land Surveyor,  Professional Engineer
- County Surveyor,  County Engineer

### OFFICE OF THE COUNTY RECORDER

County of Cass

I hereby certify that this document was filed in the Co. Recorders office at 4:00 P .M. on the 25 day of February A.D., 19 87

County Recorder Claudia Koyler

By MS, Deputy

DOCUMENT NO. 295287

Statement of Evidence:

- 1871 - U.S. General Land Office survey set wood post with bearing trees marked: 6" Norway Pine N 88° W 5 links (3.30') 6" Norway Pine S 74° E 10 links (6.60')
- 1938 - CCC notes at DNR Washburn Lake Forestry Station show scribed stake found with ties: 10" Jack Pine S 16° E 20.8' 6" White Pine N 32° W 6.8'
- 1966 - R.F. Schneider, RLS # 5740, found 4" hewed post scribed with " ¼ S" and set a 2½" x 36" iron pipe with ties: 15" Norway Pine N 20° W 5.65' with old blazes. 6" Norway Pine S 31° E 16.25' 8" Norway Pine S 27° W 7.95'
- 1979 - Found 2½" iron pipe in place that checked with 1966 ties and 1938 ties.
- 1983 - Replaced pipe set by Schneider with 4" cast iron monument and took new ties as shown on this certificate.