

CERTIFICATE OF LOCATION OF GOVERNMENT CORNER

North Sixteenth Corner of Section 9, Township 142, Range 26, 5th P.M.
Cass

STATE OF MINNESOTA, County of _____

At the corner location shown on the sketch:

- On _____ found a _____
DATE
- left monument as found, lowered monument, removed monument (explain)
- On 5-21-86 placed a 2"x60" galv. iron pipe with brass cap
DATE with 18" out of the ground

Not to scale. SKETCH OF REFERENCE TIES

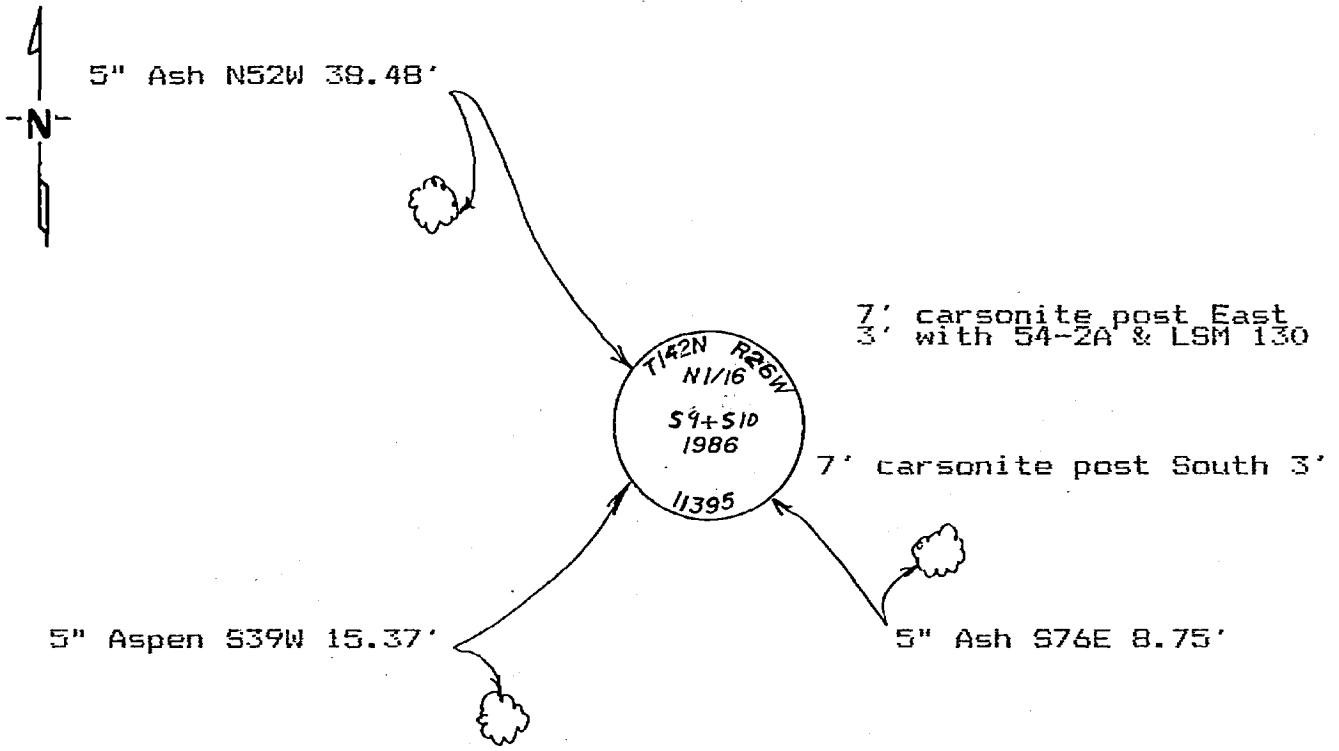

All measurements are to spks. in side of the tree, trees are double blazed and scribed and painted red with USFS 54-3 bearing tree tag.

Statement of evidence relative to this corner location is on back of page.

I hereby certify that this document and the data contained herein was prepared by me or under my direct supervision.

Walter E. Brown 8-13-86
SIGNATURE DATE

Registration No. 11395
 Land Surveyor, Professional Engineer
 County Surveyor, County Engineer

290925

OFFICE OF THE REGISTER OF DEEDS
 County of Cass

I hereby certify that this document was filed in the Reg. of Deeds office at 4:00 P.M. on the 15 day of August A.D., 1986

Register of Deeds Claudine Kayler
 By ms, Deputy
 DOCUMENT NO. 290925

STATEMENT OF EVIDENCE

North Sixteenth corner of Section 9, Township
142 north, Range 26 West of the 5th Principal Meridian.

5-21-1986 Walter E. Curo set a 2"x60" galv. iron pipe by single
proportion between the section corner and the east quarter
corner.