

CERTIFICATE OF LOCATION OF GOVERNMENT CORNER

East Quarter Corner of Section 29, Township 142N, Range 25W, 5th P.M.
STATE OF MINNESOTA, County of Cass

At the corner location shown on the sketch:

- On _____ found a _____
DATE
- left monument as found, lowered monument, removed monument (explain)
- On 10-3-85 placed a 2" Square Tubular Steel Aluminum Capped
DATE
Monument Stamped

SKETCH OF REFERENCE TIES

Nails in sides of all Bearing Trees

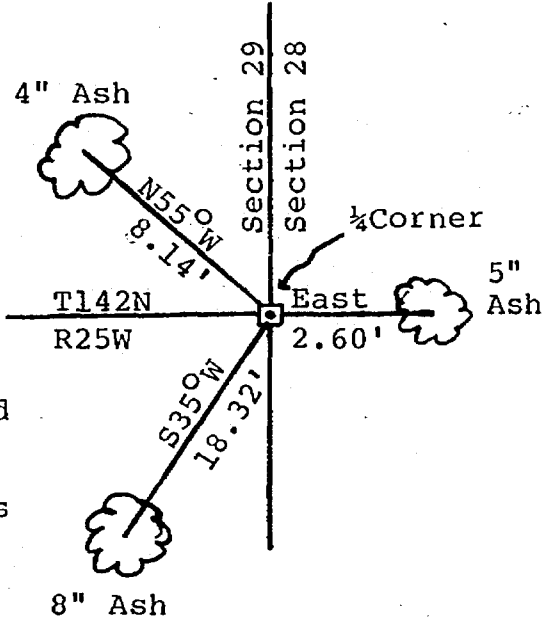
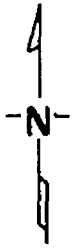

Monument is located in a low wet area. 300' more or less Westerly of a woods trail.

County Surveyors Office Sign and Post .77' Southerly

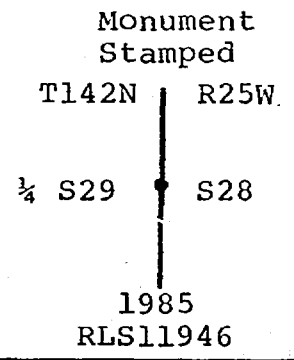

Statement of evidence relative to this corner location is on back of page. 286241

I hereby certify that this document and the data contained herein was prepared by me or under my direct supervision.

Robert Mustonen 12/3/85
SIGNATURE DATE

Registration No. 11946

Land Surveyor, Professional Engineer
 County Surveyor, County Engineer

OFFICE OF THE REGISTER OF DEEDS
County of Cass

I hereby certify that this document was filed in the Reg. of Deeds office at 3:35 P.M. on the 9 day of Dec. A.D., 19 85

Register of Deeds Claudia Kaylor
By MS, Deputy

DOCUMENT NO. 286241

STATEMENT OF EVIDENCE:

East Quarter Corner of Section 29, Township 142 North,
Range 25 West of the 5th Principal Meridian

1871

Walker, Allen & Putman, contract surveyors for the General Land Office set a post from which a Cedar 10" brs S39W 18 lks
a Tamarac 14" brs N33E 22 lks.

From the southeast corner of Section 29 run north between Sec 28&29 at 27.00 Brook 6 lks wide runs NW.

1985

Roger A. Mustonen, RLS 11946, under contract with the USFS and a private landowner to survey part of Section 29 Found the remnants of a fallen Cedar tree, (now about 15"), At 18 links N39°E (Magnetic bearing) made a thorough diligent search of the corner vicinity and did not find post. From the corner position, measured 13.00 chains south and find a Brook about 6 links wide running Northwest.

On 10/3/85 placed a square 2" tubular County Monument at 18 links N39°N from the fallen cedar and accepts same as the East Quarter Corner of Section 29.