

CERTIFICATE OF LOCATION OF GOVERNMENT CORNER

W&MC # 10 Corner of Section 21, Township 133, Range 31, 5th P.M.
 STATE OF MINNESOTA, County of Cass

At the corner location shown on the sketch:

- On _____ found a _____
DATE
- left monument as found, lowered monument, removed monument (explain)
- On 8/3/85 placed a 2" x 2" x 36" square iron with standard Cass County
DATE aluminum monument cap 2" above ground /

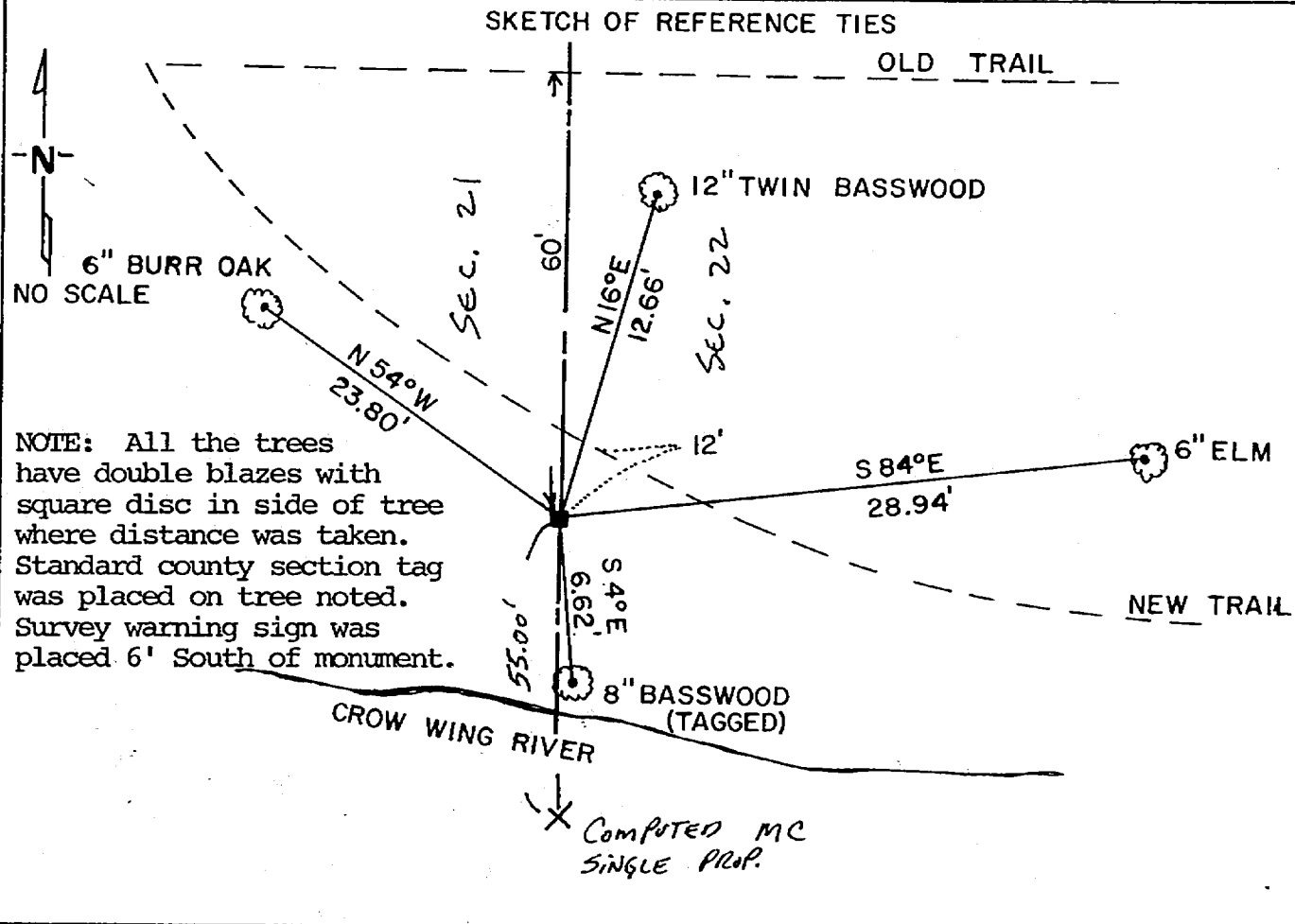

Statement of evidence relative to this corner location is on back of page. 285673

I hereby certify that this document and the data contained herein was prepared by me or under my direct supervision.

David A. Linderher 9/13/85
SIGNATURE DATE

Registration No. _____
 Land Surveyor, Professional Engineer
 County Surveyor, County Engineer

OFFICE OF THE COUNTY RECORDER
 County of Cass

I hereby certify that this document was filed in the RECORDER'S office at 3:10 P.M. on the 8 day of Nov. A.D., 1985

COUNTY RECORDER Clouline Kayler
 By MS, Deputy
 DOCUMENT NO. 285673

STATEMENT OF EVIDENCE FOR: MC #10
Section 21, Township 133 North, Range
31 West, Cass County, Minnesota.

In 1863 the original Government Survey was performed and a wood post was set to mark this corner location.

In 1915, E. B. Horst found original Northwest beartree. Set post for WCMC 55 feet North of where corner would fall in river. County Book "C", Page 83.

In 1921, E. B. Horst set iron monument at WCMC location previously established in 1915. Book "D", Page 9.

In 1985 Landecker & Associates, Inc. searched for Horst monument and remains of original Northwest beartree and did not recover. MC #10 was set by single proportionate measure between the Northeast and East quarter of said Section 21. Said position fell in river as noted by Horst. Therefore WCMC was established 55 feet North of corner position on bank of river.