

CERTIFICATE OF LOCATION OF GOVERNMENT CORNER

North Quarter Corner of Section 14, Township 141, Range 31, 5th P.M.

STATE OF MINNESOTA, County of CASS

At the corner location shown on the sketch:

On 5/3/84 found a GLO brass cap monument as set in 1917.
DATE

left monument as found, lowered monument, removed monument (explain)

On _____ placed a _____
DATE

SKETCH OF REFERENCE TIES

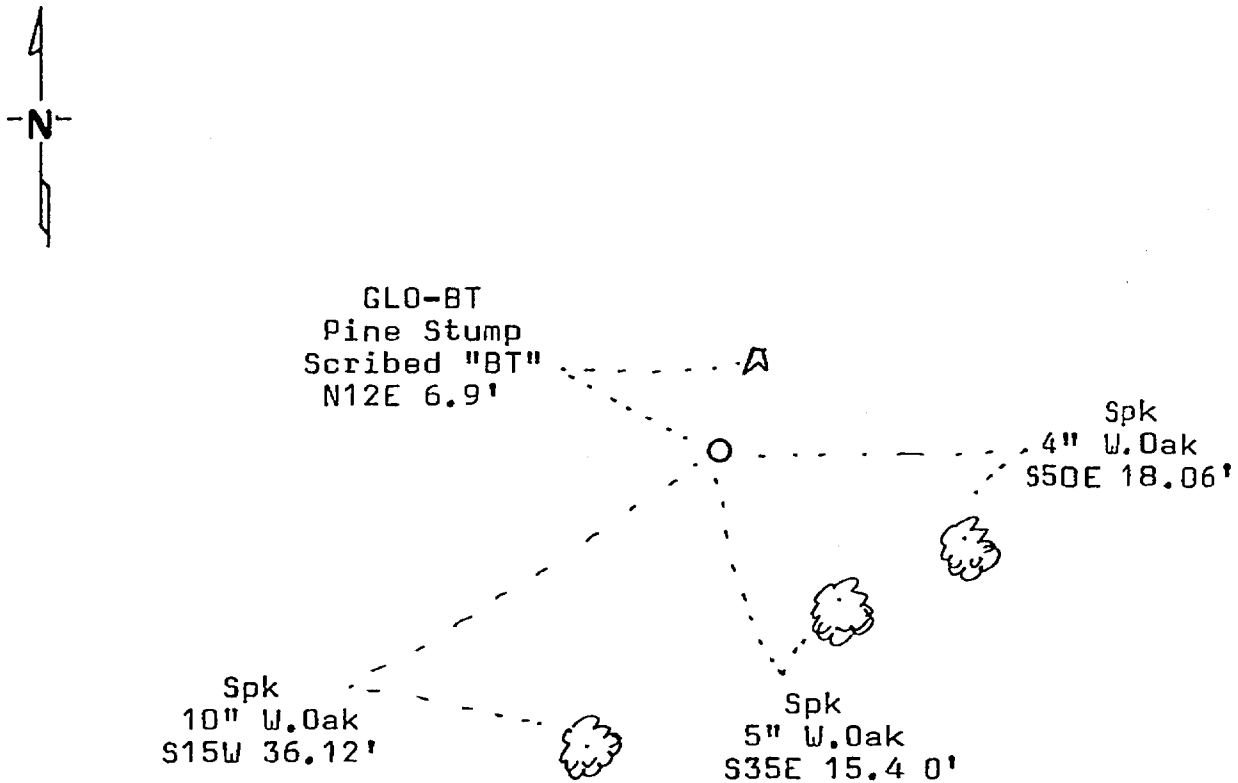

Bearings are approximate

Statement of evidence relative to this corner location is on back of page. 284982

I hereby certify that this document and the data contained herein was prepared by me or under my direct supervision.

May H. Ataner 10/7/85
SIGNATURE DATE

Registration No. 12684

Land Surveyor, Professional Engineer
 County Surveyor, County Engineer

OFFICE OF THE REGISTER OF DEEDS

County of Cass

I hereby certify that this document was filed in the Reg. of Deeds office at 3:40 P.M. on the 9 day of Oct. A.D., 1985

Register of Deeds Clairine Kayler

By MJ, Deputy

DOCUMENT NO. 284982

STATEMENT OF EVIDENCE

- 1873 - U.S. General Land Office survey set a wood post for this corner and marked the following bearing trees: 10" Y.PINE N12E 10 links and 10" J.PINE S24E 8 links.
- 1917 - U.S. General Land Office resurvey reestablished this corner from the stumps of both original bearing trees found plainly marked with "BT". An iron pipe with a marked brass cap was set to mark the corner. The following bearing trees were marked: 10" N.Pine N61½E 516 links and 5" J.Pine S28½E 187 links.
- 1985 - County Surveyor's Records in the Courthouse were checked and no additional resurvey information was found.
- 1985 - U.S. Forest Service office in Cass Lake was contacted for information and no additional survey information was found on this corner.
- 1984 - We ran a traverse to the corner area from the center of Section 11 based on survey information by W.J. Spain, Jr. from a survey dated in 1960. We found the GLO brass cap monument in good condition and the stump of the original bearing tree with "BT" scribe marks plain at N12E 6.9'. No evidence was found of the other original bearing tree. The 1917 bearing trees were not looked for.
- 1985 - We ran a traverse of the north line of Section 14. The distance east to the NE corner of Section 14 checked good with the 1917 measurement. Set a county steel sign post on the east side of the monument.