

CERTIFICATE OF LOCATION OF GOVERNMENT CORNER

MEANDER No. 26 Corner of Section 21&22, Township 143, Range 25, 5th P.M.

STATE OF MINNESOTA, County of CASS

At the corner location shown on the sketch:

On _____ found a _____
DATE

left monument as found, lowered monument, removed monument (explain)

On 5/23/85 placed a county monument for reference to computed
DATE position based on 1900 U.S. Corps of Engineers notes.

SKETCH OF REFERENCE TIES

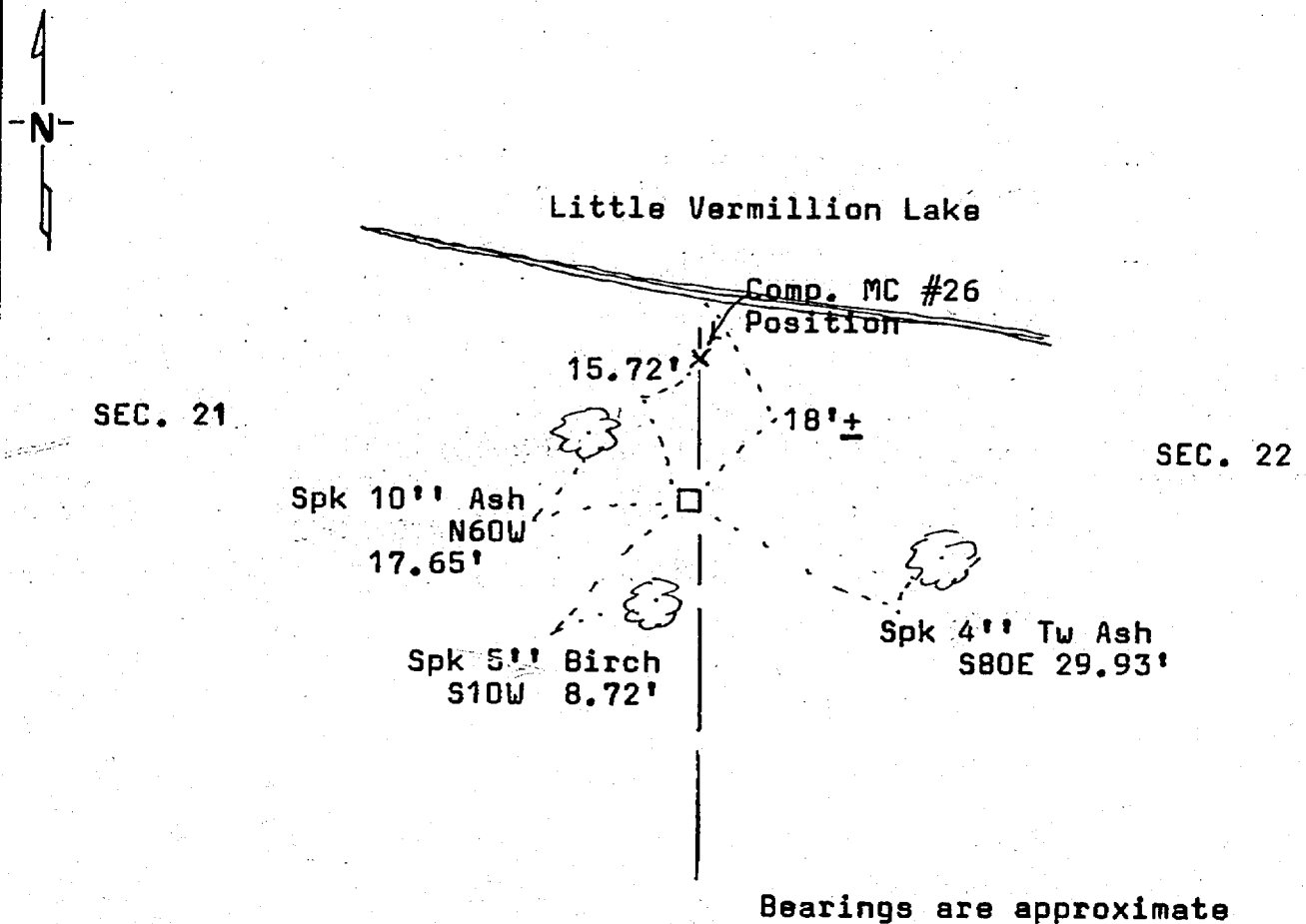

Statement of evidence relative to this corner location is on back of page.

I hereby certify that this document and the data contained herein was prepared by me or under my direct supervision.

[Signature] 6/27/85
SIGNATURE DATE

Registration No. 12684

Land Surveyor, Professional Engineer

County Surveyor, County Engineer

282880
OFFICE OF THE REGISTER OF DEEDS
County of Cass

I hereby certify that this document was filed in the Reg. of Deeds office at 3:30 P.M. on the 1 day of July A.D., 19 85

Register of Deeds Clondine Kayler
By MS Deputy

DOCUMENT NO. 282880

STATEMENT OF EVIDENCE

- 1872 U.S. General Land Office survey (set wood post) for this corner and marked the following bearing trees: 14" Elm S78W 4 links and 6" Elm S65-30E 12 links.
- 1900 U.S. Corps of Engineers topographical survey notes show this corner identified from one GLO bearing tree alive and one GLO bearing tree down.
- 1981 County Surveyor's Records in the Recorder's Office were checked and no resurvey information was found on this corner.
- 1981 U.S. Forest Service office in Cass Lake was contacted for information and no resurvey information was found on this corner.
- 1976- U.S. Bureau of Land Management resurvey found no evidence of this corner. Subsequent survey by them did not attempt to reestablish this corner.
- 1981- I ran a traverse around Section 21 and found no evidence of the corner or of the bearing trees.
- 1985- After BLM resurvey had established the southeast corner of Sec. 21 from the 1900 Corps survey information, I calculated this corner position based on the same 1900 survey information. This computed location fit well with the existing shoreline. No other evidence of the corner was found. Therefore, I accepted the 1900 U.S. Corps of Engineer's survey notes as the best evidence of the corner position for marking the section line. On May 23, 1985, a 2"x2" steel post with 3"x3" aluminum cap was set on the section line 15.72' south of the corner location as a reference monument.

(See Certificate of Survey for Cass County Land Department for measurements).