

CERTIFICATE OF LOCATION OF GOVERNMENT CORNER

North 1/4 Corner of Section 28, Township 144N, Range 25W, 5th P.M.

STATE OF MINNESOTA, County of Cass

At the corner location shown on the sketch:

- On _____ found a _____
DATE
- left monument as found, lowered monument, removed monument (explain)
- On 10-24-1984 placed a 2 1/2" X 5 feet long galvanized iron pipe
DATE with 3" brass cap up 1.5 feet

5° East declination

SKETCH OF REFERENCE TIES

Not to Scale

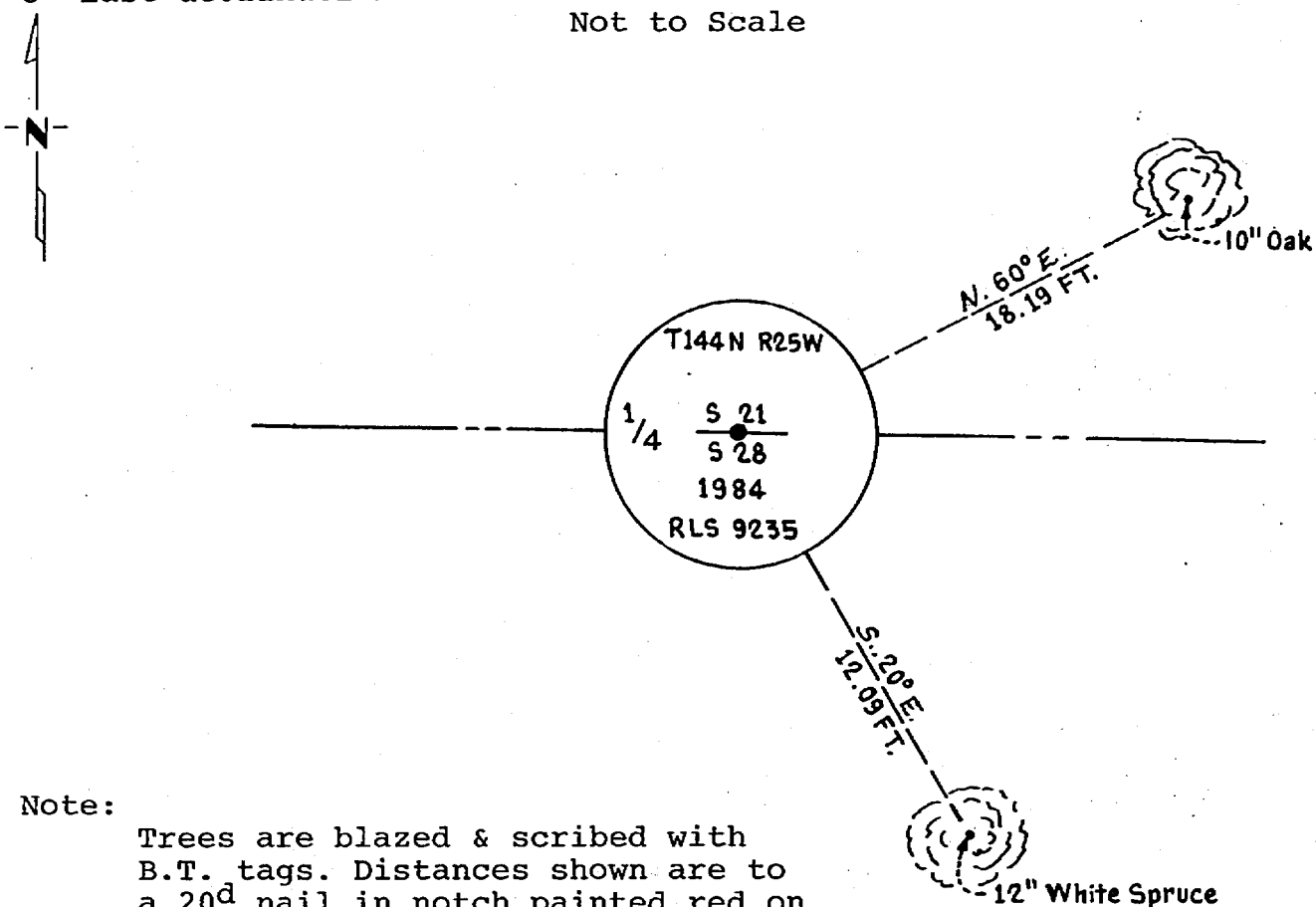

Note:

Trees are blazed & scribed with B.T. tags. Distances shown are to a 20^d nail in notch painted red on side of tree.

Statement of evidence relative to this corner location is on back of page.

I hereby certify that this document and the data contained herein was prepared by me or under my direct supervision.

James H. Jahn 3/29/85
SIGNATURE DATE

Registration No. 9235

Land Surveyor, Professional Engineer

County Surveyor, County Engineer

281959
OFFICE OF THE COUNTY RECORDER
County of Cass

I hereby certify that this document was filed in the Co. Recorders office at 10:10 A.M. on the 15 day of May A.D., 19 85

County Recorder Cherline Kaylor

By MS, Deputy

DOCUMENT NO. 281959

Statement of Evidence:

R11

This corner was originally established in April, 1876, by B.C. Baldwin, Deputy Surveyor. The field notes of that survey are filed in the office of the Secretary of State, St. Paul, Minnesota. Mr. Baldwin's notes state that a post was set to mark the corner and referenced by the following:

A 8" Balsam that bears N53°W a distance of 38 links [25.08 feet]
A 5" Ironwood that bears S4°E a distance of 34 links [22.44 feet]

On June 29, 1984, personnel from Advance Surveying & Engineering Co. made a thorough search for this corner and the above mentioned references but to no avail. This area has been logged off years ago.

On October 24, 1984, an additional search was made by Advance prior to reestablishing this corner position by "Lost" methods halfway and on line between adjacent Section corners and monumented as shown on the sketch.