

CERTIFICATE OF LOCATION OF GOVERNMENT CORNER

Northeast Corner of Section 30, Township 144N, Range 25W, 5th P.M.

STATE OF MINNESOTA, County of Cass

At the corner location shown on the sketch:

- On found a
DATE
- left monument as found, lowered monument, removed monument (explain)
- On 10-8-1984 placed a 2 1/2" (O.D.) X 5 feet long galvanized iron
DATE pipe with 3" brass cap. Up 1.5 feet

5° East declination SKETCH OF REFERENCE TIES
Not to Scale

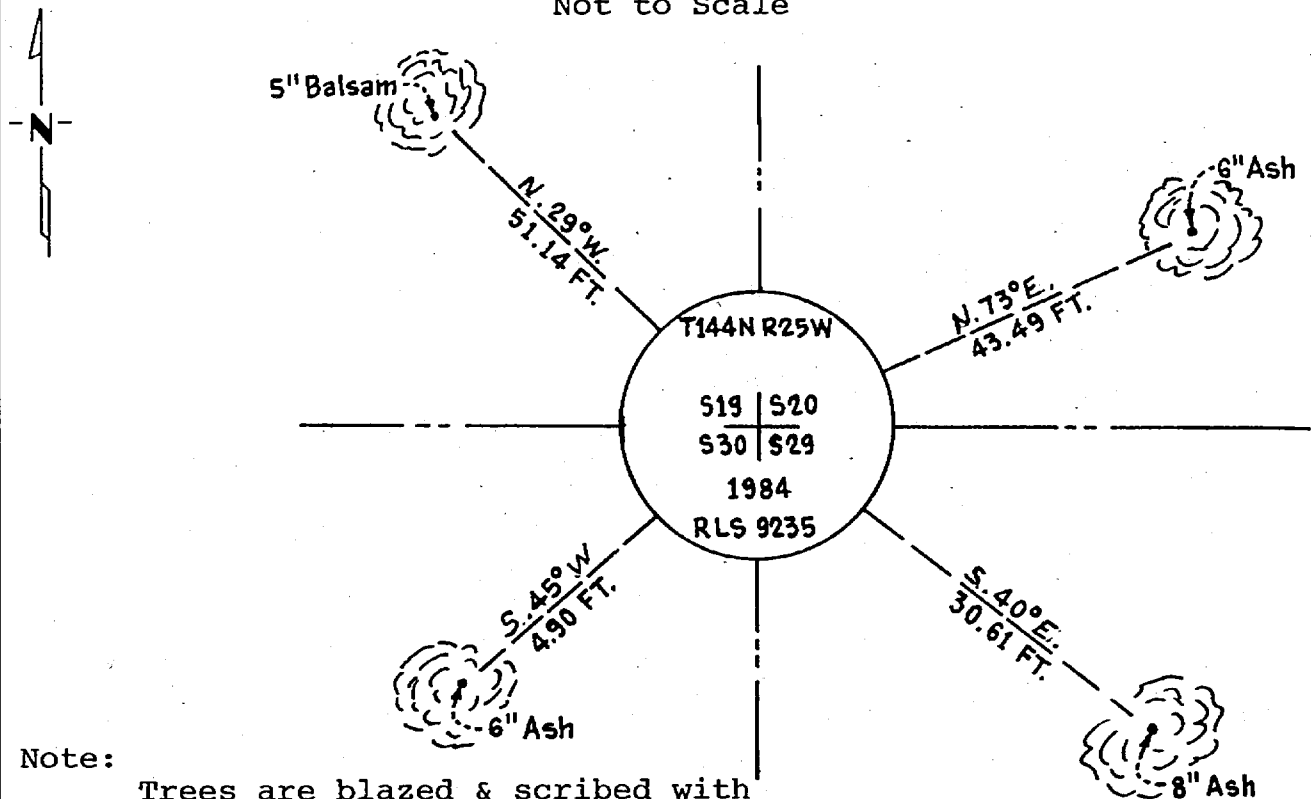

Note: Trees are blazed & scribed with B.T. Tags. Distances shown are to a 20^d nail in notch painted red on side of tree.

Statement of evidence relative to this corner location is on back of page.

I hereby certify that this document and the data contained herein was prepared by me or under my direct supervision.

James H. Parker 3/29/85
SIGNATURE DATE

Registration No. 9235
 Land Surveyor, Professional Engineer
 County Surveyor, County Engineer

281956
 OFFICE OF THE COUNTY RECORDER
 County of Cass

I hereby certify that this document was filed in the Co. Recorders office at 9:55 A. M. on the 15 day of May A.D., 1985
 County Recorder Claudia Kaylor
 By MS, Deputy
 DOCUMENT NO. 281956

Statement of Evidence:

R5

This corner was originally established in April, 1876, by B.C. Baldwin, Deputy Surveyor. The field notes of that survey are filed in the office of the Secretary of State, St. Paul, Minnesota. Mr. Baldwin's notes state that a post was set to mark the corner and referenced by the following:

A 8" Lynn that bears N46°E a distance of 42 links [27.72 feet]
A 8" Ash that bears S82°E a distance of 13 links [8.58 feet]
A 5" Ash that bears S67°W a distance of 14 links [9.24 feet]
A 6" Ash that bears N20°W a distance of 22 links [14.52 feet]

On June 11, 1984, personnel from Advance Surveying & Engineering Co. made a thorough search for this corner and the above mentioned references but to no avail.

On October 8, 1984, an additional search was made by Advance prior to reestablishing this corner by Double proportionate methods between the Northwest corner of Section 30 and the North Quarter corner of Section 26 and between the Northeast corner of Section 7 and the Southeast corner of Section 30.