

CERTIFICATE OF LOCATION OF GOVERNMENT CORNER

East Quarter Corner of Section 15, Township T144 N., Range 25 W., 5th P.M.
 STATE OF MINNESOTA, County of Cass

At the corner location shown on the sketch:

- On _____ found a _____
DATE
- left monument as found, lowered monument, removed monument (explain)
- On 1-10-1985 placed a 5/8" by 8 feet long Aluminum Rod with 3" Aluminum Cap
DATE
stamped as shown, up 1.00 foot.

5° EAST Declination

SKETCH OF REFERENCE TIES
 NOT TO SCALE

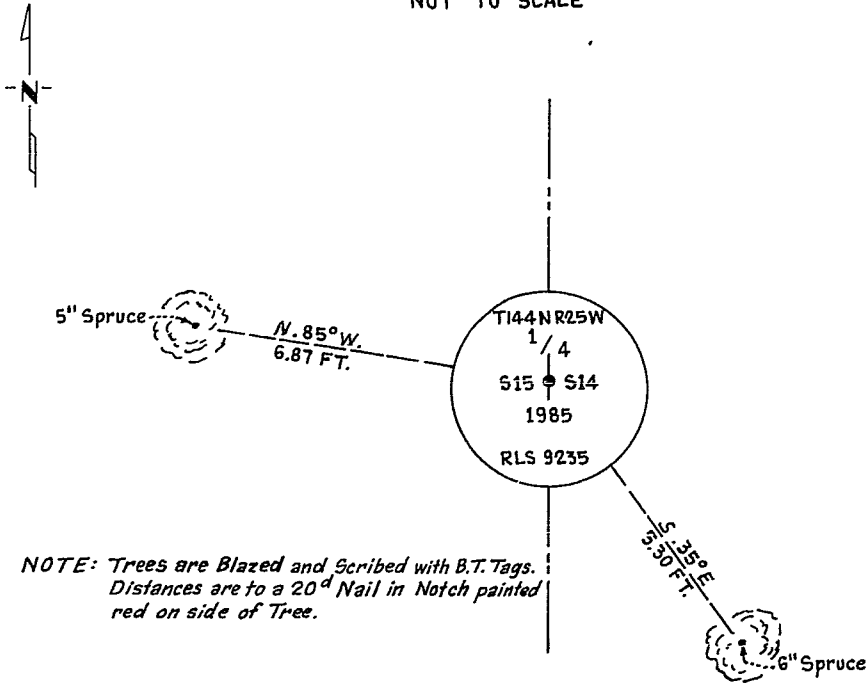

Statement of evidence relative to this corner location is on back of page.

I hereby certify that this document and the data contained herein was prepared by me or under my direct supervision.

James H. Parker 3/29/85
SIGNATURE DATE

Registration No. 9235
 Land Surveyor, Professional Engineer
 County Surveyor, County Engineer

281718
 OFFICE OF THE COUNTY RECORDER
 County of Cass

I hereby certify that this document was filed in the Co. Recorders office at 3:20 P.M. on the 3 day of May A.D., 1985
 County Recorder Claudine Kayler
 By MS, Deputy
 DOCUMENT NO. 281718

Statement of Evidence:

L17

This corner was originally established in April, 1876, by B.C. Baldwin, Deputy Surveyor. The field notes of that survey are filed in the office of the Secretary of State, St. Paul, Minnesota. Mr. Baldwin's notes state that a post was set to mark the corner and referenced by the following:

A 5" Tamarack that bears N65°E a distance of 19 links [12.54 feet]
A 5" Tamarack that bears S83°W a distance of 11 links [7.26 feet]

In 1900, A Map of survey by the Corps of Engineers shows that they found the corner.

On August 13, 1984, personnel from Advance Surveying & Engineering Co. made a thorough search for this corner and the above mentioned references but to no avail. This area is all Tamarack and Spruce swamp.

On January 10, 1985, an additional search was made by Advance prior to reestablishing this corner by Obliterated methods by using coordinate position determined from Corps of Engineers Survey done in 1900.