

# CERTIFICATE OF LOCATION OF GOVERNMENT CORNER

Northwest Corner of Section 16, Township 144 N., Range 25W., 5th P.M.

STATE OF MINNESOTA, County of Cass

At the corner location shown on the sketch:

- On \_\_\_\_\_ found a \_\_\_\_\_  
DATE
- left monument as found,  lowered monument,  removed monument (explain)
- On 12-14-1984 placed a 2" by 24" long Galvanized Iron Pipe with 3" Brass Cap  
DATE  
stamped as shown, down 0.75 feet, 9 feet west of E of New Forestry Road.

5° East Declination

SKETCH OF REFERENCE TIES  
NOT TO SCALE

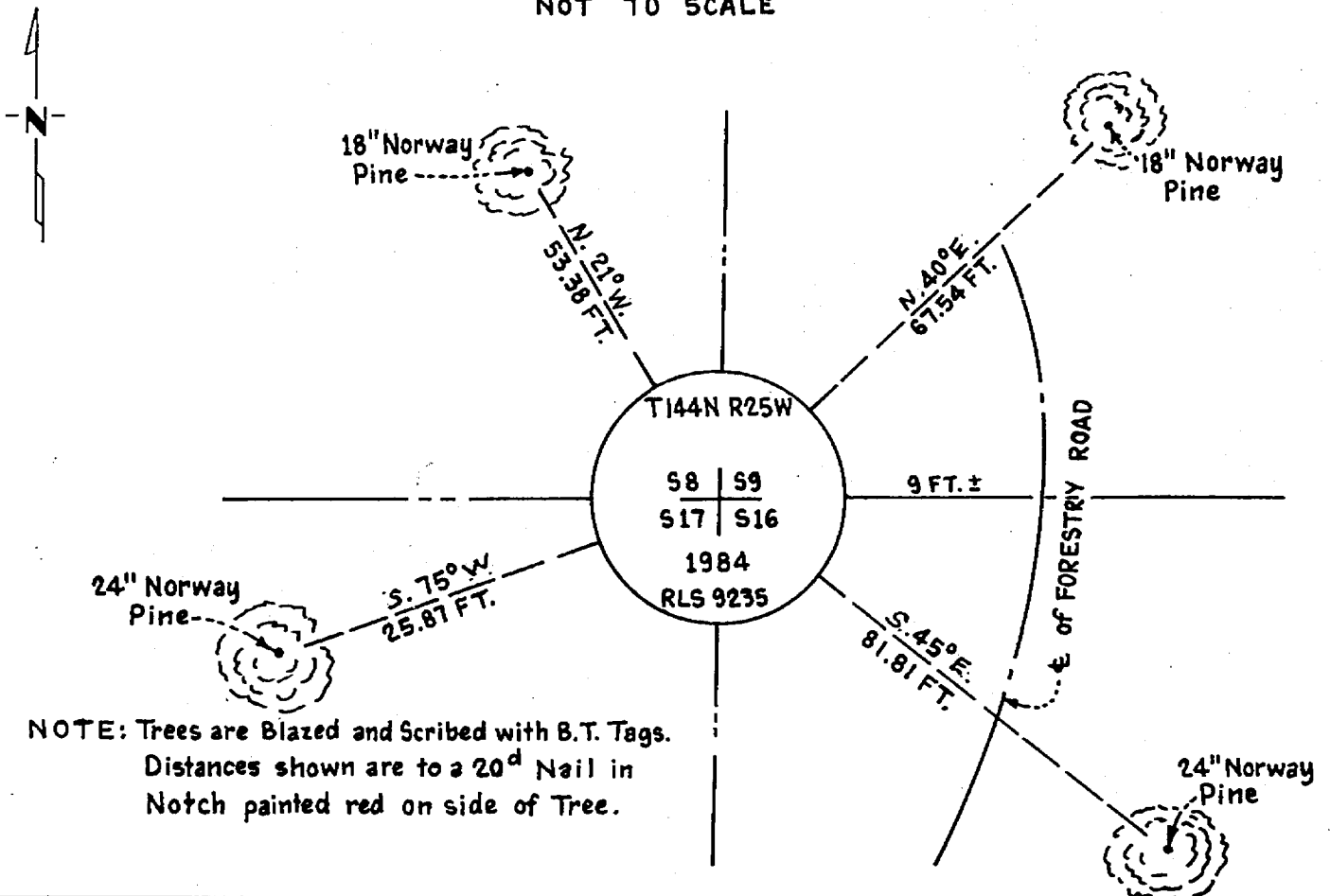

NOTE: Trees are Blazed and Scribed with B.T. Tags.  
Distances shown are to a 20<sup>d</sup> Nail in Notch painted red on side of Tree.

Statement of evidence relative to this corner location is on back of page.

I hereby certify that this document and the data contained herein was prepared by me or under my direct supervision

James H. Parker 3/29/85  
SIGNATURE DATE

Registration No. 9235

- Land Surveyor,  Professional Engineer
- County Surveyor,  County Engineer

281683  
OFFICE OF THE COUNTY RECORDER  
County of Cass

I hereby certify that this document was filed in the Co. Recorders office at 4:26 P.M. on the 2 day of May A.D., 1985

County Recorder Claudia Kayler  
By MS Deputy.

DOCUMENT NO. 281683

Statement of Evidence:

J9

This corner was originally established in April, 1876, by B.C. Baldwin, Deputy Surveyor. The field notes of that survey are filed in the office of the Secretary of State, St. Paul, Minnesota. Mr. Baldwin's notes state that a post was set to mark the corner and referenced by the following:

A 7" Spruce that bears N51°E a distance of 16 links [10.56 feet]  
A 10" Norway Pine that bears S56°E a distance of 34 links [22.44 feet]  
A 8" White Pine that bears S52°W a distance of 24 links [15.84 feet]  
A 12" Norway Pine that bears N29°W a distance of 30 links [19.80 feet]

On June 14, 1984, personnel from Advance Surveying & Engineering Co. search for this corner position and the above mentioned references but to no avail. However we do find a corner location tag on a Dead Jack Pine, dated 2-21-1942, placed by Van Dolen of the U.S.F.S. This tag states S66°E a distance of 47 links to corner. Also on tag is scratched approx.

On December 14, 1984, we return to this corner position to set a monument. There is now a new Forest Service Road thru this area. We now find a 20" Norway Pine to the Southeast that has a upper and lower blaze. With assistance from the U.S.F.S. we cut open blazes on tree to look for scribing. We can find no trace of scribing although we do find axe marks. We then count growth rings on tree to determine when blazing occurred and are able to determine it to be done 42 years ago. We feel these blazes were made by Van Dolen in 1942 while searching for original Bearing Trees and that he did not find any evidence as he placed his corner location tag approximately 200 feet to the North. We then set this corner position by double proportionate method between the Northwest corner of Section 17 and the North Quarter corner of Section 16 and between the Northeast corner of Section 8 and the Southwest corner of Section 16.