

CERTIFICATE OF LOCATION OF GOVERNMENT CORNER

Northwest Corner of Section 8, Township 144N, Range 25W, 5th P.M.

STATE OF MINNESOTA, County of Cass

At the corner location shown on the sketch:

- On _____ found a _____
DATE
- left monument as found, lowered monument, removed monument (explain)
- On 12-13-1984 placed a 2 1/2" (O.D.) by 5 feet long galvanized iron
DATE pipe with 3" brass cap as shown. Up 1.5 feet

5° East declination

SKETCH OF REFERENCE TIES
Not to Scale

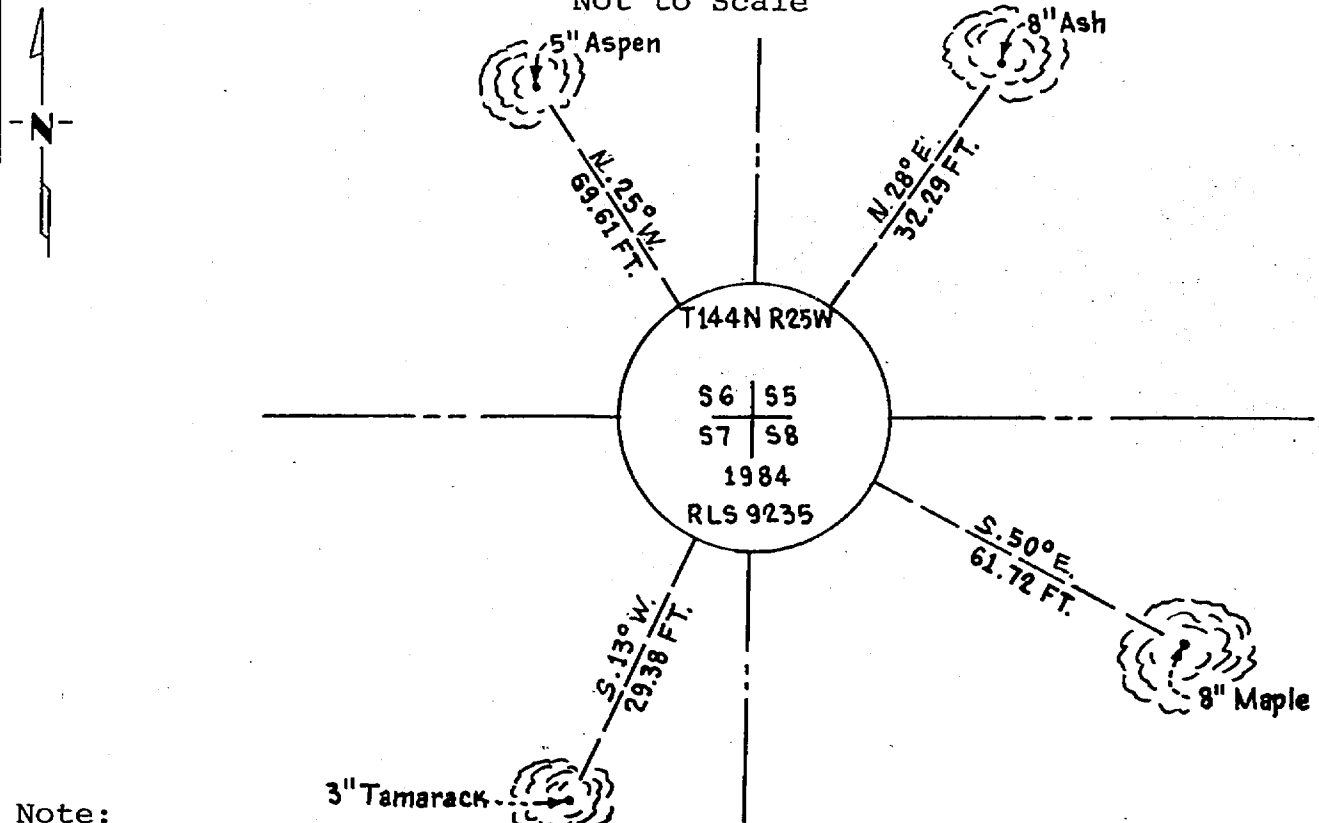

Note:

Trees are blazed & scribed with B.T. tags
Distances shown are to a 20^d nail in notch
painted red on side of tree.

Statement of evidence relative to this corner location is on back of page.

I hereby certify that this document and the data contained herein was prepared by me or under my direct supervision.

James H. Parker SIGNATURE 3/29/85 DATE

Registration No. 9235

Land Surveyor, Professional Engineer

County Surveyor, County Engineer

281668

OFFICE OF THE COUNTY RECORDER
County of Cass

I hereby certify that this document was filed in the Co. Recorders office at 3:35 P.M. on the 2 day of May A.D., 1985

County Recorder Clairine Kayler
By MS, Deputy

DOCUMENT NO. 281668

Statement of Evidence:

E5

This corner was originally established in April, 1876, by B.C. Baldwin, Deputy Surveyor. The field notes of that survey are filed in the office of the Secretary of State, St. Paul, Minnesota. Mr. Baldwin's notes state that a post was set to mark the corner and referenced by the following:

A 6" Cedar that bears N68°E a distance of 10 links [6.60 feet]
A 8" Maple that bears S28°E a distance of 28 links [18.48 feet]
A 8" Birch that bears S64°W a distance of 10 links [6.60 feet]
A 8" Birch that bears N27°W a distance of 11 links [7.26 feet]

In 1900 a map of survey by the Corps of Engineers shows that they found the corner.

On June 12, 1984, personnel from Advance Surveying & Engineering Co. made a thorough search for this corner and the above mentioned references but to no avail. However we are able to determine an old fence corner position. From this we check feature calls from original Gov't notes. The feature calls fit well with this position.

On December 13, 1984, an additional search was made by Advance prior to reestablishing this corner by Obliterated methods at fence corner position.