

CERTIFICATE OF LOCATION OF GOVERNMENT CORNER

Witness Corner to _____ between _____
 Meander #30 _____ Corner of Section 5 & 8, Township 141N, Range 31W, 5th P.M.

STATE OF MINNESOTA, County of Cass

At the corner location shown on the sketch:

- On 8-30-84 found a 2½ inch (O.D.) iron pipe with 3 inch brass cap,
 stamped ^{DATE} as shown, up 1.5 feet.
- left monument as found, lowered monument, removed monument (explain)
- On _____ placed a _____
 DATE _____

Declination: 6° East

SKETCH OF REFERENCE TIES NOT TO SCALE

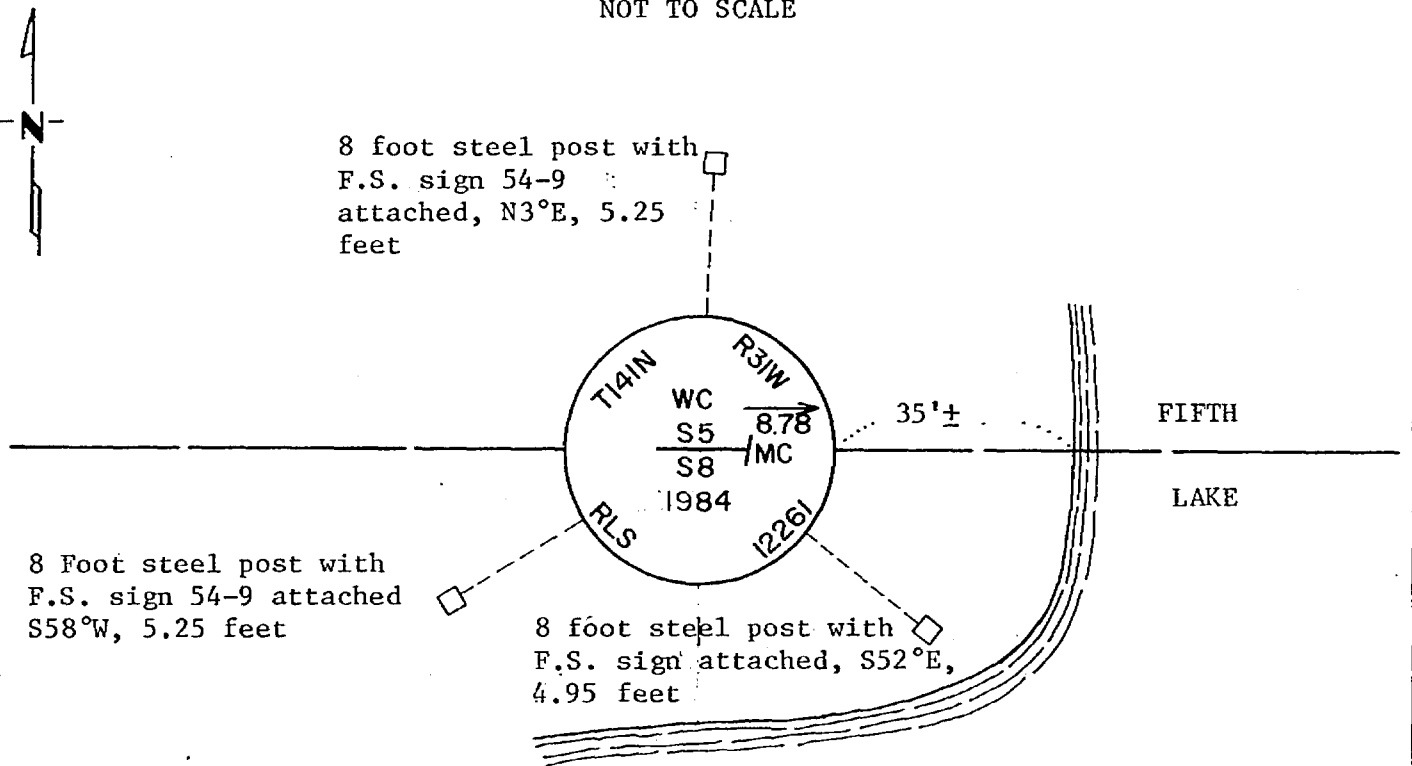

NOTE: All steel posts are marked with F.S. sign No. 54-9.

Statement of evidence relative to this corner location is on back of page.

I hereby certify that this document and the data contained herein was prepared by me or under my direct supervision.

William D. Orman 2-1-85
 SIGNATURE DATE

Registration No. 6807

- Land Surveyor, Professional Engineer
- County Surveyor, County Engineer

280554
 OFFICE OF COUNTY RECORDER

County of Cass
 I hereby certify that this document was filed in the Co. Recorder's office at 9:10 A.M. on the 27 day of February A.D., 1985
 County Recorder Claudine Kaylor
 By MS, Deputy

DOCUMENT NO. 280554

Statement of Evidence: Witness Corner, Meander Corner between Sections 5 & 8,
Township 141 North Range 31 West, 5th Principal Meridian.
West side Fifth Lake.

- 1873 P.H. Conger, U.S. Deputy Surveyor, set a post for this Meander Corner in his subdivision of the Township between August 5, 1873 and August 30, 1873. As references he scribed:
- | | | | |
|--------|--------|-------|----------------------|
| Willow | 3 inch | S79°W | 12 links (7.92 feet) |
| Willow | 3 inch | N81°W | 12 links (7.92 feet) |
- 1979 M. Stefan, R.L.S. and M. Hayes, U.S.F.S., made a thorough search for physical evidence of this corner on January 19, none was found.
- 1984 M. Hayes, U.S.F.S., returned to corner position. At the proportionate position for the lost Meander Corner, between the Meander Corner to the East and the reestablished Quarter Corner to the West, the position was found to fall in a beaver run. A Witness Corner was set which was a 2½ inch (O.D.) x 5 foot long iron pipe with a 3 inch diameter brass cap and references as follows:
- | | | |
|-------------------|-------|-----------|
| 8 foot steel post | N3°E | 5.25 feet |
| 8 foot steel post | S58°W | 5.25 feet |
| 8 foot steel post | S52°E | 4.95 feet |
- 1984 Kelly M. Booge, under F.S. Contract No. 53-6392-4-00996, made a thorough search on August 30 and found monument and ties in good condition as set by the U.S.F.S. earlier that year as shown on the sketch.

Kelly M. Booge is an employee of Okerman Surveying Inc.