

# CERTIFICATE OF LOCATION OF GOVERNMENT CORNER

CENTER SOUTH SIXTEENTH Corner of Section 15, Township 144, Range 29, 5th P.M.

STATE OF MINNESOTA, County of CASS

At the corner location shown on the sketch:

On 12/30/80 found a GLO brass cap monument as set in 1926,  
DATE

left monument as found,  lowered monument,  removed monument (explain)

On \_\_\_\_\_ placed a \_\_\_\_\_  
DATE

### SKETCH OF REFERENCE TIES

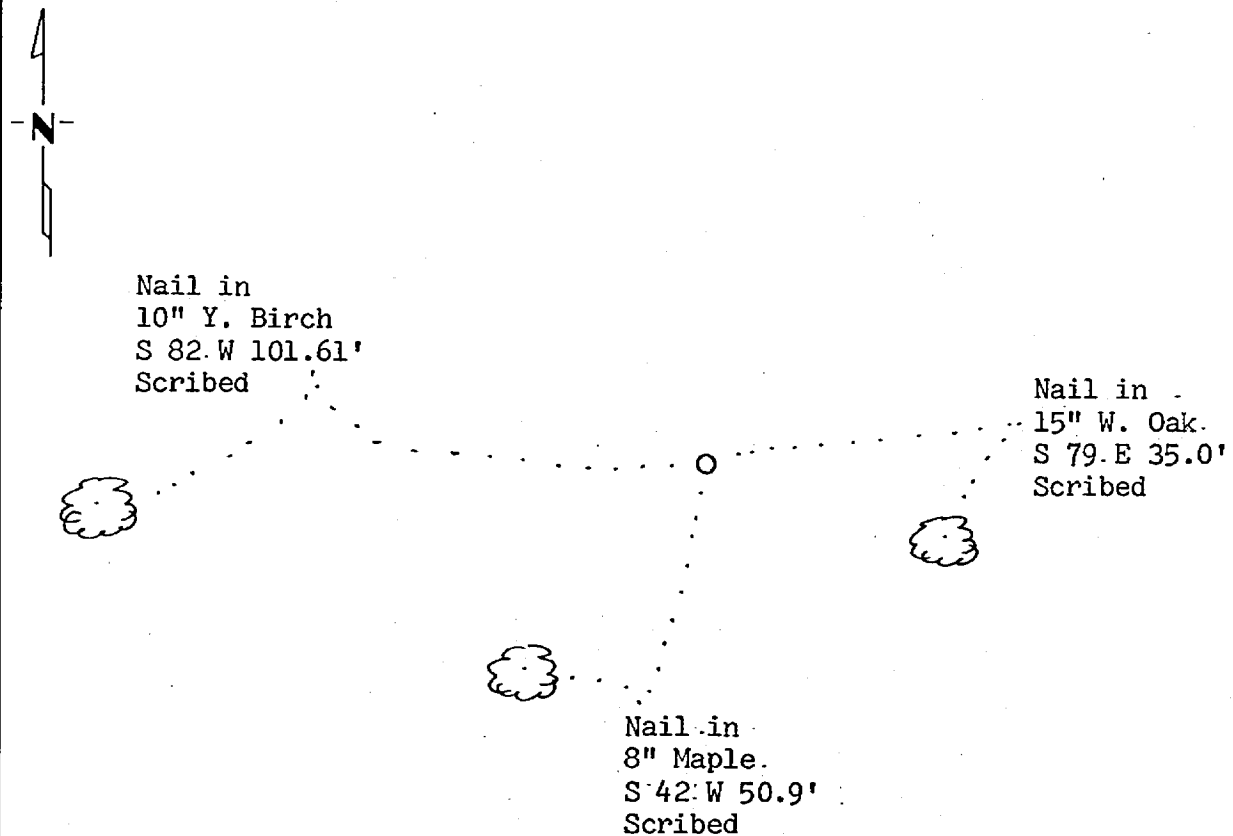

BEARINGS ARE APPROXIMATE

Statement of evidence relative to this corner location is on back of page.

I hereby certify that this document and the data contained herein was prepared by me or under my direct supervision.

Sandy H. Stevenson 9-15-82  
SIGNATURE DATE

Registration No. 12684

- Land Surveyor,  Professional Engineer
- County Surveyor,  County Engineer

279377  
OFFICE OF THE COUNTY RECORDER  
County of Cass

I hereby certify that this document was filed in the Co. Recorders office at 2:55 P. M. on the 10 day of Dec. A.D., 1984

County Recorder Cloude Kayler  
By MS, Deputy

DOCUMENT NO. 279377

Statement of Evidence:

- 1926 U.S. General Land Office dependent resurvey established this corner and an iron pipe with a marked brass cap was set to mark the corner. The following bearing trees were marked: 8" Maple S 89 E 14 links and 8" Ironwood S 88 W 18 links.
- 1970 U.S. Forest Service records show the following: S. Morrison found the brass cap monument.
- 1980 U.S. Forest Service technician G. Brama found the corner monumented with a GLO brass cap monument in good condition up 8". The following bearing trees were found: Maple at S 88 W 11.88' with scribing. (Evidently the bearings and distances were switched between the Maple and Ironwood.) No evidence found of the Ironwood. Three new bearing trees were marked and are shown on this certificate. Steel sign posts were set 1.55' west and 1.60' north of the corner. The Maple BT was cut down.
- 1982 County Surveyor's Records in the Recorder's Office were checked and no resurvey information was found on this corner.
- 1982 Analysis of the above data indicates that the location of this Government corner has been perpetuated. I accepted the monument as marking the corner location as when set in 1926 by the GLO resurvey based on bearing tree evidence.