

CERTIFICATE OF LOCATION OF GOVERNMENT CORNER

NORTHWEST SIXTEENTH Corner of Section 7, Township 141, Range 28, 5th P.M.

STATE OF MINNESOTA, County of CASS

At the corner location shown on the sketch:

On 3/11/80 found a GLO brass cap monument as set in 1918.
DATE

left monument as found, lowered monument, removed monument (explain)

On _____ placed a _____
DATE

SKETCH OF REFERENCE TIES

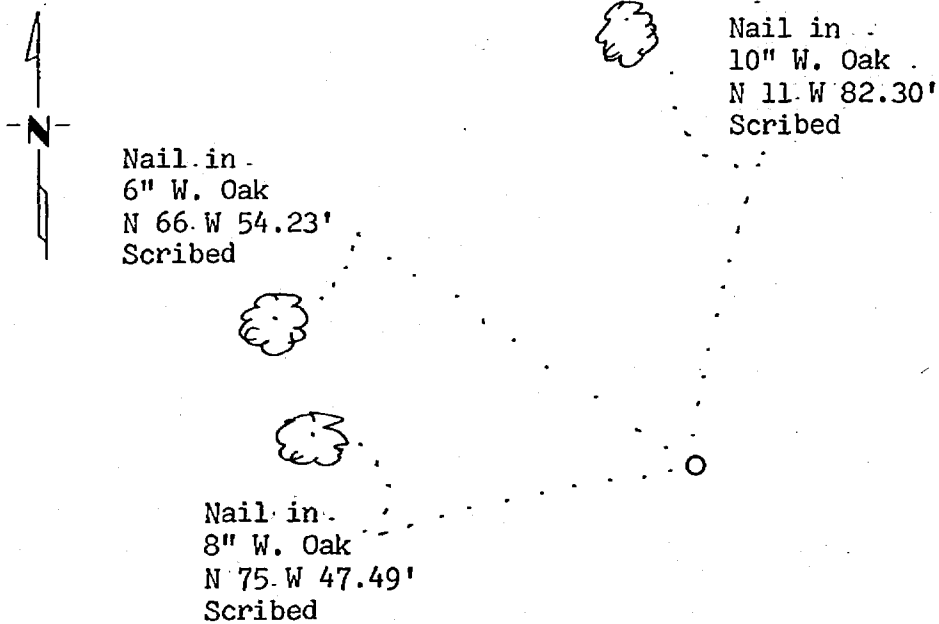

BEARINGS ARE APPROXIMATE

Statement of evidence relative to this corner location is on back of page.

I hereby certify that this document and the data contained herein was prepared by me or under my direct supervision.

Nancy H. Stevens 9-15-82
SIGNATURE DATE

Registration No. 12604

- Land Surveyor, Professional Engineer
- County Surveyor, County Engineer

279373
OFFICE OF THE COUNTY RECORDER
County of Cass

I hereby certify that this document was filed in the Co. Recorders office at 3:35 P.M. on the 10 day of Dec, A.D., 1984

County Recorder Clondine Kaylor
By MS, Deputy

DOCUMENT NO. 279373

Statement of Evidence:

- 1918 U.S. General Land Office dependent resurvey established this corner and an iron pipe with a marked brass cap was set to mark the corner. The following bearing trees were marked: 10" J. Pine S $43\frac{1}{4}$ E 432 links and 14" R. Oak S $22\frac{1}{2}$ W 582 links.
- 1980 U.S. Forest Service technician W. Olson found the corner monumented with a GLO brass cap monument under ice and leaning. Monument was straightened. The following bearing trees were found: 14" J. Pine stump at correct bearing and within 2' of record distance. Three new bearing trees were marked and are shown on this certificate.
- 1982 County Surveyor's Records in the Recorder's Office were checked and no resurvey information was found on this corner.
- 1982 Analysis of the above data indicates that the location of this Government corner has been perpetuated. I accepted the monument as marking the corner location as when set in 1918 by the GLO resurvey based on bearing tree evidence.