

CERTIFICATE OF LOCATION OF GOVERNMENT CORNER

Standard Southeast Corner of Section 36, Township 145 N, Range 28 W, 5th P.M.

STATE OF MINNESOTA, County of CASS

At the corner location shown on the sketch:

- On 09-08-81 found a 7 inch diameter concrete monument with a GLO brass cap, stamped as shown, and a 2.5 inch diameter iron pipe with a well cap.
DATE
- left monument as found, lowered monument, removed monument (explain)
- On _____ placed a _____
DATE

Magnetic: 5° E. decl.

SKETCH OF REFERENCE TIES

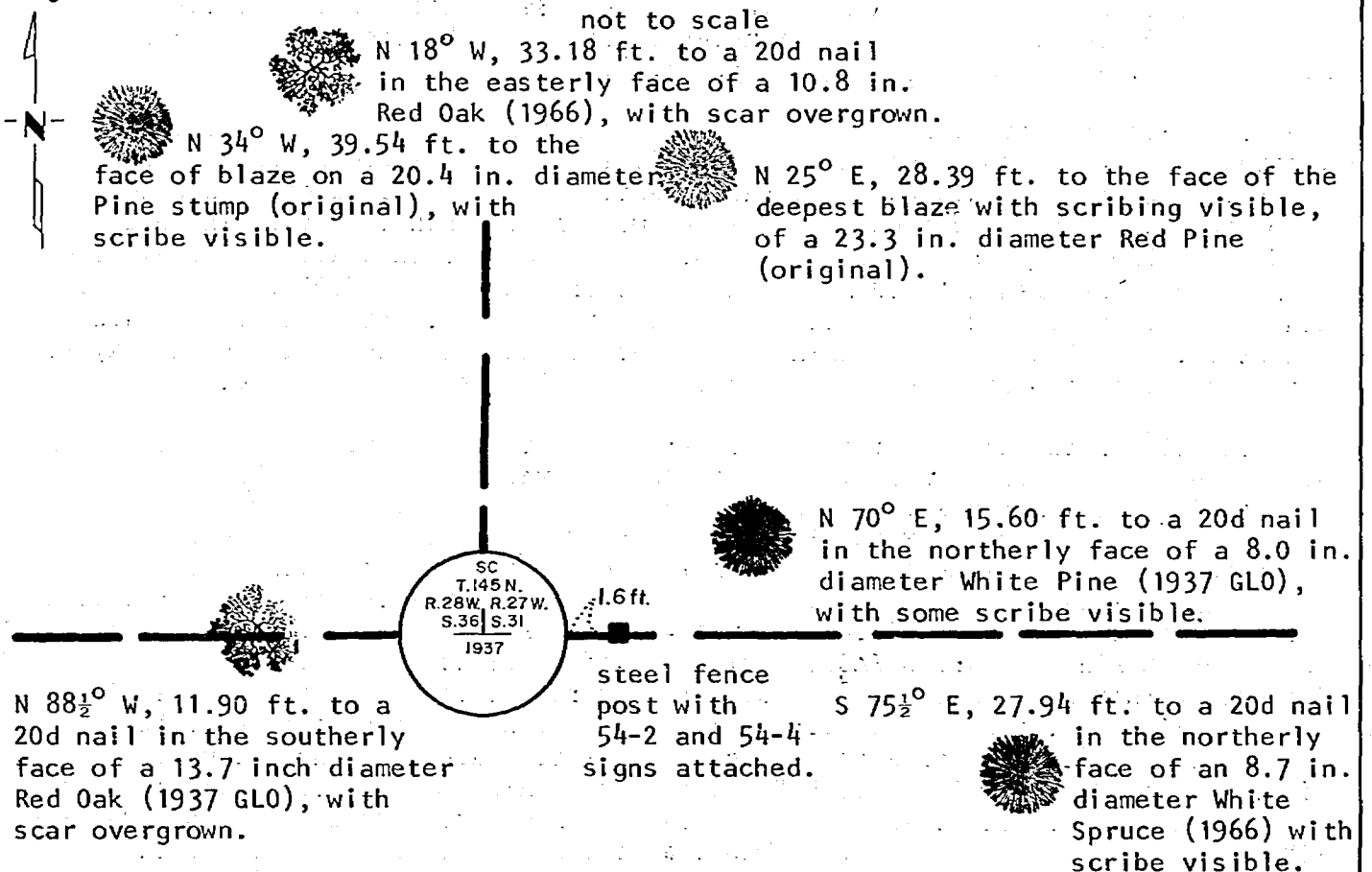

All trees are painted with red enamel and marked with a 54-3 (Bearing Tree) tag.

Statement of evidence relative to this corner location is on back of page.

I hereby certify that this survey, plan or report was prepared by me or under my direct supervision and that I am a duly Registered Land Surveyor under the laws of the State of Minnesota.

Kenneth L. Whitson

Date 3-5-84 Registration No. 14677

274372
OFFICE OF THE COUNTY RECORDER
County of Cass

I hereby certify that this document was filed in the Co. Recorders office at 11:00 A.M. on the 19 day of March A.D., 1984

County Recorder Cloudine Kaylor

By MS, Deputy

DOCUMENT NO. 274372

Statement of Evidence: The Standard Southeast Corner of Section 36, Township 145 North, Range 28 West of the 5th Principal Meridian.

George R. Stuntz, Deputy Surveyor, originally established this corner position on August 17, 1871, while running the 11th Standard Parallel. The notes for this survey are on file in the Office of the Secretary of State, St. Paul, Minnesota. The notes indicate that Mr. Stuntz set a post to mark the corner position and the following witnesses: a 16 inch diameter Yellow Pine that bears NORTH 35 degrees WEST a distance of 60 links (39.60 feet); and a 6 inch diameter Yellow Pine that bears NORTH 20 degrees EAST, a distance of 43 links (28.38 feet).

A John Curo survey is on file in the Office of the Cass County Recorder, Walker, Minnesota, as Survey No. 222, in Survey Book A, page 544. This record indicates that on December 11, 1912, Mr. Curo found both Government bearing trees, "standing green and plainly marked". On December 16, 1912, Mr. Curo set a 2.5 inch by 48 inch galvanized iron pipe, with a 3 inch cap, to mark this corner position. At a variation of 8 degrees 25 minutes the Government bearing trees are: a 16 inch diameter Yellow Pine that bears NORTH 34 degrees 34 minutes WEST, a distance of 60 links (39.60 feet); and a 6 inch diameter Yellow Pine that bears NORTH 22 degrees 55 minutes EAST, a distance of 43 links (28.38 feet)

U.S. Forest Service Form 874-9 indicates that Z. A. Zasado, Technician Foreman, visited this corner position on December 18, 1933. This record is on file in the Supervisor's Office, Chippewa National Forest, Cass Lake, Minnesota. This form indicates the corner position to be marked with an 18 inch iron pipe in good condition. The following are listed as witnesses: a 14 inch diameter Norway Pine, with old BT, that bears NORTHEAST, a distance of 1/2 chain (33.00 feet); a 16 inch diameter Norway Pine, with Forest Service Location Poster attached, that bears NORTHEAST, a distance of 1/2 chain (33.00 feet); and a 24 inch diameter Norway Pine, with old BT, that bears NORTHWEST, a distance of 1/2 chain (33.00 feet).

On file in the Office of the Secretary of State, St. Paul, Minnesota, are the notes from a dependent resurvey of portions of Township 144 North, Range 27 west of the 5th Principal Meridian. This survey was executed by Hal D. Craig, Surveyor, Government Land Office (now the Bureau of Land Management) in 1937. These notes state that a 6 inch diameter by 24 inch long concrete monument with a 3.5 inch diameter brass tablet, stamped as shown in the sketch, was set from evidence of the original bearing trees: a 14 inch diameter Norway Pine, marked "T145N R27W S31", that bears NORTH 23 degrees EAST, a distance of 43 links (28.38 feet); a 24 inch diameter Norway Pine, with portion of scribe marks discernible, that bears NORTH 35 degrees WEST, a distance of 60 links (39.60 feet). No mention is made to the 1912 iron pipe. The new witnesses to this corner position are: a 5 inch diameter White Pine, marked "SC T145N R27W S31 BT", that bears NORTH 69.5 degrees EAST, a distance of 23 links (15.18 feet); and a 6 inch diameter Red Oak, marked "SC T145N R28W S36 BT", that bears NORTH 87.5 degrees WEST, a distance of 18 links (11.88 feet).

U.S.D.A. Forest Service records indicate that on June 13, 1966, Milton Hansey visited this corner position. The record of this visitation is on file in the Supervisor's Office, Chippewa National Forest, Cass Lake, Minnesota. This record indicates that the 1937 GLO concrete monument, the 1912 iron pipe, the remains of the original bearing trees, and the 1937 GLO bearing trees were recovered. The 1937 GLO Red Oak was rescribed "S36 BT". The notes further indicate that the following new witnesses were marked: a 10 inch diameter Burr Oak, scribe "S36 BT", that bears NORTH 14 degrees West, a distance of 33.18 feet; and a 7 inch diameter White Spruce, scribed "S31 BT", that bears SOUTH 77 degrees EAST, a distance of 27.94 feet.

(continued on page 3)

CERTIFICATE OF LOCATION OF GOVERNMENT CORNER

The Standard Southeast Corner of Section 36, Township 145 North, Range 28 West of the 5th Principal Meridian.

On September 8, 1981, Ron Olesen and I visited this corner and found the 1937 concrete monument, in good condition, and a 2.5 inch (outside diameter) iron pipe, with a well cap, alongside. We did not check the bearing trees at this time as we did not have any records with us.

On December 5, 1982, I returned to this corner position to bring it to U.S. Forest Service standards. I recovered the remains of the following original witnesses: a 20.4 inch diameter Norway Pine stump, with "BT" scribe visible, that bears NORTH 34 degrees WEST, a distance of 39.54 feet to the face of the blaze; and a 23.3 inch diameter Norway Pine that bears NORTH 25 degrees EAST, a distance of 28.39 feet to the face of the deepest blaze, with scribe visible. There was a second blaze 2 inches further out, with scribe also visible. I also recovered a 21.0 inch diameter Norway Pine from 1933, with a U.S. Forest Service Location Poster attached, that bears NORTH 37 degrees EAST, a distance of 32.4 feet to the face of the tree. I also recovered the 1937 GLO bearing trees and the 1966 USFS bearing trees as shown on the sketch. This corner position is definitely a perpetuation of the original corner position and I accept this location as such.