

CERTIFICATE OF LOCATION OF GOVERNMENT CORNER

North Quarter Corner of Section 32, Township 139N, Range 30W, 5th P.M.

STATE OF MINNESOTA, County of Cass

At the corner location shown on the sketch:

- On 2/13/81 found a Spike (down 3")
DATE
- left monument as found, lowered monument, removed monument (explain)
- On 9/1/81 placed a Minnesota Department of Transportation Cast Iron Monument (flush with bituminous surface)
DATE

SKETCH OF REFERENCE TIES

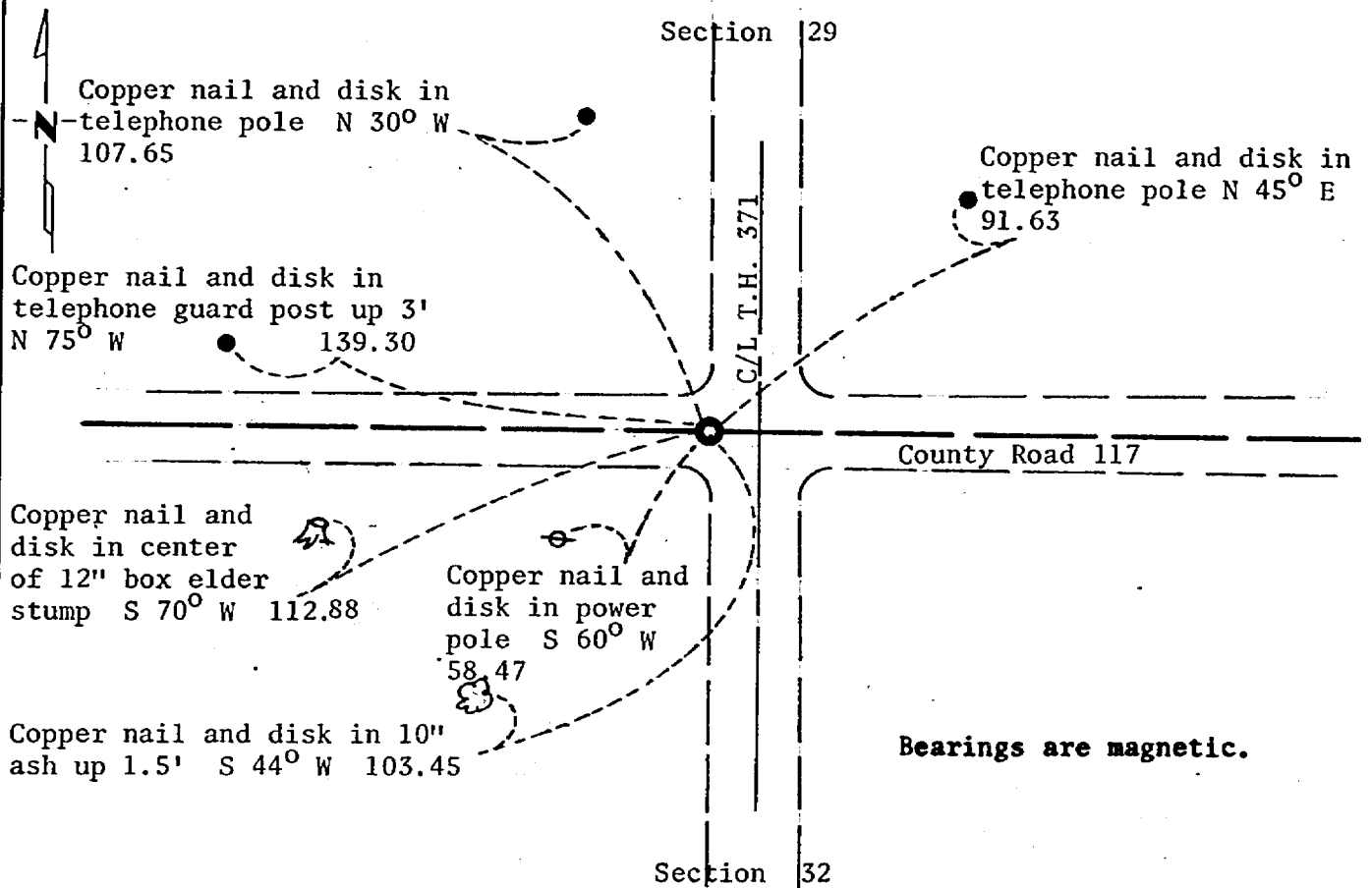

Section 32
 Monument is 17 feet west of C/L T.H. 371 and approximate C/L roads east and west

Statement of evidence relative to this corner location is on back of page.

I hereby certify that this document and the data contained herein was prepared by me or under my direct supervision.

James W. Nielson 3/4/83
SIGNATURE DATE

Registration No. 11865

- Land Surveyor, Professional Engineer
- County Surveyor, County Engineer

OFFICE OF THE COUNTY RECORDER

County of Cass

I hereby certify that this document was filed in the Co. Recorders office at 12:45 P .M. on the 4 day of April A.D., 1983

County Recorder Claudine Kayler

By MS, Deputy

DOCUMENT NO. 267959

Statement of Evidence:

North Quarter Corner Section 32, Township 139 North, Range 30 West, 5th Principal Meridian.

The Original Public Land Survey was run in 1865 and a wood post was set to mark the corner.

In 1906, Mr. John Curo set an 8" x 8" x 36" concrete post at a lost location which fit the roots of the original bearing trees.

In 1930, the Minnesota State Highway Department found the concrete monument and called for it 17.0 feet west of P.I. Station 598+74.1.

In 1967, the Minnesota State Highway Department found a 2" iron pipe at the corner location.

In 1981, the Minnesota Department of Transportation found a spike at the corner location. The spike fits the lost location of 1906 and is 17.0 feet west of P.I. Station 598+74.1 as called for in 1930.

The Minnesota Department of Transportation accepts the spike as a perpetuation of the original Government corner, **as established by Mr. Curo in 1906.**

For details and survey analysis, contact the Minnesota Department of Transportation Surveys Office in Brainerd, Minnesota.