

CERTIFICATE OF LOCATION OF GOVERNMENT CORNER

CENTER NORTH SIXTEENTH Corner of Section 30, Township 142, Range 30, 5th P.M.
 STATE OF MINNESOTA, County of CASS

At the corner location shown on the sketch:

On 2/4/81 found a GLO brass cap iron monument as set in 1917.
DATE

left monument as found, lowered monument, removed monument (explain)

On _____ placed a _____
DATE

SKETCH OF REFERENCE TIES

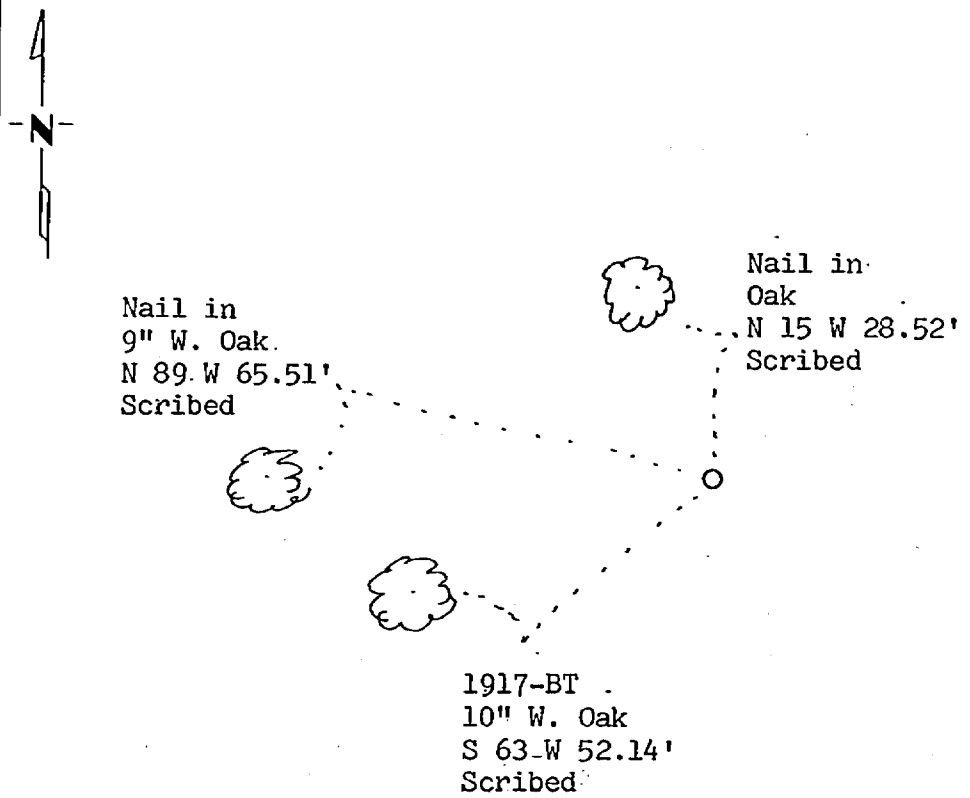

BEARINGS ARE APPROXIMATE

Statement of evidence relative to this corner location is on back of page.

I hereby certify that this document and the data contained herein was prepared by me or under my direct supervision.

Dany H. Stevenson 9-14-82
SIGNATURE DATE

Registration No. 12684

- Land Surveyor, Professional Engineer
 County Surveyor, County Engineer

265256
 OFFICE OF THE COUNTY RECORDER

County of _____

I hereby certify that this document was filed in the Co. Recorders office at 10:05 A.M. on the 29 day of Sept. A.D., 1982

County Recorder Deulah Herdink

By MS, Deputy

DOCUMENT NO. 265256

Statement of Evidence:

- 1917 U.S. General Land Office dependent resurvey established this corner and an iron pipe with a marked brass cap was set to mark the corner. The following bearing trees were marked: 10" Oak N $3\frac{1}{2}$ E 46 links and 5" Oak N 63 W 79 links.
- 1971 Robert F. Schneider, RLS #5740, surveyed plat of REHM'S ESTATES filed in October, 1971. Plat borders the east line of the NE $\frac{1}{4}$ of the NW $\frac{1}{4}$ of Sec. 30. His notes show GLO brass cap monument found in place and used.
- 1981 U.S. Forest Service technician W. Olson found the corner monumented with a GLO brass cap monument in good condition up 0.5'. The following bearing trees were found: 10" W. Oak S 63 W 52.14' with blaze scar overgrown. Two new bearing trees were marked and are shown on this certificate.
- 1982 On Sept. 9 I visited the corner and found items as per the 1981 USFS reports. I accepted the monument as marking the same position as when set in 1917 by the GLO resurvey based on the one bearing tree found and R.F. Schneider's traverse information.
- 1982 County Surveyor's Records in the Recorder's Office were checked and no resurvey information was found on this corner.