

# CERTIFICATE OF LOCATION OF GOVERNMENT CORNER

Northeast Corner of Section 7, Township 145N, Range 29W, 5th P.M.

STATE OF MINNESOTA, County of Cass

At the corner location shown on the sketch:

On 11/20/81 found a 2" x 5" iron pipe with brass cap  
DATE

left monument as found,  lowered monument,  removed monument (explain)

On                      placed a                       
DATE

### SKETCH OF REFERENCE TIES

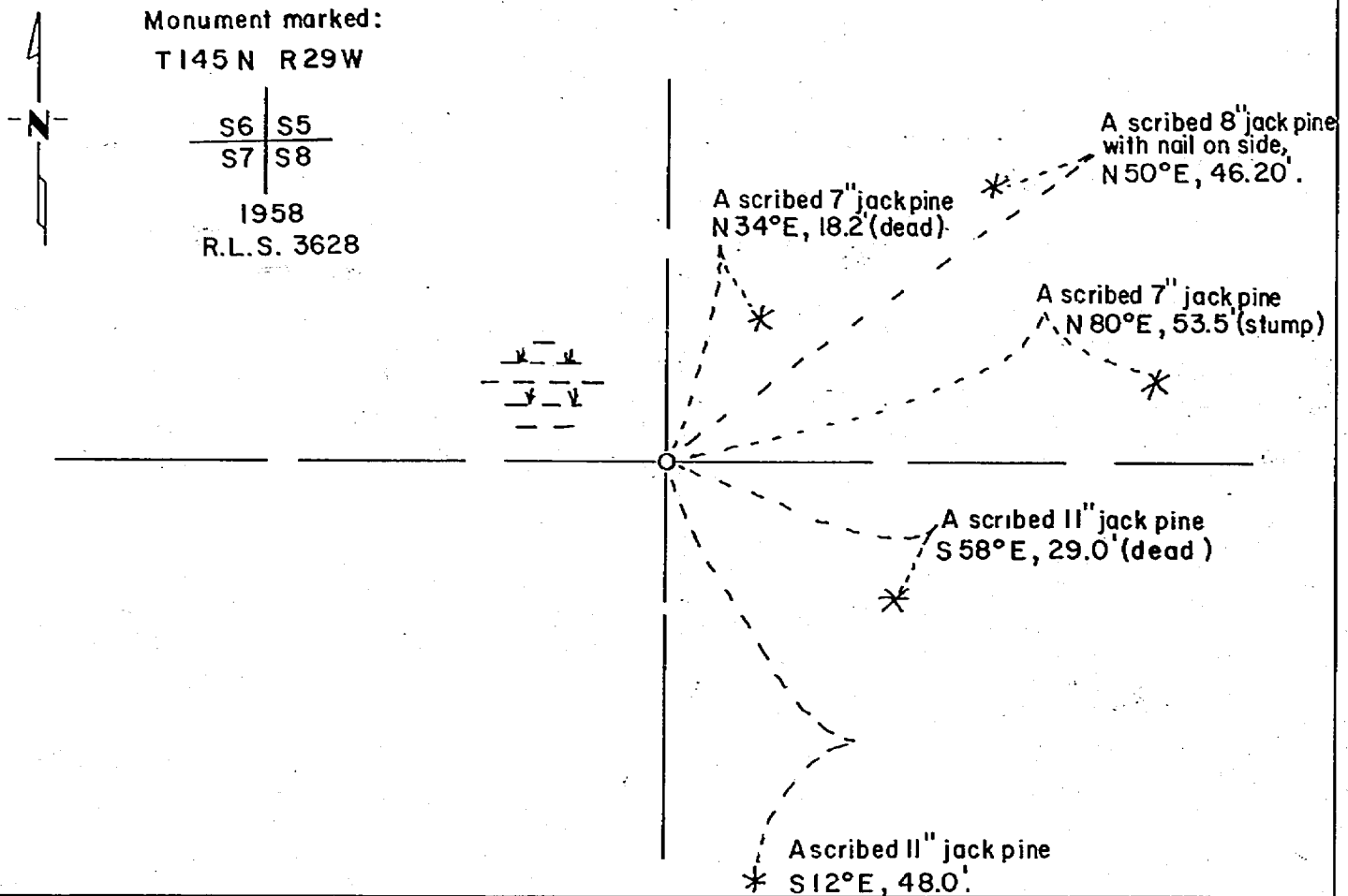

Statement of evidence relative to this corner location is on back of page.

I hereby certify that this document and the data contained herein was prepared by me or under my direct supervision.

Anthony E. Kerick 11/30/81  
SIGNATURE DATE

Registration No. 12266

Land Surveyor,  Professional Engineer

County Surveyor,  County Engineer

265248  
 OFFICE OF THE COUNTY RECORDER  
 County of Cass

I hereby certify that this document was filed in the Co. Recorders office at 9:25 A.M. on the 29 day of Sept. A.D., 1982

County Recorder Burdick Handman

By MS, Deputy

DOCUMENT NO. 265248

Statement of Evidence:

NORTHEAST CORNER OF SECTION 7, TOWNSHIP 145 NORTH,  
RANGE 29 WEST OF THE 5th PRINCIPAL MERIDIAN.

The original Public Land Survey was run in 1874 by Bonger. He placed a wood post to mark the corner and recorded two bearing trees as accessories: a 12 inch Black Pine South 37 degrees East 33 links, a 10 inch Black Pine North 45 degrees East 54 links.

In 1958, Peter J. Meyer, Registration No. 3628, found no remains of the corner. He found the remains of one original bearing tree, a 20 inch windfall with scribe B.T. visible North 45 degrees East 54 links. He marked a brass cap on a 5 foot long, 2 inch diameter, iron post and recorded the following bearing trees as accessories: a 9 inch Jack Pine South 12 degrees East 48.0 feet, a 10 inch Jack Pine South 58 degrees East 29.0 feet, a 6 inch Jack Pine North 80 degrees East 53.5 feet, a 7 inch Jack Pine North 34 degrees East 18.2 feet.

In 1981, A. Kerick, Registration No. 12266, found the remains of one original bearing tree: a 20 inch Black Pine Stump rotted, scribing barely visible, North 45 degrees East 54 links. He also found the marked brass cap on an iron post and the following bearing trees as recorded by P. Meyer in 1958: an 11 inch Jack Pine South 12 degrees East 48.0 feet, an 11 inch Jack Pine top rotted, scribing visible, South 58 degrees East 29.0 feet, a 7 inch Jack Pine Stump, scribing visible, North 80 degrees East 53.5 feet, a 7 inch Jack Pine top rotted, scribing visible, North 34 degrees East 18.2 feet. One new bearing tree was marked as accessory and appears on this certificate.

An analysis of the above data indicates that the location of this Public Land Survey corner has been perpetuated by the brass capped iron post as recorded and the accessories by P. Meyer in 1958 and the accessory recorded by A. Kerick in 1981.