

CERTIFICATE OF LOCATION OF GOVERNMENT CORNER

SOUTH SIXTEENTH Corner of Section 30&29, Township 144, Range 30, 5th P.M.

STATE OF MINNESOTA, County of CASS

At the corner location shown on the sketch:

On 3/3/81 found a GLO brass cap monument as set in 1930.
DATE

left monument as found, lowered monument, removed monument (explain)

On _____ placed a _____
DATE

SKETCH OF REFERENCE TIES

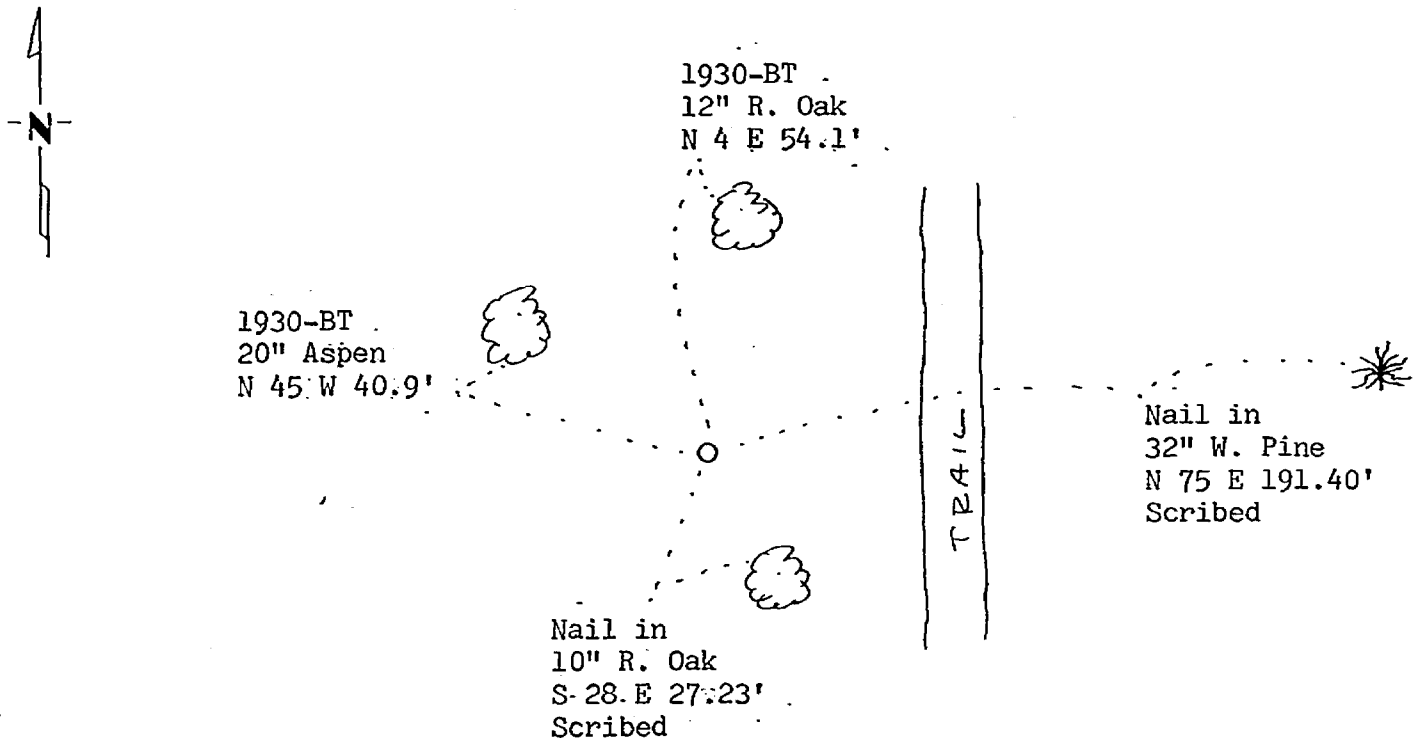

BEARINGS ARE APPROXIMATE

Statement of evidence relative to this corner location is on back of page.

I hereby certify that this document and the data contained herein was prepared by me or under my direct supervision.

Dary H. Stevenson 9-13-82
SIGNATURE DATE

Registration No. 12684

Land Surveyor, Professional Engineer

County Surveyor, County Engineer

264958
 OFFICE OF THE COUNTY RECORDER
 County of Cass

I hereby certify that this document was filed in the Co. Recorders office at 10:19 A.M. on the 14 day of Sept. A.D., 1982

County Recorder Brenda Herdink

By MS, Deputy

DOCUMENT NO. 264958

Statement of Evidence:

- 1930 U.S. General Land Office dependent resurvey established this corner and an iron pipe with a marked brass cap was set to mark the corner. The following bearing trees were marked: 6" R. Oak N $4\frac{1}{4}$ E 82 links and 6" Poplar N $44\frac{1}{2}$ W 62 links.
- 1970 U.S. Forest Service records show the following: C. Schluter found the brass cap monument.
- 1975 U.S. Forest Service records show the following: C. Krause found the brass cap monument and both 1930 bearing trees.
- 1981 U.S. Forest Service technician G. Brama found the corner monumented with a GLO brass cap monument in good condition up 4". The following bearing trees were found: 20" Aspen-N 45 W 40.9' and 12" R. Oak N 4 E 54.1'. Both trees show blaze scar overgrown. Two new bearing trees were marked and are shown on this certificate. Steel sign posts were set 3.75' north and 4.05' south of the corner.
- 1982 County Surveyor's Records in the Recorder's Office were checked and no resurvey information was found on this corner.
- 1982 Analysis of the above data indicates that the location of this Government corner has been perpetuated. I accepted the monument as marking the corner location as when set in 1930 by the GLO resurvey based on bearing tree evidence.