

CERTIFICATE OF LOCATION OF GOVERNMENT CORNER

NORTHEAST Corner of Section 6, Township 143, Range 30, 5th P.M.

STATE OF MINNESOTA, County of CASS

At the corner location shown on the sketch:

On 3/4/81 found a GLO brass cap monument as set in 1930 from evidence
of original post and bearing trees.

left monument as found, lowered monument, removed monument (explain)

On _____ placed a _____
DATE

SKETCH OF REFERENCE TIES

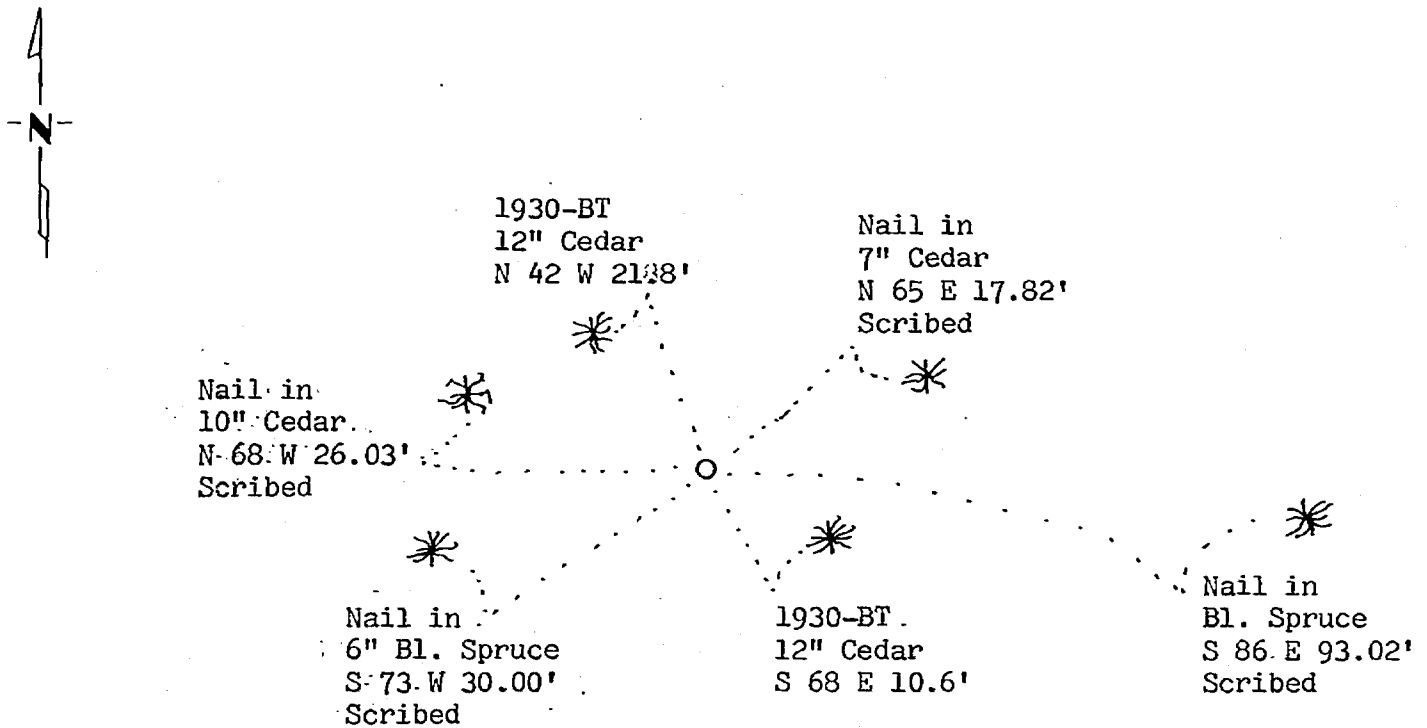

BEARINGS ARE APPROXIMATE

Statement of evidence relative to this corner location is on back of page.

I hereby certify that this document and the data contained herein was prepared by me or under my direct supervision.

Nancy A. Stevenson 9-11-82
SIGNATURE DATE

Registration No. 17684

Land Surveyor, Professional Engineer

County Surveyor, County Engineer

264937
OFFICE OF THE COUNTY RECORDER
County of Cass

I hereby certify that this document was filed in the Co. Recorders office at 9:50 A.M. on the 14 day of Sept. A.D., 1982

County Recorder Brenda Herdink
By MS, Deputy

DOCUMENT NO. 264937

Statement of Evidence:

- 1875 U.S. General Land Office survey set wood post for this corner and marked the following bearing trees: 8" Tam: N 60 E 20 links, 6" Spruce N 46 W 15 links, 6" Spruce S 13 W 23 links, and 8" Tam. S 22 E 32 links.
- 1920 U.S. General Land Office dependent resurvey found the corner marked by an old wood post showing scribe marks and three original bearing trees showing scribe marks at correct bearing and distance. An iron pipe with a marked brass cap was set to mark the corner. The following bearing trees were marked: 8" Spruce N 31 E 30 links, 10" Cedar S 67½ E 16 links, 9" Spruce (Original) S 11 W 23 links, and 10" Cedar N 41½ W 33 links.
- 1981 U.S. Forest Service technician G. Brama found the corner monumented with a GLO brass cap monument leaning. Straightened monument. The following bearing trees were found: Original Spruce stump S 11 W 15.2', Original Tam: Stump S 22 E 21.1', 1930 Spruce log N 31 E 19.8', 1930 12" Cedar S 68 E 10.6'; and 1930 12" Cedar N 42 W 21.8'. Four new bearing trees were marked and are shown on this certificate. Steel sign posts were set 3.0' north, 2.7' south, and on south side of monument.
- 1982 County Surveyor's Records in the Recorder's Office were checked and no resurvey information was found on this corner.
- 1982 Analysis of the above data indicates that the location of this Government corner has been perpetuated. I accepted the monument as marking the corner location as when set in 1930 by the GLO resurvey based on bearing tree evidence.