

# CERTIFICATE OF LOCATION OF GOVERNMENT CORNER

CENTER QUARTER Corner of Section 31, Township 142, Range 30, 5th P.M.

STATE OF MINNESOTA, County of CASS

At the corner location shown on the sketch:

On 3/12/81 found a GLO brass cap monument as set in 1917.  
DATE

left monument as found,  lowered monument,  removed monument (explain)

On \_\_\_\_\_ placed a \_\_\_\_\_  
DATE

### SKETCH OF REFERENCE TIES

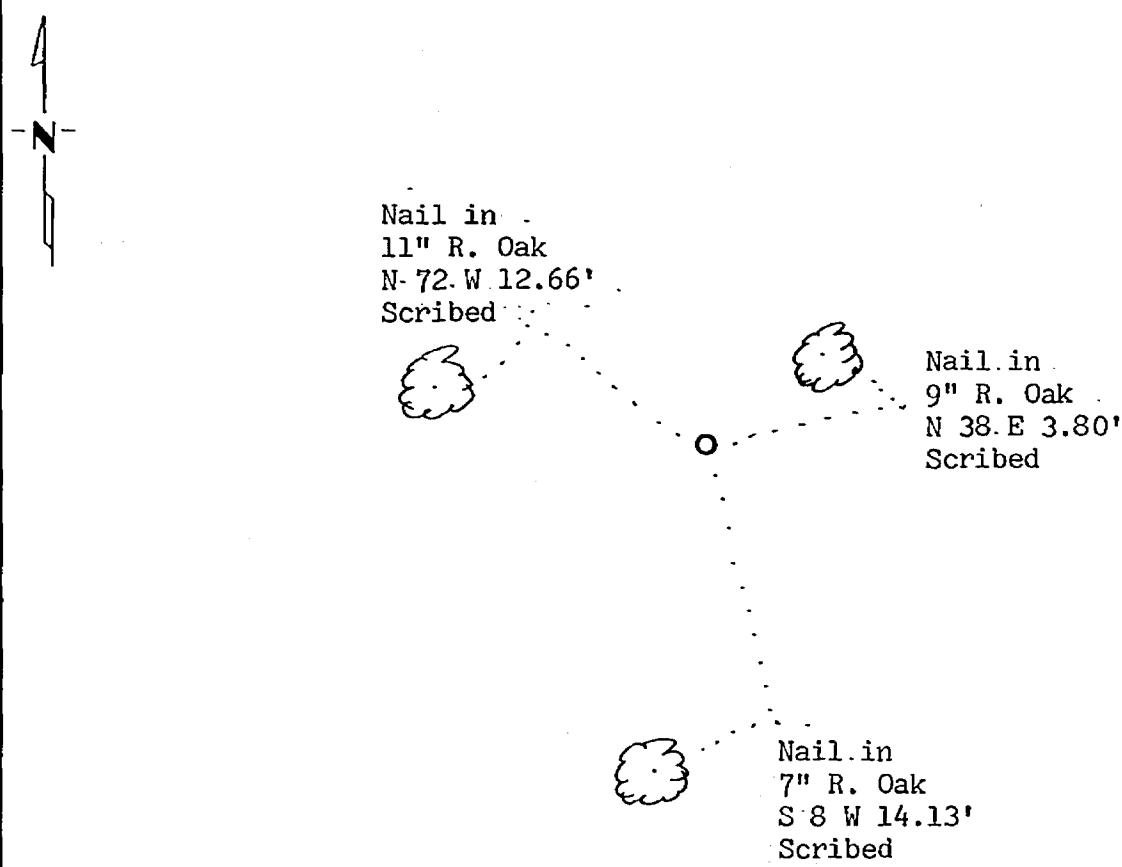

BEARINGS ARE APPROXIMATE

Statement of evidence relative to this corner location is on back of page.

I hereby certify that this document and the data contained herein was prepared by me or under my direct supervision.

Mary H. Stevenson 9-13-82  
SIGNATURE DATE

Registration No. 12684

- Land Surveyor,  Professional Engineer
- County Surveyor,  County Engineer

264933  
OFFICE OF THE COUNTY RECORDER  
County of Cass

I hereby certify that this document was filed in the Co. Recorders office at 9:30 A.M. on the 14 day of Sept. A.D., 1982

County Recorder Beulah Hendrick  
By MS, Deputy

DOCUMENT NO. 264933

Statement of Evidence:

- 1917 U.S. General Land Office dependent resurvey established this corner and an iron pipe with a marked brass cap was set to mark the corner. The following bearing trees were marked: 7" R. Oak N  $6\frac{1}{2}$  E 62 links and 6" Poplar N 31 W 95 links.
- 1965 U.S. Forest Service records show the following: L. Witthoeft found GLO brass cap monument.
- 1981 U.S. Forest Service technician W. Olsen found the corner monumented with a GLO brass cap monument in good condition up 0.4'. The following bearing trees were found: 11" R. Oak stump N  $6\frac{1}{2}$  E 40.9' rotted and mostly down. Three new bearing trees were marked and are shown on this certificate. Steel sign posts were set 4.0' west and 4.0' south of the corner.
- 1982 County Surveyor's Records in the Recorder's Office were checked and no resurvey information was found on this corner.
- 1982 On Sept. 9 I visited the corner and found items as per the 1981 USFS reports. The R. Oak stump reported in 1981 is old rotted log laying to the south. I found no evidence of scribe marks. There was some evidence that an old scar faced south when the tree was standing. A 10" R. Oak appears to be growing out of the old stump. With the found monument securely in place and the evidence of the R. Oak, I accepted the monument as marking the same position as when set in 1917.