

# CERTIFICATE OF LOCATION OF GOVERNMENT CORNER

CENTER QUARTER Corner of Section 22, Township 141, Range 29, 5th P.M.

STATE OF MINNESOTA, County of CASS

At the corner location shown on the sketch:

On 7/23/80 found a marked GLO brass cap monument in good condition up 6"  
DATE

left monument as found,  lowered monument,  removed monument (explain)

On \_\_\_\_\_ placed a \_\_\_\_\_  
DATE

## SKETCH OF REFERENCE TIES

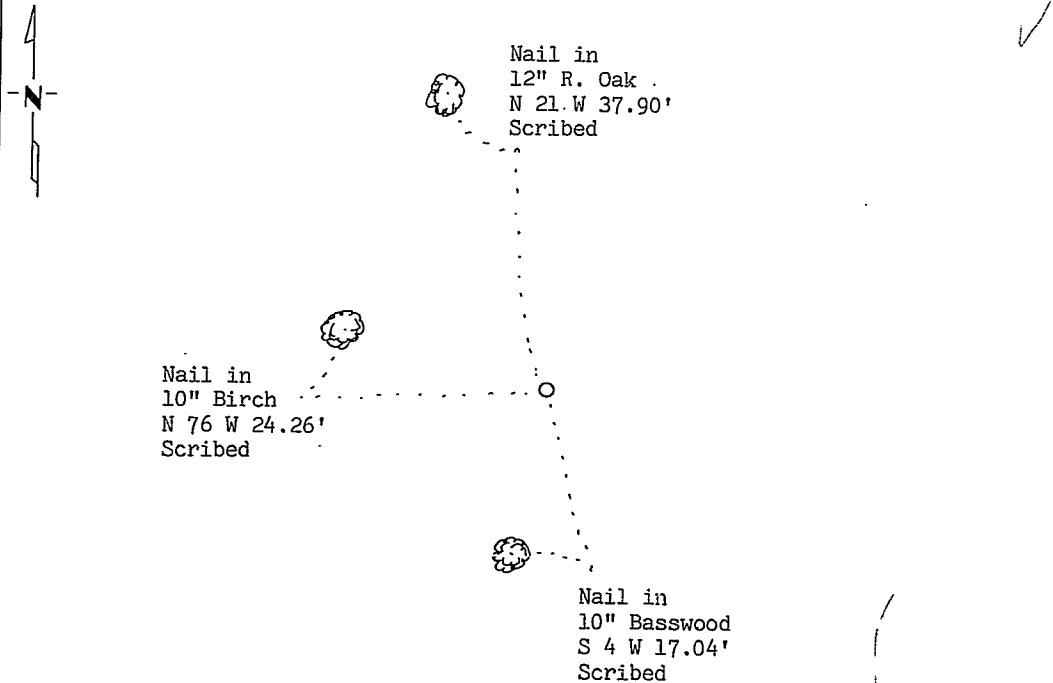

BEARINGS ARE APPROXIMATE

Statement of evidence relative to this corner location is on back of page 263903

I hereby certify that this document and the data contained herein was prepared by me or under my direct supervision.

Nancy H. Stevenson 4-30-82  
SIGNATURE DATE

Registration No. 12684

- Land Surveyor,  Professional Engineer  
 County Surveyor,  County Engineer

### OFFICE OF THE COUNTY RECORDER

County of Cass

I hereby certify that this document was filed in the Co. Recorders office at 2:25 A.M. on the 22 day of July A.D., 19 82

County Recorder Bentley Hendrich

By MS, Deputy

DOCUMENT NO. 263903

Statement of Evidence:

- 1918 U.S. General Land Office dependent resurvey established this corner and an iron pipe with a marked brass cap was set to mark the corner. The following bearing trees were marked: 16" W. Oak S 2-15 E 212 links and 14" W. Oak N 32-30 W 167 links.
- 1968 USFS technician L. Witthoeft found the GLO brass cap monument in place.
- 1980 USFS technician William Olson found the GLO brass cap monument in place in good condition. Three new bearing trees were marked and are shown on this certificate. Steel sign post were set 4.0' north and east of the corner. No evidence was found of the 1918 bearing trees.
- 1981 County Surveyor's Records in the Recorder's Office were checked and no resurvey information was found on this corner.
- 1982 Visited corner on Jan. 29 and found items as per 1980 USFS report. Snow depth prevented a detailed search for evidence of the 1918 bearing trees.
- 1982 On April 21, USFS technician C. Krause revisited the corner area and found the following evidence of the 1918 bearing trees: AT S 2 E 110.2' found large oak fallen over and at N 32 W 139.9' found large oak fallen over with old blaze scar.

I accepted the found monument as marking the same position as when set in 1918. The distances given in the 1918 notes to the bearing trees were found to have been reversed.