

CERTIFICATE OF LOCATION OF GOVERNMENT CORNER

SOUTHEAST Corner of Section 34, Township 145, Range 28, 5th P.M.

STATE OF MINNESOTA, County of CASS

At the corner location shown on the sketch:

- On 4/26/82 found a rotted wood post broken off with post point in
the ground and remains of the GLO bearing trees.
 left monument as found, lowered monument, removed monument (explain)
- On 5/7/82 placed a 2" x 60" galvanized iron pipe with marked brass cap.

SKETCH OF REFERENCE TIES

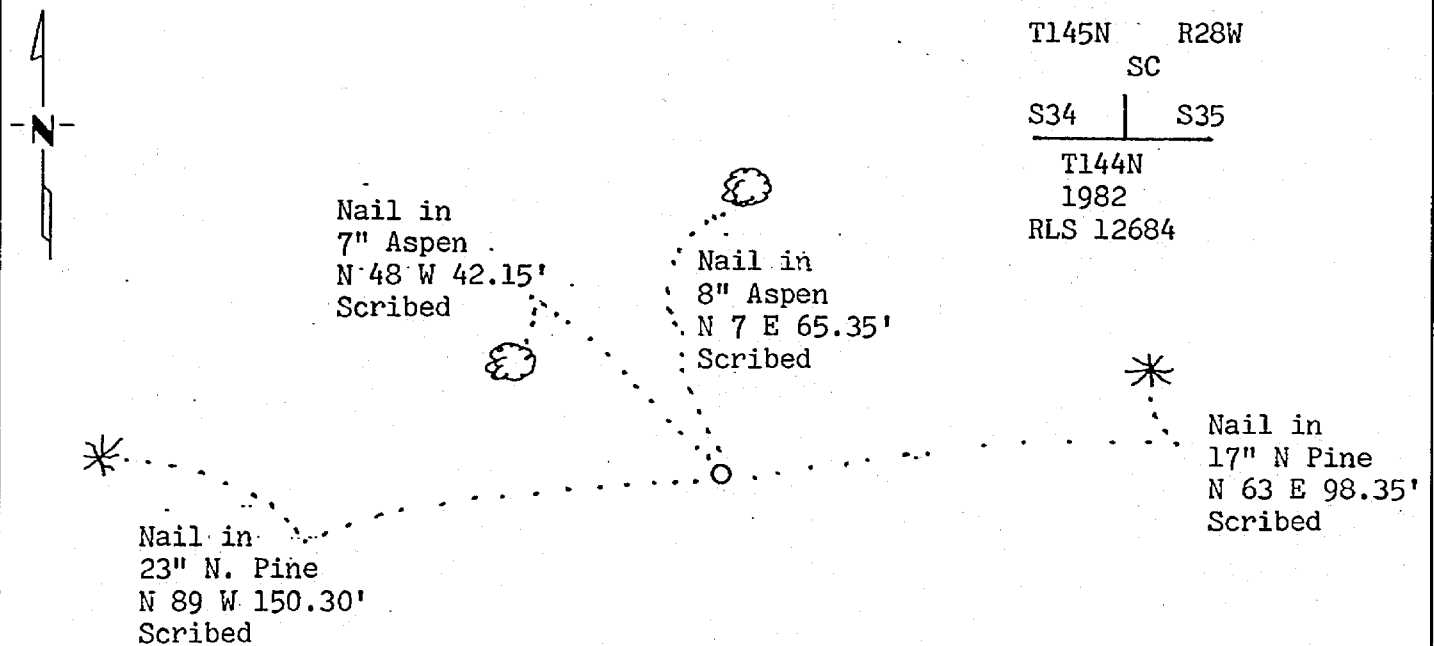

MONUMENT MARKED

T145N R28W
SC

S34 | S35

T144N
1982
RLS 12684

BEARINGS ARE APPROXIMATE

Statement of evidence relative to this corner location is on back of page.

I hereby certify that this document and the data contained herein was prepared by me or under my direct supervision.

Ray H. Steiner 5-14-82
SIGNATURE DATE

Registration No. 12684

- Land Surveyor, Professional Engineer
- County Surveyor, County Engineer

26390
OFFICE OF THE COUNTY RECORDER

County of Cass

I hereby certify that this document was filed in the Co. Recorders office at 9:10 A.M. on the 22 day of July A.D., 1982

County Recorder Beverly Anderson

By MS, Deputy

DOCUMENT NO. 26390

Statement of Evidence:

- 1871 U.S. General Land Office survey set wood post for this corner and marked the following bearing trees: 9" Ash N 22 E 28 links and 6" Ash N 59 W 15 links.
- 1907 County Surveyor's Record book B pages 323 to 327 show survey by John Curo. Curo states he found both Government bearing trees and set a new stake from them.
- 1982 Traversed to the area of this corner in March and at the approximate corner found a 2" Ash post painted blue with an old forestry location tag on a 14" Ash S 35 W 5.2'. We measured 5286.6' from this post to the SW corner of Sec. 34 which compared well with the 1907 Curo measurement of 5288.5'. I searched for this corner again in April after the snow was gone with USFS Surveyor K. Whitehorn, USFS technician C. Krause, and Cass County technician T. Freeman. Approximately 3 feet south of the Ash post we found a 1½" x 1½" x 24" badly rotted wood post. One side was flat with ax marks, but the rest of the post was too rotten for any other marks. This post fit well with the GLO bearings and distances to two badly rotted ash stumps. At the call distances we found the post point. I accepted this post point as the one set by Curo in 1907 and the two Ash stumps as the remains of the GLO bearing trees. At the location of the found post point set a 2" x 60" galvanized iron pipe with marked brass cap. Four new bearing trees were scribed and are shown on this certificate. Steel sign posts were set 5.0' north and 5.0' east of the corner.