

# CERTIFICATE OF LOCATION OF GOVERNMENT CORNER

NORTHEAST Corner of Section 28, Township 141, Range 31, 5th P.M.

STATE OF MINNESOTA, County of CASS

At the corner location shown on the sketch:

- On 3/21/80 found a 2 3/4" iron pipe with marked brass cap as per  
DATE  
certificate filed in 1959 by Harold Curo.
- left monument as found,  lowered monument,  removed monument (explain)
- On \_\_\_\_\_ placed a \_\_\_\_\_  
DATE

## SKETCH OF REFERENCE TIES

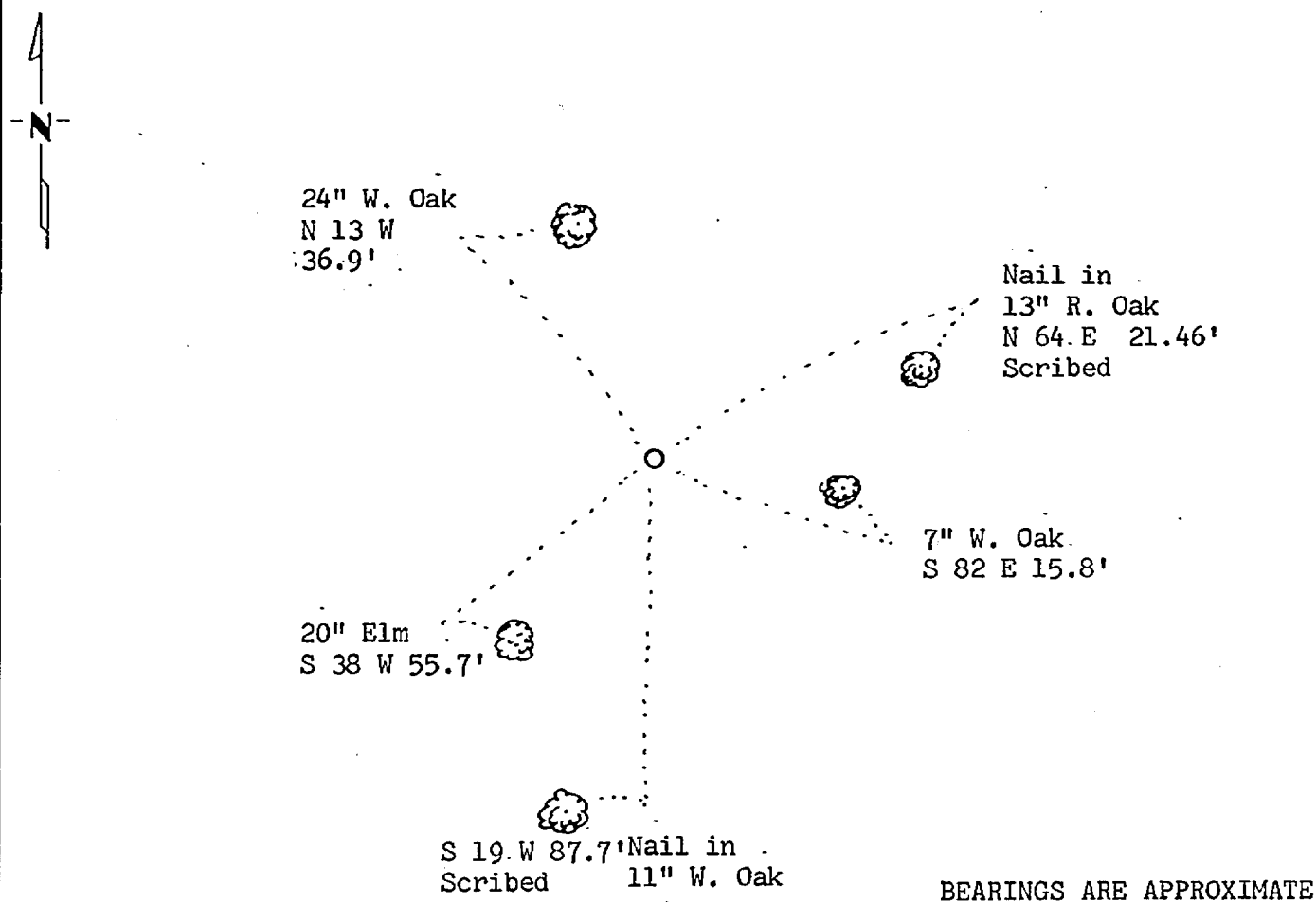

Statement of evidence relative to this corner location is on back of page.

261363

I hereby certify that this document and the data contained herein was prepared by me or under my direct supervision.

Ray H. Stevenson  
SIGNATURE

2-1-82  
DATE

Registration No. 12684

- Land Surveyor,  Professional Engineer  
 County Surveyor,  County Engineer

### OFFICE OF THE COUNTY RECORDER

County of Cass

I hereby certify that this document was filed in the Co. Recorders office at 10:00 A.M. on the 2 day of Feb. A.D., 1982

County Recorder Beneah Herdinger

By MS, Deputy

DOCUMENT NO. 261363

Statement of Evidence:

- 1873 U.S. General Land Office survey set wood post for this corner and marked the following bearing trees: 8" W. Pine S 39 W 25 links, 12" W. Pine N 53 W 35 links, 14" N. Pine N 34 E 11 links, and 20" W. Pine S 62 E 28 links.
- 1921 County Surveyor's Record Book C pages 447 and 467 show survey by E.B. Horst. Found a 4" x 4" x 48" wood stake that had been set for the corner in the fall of 1920 from three GLO bearing tree stumps and one snag.
- 1942 County Surveyor's Record Book D pages 316 and 317 show survey by John Curo. Following new ties listed: 8" W. Oak N 88-34 W 47.50', 16" W. Oak N 8-E 36.75', 7" Birch S 55-20 E 15.75', and 14" N. Pine S 46 W 46.95'. Type of monument is not stated.
- 1959 Corner certificate by Harold Curo, RLS #3417, shows 4" x 4" x 36" wood stake found at the corner. This was replaced with a 2 3/4" x 60" capped iron pipe filled with concrete with a 3" marked brass cap. Three new bearing trees were marked: 7" W. Oak S 82-32 E 15.80', 20 R. Oak N 13-32 W 36.90', and 14" Elm S 38-16 W 55.70'. Certificate was filed 3/22/60.
- 1961 Plat of survey made by U.S. Forest Service and filed as Document No. 169486 and recorded in Book 48 of Misc. Plats. Survey made by Peter J. Meyer, RLS #3628. Corner monument and bearing trees set and marked by Harold Curo in 1959 are shown on plat.
- 1980 USFS technician Jim Schoonover found monument and bearing trees in good condition. Two new bearing trees were marked and are shown on this certificate. A steel sign post was set 4.2' south of the corner.
- 1982 On Jan. 11, I visited the corner and found the monument as set in 1959 in good condition. Evidence of the original GLO pine stumps were found to the NW and NE. A pine stump and 12" Birch were found that agreed with the 1942 ties. All three of the 1959 tie trees were found. The two newly scribed tie trees were found as per the 1980 USFS report. Accepted the monument as marking the perpetuated position of the original corner.