

CERTIFICATE OF LOCATION OF GOVERNMENT CORNER

NORTH QUARTER Corner of Section 17, Township 141, Range 29, 5th P.M.

STATE OF MINNESOTA, County of CASS

At the corner location shown on the sketch:

On 7/2/80 found a GLO brass cap monument as set in 1918.
DATE

left monument as found, lowered monument, removed monument (explain)

On _____ placed a _____
DATE

SKETCH OF REFERENCE TIES

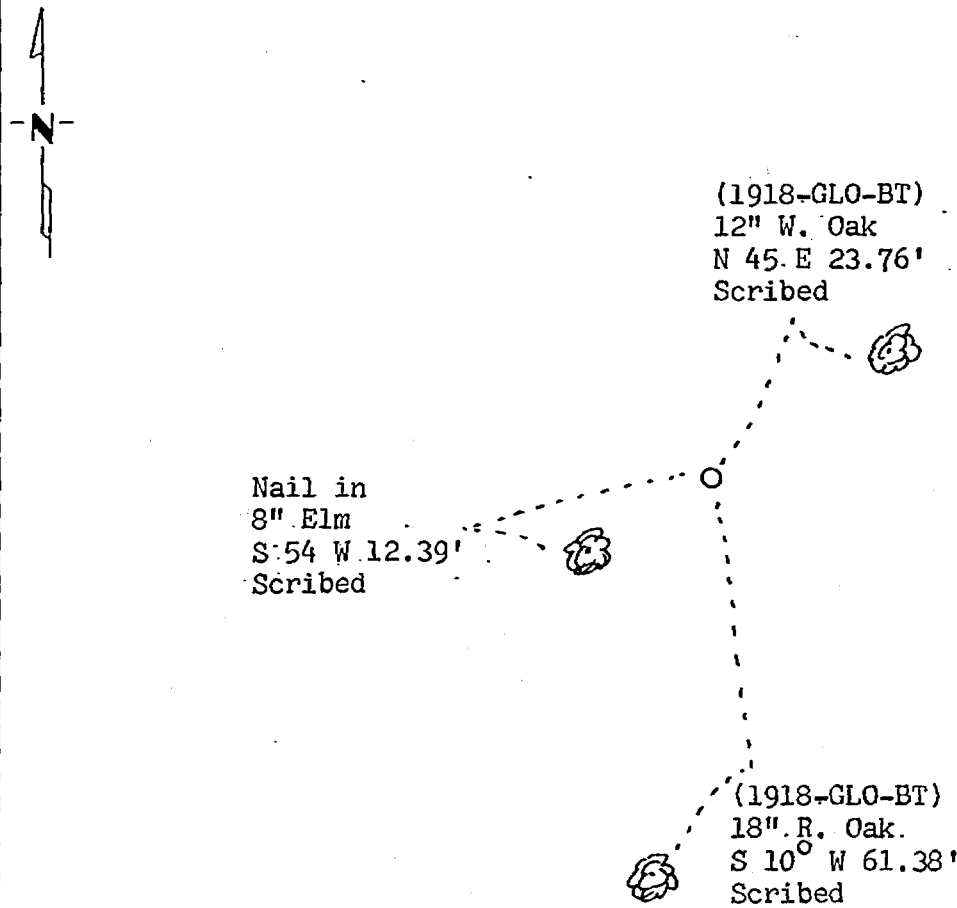

BEARINGS ARE APPROXIMATE

Statement of evidence relative to this corner location is on back of page.

260986

I hereby certify that this document and the data contained herein was prepared by me or under my direct supervision.

Mary A. Stevenson 12-15-81
SIGNATURE DATE

Registration No. 12684

Land Surveyor, Professional Engineer

County Surveyor, County Engineer

OFFICE OF THE COUNTY RECORDER

County of Cass

I hereby certify that this document was filed in the Co. Recorders office at 9:20 A.M. on the 31 day of Dec. A.D., 1981

County Recorder Beverly Hendrichs

By MS, Deputy

DOCUMENT NO. 260986

Statement of Evidence:

- 1873 U.S. General Land Office survey set wood post for this corner and marked the following bearing trees: 5" Birch N 72 E 17 links and 3" Poplar S 31 E 14 links.
- 1918 U.S. General Land Office dependent resurvey found the corner marked by a decayed wooden stake, marks obliterated. An iron pipe with a marked brass cap was set to mark the corner. The following bearing trees were marked: 8" W. Oak N 44-30 E 36 links and 10" R. Oak S 10-15 W 93 links. No trace of the original bearing trees was found.
- 1980 USFS technician Gary Brama found the GLO brass cap monument in place up 8". Both bearing trees were found standing and rescribed "BT". Also, one new bearing tree was marked and is shown on this certificate. Steel sign post were set north and east of the corner.
- 1981 On Dec. 8, I visited corner area and found items as per 1980 USFS report. Healed over scars were evident on the GLO bearing trees:
- 1981 County Surveyor's Records in the Recorder's Office were checked and no resurvey information was found on this corner.

