

CERTIFICATE OF LOCATION OF GOVERNMENT CORNER

North Quarter Corner of Section 35, Township 142, Range 27, 5th P.M.

STATE OF MINNESOTA, County of Cass

At the corner location shown on the sketch:

- On 1/5/81 found a 1 1/2" x 40" iron pipe
DATE
- left monument as found, lowered monument, removed monument (explain)
- On 10/16/81 placed a 2" x 60" iron pipe with marked 3" brass cap in
DATE
place of the found pipe.

... SKETCH OF REFERENCE TIES.

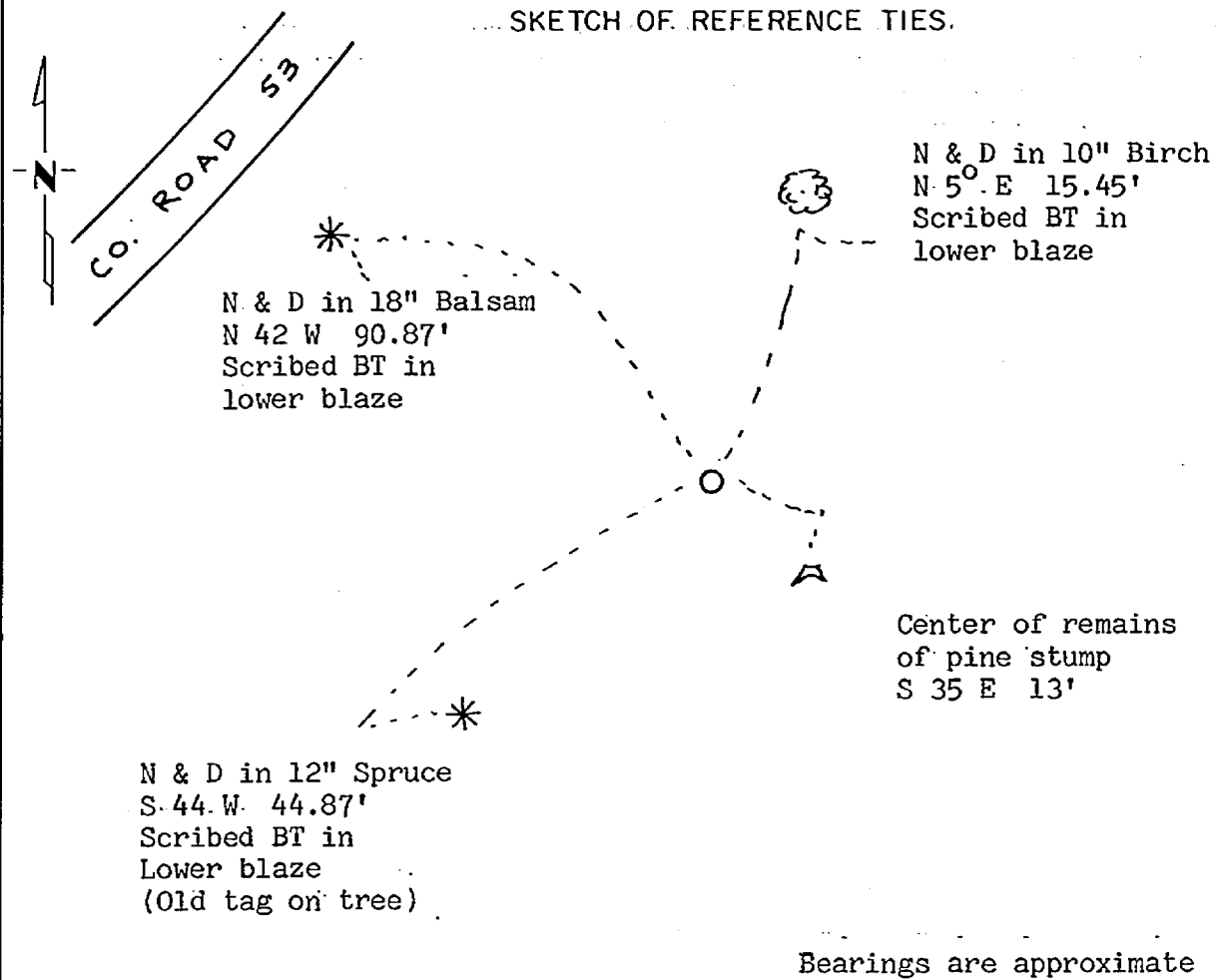

Statement of evidence relative to this corner location is on back of page. 260592

I hereby certify that this document and the data contained herein was prepared by me or under my direct supervision.

Mary H. Stevenson 12-2-81
SIGNATURE DATE

Registration No. 12684
 Land Surveyor, Professional Engineer
 County Surveyor, County Engineer

OFFICE OF THE COUNTY RECORDER
 County of Cass

I hereby certify that this document was filed in the Co. Recorders office at 10:40 A.M. on the 3 day of Dec. A.D., 19 81

County Recorder Bentley Hardwick
 By MS, Deputy

DOCUMENT NO. 260592

Statement of Evidence:

- 1873 U.S. General Land Office survey marked a 4" Spruce tree for this corner with two bearing trees marked: 5" Norway S 45 E 3 links and 6" Poplar N 40° E 4 links.
- 1922 County Surveyor's Record Book D pages 108-109 show survey by E.B. Horst. The survey shows that a 16" Norway Pine was found with "BT" reasonably plain on the SW side. Horst notes that "it is evident that an error was undoubtedly made in recording the direction." He shows post set with this stump N 45° E 2 feet. Another tie is given to a 7" N. Pine stump S 70° E 12 feet.
- 1935 U.S. Forest Service Office in Cass Lake was contacted for information. A corner card dated 3/6/35 under the CCC program shows a marked cedar post found at this corner at the approximate intersection of tangents of road north and west. A metal location poster was put on a 12" Norway Pine approximately 3 chains west of the corner.
- 1981 I found a 1½" x 40" iron pipe at the approximate corner. A rotten wooden post with a yellow forest tag was found on the west side of the pipe. The Norway Pine with tag as noted in 1935 was found 192' westerly of the pipe. The pipe was found on the easterly side of a 6' deep hole that appears to be an old gravel pit. No evidence of the GLO bearing trees was found. A pine stump was found approximately S 35° E 13 feet from the pipe. This could be the one called for by Horst to the SE, but no marks were found. It appears that sometime after 1922 the area was excavated for gravel. Evidently someone must have reset the corner after the excavation. I accepted the pipe as being the best evidence marking the perpetuated position of the corner. I removed the pipe and replaced it with a 2" x 60" iron pipe with 3" marked brass cap furnished by the U.S. Forest Service.