

# CERTIFICATE OF LOCATION OF GOVERNMENT CORNER

South Quarter \_\_\_\_\_ Corner of Section 10, Township 139, Range 29, 5th P.M.

STATE OF MINNESOTA, County of Cass

At the corner location shown on the sketch:

- On 7-9-75 found a Railroad spike set by John W. Curo from  
DATE  
original B.T. stump.  
 left monument as found,  lowered monument,  removed monument (explain)
- On 11-4-75 placed a Cast Iron Monument 4" Dia. Top X 20" long.  
DATE  
Flush with C.S.A.H. #84.

### SKETCH OF REFERENCE TIES

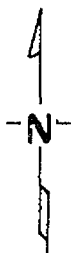

Set corner in place of railroad spike set by John W. Curo, a Registered Land Surveyor, in the State of Minnesota.  
 New ties have 2 blazes. Distance shown is horizontal measurement from brass B.T. tag on lower blaze.  
 Corner is 8' north of center of C.S.A.H. #84.

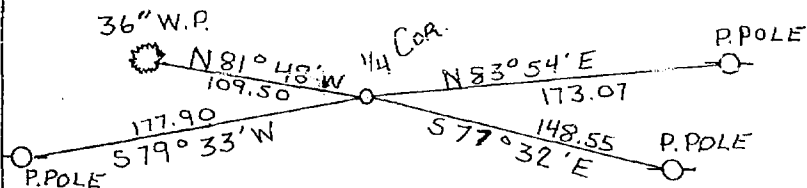

Not to scale

~~Statement of evidence relative to this corner location is on back of page.~~

I hereby certify that this document and the data contained herein was prepared by me or under my direct supervision.

Walter E. Curo 12-18-75  
SIGNATURE DATE

Registration No. 11395

- Land Surveyor,  Professional Engineer
- County Surveyor,  County Engineer

OFFICE OF THE REGISTER OF DEEDS  
 County of CASS

I hereby certify that this document was filed in the Reg. of Deeds office at 9 A .M. on the 5 day of January A.D., 19 76

Register of Deeds Beverly Hendricks  
 By NB Deputy

DOCUMENT NO. 223 877