

32

Traverse Lines  
Co. Ditch.  
#10.

TRANSIT BOOK.

No. 406

C. J. White.  
Field Engr.

Jan.-Feb. 1917.

32

TRAVERSE LINES  
Co. Ditch #10  
C. J. White - ENG'R.  
Geo. Snell - Rodman.

INDEX.

	Page.
Traverse No 1.	1-3.
" No 2.	4-11.

Traverse N<sup>o</sup> 1.

station.	Length.	Bearing.
	Continued on Next	
15-	910 Correct 909.6 vert. angle = 1° 35'	71° 15' E.
14-	366	S 66° E. v
13-	161	S 55° E v
12-	217	S 63° 30' E v
11-	530	S 59° 30' E v
10-	213	S 55° 45' E v
9-	329	S 60° E. -
8-	193	S 66° 45' E v
7-	384	N 79° 15' E. v
6-	284	S 87° E v
5-	117	S 47° 30' E v
4-	214	S 23° 30' E v
3-	162	S 80° 30' E v
2-	204	N 69° 30' E v
1-	188	S 23° E v
00 -	98	S 19° W. -

C.W.  
Geo.  
Spell.  
11/31/17

Note: sketch on this side (1)  
is one sta. too far ahead.  
sta. marked according to sketch.

Page.

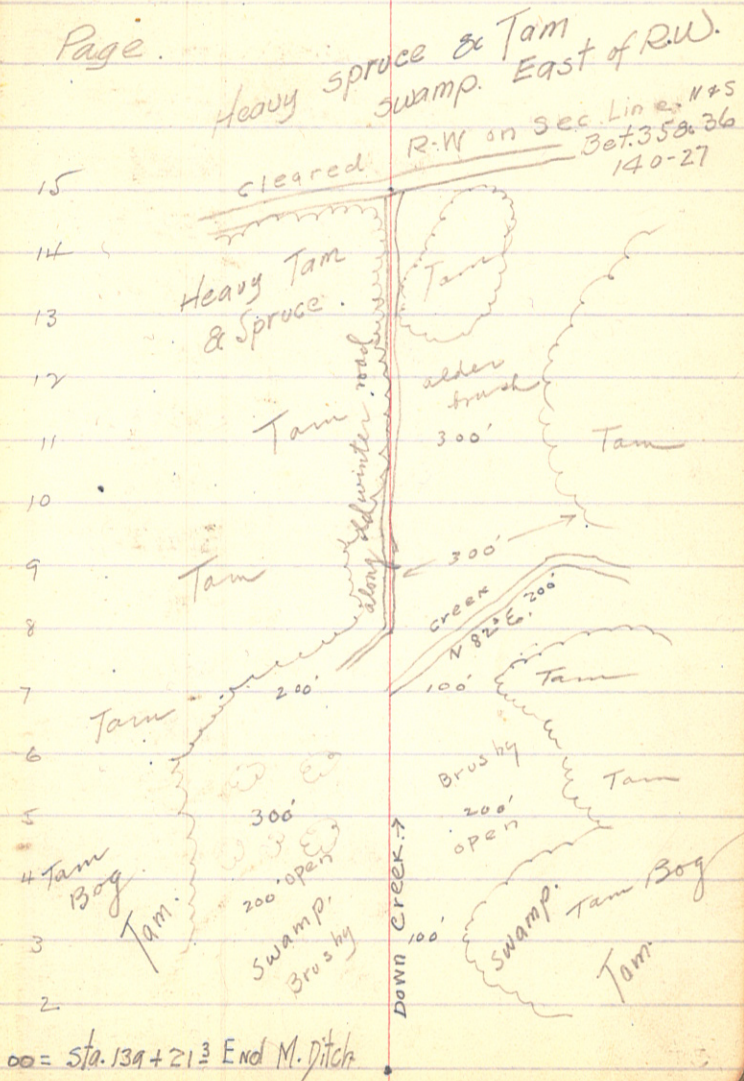

Jan. 31-1917. (2)  
 C.J.W. - G. Snell.  
 Very windy & cold.

21	190	N42°15'W ✓
20	355	N52°45'W ✓
19	300	N62°30'W ✓
18	330	N67°W ✓
17	655	N71°30'W ✓
16	880	N1°E ✓
15		N1°E ✓

15+450 recording  
 str. ...

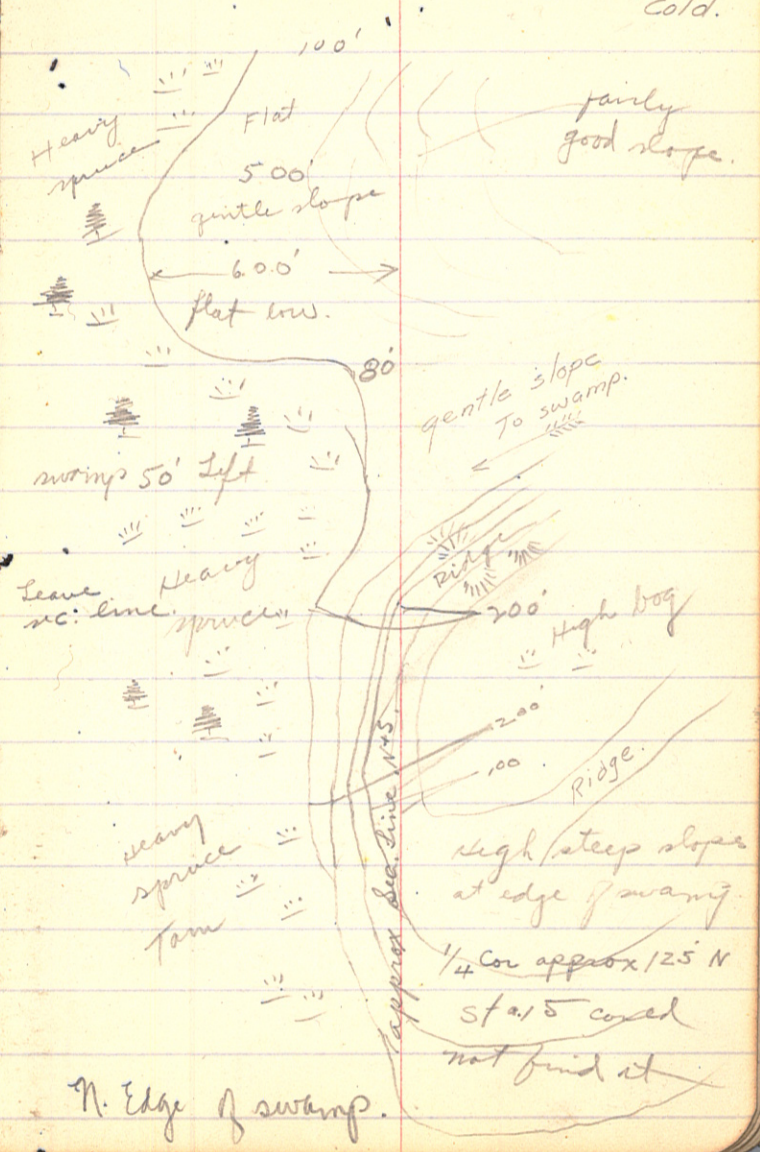

N. Edge of swamp.

Jan. 31-1917.

C.J.W. G. Snell. (3)

30		
35	455	N42°15'W ✓
34	500	N15°30'W ✓
33	305	N17°15'W ✓
32	450	N26°45'W ✓
31	287	N12°W ✓
30	348	
29	420	S89°30'E ✓
28	265	S88°15'E ✓
27	38'	S0°10'W ✓
26	38'	<del>N</del> 10°10'E ✓
25	167	N88°15'W ✓
24	168	N89°15'W ✓
23	170	N89°15'W ✓
22	335	N69°W ✓

END TRAVERSE N° 1. = Δ Sta. 101+12 M.D.

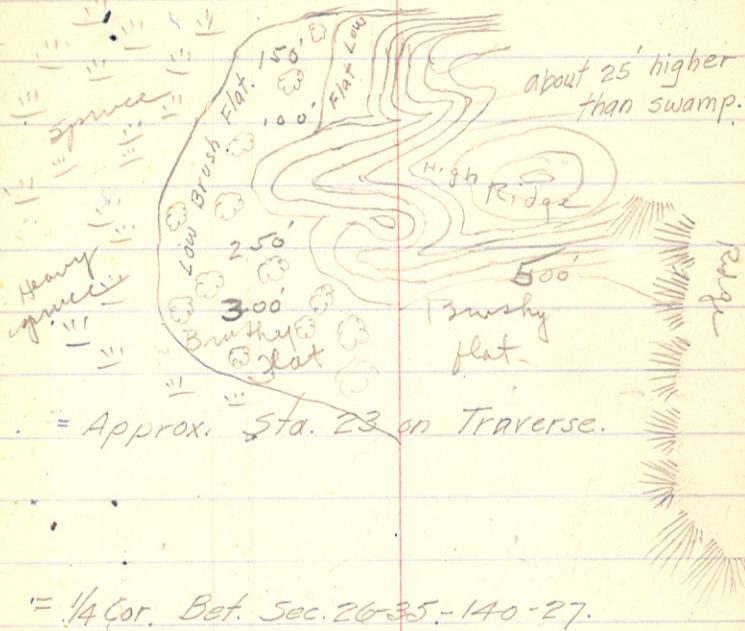

= 1/4 Cor. Bet. Sec. 26-35-140-27.

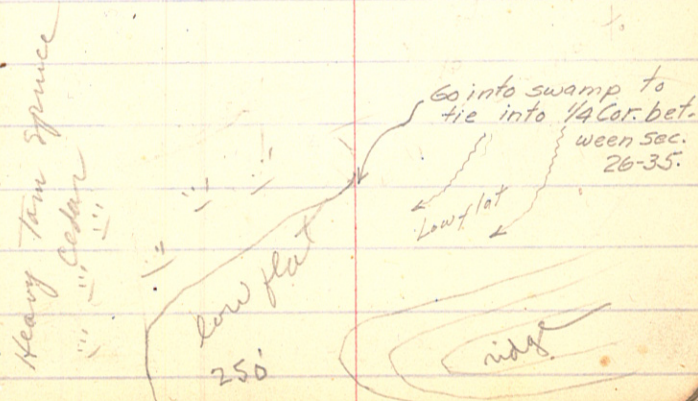

Heavy Tom Spruce  
Cedar

TRAVERSE No 2.

5	59°45'W.	345 ✓
4.	57°30'W	775 ✓
3	71°37'30"W.	560 ✓
2.	73°45'W.	325 ✓
1	78°45'W.	487 ✓
00	58°W.	285 ✓

Very Cold.  
22° below. windy.

Feb. 1. A  
C.J.W. G. Snell.

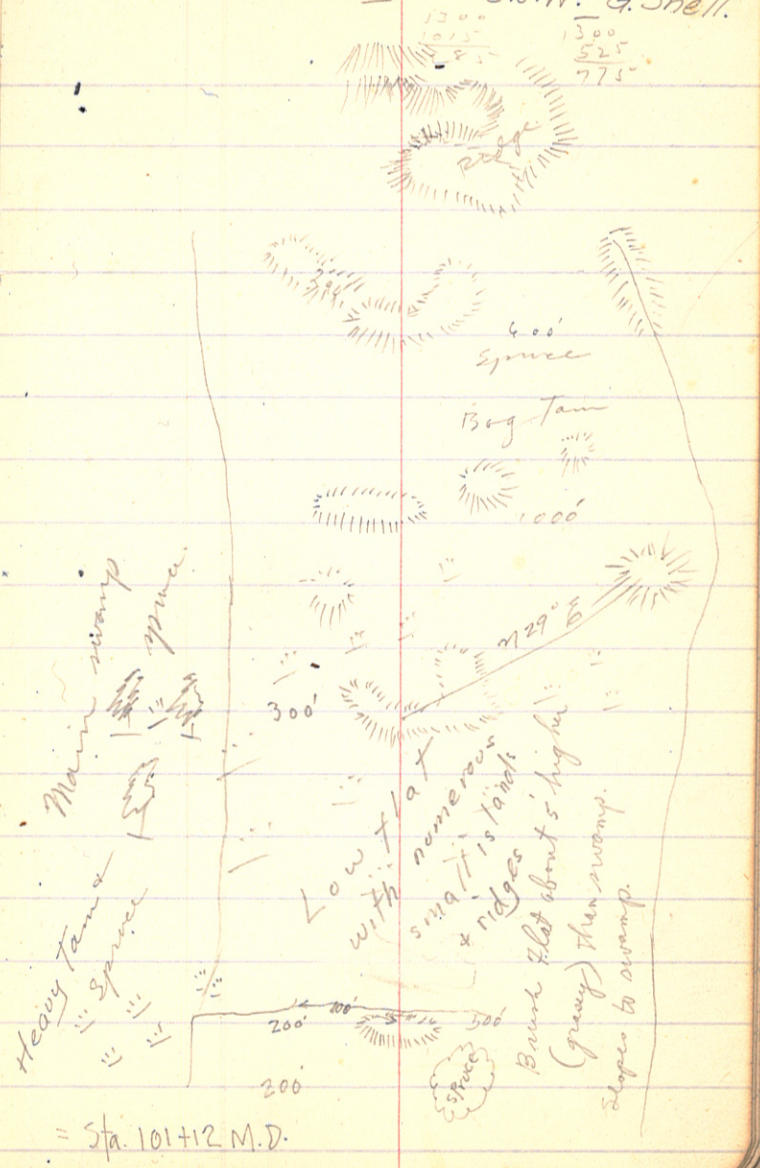

Main Swamp.  
Heavy spruce

Feb 1. 5



260  
732° E

main swamp  
150' L. of t.

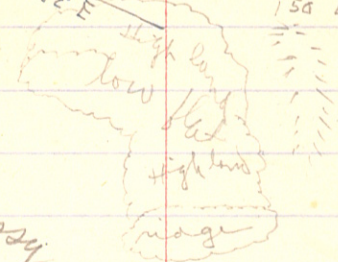

Grassy low land

13 54°15' W 830 ✓

12 538°15' E 450 ✓

11 541°30' E 317 ✓

10 517°30' W 382 ✓

9 534°15' E 210 ✓

8 554°45' E 350 ✓

7 754°45' W 350 ✓

6 734°15' W 210 ✓

= Vert Δ = 7° 30'

= W 1/4 Cor. 26

vertical 7° 30'



steep slope  
130' high



Feb. 1. 6.

15

S 30° E.

872 ✓

14

S 48° W.

750 ✓

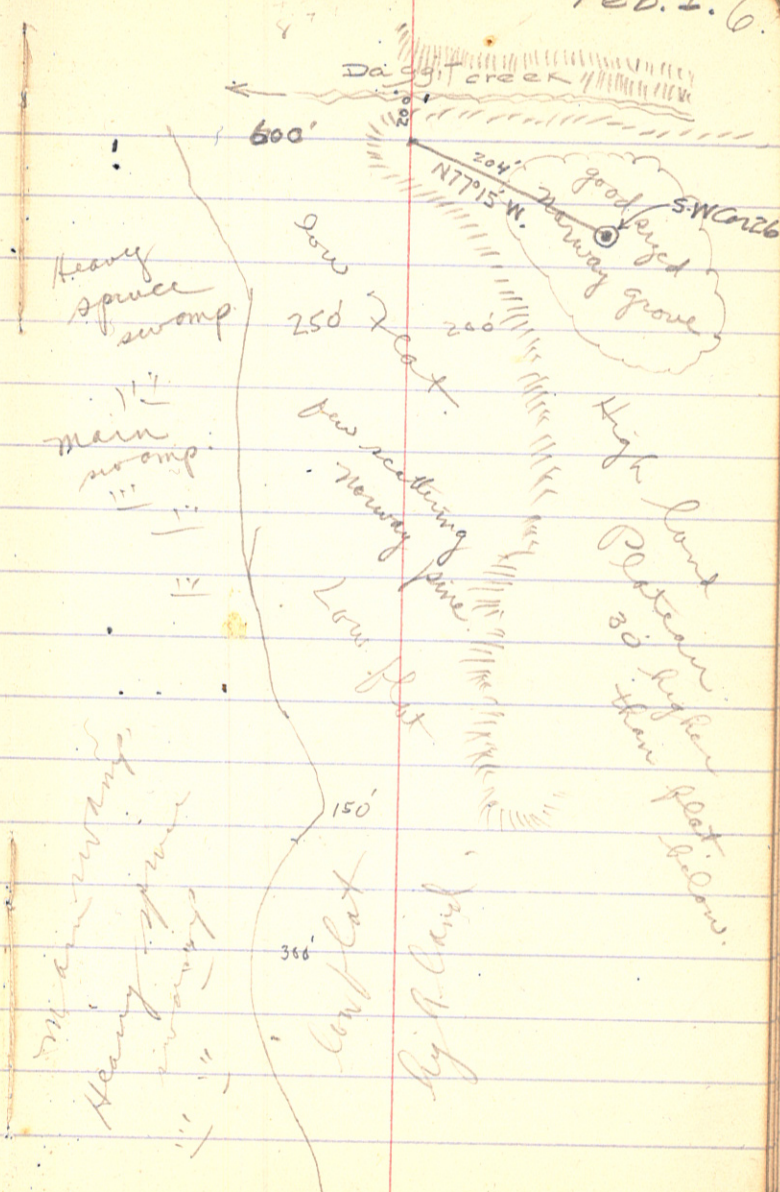

Heavy spruce swamp

main swamp

main swamp  
Heavy spruce swamp

low flat  
by railroad

High land plateau  
30' higher than flat below

Low scattering Norway pine

250' Flat

150'

366'

600'

N 77° 15' W.

204'

S.W. Cr. 26

Daggit Creek

Feb. 1 7.

20 57°15' E 730' ✓

19 512° E. 600 ✓

18 53°15' E. 500 ✓

17 58°30' E. 380' ✓

16 514° W. 570' ✓

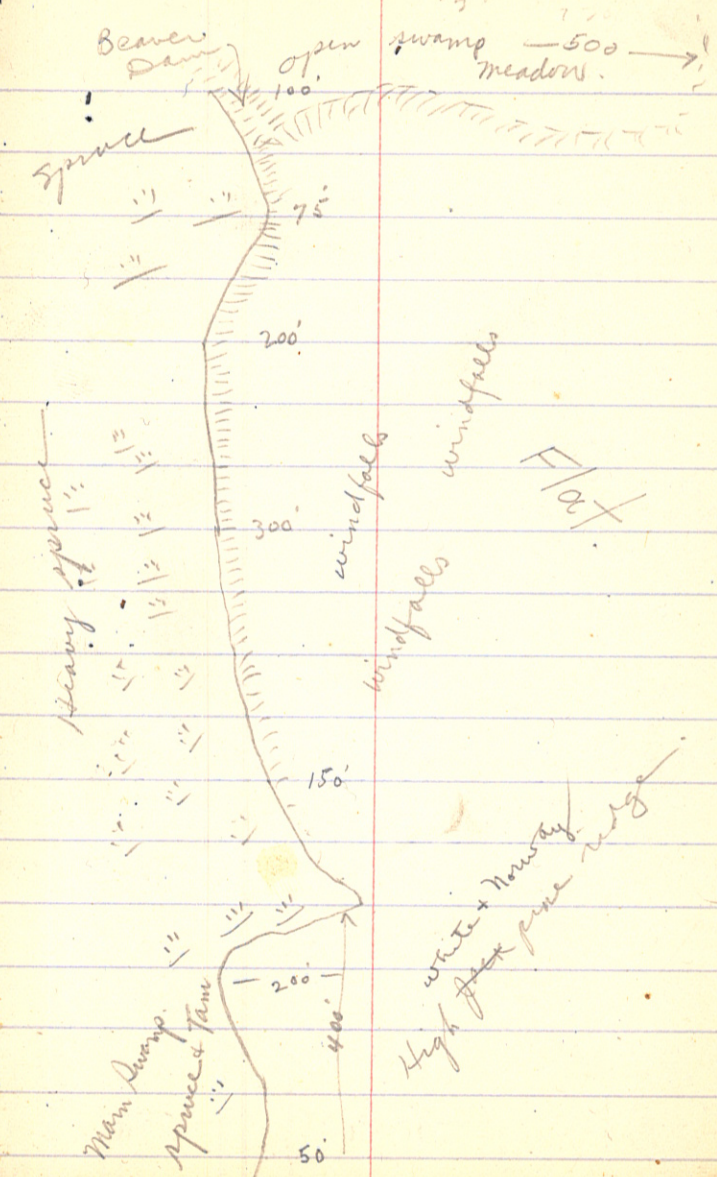

Feb. 1.

8.

Quit for day 4:15 P.M.

4 Miles from home. Terrible cold  
account of wind.

24

23

S 85° 30' E

810 ✓

22

S 52° E

370 ✓

21

S 65° 30' E

590 ✓

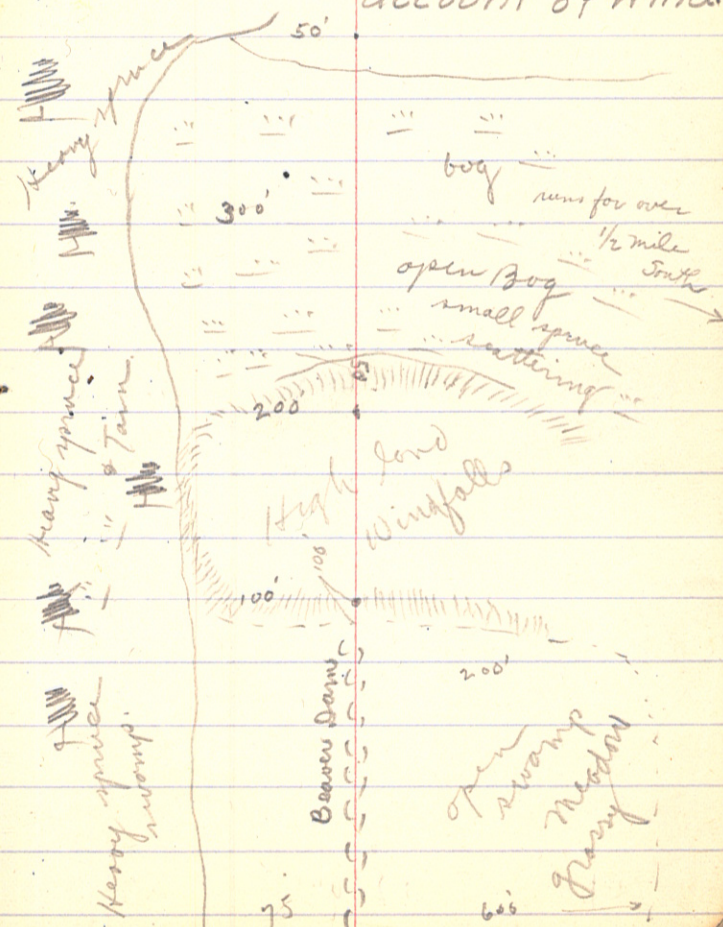

Feb. 3.  
CJW-g.s. 9.

29. N 37° 30' E 87'

28 S 37° 30' W. 87'

27 S 6° 15' W. 450' ✓

26 S 85° 45' E. 252' ✓

25 S 13° 15' E. 380' ✓

24 S 25° W. 312' ✓

= 1/4 Sec. 35.

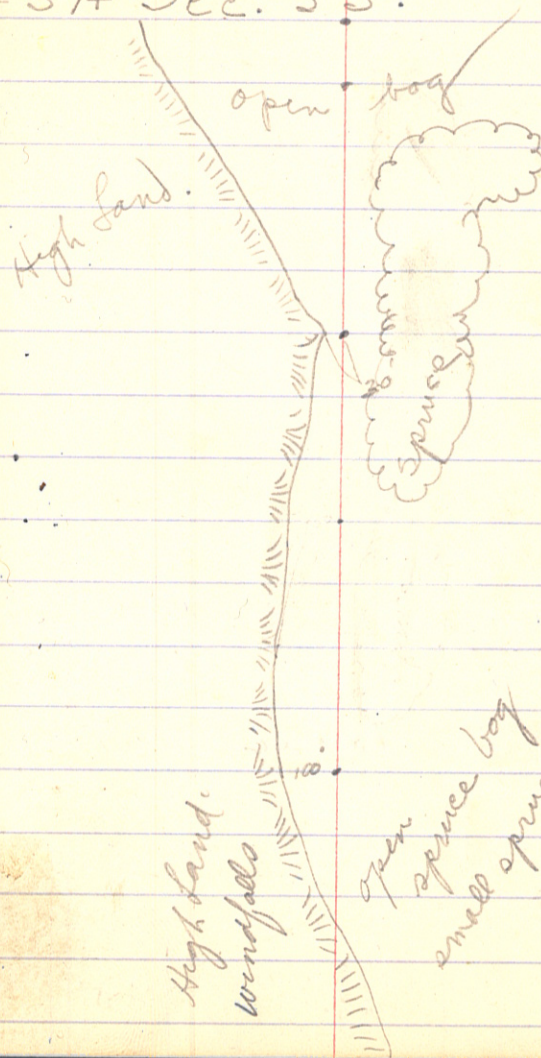

Feb. 3. 10.

Continued on Page 11.

34 = Traverse Sta. 24.

33 N 25° E. 312'

32 N 13° 15' W 380'

31 N 85° 45' W 252'

30 N 6° 15' 450'

Starting on sta. 24 again		
43		
42	n18°E	51 ✓
41	n7°45'W.	86 ✓
40	n12°30'E.	206 ✓
39	n17°45'E.	267 ✓
38	n29°30'W.	145 ✓
37	n26°15'W.	139 ✓
36	n7°15'E	106 ✓
35	n45°W.S.	120 ✓
34	n21°45'E	73 ✓
33	n20°15'W.	156 ✓
32	n63°15'W.	27.5 ✓
31	n36°W.	225 ✓
30	n33°15'W.	225 ✓
29	n22°E.	252 ✓
28	n28°30'E	285 ✓
27	n2°E.	206 ✓
26	n4°16'E.	225 ✓
25	n.	197 ✓
24	S31°E.	200 ✓

to tie into Ditch Outlet. 11.  
Feb. 3.

→ = Main Ditch Outlet in Creek. Sta.  
139+213. End. of Traverse #2.

Heavy Growth of Timber.  
Wind falls.

Wind falls.

Wind falls

Main Swamp.

Heavy spruce, Tamarac,  
Pine & Cedar.

Near old snag Approx. on N&S. 1/4 Line.

Start on Sta. 24. again.

Tie Line To

Sec. Cor.  $\frac{1300}{863}$   
437

1300  
400  
400  
1300  
616  
690

12.

00

n<sup>o</sup>45' E. 437'

= Sec. Cor. S.E. cor. S 26

1

n<sup>o</sup>45' W. 820'

2

n<sup>o</sup>4°30' W. 690'

3

= Sta. 68 on M. Ditch Line.

3  
2  
2  
2  
2  
2  
2  
2