

CO. DITCH No 2

CASS CO., MINN.

MINING
TRANSIT BOOK

363

1A

33

COUNTY DITCH, No 2

CASS COUNTY, MINNESOTA.

A. W. Moulster, Drainage Engr.

John W. Curo, Co. Surv.

F. N. Molyneux, Engr. in charge of field work.

Book 2

TWP. 133 & 134, R_G 32 WEST.

2
INDEX.

Time Sheet

Pg. 4 & 5

Lateral N ^o 1		8 ^{to} 19
Metes & Bounds, Marsh in Sec. 2		
North end LATERAL N ^o 1		20 ^{to} 27
Metes & Bounds N ^o 4		28 ^{to} 43
" " " ISLAND, SEC. 2,		44 ^{to} 47
" " " N ^o 5		48 ^{to} 68 & 76 ^{to} 107
Lateral N ^o 2		70 ^{to} 73
Metes & Bounds N ^o 6		108 ^{to} 113
" " Little Island		114 ^{to} 117
" " Big "		118 ^{to} 127

TIME SHEET - CONT. FROM BOOK 1

F.N. MOLYNEUX
 W. H. LEWIS
 FRANK PETROSKE
 JACK PETROSKE
 ARTHUR FARBER
 GEORGE H. LEWIS
 NICK PETROSKE
 GEO. E. COONS

F.N. MOLYNEUX
 G.E. COONS
 C.D. CONZETT

TEAM
 ALBERT S. LEWIS

BOARD ACCOUNT WITH GEORGE H. LEWIS

F.N. MOLYNEUX
 GEO. E. COONS
 C.D. CONZETT

JULY, 1915

Fwd. From Book 1	23	24	25	26	27	28	29	30	31	1	2	3	4	5	TOTAL Days	AMT.
	F	S	S	M	T	W	T	F	S	S	M	T	W	T		
15	1	1	1	1	1	1	1	1	1	0	1	1	1	1	15	3.25
1 1/2	0														18	7.50
11	1	1	0	1	0	1	1	1	1						17	4.50
10	1	1	0	1	0	1	1	1	1						14	3.50
10	1	1	0												12	3.00
															5	1.25

AUGUST

~~F S S M T W T F S~~ August Cont

5	6	7	8	9	10	11	12	13	14	15	16	17	18	19	20	21	22	23	24	25	26	27	28	29	30	31	TOTAL	AMT.		
F	S	S	M	T	W	T	F	S	S	M	T	W	T	F	S	S	M	T	W	T	F	S	S	M	T	W	T			
1	1	1	1	1	1	1	1	1	1	1	0	1	1	1	1	1	1	1	1	1	1	1	1	1	1	1	1	45	5.00	225.00
0	1	1	0	1	1	1	1	1	1	1	0	1	1	1	1	1	1	1	1	1	1	1	1	1	1	1	1	26	5.00	130.00
0	1	1	1	1	1	1	1	1	1	1	1	1	1	1	1	1	1	1	1	1	1	1	1	1	1	1	1	Total 4 Da	25.00	

16 Traps 18 Da. 1

JULY 100 per Trip

1800

August 1915

1	2	3	4	5	6	7	8	9
B	D	B	D	B	D	B	D	B
S	L	S	L	S	L	S	L	S
14 1/2								

Rained at night

Farming till 8:00 this morning

Time day

Fine day

Fine day

Fine day

5.18

37.74 Da @ 1.00 = 37.74

8

LATERAL N^o 1

F.N. Polynieux, transit

Arthur Farber, flag

10

Frank Petroske, head-chain

Jack " rear "

9

George H. Lewis, axe.

Albert S. Lerris, & team hauling crew

8

to & from work.

7

COMMENCED July 23, 1916, Fair morning.

QUIT FOR DAY

6 +19.7 Δ

N. 68° 55' E On beaver dam

5

4

3

2

1

0+00 Δ

N. 69° 10' E = 320+57.7 of
Main Ditch.

COMMENCED 4 P.M. JULY 22, 1915

Co. DITCH N^o 2

CASS Co., MINN.

9

LATERAL MARSH

12" WATER.

Popel Island

Water

Big Marsh

Water

N. 15' E. of Sec Line

Big Marsh.

Main Ditch

Water

F.N. Polynieux

180	
109	33'
70	27

10

LATERAL No 1

28

27

26

25

24

+79.4 Δ 1120.9 5° 55' R. N. 13° 20' E. On big beaver dam

23

22

21

20

19

18

+65.7 Δ

N. 7° 05' E

17

16

15

14

13

12

+58.5 Δ 1158.5' 61° 46' L N. 7° 10' E

11

Co. DITCH No 2

CASS Co. MINN. 11

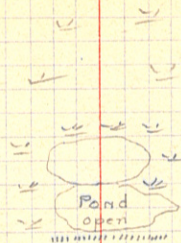

Narrow

Here

OPEN MARSH

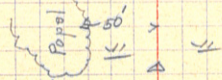

J. M. Polymant

59+39.5 ⊙

¼ Sec. Cor

57+19.6 Δ 1240.6 78° 38' L N. 1° 20' E

50

76+79.0 Δ 1145.4 46° 12' R N. 50° 0' E

45

36 +33.6 Δ 1154.2 9° 37' L N. 3° 30' E

35

34

33

32

31

30

29

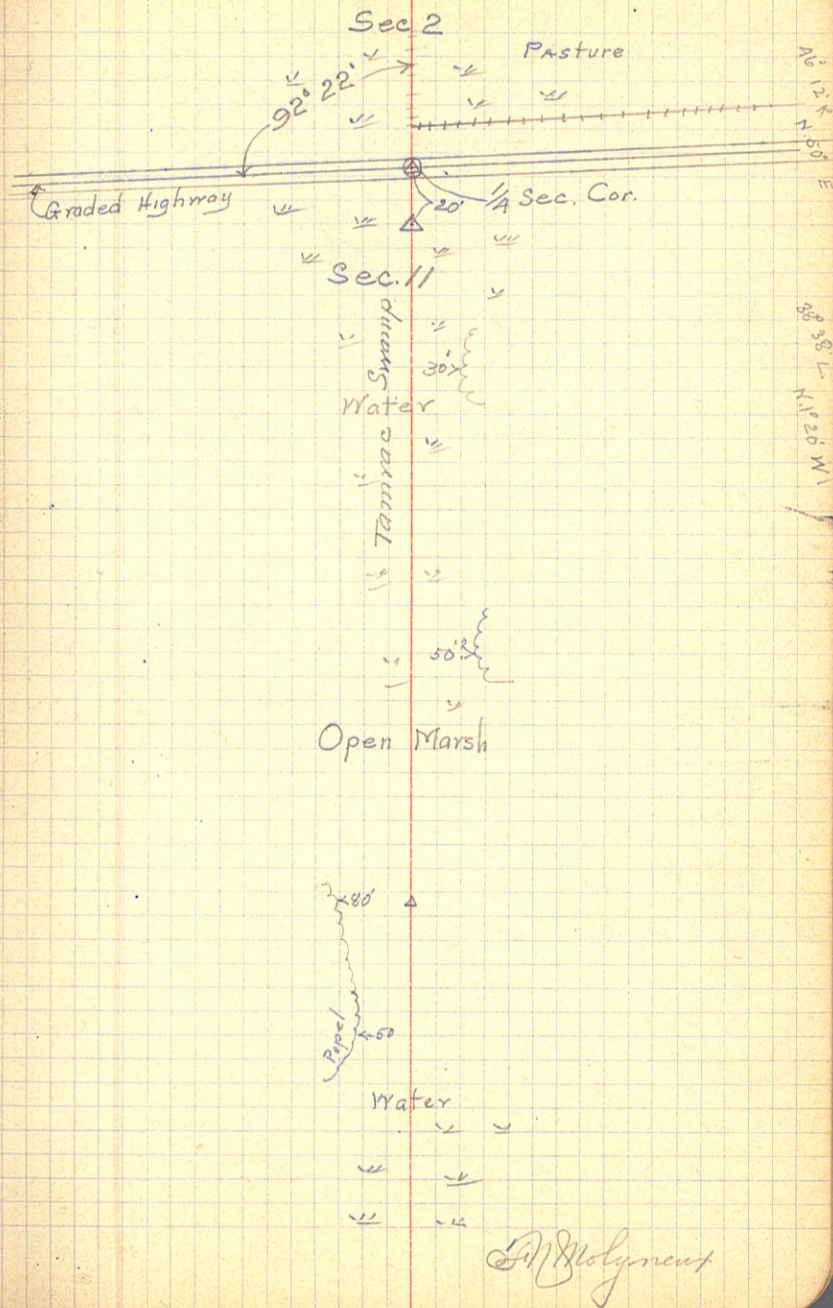

81 +30 ✓

+79.6 Δ 1179.6 19°25' L. N. 71° 55' E

88

79

78

77

76

75+01.5

14+13.4 of M+B. #3

74+31. Δ

S. 88° 50' E.

69 Δ 980.4 90° R. S. 88° 50' E.

66+76

fence corner

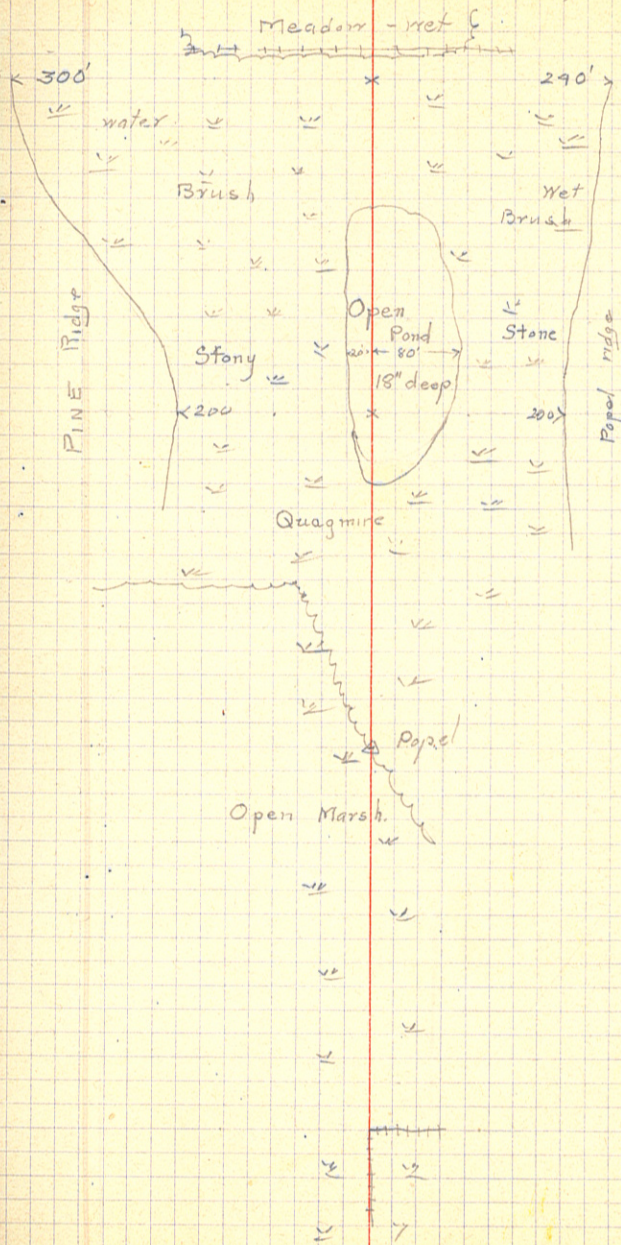

M. J. Molyneux

24

13

+92.5 Δ 478' 39° 36' L N. 63° 00' W

92

+40

Leave pond

71

+85

Enter lake

90

89

88

+14.5 Δ 734.9 95° 08' L N. 23° 20' W

87

86

85

84

83

82

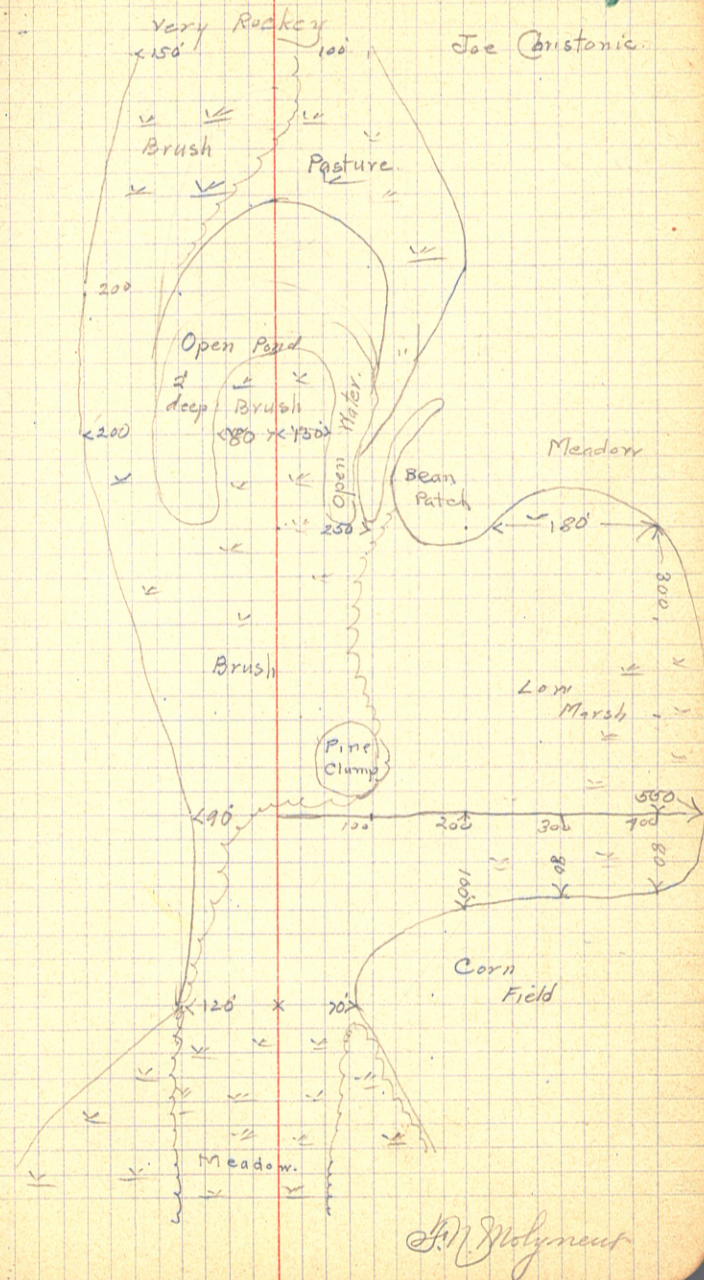

112 \checkmark End 944.4'

in marsh.

+30. Enter marsh
 +18.5 Δ
 9106
 +88.0

On beaver dam, S. end of marsh

E+W 2 wire fence
 Supposed to be the line

9105

9104

9103

+55.6 Δ 678' 9° 28' R. N. 25° 20' W. On beaver dam.

8102

8101

8100

899

898

897

896

+77.6 Δ 285.1 28° 02' R. N. 35° W

95

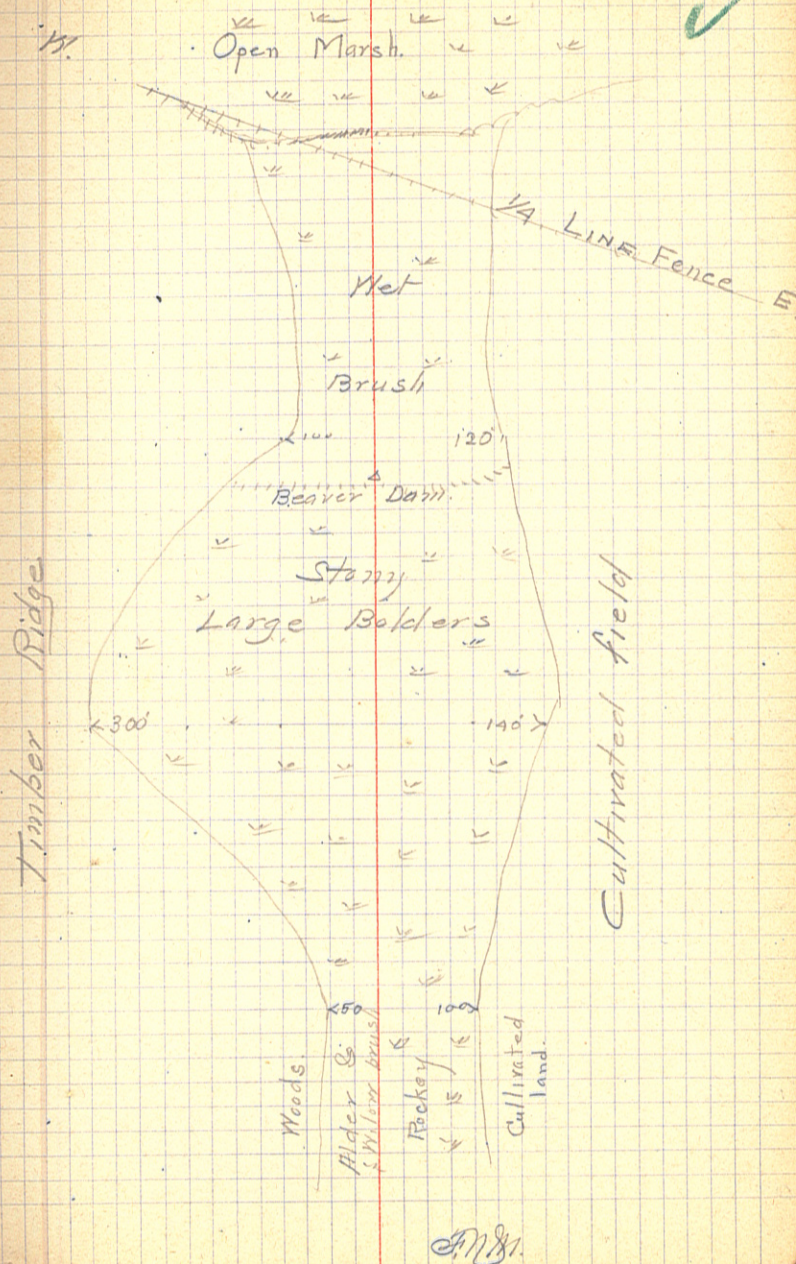

✓ Around marsh in Sec. 2, at north end of LATERAL No 1

SAME CREW. FINE DAY.

10

9

8

7

6

5

4

3

2

1

0+00 =

N. 31° 30' W = 306 + 18.5 of Lateral No 1

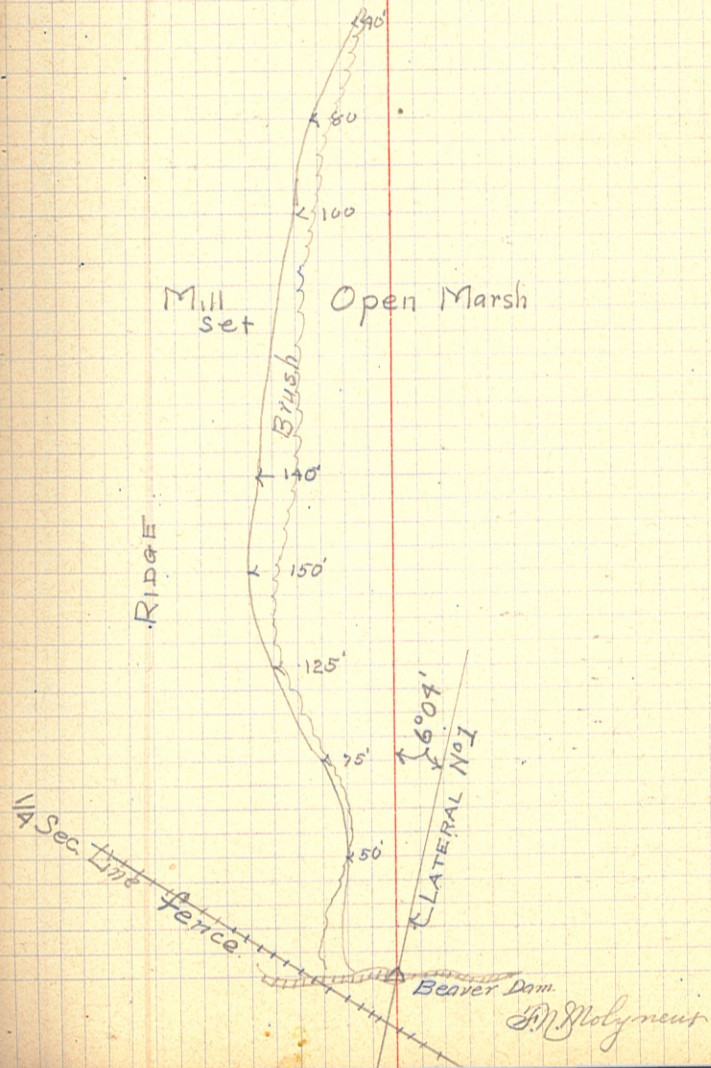

22

Metes & Bounds.

Around Marsh in Sec. 2 at north end of LATERAL No 1
Same Crew, Fine morning - Cold.

+66.9 Δ 949.9 75° 05' R. S. 69° 05' E

22

21

20

19

18

17

16

15

14

+170 Δ 1317 97° 35' R. N. 66° E FINE DAY

13

12

11

Com. July 24, 1915
Quit July 23, 1915

Co. DITCH No 2

CASS Co., MINN. 23

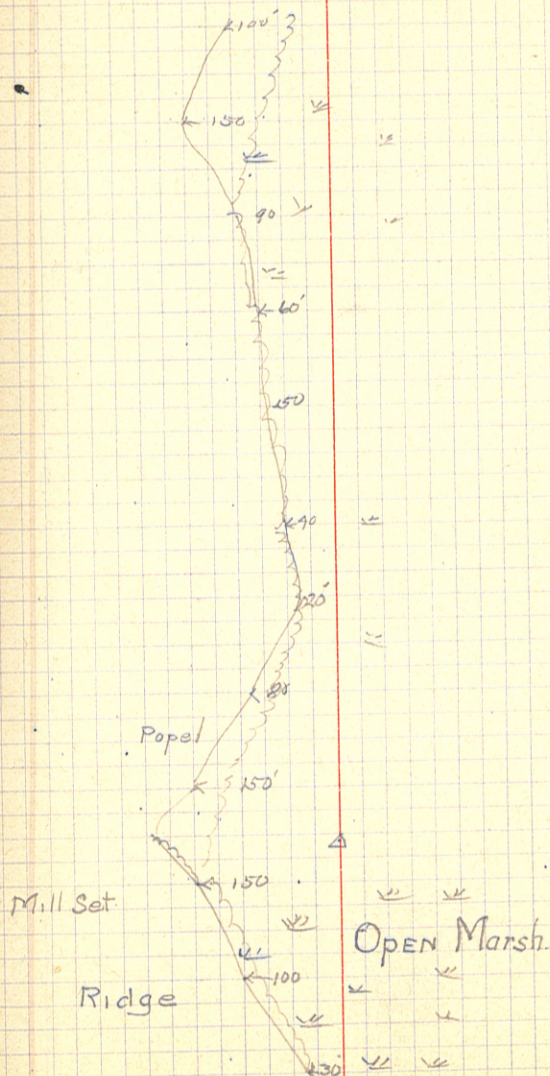

E. M. Polynieux

24

METES & BOUNDS

✓ Around marsh in Sec. 2, at north end of LATERAL N^o 1

35

34

33

32

+99.1 Δ 447.7 79° 09' R. S. 47° 50' N.

31

30

29

28

27

+46.4 Δ 479.5 38° 40' R. S. 32° E

26

25

24

23

Co. Ditch N^o 2

CASS CO. MINN.

25

FRED JANS.

TAME HAY

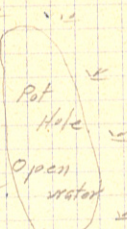

Open Marsh

Field

FRED JANS.



M. J. Jans

Around marsh in Sec. 2, at north end of LATERAL No 1



10-30 A.M. July 24, 1915

+76.8 Δ

44

43

42

41

40 +16.1 Δ 422 190° 50' L. S. 28° 10' W.

39

38

37

36

Point of beginning
On beaver dam

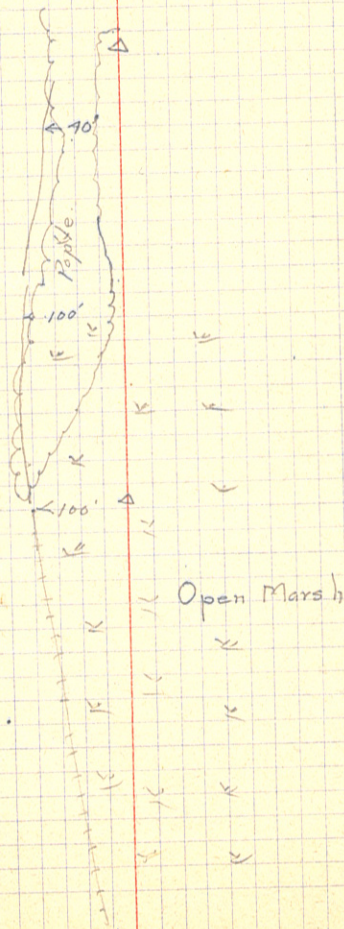

METES & BOUNDS No 4
Sec. 2

- 9
- 8
- 7
- 6
- 5
- 4
- 3
- 2
- 1
- 0+00

+72.7 Δ 472.7 88° 18' L. N. 0° 45' E.

88° 50' E Along Sec. line

July 21, A.M. Same Crerr.

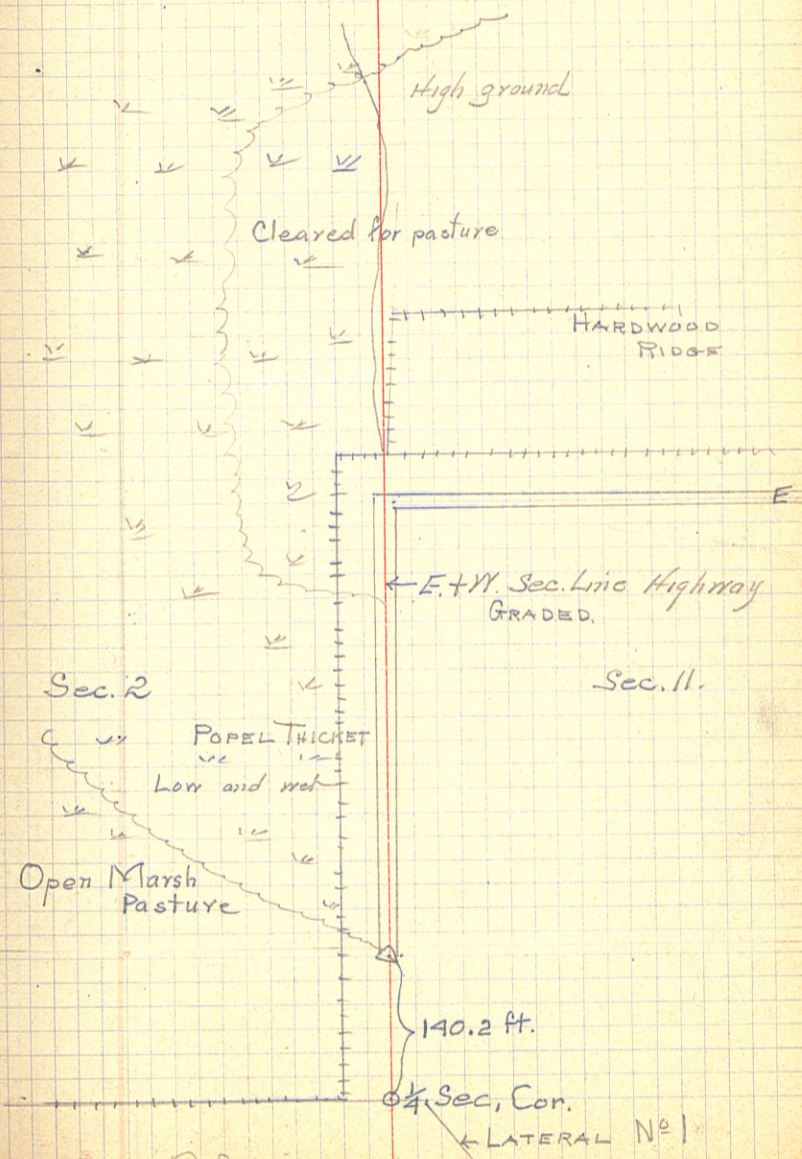

A.M.

1/4 Sec. Cor. LATERAL No 1

30

METES & BOUNDS No 4

22. +00 Δ

N. 72° 10' W.

21

20

19

18

+50.3 Δ
+48

17

+38 Δ

16

15

14 +35

13

12 +30

+61.0 Δ

11

10

$$\begin{array}{r} 17 \times 50.3 \\ 4 + 22.1 \\ \hline 127.76 \end{array}$$

72° 33' L

N. 72° 20' W

3 wire fence

N. 0° 30' E

fence, enter open marsh

enter marsh.

N. 0° 30' E

Co. Ditch No 2

CASS Co., MINN.

31

Rye Field

Open Marsh
Meadow.
Water.Poplar & Alder
Thicket.Open Marsh.
Meadow
10' WATER

PASTURE

Poplar + brush

High ground

E. M. Molyneux

32

METES & BOUNDS No 4

SAME CREW. FINE DAY.

+42.7 Δ 822.7 66° 57' R. N. 23° 50' W.

34

Enter marsh

33 +10

Leave marsh

+30

32

+70.6 Δ

Enter Marsh 10-15 A.M.
 Commenced July 29, 1915
 S. 88° 30' W. Quit for dinner
 July 21, 1915

31

30

29

28

27

26

+200 Δ 868.7 18° 41' L S. 89° 15' W.

25

24

23

Co. DITCH No 2

GASS Co., MINN.

33

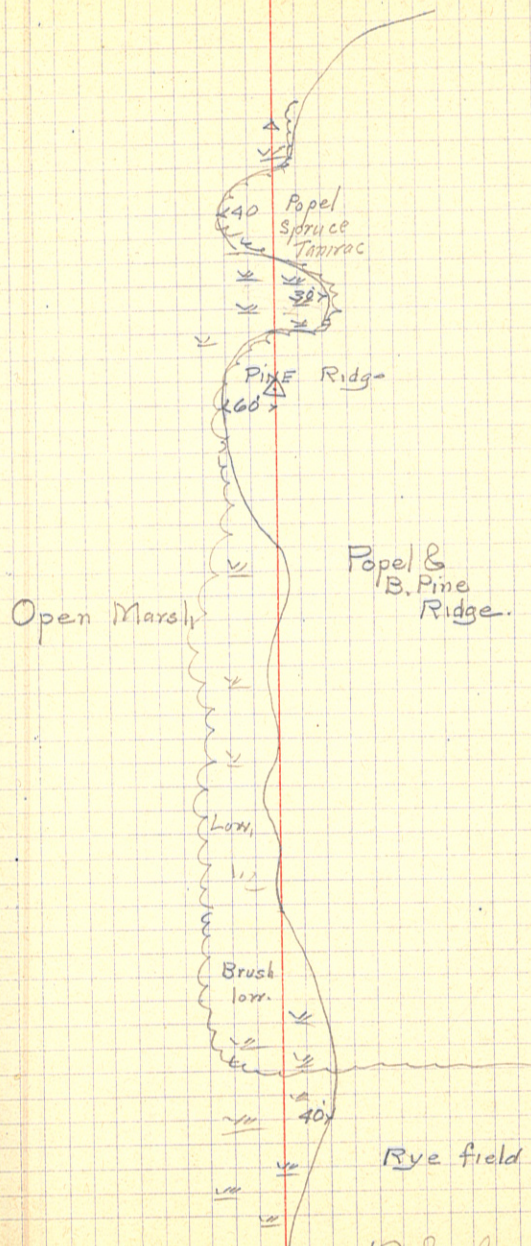

J. M. Molyneux

34

METES & BOUNDS No 4

+58.0 Δ

33° 37' L N. 76° 20' W.

47

46

45

44

+97

E + N. 1/4 Fence Line

43

+80

N. + S. 1/4 Fence Line

42

+97.3 Δ

754.6

12° 58' L N. 36° 50' W.

41

40

39

38

37

36

35

774.58
1119.23
560.7

Co. Ditch No 2.

CASS Co. MINN.

35

Open Marsh

Very soft and wet

E + N. 1/4
3 wire
N. + S. 1/4
3 wire
fence line

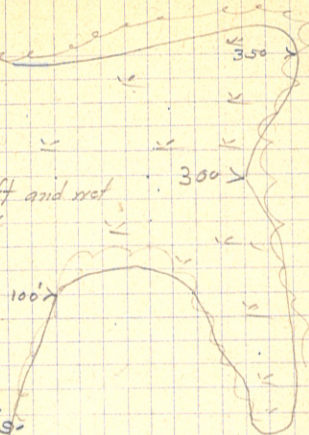

12° 58' L
N. 36° 50' W

J. R. Holyneup

36



METES & BOUNDS No 4

60

59 +20.3 Δ 768.3 120° 57' L. S. 0° 30' E of N. + S. Highway
Btr. Sec. 2 + 3

58

57

56

55

54

53

52

+52.0 Δ 10° 29' R. N. 59° 50' W.

51

514.52
974.58
3.99

50

49

48

Co. Ditch No 2,

CASS Co. MINN.

37

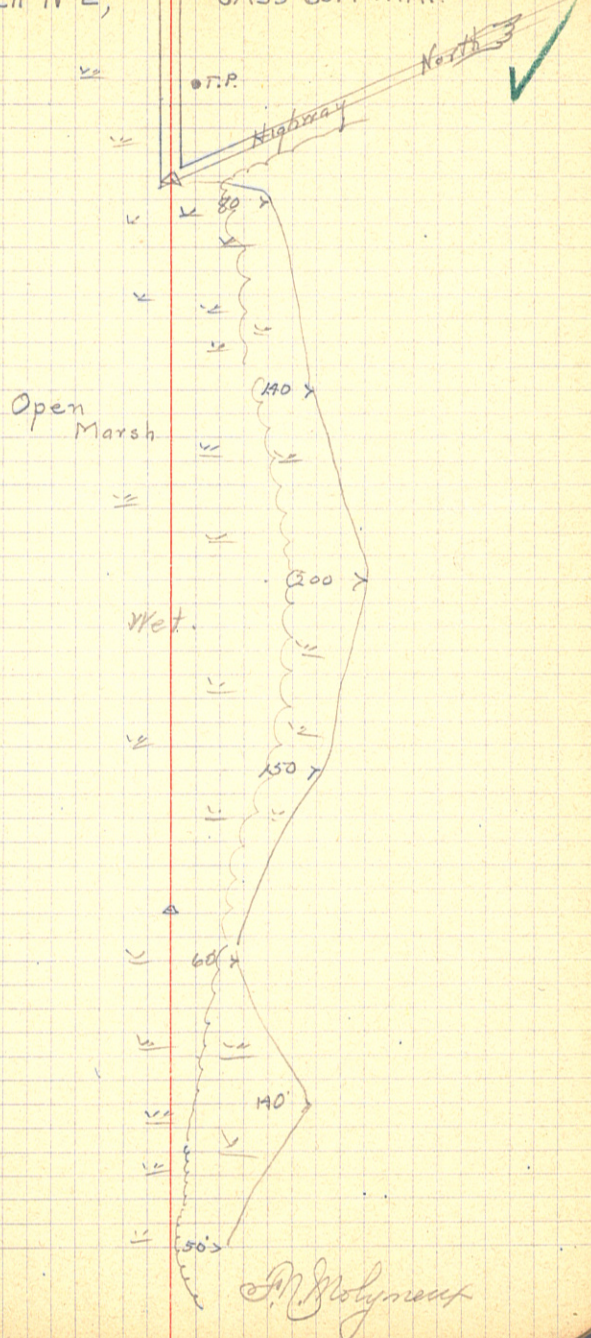

38

METES & BOUNDS No 4

73

72

+75.9 Δ
+73

291.2

58°38' R. S. 27°16' E

3 wire fence

71 +06

3 wire fence

70

69

+84.7 Δ

969.4

85°28' L. S. 86°10' E

Leave Road

68

67

66 +03

E+W.L. line fence

65 +37

Ditch runs east

64

63

62

61

Co. Ditch No 2

CASS CO., MINN.

39

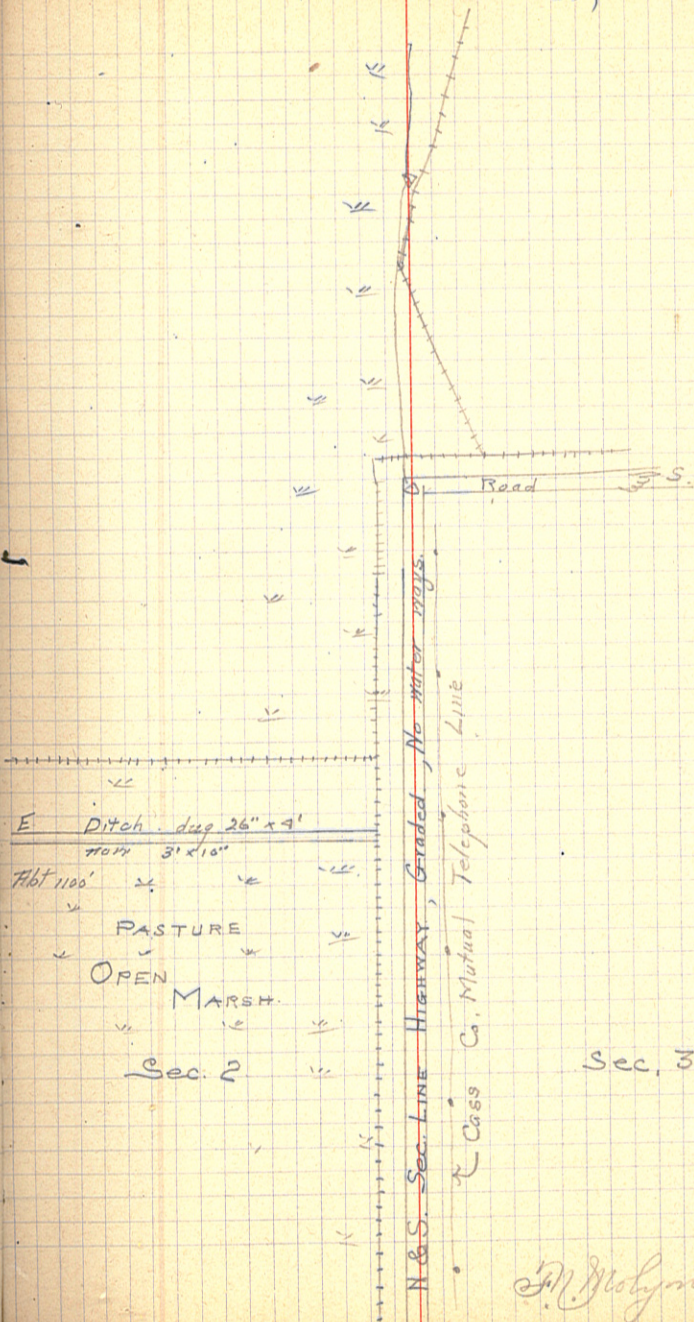

M. Molyneux

40



METES & BOUNDS N^o4

86

85

84

83

82

81

80

427.3 Δ 851.4 4° 46' R, S, 22° 35' E

79

78

77

76

75

74

CO. DITCH N^o2

CASS Co. MINN.

41

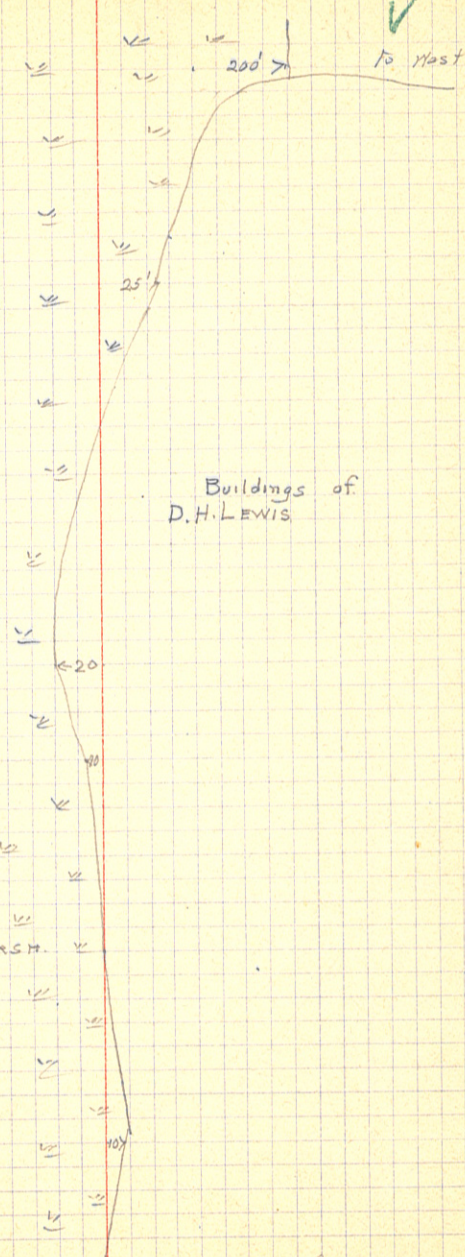

J. N. Molyneux

96 +29.5 Δ 268.8

95

94

+55.7 Δ 1328.4 26° 01' R. S. 3° 0' Y.

93

92

91

90

89

88

87

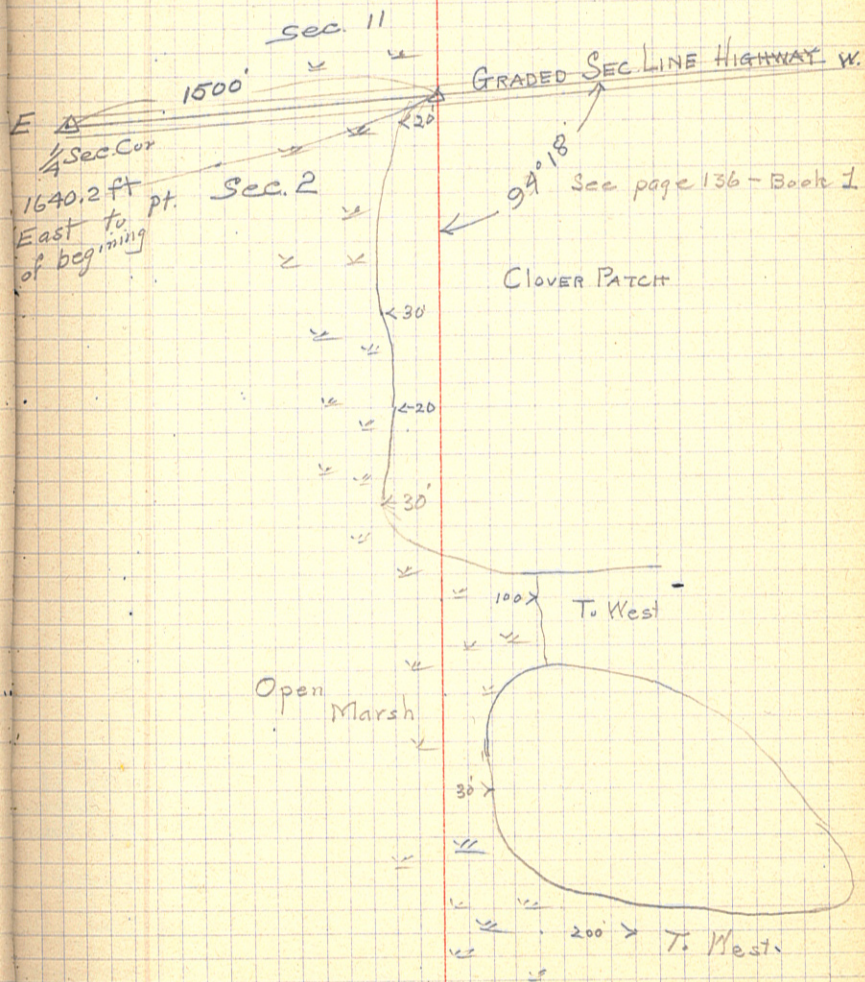
On Sec. Line
S. side Sec. 2

J. N. Molyneux

JULY 24, 1915

9

8 +16.7 Δ 189.7 27° 41' L. N. 50° 20' W

7

6 +32 502 48° 57' L. N. 22° 30' W

5

4

3

2

1 +30.0 Δ 130' 19° 06' L. N. 26° 50' E.

0+00

46° 31' R. N. 45° 40' E. Is point 1200' west and 333.8' North of the 1/4 Sec. Cor. between Secs. 2 & 11, 139-32

Metes and bounds run to determine the acreage of a small pine cut over island in the marsh of Sec. 2 See book 1 page 136.

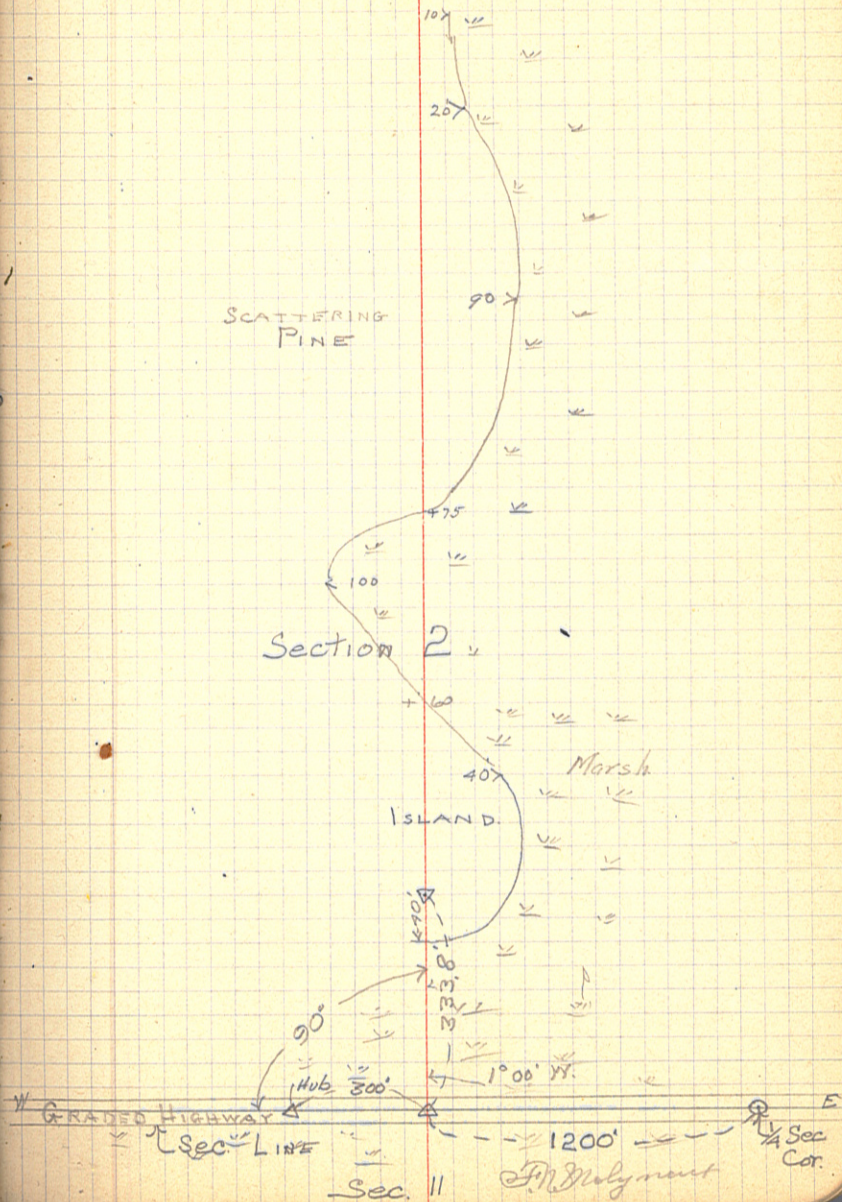

19	+38.9	116.6'	= 0.00 Pt. of beginning	
18	+22.3 Δ	642.3	11° 26' L	S. 16° 15' E
17	+20.		LEAVE MARSH	
16				
15	+58		Enter marsh	
14				
13	+64 Δ		S. 5° 0' E	
12	+80.0 Δ	238.2	85° 12' L.	S. 5° 0' E 21' W. to 1/4 line fence.
11				
10	9+41.8	125.1	19° 20' L.	S. 80° 30' W.

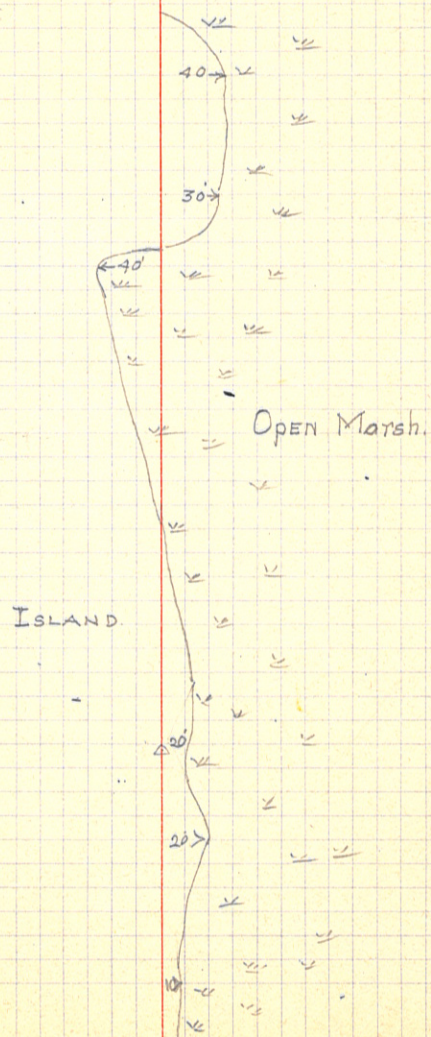

✓ For acreage measurements of marsh in the north half of Sec 27, 134-32 and to the north and west of the main ditch.

Commencing at a point on the E. & W. $\frac{1}{4}$ line through Sec. 27, center of highway and 800 feet west of the \mathcal{C} of main ditch.

F. N. Molyneux, Transit

Arthur Farber, flag

Frank Petroske, head chain

Jack " rear "

Nick " axe "

Commenced July 26, 1915.

Fine morning

5

4

3

2

12

1

11

0+00

10

9

N. 6° 15' W. POINT ON $\frac{1}{4}$ SEC. LINE

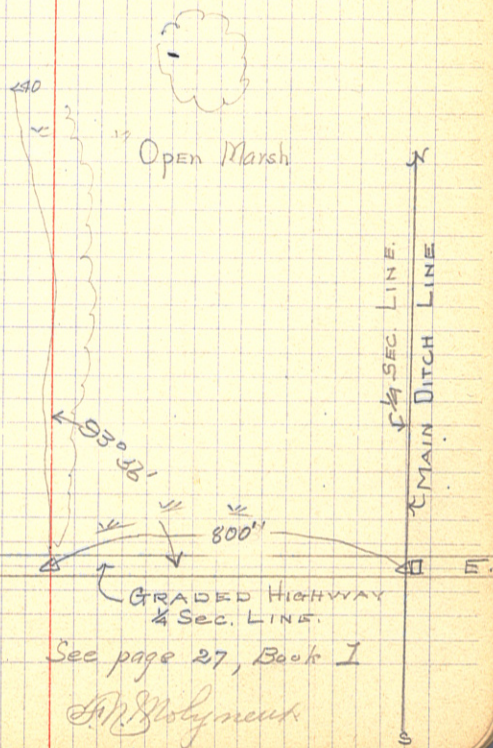

Sec page 27, Book I

F. N. Molyneux

50

METES & BOUNDS No 5

18

17

16

15

14

13

12

11 +08.1 Δ 481.1 12° 06' L. N. 18° 30' W.

10

9

8

7

6 +27.0 Δ 627 N. 63° 30' W.

Co. DITCH No 2

CASS Co., MINN. 51

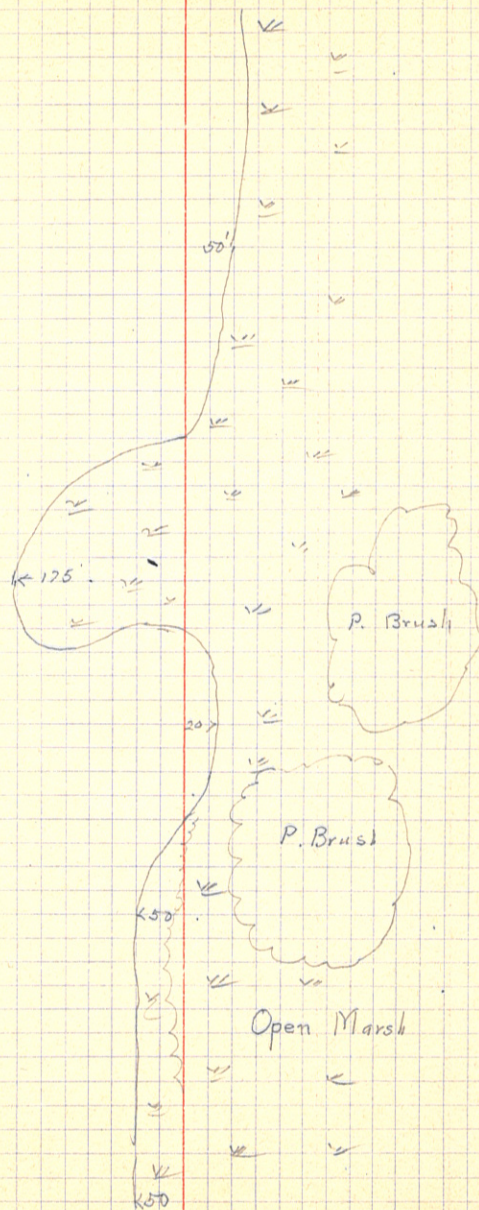

M. Molyneux

METES & BOUNDS No 5

+33.6 Δ

N. 43° 55' W.

31

30

29

28

27

+54.0 Δ 1545.9 25° 25' L. N. 44° 15' W.

26

25

24

23

22 +27 Δ 1118.4

N. 18° 40' W.

21

20

19

HARDWOOD RIDGE.
Small scattering trees.

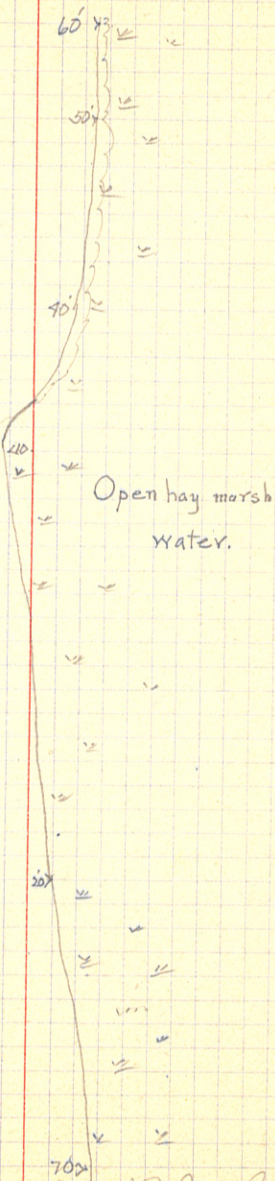

J. M. Molyneux

54

METES & BOUNDS No 5

44

43

12 +23.5 Δ 252' 39° 06' L. N. 66° 45' W

41

40

+71.5 Δ 478 37° 11' L. N. 27° 45' W.

39

38

37

36

35

+93.5 Δ 839.5 53° 14' R. N. 9° 10' E.

34

Leave marsh

33

+15 Enter marsh

32

Co. DITCH No 2

CASS Co., MINN.

55

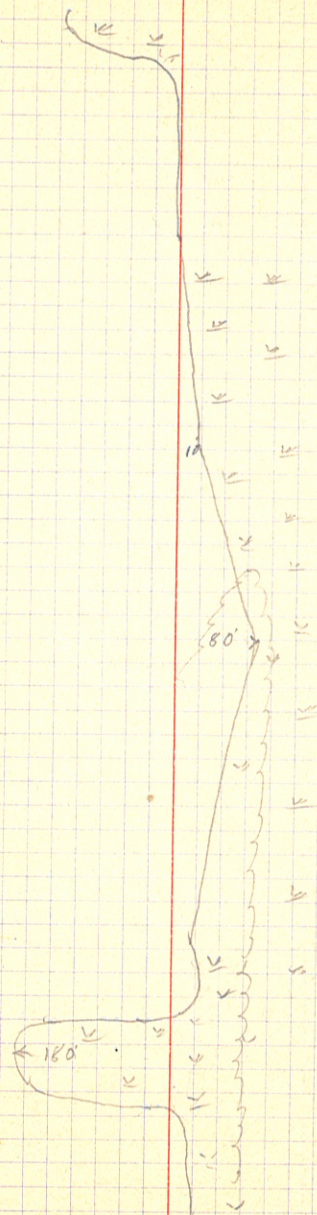

AM Holyment

56

METES & BOUNDS N^o 5.

57

56

+45.5 Δ 864.7 27° 31' R. N. 46° 30' W

55

54

53

52

51

50

49

+25

48

Intersect Sec Line
1525' N. of Sec. Cor.

47

+80.8 Δ 457.3 7° 48' L N. 75° 30' W

46

45

Co. DITCH N^o 2

CASS Co., MINN.

57

28
27
21
22
1525'

Low open ridge

Open marsh

E. N. Holyman

58

METES & BOUNDS No 5

70

+10



enter marsh

+55 Δ

69

68

67

66

+80 leave marsh

65

64

+87.0 Δ

841.5

57° 12' R N 10° 10' E

enter marsh

63

leave marsh

62

61

60

enter marsh

59

58

CO. DITCH No 2

CASS CO., MINN.

59

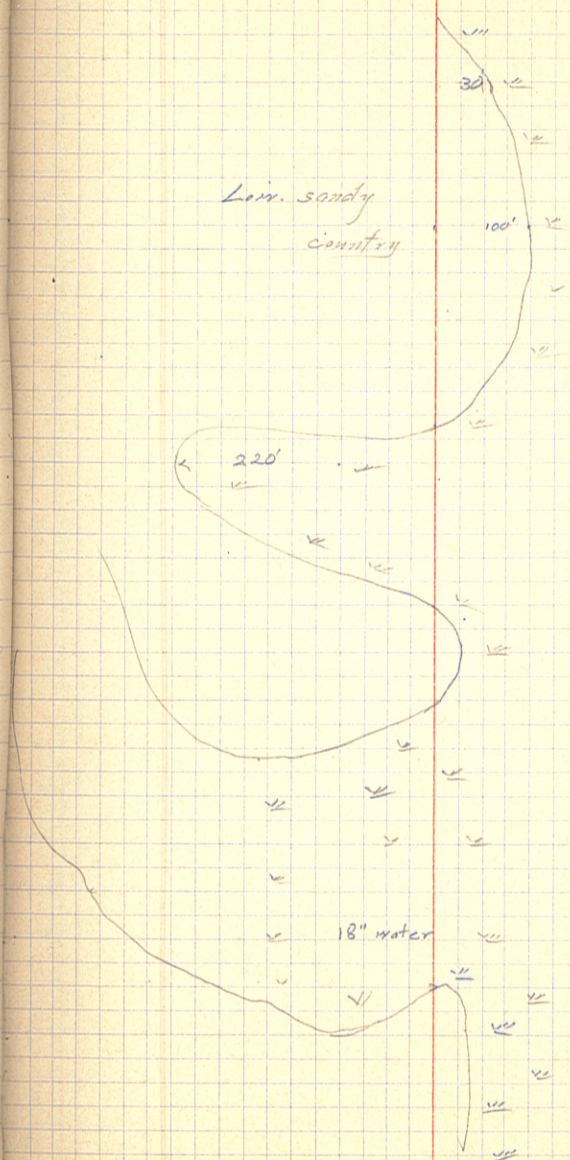

M. Holy ment

60 ✓

METES & BOUNDS N^o 5

83

82

81

80

79 $+25.8 \triangle 524.2 \ 6^{\circ} 41' R. \ S, 38^{\circ} 45' E.$

78

77

76

75

74 $+01.6 \triangle 1014.6 \ 179^{\circ} 17' R. \ S, 45^{\circ} 30' E.$

73

72

71

Co. DITCH N^o 2

CASS Co., MINN. ✓ 61



62 ✓

METES & BOUNDS No 5

96

95

94

93 +11.0 Δ 358 21° 24' R. N. 3° 40' E.

92

91

90

89 +53.0 Δ 294.2 17° 46' L N. 17° 46' N.

88

87

86 +58.8 Δ 214.8 130° 30' L N. 0° 10' N.

85

84

+44.0 Δ 518.2 10° 28' L. S. 49° 20' E

84

Co. DITCH No 2.

CASS Co. MINN.

✓ 63



A. N. Molyneux

64



METES & BOUNDS No 5

9 109

+51.2 Δ 323.9 15°48' L N. 39°40' W.

9 8

9 7

9 6

+27.3 Δ 1216.3 22°22' L. N. 18°40' W.

9 105

9 4

9 3

89 2

88 1

8 100

8 99

8 98

8 97

Co. DITCH No 2

CASS Co., MINN.

65



S. D. Holmquist

✓ Quit for the day, July 26, 1915

Traced and hubbed Sec line between
Sec 21+22 so as to get location of
lateral No 2 parallel and 15 feet west
of same

✕
CONTINUED ON PAGE 74

+77.5 Δ 5.62.5

125

124

123

TUESDAY JULY 27, 1915. ✓

Rainy morning. Quit at 8-30 A.M.

Went out on line, rather wet. None of crew
come. Looked over "Big" island and returned
to camp for dinner. Camp P.M.

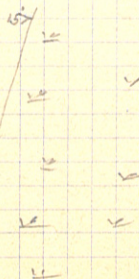

✓ Wednesday, July 28, 1915

Fine morning, fog cleared about 8-30 A.M.

Same crew.

26+44

60° 52' L N. 76° 30' W.

4

13+24

90° R. N. 2° 15' W. Hard ground 80' W.
Low place in west side of marsh.

1

0+00

S. 87° 50' W. = 197+19.4 MAIN DITCH

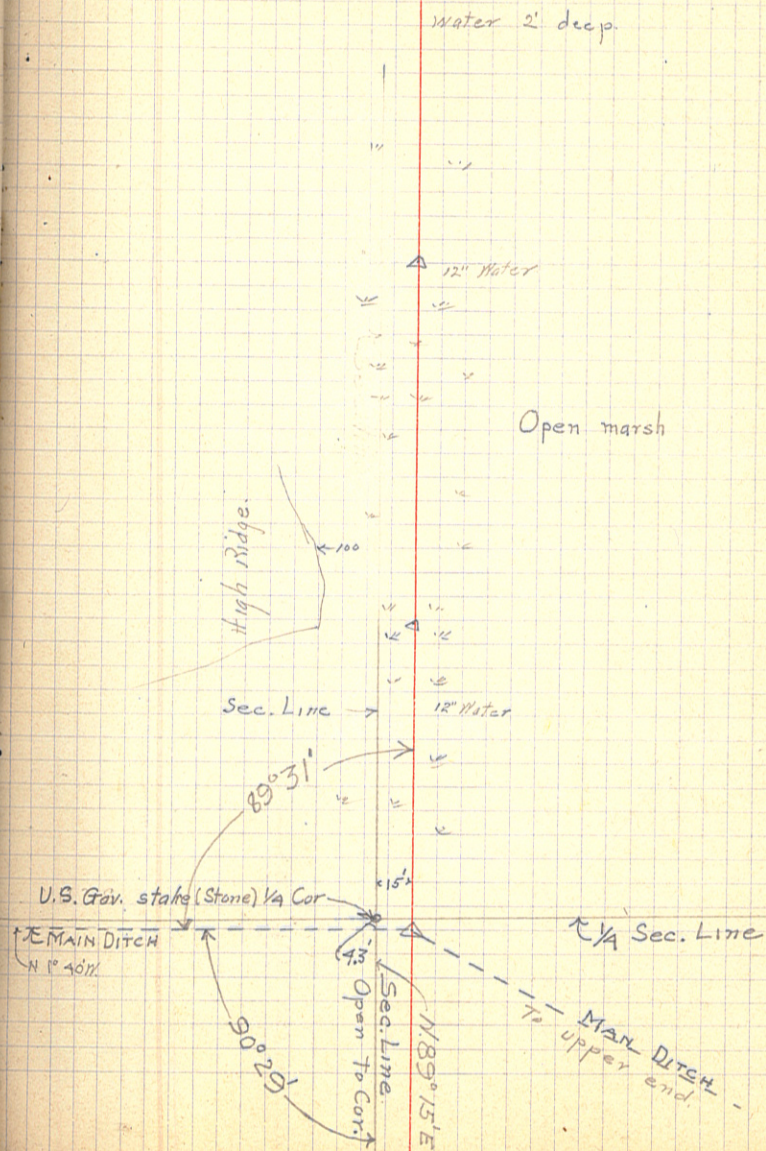

89+50

End

79+57 Δ

N. 66° 40' W. On beaver dam

77+00.7 Δ

65° 02' L N. 66° 45' W

73+28.3 Δ

N. 1° 45' W.

53+13.3

X Section, 15' W. of Sec. C

47+32.3 Δ

N. 1° 45' W. On beaver dam

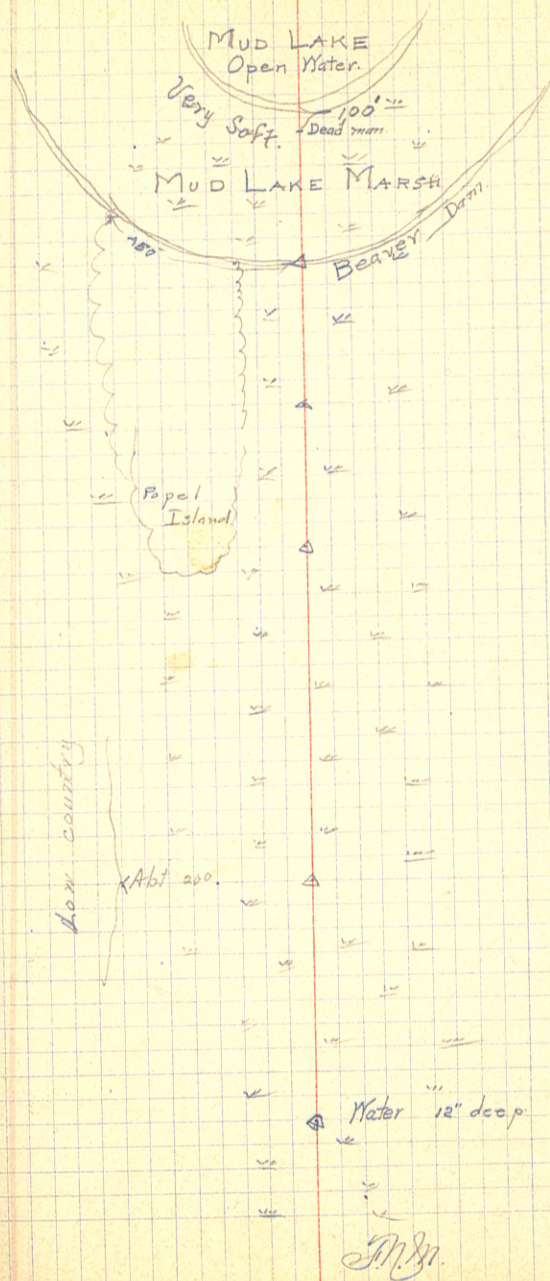
30+54 Δ 61° 29' R. N. 1° 35' W. This hub is 15 ft west of
Sec. line + 2000 ft North
of Sec. Cor., Secs.21 | 22
28 | 27Noon, Quit
for dinner

M.S.M.

74



Metes & Bounds No 5

WEDNESDAY JULY 28, 1915, P.M.

137

136

135

134

133

132

+89.3 Δ

611.8

66° 18' L. S 67° 30' W.

131

$$\begin{array}{r} 131 \times 82.3 \\ 128 \times 22.5 \\ \hline 611.8 \end{array}$$

130

129

128

127

126

125 + 77.5

562.5

19° 17' R.

N. 45° 55' W.

Commenced 12-35 P.M.

Cont from page 68

Co. Ditch No 2

Cass Co., MINN.

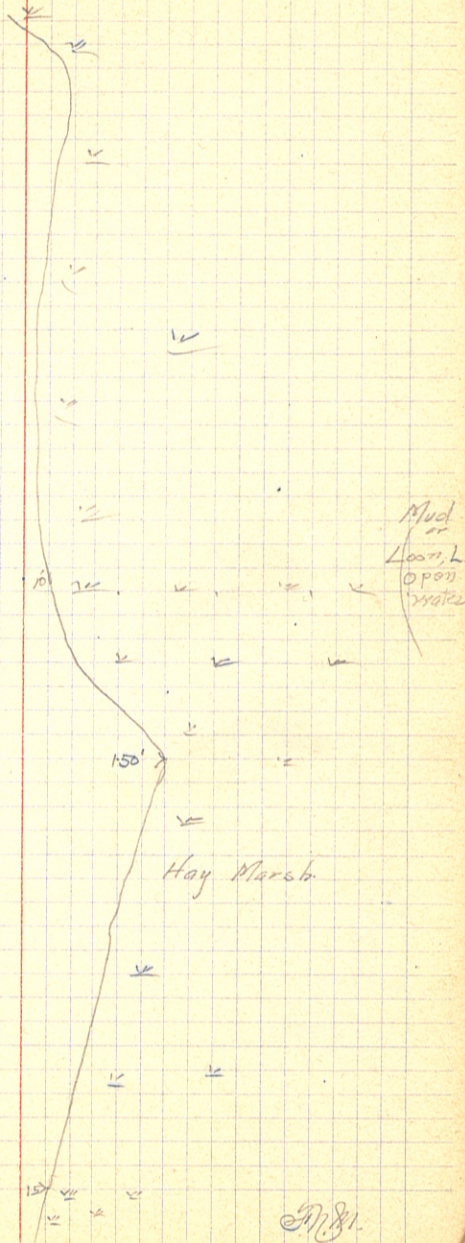

M.B.

76



Metes & Bounds & 5

150

149

148

147

146

145

+83.7 Δ 396.1 28° 24' R. N. 0° 15' W.

144

$$\begin{array}{r} 144 + 83.7 \\ 140 + 87.6 \\ \hline 396.1 \end{array}$$

143

142

141

+87.6 Δ 896.3 43° 44' R. N. 28° 25' W.

140

$$\begin{array}{r} 140 + 87.6 \\ 131 + 89.3 \\ \hline 896.3 \end{array}$$

139

138

+60

enter Marsh

Co. Ditch No 2

CASS Co., MINN.

77

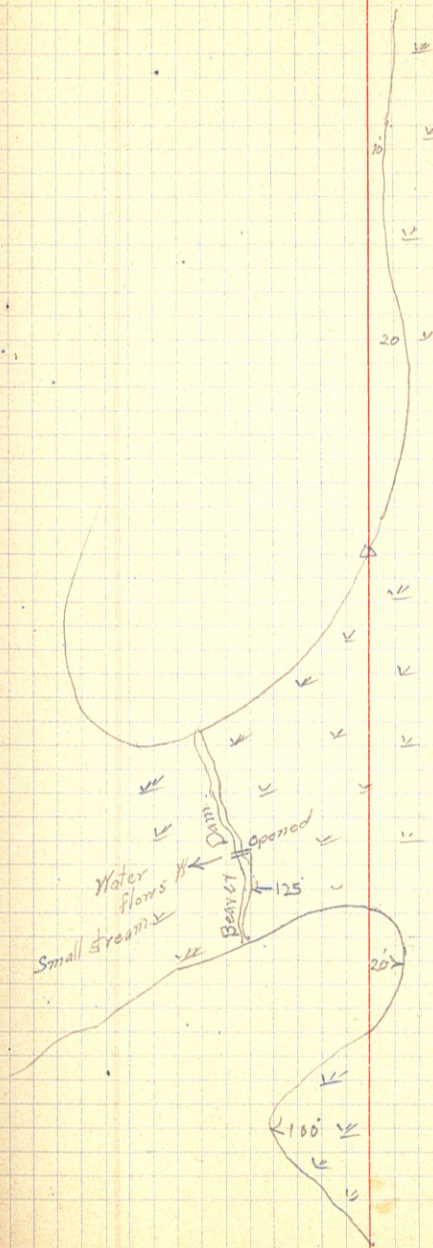

A. S.

Metes & Bounds No 5

163

+34.0 Δ

162

162+24
152+22.5
1071.6

78° 28' R 3,85' 0" E

161

160

159

158

157

156

155

154

153

+22.5 Δ

152

152+22.5
199+18.2
336.8

16° 45' R. N. 16° 45' E

151

Ryan Lake
Marsh

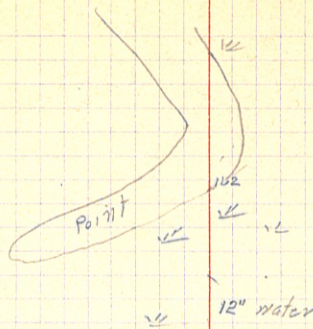

12" water

12" water

Open Marsh

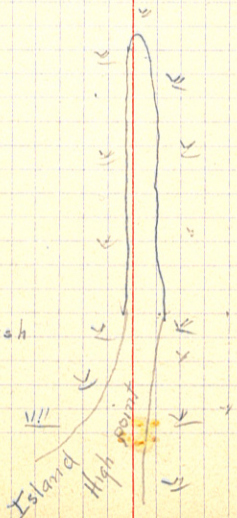

Open water

Handwritten signature or initials.

177

176

175

174

173

172

+63.5

△

$$\begin{array}{r} 171 + 63.5 \\ 162 + 34 \\ \hline 9 \quad 29.5 \end{array}$$

29° 08' R. 3.55° 10' E

171

170

169

168

167

165

169

Lean Country

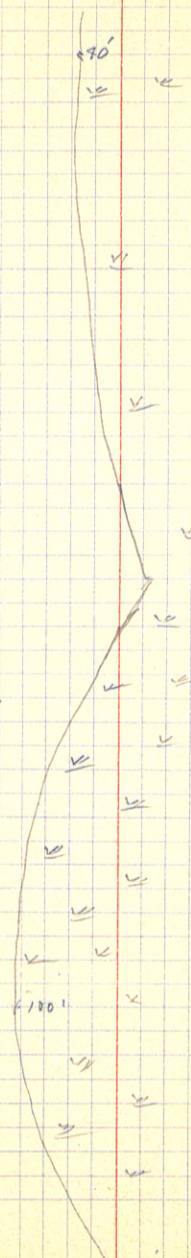

AmB

82 ✓

+71.7 Δ

190

189

188

187

186

+85.6 Δ

185

184

183

182

181

180

+38.0 Δ

179

178

Metes & Bounds No 5

$$\begin{array}{r} 190 + 71.7 \\ 185 + 85.6 \\ \hline 447.3 \end{array}$$

83° 32' L N. 16° 50' E

$$\begin{array}{r} 185 + 85.6 \\ 179 + 38.0 \\ \hline 647.6 \end{array}$$

61° 01' L. S. 79° E

$$\begin{array}{r} 179 + 38.0 \\ 174 + 50 \\ \hline 774 \end{array}$$

37° 05' R. S. 18° E

Co. Ditch No 2

CASS Co, MINN.

83 ✓

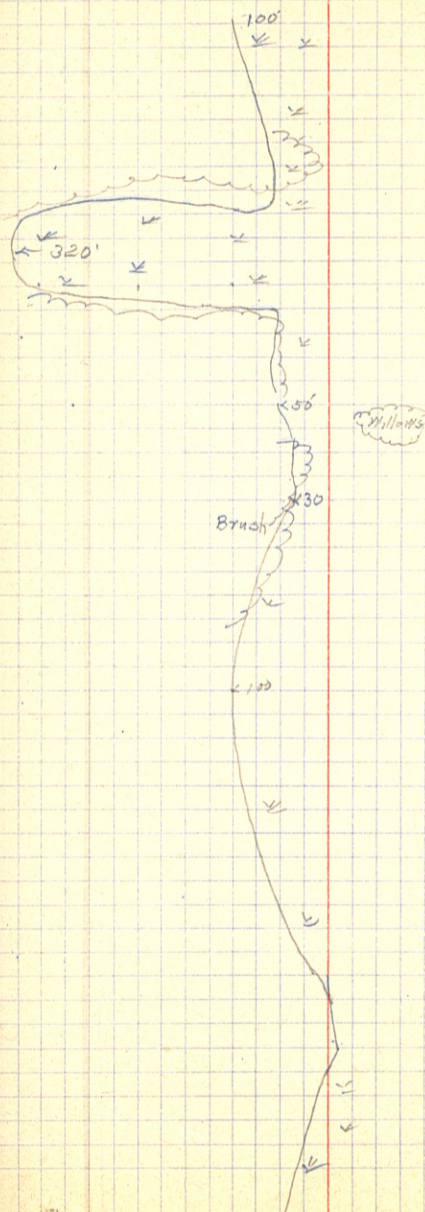

A.M.B.

84

Metes & Bounds No 5

203

202

201

+69.7 Δ

200

199

198

197

196

195

194

193

192

191

N. 16° 50' E.

Co. Ditch No 2

Cass Co., Minn.

85

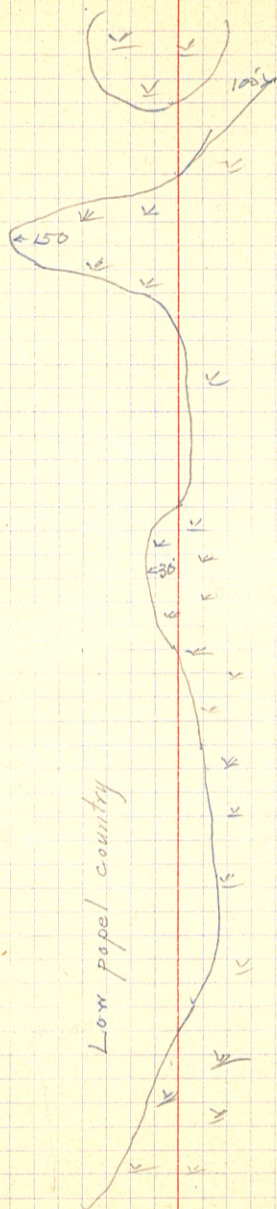

Brush patches

Low paper country

[Handwritten signature]

Meters & Bounds No. 5
THURSDAY JULY 29, 1915

216

215

214

213

212 +11.3 Δ

$$\begin{array}{r} 212 + 11.3 \\ 205 + 22.2 \\ \hline 636.1 \end{array}$$

35° 14' L N. 33° 45' W.

211

210

209

208

207

206

+75.2 Δ

$$\begin{array}{r} 205 + 45.2 \\ 190 + 71.5 \\ \hline 1583.5 \end{array}$$

15° 05' L N. 1° 30' W. 1/4 Sec. Cor. 19' E.

205

Comm. July 29, 1915
Quit July 28, 1915
Fine day

204

Scattered brush

Low ground

Wet in places
400' L.Low
dry
ground.

Open Marsh

1915 Sec. Cor.

Sec. 15+16

ANS

229

8

7.
+97.3 Δ

226+97.3
221+11.3
9 36.7

58° 09' L. S. 78° 15' W

225

4

3

2

+48.0 Δ

221+48.0
212+11.3
9 36.7

9° 39' L. N. 43° 45' W

221

226

219

218

217

