

N^o 166

PASTY

FIELD BOOK

No. 385

Property of Cass County

Please return to

County Highway Engineer

Walker,

Missouri

46

238

8

175

46

1

Our Leather Bound Engineers Note Books are carried in the following rulings:

- No. 380 LEVEL BOOK. Left and Right Hand Page the same as Left Hand Page of this Book.
- No. 382 FIELD BOOK. Left Hand Page as in this Book, Right Hand Page 4 x 4 to the inch, Center Line Red.
- No. 384 MINING TRANSIT BOOK. Left Hand Page as in this Book, Right Hand Page 8x8 to the inch, Center Line Red.
- No. 385 FIELD BOOK. Left Hand Page as in this Book, Right Hand Page 8 vertical and 4 horizontal lines to the inch, Center Line Red.

We also carry the Note Books listed above, bound in extra strong Fabri-Hide (otherwise the same quality of book), which can be furnished at a somewhat lower price.

In ordering Fabri-Hide covered books, add the letter "F" to catalog number.

THE FREDERICK POST CO.
ENGINEERING and DRAFTING SUPPLIES
IRVING PARK STATION
CHICAGO, ILL.

Index

Page

Cedar Lake Investigation

182 Investigation for Mr. Noble, Cedar L. ^{Sec. 18-}

Co. Aid Rd #19

5-11 - Transit Notes

13-24 Level Notes

Co. Aid Rd. No 13 - Gull L. Rd.

{ 27-32 Transit Notes

{ 33-40 Cross Sections

1 Elevations of Swamp at Cedar Lake
 SEC. 18-T142N.R31W.

Nov 29-30-1929

Party { Prudlo
 Lester Rod
 Ellis 4xc

Swamp East.

| | | | |
|----|-----|-------|--------|
| BM | 340 | 10340 | 100.00 |
| WL | | 5.10 | 98.30 |

At (E) 10" Tamarack 35' E of Outlet Cedar L
 W.L. at outlet

| | | | |
|--|------|-------|-------|
| | 7.75 | 10605 | 98.30 |
|--|------|-------|-------|

| | | | |
|--|------|-------|-------------|
| | 6.85 | 10900 | 3.90 102.15 |
|--|------|-------|-------------|

| | | | |
|--|------|-------|-------------|
| | 6.13 | 11327 | 1.86 107.14 |
|--|------|-------|-------------|

| | | | |
|--|-----|-------|--|
| | 9.6 | 103.7 | |
|--|-----|-------|--|

| | | | |
|----|--|------|--------|
| BM | | 6.47 | 106.80 |
|----|--|------|--------|

Elev of Swamp at (B)
 5" Poplar 60' North of Corner at (B)

| | | | |
|--|------|-------|-------------|
| | 5.01 | 11021 | 8.07 105.20 |
|--|------|-------|-------------|

| | | | |
|--|------|-------|-------------|
| | 5.27 | 11490 | 0.58 109.63 |
|--|------|-------|-------------|

| | | | |
|--|------|-------|-------------|
| | 6.88 | 11813 | 3.65 111.25 |
|--|------|-------|-------------|

| | | | |
|--|------|-------|-------------|
| | 9.52 | 11885 | 8.80 109.33 |
|--|------|-------|-------------|

| | | | |
|--|-------|-------|-------------|
| | 12.43 | 12435 | 6.93 111.92 |
|--|-------|-------|-------------|

| | | | |
|--|------|-------|-------------|
| | 3.84 | 12294 | 5.25 119.10 |
|--|------|-------|-------------|

| | | | |
|--|------|-------|-------------|
| | 4.65 | 12606 | 1.53 121.41 |
|--|------|-------|-------------|

| | | | |
|--|------|-------|-------------|
| | 6.77 | 12678 | 6.05 120.01 |
|--|------|-------|-------------|

| | | | |
|--|------|-------|-------------|
| | 2.68 | 12439 | 5.07 121.71 |
|--|------|-------|-------------|

| | | | |
|----|--|------|--------|
| BM | | 8.93 | 115.46 |
|----|--|------|--------|

| | | | |
|--|------|-------|--------------|
| | 5.95 | 11856 | 11.78 112.61 |
|--|------|-------|--------------|

| | | | |
|--|-----|-----|-------|
| | 7.2 | 7.8 | 110.8 |
|--|-----|-----|-------|

| | | | |
|--|------|--------|-------------|
| | 5.71 | 116.75 | 7.52 111.04 |
|--|------|--------|-------------|

| | | | |
|--|------|-------|-------------|
| | 8.40 | 12442 | 0.73 116.02 |
|--|------|-------|-------------|

| | | | |
|--|------|-------|-------------|
| | 0.91 | 11608 | 9.25 115.17 |
|--|------|-------|-------------|

| | | | |
|----|--|------|--------|
| BM | | 0.02 | 116.06 |
|----|--|------|--------|

At C 6" spruce So. End of Brush Line
 Elev Swamp at (C)
 " Swamp

75" Poplar 60' NE T.H. 7 40' E. Sec Line

Elev. Swamp at (D)
 Elev T.H. #19

| | | | |
|--|------|-------|--|
| | 10.6 | 105.5 | |
|--|------|-------|--|

| | | | |
|--|-----|-------|--|
| | 4.7 | 111.4 | |
|--|-----|-------|--|

②

Elevations of Swamp W. of Cedar Lake

11/30-29

Party { Prudlo
Lester-Rod
Ellis Axe

| | | | |
|------|--------|------|--------|
| 5.37 | 103.67 | | 98.30 |
| 6.20 | 106.32 | 3.55 | 100.12 |
| 5.14 | 107.96 | 3.50 | 102.82 |
| | | 3.65 | 104.31 |
| | | 4.3 | 103.7 |

BM

W.L. Lake Cedar.

Swamp

Swamp.

6" Cedar at end of Brush Line on North & S. Line

Elev Swamp at N. & S. Line.

Transit Notes County Aid Road #19

12/16-29 -

Prudlo T
Vogt
Shequin

5

Meadow

13

13+00

8+16.0 Sec. Line POT. No. Mon. S70°0'W.

RP { 6" J.P. inc 73.6 NW
 8" J.P. 77.7 SW. ^{Town} --- FE
_{Road} ---

26' 6" J.P. N.W. 68.5 P15'CM P15'CM
 Mon. 8" J.P. SW 80.0' Button on side of tree

8+16.0

Wild Land

0+00

R.P. { 5" J.P. 50.6 NW
 2" J.P. 53.5 SW.

0+6.00 Sec 16-21-135-32

R.P. { FP 56.9 SE
 FP 38.5 SW

Swamp

43

37

34+560 1/4 Line No Mon POT

6

R.P. { 4" J Pine 59.9 NW
3" J Pine 72.7 NE

Wild Land

FE 37+00

R.P. { 4" J Pine 50.4 NW
8" J.P. 94.8 NE

----- 53+00 -----

Swamp

15 per X

69

67

61+00 Sec Line No 1467 A0°39'R

56

49

7

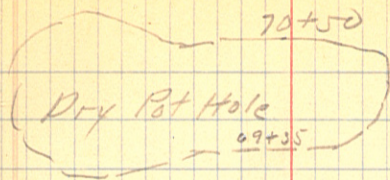

RP { 6" JP 48.3 SW
 4" JP 41.1 SE

RP { 4" JP 45.0 NW
 4" JP 59.5 NE

Wild Land
 Get Notes from Greene

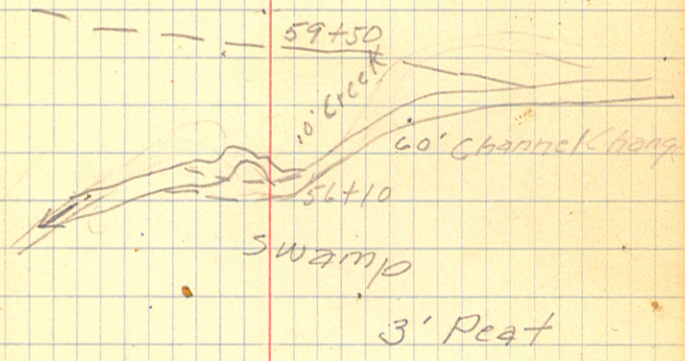

RP { 1" JP 65.5 NW
 10" JP 53.5 NE

50+50

92

87+640 1/4 Line Iron Pipe Inp 0°08' L

80

74+18

iron pipe 2' L of E

73

72

87+64
73
72+64

8

R.P. { 7" J.P. 541 NE
6" J.P. 843 NW

R.P. { 3" J.P. 559 NE Road 87+70
4" J.P. 787 NW ↑
P. 15" CM

R.P. { 6" J.P. 638 NE
9" J.P. 509 NW

Wild Land.

R.P. { 4" J.P. 632 SE
5" J.P. 614 SW
72+50
Town Road
↑
P. 15" CM

117

114+028 Sec Line No. Mon Δ 1°37' R

112

109+18.5 Ref. Cor. Iron Pipe in p.

102

101

100

99

98

Wild Land

R.P. { 5" J. Pine 588 NE
5" J. Pine 517 SE

Ref. Cor.

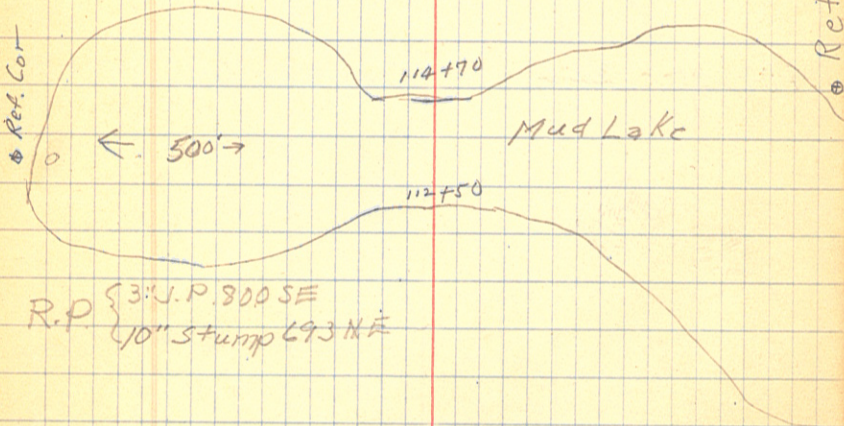

Ref. Cor.

R.P. { 3" J.P. 800 SE
10" Stump 693 NE

Wild Land

101+35

Dry Pot Hole

99+25

R.P. { 5" J.P. 65.7 NE
5" J.P. 425 NW

148

R.P. { 4" J.P. 417 So.
4" J.P. 418 SW.

Wild Land.

140+600 1/4 Line Iron Pipe Imp. Δ 021' L

R.P. { 12" J.P. 538 SE
12" J.P. 797 SW.

134

R.P. { 4" J.P. 440 SE
3" J.P. 614 SW

Wild Land

130

R.P. { 6" J.P. 555 NW
6" J.P. 693 NE

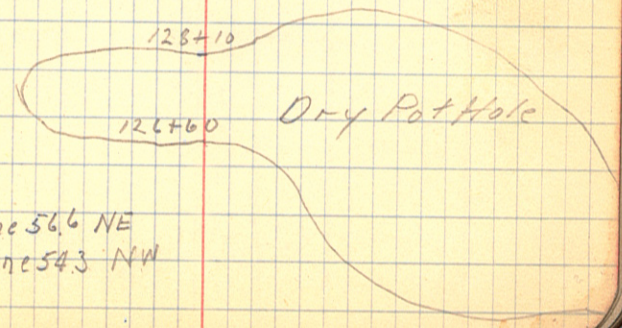

124

R.P. { 4" J.P. 566 NE
3" J.P. 543 NW

124

162+671 County Line Cass-Wadena

R.P. { 13" J. Pine St. 76.0 NW.
10" J. Pine Stump 65.8 NE

Wild Land

154

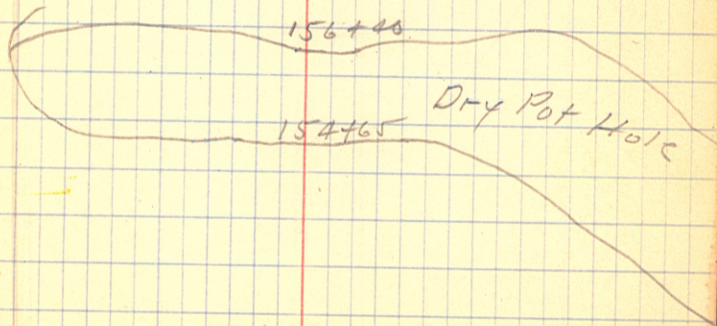

Wild Land.