

CASS LAKE BRIDGE

Book #. 1

North Side Ditch. Located
along south line sec

27-145-31 Ditch

Being on N Side Road.

CASS LAKE-BALL CLUB

ROAD

ENGINEERS

LEVEL BOOK

No. 411

INDEX

Page
29

Levels	Page
Sketch from Nails Ave East to Wend Br. 7-5	
Levels & Cross section of Borrow Pit for West approach of bridge	9-12
Check for grade on W. approach	13-16
Re cross section of Borrow pit for estimate	16
Notes by R. W. Noulster	17
Transit notes for Road from Cass Lake Narrows, east towards Cuba	19-26
Location of old road and foot tracks	26-27
Levels on road	29-43
" " "	48-49
Topography notes	44-47
Borrow pit notes for east approach of Br. pit near foot tracks.	50
Cross section of pit page	51
side ditch notes on slope sec 29, 145-31 south W of Cass Lake	52-53

7 Cass Lake Narrows.
1 Bridge.

F.W. Woodrater
J.H. B. Massey
7/22, 18.

15798.7 = 00 of Br. Survey

13+20 = approximately 1/4 Cor

- 4
- +30 Edge of low land
- +20 Near East foot of hill
- 3
- +85
- +70
- +57.0 Hub. top of hill
- 2
- +60 Hub. West foot of hill
- +39.25 Line R.R. Spur.
- +10.0 Hub.
- 1 shed
- 00 1/4 Cor Eric Neil's Ave.

Sketch

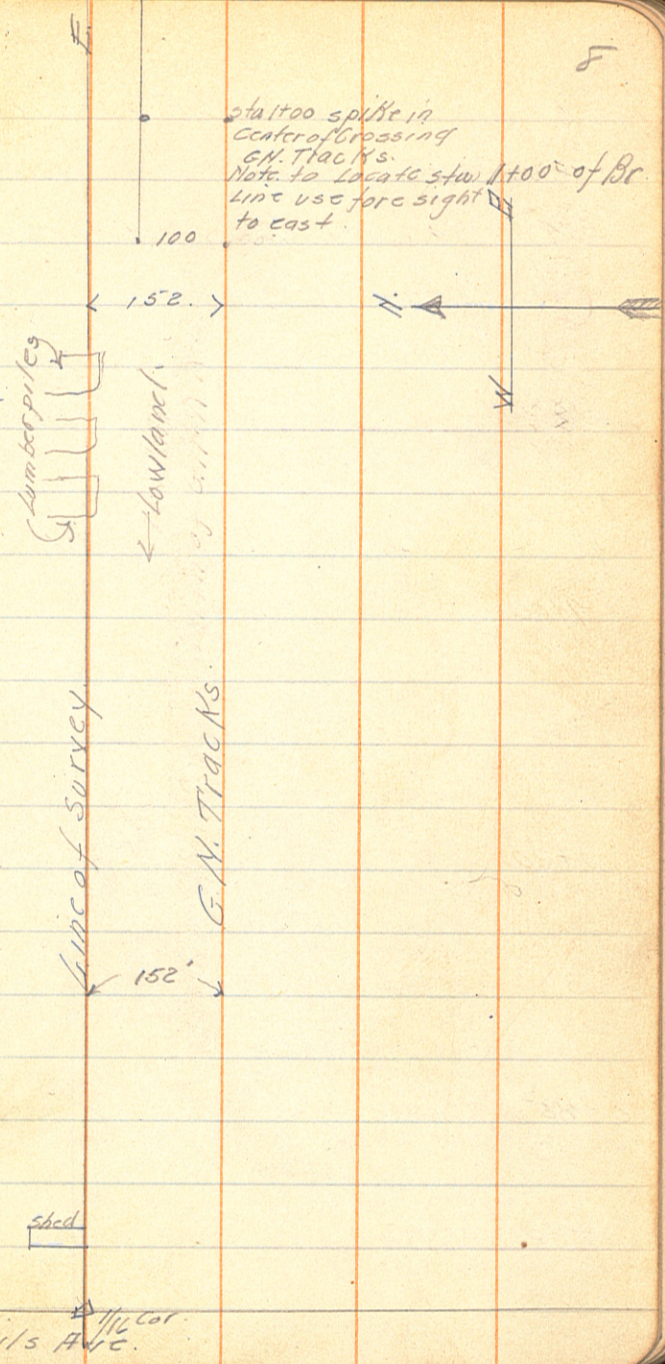

July 19, 1915

Side Ditch, North Side Road.
 00 Being about 300' W of S $\frac{1}{4}$ Cor Sec 29-115-31

Sta	B.S.	H.I.	ROD	F.S.	Elev
BM 00	530	10530	97		100.00 95.4
1		97	94		95.9
2		101	93		94.0
3			98		95.6
4			10.1		95.2
5			10.6		94.7
6			11.1		94.2
7			11.6		93.7
8			11.9		93.4
9			12.4		92.9
T.P.	557	9922		1165	93.65
+60			6.7		92.5
10			6.4		92.8
+110			40		95.2
+50			2.7		96.5
112			3.6		95.6
13			5.2		94.0
14			6.7		92.5
15			7.5		91.7

BM Nail in tele pole 75' R. Sta 2+00

Ground
Elev

Grade
Elev

L & R

3' Bottom 1:15 slope
Area cu yds.

00	00	00	00
15	15	15	15
+0.7	+0.7	+0.3	2.15
2.2		1.8	26.00
+1.5	+3.5	+3.1	26.00
6.0		4.9	57.5
+1.7	+5.0	+1.1	36.10
6.2		5.6	165.7
+1.9	+1.3	+1.9	348.7
6.1		6.4	104.7
+3.8	+3.1	+3.6	21.67
6.3		5.1	62.8
+2.8	+2.0	+2.5	12.28
1.3		4.0	9.84
+2.7	+1.6	+2.1	41.9
4.2		3.6	