

2



MILE POSTS

M. P.	Sta. No.	
26	1477	plus 65
27	1530	" 45
28	1583	" 25
29	1636	" 05
30	1688	" 85
31	1741	" 65
32	1794	" 45
33	1847	" 25
34	1900	" 05
35	1952	" 85
36	2005	" 65
37	2058	" 45
38	2111	" 25
39	2164	" 05
40	2216	" 85
41	2269	" 65
42	2322	" 45
43	2375	" 25
44	2428	" 05
45	2480	" 85
46	2533	" 65
47	2586	" 45
48	2639	" 25
49	2692	" 05
50	2744	" 85

1800 to 1803 + 60
1766 to 1787

1682
73

PROFILE BOOK

Published by

KEUFFEL & ESSER CO.

Drawing Materials

Mathematical and Surveying Instruments

Measuring Tapes.

NEW YORK,
127 Fulton Street.

CHICAGO 68 W. Madison St.
ST. LOUIS 813 Locust St.

General Office and Factories,
HOBOKEN, N. J.

SAN FRANCISCO 48-50 Second St.
MONTREAL 252 Notre Dame St. W.

Sta. 1455-2778.

PROFILE BOOK
No. 2
S.R.H. No. 80

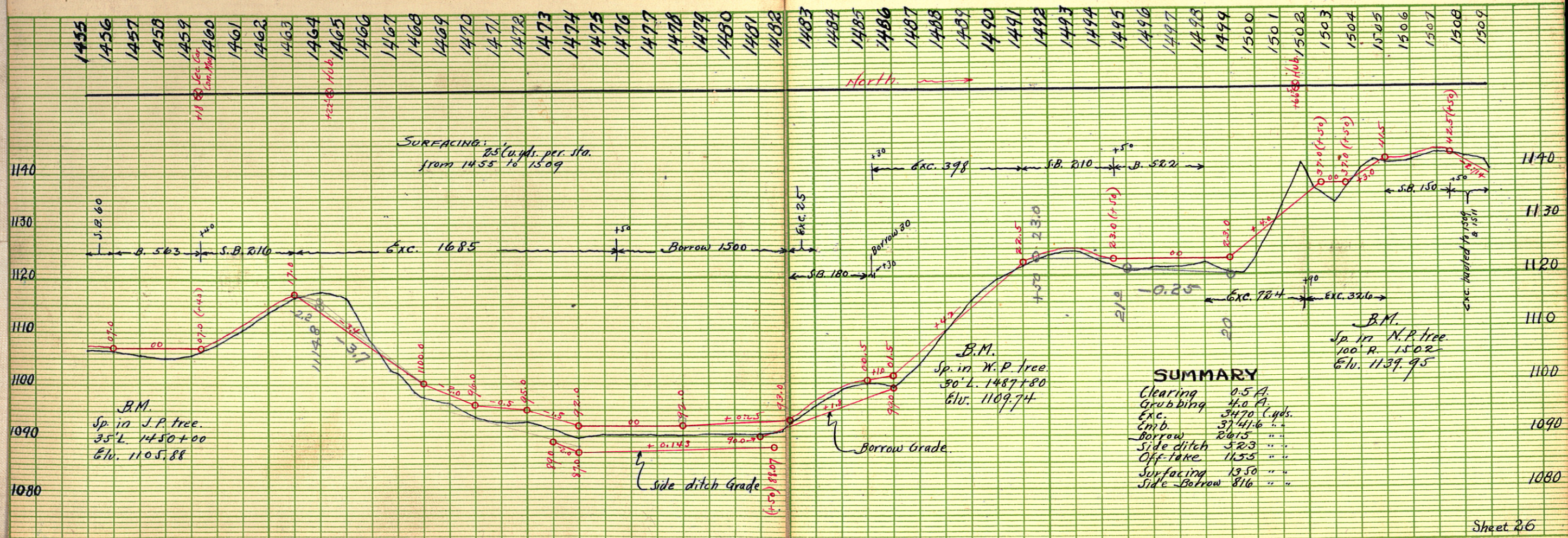

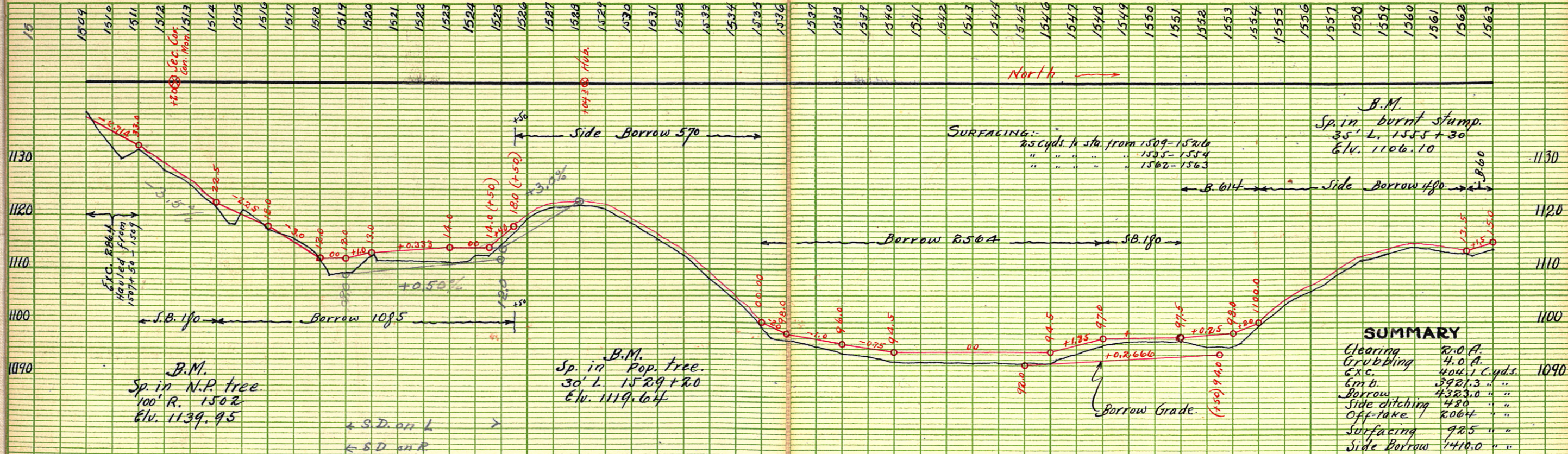

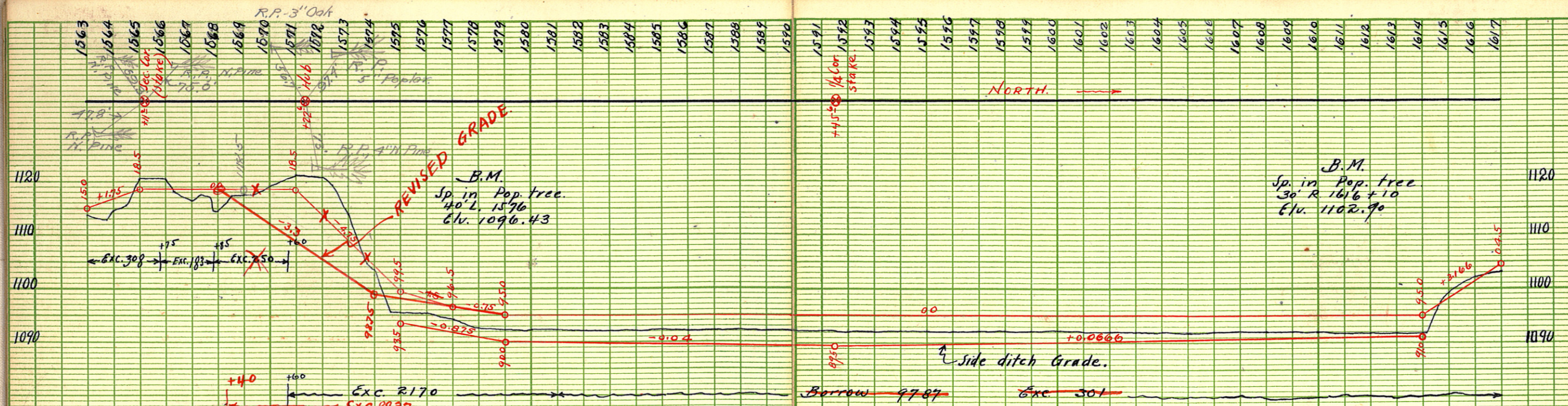

SUMMARY

Clearing	0.5	A
Grub.	1.0	A
Exc.	9210.3	C yds
Emb.	10844.9	"
Borrow	9787.0	"
Surfacing	1550	"
Side ditch	1577	"
Off take	2750	"

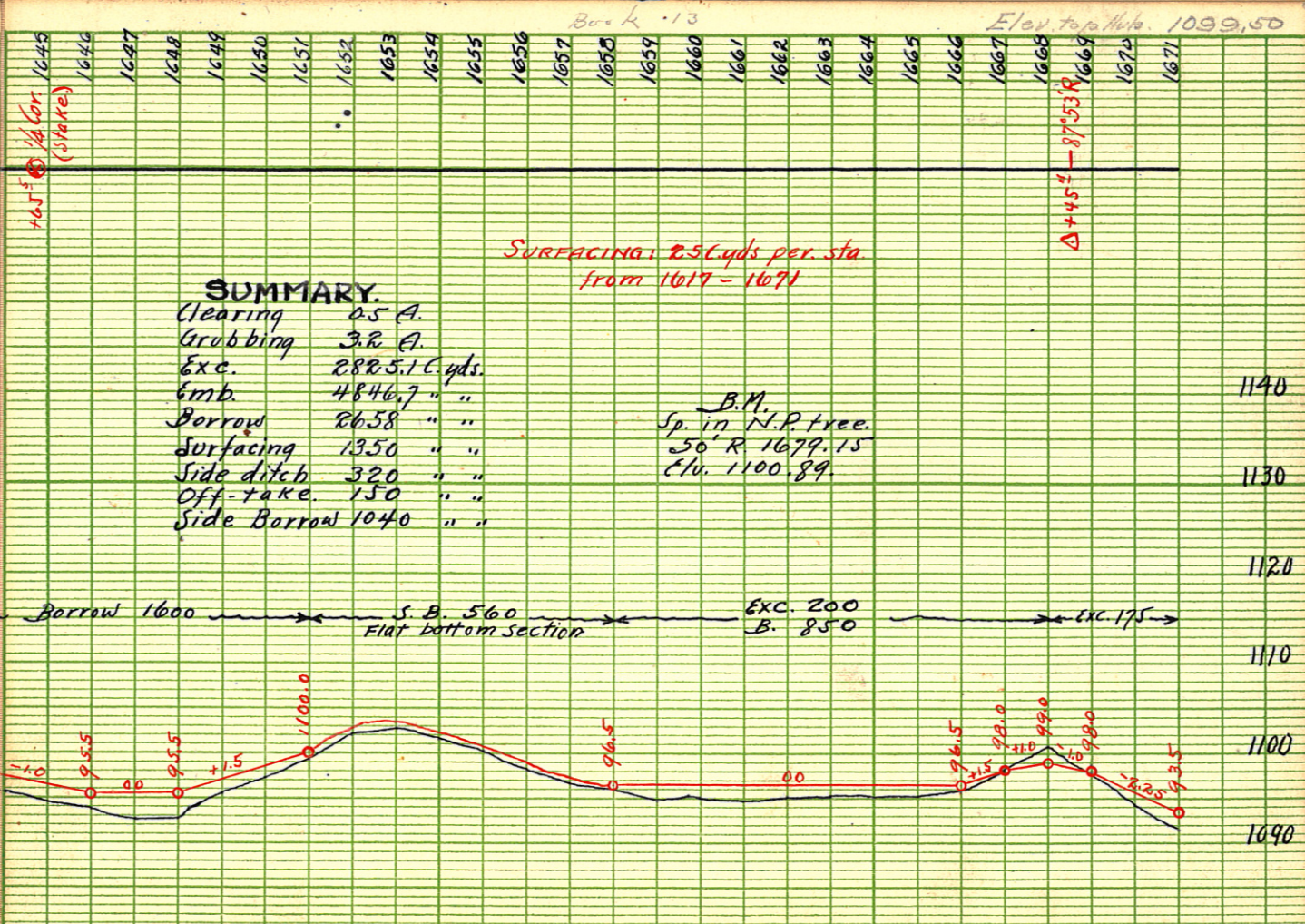
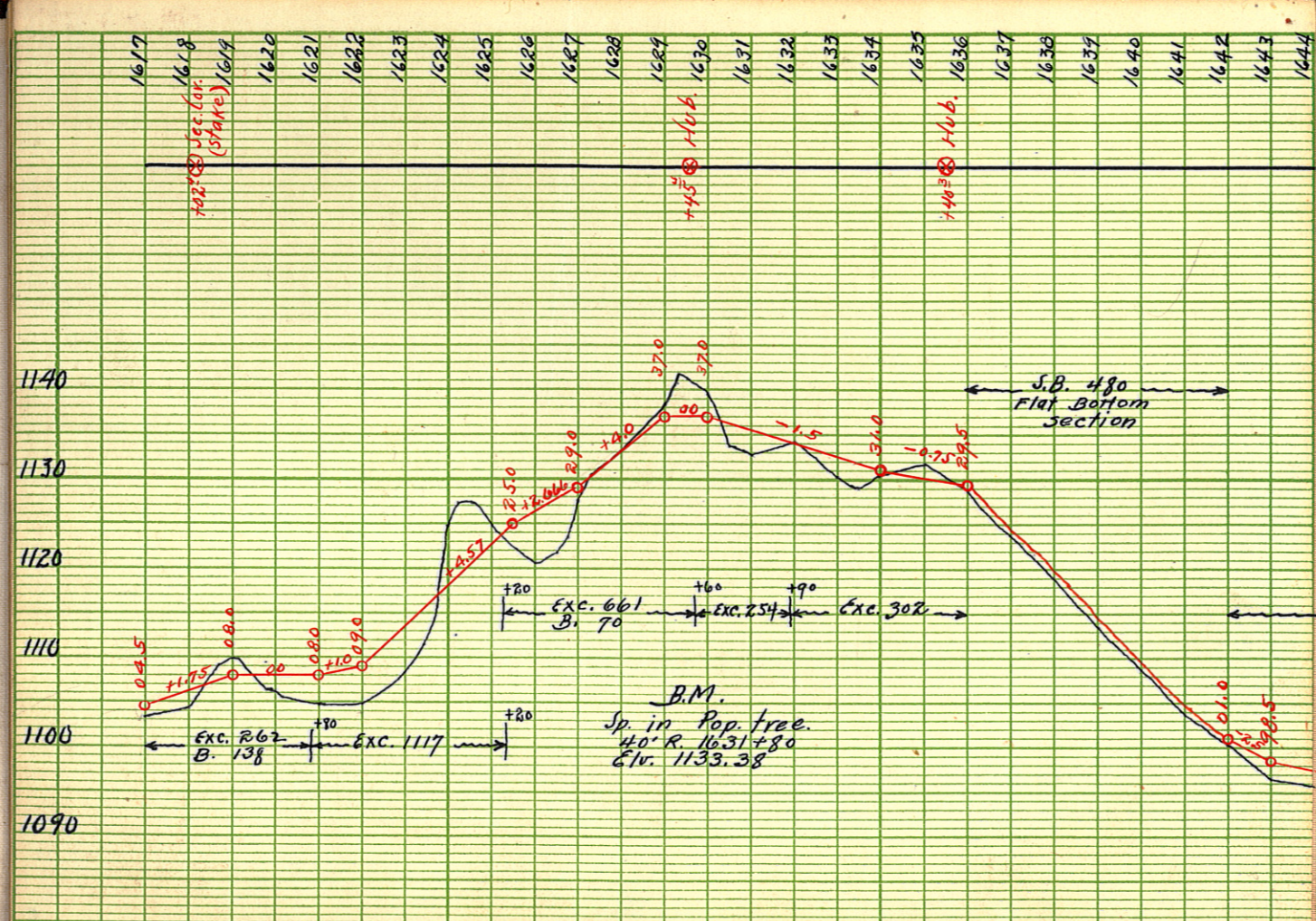

SUMMARY.
 Clearing 0.5 A.
 Grubbing 3.2 A.
 Exc. 2825.1 C. yds.
 Emb. 4846.7 " "
 Borrow 26.58 " "
 Surfacing 13.50 " "
 Side ditch 320 " "
 Off-take 150 " "
 Side Borrow 1040 " "

SURFACING: 2.5 C. yds per sta.
 from 1617 - 1671

B.M.
 Sp. in N.P. tree.
 50' R. 1679.15
 Elev. 1100.89

Book 13 Elev. top of Hike 1099.50

1725
1726
1727
1728
1729
1730
1731
1732
1733
1734
1735
1736
1737
1738
1739
1740
1741
1742
1743
1744
1745
1746
1747
1748
1749
1750
1751
1752

Mill St.

Arling Ave.

Front

Street

9000K
405

9000L
460

1735 464
1736 410
1741 380

VILLAGE OF PINE RIVER.

1753
1754
1755
1756
1757
1758
1759
1760
1761
1762
1763
1764
1765
1766
1767
1768
1769
1770
1771
1772
1773

035L
spike

037R
spike

(P.R. FAIR Grounds.)

M.&I. Ry. Fence = 33' to L of E.

B.M.
Ontop of U.S.G. B.M.
4" pipe about 100' S. of M.&I. Section House, on
West side of track.
No 80 Elev. = 1107.44
U.S. Elev. = 1299.50 above Sea Level.

1773 1774 1775 1776 1777 1778 1779 1780 1781 1782 1783 1784 1785 1786 1787 1788 1789 1790 1791 1792 1793 1794 1795 1796 1797 1798 1799 1800

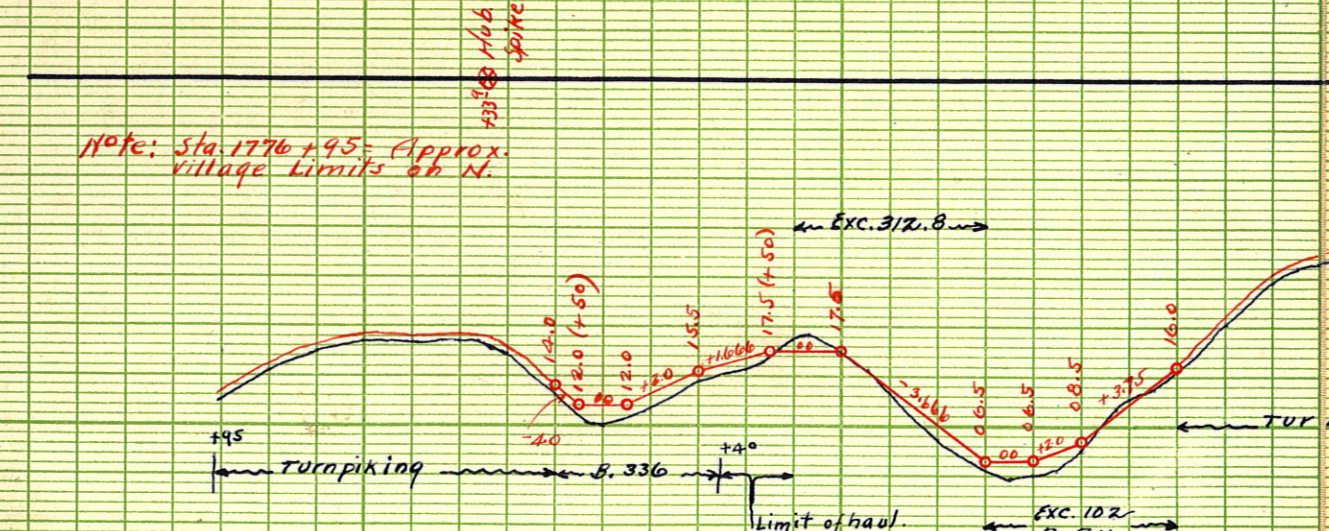

B.M.
Sp. in J.P. Tree.
35' R. 1784+20
Elev. 1113.91

1801 1802 1803 1804 1805 1806 1807 1808 1809 1810 1811 1812 1813 1814 1815 1816 1817 1818 1819 1820 1821 1822 1823 1824 1825 1826 1827

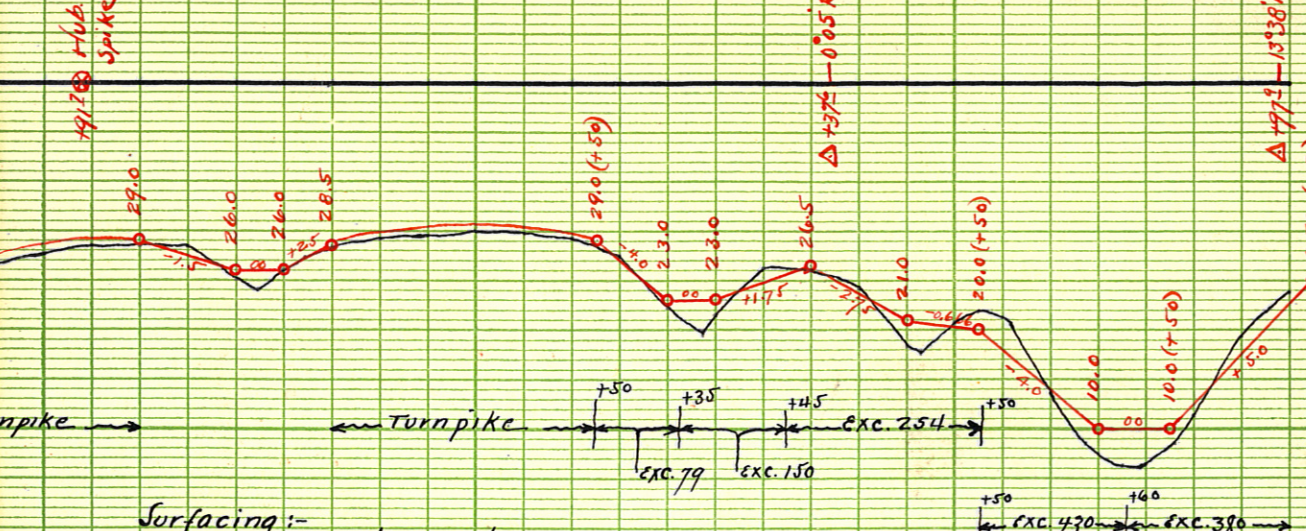

Surfacing:-
25 cyds. per sta.
1784 - 1797
1803 - 1807
1812+50 - 1827

B.M.
Sp. in Tel. pole.
30' R. 1793+90
Elev. 1103.79

B.M.
Sp. in J.P. tree.
30' R. 1820+50
Elev. 1121.94

SUMMARY.

Clearing	1.0 A.
Grubbing	0.5 A.
Exc.	1999.9 C.yds.
Emb.	2233.3 " "
Borrow	547 " "
Surfacing	187.5 " "
Turnpike	1855 Lin. ft.

60.8 Cuds. hauled
from 1827-1827+50
to 1824-1825.

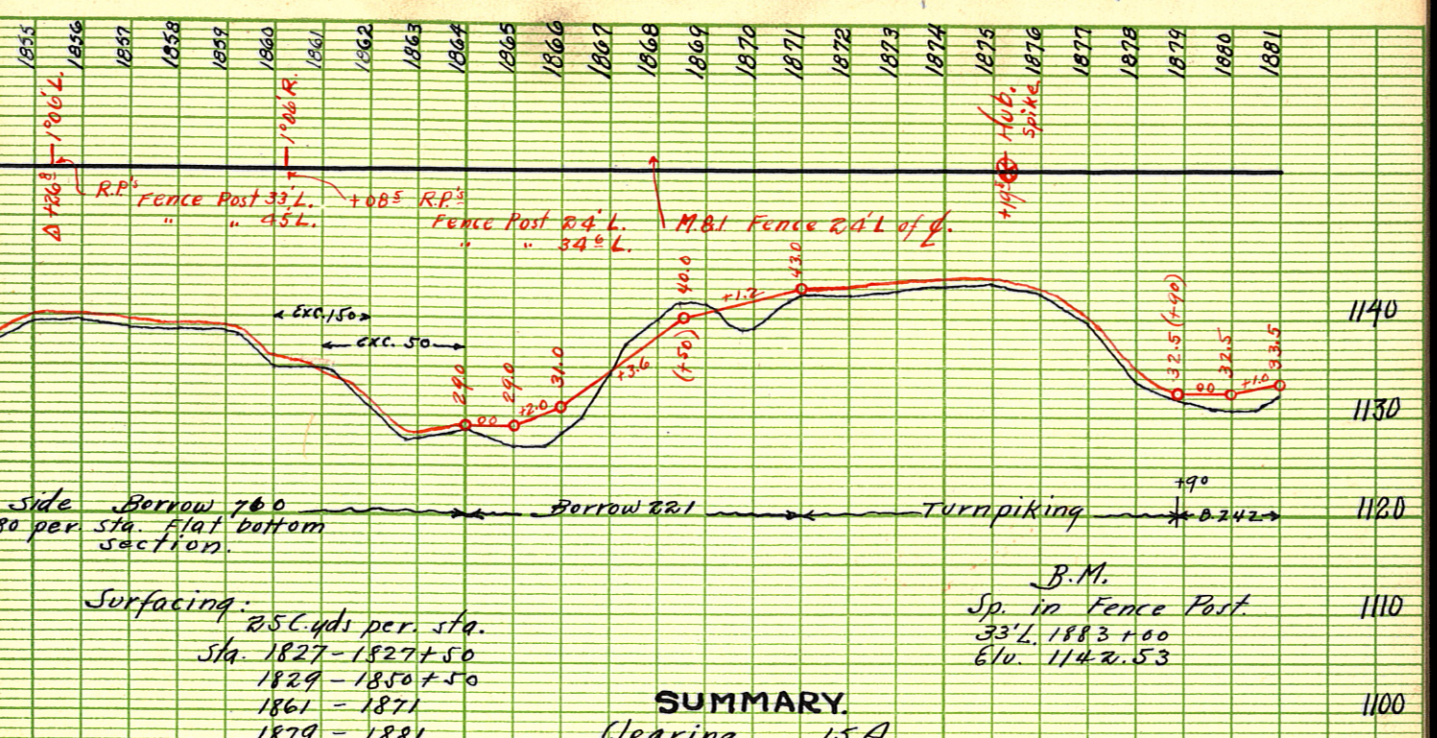
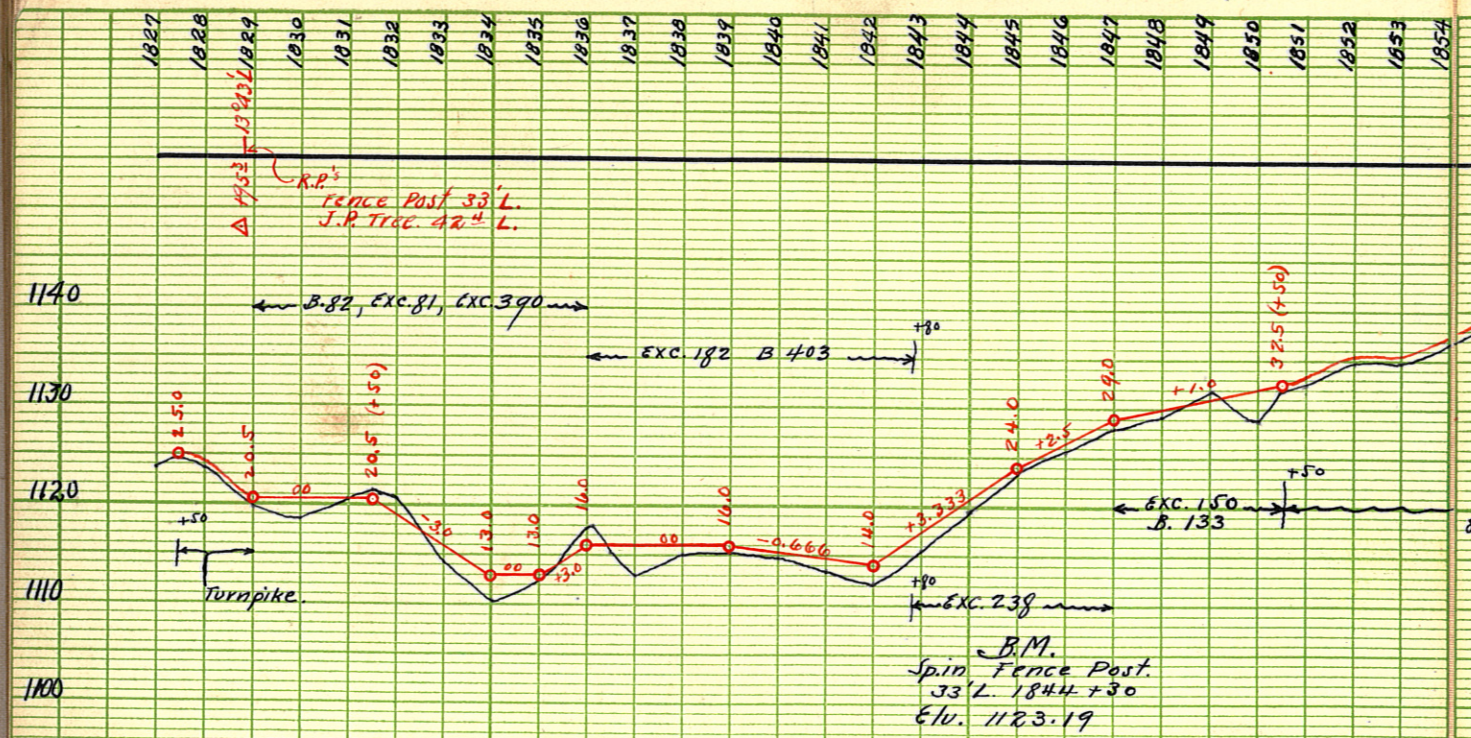

Surfacing:
 25 C. yds per sta.
 Sta. 1827 - 1827 + 50
 1829 - 1850 + 50
 1861 - 1871
 1879 - 1881

SUMMARY.

Clearing	1.5 A.
Grub.	1.0 A.
Exc.	1823.2 C. yds.
Emb.	2297.0 " "
Borrow	1081 " "
Surfacing	850 " "
Side Borrow	760.0 " "
Turnpike	1344 ft.

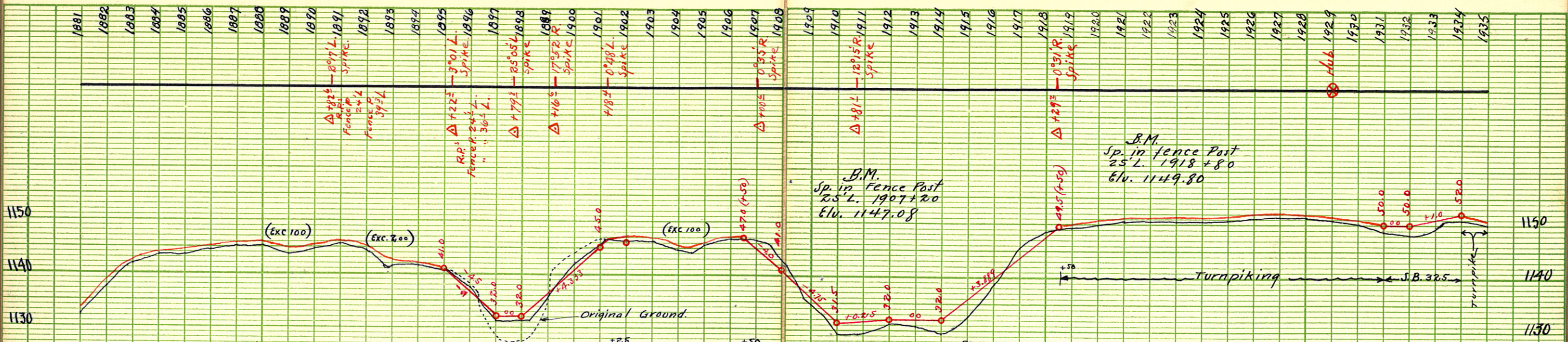

Work from sta 1895-1901+25 was done in 1912.

Surfacing:
 2.5 Cyds. per sta.
 sta. 1895-1901+25
 " 1906+50-1918+50

SUMMARY.

Clearing	00 A.
Grub.	00 A.
Exc.	1975 Cyds.
Emb.	1196.5 " "
Borrow	447 " "
Surfacing	457 " "
Side Borrow	325 " "
Turnpike	3200 ft.

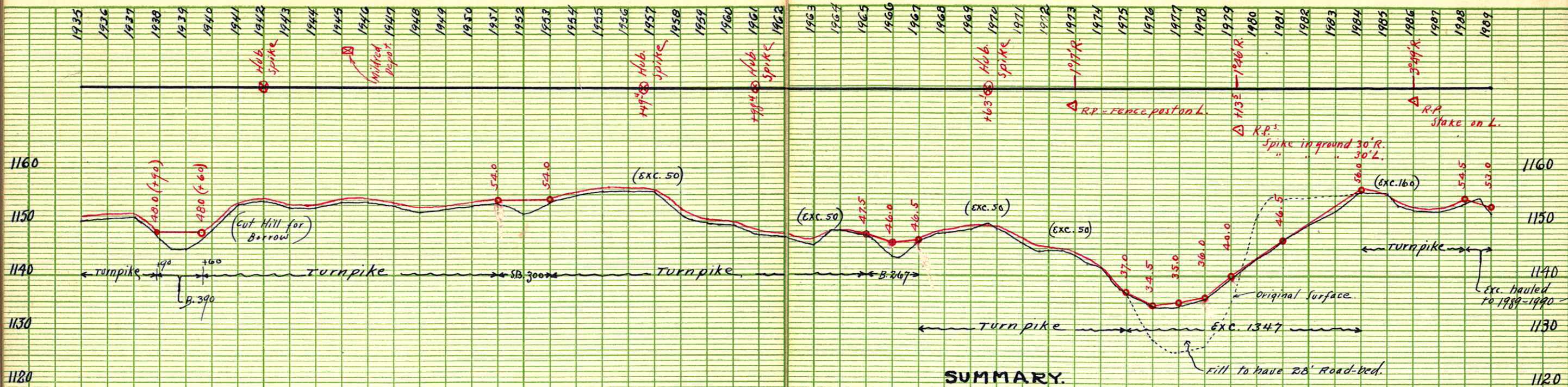

SUMMARY.
 Clearing + grub 00 A.
 Exc. 1793 C. yds.
 Emb. 1542 R. " "
 Borrow 657 " "
 Surfacing 1342.5 " "
 Side Borrow 300 " "
 Turnpike 3590 ft.

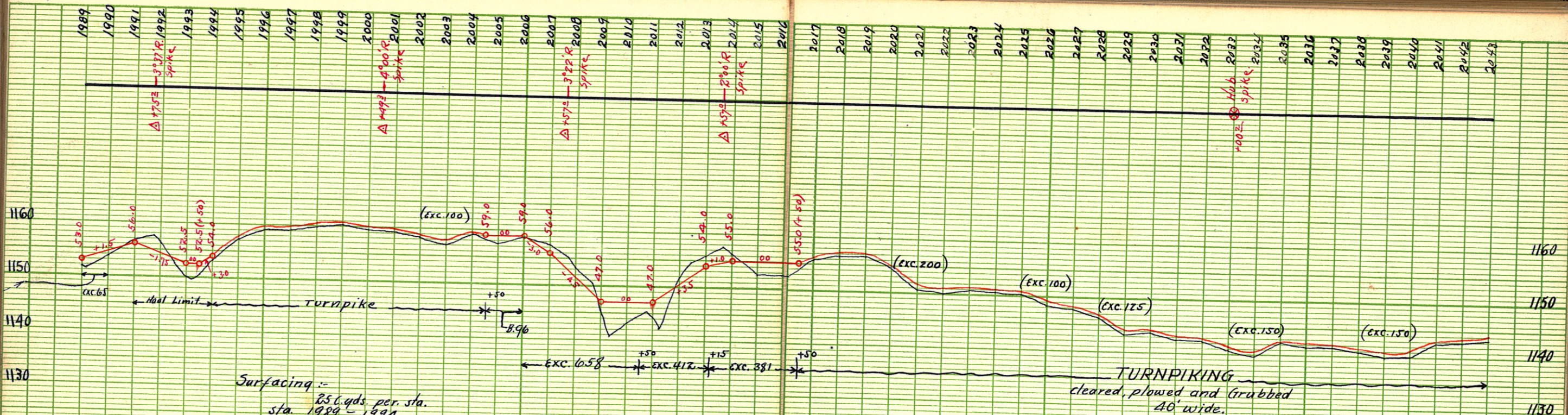

Surfacing :-
 25 c.yds. per sta.
 sta. 1989 - 1994
 2004+50 - 2016+50

B.M.
 Sp. in fence Post.
 25' L. 1983+60
 Elevation 1155.21

B.M.
 Sp. in fence Post.
 25' L. 2004+00
 Elevation 1159.52

SUMMARY

Clearing & Grub.	00 ft.
Exc.	2761.8 C.yds.
Emb.	1749.9 " "
Borrow	96.0 " "
Surfacing	42.5 " "
Turnpike	3700 Lin.ft.

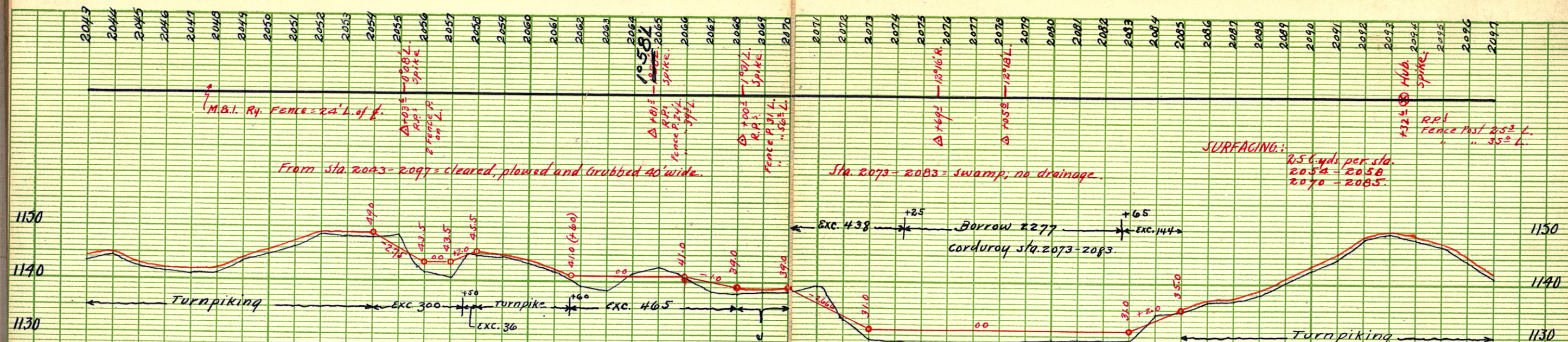

B.M.
Sp. in Fence Post.
25' L. 2032+00
Elev. 1142.56

B.M.
Sp. in fence post.
25' L. 2058+00
Elev. 1145.23

B.M.
Sp. in fence Post.
25' L. 2087+00
Elev. 1137.34

SUMMARY.

Clearing	00A.
Grubbing	0.5A.
Exc.	1682.6 C. yds.
Emb.	2580.4 " "
Borrow	2277 " "
Surfacing	675 " "
Turnpike	2860 ft.
Corduroy	1000 "

5 Δ 0°10' R.

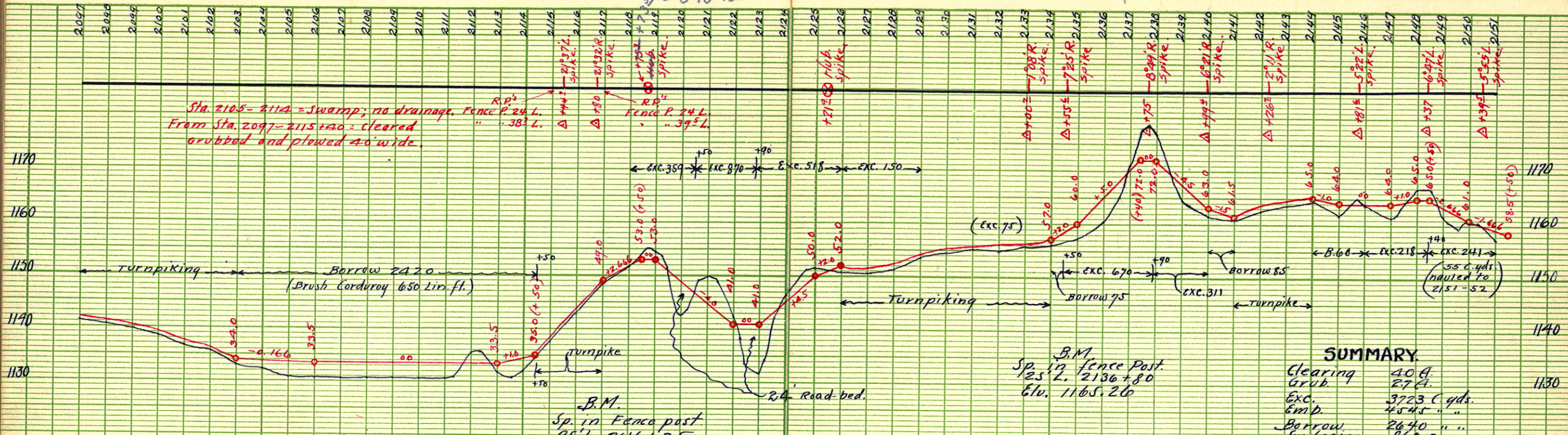

Sta. 2105-2114 = Swamp; no drainage. Fence P. 24 L.
 From Sta. 2097-2115 +40 = cleared
 grubbed and plowed 40 wide.

SURFACING: (if needed)
 2.5 c. yds. per sta.
 Sta. 2103-2114 +50
 2117-2126
 2134-2141
 2144-2151

B.M.
 Sp. in Fence post
 25 L. 2116 + 35
 Elev. 1144.60

B.M.
 Sp. in fence post.
 25 L. 2136 + 80
 Elev. 1165.26

SUMMARY.

Clearing	40 A.
Grub.	27 A.
Exc.	3723 C. yds.
Emp.	454.5 " "
Borrow	2640 " "
Surfacing	862.5 " "
Turnpike	1700 Lin. ft.
Brush Corduroy	650 " "

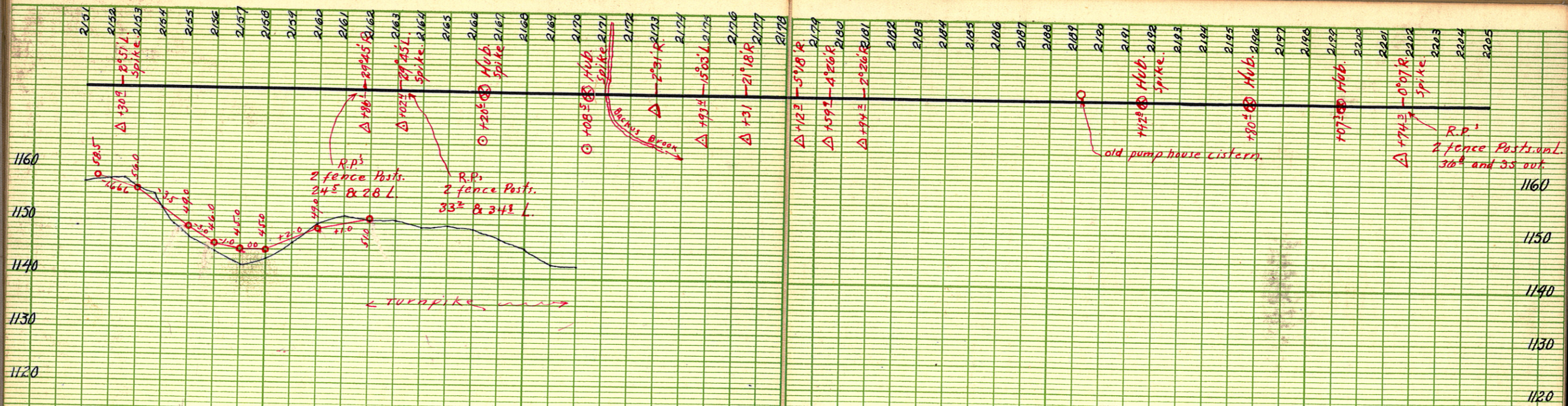

2205
 2206
 2207
 2208
 2209
 2210
 2211
 2212
 2213
 2214
 2215
 2216
 2217
 2218
 2219
 2220
 2221
 2222
 2223
 2224
 2225
 2226
 2227
 2228
 2229
 2230
 2231
 2232
 2233
 2234
 2235
 2236
 2237
 2238
 2239
 2240
 2241
 2242
 2243
 2244
 2245
 2246
 2247
 2248
 2249
 2250
 2251
 2252
 2253
 2254
 2255
 2256
 2257
 2258
 2259

1150
1140

1150
1140

10

B.M.
 Sp. in fence Post.
 35' L. 2208+20
 Elevation 1149.98

B.M.
 Sp. in Tel pole
 30' L. 2253+00
 Elevation 1150.91

Δ 193' - 92' 24" R.
 Δ 444' - 70' 30" L.
 spikes

Δ 116' - 0' 34" L.
 Spike

spikes.
 Δ 429' - 40' 42" L.
 Δ 29' - 42' 18" R.
 R.P.s.
 Tel. pole 16' L.
 Tack in N-W Cor. of
 Cor. Building on R.
 35' R.

just on N. edge of
 side walk Xing.
 33' to L. of E. Building
 Line on front St. Backus.

Hub Spike

Δ 116' - 0' 22" L.
 Spike

Hub Spike

M.B.I. Ry. Fence = 33' L.

+975

TURNPIRING

Sta. 2241+975 = N. Limits of
 Backus, Minn.

2259 2260 2261 2262 2263 2264 2265 2266 2267 2268 2269 2270 2271 2272 2273 2274 2275 2276 2277 2278 2279 2280 2281 2282 2283 2284 2285 2286

⊙ +2810 Hub
spike

1150
1140

← exc. 100 →

← TURNPIKING → Side Borrow 360
60 per sta.

TURNPIKING

B.M.
Sp. in tel. pole
35' L. 2280+00
Elev. 1151.10

SURFACING. (if needed)
20 C. yds. per sta.
on this sheet.

2287 2288 2289 2290 2291 2292 2293 2294 2295 2296 2297 2298 2299 2300 2301 2302 2303 2304 2305 2306 2307 2308 2309 2310 2311 2312 2313

⊙ +2810 Hub
spike

1150
1140

← exc. 200 → +50

+50
SB 420
60 per sta.

+50
Turnpike

SUMMARY.
Grubbing 1.0 A.
Turnpike 4100 ft.
Surfacing 1080 C. yds.
Exc. 300 " "
Side Borrow 780 " "

B.M.
Sp. in fence Post
33' L. 2304+70
Elev. 1154.48

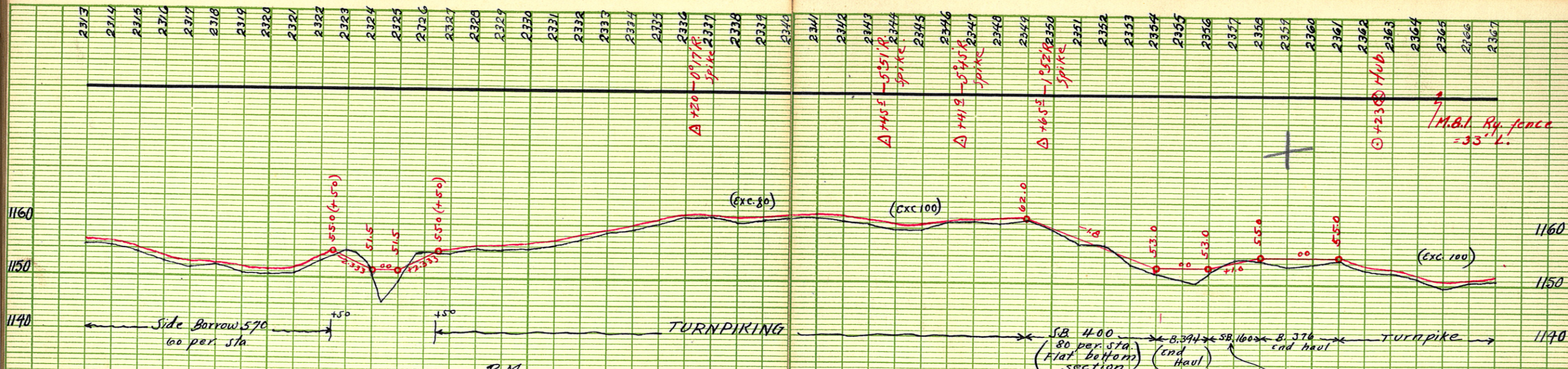

SURFACING (if needed)
 20 C. yds. per sta.
 on this sheet.

B.M.
 Sp. in fence Post.
 33' L. 2328+00
 Elev. 1155.37

SUMMARY

Clearing	2.0 A.
Grubbing	2.0 A.
Exc.	694.96 yds.
Emb.	337.5 "
Surfacing	1080 "
Borrow	770 "
Side borrow	1130 "
Turnpike	2850 lin ft.

B.M.
 Sp. in fence P.
 33' L. 2362+70
 Elev. 1153.30

80 per. sta.
 Flat bottom
 section

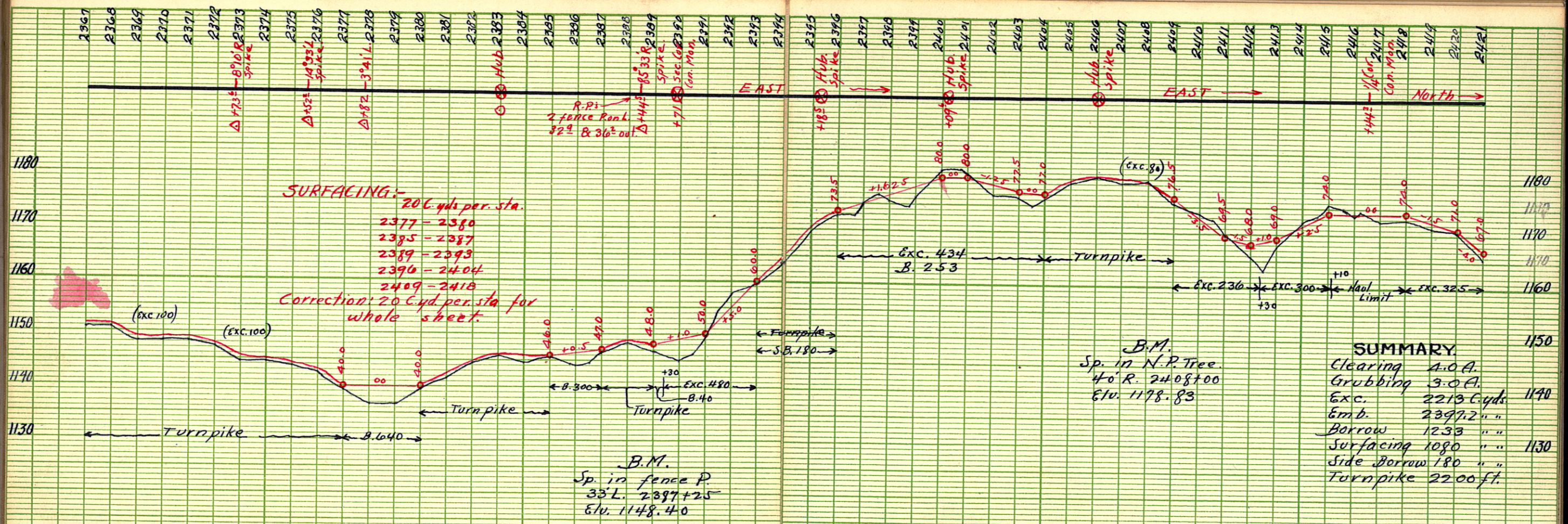

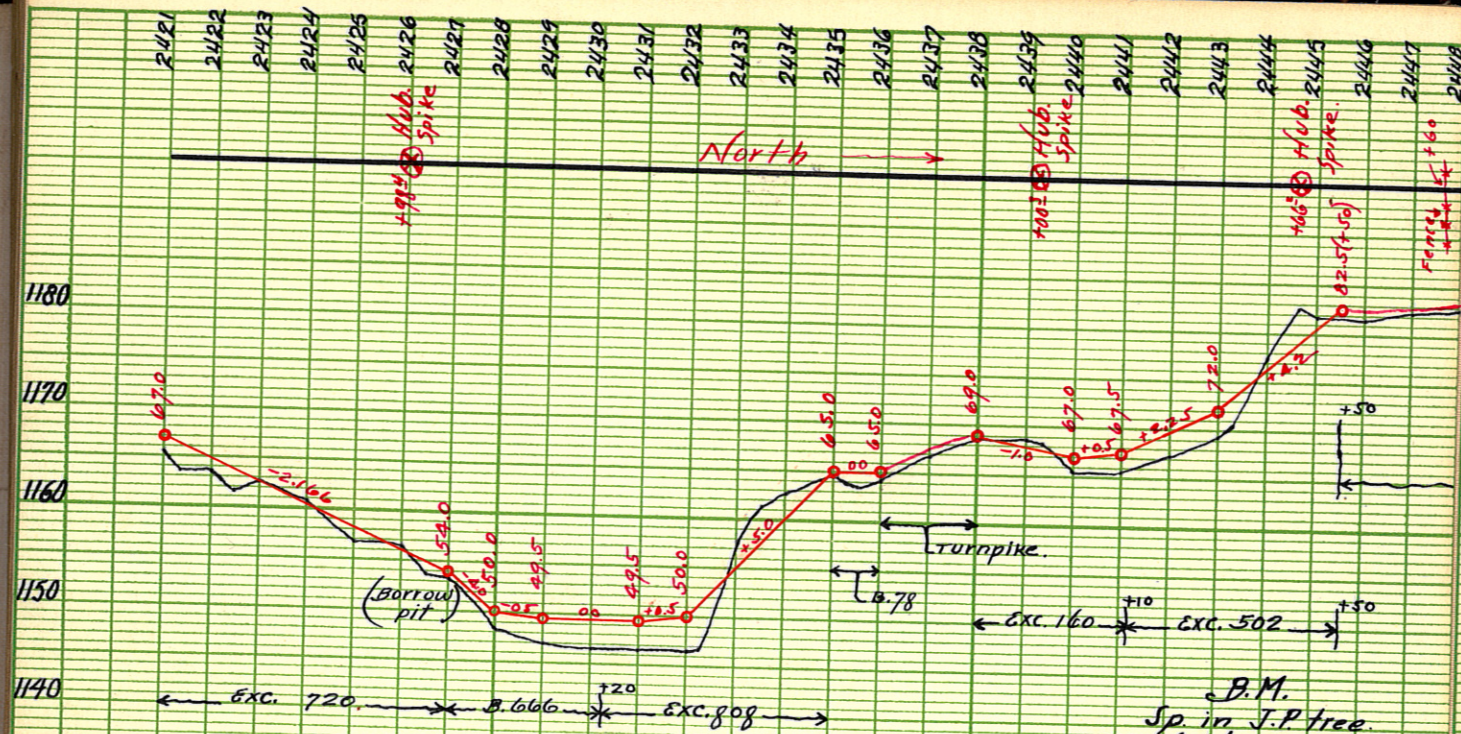

B.M.
Sp. in J.P. tree.
50 R. 2424 + 80
Elev. 1158.34

SURFACING:
20 C. yds. per sta
on this sheet.

B.M.
Sp. in J.P. tree.
40 L. 2443 + 85
Elev. 1178.80

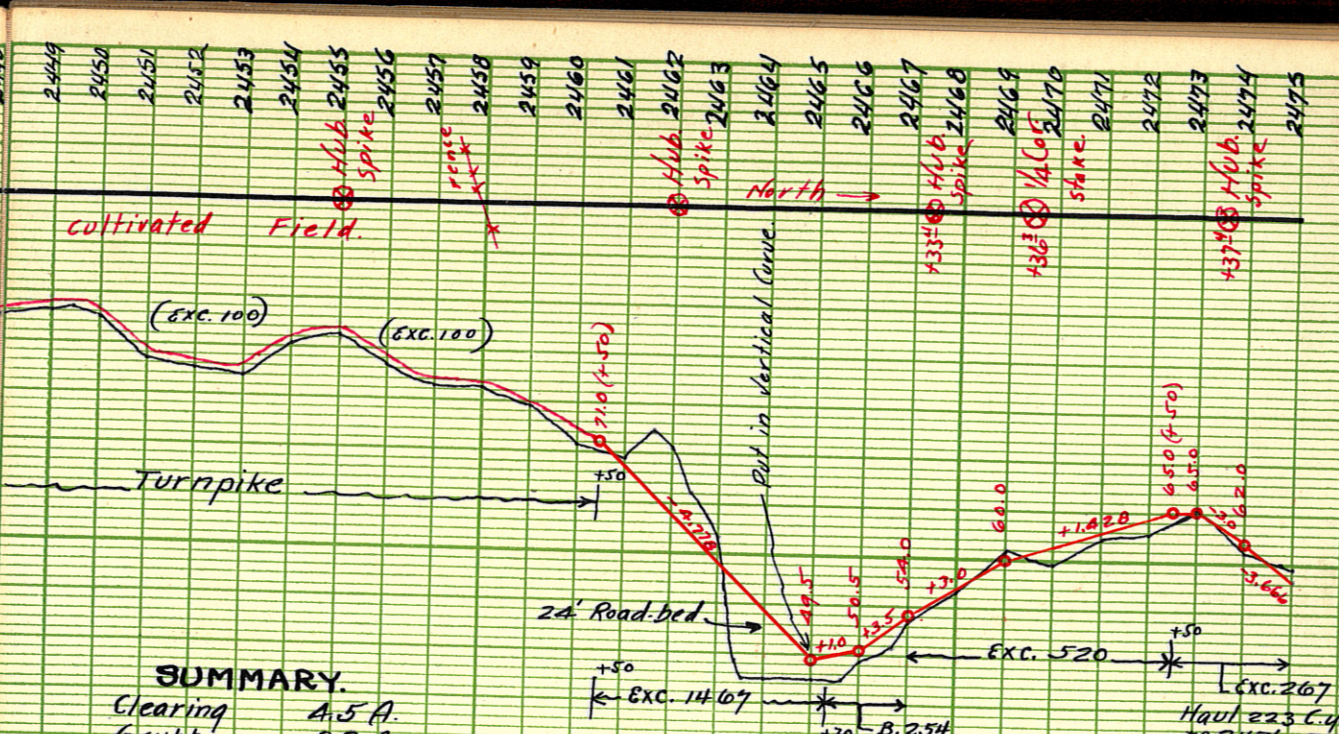

SUMMARY.

Clearing	4.5 A.
Grubbing	3.2 A.
Exc.	4645 C. yds.
Emb.	3472.3 " "
Borrow	998 " "
Surfacing	1080 " "
Turnpike	1700 ft.

B.M.
Sp. in J.P. tree
40 L. 2466 + 20
Elev. 1151.22

Exc. 267
Haul 23 C. yds.
to 2476-77

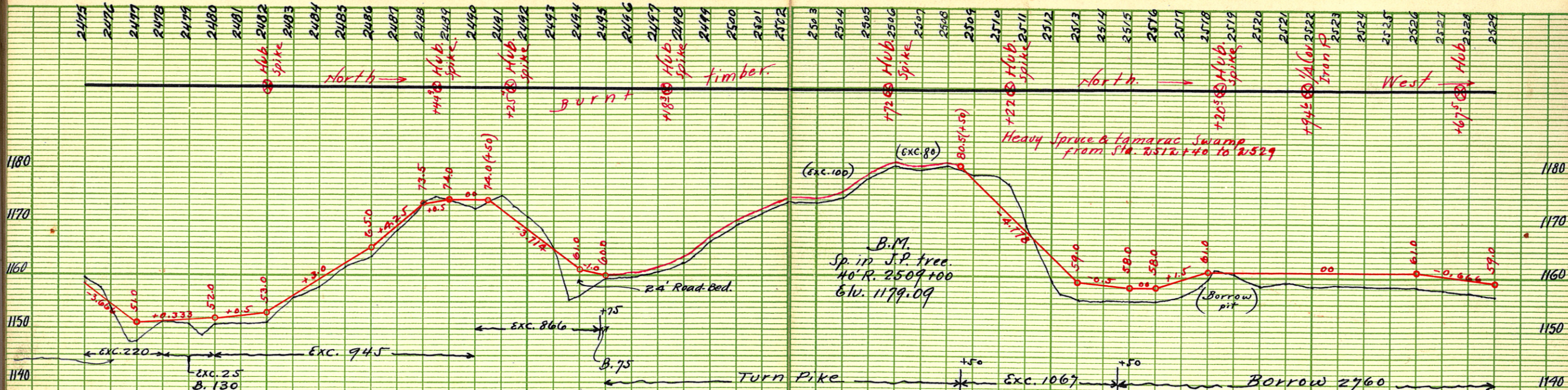

Surfacing: (if needed)
 20 Cys. per sta
 2475-2495
 2508+50-2529

SUMMARY.

Clearing	5.5A.
Grubbing	3.7A.
Exc.	3371.6 C.yds.
Emb.	5553.4 " "
Borrow	2965 " "
Surfacing	810 " "
Side ditch	870 " "
Off-take	460 " "
Turn pike	1350 " "

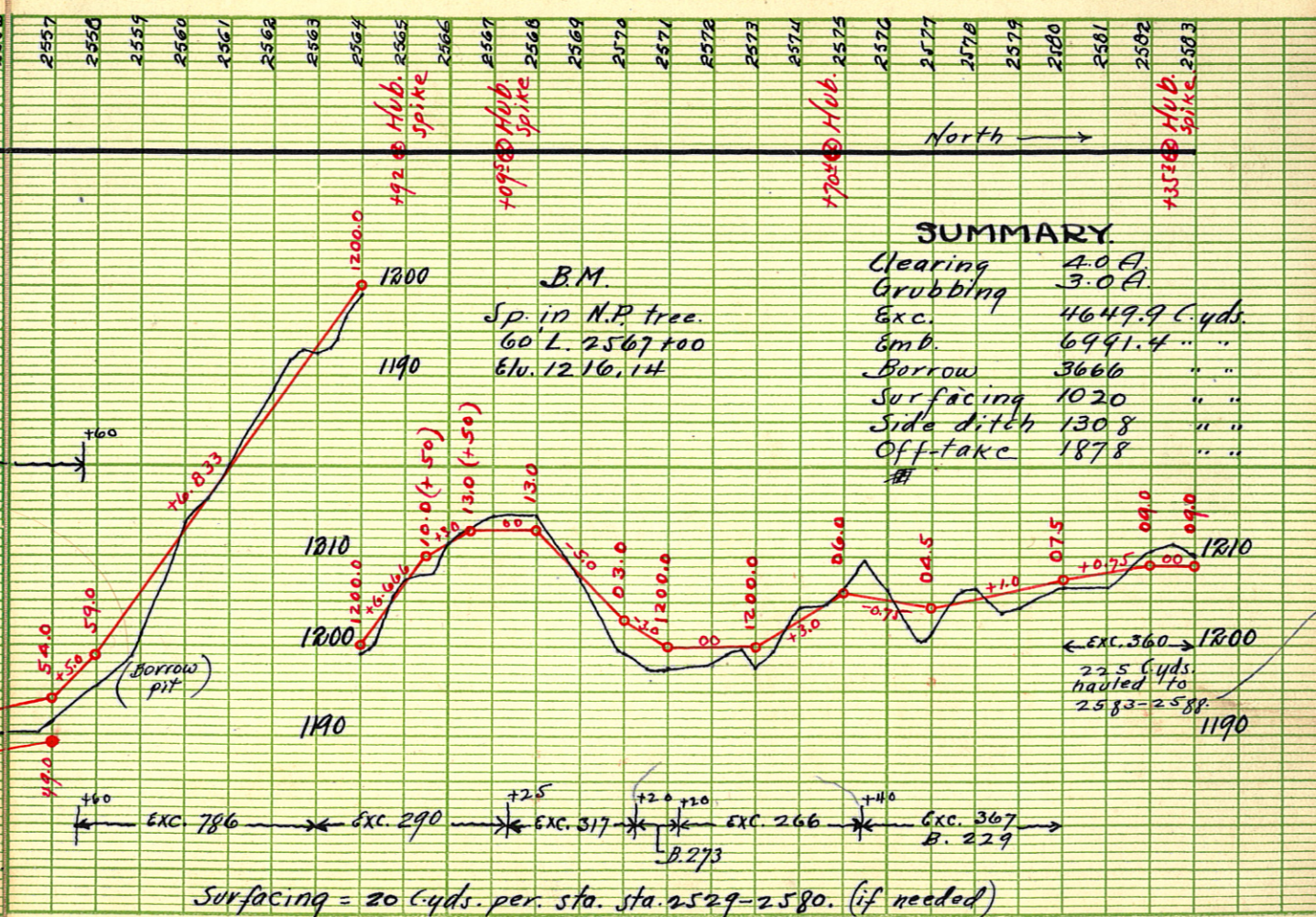
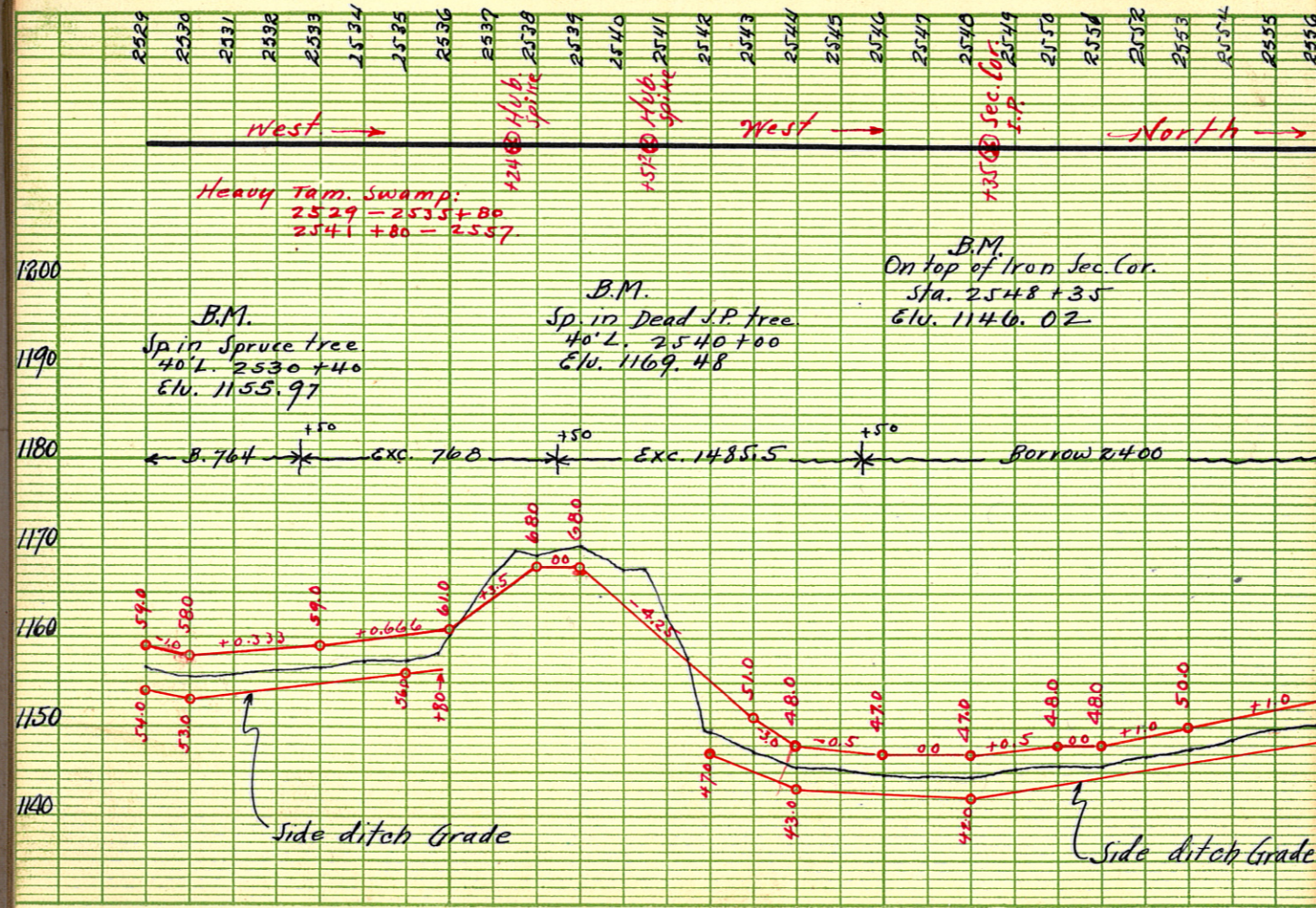

SUMMARY

Clearing	4.0 A.
Grubbing	3.0 A.
Exc.	4649.9 C. yds.
Emb.	6991.4 " "
Borrow	3666 " "
Surfacing	1020 " "
Side ditch	1308 " "
Off-take	1878 " "

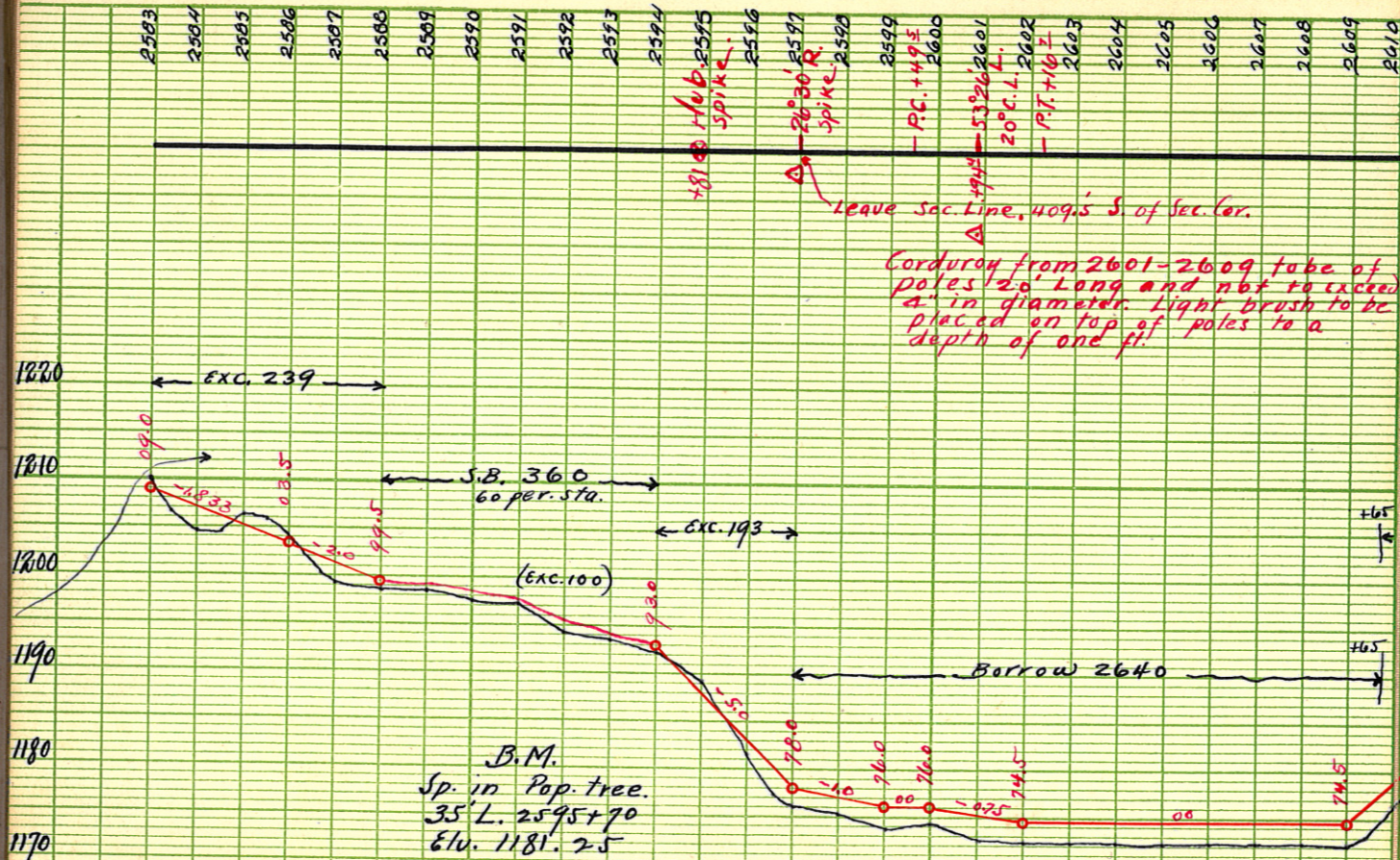

Leave Sec. Line, 409's S. of Sec. Cor.

Corduroy from 2601-2609 tube of poles 20' Long and not to exceed 4" in diameter. Light brush to be placed on top of poles to a depth of one ft.

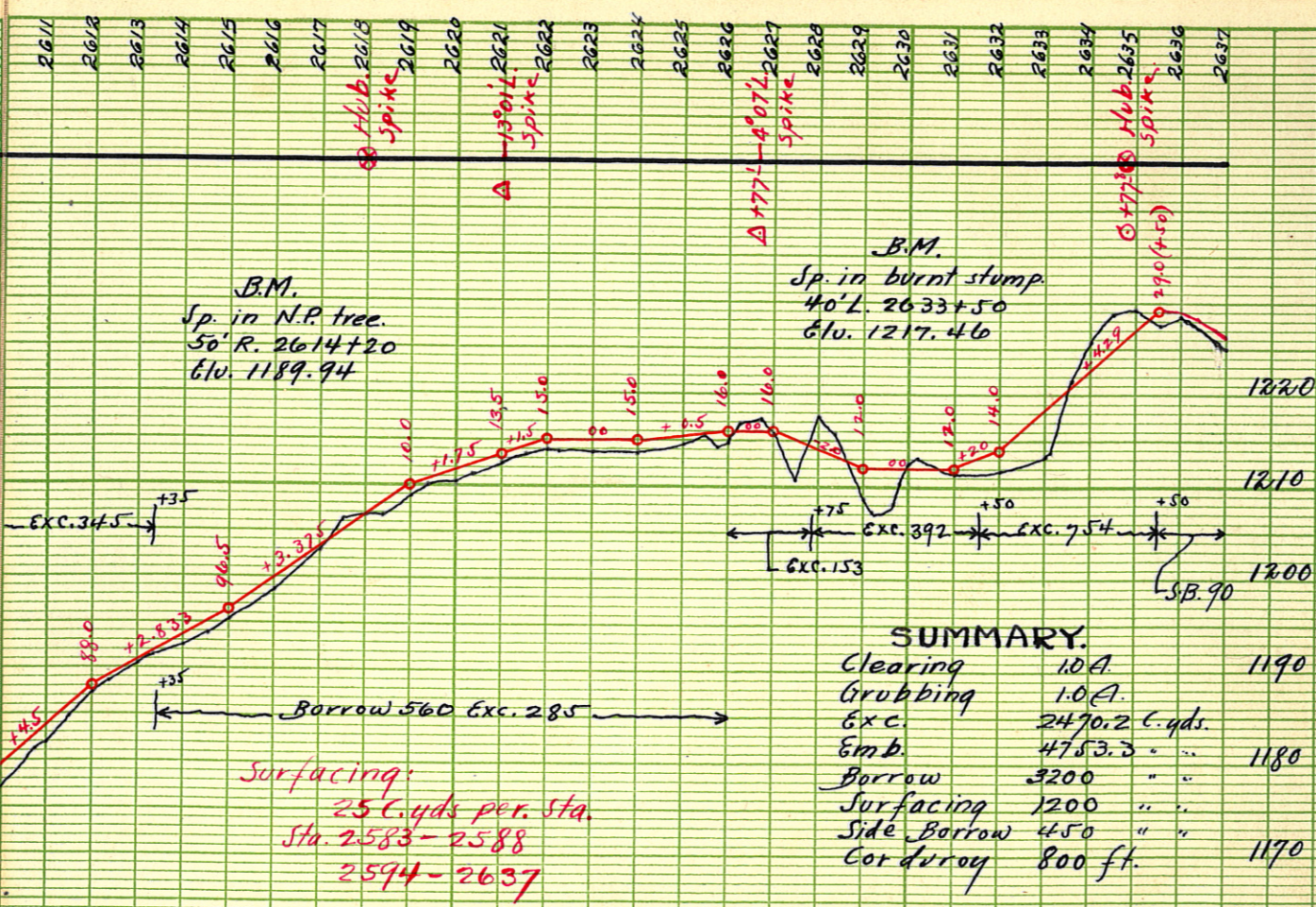

B.M.
Sp. in N.P. tree.
50' R. 2614+20
Elev. 1189.94

B.M.
Sp. in burnt stump
40' L. 2633+50
Elev. 1217.46

SUMMARY.

Clearing	10 A.	1190
Grubbing	1.0 A.	
Exc.	2470.2 C. yds.	
Emb.	4753.3 " "	1180
Borrow	3200 " "	
Surfacing	1200 " "	
Side Borrow	450 " "	
Corduroy	800 ft.	1170

#47

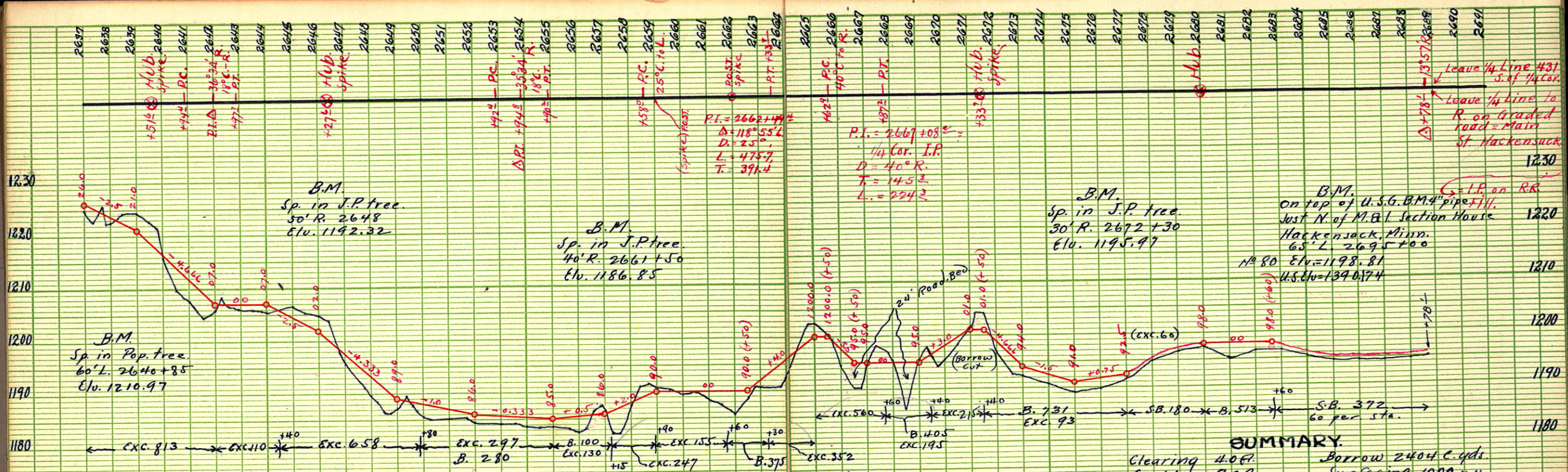

Surfacing: 25 Cys. per Sta.
2637 - 2677

SUMMARY.

Clearing	4.0 ft.	Borrow	2404 C. yds.
Grubbing	2.0 ft.	Surfacing	1000 " "
Exc.	3824.9 Cys.	Side Borrow	552 " "
Emb.	4957.1 " "	Guard Rail	2000 ft.

2691
 2692
 2693
 2694
 2695
 2696
 2697
 2698
 2699
 2700
 2701
 2702
 2703
 2704
 2705
 2706
 2707
 2708
 2709
 2710
 2711
 2712
 2713
 2714
 2715
 2716
 2717
 2718
 2719
 2720
 2721
 2722
 2723
 2724
 2725
 2726
 2727
 2728

M.A. Depot.

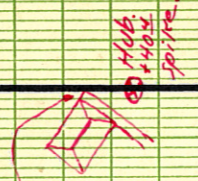

Line just misses corner of side walk in front of Hackensack P.O.

4302 - 1945 L. spike.

+ 34 - 10174 L. spike.

VILLAGE OF HACKENSACK.
MINNESOTA.

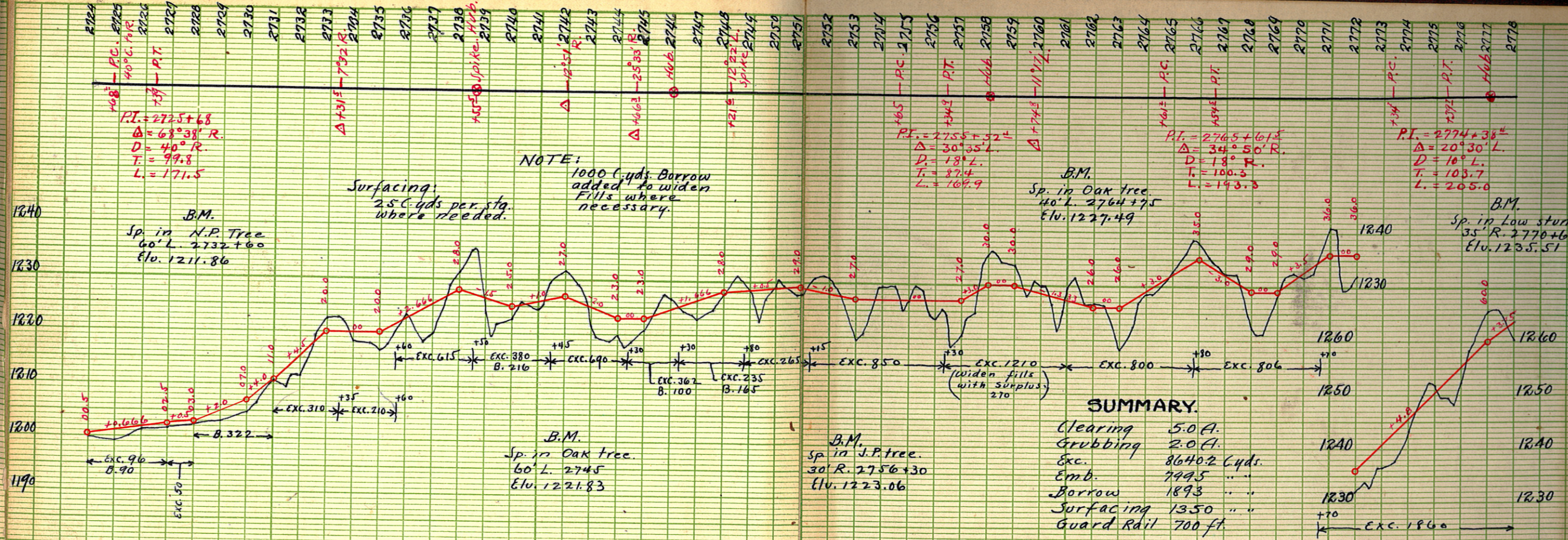

NOTE:
1000 C. yds. Borrow
added to widen
Fills where
necessary.

Surfacing:
25 C. yds per sta.
where needed.

SUMMARY.

Clearing	5.0 A.
Grubbing	2.0 A.
Exc.	8640.2 C. yds.
Emb.	7995 " "
Borrow	1893 " "
Surfacing	1350 " "
Guard Rail	700 ft.