

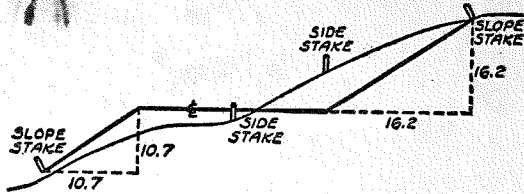

II

OK

HARCO  
II  
FIELD BOOK



DISTANCES FROM SIDE STAKES FOR CROSS-SECTIONING  
SLOPE 1 TO 1. ROADWAY OF ANY WIDTH

	0	.1	.2	.3	.4	.5	.6	.7	.8	.9	
0	0.00	0.10	0.20	0.30	0.40	0.50	0.60	0.70	0.80	0.90	0
1	1.00	1.10	1.20	1.30	1.40	1.50	1.60	1.70	1.80	1.90	1
2	2.00	2.10	2.20	2.30	2.40	2.50	2.60	2.70	2.80	2.90	2
3	3.00	3.10	3.20	3.30	3.40	3.50	3.60	3.70	3.80	3.90	3
4	4.00	4.10	4.20	4.30	4.40	4.50	4.60	4.70	4.80	4.90	4
5	5.00	5.10	5.20	5.30	5.40	5.50	5.60	5.70	5.80	5.90	5
6	6.00	6.10	6.20	6.30	6.40	6.50	6.60	6.70	6.80	6.90	6
7	7.00	7.10	7.20	7.30	7.40	7.50	7.60	7.70	7.80	7.90	7
8	8.00	8.10	8.20	8.30	8.40	8.50	8.60	8.70	8.80	8.90	8
9	9.00	9.10	9.20	9.30	9.40	9.50	9.60	9.70	9.80	9.90	9
10	10.00	10.10	10.20	10.30	10.40	10.50	10.60	10.70	10.80	10.90	10
11	11.00	11.10	11.20	11.30	11.40	11.50	11.60	11.70	11.80	11.90	11
12	12.00	12.10	12.20	12.30	12.40	12.50	12.60	12.70	12.80	12.90	12
13	13.00	13.10	13.20	13.30	13.40	13.50	13.60	13.70	13.80	13.90	13
14	14.00	14.10	14.20	14.30	14.40	14.50	14.60	14.70	14.80	14.90	14
15	15.00	15.10	15.20	15.30	15.40	15.50	15.60	15.70	15.80	15.90	15
16	16.00	16.10	16.20	16.30	16.40	16.50	16.60	16.70	16.80	16.90	16
17	17.00	17.10	17.20	17.30	17.40	17.50	17.60	17.70	17.80	17.90	17
18	18.00	18.10	18.20	18.30	18.40	18.50	18.60	18.70	18.80	18.90	18
19	19.00	19.10	19.20	19.30	19.40	19.50	19.60	19.70	19.80	19.90	19
20	20.00	20.10	20.20	20.30	20.40	20.50	20.60	20.70	20.80	20.90	20
21	21.00	21.10	21.20	21.30	21.40	21.50	21.60	21.70	21.80	21.90	21
22	22.00	22.10	22.20	22.30	22.40	22.50	22.60	22.70	22.80	22.90	22
23	23.00	23.10	23.20	23.30	23.40	23.50	23.60	23.70	23.80	23.90	23
24	24.00	24.10	24.20	24.30	24.40	24.50	24.60	24.70	24.80	24.90	24
25	25.00	25.10	25.20	25.30	25.40	25.50	25.60	25.70	25.80	25.90	25
26	26.00	26.10	26.20	26.30	26.40	26.50	26.60	26.70	26.80	26.90	26
27	27.00	27.10	27.20	27.30	27.40	27.50	27.60	27.70	27.80	27.90	27
28	28.00	28.10	28.20	28.30	28.40	28.50	28.60	28.70	28.80	28.90	28
29	29.00	29.10	29.20	29.30	29.40	29.50	29.60	29.70	29.80	29.90	29
30	30.00	30.10	30.20	30.30	30.40	30.50	30.60	30.70	30.80	30.90	30
31	31.00	31.10	31.20	31.30	31.40	31.50	31.60	31.70	31.80	31.90	31
32	32.00	32.10	32.20	32.30	32.40	32.50	32.60	32.70	32.80	32.90	32
33	33.00	33.10	33.20	33.30	33.40	33.50	33.60	33.70	33.80	33.90	33
34	34.00	34.10	34.20	34.30	34.40	34.50	34.60	34.70	34.80	34.90	34
35	35.00	35.10	35.20	35.30	35.40	35.50	35.60	35.70	35.80	35.90	35
36	36.00	36.10	36.20	36.30	36.40	36.50	36.60	36.70	36.80	36.90	36
37	37.00	37.10	37.20	37.30	37.40	37.50	37.60	37.70	37.80	37.90	37
38	38.00	38.10	38.20	38.30	38.40	38.50	38.60	38.70	38.80	38.90	38
39	39.00	39.10	39.20	39.30	39.40	39.50	39.60	39.70	39.80	39.90	39
40	40.00	40.10	40.20	40.30	40.40	40.50	40.60	40.70	40.80	40.90	40
41	41.00	41.10	41.20	41.30	41.40	41.50	41.60	41.70	41.80	41.90	41
42	42.00	42.10	42.20	42.30	42.40	42.50	42.60	42.70	42.80	42.90	42
43	43.00	43.10	43.20	43.30	43.40	43.50	43.60	43.70	43.80	43.90	43
44	44.00	44.10	44.20	44.30	44.40	44.50	44.60	44.70	44.80	44.90	44
45	45.00	45.10	45.20	45.30	45.40	45.50	45.60	45.70	45.80	45.90	45
46	46.00	46.10	46.20	46.30	46.40	46.50	46.60	46.70	46.80	46.90	46
47	47.00	47.10	47.20	47.30	47.40	47.50	47.60	47.70	47.80	47.90	47
48	48.00	48.10	48.20	48.30	48.40	48.50	48.60	48.70	48.80	48.90	48
49	49.00	49.10	49.20	49.30	49.40	49.50	49.60	49.70	49.80	49.90	49
50	50.00	50.10	50.20	50.30	50.40	50.50	50.60	50.70	50.80	50.90	50

Distance of slope stake from side or shoulder stake for any width roadway, slope 1 to 1. If ground is nearly level, the cut or fill at side stake is located by the double entry method in left column and top row. The number in body of table in same row and column gives distance from side stake to slope stake. If ground is not level estimate the difference in elevation between the side stake and slope stake, lower target by this amount if cut, elevate if fill. Add this amount to cut or fill and find distance in table. Set up rod at this point, and line of sight should cut target. If it does not make the slight adjustment necessary.



Book #4

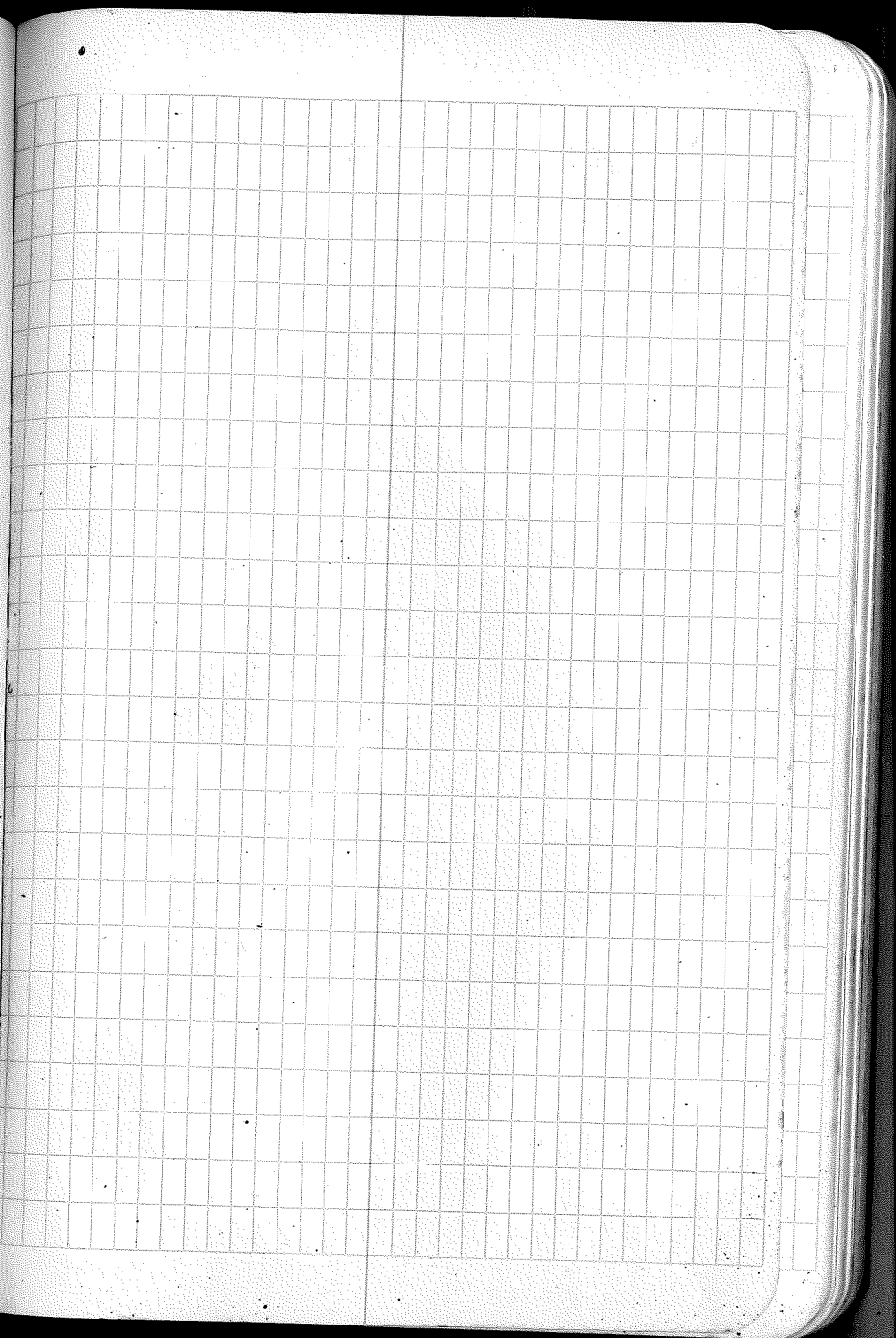
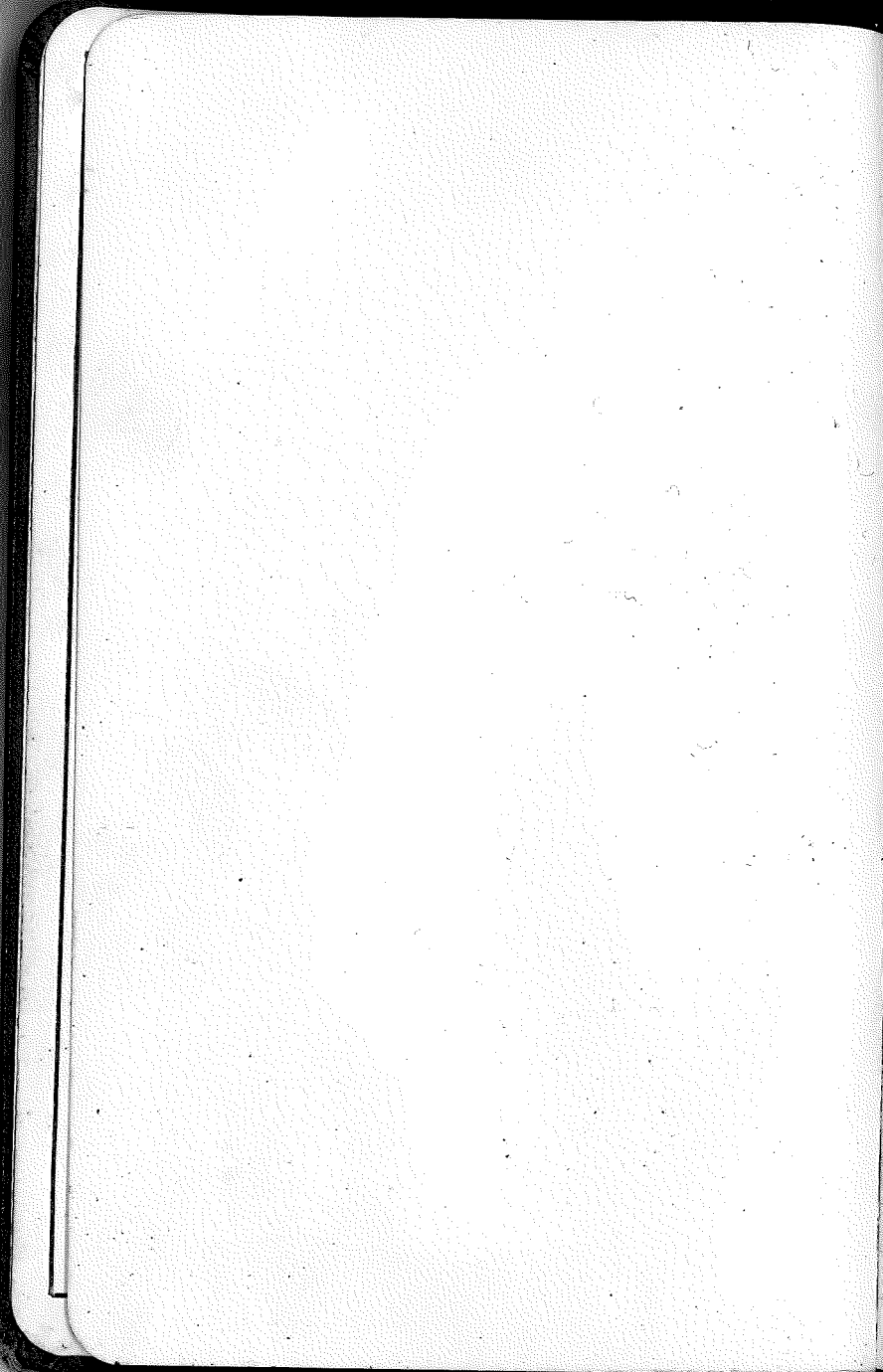

INDEX

T. 138 B. 26

6	5	4	3	2	1
7	8	9	10	11	12
<del>13</del>	<del>12</del>	<del>11</del>	<del>10</del>	<del>9</del>	<del>8</del>
18	17	16	15	14	13
19	20	21	22	23	24
<del>25</del>	<del>24</del>	<del>23</del>	<del>22</del>	<del>21</del>	<del>20</del>
30	29	28	27	26	25
<del>31</del>	<del>30</del>	<del>29</del>	<del>28</del>	<del>27</del>	<del>26</del>
31	32	33	34	35	36

$\frac{10}{15}$

738-26

See pages 13 & 14  
of Book #3  
for this trip.

0400 started East from

$\frac{9}{16} \frac{10}{15}$

Var.  $7\frac{1}{2}^{\circ}$

Look for:  
At 2671.68' or  
40.48 chs.  
W. Birch 14", N. 60 Ks.  
Y. Pine 20", S 12E 62 Ks.

10/11  
15/14

138-26

Look for

Tom 3" N51E 141KS

" 3" N53W 501KS

" 9" S45E 771KS

" 4" S22W 171KS

Dist. is 80.95chs.

26+00

21  
28

137-26

24+50 Open Hay Field on South Side

19+59 Found Secondary road

13+20 Set E  $\frac{1}{16}$  Cor  
12+50 Enter Jack Pine

8+80 Enter Mixed Hardwoods

437

27+00

W/F Fence  
Started West from

21  
28

137-26

Date

Feb. 13, 1937

3

Martin - Chief of party  
Peterson, Dean, (Chief)  
Gronlieb - Pilot  
Anderson - Engineer  
Chase - " "

Look for:

Ha. Pine 4" diam 67 lbs

" " 3" S 46 E 90 lbs

Found

No evidence -

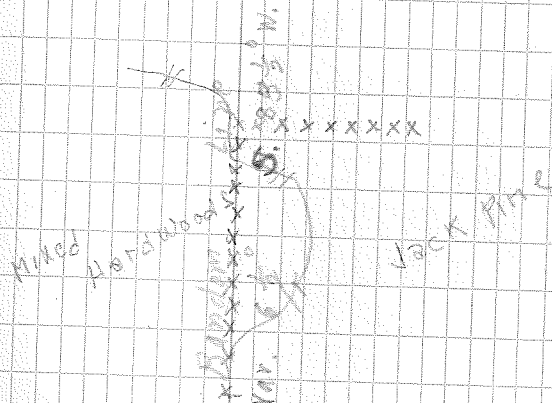

Set compass up in center of

road where approx. line would be

Shot on 875

Pine 12" N 43° W

Pine 12" S 55° W

was set slightly

to so picket line  
would miss fence.

5280

Set Section Cor

20/21

27/28

138-26

Found two B.T.S

Reading Fir Sec. 29.6% S. 19° E, 63'

" " " " 20 " N. 48 1/2° E, 63'

45+28

left Field enter Aspen

43+08

Aspen starts on North Side

39+90

Open Hay Field on South Side

32+10

Enter Mixed Brush

30+80

Mixed Brush starts on North Side

Feb. 18, 1939.

Makison - Chief

Peterson - Ch.

Greulich - Picket

Anderson - Brusher

Chase - " "

Look for:

W. Pine 30" N35E 131/Ks.

Y. Pine 27" N32W 147/Ks.

Charred Pine 24" S70E, 102/Ks

W. Pine 25SW 102/Ks.

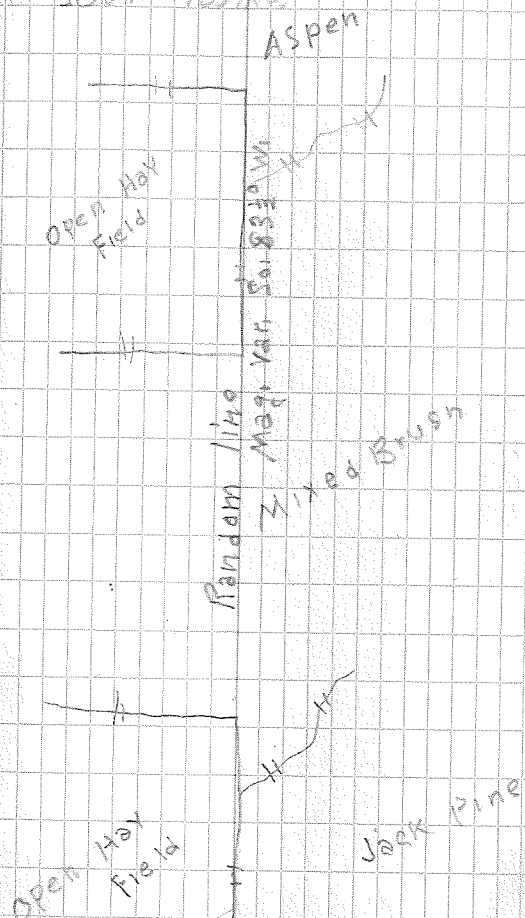



36+40 Set  $\frac{1}{2}$  Cor  
25+00 Enter Aspen

20+45 Enter white oak

4+08 Enter Aspen

1+10 Enter white oak

0+00 Started W. from ~~111~~ Sec. Cor  $\frac{20}{21}$ / $\frac{27}{28}$  138-26

Look For, ~~Hor.~~ 6.5" H Mattson-Chief  
W. Pine 24" N. 15° W 40' K Peterson, Ch.  
" " 30" S. 12° W ~~45~~ 1.15 Greulich-Pickett  
45 Anderson-Brusher  
White Chase - Brusher

Found:  
No evidence

Random line  
Mag Van S. 83° 30' W

Aspen

White oak

1974  
30/29

138-26

52+80 Set Sec. Corner

51+70 Enter Red Oak

39+60 Set  $\frac{1}{6}$  Cor.

39+60 Cont. on Random line

Date  
Feb. 16, 1937.

Var 6.85

Look For

W. P. He 10" S. 13. W. 3051K

Y " " 12" S. 11. W. 270 "

Y " " 12" N. 8. W. 346 "

Matteson-Chief

Peter Sob Ch.

Greulich-Picket

Anderson-Brosch

Chase -Brush

Found:

No evidence.

Aspen

Random line  
Aspen Var 5.830 W.

Aspen

26+40

Set  $\frac{1}{4}$  Cor

$\frac{19}{30}$  139-26

22+06

Enter Aspen

20+00

Enter Swamp Willow

8+40

Enter Aspen

0+00

Started West from

$\frac{19}{30}$   $\frac{20}{29}$   
 $\frac{19}{30}$  139-26

138-27

Feb 16, 1937

Swamp  
 Look for:  
 Dead Pine 18" N63W 337115.  
 " " 8" S73E 233115

200  
 Random Line  
 6.50

RRR Day

52+80

Set Sec. Cor.

24/19  
25/30

138-26

49+05

Left lake - Enter Aspen

48+00

43+00

42+15

Reach Lake

34+25

Enter Mixed Hardwood

28+70

Enter Open Swamp

138-27

Date Feb 16, 1928

Molson - chief.  
Greplich - pictor. Anderson  
Chase  
Peterson, A. - chain.Look for S.C. at 5263 $\frac{1}{2}$ '

W. Pine 24" N46E 495 Iks.

Y. Pine 20" N83W 557 Iks.

Y. Pine 13" N22W 788 Iks.

Y. Pine 15" S27W 730 Iks.

Look for M.C. at

4856.9'

Y. Pine 20" N53W 91 Iks.

No other trees.

Found:

No evidence

Look for M.C. at

4339.9'

Aspen 7" N74E 102 Iks.

" 12" S33W 31 Iks.

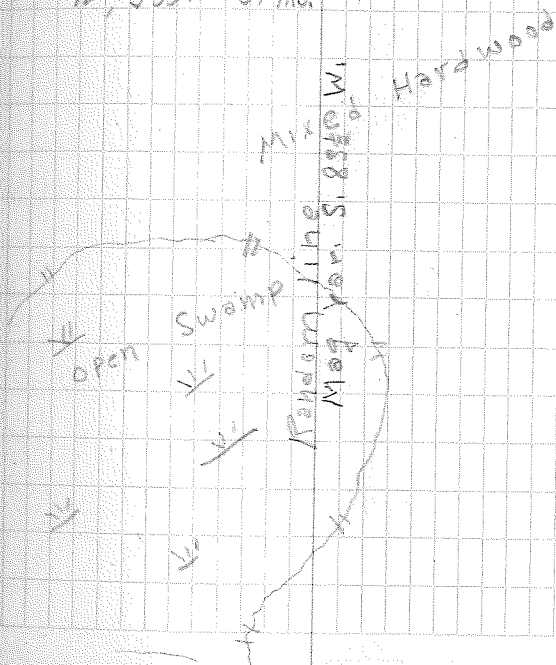

26+40

APP  $\frac{1}{4}$  Cor $\frac{22}{27}$  138-213+20 Set APP w.  $\frac{1}{4}$  Cor12+13 Stopped running - Reached Lake  
11+65 Enter Jack Pine  
11+74

10+12 Left field Enter ASPEN

5+80 open Field on North Side

0+00 started East from

 $\frac{21}{27}$  137-26

138-26

9.

Feb. 28, 1934

MADISON - Chief  
PETERSON - Pickett  
PETERSON - B. B. H.  
KANGUS - B. B. H.  
CHASSO - CHAIN

Found:

Lake M.C. Pipe also  
two B.L.S.  
Sec. 22. 10" Jack Pine  
Sec. 27. 8" Jack Pine

Look for ab:

1174.14' M post

W. side of Roth ASPEN

Lake.

J. Pine 9" SWW 27/15

" 4" NW 47/15

Open Field

Jack Pine

Jack Pine

Random line  
Var. N. side

52+80

Center of road

22/23

27/26

49+54  
49+00Enter open Grass Land  
Left lake Enter Jack Pine

26+40

Started East From

22/23

138-27

138-27

0

10

Feb 28 1938

Look for:

W. Pine 22" N63W 24HS Open grass

Y. Pine 6" N20W 24HS

Dead Pine 17" S50E 24HS

W. Pine 6" S3W 228HS Found

Ori. Notes - ran West

from this corner 132' original B.T. 15" N.

+ set M.C. 4

W. Birch 9" N60E, 24HS,

N. Pine 15" S15W, 40HS.

10' 0" original m.

M.C. Pine and

Pine with Scribner

also Copper B.T.S.

For Section Cor.

14" Jack Pine Sec. 22

8" W. Oak Sec. 27

6" W. Oak Sec. 23

Random line  
27/26

Lake

Martin-Chief  
Petersen-Brown  
Kongus-Brown  
Chase-Chi

26+40

Set APP  $\frac{1}{2}$  Cur.

23

26

138-26

23+48

Enter Mixed Hardwood

Quit for day Feb 22, 1939.

17+10

Enter ASPEN

14+24

Enter Mixed Hardwood

13+50

Set APP W.  $\frac{1}{6}$  Cur

11+00

Enter Spruce Swamp

9+10

Enter Mixed Brush

6+87

Enter Mixed Hardwood

0+00

started from East from

22/23

27/28

138-26

11

Look for:  $\frac{1}{4}$  past  
 W Pine 20" N70E 48IKs.  
 " 24" S40E 52IKs.

Mixed Hardwood

Feb 22, 1939

Mattson-Chief

Chase - Chief  
 Peterson - Di Picker  
 Peterson - Brush  
 Kangas - Brush

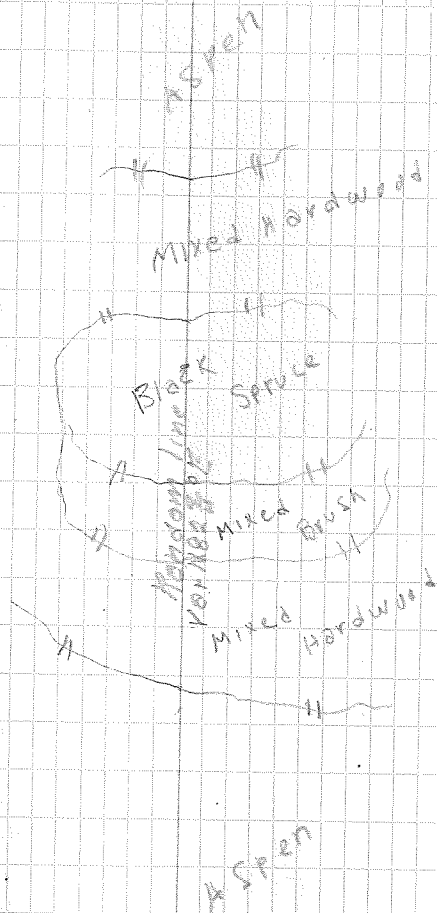

V. 7 1/2

52+81 Set APP Sec. Car.  
52+90 Enter Swamp willow

$\frac{23}{26} \frac{24}{25}$  138-26

46+62 Enter Aspen

38+65 Enter B. Spruce Swamp

26+40 Started East From

$\frac{23}{26}$  138-26

Look for:

Spr. 8" N20E, 117 IKs

W. Pine 18" S 6E, 100 IKs

W. Birch 8" S 15W 57 IKs

No other tree convenient

in Sec. 23.

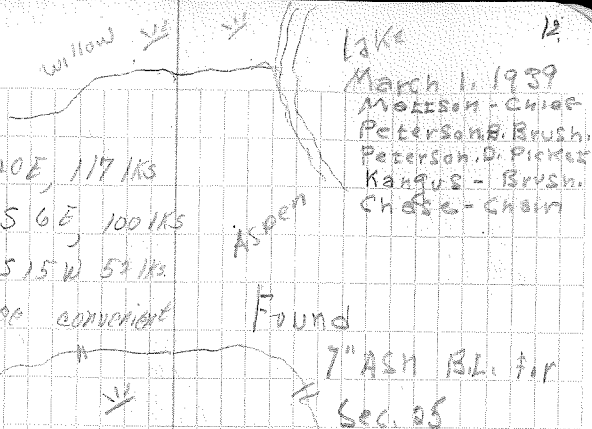

Lake 12

March 1, 1939  
Molison - Chief  
Peterson B. Brush  
Peterson D. Pieter  
Kangas - Brush  
Chase - Chief

Found

7" ASH Bl. fir

Sec. 25

Black

Spruce

Mixed

Random line  
Handwritten

Handwritten



26+40 Set App  $\frac{1}{4}$  Cor.

$\frac{24}{25}$

138-26

20+14 Enter Black Spruce

16+08 Enter Black Ash

15+00 Crossed Creek

$\frac{13}{13}$ +60 Crossed Creek  
Set APP W.  $\frac{1}{16}$  Cor.

12+16 Found Creek

9+90 Enter Swamp Willow

1+74 Enter Mixed Hardwood

8+00 Started East from

$\frac{33}{31}$

13

Leak for:  $\frac{1}{4}$  post

Blk. Ash 7" N45E, 27IKS  $\searrow$

" " 8" S70W 6IKS

40.25 ch.

B. Swamp  
Swamp  $\searrow$

March 1, 1937

Madsen - Chief  
Peterson - Brush H.  
Peterson - Picket  
Kongus - Brush H.  
Chase - Chief

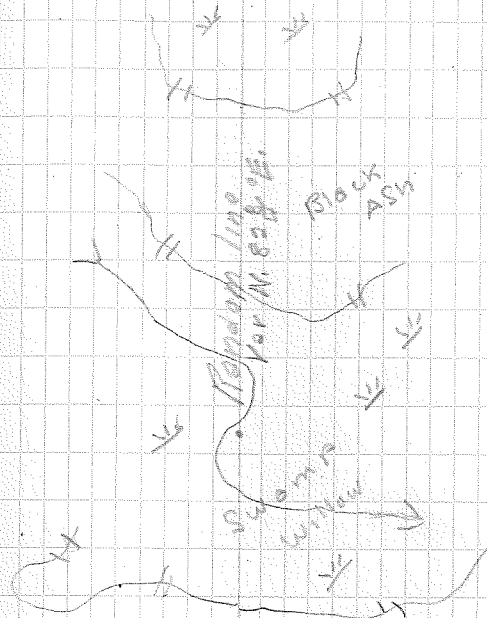

Mixed Hardwood

7+74

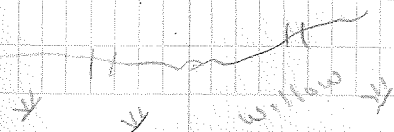

52+81

Set App Sec. Cor.

 $\frac{24}{25}$ 

138-26

39+61

Set App E.  $\frac{1}{16}$  Cor.

33+43

Enter Aspen

31+22

Enter Black Spruce

30+62

Enter Balsam

26+40

Started East From

 $\frac{24}{25}$  138-26

Lost for at 80.5 ch.

Aspen 3" N48 E. 75 lks.

Y. Pine 4" S78 E 136 lks.

" 5" S87  $\frac{1}{2}$  W 72 lks.

" 11" N34 W 35 lks.

March 2, 1939 <sup>14</sup>Morrison - Chief  
Peterson - Pioneer  
Chase - Brush  
Kangas - Chain

Found:

22" White Pine

with Copper Plate

For Sec. 30. Little Pine

LWP

Random line  
for 182205

Aspen

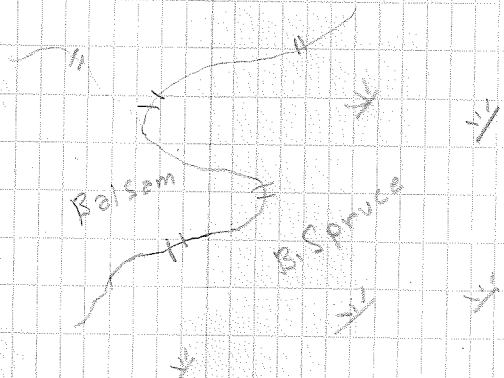

~~25+40~~ set app. 4 car.  $\frac{9}{16}$  138-26

25+74 Hit line running North and South

22+00 Enter spruce swamp

16+50 Enter Aspen

13+20 set app E. to car

7+92 Enter Jack pine

3+58 Enter aspen  
leave cropland

~~3+58~~ leave cropland

0+00 Started West from  $\frac{9}{16}$  138-26

Feb. 20, 1939

15

Estrem - Notes  
Woods - brushing  
Harland - ch.  
Bustick - brushing

Look for: SPRUCE SWP

Spruce 4 ins. S. 89° W. 3 1/2 ft.

" 3 " N 42° E 7 1/2 ft. Found 2 squares  
stack 48 ft. S.  
of trace

Aspen  
Found two 4"  
bearing trees  
N. 56° E. 3 ft.  
N. 64° W. 4 ft.

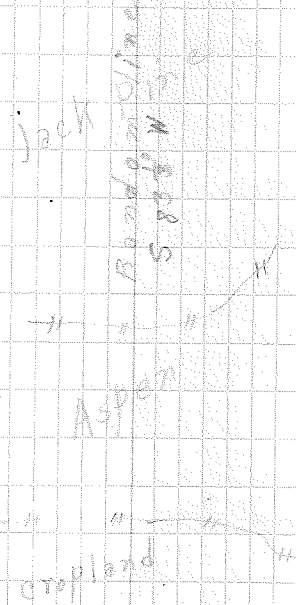

52+10

Found sec cor.

8/9  
17/16

138-26

F

39+70

Set app. w. to cor.

37+00

Bottom of Hill

36+30

Top of Hill

34

31+11  
31+00Hit trail  
leave spruce sup.

133-27

Feb. 21, 1939

16

Estrem - Notes

Wood-brooding

Boskirk

Harland Ch.

Var T.

Look for:

y. pine 10 ins. N. 30° E. 40 lks

Aspen 7" N. 43° W. 40 lks

y. pine 13" S. <sup>53</sup> E. 75 lks

y. " 12" S. 57 W. 83 lks

Found:

I.P. 42 ft. N. of

line 8/9  
17/16

B.T. 4" Oak

with copper plate

N. 40° W. S. 8

T. 136

R. 26

Aspen

Aspen

26+40 set app by cor.

$\frac{81}{171}$

138-26

13+20 set app E. to cor.

9+25 Enter lake

7+24 found M.C. post

5+27 Hit road

4+15 Enter jack pine

0+00 started w. from cor.

$\frac{819}{1716}$

133-27

Feb. 23, 1937

17.

Estym - notes  
woods - brushing  
sawick - brushing  
Harland - etc.

look for:

M. post on E side lake

x pine 12" S. 60° E. 34' 1/2 Ks.

" " 8" N. 120° E. 31' 1/2 Ks.

M. post on W side lake

x pine 6" S. 25° W. 61' 1/2 Ks.

y pine 20" N. 90° W. 63' 1/2 Ks.

lake

Random line runs

look for:

M. post on E side lake

x pine 12" S. 60° E. 34' 1/2 Ks.

" " 8" N. 120° E. 31' 1/2 Ks.

Found: M.C. post

P. + 8" jack pine

N. 41° W. 16 ft.

with copper plate

S. 71° W. 26 ft.

10" jack pine

S. 64° W. 23 ft.

with copper plate

317 + 138 P. 20

New Orleans over

Birch

Var 70

52+80 set app. sec. Cor.

43+00 Enter jack pine

39+70 set app. w.  $\frac{1}{4}$  cor.

34+50 Enter Oak

33+40 To road  
32+27 top of Hill  
31+92 Bottom Hill  
31+80 set staff compass

30+74 Enter jack pine

138-27

Feb 23, 1939  
Estrelin - Notes 18.  
Woods - Brushing  
Lusk - brushy  
Harland - etc.

look for:

J. pine 6" N. 45° E. 36 lks.

Y. pine 17" N. 70° W. 56 lks. Found  $\frac{1}{2}$

J. pine 7" S. 65° E. 33 lks. Evidence

Y. pine 12" S. 55° W. 44 lks



Oak

look for: Found:  
14" dead jack pine  
M. post on w. side lake N. 140° W. 2 ft.  
Jack pine 6" ~~S. 70° W. 58~~ <sup>N. 140° W. 2 ft.</sup> <sup>with copper plate</sup> 58 7/135 19.25  
Y. pine 20" N. 80° W. 60 lks.

Jack pine  
Continued line w.  
off from 1940 S. 91° W. to  
line remaining

26+40 set app.  $\frac{1}{2}$  cor.

21+00 Enter Birch

13+20 set app. E  $\frac{1}{4}$  cor.

11+30 Enter Oak

9+00

5+55 Enter Lake Mimio  
3+25 bottom of Hill

1+45 Top of Hill

2+00

0+00 Started West from

$\frac{7}{18}$

138-26

138-27

Feb. 24, 1934  
Estrem-Notes 19  
part 2nd ch.

by sick pushing  
Peter's pushing  
Found: 72

Look for: at 2626.8' is 4

Y. Pine 8 inches N. 35° W. 41 Ks.  
W. Birch 2 " S. 25° E. 32 Ks

Evidence

M. post on W. side Lake Mimio

Aspen 8 " S. 18° W. 14 Ks

W. Pine 9 " N. 18° E. 15 Ks

M. post on E. side Lake Mimio

Hard pine 6 " S. 14° E. 15 Ks

6 " N. 26.

Oak

Look for at 985' is 0

M.C. on ~~hill~~ Mimio Lake

Found: 70

Evidence

Aspen 8 " S. 18° W. 14 Ks

W. Pine 9 " N. 18° E. 15 Ks

W. Pine 6 " N. 18° E. 15 Ks

W. Pine 6 " N. 18° E. 15 Ks

W. Pine 6 " N. 18° E. 15 Ks

Jack Pine

Look for at 244.2'

Found: 70

Evidence

M.C. on E. side Mimio Lake

Hard pine 6 " S. 14° E. 15 Ks

" " N. 26 Ks.

52+80

set app sec. cor.

 $\frac{7}{18}$  138-2

51+50

Enter Aspen

47+40

Enter B. Oak

45+80

Enter Aspen

42+70

Enter Black Oak

39+60

set app w. to cor.

38+29

Enter Aspen

30+30

Enter SW Prob. to Rd

29+81

Hit road

138-27

Feb. 27, 1939

20.

Estrem - notes

basical - etc.

woods - brushing

Hippers - brushing

look for:

w. pine 16" ~~N. 35° E. 47~~ 1/ks.

w. " 22" S. 76° E. 48 1/ks. Found no

w. " 16" S. 69° W. 18 1/ks. Evidence

w. " 23" N. 30° W. 57 1/ks.

" " "

Aspen

" " "

B. Oak

" " "

Aspen

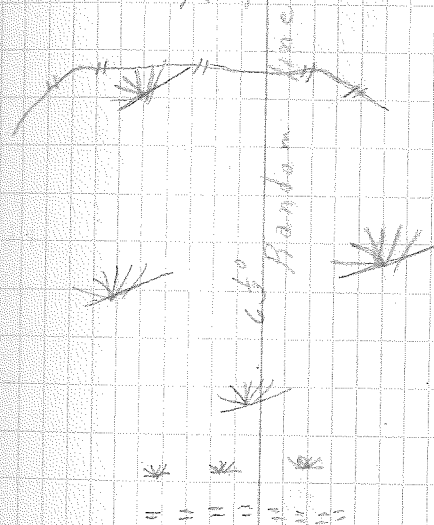



look for:

0 + 00 Started West fish 

13	15
14	17

 T 138-R-27

look for:

The image shows an open notebook with two blank pages. The pages are white with light blue horizontal ruling. The notebook has a dark cover visible around the edges. The pages are slightly aged and show some minor discoloration. The right page has a small tab at the top with the number '138-27' and the page number '23' in the top right corner.

138-27

24

The left page of the notebook is a grid with 20 columns and 25 rows. The grid is composed of thin, light-colored lines. The page is otherwise blank, with no text or markings.

The right page of the notebook is a grid with 20 columns and 25 rows. The grid is composed of thin, light-colored lines. The page is otherwise blank, with no text or markings.

26+40 Set App 1/4 Cor  
26+40 Fence 5  
26+37 Type change

$\frac{28}{33}$  138-26

23+15 Type change fence w 9 5

19+20 Set App E 1/6 Corner

11+95 Type change

6+00 Type change

3+00 Farm 300 St H.

0+00 Started west from  $\frac{28}{33}$  138-26

138-27

25

Feb 14, 1939  
Herbert  
Stegelik  
R. Petersson

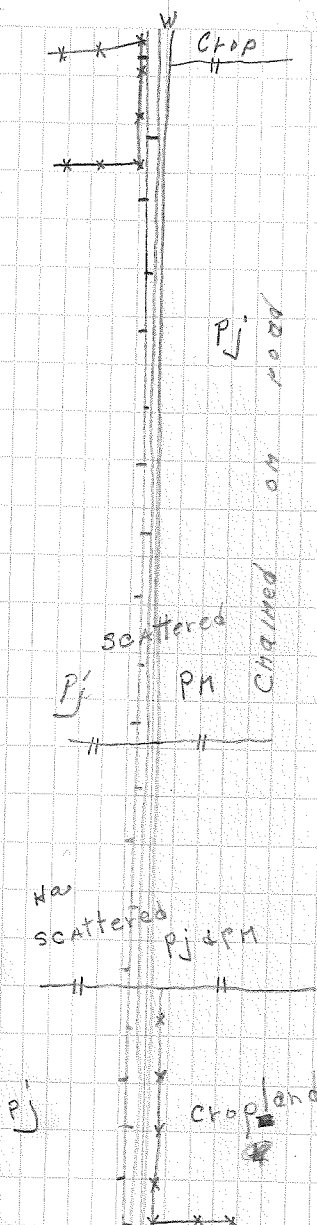

Started from J.P. 18" - Cor. 11"  
N.P. 14" 130-26

5280

Set app Ice Cor  
Road N-S

29/28  
32/39

Feb 14, '39 26  
Herbert  
Stogelvik  
R. Peterson

found:  
B.T. NW pj 8"  
S. 29 T. 138 - R26  
B.T. NW

39+65  
39+30

Fence 5 Type change  
set app W 1/16 Cor

33+85  
33+16

farm Road N  
fence 3 & W type change

29+10

Road to farm 3

26+40

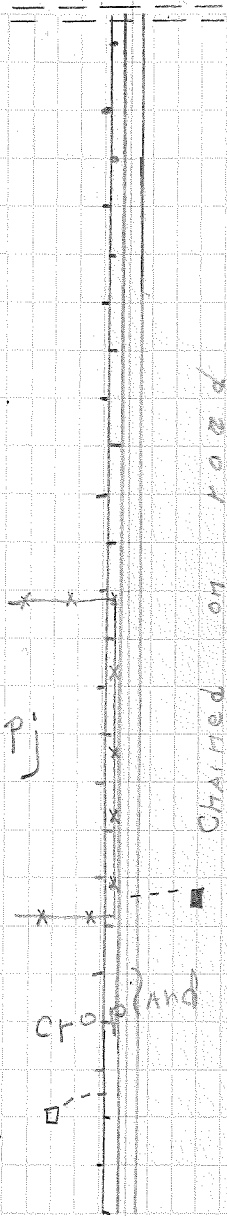

26+40

Set app 1/4 Cor.

Line Cont on Pg 6  
29  
32

24+75

Type change

22+90

Type change

20+25

Type change

19+00

Type change

13+20

Set App. 1/16 Cor

8+75

Type change

2+90

Type change

0+65

Trail NW

0+00

Started West from

29/29  
32/33

138-26

13827

Weather:  
Very Cold

Feb 14, 1939 27

Herbert  
Stegelmik  
K. Peter = 10

Look for:

y. pine 14"

y. pine 12"

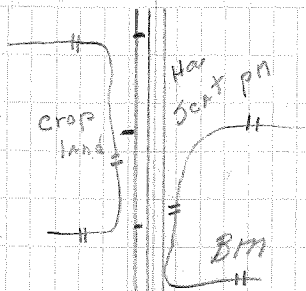

Found:

BT. 10" PN IV 36'

S. 29.7138 N 26

BT. 10" PN W 44'

S 32 T 139 N 26

Chained on road

Har Sect PN & PW

Har-  
Scattered  
PN & PW

crop land

PI

26+40 Set App 1/4 Cor 32/33 138-26  
26+00 Fence S.

19+65 Trail W  
18+00 Type change

13+20 Set App 1/16 Cor 22/33 fence 1/4 S

11+50 Type Change

0+00 Started S. from 29/28 138-26  
30/33

138-27

Feb 14, 1939 28  
Herbert  
Stegalvik  
R. Peterson

Found:

BT. SE 43' Pj 8"

BT. W 41' Pj 8"

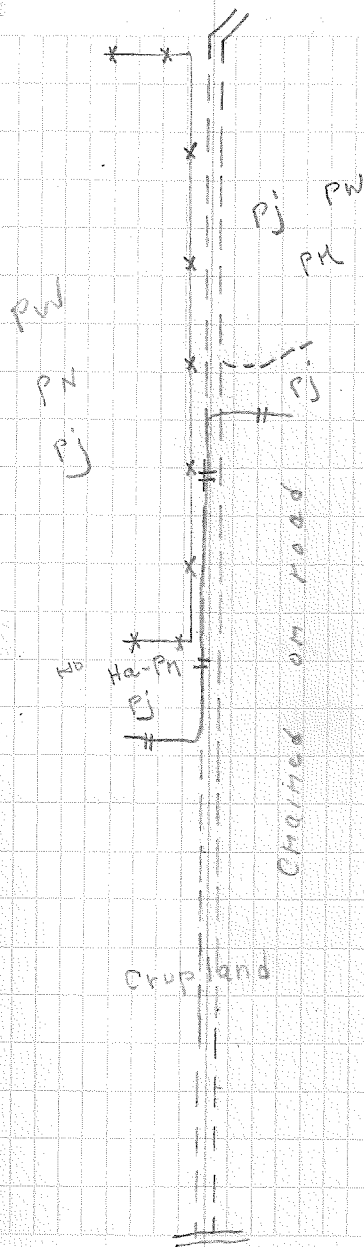



Road Turns W.  
52+80 Set app. sec. cor  $\frac{32}{33}$  138-26.

45+00 Type change

39+60 set app  $5\frac{1}{16}$  Cor  $\frac{32}{33}$  Type Change

27+40 Road SW.

26+40 Continued So. from  $\frac{32}{33}$  138-26

0+00 started So. from  $\frac{29}{32}$  138-26

Feb 14 1939

Herbert  
Stegelin 29  
R. Peterson

Found:

BT. 6" P.M. NE 55ft.  
S. 33 T. 138-26

BT. 8" P.J. 102 ft. SW.  
S. 1 T. 138-26

Ha Pj  
P.M. P.W. W.P. W.O.

Cropland

Chained on Road

P.M. P.W.

P.W.

P.J.

P.J.

Ha

P.M.

Ha

Herbert  
Stegelm  
Peterson

30.

52780 Set App. Sec Cor.  
No. Evidence $\frac{30}{31} \frac{29}{32}$ 

138-26

45400 Hit Road

39+20 Set App. W. 1/6 Cor.  
39+10 Fence Runs N.

36+73 Type change

29+29 Type change

26+80 Fence N.

20+40 Continued West Stem

 $\frac{29}{32}$ 

138-26

Look For:

y. pine 12" N 72E 34Lbs  
y. pine 13" S. 70E 42Lbs  
y. pine 14" S. 73W 31Lbs  
w. pine 16" N 64W 25LbsROAD  
CHAINED ON

Found:

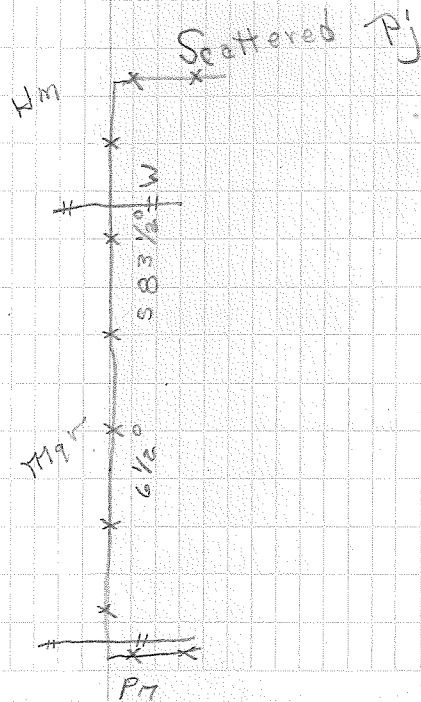

26+40 Set App 1/4 Cor  $\frac{30}{31}$  138-26  
25+88 Fence So. Type Change

18+77 Road to Farm Fence So. Type Change

13+20 Set App E 1/16 Cor  
12+51 Fence W & S

8+39 Type change

3+18 Road N. to Farm

0+00 Started W. from  $\frac{30}{31}$  138-26

138-27

Feb 15, 1938 31.  
Herbert  
Steger  
P. Peterson

Look for  
y. Pine 13" N 4W 111 Ks  
y Pine 15" S 3E 126 Ks  
Dist. 2626.8'

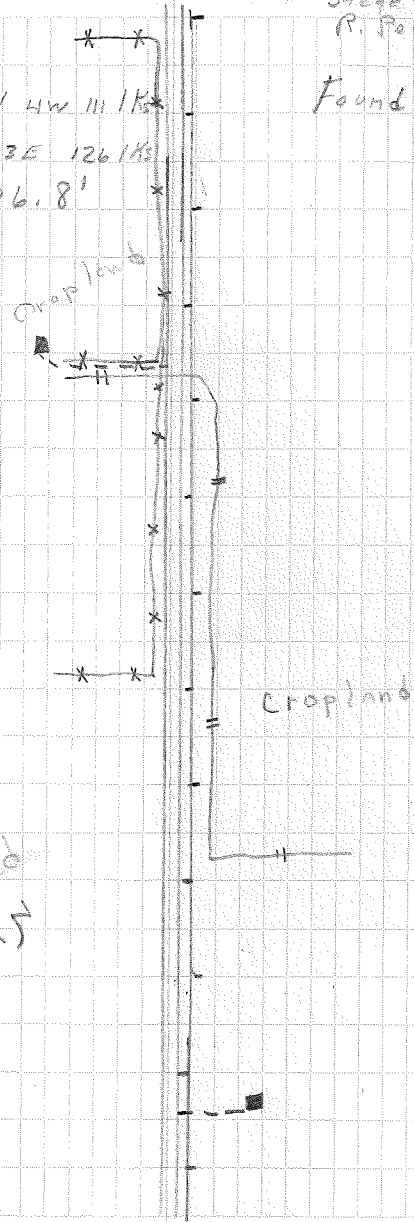

52+18 Set App. section Cor in road  
 intersect  $\frac{30}{31}$   
 138-26

39+60  
 39+38

Set App w 1/4 cor.  
 Type change

26+40

Continued w. from 1/4  $\frac{30}{31}$  138-26

Feb-15, 1939 32

Herbert  
 Stegely  
 R. Peterson

Found:

Look for  
 pipe 18" N 1/2 E 470 LMS  
 " 7" S 83 E 281 LMS  
 " 18" S 55 W 492 LMS  
 " 20" N 1 W 605 LMS

Crop land

Hm

Na

Scattered Tj & Pn

1/4 6.50

138-27

33

138-27

34

This is a blank ledger page with a grid of 10 columns and 25 rows. The columns are of varying widths, with the first column being the widest and the last column being the narrowest. The grid is composed of thin, light-colored lines on a white background.

This is a blank ledger page with a grid of 10 columns and 25 rows. The columns are of varying widths, with the first column being the widest and the last column being the narrowest. The grid is composed of thin, light-colored lines on a white background.

13827

138-27

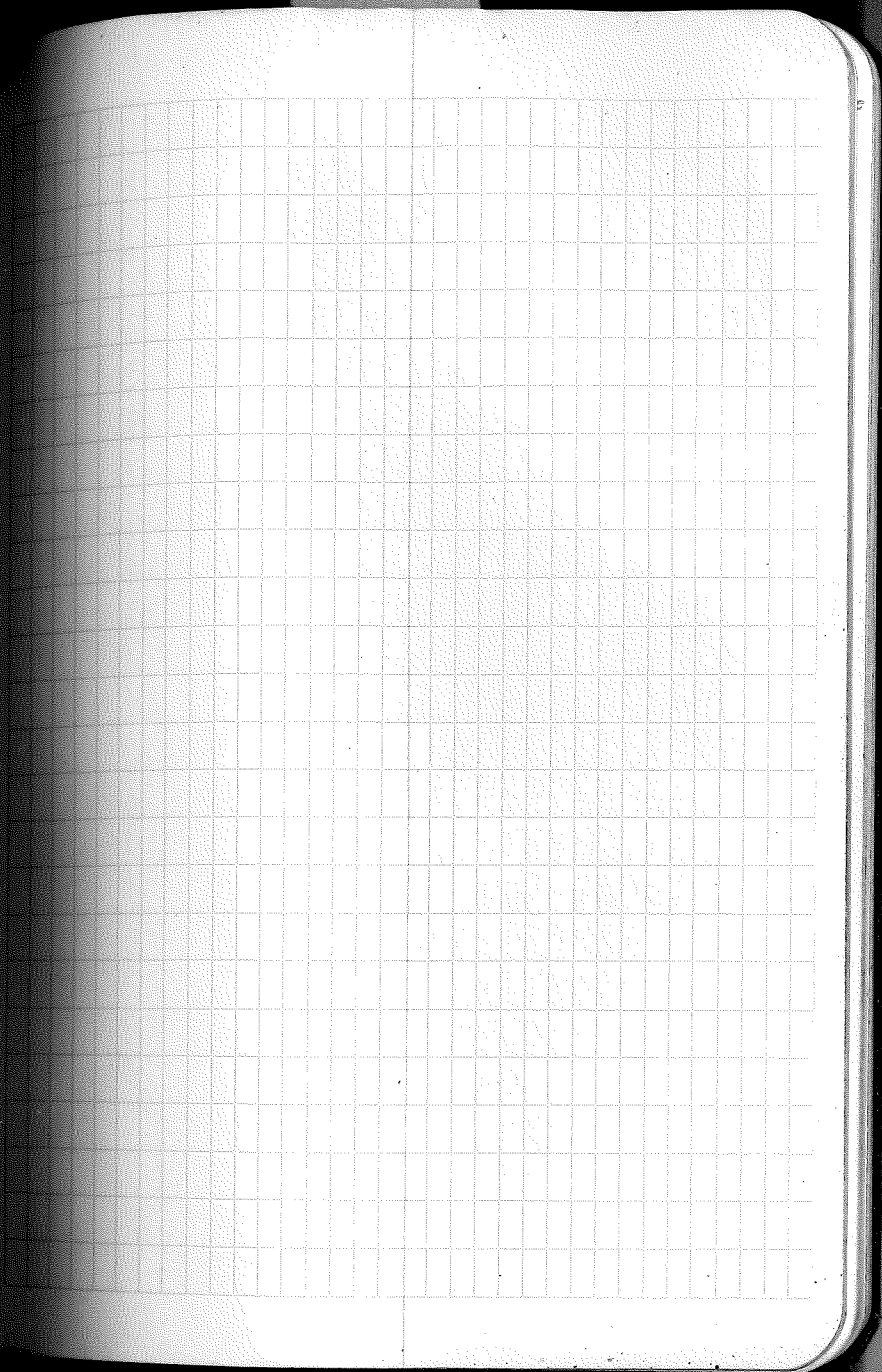
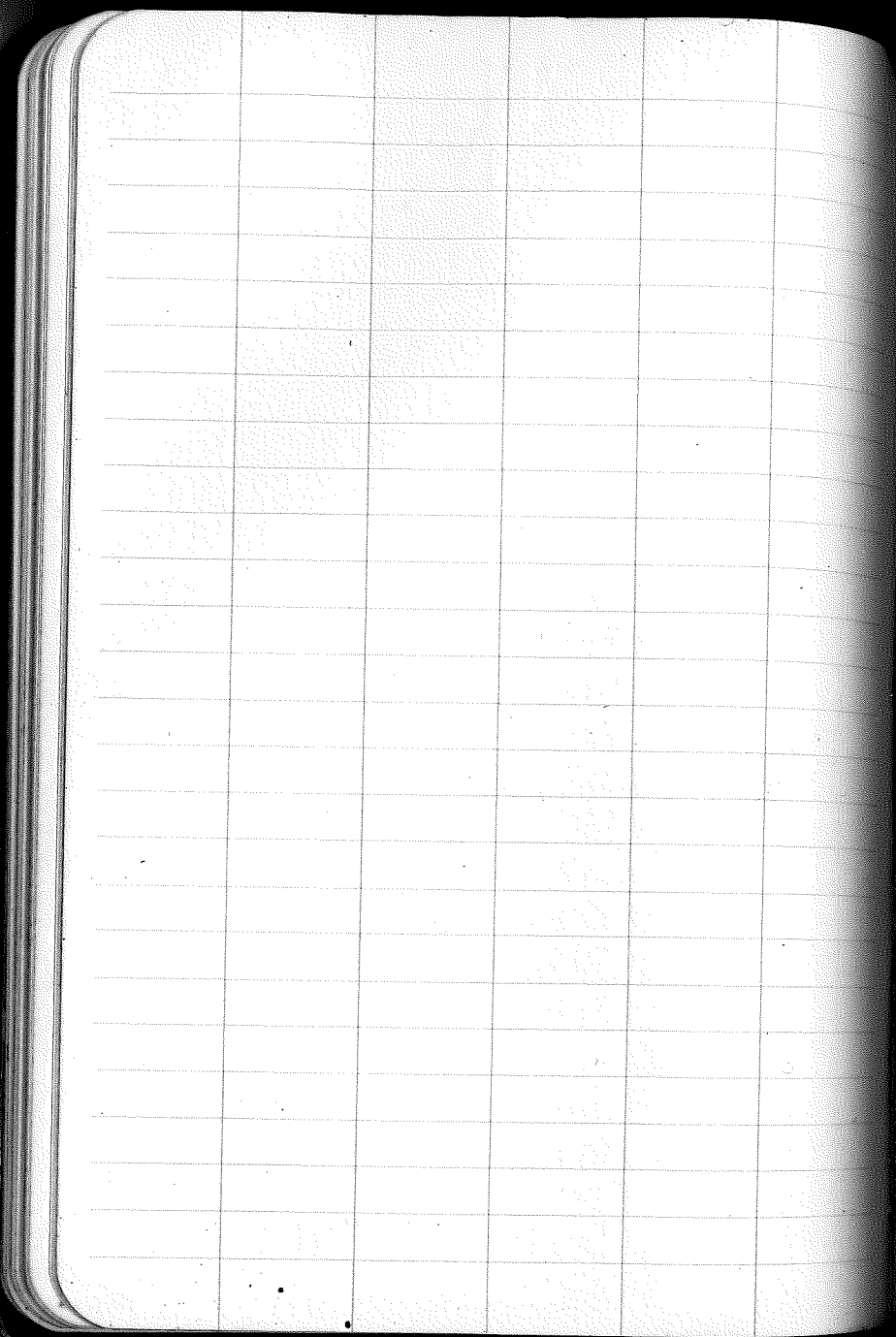



138-27

T. 138 | P. 27

N

6 <sup>00</sup>	5 <sup>10</sup>	4 <sup>00</sup>	3	2	1
33 32	36 34	30 28	27 26	25 24	23
7	8	9	10	11	12
					21 22
18	17	16	15	14	13
38 39	40 41				30
19	20	21	22	23	24
			2 1 3	4 7 8	
30	29	28	27	26	25
					19 20
31	32	33	34	35	36
10	9 12	11 14	13 16	15 17	18

26740

Set APP  $\frac{1}{4}$  Cor. occ.T. 138 N  
R. 27 W.

28751

Reached land - Enter Mixed  
Hardwood

13720

Set APP E  $\frac{1}{4}$  Cor. occ.

0700

Started west from

22/23  
27/26

138-27

March 1939

11

Mixed  
Hardwood

Look For!

N.  $\frac{22}{23}$  MC. PostLinden - N.  $67\frac{1}{2}^{\circ}$  E 41.1KSE  $\frac{23}{22}$  MC. PostY. Pine 28" N.  $93^{\circ}$  E. 45.1KS.Y. Pine 26" N.  $43^{\circ}$  E 103.1KS.W.  $\frac{23}{27}$  MC. PostWhite Birch 8" S  $35^{\circ}$  W. 45.1KS.W. Birch 8" S.  $5\frac{1}{2}^{\circ}$  E. 43.1KS. $\frac{1}{4}$  Cor.  $\frac{23}{27}$ Y. Pine 18" S.  $32\frac{1}{2}^{\circ}$  E 35.1KSW. Pine 20" N.  $67\frac{1}{2}^{\circ}$  W. 54.1KS.W.  $\frac{21}{22}$  MC. PostButternut 4" S  $51^{\circ}$  W. 69.1KS.W. Birch 4" N.  $40^{\circ}$  W 30.1KS $\frac{1}{4}$  Cor.  $\frac{21}{22}$ 

See page 3.

Random line  
Var  $8$   $84^{\circ}$  W.plotted  
4-14-39  
GHW

52+80

Set Sec. Cor (in lake)

21	22
28	27

40+58

Reached Lake

39+60

Set App. W.  $\frac{1}{6}$  Cor. ecc.

26+40

Started East Prom

28	27
28	27

Lake

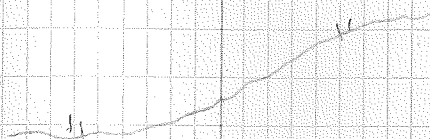
Random line  
var. 5-8 ft W.

Mixed Hardwood

 21/27  
 28/27

138-27

26+40 Set app. c. 1/4 Cor

25  
26

15+50 Enter spruce swamp

13+20 set west 1/16 Cor.

11+94 d of Kego Lake Road  
11+51 Sh. of Fox Lake

4+45 line intersects shore

3+81 C. of Cabin

2+10 line intersects shore

0+00 Started East from

22 23  
29 26 138-27

Date: April 13, 1939

Party: Woods - ch. 3

Michalson - Notes

Estes - ch.

Johnson - ch.

Hallstrom - ax

Look for:

Found:

W. Pine 24" N, 70° E. 461KS

No evidence

N. Pine 18" S, 90° W. 71KS.

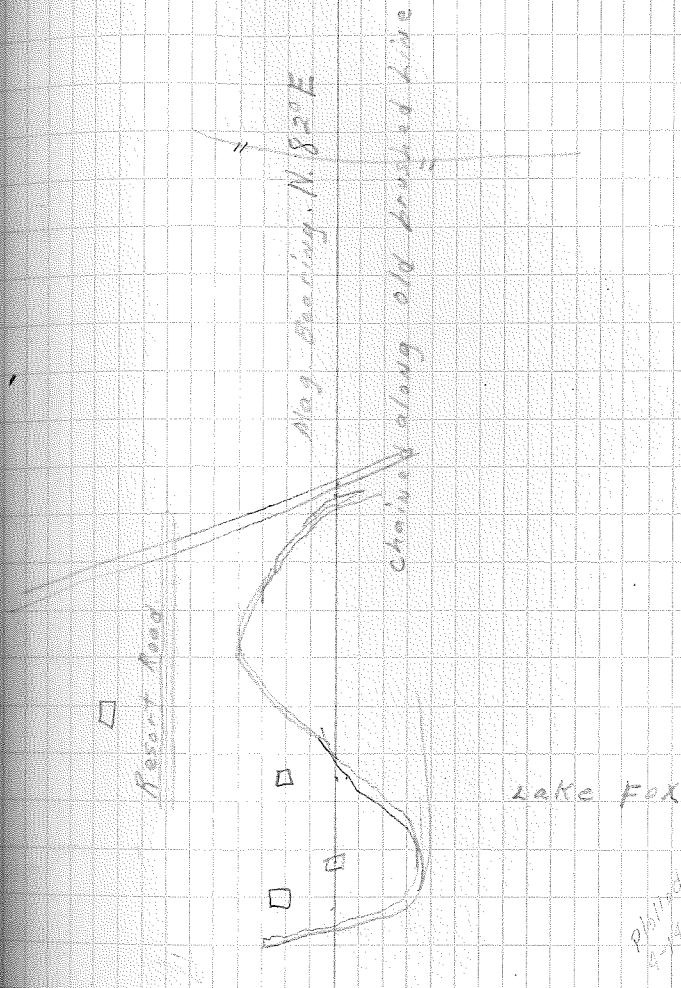

138-630

138-27  $\frac{23}{24}$  |  $\frac{24}{25}$   
 53+75 Reached T.P. at fence corner

Enter highland

45+92 East bank Daggett Brook

44+92 West bank Daggett Brook

~~43+00~~  
~~43+80~~ Fence - offset 18' south and chained  
 along fence

40+35 Enter marsh

39+60 Set East  $\frac{1}{16}$  C.C. corner

28+37 Leave P.S. Swamp

26+40 continued East from  $\frac{1}{16}$  cor.  $\frac{23}{26}$

LOOK FOR:  
 Redox N 67° E. 56 LKS.  
 " " " N 15° W. 44 LKS.  
 Spanish S 40° E. 14 LKS.  
 W. Birch 14° S. 190 W. 19 LKS.

F.U.N.D.

B.T. 12" Pj. S. 12° W. 72'

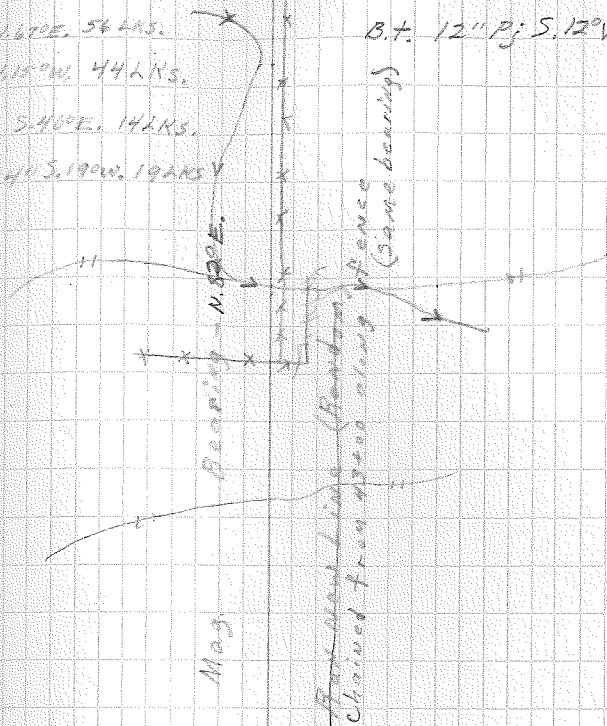

highland

P.S. Swamp

plotted  
 2/14/30  
 RMD

~~37~~

See page 37 for notes  
of this 1/2 mile

0400 started West ~~138-27~~ 138-27

Look Park

~~W. Side 16" N. 33° E. 57 lks.~~

~~" 22" S. 76° E. 48 lks.~~

M.C. on E. side Lake

Elm 6" N. 55° E. 5 lks.

W. Side 6" S. 30° W. 14 lks.

M.C. on W. side Lake

Hesper 5" N. 65° W. 50 lks.

Birch 7" S. 15° W. 34 lks.

~~12/~~ Extension Section Cor.

~~13/~~ Look Park

W. Side 16" N. 33° E. 57 lks.

" 22" S. 76° E. 48 lks.

" 16" S. 67° W. 18 lks.

" 23" N. 30° W. 57 lks.

Map bearing S. 83° W.

Var 6 50

Find

See page 37

2010

26+40

Look for:

White pine - 10" N. 40° E. 40/ks

Aspen 10" N. 67° W. 45/ks

Y. Birch 8" S. 35° E. 7/ks

Elm 6" S. 75° W. 50/ks

Map Bedding S. 83.5° W. Random line

26+40 Set Appr. CCC.  $\frac{1}{4}$  Cor. 2" <sup>138-27</sup> 24  
 26+30  $\frac{1}{2}$  of Mitchell Lake Road 25

19+40 Road turns N.E.

13+20 Set Appr. CCC. W.  $\frac{1}{16}$  Cor.

8+29 Enter road and chained along it.

1+25 Road N.S.

1+00 started East  
 West

23/24  
 26/25

Date - April 14, 1939

Party: 7.

Woods - Chief

Michaelson - Note

Estrem - AX

Johnson - Chain

Hellstrom - AX

No evidence

Asketon

y-pine 15' N. 43 W. 36/ths

y-pine 22' S. 55 W. 65/ths

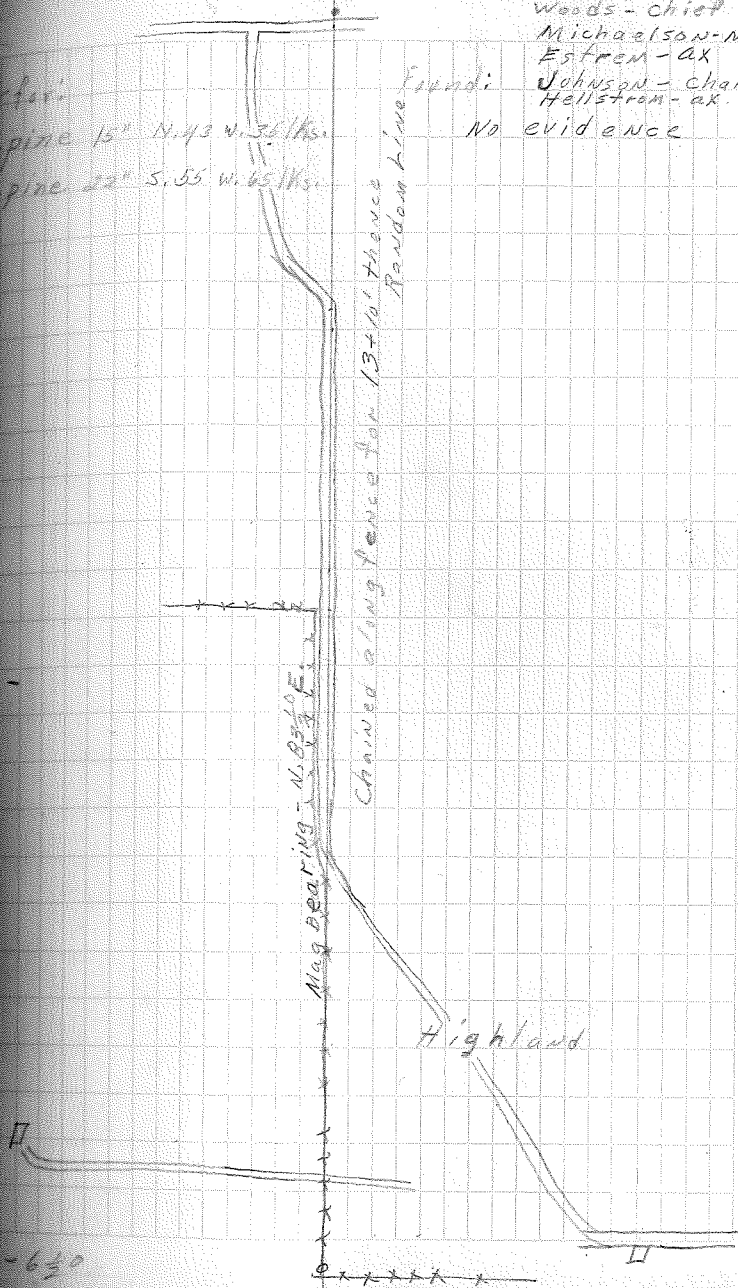

100-630



52+80 Set App. Section corner (C.C.R.)  
2" Black ash squared & Keeled.

27  
25

41+00 off set line 18' North of fence and  
chained along it.

39+60 Set Appr. C.C.R. E.  $\frac{1}{2}$  cor.

29+53 Crossed fence

26+40 cont. East from  $\frac{1}{2}$  cor. 27

Back for:

13" N. 10 W. 36 Ks

" 16" N. 72 E. 49 Ks

" 14" S. 90 E. 39 Ks

" 23" S. 32 W. 54 Ks

Found:

No evidence

Marsh

Mag. bearing N. 83.5° E

26+40 Set App. C.C.C.  $\frac{1}{4}$  cor.

23+20 Cross brushed N.-S. Line

19+46 West shore of Lake.

3+45 Shore of lake

1+55 tip of land

0+60

started West from cor.

138-27

32

6

Date - ~~April 12, 1939~~  
AprilParty: G.  
Weats - chief.  
Michaelson - notes  
Esterson - Lt.  
Johnson - ch.  
Muller - tax.

look for:

y. pine 14" N. 80 W. 121 Ks.

y. pine 14" S. 9 E. 92 Ks.

look for:

M.C. on W. side of lake

y. pine 14" N. 43 E. 24 Ks.

y. m. 24" S. 9 E. 92 Ks.

Found:

No evidence

Found: 1

No evidence

look for:

M.C. post on E. side lake

y. pine 6" N. 87 E. 69 Ks.

y. pine S. 72 E. 103 Ks.

Found:

highland

Lake

Mgr.

Aspen

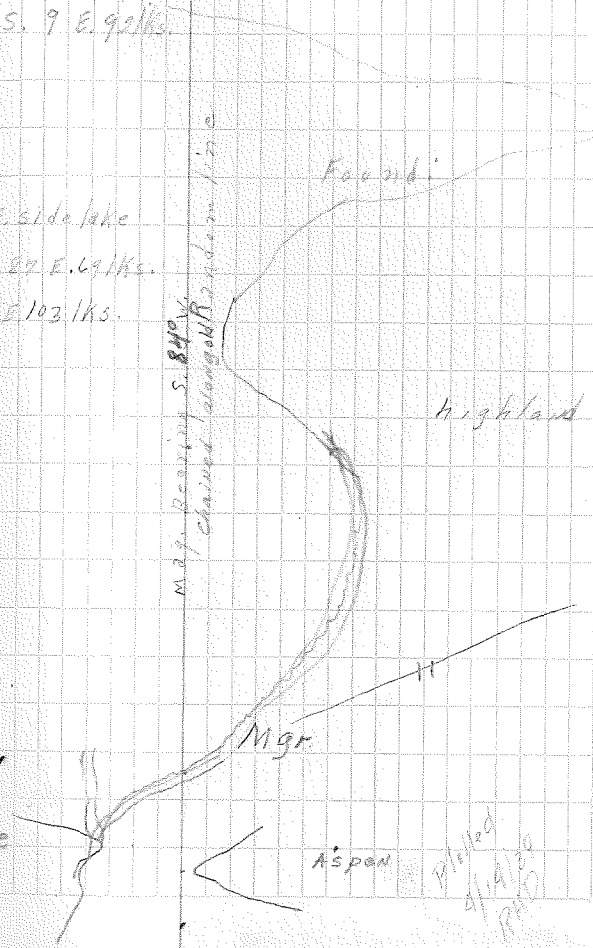
Potted  
4/12/39  
R.H.Map bearing S. 84° W.  
M.C. cleared along RR border in 1930

138-27

Found I.P. section corner 31 32

Not chained or brushed from 29+40 on  
because of consent of Resort owner  
Not secured.

29+40 Center of County Road

26+40 Cont. West from here. 32

Look for:

W. Birch 4" N. 43 E. 24/Ks.

Aspen 10" S. 58 E. 9.1/Ks.

" 12" S. 38 W. 37.1/Ks.

" 12" N. 52 W. 12/Ks.

Found:

Map Bearing 5.84 W. Boulder line

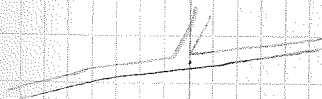

Photo  
9-14-38  
RHD

138-27  $\frac{3}{4}$ 26+40 set appx. c.c.  $\frac{1}{4}$  cor.

13+20  
39+60 set appx. c.c. E.  $\frac{1}{4}$  cor.

0+00 started West ~~E. T. 1/4~~  $\frac{3}{4}$  138-27

Date: ~~April 12, 1939~~  
Party: Woods-chief  
Michaelson-Nees  
Estren-ax.  
Judson-oh.  
Holliston-ax

Found: No evidence

Look for:  
w. ~~lines~~ 6" N 21 W. 5/ks.  
w. " 8" S. 70 E 13/ks.

Look for:  
~~N.E. post on E. side lake~~  
~~Aspen 5' 4/ks.~~  
~~Peter's N. 6. 3/ks.~~

N 29 bearing road S. 80 W.  
Chaired along rd. 1/2 on 1/2 c.

Found:

Photo  
4/19/39  
RHS

52480 Set appx. section corner in  $\frac{32}{8} \frac{33}{4}$   
 coarse marsh grass.

43459 Enter marsh - alder mgr.

41717 intersect fence running N-S. - south appx.  
 200' to sh. of lake

39460 Set appx. CCC. w. to car

26440 cont. west from  $\frac{1}{2}$  car

$\frac{33}{4}$

Aspen 6' N. 40 E 26/ks  
 Birch 6' S. 64 E 26/ks  
 pine 16' S. 45 W. 7/ks  
 Birch 5' N. 22 W. 11/ks

Found:  
 no evidence

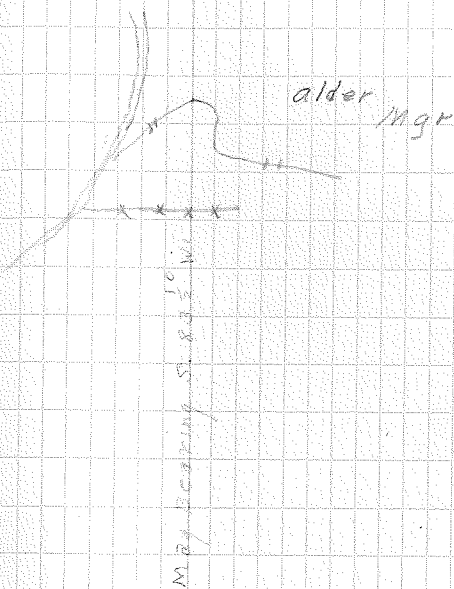

26440  
 41717  
 39460

26+40 set Appar. cor.  $\frac{1}{4}$  cor.

138-29

 $\frac{34}{3}$ 

13+20

Cor. E. to cor.

1400

started ~~E~~ West from cor. $\frac{23}{27}$   $\frac{34}{312}$ ~~138-27~~ 138-27

Date - April 12, 1959

Dept. 13.  
Woodchick  
Michaelson - NotesEspinoza - ar  
Johnson - ch.  
Hollister - ar

Look for:

Spruce 4" N. 1/4 W. 16 1/2 ft.

Spruce 4" S. 4 1/2 E. 16 1/2 ft.

Found:

Found:

No evidence.

M39 Bearing 189 deg. 5.88 m.  
Chain along brush line  
Old fence line138-27  
138-27  
138-27

138-27

52+10

Random line from North intersects Line  $\frac{33}{43}$ 

Set Appr. C.C. section corner at this point.

39+60

Set Appr. C.C. w. to car

26+40

cont. west  
~~East~~ from  $\frac{1}{4}$  cor.  $\frac{34}{3}$ 

Look for:

Found:

Aspen 7" N. 78° E. 8 1/2 k.

No evidence

" 8" S. 17° E. 8 1/2 k.

" 7" S. 47° W. 14 1/2 k.

W. Birch 5" N. 47° W. 20 1/2 k.

Map bearing 145° E. 5.850W  
old Random linep. 138  
138-27  
14.

26743 Fence Runs north

138-27  $\frac{26}{100}$

16459 Fence south open Field south of Line

~~16459 Fence south open Field south of Line~~

~~of 500 ft. S. of line~~

Void April 11, 1939 W. Ry.

35/36 137-138-21

0400 started West from cor.

~~35/36~~ 137-27

April 11, 1939

Wedderburn

Estimate

Tahlequah

Higdon

1 act 1/2

Higdon line

1 act 1/2

in center of

road white post with

red top 19' west on line

Also yellow tag on

post.

16/10 11/15



52+80

Set App. Section Oct  
(CCC)

138-27

~~34.35~~  
31.2~~40+20~~ Left hayfield~~40+20~~ left hayfield~~37+80~~ Set APP. CCC. W. to

37+80 Road runs North-south

Enter hayfield

37+27 Estimated distance across creek (west side)

36+395 E of creek

35+52 Creek SW. Wgs back and empty into  
another creek. Marsh ends

32+75

Left creek enter Lowland Marsh

32+33

edge of creek

36+40

cont. ~~East~~ West from car.

16.

April 11, 1939

Look for

y pine 13" N. 10. W. 148

y pine 13" N. 56 E. 170

y pine 6" S. 54 E. 142

y pine 6" S. 52 W. 60

found:

No evidence.

Woodcock - 1/2

Kestrel - 1/2

Townsend - 1/2

H. Starling - 1/2



26+40 Barbed fence runs N. 20° S and East

25+43 left spruce swp

14+34 Enter spruce swp  
18+20 set app w to corner

1+00 started East from cor.  $\frac{35}{21}$  38-27

April 1939/7

~~JP~~

Wood - CH. etc  
Estimate on

Look for  
ypine 14" North 44 lbs.  
6" S. 20 E. 24 lbs.

Found:  
104 lbs of  
115 lbs of  
I.P. scribed  $\frac{1}{4}$   $\frac{38}{1}$

SPT  
SPT

Mag. Beeping N. 24°  
State game refuge  
Boundary line

Found:

BT 6" pino 47 ft S BT 10" pino 115 ft  
N. 38° W. S. 35° E. 137 R. 27 S. 70° E. S. 11° E. 137 R. 27  
BT 8" pino 48 ft white post with red  
S. 50° W. S. 2° E. 137 R. 27 Top 19 ft E. Arrow I.P.

BT  
Count

43400 Fence ends.

40439 Road N-S.

26440 cont. East from fence.

April 11, 1939 18.

Woods-chick-axe

Estland-ch-

Johanson-ch-

Hilston-axe.

Look for:

Area from 43400 to  
Sec. 12, West Flooded  
and could not check  
the distance to Sec.  
10. April 11, 1939

Mag. bearing N 0° E  
Panther

26440  
4/11/39  
H.D.

26+40 → Falls in lake East between  $\frac{25}{36}$  138-27  
sta.

21+90 Enter Lake Pass

13+20 set temp. CCC  $\frac{1}{4}$  cor. (W.)

12+30 Barbed fence running north-s.

7+97 trail runs N. 20° E.

2+50 Barbed fence running south

0+00 Started East from cor.  $\frac{26}{35}$  137-7  
3536

Apr. 10, 1939

17.

Party  
Woods - chf.  
Estrom - chain  
Johnson - chain  
Hilts - Em - B. Mack

Look for:

Lake Pass

Found:

Look for:

No. post on W. side of lake

Hard pine 6" S. 90° E. 700 lbs

Dry pine 6" N. 11° E. 900 lbs

Found: No

Evidence

old line re-brushed.

□ Farm

New B.T. New B.T.

County rd.

Plot of  
4/14/39

53737 Reached Intersection of 3 roads

48747 fence runs south

43759 Barbed runs N.W. - S.E.

39760 Set temp CCC E.  $\frac{1}{6}$  cor.

37760 Left Lake Bass (E. shore)

26740 continued east across lake

county rd.

W.M.  
bearing  
iron pipebearing iron pipe  
W.M.

Sec. cor. at

Chap  
LandRd. Intersection  
(Not located)Farm  
Address  
Tel.

Look for:

pine 18" N.  $1\frac{1}{2}$  E 470 lks.

" 7" S 82 E 291 lks.

" 18" S 35 W 472 lks.

" 20" N 1 W 605 lks.

Found:

IP. witness cor.

IP. witness cor.

Look for:

N.C. post on E. side lake

Dry pine 12" S.E.W. 211 lks.

" " 20" N.S.E. 208 lks.

Found: no

evidence

Lake Bass

26-40

$$\frac{12}{13}$$

135

8+70 HIT MITCHELL LAKE (W. SHORE)

0+00

Started E from temp. spec. cor.

$$\frac{11}{14} \frac{12}{13} 135$$

CAN. 16, 1940 21

 PARTY  
 BECKER - CHIEF  
 DEYMAN - CHN.  
 MINNERATH - STR.  
 HAYBANK - AXE  
 ROTHSTEIN - AXE

W

Look for:

LAKE MITCHELL

Beating  
Ransom Line

Magnetic

 At 504.2' Look for W.M.C.  
 ASPEN 5" N 65W, 50M  
 W. Birch 7" S 15W, 50M

Var. 6°

51491 FOUND SEC. ~~14~~<sup>13</sup>-138-27 IN CENTER OF  
COR. MITCHELL LAKE ROAD  
85 Feet North.

39464 SET TERRACES COR. (E)

35444 BARBED TURNS E. W.

31488  
31700 WEST LAKE MITCHELL (E. SHORE)

36400 CONT. E. ACROSS LAKE

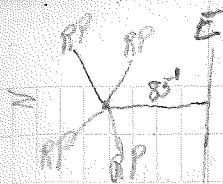

JAN. 17, 1947  
PARTY  
BECKER - CHIEF  
MUNNERTH - C.M.  
DEIMAN - B.M.

FOUND 4 RP-TREES  
2 1/2" WHITE PINE S.W.  
6" BIRCH S.E.  
6" ASPEN N.W.  
8" OAK N.E.

Look for:  
at 3410.2' E.M.S.  
E.P. 6" N55E, 51KS.  
W.P. 6" S30W, 141KS.

6°

138-27

west between  $\frac{1}{12}$ 26+40 Set two inch aspen  
stake

139

13+20 Set temp. ccc E.  $\frac{1}{16}$  cor.  
2" Aspen stake

5+55 Center of Mitchell L. Tr. Trail

2+27 Leave Bag (L. Tea, leather coat)

0+00 Started west from sec. 6.  $\frac{1}{12}$ 

June 2, 1939

Party

Wilde - aht.  
Eaton - Mites + rear ch.  
Egan - Head st.  
Veland - Ricket  
Cronquist - brush

23

Found: No

Pine 20" S. 27 W. 58 Lbs. Evidence  
Pine 20" N. 32 W. 37 Lbs.

Extensive section

leaf fall

Pine 20" S. 27 W. 425 Lbs

Pine 17" S. 24 W. 385 Lbs.

Pine 17" S. 27 W. 493 Lbs

Pine 16" S. 27 W. 334 Lbs

Mitchell's Bearing - S. 88 W.

Random L. 1/2 mi

2. P. in bag and 150' north of edge of 7 ac. pot-hole

Mar. 70



53+39 set squared  
5 ft. N. of old stake  $\frac{2}{11} \frac{1}{12}$

43+42 Daggett Brook - approx. 15' wide  
43+41 Leave SWP.

39+60 set Temp. w. to cor. 2" Aspen stake

35+00 Enter SWP. (willow, alder, marsh grass)

31+48 Center of trail

26+40 continued west

June 5, 1939

27

Notes:

Pine 20" N. 37° E. 321Ks

Pine 6" N. 62° W. 181Ks.

Pine 11" S. 55° E. 601Ks

Pine 7" S. 60° W. 211Ks

Found: 2" stake

faced on 4 sides

A scythe blade stuck in

ground besides stake,

which appears to be

← about 10 yrs. old.

Noted old brushed

out line N. &amp; S.

break from old stake,

also, several old

blazes and new

blazes, on aspen

and N. Pine.

Abandoned  
saw mill

26+40 west between  $\frac{2}{11}$  138  
set Temp & cor. 2" Aspen stake

17+00 Leave Spruce - Tam. swp.

14+34 Enter Spruce - Tam. swp.  
13+20 set Temp. & cor. 2" Aspen stake

2+59 Reached woods trail - Grubbed to  
a 10 ft width.

at 00 started west from temp. cor.

$\frac{2}{11}$

June 6, 1939

Party: Same except 25  
Holland brush  
Cronquist pickets.

004 for:

Birch 6" N. 37° E. 291 Ks.

7" S. 13° E. " "

Found: No evidence

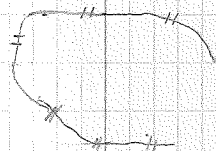

M. 13.5

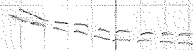

Var: 50

Ren on old brushed  
out line, a 70  
var.

52+80 Set Temp sec. Cor. 3"  $\frac{3}{2}$   
 Aspen stake 10 "

~~41+00~~ 41+00 Leave Swp. Willow-Tam.

25+30 Enter Swp. Willow-Tam.

26+40 Continued west

June 8, 1939

26

Notes:

Found! Nothing

Birch 6" N. 50° E. 12/Ks.

Aspen 12" N. 60° W. 34/Ks.

" 7" S. 45° E. 15/Ks.

W. Birch 7" S. 46° W. 41/Ks.

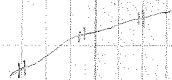
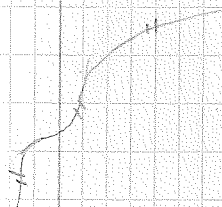

0

west between  $\frac{3}{10}$  138-27  
 2640 Set Temp. 41 corner

3" Aspen blazed on 2 sides  
 sharpened on end put in  
 ground 6"

11415 Leave Mgr

10400 Enter Swamp. Mgr

8400 A 12" white pine in center of  
 line running west

2455 Leave Swamp

1456 edge of Swamp

0400 started west from temp. cor.  $\frac{3}{10} \frac{2}{11}$

see later

Aspen 6" N. 200W. 51Ks

Maple 4" S. 80W. 27/Ks

Found:

NO Evidence

Aspen

Aspen

Aspen

Aspen

Var 70

51+86 set temp. sec. cor.  $\frac{4}{3}$   
A 3" squared birch  $\frac{9}{10}$

(dist. to sec. cor. is original  
chainage)

46+30 Leave Mgr. Swamp

45+10 Enter Mgr. Swamp

39+60 set temp. CCC. W.  $\frac{1}{6}$  cor.

36+47 Leave Swamp

35+00 Enter Mgr. Swamp

26+40 Continued west

June 30, 1939

Report:

Pine 24° N. 77° E. 144 lks.

Pine 30° N. 32° W. 218 lks.

Pine 15° S. 50° E. 170 lks.

24° S. 50° W. 194 lks.

Part of Woods - Picket's vein.

Holland - Rear ch.

Dieman - Head ch.

House - axe

Morse -



Found: Nothing

No evidence at 51+86

But at 1+57'

in the next mile

found a 3" Birch  
squared up - possible  
the sec. cor. - No

signs of original  
corner.

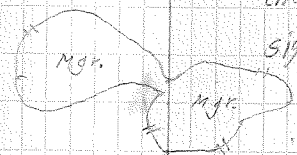

west between  $\frac{4}{9}$  138-27  
 26+33 Set temp. cor.  $\frac{1}{4}$  corner  
 a

13+20 set temp. C.C. E  $\frac{1}{16}$  cor.

1457 Found old blazed trees. <sup>3" birches</sup> - No tree  
 0+00 started W. from temp. cor.  $\frac{4}{9}$

date taken - N. Michaelson

Look for:

1. 5" S. 300E. 19/Ks.  
 2. Pine 8" N. 150W. 40/Ks.

Found:

No evidence

Aspen  
 B.M.

Random line  
 magnetic bearing N 81  $\frac{1}{2}$  W.

Aspen

B.M.

Public lands North of Random line

evidence

Var: 55°

Dist. to  $\frac{1}{4}$  and sec. cor. is original chainage

138-27

52+67 Set approx. sec. cor.  
 52+25 Found a W. pine stump - 80' so. - has a mark  
~~52+64~~ Set temp. ecc. Sec. cor. 5 | 7  
 52+20 Left swamp grass. 3 birch 8 | 9 138-27  
 A  
 50+50 Entered swamp grass.

39+60 Set temporary C.C. W. 1/2 Cor.

36

32+00 Entered Aspen quit for day

26+33 continued W. from temp. cor. 4

Look for:

W. Pine 36" N. 35° E. 24 lbs  
 " 24" N. 52° W. 20 lbs  
 " 30" S. 40° W. 26 lbs.  
 Tam. B. 5.31° E. 5.6 lbs.

Found:

Faudel ✓  
 Burton ✓  
 No certain evidence

Found at 5225' a 20"  
 W. Pine stump all burnt  
 & cut up at 80' so. of line  
 This stump has a 27"  
 mark which looks like  
 a possible scribe mark.

Mag. bearing  
 J. N. 213° V  
 W. Random line

Aspen

B.M.

Party. 30  
 Michaelson - notes  
 Dieman  
 Horse

West between  $\frac{5}{8}$ 

138-27

20455 Left Swamp  
 19406 entered Swamp.

10496 Left Swamp.

6455 edge of Swamp.

1427 Blazed line N-S

0400 started West from temp. sec. c.  $\frac{5}{8} \frac{4}{9}$

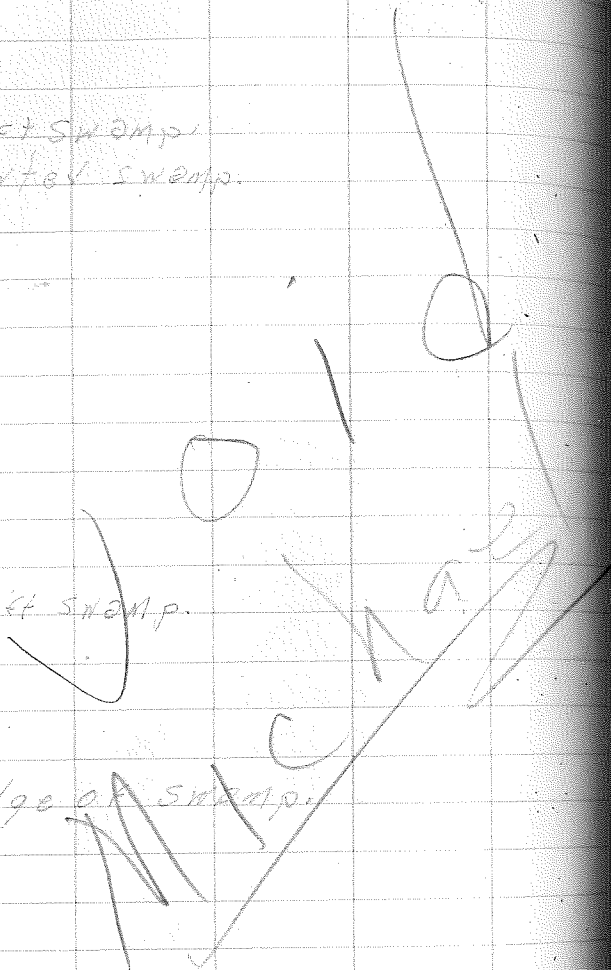

JULY 5, 1939

10014 fir

Maple 5" S. 45° E. 28 lbs.

Birch 7" N. 20° E. 32 lbs.

Found: Woods-cree  
 Dicentra  
 Holland-cree  
 House-cree  
 poplars

SON  
 July 5, 1939

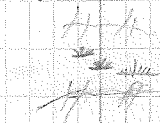

Along Boundary S. 80° E. W  
 Road on line.

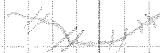

Temp: 6°



26+40 Set approx  $\frac{1}{4}$  cor. W  $\frac{6}{7}$  -  
3" aspen stake.

16+00 entered Mgr. Swamp

13+20 Set approx  $\frac{1}{16}$  cor. E

8+10 Left st. swamp entered Hb. 0-1

8+00 entered swamp S.T.

0+00 started ~~east~~ <sup>W</sup> from section cor.  $\frac{165}{70}$

Notes:

~~1200 T N. 45° W 350 lks~~  
~~PINE 415. 100° E. 579 lks~~  
~~1200 C S. 37° W 262 lks~~

Found!

No evidence

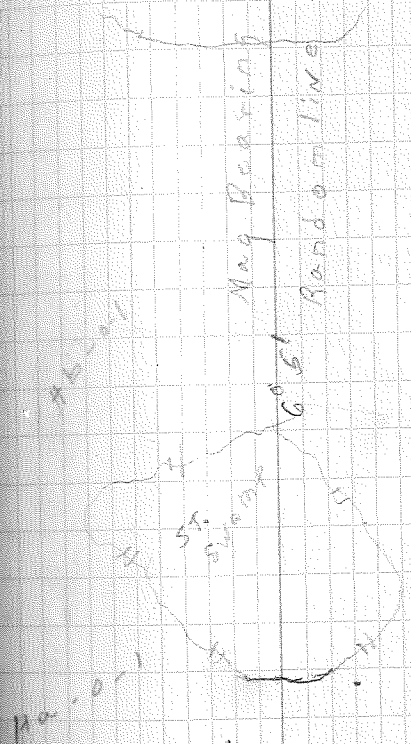

cor. - 60

50+82 Set trap. Sec. con  $\frac{1}{6}$   
127

47+30 Crossed trail going through meadow

46+00 Left Mgr Swamp, entered upland  
hay meadow

39+60 Set APPROX to cor E

26+40 Continue W. from approx 1/4 sec W.

Found:  
No evidence  
upland hay meadow

Distance 97 chs

or 5092 ft

Mag. Bearing

Random

26445 Set Approx. 1/4 Cor

5  
8

23400 Left Swamp.

19400 Entered swamp. Mgr. Mt. S.W.

13450 Left swamp, mgr. Mt.

13420 Set Approx. W. 1/16 Cor.

9433 Enter swamp mgr. Mt.

0400 Started from sect.  $\frac{6}{7}$   $\frac{574}{89}$  Cor. 135-

Nov. 15, 39

Bedner Chr.

Anderson Pickets

Johnson to Ch. & Mt.

Davis Are

Meelberg Are

Found:

No evidence

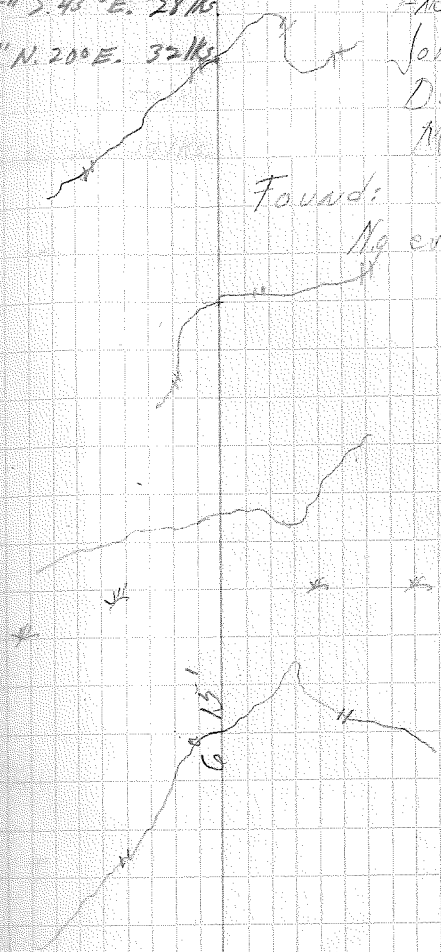

18436 edge of Lake - Eagle  $\frac{13}{24}$  1300

This line  
Was  
run from West -

5476 crossed fence N-S

5400 started West from  $\frac{13}{24}$  1300 T138-227

July 12 1939

Woods - chip - notes

Dahl - brushing

Fauxie - brushing

Holland - brushing

Diehard - brushing

Crow Nest - pickets

Eagle

—

May Bearing S 87° W  
Pickets M line

Found?

21" ip with oval

shape cap scribed

13 18

24 19

16" Norway pine Due  
West from 13 18 with Metal Tag 23'

19" Norway pine S 87° W

with Metal tag distance 32'

14" Norway pine S 57° E

with Metal cap

Distance 32'

5476

6 1/2°

52790 Set Approx sec cor

6/5/14 138-27  
7/8/1458799 Offset on Line 1450 N.  
58799 Left Swamp

46757 Offset South 1450

42793 Entered swamp near mt.

39760 Set Approx 1/16 cor. w.

26740 Continued west from 1/16 cor. Entrance, near

Nov. 16, 1936

Party:

Becker Ch.

Anderson Picket

Ch. Johnson Notes

Davis Ave

Meekburg Ave

Look for:

Jack Pine 4" NW 3000

W. Pine 4" SW 1700 N 2000

Aspen 6" S 3500 2600

Distance: 8000 1500

11 1936

Found -

Map of the  
Swamp

Next  $\frac{1}{2}$  mile going west see page 6.

This line was rerun from West

18+58 Edge of Lake Mitchell

V 0/19

10+26 fence N-S

V 0/19

8+00

started west from

$\frac{12}{13}$  17

T 138 R-27

T 138 R-26

July 12 1939

woods - oak - notes

oak - bushing - oak

oak - bushing

oak - bushing

oak - bushing - pines

lake

M 29. Bearing 100° W  
Random line

Aspen  
Mixed brush

Aspen  
Mixed brush

Refer back to page 5.

went to see corner  $\frac{12}{13}$  17

I found the I.P. had been  
pulled out of the ground

and was hanging in a 4"

~~tree~~ trunk. Approx. 40' south

west of where corner

should be. There was a

new road being built and

they had tied a tree into

the corner being pulled

out the I.P. I chained out

the distance that was on

the trees and set compass

where all four points came

together and started line

west.

var.  $6\frac{1}{2}$ °

East between  $\frac{18}{19}$  138-27  
 20400 Crossed edge N-5  
 25408 Reached I.P.  $\frac{1}{4}$  cor. and set  
 a squared birch stake.  
 Continued east and began  
 brushing.

13420 Set temp ecc. N.  $\frac{1}{16}$  cor.

8458 Reached rd. into farm.

4458 Reached rd. into farm.

0400 Started E. from <sup>temp.</sup> Sec. cor.  $\frac{13}{18}$   $\frac{18}{19}$  on rd.

June 13, 1939

Look for:

W.P. 20" N27E 49 LKS  
 Break 12" S45E 70 LKS

Map 74  
 38  
 W. P. - conpr. Dieman  
 Paul - ch. Holland  
 Lawrence - ch. Holland  
 Metase. Metas. Cronquist

IP  
 Found: I.P.  $\frac{1}{4}$  cor. - Edge  
 of rd. at turn.  
 I.P. W.P. Mon. - N.45E - 45'  
 I.P. W.M. - S.45E - 45'  
 I.P. W.M. - N.45W - 45'  
 I.P. W.M. - S.W. - pulled  
 out & lying on ground.

Location Sec. cor. determined by  
 measuring west the required  
 2508' from permanent I.P.  
 $\frac{1}{4}$  cor. between  $\frac{18}{19}$

5261 Cor. in slough - under water

5261'

5148' into the next mile.  
113'

46430 Edge of pot Hole Lake  
setup compass Make right  
Angle to line for 100' then  
triangulated distance across  
lake, R.W. Johnson doing the  
figuring of the distance.

Least fork:  
W.P. 24" N 11 1/2° E 27 245.  
W.P. 20" N 33 1/2° W 70 245.  
W.P. 20" S 34 1/2° E 18 245  
W.P. 35" S 42° W 70 245

Found: No evidence.

Short mile 5148'

$$\tan 81^\circ = \frac{a}{100'}$$

$$\tan 81^\circ = 6.3138$$

$$6.3138 = \frac{a}{100}$$

$$a = 631.38'$$

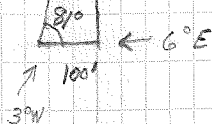



East between  $\frac{17}{20}$  T 138-R-27  
2.4-4.0 set temp. 4 cov. 1/2 Aspen stake  
2.5-7.5 edge of SWP M. 9.8

1+13 started chaining east from water edge -  
0+00 in water  $\frac{18}{19}$   $\frac{19}{20}$  T 138-R-27

\* \*  
\* \*  
H H

JUNE 15, 1939

Look for  
y pins - N 3/4 W 25 1/2 S.

Woods - CHE notes  
Holland, OH  
Fouquieria  
diandra  
along west side.

Found: No evidence

More about 1/2 N 3/4 W  
Ponded Lake

Var. 60

32180 Set Temp. sec. cor. 3" Aspen stake

39160 Set Temp. E. to cor. 2" Aspen stake

36130 quit chaining June 19-1939.

28+48 Left S.W. p. M. 9 R.

Continued East from 1/4 cor.

Look P.O.Y.

Found: no

Charred stump N 30 E 1/4 Ks. Evidence

" " S 40 E 2 1/4 Ks.

May bearing N 30 E  
Pardon line

11-11  
x 2  
x

V. 6°

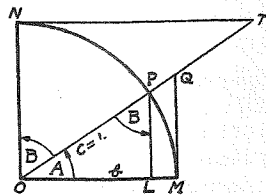

TABLE II

TRIGONOMETRIC FORMULAE

$$\angle A = \angle MOP \quad \angle B = \angle PON = \angle OPL$$

$$R = OB = c = 1$$

$$\sin A = \frac{a}{c} = \frac{a}{1} = a = \cos B = LP$$

$$\cos A = \frac{b}{c} = \frac{b}{1} = b = \sin B = OL$$

$$\tan A = \frac{a}{b} = \frac{MQ}{OM} = \frac{MQ}{1} = MQ = \cot B = MQ$$

$$\cot A = \frac{NT}{ON} = \frac{NT}{1} = NT = \tan B = NT$$

$$\sec A = \frac{OQ}{OM} = \frac{OQ}{1} = OQ = \csc B = OQ$$

$$\csc A = \frac{OT}{ON} = \frac{OT}{1} = OT = \sec B = OT$$

$$\text{vers } A = \frac{LM}{OP} = LM = \text{covers } B \#$$

$$\text{covers } A = \frac{OP - LP}{OP} = OP - LP = \text{vers } B$$

$$\text{exsec } A = PQ = \text{coexsec } B$$

$$\text{coexsec } A = PT = \text{exsec } B$$

$$\sin \frac{1}{2}A = \sqrt{\frac{1 - \cos A}{2}} \quad \cos \frac{1}{2}A = \sqrt{\frac{1 + \cos A}{2}}$$

$$\sin 2A = 2 \sin A \cos A \quad \cos 2A = \cos^2 A - \sin^2 A$$

$$\text{Law of Sines} \quad \frac{\sin A}{a} = \frac{\sin B}{b} = \frac{\sin C}{c}$$

$$\text{Law of Cosines} \quad c^2 = a^2 + b^2 - 2ab \cos C$$

$$\text{Law of Tangents} \quad \frac{a+b}{a-b} = \frac{\tan \frac{1}{2}(A+B)}{\tan \frac{1}{2}(A-B)}$$

11/11 started back from Sec. 11/11 2012