

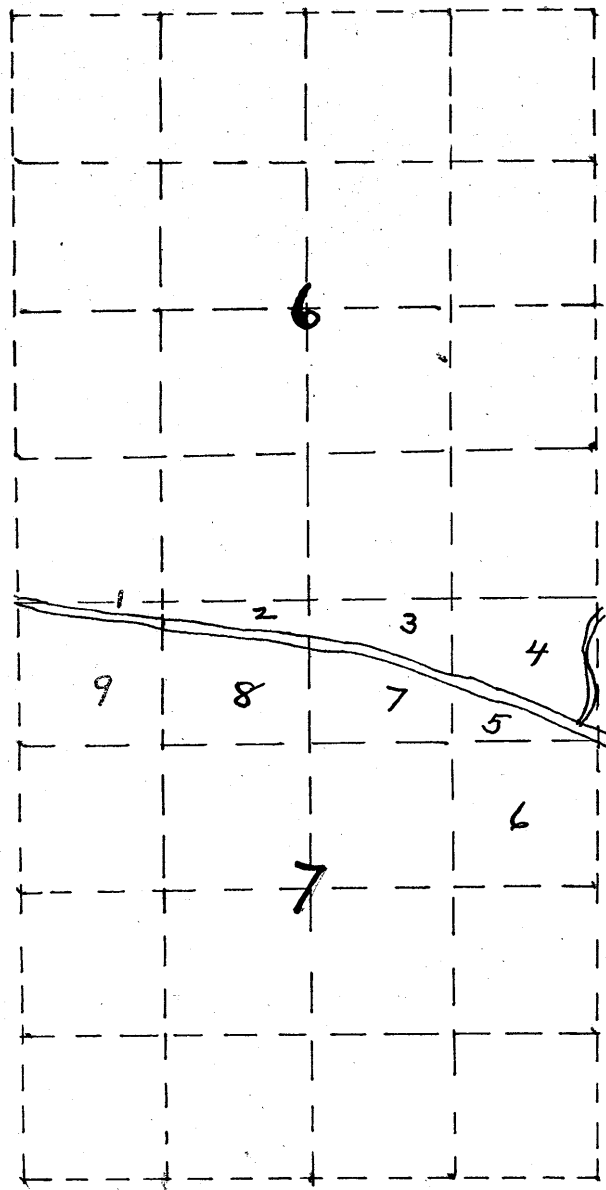

TOWN. 137 N. RANGE 29 WEST OF 5TH P. M.



 U.S. FEE TITLE BY PURCHASE OR CONDEMNATION
 FLOWAGE RIGHTS

**PINE RIVER RESERVOIR
SURVEY AND MAP**

MADE UNDER THE DIRECTION OF

LIEUT. COL. W. A. JONES, CORPS OF ENGINEERS, U. S. A.

AND

MAJOR FREDERICK V. ABBOT, CORPS OF ENGINEERS, U. S. A.

W. C. WEEKS, ASSISTANT ENGINEER, 1897

E. MILTON FOWBLE, SURVEYOR, 1929.

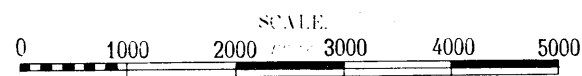

NOTE:

CONTOUR 1236.7 FEET ABOVE THE SEA SHOWN THIN — 36 —
 CONTOUR 1240 FEET ABOVE THE SEA SHOWN THICK — 40 —
 TO REDUCE THE ELEVATIONS ON THIS MAP TO ACTUAL SEA
 LEVELS OF MISSISSIPPI RIVER COMMISSION (PREVISE LEVELS)
 SUBTRACT FEET

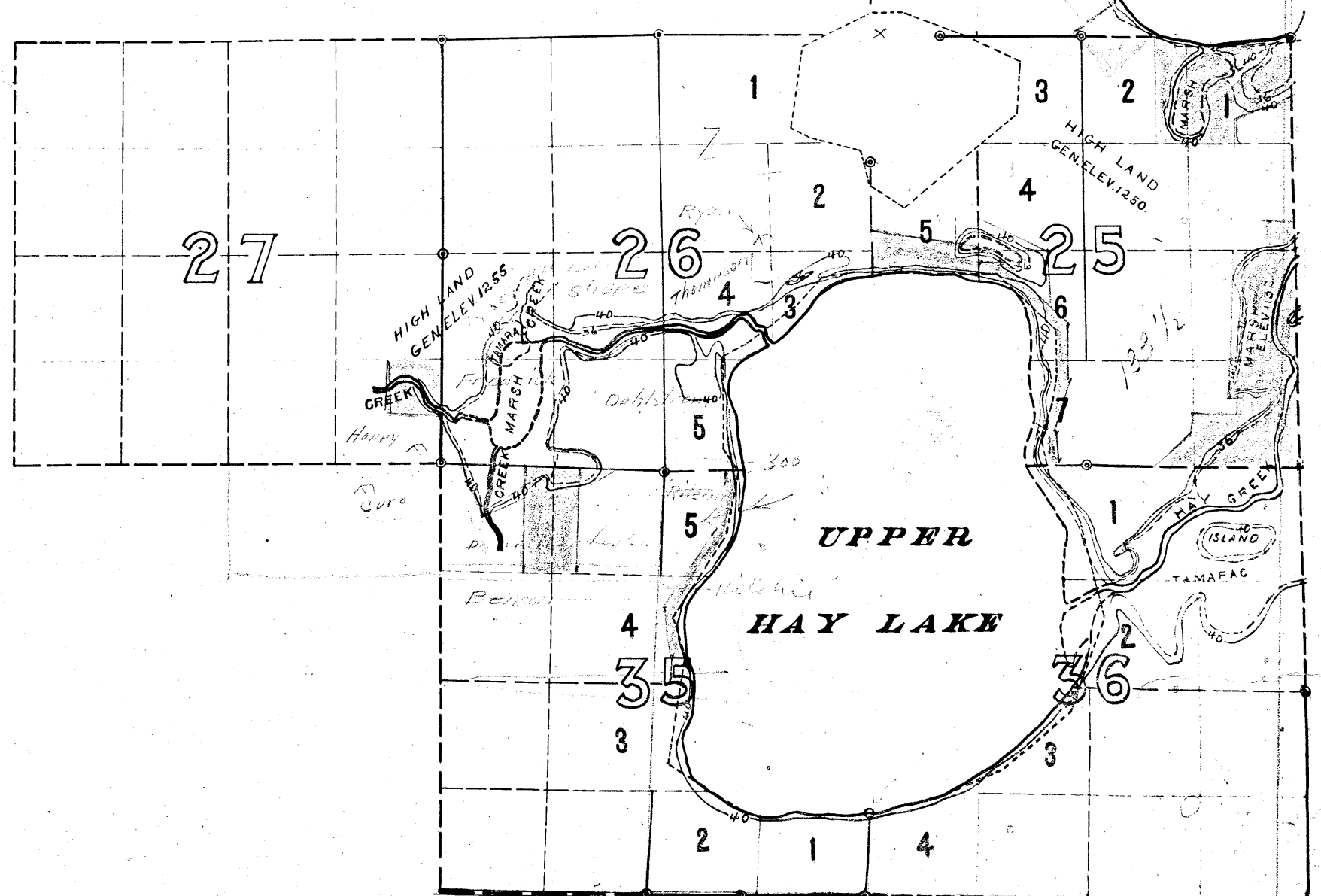
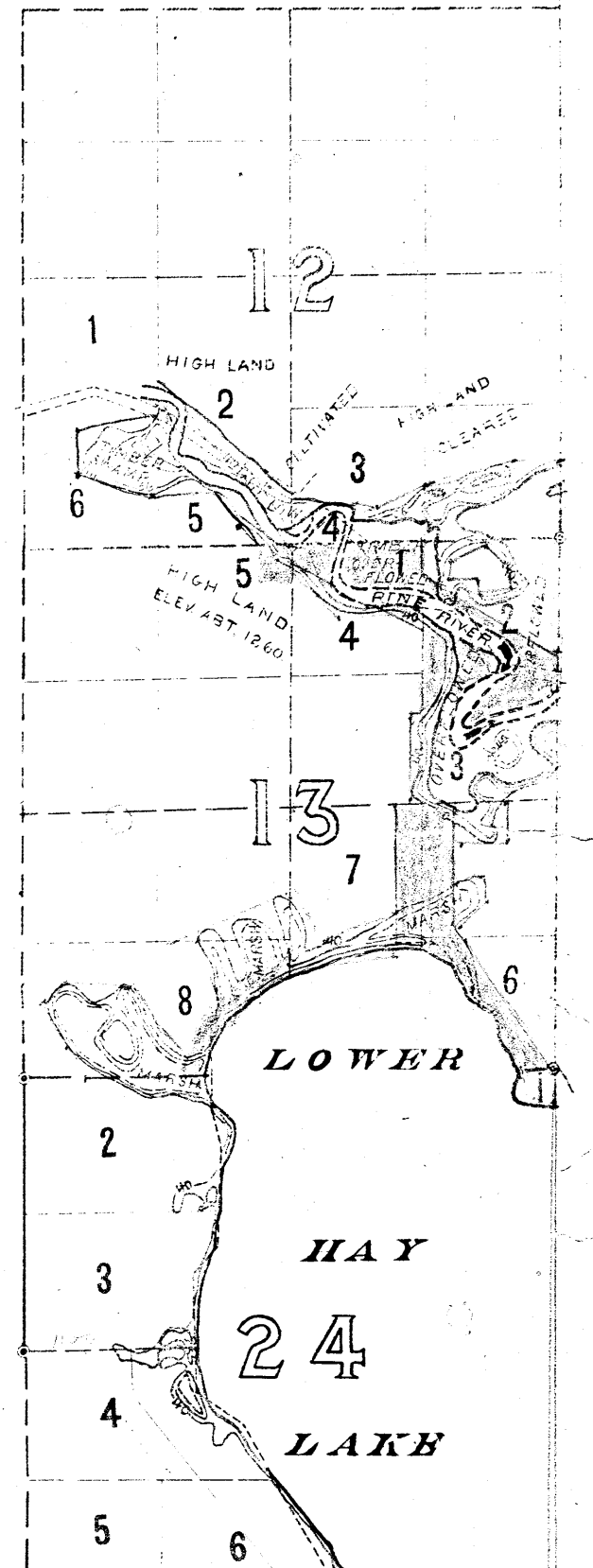

137-29 #7801

26

F

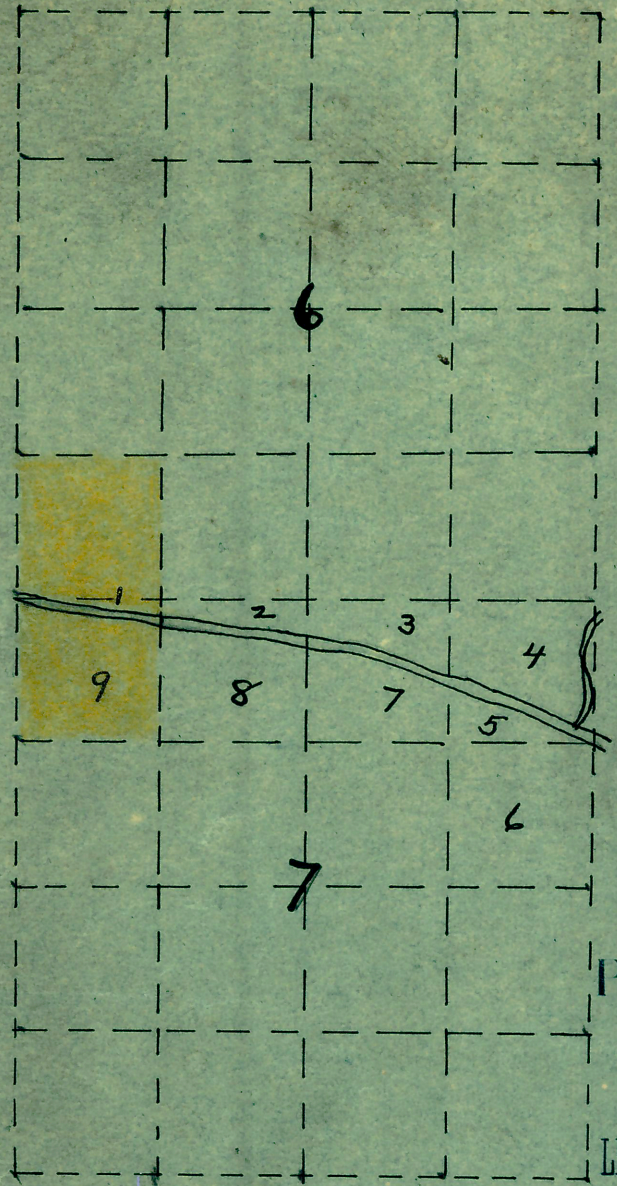

U.S. FEE TITLE BY PURCHASE OR CONDEMNATION
 FLOWAGE RIGHTS

PINE RIVER RESERVOIR
 SURVEY AND MAP
 MADE UNDER THE DIRECTION OF
 LIEUT. COL. W. A. JONES, CORPS OF ENGINEERS, U. S. A.
 AND
 MAJOR FREDERIC V. ABBOT, CORPS OF ENGINEERS, U. S. A.
 W. C. WEEKS, ASSISTANT ENGINEER, 1897.
 T. MILTON FOWBLE, SURVEYOR, 1899.

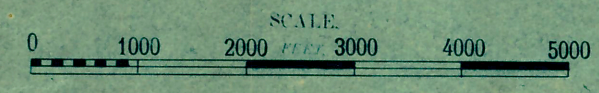

NOTE:
 CONTOUR 1236.7 FEET ABOVE THE SEA SHOWN THUS — 36 —
 CONTOUR 1240 FEET ABOVE THE SEA SHOWN THUS — 40 —
 TO REDUCE THE ELEVATIONS ON THIS MAP TO ACTUAL SEA
 LEVELS OF MISSISSIPPI RIVER COMMISSION (PRECISE LEVELS)
 SUBTRACT FEET



F