

CERTIFICATE OF SURVEY

PART OF THE SOUTHWEST QUARTER OF THE SOUTHEAST QUARTER,
SECTION 18, TOWNSHIP 143 NORTH, RANGE 31 WEST,
CASS COUNTY, MINNESOTA

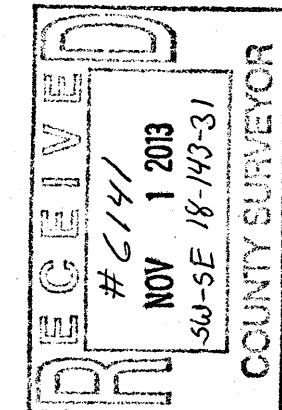

PROPOSED DESCRIPTIONS:

SOUTH TRACT

That part of the Southwest Quarter of the Southeast Quarter, Section 18, Township 143 North, Range 31 West, Cass County, Minnesota, described as follows: COMMENCING at the southwest corner of said Section 18; thence South 89 degrees 20 minutes 57 seconds East, assigned bearing, along the south line thereof 3415.00 feet; thence North 00 degrees 03 minutes 48 seconds East, parallel with the west line of said Section 18, for a distance of 165.00 feet; thence North 89 degrees 20 minutes 57 seconds West 276.96 feet to a point on the east line of said Southwest Quarter of the Southeast Quarter, the point of beginning of the tract to be herein described; thence North 00 degrees 05 minutes 56 seconds East, along said east line 53.84 feet to a point distant 271.28 feet southerly of the southeast corner of the North 5/8 of said Southwest Quarter of the Southeast Quarter; thence North 89 degrees 20 minutes 57 seconds West 1307.51 feet to the west line of said Southwest Quarter of the Southeast Quarter; thence South 00 degrees 06 minutes 31 seconds West, along said west line 53.84 feet to the intersection with a line bearing North 89 degrees 20 minutes 57 seconds West from the point of beginning; thence South 89 degrees 20 minutes 57 seconds East 1307.52 feet to the point of beginning.

Containing 1.61 acres, more or less.
Subject tract is non-conforming on it's own and must be attached to an adjoining parcel. (PIN 20-018-3406)

NORTH TRACT

That part of the Southwest Quarter of the Southeast Quarter, Section 18, Township 143 North, Range 31 West, Cass County, Minnesota, described as follows: BEGINNING at the southeast corner of the North 5/8 of said Southwest Quarter of the Southeast Quarter; thence South 00 degrees 05 minutes 56 seconds West, assigned bearing along the east line thereof 271.28 feet; thence North 89 degrees 20 minutes 57 seconds West 1307.51 feet to the west line of said Southwest Quarter of the Southeast Quarter; thence North 00 degrees 06 minutes 31 seconds East, along said west line 270.83 feet to the southwest corner of said North 5/8 of the Southwest Quarter of the Southeast Quarter; thence South 89 degrees 22 minutes 39 seconds East, along the south line of said North 5/8 of the Southwest Quarter of the Southeast Quarter 1307.46 feet to the point of beginning.

Containing 8.13 acres, more or less.
Subject tract is to be attached to adjoin parcel(PIN 20-018-4406).

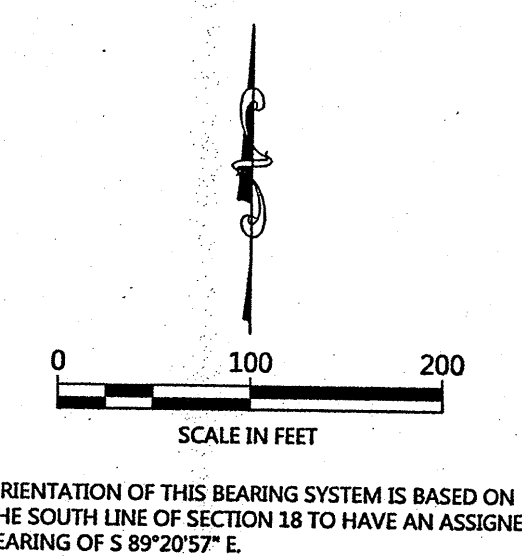

- ### LEGEND
- DENOTES IRON MONUMENT SET & MARKED BY LICENSE NO. 21367
 - DENOTES MONUMENT FOUND
 - × DENOTES CALCULATED POSITION

NO.	DATE	DESCRIPTION	BY

HEREBY CERTIFY THAT THIS SURVEY, PLAN OR REPORT WAS PREPARED BY ME OR UNDER MY CLOSE PERSONAL SUPERVISION AND THAT I AM A DULY LICENSED LAND SURVEYOR UNDER THE LAWS OF THE STATE OF MINNESOTA.

Terry L. Freeman
TERRY L. FREEMAN
LIC. NO. 21367

NORTHERN ENGINEERING & CONSULTING, INC.
P.O. Box 293, Walker, MN 56484
Phone: 218-547-1281
web: www.necusa.com

CERTIFICATE OF SURVEY
Curt Ulferts
23313 South US Highway 75, Site 22
Lyndon, KS 66451

JOB NO. 13-161
DATE: 11-01-2013
SHEET NO.
1 OF 1