

Sketch of  
 North 100 feet of the South 200 feet of Government Lot 1  
 Section 14 Township 139<sup>N</sup> Range 26<sup>W</sup> of the 5<sup>th</sup> P.M. Cass County Minnesota  
 Prepared by Harold Curo County Surveyor of Cass County Minnesota  
 Showing the Locations of the buildings there on.



**CERTIFICATE**

I the undersigned Harold Curo hereby certify that I am a Registered Land Surveyor in the State of Minnesota. That I have prepared this sketch showing the locations of the building now located on the N 100 feet of the S 200 feet of Gov'l. lot 1 Sec 14 Twp 139 Rge 26.

Report

That Edward F Meyer record owner is in possession of the property that there are no visible repairs or improvements accomplished within the last 90 days. That there are no encroachments and no violation of building restrictions. That all improvements are within the boundary lines of said property as shown by this sketch Dated this 11<sup>th</sup> day of September 1953

Scale  
 1 inch = 50 ft

Section 15  
 Section 14  
 Section line of State Highway No 6

75 ft

200 ft  
 100 ft

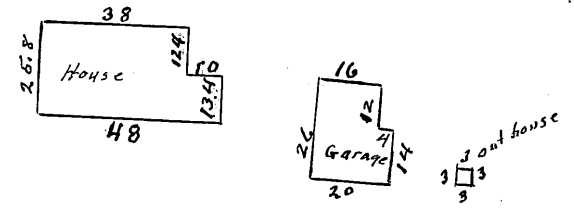

South line of N. 100 ft of S 200 ft of Gov't lot 1

South line of Gov't Lot 1

75 ft

100 ft