

# CERTIFICATE OF SURVEY



- LEGEND**
- DENOTES UTILITY POLE
  - DENOTES TELEPHONE PEDESTAL
  - DENOTES OVERHEAD ELECTRICAL LINE
  - DENOTES GUY ANCHOR
  - DENOTES GRAVEL SURFACE
  - DENOTES BITUMINOUS SURFACE
  - DENOTES CULVERT
  - DENOTES MINOR (1 FOOT) CONTOUR LINE
  - DENOTES MAJOR (5 FOOT) CONTOUR LINE

S. LINE NE 1/4 OF SE 1/4, SEC. 30, T. 140, R. 30, CASS COUNTY, MINNESOTA  
 W. LINE GOVT. LOT 8, SEC. 30, T. 140, R. 30, CASS COUNTY, MINNESOTA

**BENCHMARK:**  
 RR spike on west side of utility pole  
 Elevation = 1400.28 feet (NAVD 88), 1996 adjust.  
 Location is shown on this survey.

## TREE TABLE

No.	Tree Type	Tree Size	Notes	No.	Tree Type	Tree Size	Notes
1	Burr Oak	10"		63	Burr Oak	7"	
2	Burr Oak	13"		64	Burr Oak	7"	
3	Burr Oak	9"		65	Burr Oak	8"	
4	Burr Oak	6"	Double	66	Burr Oak	8"	
5	White Pine	6"		67	Burr Oak	6"	
6	Burr Oak	11"		68	Burr Oak	9"	Double
7	White Pine	6"		69	Burr Oak	8"	Quadruple
8	Burr Oak	7"		70	Burr Oak	8"	Double
9	Burr Oak	9"		71	Burr Oak	8"	
10	White Pine	5"		72	Burr Oak	9"	
11	Burr Oak	7"		73	Burr Oak	5"	
12	Burr Oak	8"		74	Burr Oak	8"	
13	Burr Oak	8"		75	Burr Oak	8"	
14	Burr Oak	7"		76	Burr Oak	6"	
15	Burr Oak	7"		77	Burr Oak	4"	Double
16	Burr Oak	8"		78	Burr Oak	5"	
17	Burr Oak	8"		79	Burr Oak	9"	
18	Burr Oak	12"		80	Burr Oak	9"	
19	Burr Oak	5"		81	Burr Oak	8"	
20	Burr Oak	13"		82	Burr Oak	4"	
21	Red Pine	25"		83	Burr Oak	10"	
22	Burr Oak	10"		84	Burr Oak	8"	Double
23	Burr Oak	10"		85	Burr Oak	7"	
24	Burr Oak	14"		86	Burr Oak	11"	
25	Burr Oak	8"		87	Burr Oak	11"	
26	Burr Oak	6"		88	Burr Oak	8"	
27	Burr Oak	10"		89	Red Pine	28"	
28	Red Pine	8"		90	Red Pine	21"	
29	Burr Oak	9"		91	Red Pine	19"	
30	Burr Oak	8"		92	Red Pine	10"	
31	Burr Oak	6"		93	Burr Oak	9"	
32	Burr Oak	7"		94	Burr Oak	8"	
33	Maple	13"		95	Burr Oak	12"	
34	Burr Oak	6"		96	Burr Oak	7"	
35	Burr Oak	7"	Double	97	Red Pine	18"	
36	Burr Oak	9"		98	Red Pine	17"	
37	Burr Oak	6"		99	Red Pine	17"	
38	Red Pine	18"		100	Red Pine	19"	
39	Red Pine	7"		101	Burr Oak	10"	
40	Red Pine	18"		102	Burr Oak	7"	
41	Burr Oak	6"		103	Burr Oak	5"	
42	Red Pine	17"		104	Burr Oak	8"	
43	Burr Oak	8"		105	Burr Oak	8"	
44	Red Pine	14"		106	Red Pine	19"	
45	Red Pine	19"		107	Red Pine	21"	
46	Red Pine	7"		108	Burr Oak	8"	
47	Red Pine	17"		109	Burr Oak	8"	
48	Red Pine	13"		110	Burr Oak	8"	
49	Burr Oak	9"		111	Burr Oak	10"	
50	Burr Oak	9"	Triple	112	Red Pine	22"	
51	Red Pine	15"	Double	113	Burr Oak	12"	
52	Red Pine	19"		114	Burr Oak	10"	
53	Red Pine	19"		115	Burr Oak	16"	
54	Burr Oak	9"		116	Burr Oak	14"	
55	Burr Oak	9"	Triple	117	Red Pine	20"	
56	Burr Oak	12"		118	Red Pine	20"	
57	Burr Oak	10"	Triple	119	Burr Oak	7"	
58	Burr Oak	8"		120	Red Pine	6"	
59	Burr Oak	9"	Double	121	Burr Oak	9"	
60	Burr Oak	8"		122	Burr Oak	14"	
61	Burr Oak	8"	Double				
62	Burr Oak	7"					

**\*\*Notes:**  
 1. Tree numbers 49 & 51 purposely skipped to match field notes.  
 2. Largest tree measurement listed in table for multiple tree trunk groups.

**SURVEYOR'S NOTES:**

1. Benchmark: Set RR spike on west side of utility pole. Elevation = 1400.28 (NAVD 88), 1996 adjust. Location is shown on this survey.
2. The field survey was completed on 8-25-11.
3. The utilities as shown on this survey were developed from the visible utilities across your property and is not implied nor intended to be the complete inventory of utilities in this area. It is the client's responsibility to verify the location of all utilities prior to construction or improving your property.

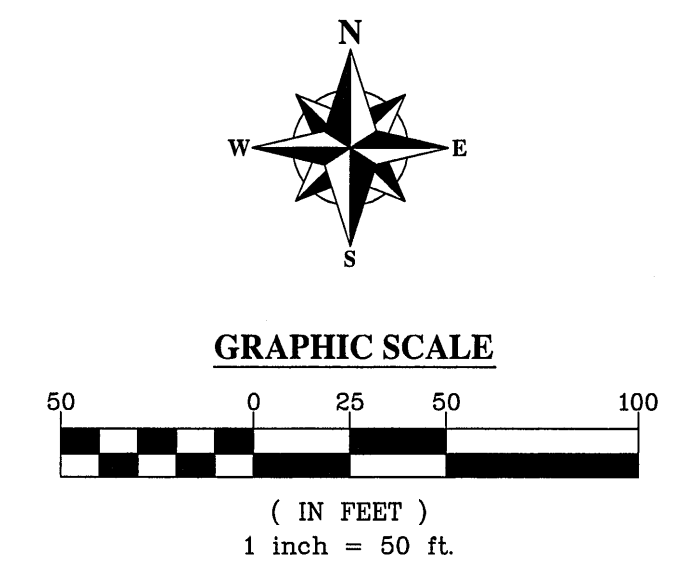

**RECEIVED**  
 # 5728  
 SEP - 9 2011  
 NE-E  
 30-140-30  
 CASS COUNTY SURVEYOR

I hereby certify that this survey, plan or report was prepared by me or under my direct supervision and that I am a duly licensed land surveyor under the laws of the state of Minnesota.  
 Dated this 7th day of September, 2011  
 By: *Bruce W. Skipton*  
 Bruce W. Skipton, Minnesota License No. 17768

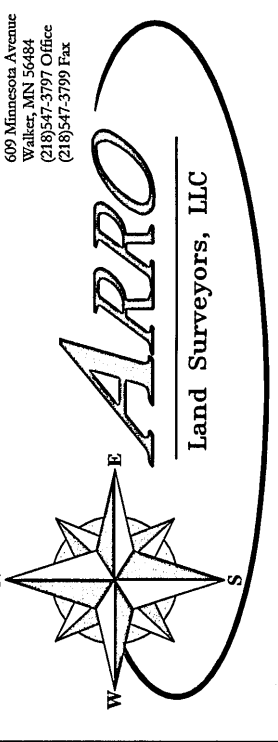

**TOPOGRAPHICAL SURVEY**  
 Part of the NE 1/4 of the SE 1/4  
 & Gov't Lot 8,  
 Sec. 30, T. 140, R. 30,  
 Cass County, Minnesota

**CLIENT:**  
 John Thomas  
 501 South 1st Street  
 Hackensack, MN 56452

DRAWN BY: <u>      </u>	CHECKED BY: <u>      </u>		
APPROVED BY: <u>      </u>	JOB NUMBER: <u>      </u>		
NO.	DATE	BY	REVISION DESCRIPTION

