

TRACT 4-0.1 ACRES
 PART SE 1/4-SE 1/4, SEC. 13
 JOSEPH D. & RUTH DOYLE
 JUNE 8, 1966
 MICROFILMED
 DOCUMENT NO. 182333

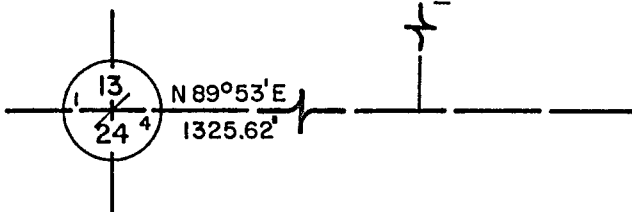

O CONSERVATION MARKER SET

MINNESOTA CONSERVATION DEPARTMENT DIVISION OF GAME & FISH		
PROPERTY MAP		
WEBB LAKE SPAWNING AREA		
CASS COUNTY- NEAR HACKENSACK		
SEC. 13	T. 140 N. R. 30 W.	5 TH. P.M.
DRAWN JAJ 7-13-65	BUREAU OF ENGINEERING	SURVEY R.F. SCHNEIDER NO. 5740
CHECKED GLC 7-14-65		DATUM
REVISED	<i>R. J. Doyle</i> 7-15-65 CHIEF ENGR.	

REQ. 64-90	SHEET 1	FILE F-617-X
------------	---------	--------------