

CERTIFICATE OF SURVEY



DESCRIPTION - (PARCEL "A")

That part of Government Lot 5, Section 14, Township 144, Range 31, Cass County, Minnesota, being described as follows:
 Commencing at the southwest corner of said government lot; thence South 86 degrees 49 minutes 51 seconds East (assuming that the west line of said government lot bears North 01 degrees 05 minutes 44 seconds West), along the south line of said government lot, a distance of 751.46 feet to the point of beginning of the parcel of land to be described; thence North 86 degrees 49 minutes 51 seconds West, along said west government lot line, a distance of 238.00 feet; thence South 79 degrees 42 minutes 26 seconds East, a distance of 680 feet, more or less, to the shoreline of Little Moss Lake; thence Southwesterly along said shoreline, a distance of 376 feet, more or less, to a line that bears South 88 degrees 06 minutes 04 seconds East from said point of beginning; thence North 88 degrees 06 minutes 04 seconds West, a distance of 788 feet, more or less, to the point of beginning.
 Said parcel contains 6.4 acres of land, more or less, and is subject to existing easements of record.

DESCRIPTION - (PARCEL "B")

That part of Government Lot 5, Section 14, Township 144, Range 31, Cass County, Minnesota, being described as follows:
 Commencing at the southwest corner of said government lot; thence on an assumed bearing of North 01 degrees 05 minutes 44 seconds West, along the west line of said government lot, a distance of 332.00 feet to the point of beginning of the parcel of land to be described; thence continuing North 01 degrees 05 minutes 44 seconds West, along said west government lot line, a distance of 238.00 feet; thence South 79 degrees 42 minutes 26 seconds East, a distance of 680 feet, more or less, to the shoreline of Little Moss Lake; thence Southwesterly along said shoreline, a distance of 376 feet, more or less, to a line that bears South 88 degrees 06 minutes 04 seconds East from said point of beginning; thence North 88 degrees 06 minutes 04 seconds West, a distance of 788 feet, more or less, to the point of beginning.
 Said parcel contains 6.0 acres of land, more or less, and is subject to existing easements of record.

DESCRIPTION - (PARCEL "C")

That part of Government Lot 5, Section 14, Township 144, Range 31, Cass County, Minnesota, being described as follows:
 Commencing at the southwest corner of said government lot; thence on an assumed bearing of North 01 degrees 05 minutes 44 seconds West, along the west line of said government lot, a distance of 760.00 feet to the point of beginning of the parcel of land to be described; thence continuing North 01 degrees 05 minutes 44 seconds West, along said west government lot line, a distance of 238.00 feet; thence South 79 degrees 42 minutes 26 seconds East, a distance of 680 feet, more or less, to the shoreline of Little Moss Lake; thence Southwesterly along said shoreline, a distance of 376 feet, more or less, to a line that bears South 88 degrees 06 minutes 04 seconds East from said point of beginning; thence North 88 degrees 06 minutes 04 seconds West, a distance of 788 feet, more or less, to the point of beginning.
 Said parcel contains 4.8 acres of land, more or less, and is subject to existing easements of record.

DESCRIPTION - (PARCEL "D")

That part of Government Lot 5, Section 14, Township 144, Range 31, Cass County, Minnesota, being described as follows:
 Commencing at the southwest corner of said government lot; thence on an assumed bearing of North 01 degrees 05 minutes 44 seconds West, along the west line of said government lot, a distance of 995.00 feet to the point of beginning of the parcel of land to be described; thence continuing North 01 degrees 05 minutes 44 seconds West, along said west government lot line, a distance of 331.51 feet to the northwest corner of said government lot; thence South 89 degrees 12 minutes 53 seconds East, a distance of 1205 feet, more or less, to the shoreline of Little Moss Lake; thence Southwesterly along said shoreline, a distance of 376 feet, more or less, to a line that bears South 88 degrees 11 minutes 24 seconds East from said point of beginning; thence North 88 degrees 11 minutes 24 seconds West, a distance of 840 feet, more or less, to the point of beginning.
 Said parcel contains 6.1 acres of land, more or less, and is subject to existing easements of record.

LEGEND

- DENOTES 1/2 INCH X 14 INCH IRON PIPE SET AND MARKED WITH RLS 17768 CAP.
- DENOTES FOUND SURVEY MONUMENT
- DENOTES FOUND GLO MONUMENT
- ▨ DENOTES GRAVEL SURFACE
- ▩ DENOTES WATER SURFACE
- ⊖ DENOTES DELINEATED WETLAND BY AQUATIC ECOLOGISTS, INC.

GRAPHIC SCALE
 100 0 50 100 200
 (IN FEET)
 1 Inch = 100 Ft.

SURVEYORS NOTES:

1. Bearing Orientation: The west line of Government Lot 5, Section 14, Township 144, Range 31 is assumed to have a bearing of North 01 degrees 05 minutes 44 seconds West.
2. The field survey was completed on March 1st, 2011. There was approximately 30 inches of snow cover across the property being surveyed.
3. Arco Land Surveyors, LLC has made no investigation or independent search for easements of record, encumbrances, restrictive covenants, ownership title evidence, or any other facts that an accurate and current title search may disclose.

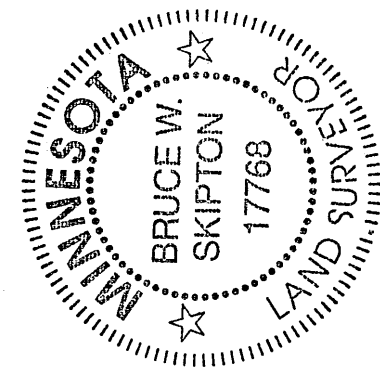
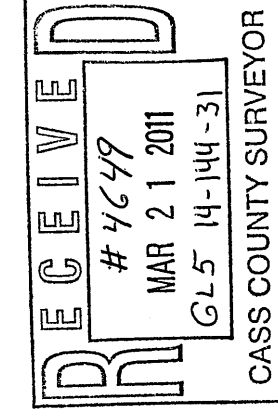

NO.	DATE	BY	REVISION DESCRIPTION

CLIENT:
Russell Mann
 25690 Rum River Drive NW
 Isanti, MN 55040

DIVISION SURVEY
 Part of Gov't Lot 5, Sec. 14, T. 144,
 R. 31, Cass Co., MN.

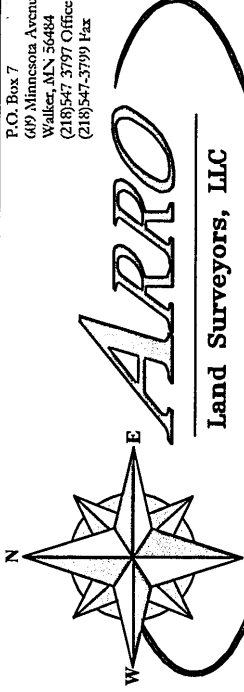

I hereby certify that this survey, plan or report was prepared by me or under my direct supervision and that I am a duly licensed land surveyor under the laws of the state of Minnesota.
 Dated this 21st day of March 2011
 By: *Bruce W. Skipton*
 Bruce W. Skipton, Minnesota License No. 17768