

CERTIFICATE OF SURVEY

PART OF SECTION 8, TOWNSHIP 136, RANGE 30 CASS COUNTY, MINNESOTA

PROPERTY DESCRIPTION OF RECORD:

The Northeast Quarter of the Northwest Quarter and the Southeast Quarter of the Northwest Quarter and the Northwest Quarter of the Southwest Quarter and the Northeast Quarter of the Southwest Quarter and the Southwest Quarter of the Southwest Quarter and the Southeast Quarter of the Southwest Quarter and the Southwest Quarter of the Southeast Quarter and the Northeast Quarter of the Southeast Quarter and the Southeast Quarter of the Southeast Quarter, Section 8, Township 136, Range 30, Cass County, Minnesota.

TOTAL ACRES 348.731

CORNER ACCESSORY TIES

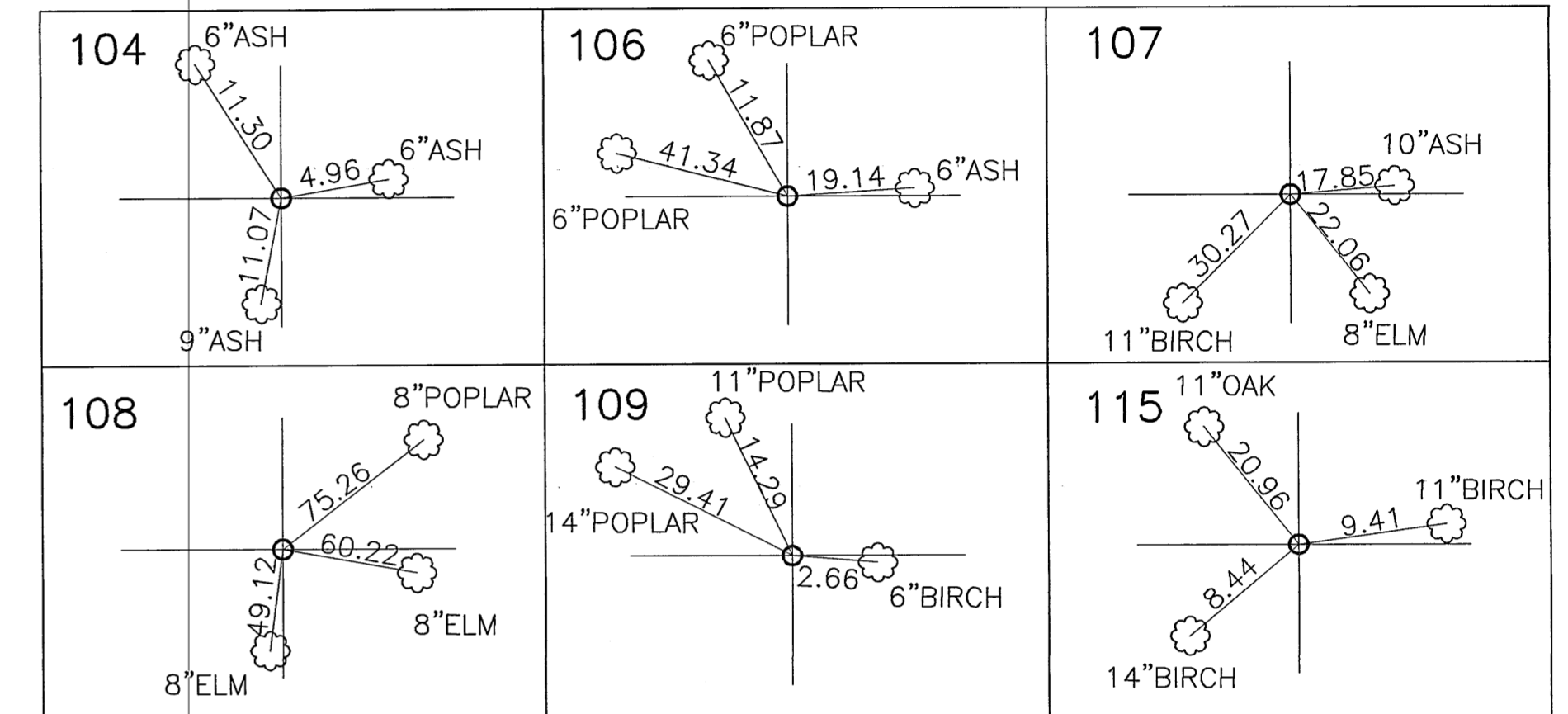

* FOR SECTION CORNER TIES SEE RECORDED CERTIFICATES OF LOCATION

NUMBER	NORTHING	EASTING
101	262203.71293	492110.90262
102	264811.34851	492083.99288
103	267418.98408	492057.08314
104	267430.98485	493364.33403
105	267442.98562	494671.58492
106	264821.08504	493379.88411
107	263524.66125	494677.87067
108	263533.22649	495968.07988
109	264840.55809	495971.66207
110	264850.29459	497267.5488
111	264830.82158	494675.77534
112	262233.28889	497249.02939
113	262225.8949	495964.4977
114	262218.50091	494679.966
115	262211.10692	493395.43431
116	263541.79174	497258.2891
117	262203.90288	492143.90241
118	264811.59644	492116.99207
121	267466.98715	497286.08671

LEGEND

- 1/2" IRON PIPE MONUMENT SET
- MARKED BY REG. NO. 44530
- MONUMENT FOUND
- x — FENCE LINE

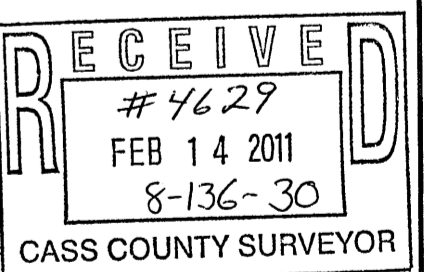

SURVEYOR'S CERTIFICATION

I hereby certify that this survey was prepared by me or under my direct supervision and that I am a duly licensed land surveyor under the laws of the State of Minnesota.

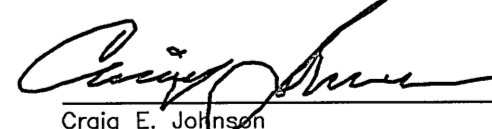
 Craig E. Jolliffe
 License Number 44530

12/27/2010
Date

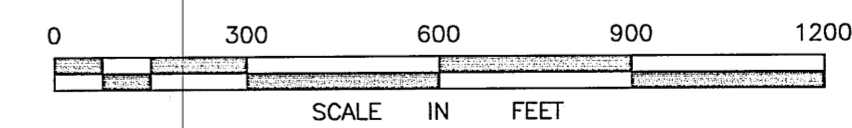

Horizontal Datum: Cass County South NAD83 (1996)

CERTIFICATE OF SURVEY
SECTION 8, TOWNSHIP 136, RANGE 30

BOLTON & MENK, INC.
Consulting Engineers & Surveyors

7533 SUNWOOD DRIVE, RAMSEY, MN 55303 (763) 433-2851
MANKATO, MN FAIRMONT, MN SLEEPY EYE, MN BURNSVILLE, MN
WILLMAR, MN CHASKA, MN RAMSEY, MN AMES, IA

FOR: CASS COUNTY LAND DEPARTMENT