

Assessment & Tax List 1955
Wabedo

INDEX TO SECTIONS

SECTION PAGE

Sec. 1	
" 2	
" 3	
" 4	
" 5	
" 6	
" 7	
" 8	
" 9	
" 10	
" 11	
" 12	
" 13	
" 14	
" 15	
" 16	
" 17	
" 18	
" 19	
" 20	
" 21	
" 22	
" 23	
" 24	
" 25	
" 26	
" 27	
" 28	
" 29	
" 30	
" 31	
" 32	
" 33	
" 34	
" 35	
" 36	

For Convenience of Auditor in Showing Boundaries of School Districts

Township No. 140 Range No. 28 Mer. P. M.

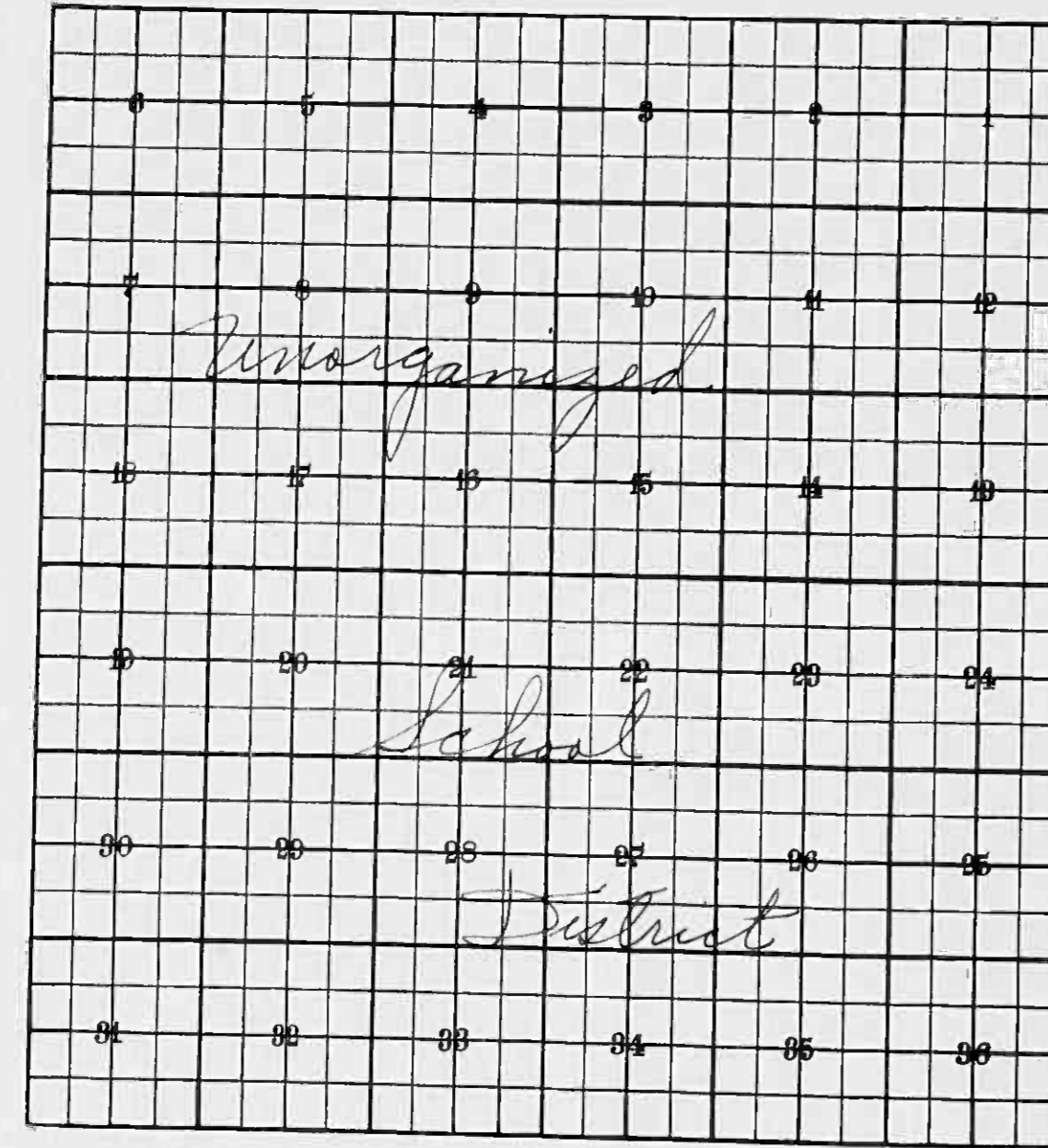

Returns Showing Grain Received in or Handled by Elevators, Warehouses and Mills in the _____ of _____ in the _____ County of _____ for the Year Ending May 1, 1955.

NAMES OF OWNERS	ADDRESS	Bushels of Wheat	Bushels of Soy Beans	Bushels of Flax	Total No. of Bushels of Wheat, Soy Beans and Flax	★ Tax of $\frac{1}{4}$ Mill per Bushel		Bushels of Corn	Bushels of Barley	Bushels of Rye	Bushels of Oats	Bushels of Buckwheat	Bushels of all Other Grains	Total No. Bushels Corn, Barley, Rye, Oats, Buckwheat and all Other Grains	★ Tax of $\frac{1}{4}$ Mill Per Bushel		★ Total Tax		REMARKS		
						Dollars	Cts.								Dollars	Cts.	Dollars	Cts.			

Note ★ Assessors will not fill these Columns

HOMESTEADS

Sec. or Lot	Town or Block	Range	Number of Acres of Land	
			Acres	100ths

SUMMARY OF TAX COLLECTION

Original Levy	\$	16,528.08	
Additions	\$		
			\$ 16,528.08
Abatements	\$	129.72	
			\$ 16,398.36
COLLECTIONS			
March Settlement	\$	3257.32	
June Settlement	\$	9039.43	
November Settlement	\$	2839.62	
January Settlement	\$	76.46	\$ 1512.83
			\$ 1186.53
Over Collected	\$	36.42	
Under Collected	\$		
Delinquent	\$	1229.95	\$ 1186.53
Total	\$		\$

Hawley Pass

Hawley Springs and Iowa Point

Hawley Addition

TABULAR SCHEDULE OF VALUATIONS,

LEVIED IN THE Town OF Wabedo

School District No.	VALUATION BY SCHOOL DISTRICTS				RATE OF STATE TAXES		RATE OF COUNTY TAXES					RATE OF TOWN TAXES										RATE OF					
	Agri-cultural Lands	Non-Agri-cultural Lands	Personal Property	Total Value of all Property except Money and Credits	Total Rate of State Tax	Rev.	It. & B.	Wel-fare	Bonds and Int.	Courthouse Bldg Fund	Total Rate of County Tax	Rev.	It. & B.	Drag Tax	State Loan	Phone	Total Rate of Town Tax	Local	Spe-cial	State Loan	Defi-ciency		Tui-tion	Trans-portion	C. O.		
<u>Un</u>	<u>48669</u>	<u>15077</u>	<u>13,232</u>	<u>76,980</u>	<u>H. 3.98</u>	<u>28.01</u>	<u>14.01</u>	<u>49.83</u>	<u>9.97</u>	<u>2.00</u>	<u>103.82</u>	<u>4.5</u>	<u>7.8</u>	<u>1.0</u>	<u>2.2</u>	<u>2.6</u>	<u>18.10</u>	<u>1.0</u>	<u>20.0</u>	<u>40.0</u>	<u>40.0</u>	<u>1.08</u>	<u>15.0</u>	<u>1.08</u>	<u>15.0</u>		
Assessed Value Homestead	<u>Rural 11755</u>	<u>All Other</u>	<u>Personal Property</u>	<u>Total 11,755</u>																							
Non-Homestead	<u>51493</u>		<u>13,232</u>	<u>65,225</u>																							
Total	<u>63,748</u>		<u>13,232</u>	<u>76,980</u>																							

N. H. 5.17
9.15

RATES AND TAXES

COUNTY OF CASS, STATE OF MINNESOTA

SCHOOL TAXES			LOCAL 1 MILL AND SPECIAL SCHOOL TAXES BY DISTRICTS										ALL OTHER TAXES		
Total Rate of Sch'l Tax	Total Rate of all Taxes		Local 1 Mill	Spe-cial	State Loan	Def. Transp. C. O.	Total School Taxes	FUNDS	Rate	Amount					
<u>77.08</u>	<u>202.98</u>		<u>4867</u>	<u>91338</u>	<u>194676</u>	<u>5256</u>	<u>73004</u>	<u>375141</u>	State - Non-Homestead,		<u>33680</u>				
<u>97.08</u>	<u>222.98</u>		<u>2831</u>	<u>113244</u>	<u>113244</u>	<u>3058</u>	<u>42467</u>	<u>274844</u>	State - Homestead,		<u>30638</u>				
			<u>7698</u>	<u>210582</u>	<u>307920</u>	<u>8314</u>	<u>115471</u>	<u>649985</u>	County Revenue,		<u>215611</u>				
									County Road and Bridge,		<u>107839</u>				
									County Welfare,		<u>383581</u>				
									Bonds and Interest		<u>76744</u>				
									<u>Courthouse Bldg</u>		<u>15396</u>				
											<u>799171</u>				
									Town Revenue,		<u>34641</u>				
									Town Road and Bridge,		<u>60044</u>				
									Town Drag,		<u>7678</u>				
									Town State Loan,		<u>16936</u>				
									<u>Phone</u>		<u>20815</u>				
											<u>139334</u>				
									School Local 1 Mill,		<u>7648</u>				
									School Special,		<u>210582</u>				
									School State Loan,		<u>307920</u>				
									Deficiency		<u>8314</u>				
									Tuition		<u>115471</u>				
									Transportation		<u>649985</u>				
									<u>C. O.</u>						

Total Taxes Real Estate 13,509.15
Pers. Prop. 3018.90
Total 16528.05

Total Number of Acres 9431.63
State of Minnesota, }
COUNTY OF CASS }
I, L. C. Peterson, Auditor of said County and State of Minnesota, do hereby certify that the foregoing is a true and correct Schedule, showing the valuation of all the taxable property, in the Town of Wabedo, in said County, the several rates of Taxation and Totals of the several Tax Funds levied thereon for the year A. D. 1955.
Witness my hand and official seal, this 15th day of December, D. 1955.

SEAL

L. C. Peterson
County Auditor
By Allen Billow, Deputy

or Ceased to be Homesteads

HOMESTEADS			
Sec. or Lot	Town or Block	Range	Number of Acres of Land

COLLECTIONS OF TAXES OF 1955

Town of Wahedo

CASS COUNTY, MINNESOTA

FUNDS	MARCH SETTLEMENT 1955	JUNE SETTLEMENT 1955	NOV. SETTLEMENT 1955	Amount Collected from Nov. 1955 to First Monday in Jan. 1956	REDUCTIONS	Total Reductions and Collected	BALANCE UNCOLLECTED	ADDITIONS	Total Uncollected to First Monday in January, 1956
State-Non-Homestead,	6912	18281	5082	29					
State-Homestead,	5757	19057	5266	147					
County Revenue,	40472	120043	37060	1036					
County Road and Bridge,	20243	60143	18537	518					
County Welfare,	71999	213557	65930	1843					
County Bond and Interest,	14406	42728	13191	369					
Court Houses	2890	8571	2646	24					
Town Revenue,	6502	19286	5954	66					
Town Road and Bridge,	11278	33429	10320	288					
Town Drag,	1445	4286	1323	37					
Town State Loan,	3179	9429	2911	82					
Phone	3757	11143	3440	97					
School Local 1 Mill,	1445	4285	1323	37					
School Special,	54431	101492	36780	848					
School State Loan,									
Deficiency	57786	171428	52924	1480					
Tuition									
Transportation	1561	4629	1429	40					
C.O.	21673	64286	19846	555					
	325732	903943	283962	7646					

	SCHOOL DISTRICT NO.	LOCAL 1 MILL	SPECIAL	STATE LOAN	Deficiency	Transportation	C. O.	TOTALS
MARCH SETTLEMENT	9 Un. 12 Un.	168 1277	3363 51068		6726 57070	182 1379	2522 19157	12861 143945
	Totals	1445	54431		57796	1561	21673	136706
	9 Un. 12 Un.	3497 788	61946 31537		139880 31539	3777 852	52457 11827	268568 76542
JUNE SETTLEMENT	Totals	4285	101492		171428	4629	64286	346118
	9 Un. 12 Un.	807 516	16143 20637		32287 20637	872 557	12107 7739	62216 50086
	Totals	1323	36780		52924	1429	19846	112302
NOVEMBER SETTLEMENT	9 Un. 12 Un.	32 05	632 216		1264 216	34 06	474 81	2436 527
	Totals	37	848		1480	40	555	2960
	School District No.							
NOVEMBER to JANUARY	Totals							
	School District No.							
	Totals							
ADDITIONS	School District No.							
	Totals							
	School District No.							
REDUCTIONS	Totals							

or Ceased to be Homesteads

HOMESTEADS			
Sec. or Lot	Town or Block	Range	Number of Acres of Land
			Acres 100ths

Wahedo Springs Chartered Iowa Point
 Wahedo Addition

Assessment Roll and Tax List of Real Property in the Town of Wabedo

*Indicate Type of Property: R-Residential, C-Commercial, I-Industrial, U-Utility, F-Farm

Cass County, Minnesota, for Taxes for the Year 1955.

Table with columns: IN WHOSE NAME ASSESSED, TO WHOM TRANSFERRED, DESCRIPTION OF PROPERTY, TRUE AND FULL VALUATIONS, ASSESSED VALUATIONS, VALUATIONS BY SCHOOL DISTRICTS AS EQUALIZED BY DEPARTMENT OF TAXATION, TAX INCLUDING STATE HOMESTEAD, STATE TAX ON NON-HOMESTEAD, SPECIAL TAXES, TOTAL TAXES, PAID, WHEN PAID, Number of Receipt, March Settlement 1956, June Settlement 1956, Penalty, November Settlement 1956, Penalty, Collections to First Monday in January 1957, Penalty, Delinquent on First Monday in January 1957, Total Delinquent Tax and Penalty, REMARKS.

Wabedo Pass

Wabedo Springs Grand Iowa Point

Handers Addition

Assessment Roll and Tax List of Real Property in the Town of Wabedo

Form-SCD (55) BILLS-DAY & COMPANY, MINNEAPOLIS

Indicate Type of Property: R-Residential, C-Commercial, I-Industrial, U-Utility, F-Farm

Table with columns: IN WHOSE NAME ASSESSED, TO WHOM TRANSFERRED, DESCRIPTION OF PROPERTY, TRUE AND FULL VALUATIONS, ASSESSED VALUATIONS, FINAL EQUALIZED VALUE.

Cass County, Minnesota, for Taxes for the Year 1955

Table with columns: SOLD FOR TAXES, VALUATIONS BY SCHOOL DISTRICTS AS EQUALIZED BY DEPARTMENT OF TAXATION, Tax Including State Homestead, SPECIAL TAXES, TOTAL TAXES, PAID, WHEN PAID, Number of Receipt, March Settlement 1956, June Settlement 1956, November Settlement 1956, Collections to First Monday in January 1957, Delinquent on First Monday in January 1957, Total Delinquent Tax and Penalty, REMARKS.

Wabedo Pass

Wabedo Springs Gran Iowa Point

Wabedo Addition

Assessment Roll and Tax List of Real Property in the Town of Wabedo, Iowa

*Indicate Type of Property: R-Residential, C-Commercial, I-Industrial, U-Utility, F-Farm

Table with columns: IN WHOSE NAME ASSESSED, TO WHOM TRANSFERRED, DESCRIPTION OF PROPERTY, TRUE AND FULL VALUATIONS, ASSESSED VALUATIONS, FINAL EQUALIZED VALUE.

Cass County, Minnesota, for Taxes for the Year 1955.

Table with columns: VALUATIONS BY SCHOOL DISTRICTS AS EQUALIZED BY DEPARTMENT OF TAXATION, TAX INCLUDING STATE HOMESTEAD, SPECIAL TAXES, TOTAL TAXES, PAID, WHEN PAID, Number of Receipt, March Settlement 1956, June Settlement 1956, November Settlement 1956, Collections to First Monday in January 1957, Delinquent on First Monday in January 1957, Total Delinquent Tax and Penalty, REMARKS.

Wabedo Pass

Wabedo Springs Sharp Iowa Point

Landers Addition

Assessment Roll and Tax List of Real Property in the Town of Wabedo

Indicate Type of Property: R-Residential, C-Commercial, I-Industrial, U-Utility, F-Farm

Table with columns: IN WHOSE NAME ASSESSED, TO WHOM TRANSFERRED, DESCRIPTION OF PROPERTY, TRUE AND FULL VALUATIONS, ASSESSED VALUATIONS, FINAL EQUALIZED VALUE. Includes handwritten entries for 'North Central Area Council of Young Men's Christian Assoc.' and various lot numbers.

Cass County, Minnesota, for Taxes for the Year 1955.

Table with columns: SOLD FOR TAXES, VALUATIONS BY SCHOOL DISTRICTS AS EQUALIZED BY DEPARTMENT OF TAXATION, Tax including State Homestead, State Tax on Non-Homesteaded, SPECIAL TAXES, TOTAL TAXES, PAID, WHEN PAID, Number of Receipt, March Settlement 1956, June Settlement 1956, Penalty, November Settlement 1956, Penalty, Collections to First Monday in January 1957, Penalty, Delinquent on First Monday in January 1957, Total Delinquent Tax and Penalty, REMARKS. Includes handwritten entries for 'PAID IN FULL MAY 31 1956' and various tax amounts.

Assessment Roll and Tax List of Real Property in the Town of Wakeo, Cass County, Minnesota, for Taxes for the Year 1955. *Indicate Type of Property: R-Residential, C-Commercial, I-Industrial, U-Utility, F-Farm

Table with columns: IN WHOSE NAME ASSESSED, TO WHOM TRANSFERRED, DESCRIPTION OF PROPERTY, TRUE AND FULL VALUATIONS, ASSESSED VALUATIONS, VALUATIONS BY SCHOOL DISTRICTS AS EQUALIZED BY DEPARTMENT OF TAXATION, TAXES, PAID, WHEN PAID, Number of Receipt, March Settlement 1956, June Settlement 1956, Penalty, November Settlement 1956, Collections to First Monday in January 1957, Delinquent on First Monday in January 1957, Total Delinquent Tax and Penalty, REMARKS.

Assessment Roll and Tax List of Real Property in the Town of Wabedo, Cass County, Minnesota

Cass County, Minnesota, for Taxes for the Year 1955.

Table with columns for Property Description, Valuations (True and Full, Assessed), Taxes (School Districts, State, Special, Total), and Payment Status (Paid, When Paid, March, June, November, Collections, Delinquent, Total Delinquent). Includes handwritten entries for various property owners like W.P. Diamond, John C. Ford, and Roy W. Pedersen.

Wabedo Pass

Wabedo Springs, Onawa, Iowa Point

Wabedo Addition

Assessment Roll and Tax List of Real Property in the Town of Wabedo, Cass County, Minnesota, for Taxes for the Year 1955.

Main table with columns: IN WHOSE NAME ASSESSED, TO WHOM TRANSFERRED, DESCRIPTION OF PROPERTY, TRUE AND FULL VALUATIONS, ASSESSED VALUATIONS, VALUATIONS BY SCHOOL DISTRICTS AS EQUALIZED BY DEPARTMENT OF TAXATION, TAXES, PAID, WHEN PAID, etc.

103 90

559

113 46

288

116 34

146 34

Wabedo Pass

Wabedo Springs

Landers Addition

Assessment Roll and Tax List of Real Property in the Town of Wabedo

Indicate Type of Property: R-Residential, C-Commercial, I-Industrial, U-Utility, F-Farm

Cass County, Minnesota, for Taxes for the Year 1955.

Table with columns for 'DESCRIPTION OF PROPERTY' (Subdivision, Acres, etc.), 'TRUE AND FULL VALUATIONS' (Land, Buildings, Machinery, etc.), and 'ASSESSED VALUATIONS' (Rural, All Other, etc.). Includes handwritten entries for Esther M. Elia, Clara Nelson, and Henry Pearson.

Table for tax details with columns for 'VALIDATIONS BY SCHOOL DISTRICTS AS EQUALIZED BY DEPARTMENT OF TAXATION' (District No., Rate, etc.), 'Taxes' (Including State, Special, Total), 'PAID' (When Paid, etc.), and 'REMARKS'. Includes handwritten entries like 'PAID IN FULL DEC 12 1955' and 'PAID IN FULL FEB 0 1956'.

Wabedo Pass

Wabedo Springs Chas Iowa Point

Handers Addition

Assessment Roll and Tax List of Real Property in the Town of Wabeno of Wabeno *Indicate Type of Property: R-Residential, C-Commercial, I-Industrial, U-Utility, F-Farm

Cass County, Minnesota, for Taxes for the Year 1955.

Form 50D (55) MINN.

IN WHOSE NAME ASSESSED	TO WHOM TRANSFERRED	DESCRIPTION OF PROPERTY			No. School District	Indicate Homestead For or No	Indicate Agricultural Use or No	Indicate Type of Property	TRUE AND FULL VALUATIONS							Total Assessed Value as Equalized by the Board of Review	FINAL EQUALIZED VALUE				
		SUBDIVISION	Sec. or Lot	Town or Block					Rng.	Number of Acres of Land Acres 100ths	LAND Exclusive of Structures and Improvements	BUILDINGS and Other Structures	MACHINERY Permanently Attached to Real Estate	TOTAL True and Full Value	RURAL			ALL OTHER			
															Homestead Up to \$4,000 20%			Over \$4,000 and Non-Homestead 33 1/4%	Homestead Up to \$1,000 25%	Over \$1,000 and Non-Homestead 40%	MACHINERY Permanently Attached to Real Estate 33 1/4%
									Dollars	Dollars	Dollars	Dollars	Dollars	Dollars	Dollars	Dollars	Dollars	Dollars	Dollars		
									Dollars	Dollars	Dollars	Dollars	Dollars	Dollars	Dollars	Dollars	Dollars	Dollars	Dollars		
									Dollars	Dollars	Dollars	Dollars	Dollars	Dollars	Dollars	Dollars	Dollars	Dollars	Dollars		

Handwritten entries in the table include: John L. & Elizabeth Glines (lots 2, 3, 4), North Central Area Council of Young Men's Christian Assoc. (lots 5, 6, 7, 8, 9), Fred L. & Lucille M. Hiesche (lots 11, 12, 13, 14), and another North Central Area Council of Young Men's Christian Assoc. (lots 17, 18, 19, 20). A total of 370.40 acres is noted at the bottom left.

SOLD FOR TAXES	VALUATIONS BY SCHOOL DISTRICTS AS EQUALIZED BY DEPARTMENT OF TAXATION								Tax including State Homestead	State Tax on Non-Homestead	SPECIAL TAXES	TOTAL TAXES	PAID	WHEN PAID	Number of Receipt	March Settlement 1956	June Settlement 1956	November Settlement 1956	Penalty	Collections to First Monday in January 1957	Penalty	Delinquent on First Monday in January 1957	Total Delinquent Tax and Penalty	REMARKS	
	District No.	District No.	District No.	District No.	District No.	District No.	District No.	District No.																	
	Rate - Mills	Rate - Mills	Rate - Mills	Rate - Mills	Rate - Mills	Rate - Mills	Rate - Mills	Rate - Mills																	
										\$ cts.	\$ cts.	\$ cts.	\$ cts.	Month Day Year		\$ cts.	\$ cts.	\$ cts.	\$ cts.	\$ cts.	\$ cts.	\$ cts.	\$ cts.	\$ cts.	
										\$ cts.	\$ cts.	\$ cts.	\$ cts.	Month Day Year		\$ cts.	\$ cts.	\$ cts.	\$ cts.	\$ cts.	\$ cts.	\$ cts.	\$ cts.	\$ cts.	
										\$ cts.	\$ cts.	\$ cts.	\$ cts.	Month Day Year		\$ cts.	\$ cts.	\$ cts.	\$ cts.	\$ cts.	\$ cts.	\$ cts.	\$ cts.	\$ cts.	
										\$ cts.	\$ cts.	\$ cts.	\$ cts.	Month Day Year		\$ cts.	\$ cts.	\$ cts.	\$ cts.	\$ cts.	\$ cts.	\$ cts.	\$ cts.	\$ cts.	
										\$ cts.	\$ cts.	\$ cts.	\$ cts.	Month Day Year		\$ cts.	\$ cts.	\$ cts.	\$ cts.	\$ cts.	\$ cts.	\$ cts.	\$ cts.	\$ cts.	
										\$ cts.	\$ cts.	\$ cts.	\$ cts.	Month Day Year		\$ cts.	\$ cts.	\$ cts.	\$ cts.	\$ cts.	\$ cts.	\$ cts.	\$ cts.	\$ cts.	
										\$ cts.	\$ cts.	\$ cts.	\$ cts.	Month Day Year		\$ cts.	\$ cts.	\$ cts.	\$ cts.	\$ cts.	\$ cts.	\$ cts.	\$ cts.	\$ cts.	
										\$ cts.	\$ cts.	\$ cts.	\$ cts.	Month Day Year		\$ cts.	\$ cts.	\$ cts.	\$ cts.	\$ cts.	\$ cts.	\$ cts.	\$ cts.	\$ cts.	
										\$ cts.	\$ cts.	\$ cts.	\$ cts.	Month Day Year		\$ cts.	\$ cts.	\$ cts.	\$ cts.	\$ cts.	\$ cts.	\$ cts.	\$ cts.	\$ cts.	
										\$ cts.	\$ cts.	\$ cts.	\$ cts.	Month Day Year		\$ cts.	\$ cts.	\$ cts.	\$ cts.	\$ cts.	\$ cts.	\$ cts.	\$ cts.	\$ cts.	
										\$ cts.	\$ cts.	\$ cts.	\$ cts.	Month Day Year		\$ cts.	\$ cts.	\$ cts.	\$ cts.	\$ cts.	\$ cts.	\$ cts.	\$ cts.	\$ cts.	
										\$ cts.	\$ cts.	\$ cts.	\$ cts.	Month Day Year		\$ cts.	\$ cts.	\$ cts.	\$ cts.	\$ cts.	\$ cts.	\$ cts.	\$ cts.	\$ cts.	
										\$ cts.	\$ cts.	\$ cts.	\$ cts.	Month Day Year		\$ cts.	\$ cts.	\$ cts.	\$ cts.	\$ cts.	\$ cts.	\$ cts.	\$ cts.	\$ cts.	

Handwritten entries in the table include: 430, 9588, 222, 4810, 194, 67, 67, 67, 67, H 239, H 40, H 40, H 40, H 40, 104, H 319, 709, 1028, 430, 9588, 586, 31040, 12740, 18300.

Assessment Roll and Tax List of Real Property in the Town of Wabedo, Cass County, Minnesota, for Taxes for the Year 1955. *Indicate Type of Property: R-Residential, C-Commercial, I-Industrial, U-Utility, F-Farm

Table with columns: IN WHOSE NAME ASSESSED, TO WHOM TRANSFERRED, DESCRIPTION OF PROPERTY, TRUE AND FULL VALUATIONS (RURAL, ALL OTHER, MACHINERY), and FINAL EQUALIZED VALUE.

Cass County, Minnesota, for Taxes for the Year 1955.

Table with columns: VALUATIONS BY SCHOOL DISTRICTS AS EQUALIZED BY DEPARTMENT OF TAXATION, TAXES (SOLD FOR, DISTRICT, RATE), PAID (WHEN PAID, PAID IN FULL), and REMARKS.

Wabedo Pass

Wabedo Springs Chapel Iowa Point

Landers Addition

Assessment Roll and Tax List of Real Property in the town of Wabedo,
*Indicate Type of Property: R-Residential, C-Commercial, I-Industrial, U-Utility, F-Farm

Table with columns: IN WHOSE NAME ASSESSED, TO WHOM TRANSFERRED, DESCRIPTION OF PROPERTY, TRUE AND FULL VALUATIONS (LAND, BUILDINGS, MACHINERY, TOTAL), ASSESSED VALUATIONS (RURAL, ALL OTHER, MACHINERY, TOTAL), Total Assessed Value, FINAL EQUALIZED VALUE.

Cass County, Minnesota, for Taxes for the Year 1955.

Table with columns: SOLD FOR TAXES, VALUATIONS BY SCHOOL DISTRICTS AS EQUALIZED BY DEPARTMENT OF TAXATION, Tax including State Homestead, State Tax on Non-Homestead, SPECIAL TAXES, TOTAL TAXES, PAID, WHEN PAID, Number of Receipt, March Settlement 1956, June Settlement 1956, Penalty, November Settlement 1956, Penalty, Collections to First Monday in January 1957, Delinquent on First Monday in January 1957, Total Delinquent Tax and Penalty, REMARKS.

Assessment Roll and Tax List of Real Property in the Town of Wadena, *Indicate Type of Property: R-Residential, C-Commercial, I-Industrial, U-Utility, F-Farm

Table with columns: IN WHOSE NAME ASSESSED, TO WHOM TRANSFERRED, DESCRIPTION OF PROPERTY, TRUE AND FULL VALUATIONS, ASSESSED VALUATIONS, FINAL EQUALIZED VALUE. Includes entries for Albert Hughes, State of Minnesota, Williams S. Liskey, Navillus Land Co., W. L. Johnson, Erick + Karin Wikstrom, Adolph + Alma Nelsons, Peter + Olga Jamburmen, W. A. Clark, and Wm. S. Liskey.

Cass County, Minnesota, for Taxes for the Year 1955.

Table with columns: SOLD FOR TAXES, VALUATIONS BY SCHOOL DISTRICTS AS EQUALIZED BY DEPARTMENT OF TAXATION, TAX INCLUDING STATE HOMESTEAD, SPECIAL TAXES, TOTAL TAXES, PAID, WHEN PAID, Number of Receipt, March Settlement 1956, June Settlement 1956, November Settlement 1956, Collections to First Monday in January 1957, Delinquent on First Monday in January 1957, Total Delinquent Tax and Penalty, REMARKS. Includes entries for various lots with handwritten tax amounts and payment dates.

Assessment Roll and Tax List of Real Property in the Town of Wahedo, Cass County, Minnesota, for Taxes for the Year 1955.

Table with columns: IN WHOSE NAME ASSESSED, TO WHOM TRANSFERRED, SUBDIVISION, TRUE AND FULL VALUATIONS (LAND, BUILDINGS, MACHINERY, TOTAL TRUG AND FULL VALUE, RURAL, ALL OTHER, MACHINERY PERMANENTLY ATTACHED TO REAL ESTATE, TOTAL ASSESSED VALUE, Total Assessed Value as Equalized by the Board of Review, FINAL EQUALIZED VALUE). Includes handwritten entries for J.R. E. Thudge, Ansel B. & Ruth M. Bishop, Chester H. & Eugene Schmidt, etc.

Cass County, Minnesota, for Taxes for the Year 1955.

Table with columns: SOLD FOR TAXES, VALUATIONS BY SCHOOL DISTRICTS AS EQUALIZED BY DEPARTMENT OF TAXATION, Tax including State Homestead, State Tax on Non-Homestead, SPECIAL TAXES, TOTAL TAXES, PAID, WHEN PAID, Number of Receipt, March Settlement 1956, June Settlement 1956, Penalty, November Settlement 1956, Penalty, Collections to First Monday in January 1957, Penalty, Delinquent on First Monday in January 1957, Total Delinquent Tax and Penalty, REMARKS. Includes handwritten entries for J.R. E. Thudge, Ansel B. & Ruth M. Bishop, etc.

Wahedo Pass

Wahedo Springs - Grand Iowa Point

Handwritten Additions

Assessment Roll and Tax List of Real Property in the Town of Wabedo

*Indicate Type of Property: R-Residential, C-Commercial, I-Industrial, U-Utility, F-Farm

Cass County, Minnesota, for Taxes for the Year 1955.

Table with multiple columns: ON WHOSE NAME ASSESSED, TO WHOM TRANSFERRED, DESCRIPTION OF PROPERTY, TRUE AND FULL VALUATIONS, ASSESSED VALUATIONS, VALUATIONS BY SCHOOL DISTRICTS AS EQUALIZED BY DEPARTMENT OF TAXATION, TAX INCLUDING STATE HOMESTEAD, SPECIAL TAXES, TOTAL TAXES, PAID, WHEN PAID, Number of Receipt, March Settlement 1956, June Settlement 1956, Penalty, November Settlement 1956, Collection to First Monday in January 1957, Delinquent on First Monday in January 1957, Total Delinquent Tax and Penalty, REMARKS.

Assessment Roll and Tax List of Real Property in the Town of Wabedo, Cass County, Minnesota, for Taxes for the Year 1955.

Table with columns for IN WHOSE NAME ASSESSED, TO WHOM TRANSFERRED, DESCRIPTION OF PROPERTY, TRUE AND FULL VALUATIONS, ASSESSED VALUATIONS, VALUATIONS BY SCHOOL DISTRICTS, TAXES, PAID, WHEN PAID, and REMARKS. Includes handwritten entries for various property owners like Frank E. & Helen B. Bergen, Thomas F. & Mae Rose Mckeever, etc.

Assessment Roll and Tax List of Real Property in the Town of Wabedo, *Indicate Type of Property: R-Residential, C-Commercial, I-Industrial, U-Utility, F-Farm

Cass County, Minnesota, for Taxes for the Year 1955.

Table with columns: IN WHOSE NAME ASSESSED, TO WHOM TRANSFERRED, DESCRIPTION OF PROPERTY, TRUE AND FULL VALUATIONS, ASSESSED VALUATIONS, VALUATIONS BY SCHOOL DISTRICTS AS EQUALIZED BY DEPARTMENT OF TAXATION, Tax including State Homestead, State Tax on Non-Homestead, SPECIAL TAXES, TOTAL TAXES, PAID, WHEN PAID, Number of Receipt, March Settlement 1956, June Settlement 1956, November Settlement 1956, Penalty, Collections to First Monday in January 1957, Delinquent on First Monday in January 1957, Total Delinquent Tax and Penalty, REMARKS.

Wabedo Pass

Wabedo Springs Chap. Iowa Point

Landers Addition

Assessment Roll and Tax List of Real Property in the Town of Wabedo
* Indicate Type of Property: R-Residential, C-Commercial, I-Industrial, U-Utility, F-Farm

Cass County, Minnesota, for Taxes for the Year 1955.

Table with columns: IN WHOSE NAME ASSESSED, TO WHOM TRANSFERRED, DESCRIPTION OF PROPERTY, TRUE AND FULL VALUATIONS, ASSESSED VALUATIONS, VALUATIONS BY SCHOOL DISTRICTS AS EQUALIZED BY DEPARTMENT OF TAXATION, SOLD FOR TAXES, TAXES (District, State, SPECIAL, TOTAL), PAID, WHEN PAID, Number of Receipt, March, June, November Settlement, Collections to First Monday in January 1957, Delinquent on First Monday in January 1957, Total Delinquent Tax and Penalty, REMARKS.

August Gordon

1/4 of 1/4 of Sec 28 of Twp 23 N R 28 W

Joseph J. & Clara W. Keams
Eddie & Winnie L. Chapman

SE 1/4 of NE 1/4 of Sec 28 of Twp 23 N R 28 W

100 added assessment 1955

Bert & Margriet Allen

4 acres of Lot 5

Howard & Verne Claussen

1/4 Sec of Lot 5

Willette G. & Bernice J. Waile
Edward W. & Margie Marie

5/8 ac of Lot 5

367

H 275
165
440

8930 84 9014

6862 2152

Assessment Roll and Tax List of Real Property in the Town of Wahedo, Cass County, Minnesota, for Taxes for the Year 1955.

Table with columns: IN WHOSE NAME ASSESSED, TO WHOM TRANSFERRED, DESCRIPTION OF PROPERTY, TRUE AND FULL VALUATIONS, ASSESSED VALUATIONS, VALUATIONS BY SCHOOL DISTRICTS AS EQUALIZED BY DEPARTMENT OF TAXATION, SOLD FOR TAXES, SPECIAL TAXES, TOTAL TAXES, PAID, WHEN PAID, Number of Receipt, March Settlement 1956, June Settlement 1956, November Settlement 1956, Collections to First Monday in January 1957, Delinquent on First Monday in January 1957, Total Delinquent Tax and Penalty, REMARKS.

Wahedo Pass

Wahedo Springs Chas Iowa Point

Landers Addition

Assessment Roll and Tax List of Real Property in the Town of Wabedo

*Indicate Type of Property: R-Residential, C-Commercial, I-Industrial, U-Utility, F-Farm

Table with columns: IN WHOSE NAME ASSESSED, TO WHOM TRANSFERRED, DESCRIPTION OF PROPERTY, TRUE AND FULL VALUATIONS (RURAL, ALL OTHER, MACHINERY), TOTAL ASSESSED VALUE, FINAL EQUALIZED VALUE.

Cass County, Minnesota, for Taxes for the Year 1955.

Table with columns: SOLD FOR TAXES, VALUATIONS BY SCHOOL DISTRICTS AS EQUALIZED BY DEPARTMENT OF TAXATION, Tax including State Homestead, State Tax on Non-Homestead, SPECIAL TAXES, TOTAL TAXES, PAID, WHEN PAID, Number of Receipt, March Settlement 1956, June Settlement 1956, November Settlement 1956, Collections to First Monday in January 1957, Delinquent on First Monday in January 1957, Total Delinquent Tax and Penalty, REMARKS.

Assessment Roll and Tax List of Real Property in the Town of Wabedo

*Indicate Type of Property: R-Residential, C-Commercial, I-Industrial, U-Utility, F-Farm

Table with columns: IN WHOSE NAME ASSESSED, TO WHOM TRANSFERRED, DESCRIPTION OF PROPERTY, TRUE AND FULL VALUATIONS, ASSESSED VALUATIONS, FINAL EQUALIZED VALUE.

Cass County, Minnesota, for Taxes for the Year 1955.

Table with columns: SOLD FOR TAXES, VALUATIONS BY SCHOOL DISTRICTS AS EQUALIZED BY DEPARTMENT OF TAXATION, Tax including State Homestead, SPECIAL TAXES, TOTAL TAXES, PAID, WHEN PAID, Number of Receipt, March Settlement 1956, June Settlement 1956, November Settlement 1956, Collections to First Monday in January 1957, Delinquent on First Monday in January 1957, Total Delinquent Tax and Penalty, REMARKS.

Wabedo Pass

Wabedo Spring's Quarry Iowa Point

Landers Addition

Assessment Roll and Tax List of Real Property in the Town of Wabedo

Indicate Type of Property: R-Residential, C-Commercial, I-Industrial, U-Utility, F-Farm

Table with columns: IN WHOSE NAME ASSESSED, TO WHOM TRANSFERRED, DESCRIPTION OF PROPERTY, TRUE AND FULL VALUATIONS (LAND, BUILDINGS, MACHINERY, TOTAL), ASSESSED VALUATIONS (RURAL, ALL OTHER, MACHINERY, TOTAL ASSESSED), PINAL EQUALIZED VALUE.

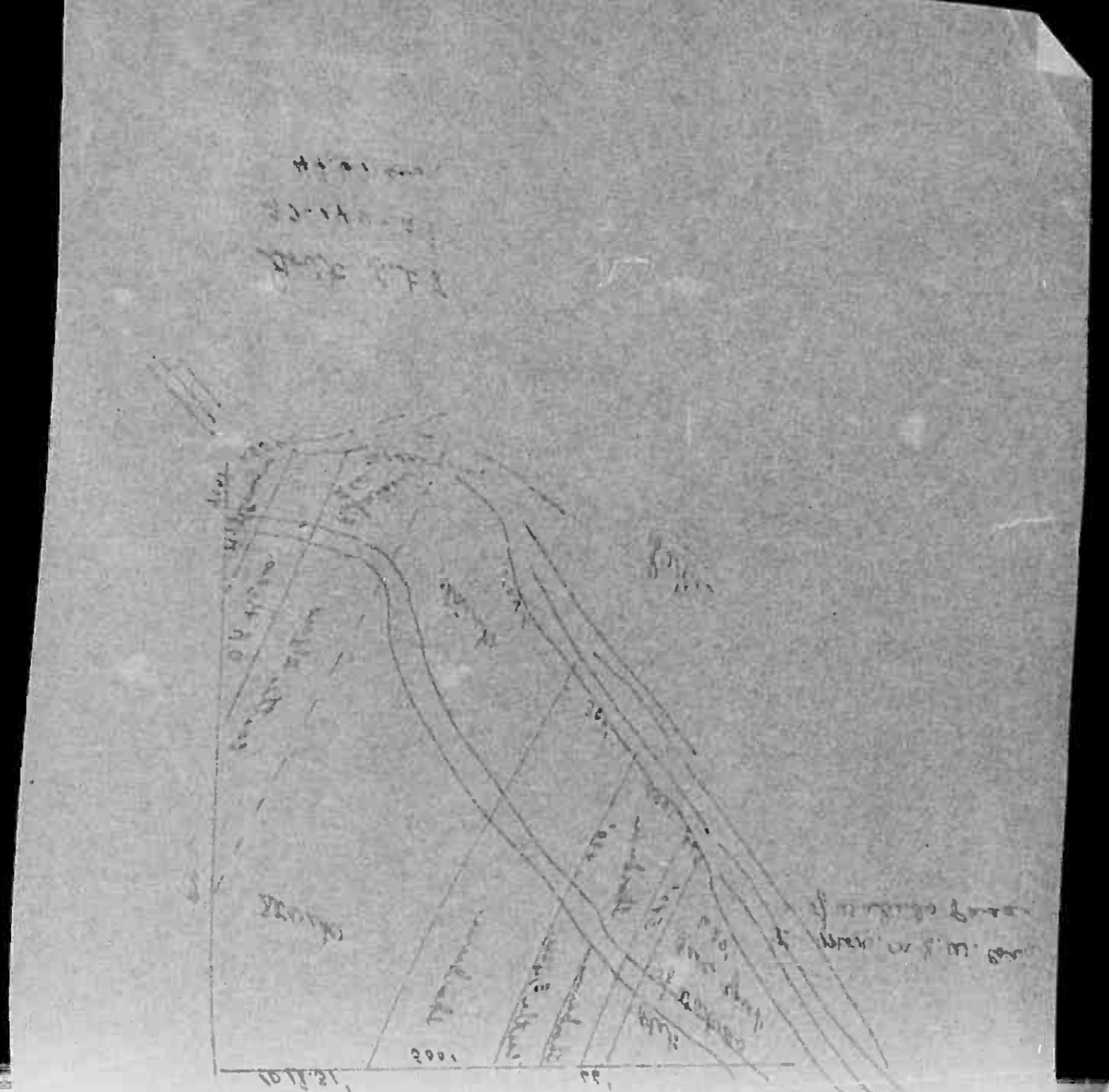

Cass County, Minnesota, for Taxes for the Year 1955.

Table with columns: VALUATIONS BY SCHOOL DISTRICTS AS EQUALIZED BY DEPARTMENT OF TALLATION, TAXES (SOLD FOR, SPECIAL, TOTAL), PAID, WHEN PAID, Number of Receipts, March Settlement, June Settlement, November Settlement, Collections to First Monday in January, Delinquent on First Monday in January, Total Delinquent Tax and Penalty, REMARKS.

Assessment Roll and Tax List of Real Property in the Town of Wabedo

*Indicate Type of Property: R-Residential, C-Commercial, I-Industrial, U-Utility, F-Farm

Table with columns: IN WHOSE NAME ASSESSED, TO WHOM TRANSFERRED, DESCRIPTION OF PROPERTY, TRUE AND FULL VALUATIONS, ASSESSED VALUATIONS, FINAL EQUALIZED VALUE.

Cass County, Minnesota, for Taxes for the Year 1955.

Table with columns: SOLD FOR TAXES, VALUATIONS BY SCHOOL DISTRICTS AS EQUALIZED BY DEPARTMENT OF TAXATION, SPECIAL TAXES, TOTAL TAXES, PAID, WHEN PAID, Number of Receipt, March Settlement 1956, June Settlement 1956, November Settlement 1956, Collections to First Monday in January 1957, Delinquent on First Monday in January 1957, Total Delinquent Tax and Penalty, REMARKS.

Assessment Roll and Tax List of Real Property in the Town of Wabedo, Cass County, Minnesota

Cass County, Minnesota, for Taxes for the Year 1955.

Form 302 (REV. 5-22-54) - MINNAPOLIS

*Indicate Type of Property: R-Residential, C-Commercial, I-Industrial, U-Utility, F-Farm

Main table with columns: IN WHOSE NAME ASSESSED, TO WHOM TRANSFERRED, DESCRIPTION OF PROPERTY, TRUE AND FULL VALUATIONS (LAND, BUILDINGS, MACHINERY, TOTAL), ASSESSED VALUATIONS (RURAL, ALL OTHER, MACHINERY, TOTAL ASSESSED), FINAL EQUALIZED VALUE, VALUATIONS BY SCHOOL DISTRICTS AS EQUALIZED BY DEPARTMENT OF TAXATION, TAXES (SPECIAL, TOTAL), PAID, WHEN PAID, Number of Receipt, March Settlement 1955, June Settlement 1955, Penalty, November Settlement 1955, Penalty, Collections to First Monday in January 1957, Penalty, Delinquent on First Monday in January 1957, Total Delinquent Tax and Penalty, REMARKS.

Wabedo Cass Iowa Point Landers Addition

Assessment Roll and Tax List of Real Property in the Town of Wabedo

Indicate Type of Property: R-Residential, C-Commercial, I-Industrial, U-Utility, F-Farm

Form 302 (55) JULY 1954 - 1955

IN WHOSE NAME ASSESSED	TO WHOM TRANSFERRED	DESCRIPTION OF PROPERTY				No. School District	Indicate Homestead Tax or No	Indicate Agricultural Tax or No	Indicate Type of Property	TRUE AND FULL VALUATIONS					ASSESSED VALUATIONS					FINAL EQUALIZED VALUE		
		SUBDIVISION	Sec. of Lot	Town of Block	Rng.					Number of Acres of Land	LAND Exclusive of Structures and Improvements	BUILDINGS and Other Structures	MACHINERY Permanently Attached to Real Estate	TOTAL True and Full Value	RURAL		ALL OTHER		MACHINERY Permanently Attached to Real Estate		TOTAL ASSESSED VALUE	Total Assessed Value as Equalized by the Board of Review
															Acres	10ths	Homestead Up to \$1,000 20%	Over \$4,000 and Non-Homestead 33 1/3%				
Leona Milling Co Sheridan Realty Co		E 1/2 of lot 1 less 9 ac. to NE 1/4 of NE 1/4 Paulson 22 1/2 22				21	no	no														
Harold L. & Norma J. Blakeman		NW 1/4 of NE 1/4				40	yes	no														
Emil & Anna Palke		SW 1/4 of NE 1/4 1/2 of lot 2				11.70	yes	no														
Arthur B. & Jennie C. Morrisons		SE 1/4 of NE 1/4 E 1/2 of lot 2				11	yes	no														
Sheridan Realty Co		1/2 of lot 1				29	no	no														
Harold L. & Norma J. Blakeman		NE 1/4 of NW 1/4				40	yes	no														
State of Minnesota		NW 1/4 of NW 1/4																				
State of Minnesota		SW 1/4 of NW 1/4																				
Harold L. & Norma J. Blakeman		SE 1/4 of NW 1/4 lot 3				32.25	yes	no														
Kosce & Sadie Murden		NE 1/4 of SW 1/4 lot 4 less 11.30'				23.50	no	no														
"		NW 1/4 of SW 1/4				40	yes	no														
"		SW 1/4 of SW 1/4				40	no	no														
Joe J. & Blanche C. Roscoe		SE 1/4 of SW 1/4				40	no	no														
Harold L. & Norma J. Blakeman		11.30' of lot 4					yes	no														
Harold C. & Fern Atwood		NE 1/4 of SE 1/4 lot 6				53.50	yes	no														
"		NW 1/4 of SE 1/4																				
"		SW 1/4 of SE 1/4 lot 5				36	yes	yes														
"		SE 1/4 of SE 1/4																				
Co. E. & Ruth M. Paulson		2 ac. of lot 1				2	no	no														

Cass County, Minnesota, for Taxes for the Year 1955.

SOLD FOR TAXES	VALUATIONS BY SCHOOL DISTRICTS AS EQUALIZED BY DEPARTMENT OF TAXATION						Tax Including State Homestead	State Tax on Homestead	SPECIAL TAXES	TOTAL TAXES	PAID	WHEN PAID	Number of Receipt	March Settlement 1954	June Settlement 1954	November Settlement 1954	Penalty	Collections to First Monday in January 1957	Penalty	Delinquent on First Monday in January 1957	Total Delinquent Tax and Penalty	REMARKS						
	District No.	District No.	District No.	District No.	District No.	District No.																	Rate	Rate	Rate	Rate	Rate	Rate
	Dollars	Dollars	Dollars	Dollars	Dollars	Dollars																	Mills	Mills	Mills	Mills	Mills	Mills
1							665		13478	344	13842	PAID IN FULL	MAY 31 1955	12898		13842												
2							48		974		974	PAID IN FULL	JUN 27 1956	9324		974	14											
3									5196	64	5260	PAID IN FULL	MAY 31 1956	2898		5260												
4									8340	130	8470	PAID IN FULL	MAY 8 1955	5990		8470												
5	FOR TAXES						145		2944	74	3018	PAID IN FULL	MAY 31 1955	2898		3018												
6							48		974		974	PAID IN FULL	JUN 27 1956	9324		974	14											
7																												
8																												
9									6534	94	6628	PAID IN FULL	JUN 27 1956	9324		6628	100											
10																												
11							200		7104	78	7182	PAID IN FULL	MAY 31 1956			7182												
12							40		812		812	PAID IN FULL	MAY 31 1956	12400		812												
13							40		812		812	PAID IN FULL	MAY 31 1956			812												
14							100		2030	52	2082	PAID IN FULL	MAY 31 1956	13114		2082												
15							12		244		244	PAID IN FULL	JUN 27 1956	9324		244	14											
16									12932	156	13088	PAID IN FULL	AUG 6 1956	10766		13088	196											
17																												
18							80		1624		1624	PAID IN FULL	AUG 6 1956	10765		1624	24											
19																												
20									3654	94	3748	PAID IN FULL	MAY 31 1955	12897		3748												

Wabedo Pass
Wabedo Springs
Chapin
Iowa Point
Murdens Addition

Assessment Roll and Tax List of Real Property in the Town of Wabedo, Minnesota

Indicate Type of Property: R-Residential, C-Commercial, I-Industrial, U-Utility, F-Farm

Wabedo Pass

Table with columns: IN WHOSE NAME ASSESSED, TO WHOM TRANSFERRED, DESCRIPTION OF PROPERTY, TRUE AND FULL VALUATIONS, ASSESSED VALUATIONS, FINAL EQUALIZED VALUE.

Handwritten names: J. E. Armstrong, James G. Armstrong, R. J. Andrews, D. R. Walker, D. B. + Maude Walker, Ellen + Clarence C. Fitzsimmons, Clarence B. + Sophie Cottrell, Thos. + Freda Schmidt, Geo. W. + Lillian M. Wilson

Wabedo Pass, Lots 41 & Sec. 22-27-40-28

Cass County, Minnesota, for Taxes for the Year 1955.

Table with columns: SOLD FOR TAXES, VALUATIONS BY SCHOOL DISTRICTS AS EQUALIZED BY DEPARTMENT OF TAXATION, Tax including State Homestead, SPECIAL TAXES, TOTAL TAXES, PAID, WHEN PAID, Number of Receipt, March Settlement 1956, June Settlement 1956, Penalty, November Settlement 1956, Penalty, Collections to First Monday in January 1957, Penalty, Delinquent on First Monday in January 1957, Total Delinquent Tax and Penalty, REMARKS.

Handwritten numbers: 81, 1012, 1093

Summary totals for the bottom row: 24366, 520, 24886, 4086, 9863, 892, 10045

Wabedo Springs, Iowa Point, Landers Addition

Assessment Roll and Tax List of Real Property in the _____ of _____,
*Indicate Type of Property: R-Residential, C-Commercial, I-Industrial, U-Utility, F-Farm

Wabedo Pass

Lowmie Chapman Beach Springs

Handers Addition

Table with columns: IN WHOSE NAME ASSESSED, TO WHOM TRANSFERRED, DESCRIPTION OF PROPERTY (SUBDIVISION, Sec. of Lot, Town or Block, Rng., Acres of Land), TRUE AND FULL VALUATIONS (LAND, BUILDINGS, MACHINERY, TOTAL True and Full Value), ASSESSED VALUATIONS (RURAL, ALL OTHER, MACHINERY, TOTAL ASSESSED VALUE), Total Assessed Value as Equalized by the Board of Review, FINAL EQUALIZED VALUE.

Cass County, Minnesota, for Taxes for the Year 1955.

Table with columns: SOLD FOR TAXES, VALUATIONS BY SCHOOL DISTRICTS AS EQUALIZED BY DEPARTMENT OF TAXATION (District No., Rate, Mills), Tax including State Homestead, State Tax on Non-Homestead, SPECIAL TAXES, TOTAL TAXES, PAID, WHEN PAID, Number of Receipt, March Settlement 1955, June Settlement 1955, Penalty, November Settlement 1955, Penalty, Collections to First Monday in January 1957, Penalty, Delinquent on First Monday in January 1957, Total Delinquent Tax and Penalty, REMARKS.