

ASSESSMENT & TAX LIST

Wabedo

1952

SUMMARY OF TAX COLLECTION

Original Levy	-	-	-	-	-	\$14020.96	
Additions	-	-	-	-	-	\$	
							\$14020.96
Abatements	-	-	-	-	-	\$	87.84
							\$13933.12
COLLECTIONS							
March Settlement	-	-	-	-	-	\$2113.4	
June Settlement	-	-	-	-	-	\$6940.31	
November Settlement	-	-	-	-	-	\$3542.69	
January Settlement	-	-	-	-	-	\$ 85.16	\$12679.50
							\$1253.62
Over Collected	-	-	-	-	-	\$ 18.56	
Under Collected	-	-	-	-	-	\$	
Delinquent	-	-	-	-	-	\$1272.18	\$1253.62
Total	-	-	-	-	-		\$13933.12

WABEBO PASS
 WABEBO SPRINGS
 IOWA POLICE
 HANDBOOK'S ADDITION

TABULAR SCHEDULE OF VALUATIONS,

LEVIED IN THE Town OF Wabedo

RATES AND TAXES

COUNTY OF CASS, STATE OF MINNESOTA

School District No.	VALUATION BY SCHOOL DISTRICTS				RATE OF STATE TAXES Total Rate of State Tax	RATE OF COUNTY TAXES					Total Rate of County Tax	RATE OF TOWN TAXES										Total Rate of Town Tax													
	Agri-cultural Lands	Non-Agri-cultural Lands	Personal Property	Total Value of all Property except Money and Credits		Rev.	R. & B.	Wel-fare	Bonds and Int.	Rev.		R. & B.	Drag Tax	State Loan	Deficiency	Tuition	Transportation	Other																	
<u>Uu</u>	<u>41723</u>	<u>137121</u>	<u>7393</u>	<u>62,828</u>	H. <u>4.58</u>	<u>27.1</u>	<u>12.8</u>	<u>51.3</u>	<u>14.3</u>	<u>105.56</u>	<u>5.6</u>	<u>16.</u>	<u>1.</u>					<u>22.6</u>	<u>1.</u>	<u>20.</u>	<u>40.</u>	<u>3.</u>	<u>3.</u>	<u>15.</u>	<u>102.</u>										

N. H. 2.26
6.84

Assessed Value	Rural	All Other	Personal Property	Total
Homestead	<u>13705</u>			<u>13705</u>
Non-Homestead	<u>41730</u>		<u>7393</u>	<u>49,123</u>
Total	<u>55435</u>		<u>7393</u>	<u>62,828</u>

SCHOOL TAXES	LOCAL 1 MILL AND SPECIAL SCHOOL TAXES BY DISTRICTS											ALL OTHER TAXES		
	Total Rate of Sch'l Tax	Total Rate of all Taxes	Local 1 Mill	Special	State Loan	Def.	Timp.	B. & I.	C. & O.	Total School Taxes	FUNDS	Rate	Amounts	
	<u>82.</u>	<u>214.68</u>	<u>4172</u>	<u>834.46</u>	<u>166892</u>	<u>12517</u>	<u>12517</u>	<u>62585</u>	<u>342129</u>	State-Non-Homestead		<u>11116</u>		
	<u>102.</u>	<u>234.68</u>	<u>2110</u>	<u>84420</u>	<u>84420</u>	<u>6331</u>	<u>6331</u>	<u>31658</u>	<u>215270</u>	State-Homestead		<u>28761</u>		
			<u>6282</u>	<u>167866</u>	<u>251312</u>	<u>18848</u>	<u>18848</u>	<u>94243</u>	<u>557399</u>	County Revenue, County Road and Bridge, County Welfare, Bonds and Interest		<u>170262</u> <u>80420</u> <u>322304</u> <u>89842</u> <u>262828</u>		
										Town Revenue, Town Road and Bridge, Town Drag, Town State Loan		<u>35184</u> <u>100525</u> <u>6283</u> <u>141992</u>		
										School Local 1 Mill, School Special, School State Loan, Deficiency Tuition Transportation Bond & Interest Capital Outlay		<u>6282</u> <u>167866</u> <u>251312</u> <u>18848</u> <u>18848</u> <u>94243</u> <u>557399</u>		

Total Taxes Real Estate 12269.28
Pers. Prop. 1751.68
Total 14020.96

Total Levy, \$ 14,020.96

L. C. Peterson
Auditor of said County and State aforesaid, do hereby certify that the foregoing is a true and correct Schedule, showing the valuation of all the taxable property, in the Town of Wabedo, in said County, the several rates of Taxation and Totals of the several Tax Funds levied thereon for the year A. D. 1952.

Witness my hand and official seal, this 6 day of January A. D. 1953

L. C. Peterson County Auditor.
By Helen Billen, Deputy



Assessment Roll and Tax List of Real Property in the Town of Wabedo

Cass County, Minnesota, for Taxes for the Year 1952.

IN WHOSE NAME ASSESSED	TO WHOM TRANSFERRED	DESCRIPTION OF PROPERTY				TRUE AND FULL VALUATIONS				ASSESSED VALUATIONS					FINAL EQUALIZED VALUE	SOLD FOR TAXES	VALUATIONS BY SCHOOL DISTRICTS AS EQUALIZED BY DEPARTMENT OF TAXATION						TAX INCLUDING STATE HOMESTEAD	STATE TAX ON NON-HOMESTEAD	SPECIAL TAXES	TOTAL TAXES	PAID	WHEN PAID	Number of Receipts	March Settlement 1953	June Settlement 1953	Penalty	November Settlement 1953	Penalty	Collections to First Monday in January 1954	Penalty	Delinquent on First Monday in January 1954	Total Delinquent Tax and Penalty	REMARKS					
		Subdivision	Sec. or Lot	Town or Block	Rng.	Number of Acres of Land	LAND Exclusive of Structures and Improvements	BUILDINGS and Other Structures	MACHINERY Permanently Attached to Real Estate	TOTAL True and Full Value	RURAL		ALL OTHER				MACHINERY Permanently Attached to Real Estate	TOTAL ASSESSED VALUE	Total Assessed Value as Equalized by the Board of Review	District No.	Rate	District No.																		Rate	District No.	Rate	District No.	Rate
											Homestead Up to \$4,000 20%	Over \$4,000 and Non-Homestead 33 1/3%	Homestead Up to \$4,000 25%	Over \$4,000 and Non-Homestead 40%																														
Earnest W. Barentzen		NE 1/4 of NE 1/4	Lot 4	5	140 28	4117	No		270				90	90		1	90							1932	20	1952	1	PAID IN FULL	APR 10 1953	3213		1952												
Alona L. Stella Luby		NW 1/4 of NE 1/4	Lot 3		3572	No		422	103	100			175	175		2	175							3756	40	3796	2	PAID IN FULL	MAY 29 1953	12076		3796												
Earnest W. Barentzen		SW 1/4 of NE 1/4	Lot 5		4785	No		490					160	160		3	160							3434	36	3470	3	PAID IN FULL	APR 10 1953	3213		3470												
		SE 1/4 of NE 1/4	Lot 5													4																												
																5																												
Henry L. & Irene L. Brunette		NE 1/4 of NW 1/4	Lot 2		4687	Yes		565	630	825	combine	2062	239	289	528	6	239							11336	66	11402	6	PAID IN FULL	MAY 29 1953	12074		11402												
State of Minnesota		NW 1/4 of NW 1/4	Lot 1													7																												
Wilbur L. & Bernice E. Thatcher		SW 1/4 of NW 1/4	Lot 9		32	No		384					128	128		8	128							2748	28	2776	8	PAID IN FULL	MAY 1 1953	5199		2776												
		SE 1/4 of NW 1/4														9																												
Miss B. & Jewell C. Dunne		1/2 of NE 1/4 of SE 1/4 less 10' dockage			10	No		351	471	450		822	274	274	274	10	274							5882	62	5944	10	PAID IN FULL	JUL 9 1953	11157		5944												
Fred W. Schauer & Bernice E. Thatcher		NE 1/4 of SW 1/4	Lot 7		5375	Yes		390				390	78	78		11	78							1674		1674	11	PAID IN FULL	AUG 13 1953	12718		1674												
Wilbur L. & Bernice E. Thatcher		NW 1/4 of SW 1/4	Lot 8		40	No		480				480	160	160		12	160							3434	36	3470	12	PAID IN FULL	MAY 1 1953	5199		3470												
Fred W. Schauer & Bernice E. Thatcher		SW 1/4 of SW 1/4			40	Yes		270				270	54	54		13	54							1160		1160	13	PAID IN FULL	AUG 13 1953	12718		1160												
		SE 1/4 of SW 1/4														14																												
Thomas H. Conners		10' dockage of NE 1/4 of SE 1/4				No		15				15		5		15	5							108		108	15	2nd Half Paid	OCT 6 1953	13303		54		54										
J. L. & Jessaline C. Scott		1/2 of NE 1/4 of SE 1/4 less 10' dockage			20	No		240	471	450		690	237	237		16	237							5088	64	5142	16	SOLD FOR TAXES																
B. F. Hartzfel		NW 1/4 of SE 1/4	Lot 6		32	No		480	96	90		576	192	192		17	192							4122	44	4166	17	PAID IN FULL	MAY 29 1953	12073		4166												
"		SW 1/4 of SE 1/4			40	No		270				270	90	90		18	90							1932	20	1952	18	PAID IN FULL	MAY 29 1953	12073		1952												
Thomas H. Conners		SE 1/4 of SE 1/4			40	"		270				270	90	90		19	90							1932	20	1952	19	2nd Half Paid	OCT 6 1953	13303		976		976										
Miss B. & Jewell C. Dunne		1/2 of NE 1/4 of SE 1/4 less 10' dockage			60	No		201				201	67	67		20	67							344	04	348	20	PAID IN FULL	JUL 9 1953	11157		348												
					48936			5688	2638	2515		1726	371	1957	2328		371							49976	442	50418						34014		11262										

Ref. W. #1109 #1106 8.25.53 11.06 Abated

WABEDO PASS HEND SPRINGS 10TH FOL MANDELS ADDITION

Assessment Roll and Tax List of Real Property in the Down of Wabeka

IN WHOSE NAME ASSESSED	TO WHOM TRANSFERRED	DESCRIPTION OF PROPERTY				TRUE AND FULL VALUATIONS					ASSESSED VALUATIONS					FINAL EQUALIZED VALUE		
		SUBDIVISION	Sec. or Lot	Town or Block	Rag.	Number of Acres of Land	LAND Structures and Improvements	BUILDINGS and Other Structures	MACHINERY Permanently Attached to Real Estate	TOTAL True and Full Value	RURAL		ALL OTHER		MACHINERY Permanently Attached to Real Estate		TOTAL ASSESSED VALUE	Total Assessed Value as Equalized by the Board of Review
											Homestead Up to \$4,000	Over \$4,000 and Non-Homestead	Homestead Up to \$4,000	Over \$4,000 and Non-Homestead				
											20%	33 1/3%	25%	40%				
Acres	100ths	Dollars	Dollars	Dollars	Dollars	Dollars	Dollars	Dollars	Dollars	Dollars	Dollars	Dollars	Dollars	Dollars				
	North Central Area Council of Young Men's Christian Associations	NE 1/4 of NE 1/4	10	14	28	40	201		201		67			67				
	"	NW 1/4 of NE 1/4	"	"	"	40	201		201		67			67				
	"	SW 1/4 of NE 1/4	"	"	"	40	201		201		67			67				
	"	SE 1/4 of NE 1/4	"	"	"	40	201		201		67			67				
	"	NE 1/4 of NW 1/4	"	"	"	40	201		201		67			67				
	"	NW 1/4 of NW 1/4	"	"	"	40	201		201		67			67				
	"	SW 1/4 of NW 1/4	"	"	"	40	201		201		67			67				
	"	SE 1/4 of NW 1/4	"	"	"	40	201		201		67			67				
	"	NE 1/4 of SW 1/4	"	"	"	40	201		201		67			67				
	"	NW 1/4 of SW 1/4	"	"	"	40	201		201		67			67				
	"	SW 1/4 of SW 1/4	"	"	"	40	201		201		67			67				
	"	SE 1/4 of SW 1/4	"	"	"	40	201		201		67			67				
	"	NE 1/4 of SE 1/4 Lot 1	"	"	"	34	408	6300	408	126			136					
	"	NW 1/4 of SE 1/4 Lot 2	"	"	"	57	30	685	9190	1397	735		2132					
	"	SW 1/4 of SE 1/4	"	"	"			2185	8785	1337	700		2037					
	"	SE 1/4 of SE 1/4	"	"	"													
						571	90	3505	12010	1397	1675		3072					
								8100	11625	1337	1645		2977					

Cass County, Minnesota, for Taxes for the Year 1952.

SOLD FOR TAXES	VALUATIONS BY SCHOOL DISTRICTS AS EQUALIZED BY DEPARTMENT OF TAXATION						Tax Including State Homestead	State Tax on Non-Homestead	SPECIAL TAXES	TOTAL TAXES	PAID	WHEN PAID	Number of Receipts	March Settlement 1953	June Settlement 1953	November Settlement 1953	Penalty	Collections to First Monday in January 1954	Penalty	Delinquent on First Monday in January 1954	Total Delinquent Tax and Penalty	REMARKS
	District No.	District No.	District No.	District No.	District No.	District No.																
	Rate	Rate	Rate	Rate	Rate	Rate																
	Mills	Mills	Mills	Mills	Mills	Mills																
Dollars	Dollars	Dollars	Dollars	Dollars	Dollars	\$ cts.	\$ cts.	\$ cts.	\$ cts.	\$ cts.	\$ cts.	\$ cts.	\$ cts.	\$ cts.	\$ cts.	\$ cts.	\$ cts.	\$ cts.	\$ cts.	\$ cts.	\$ cts.	
1						67	14 38	16	14 54	1	1st Half Paid MAY 1 1953 2nd Half Paid OCT 21 1953											
2						67	14 38	16	14 54	2	1st Half Paid MAY 1 1953 2nd Half Paid OCT 21 1953											
3						67	14 38	16	14 54	3	1st Half Paid MAY 1 1953 2nd Half Paid OCT 21 1953											
4						67	14 38	16	14 54	4	1st Half Paid MAY 1 1953 2nd Half Paid OCT 21 1953											
5										5												
6						67	14 38	16	14 54	6	1st Half Paid MAY 1 1953 2nd Half Paid OCT 21 1953											
7						67	14 38	16	14 54	7	1st Half Paid MAY 1 1953 2nd Half Paid OCT 21 1953											
8						67	14 38	16	14 54	8	1st Half Paid MAY 1 1953 2nd Half Paid OCT 21 1953	4133										
9						67	14 38	16	14 54	9	1st Half Paid MAY 1 1953 2nd Half Paid OCT 21 1953	5196										
10										10												
11						67	14 38	16	14 54	11	1st Half Paid MAY 1 1953 2nd Half Paid OCT 21 1953											
12						67	14 38	16	14 54	12	1st Half Paid MAY 1 1953 2nd Half Paid OCT 21 1953											
13						67	14 38	16	14 54	13	1st Half Paid MAY 1 1953 2nd Half Paid OCT 21 1953											
14						67	14 38	16	14 54	14	1st Half Paid MAY 1 1953 2nd Half Paid OCT 21 1953											
15										15												
16						136	29 20	30	29 50	16	1st Half Paid MAY 1 1953 2nd Half Paid OCT 21 1953											
17						1397	45 70	166	45 93	17	1st Half Paid MAY 1 1953 2nd Half Paid OCT 21 1953											
18										18												
19										19												
20										20												
						71397	6 59 46	388	6 63 34													
						1675																
						3072																

VALUED PAISS

MADEO SPRINGS

JOWA POINT

MANDEE'S ADDITION

Assessment Roll and Tax List of Real Property in the Town of Wabeka

Table with columns: IN WHOSE NAME ASSESSED, TO WHOM TRANSFERRED, DESCRIPTION OF PROPERTY, TRUE AND FULL VALUATIONS, ASSESSED VALUATIONS, FINAL EQUALIZED VALUE, VALUATIONS BY SCHOOL DISTRICTS AS EQUALIZED BY DEPARTMENT OF TAXATION, TAX INCLUDING STATE HOMESTEAD, STATE TAX ON NON-HOMESTEAD, SPECIAL TAXES, TOTAL TAXES, PAID, WHEN PAID, Number of Receipt, March Settlement 1953, June Settlement 1953, November Settlement 1953, Penalty, Collections to First Monday in January 1954, Delinquent on First Monday in January 1954, Total Delinquent Tax and Penalty, REMARKS.

Assessment Roll and Tax List of Real Property in the Town of Loun of Stabed

Cass County, Minnesota, for Taxes for the Year 1952.

IN WHOSE NAME ASSESSED	TO WHOM TRANSFERRED	DESCRIPTION OF PROPERTY				TRUE AND FULL VALUATIONS					ASSESSED VALUATIONS					FINAL EQUALIZED VALUE	SOLD FOR TAXES	VALUATIONS BY SCHOOL DISTRICTS AS EQUALIZED BY DEPARTMENT OF TAXATION						Tax Including State Homestead Mills	State Tax on Non-Homestead Mills	SPECIAL TAXES	TOTAL TAXES	PAID	WHEN PAID	Number of Receipt	March Settlement 1952	June Settlement 1952	November Settlement 1952	Penalty	Collections to First Monday in January 1954	Penalty	Delinquent on First Monday in January 1954	Total Delinquent Tax and Penalty	REMARKS
		Subdivision	Sec. or Lot	Town or Block	Reg.	Number of Acres of Land	LAND Exclusive of Structures and Improvements	BUILDINGS and Other Structures	MACHINERY Permanently Attached to Real Estate	TOTAL True and Full Value	RURAL Homestead Up to \$4,000 20%	ALL OTHER Over \$4,000 and Non-Homestead 25%	MACHINERY Permanently Attached to Real Estate 33 1/3%	TOTAL ASSESSED VALUE	Total Assessed Value as Equalized by the Board of Review			District No.	District No.	District No.	District No.	District No.	District No.																
<u>Ester M. Elias</u>		<u>NE 1/4 of NE 1/4 Lot 1</u>	<u>14 1/2</u>	<u>at</u>	<u>21</u>		<u>250</u>	<u>725</u>	<u>750</u>	<u>985</u>	<u>197</u>	<u>190</u>	<u>197</u>	<u>190</u>	<u>1</u>	<u>SOLD FOR TAXES</u>	<u>2175</u> Rate: 9.1 Mills						<u>42.30</u>		<u>42.30</u>	<u>1</u>									<u>7230</u>	<u>46.53</u>			
<u>Jean C. Collier</u>		<u>SE 1/4 of NE 1/4 Lot 2</u>			<u>36.25</u>	<u>12</u>	<u>431</u>	<u>262</u>	<u>250</u>	<u>693</u>	<u>231</u>	<u>227</u>	<u>231</u>	<u>227</u>	<u>4</u>							<u>52</u>	<u>49.60</u>	<u>52</u>	<u>50.12</u>	<u>4</u>	<u>PAID IN FULL</u>	<u>DEC 18 1953</u>	<u>5388</u>				<u>50.12</u>	<u>4.00</u>					
<u>Henry Pearson</u>		<u>NE 1/4 of SE 1/4 Lot 3</u>			<u>14.25</u>	<u>Not</u>	<u>170</u>	<u>64</u>	<u>61</u>	<u>234</u>	<u>78</u>	<u>77</u>	<u>78</u>	<u>77</u>	<u>16</u>							<u>78</u>	<u>16.74</u>	<u>78</u>	<u>169.2</u>	<u>16</u>	<u>PAID IN FULL</u>	<u>MAY 26 1953</u>	<u>6417</u>				<u>169.2</u>						
<u>Reuben W. & Ethel C. ...</u>		<u>NW 1/4 of SE 1/4 Lot 4</u>			<u>23.25</u>	<u>Not</u>	<u>345</u>	<u>249</u>	<u>237</u>	<u>594</u>	<u>198</u>	<u>194</u>	<u>198</u>	<u>194</u>	<u>18</u>							<u>198</u>	<u>42.50</u>	<u>194</u>	<u>429.7</u>	<u>18</u>	<u>PAID IN FULL</u>	<u>MAR 24 1953</u>	<u>3674</u>				<u>429.7</u>						
					<u>94.75</u>		<u>1196</u>	<u>1310</u>	<u>1248</u>	<u>2506</u>	<u>197</u>	<u>597</u>	<u>2444</u>	<u>190</u>	<u>20</u>		<u>4197</u>					<u>50.7</u>	<u>151.14</u>	<u>114</u>	<u>15228</u>							<u>5986</u>		<u>50.12</u>	<u>42.30</u>				

MARSDEN PASS
MARBED SPRINGS
10th FOL
MARSDEN'S ADDITION

IN WHOSE NAME ASSESSED	TO WHOM TRANSFERRED	DESCRIPTION OF PROPERTY	TRUE AND FULL VALUATIONS				ASSESSED VALUATIONS						FINAL EQUALIZED VALUE	SOLD FOR TAXES	VALUATIONS BY SCHOOL DISTRICTS AS EQUALIZED BY DEPARTMENT OF TAXATION						SPECIAL TAXES	TOTAL TAXES	PAID	WHEN PAID	Number of Receipt	March Settlement 1953	June Settlement 1953	November Settlement 1953	Collections to First Monday in January 1954	Delinquent on First Monday in January 1954	Total Delinquent Tax and Penalty	REMARKS								
			Subdivision	Sec or Lot	Town or Block	Rng.	Number of Acres of Land	LAND Exclusive of Structures and Improvements	BUILDINGS and Other Structures	MACHINERY Permanently Attached to Real Estate	TOTAL True and Full Value	RURAL			ALL OTHER		MACHINERY Permanently Attached to Real Estate	TOTAL ASSESSED VALUE	District No.	District No.													District No.	District No.	Rate	Rate	Rate	Rate		
												Homestead Up to \$4,000 20%			Over \$4,000 and Non-Homestead 33 1/3%	Homestead Up to \$4,000 25%																							Over \$4,000 and Non-Homestead 40%	\$ cts.
		NE 1/4 of NE 1/4			15 1/4																																			
		NW 1/4 of NE 1/4																																						
	John & Elizabeth Laines	SW 1/4 of NE 1/4 Lot 2						257 21	No	390	945 900	1335 1290	445 420	445 430					445		104 44	100	105 44	3rd Half Paid	OCT 15 1953	1348 11357			5272											
		SE 1/4 of NE 1/4																																						
	" " " "	Lot 1 lying E. of G.A.R. #28						425	No	121	212 200	333 321	111 107	111 107							2382	76	24 08	2nd Half Paid	OCT 5 1953	1348 11357			1209											
	E. C. Olson	NE 1/4 of NW 1/4						4950	No	549		549	183	183					183		39 28	42	39 70	1st Half Paid	MAY 1 1953			1985												
	"	NW 1/4 of NW 1/4						40	"	201		201	67	67					67		1438	16	14 64	2nd Half Paid	OCT 21 1953			727												
	"	SW 1/4 of NW 1/4						40	"	201		201	67	67					67		1438	16	14 64	2nd Half Paid	OCT 21 1953			727												
	"	SE 1/4 of NW 1/4						40	"	201		201	67	67					67		1438	16	14 64	2nd Half Paid	OCT 21 1953			727												
		NE 1/4 of SW 1/4						40	Yes	270	790 750	1060 1020	212 204	312 304					H 212		4562		45 52	Balance Paid	OCT 27 1953			2276												
	Gerd & Lucie M. Duesch	NW 1/4 of SW 1/4						40	No	201		201	67	67					H 67		46		45 58	Balance Paid	OCT 27 1953			727												
	"	SW 1/4 of SW 1/4						40	"	201		201	67	67					H 40		16		45 58	Balance Paid	OCT 27 1953			727												
	"	SE 1/4 of SW 1/4 Lot 4						2895	"	291	159 150	450 441	150 147	150 147					H 20		34		1934 3270	Balance Paid	OCT 27 1953			1627												
		NE 1/4 of SE 1/4																																						
		NW 1/4 of SE 1/4 Lot 3						24	No	312		312	104	104					H 104		24		2232	1st Half Paid	MAY 1 1953	5196 14133			1129											
	E. C. Olson	SW 1/4 of SE 1/4																																						
		SE 1/4 of SE 1/4																																						
								3724		2938	2106 2000	5044 4938	212 204	1328 1306	1540 1510					H 212 883		306		10444 23504			10651			21096										

WARREN PASS

WARREN SPRINGS

10-A FOOT

HANDER'S ADDITION

Assessment Roll and Tax List of Real Property in the Town of Wadena

Cass County, Minnesota, for Taxes for the Year 1952

IN WHOSE NAME ASSESSED	TO WHOM TRANSFERRED	DESCRIPTION OF PROPERTY				TRUE AND FULL VALUATIONS		ASSESSED VALUATIONS					Total Assessed Value as Equalized by the Board of Review	FINAL EQUALIZED VALUE	SOLD FOR TAXES	VALUATIONS BY SCHOOL DISTRICTS AS EQUALIZED BY DEPARTMENT OF TAXATION						Tax Including State Homestead	State Tax on Non-Homestead	SPECIAL TAXES	TOTAL TAXES	PAID	WHEN PAID	Number of Receipt	March Settlement 1953	June Settlement 1953	Penalty	November Settlement 1953	Penalty	Collections to First Monday in January 1954	Penalty	Delinquent on First Monday in January 1954	Total Delinquent Tax and Penalty	REMARKS																
		SUBDIVISION	Sec. of Loc	Town or Block	Rng.	Number of Acres of Land	No. of School District	Indicate Homesteaded Yes or No	Indicate Agricultural Yes or No	LAND Excludes Structures and Improvements	BUILDINGS and Other Structures	MACHINERY Permanently Attached to Real Estate				TOTAL True and Full Value	RURAL		ALL OTHER		MACHINERY Permanently Attached to Real Estate																		TOTAL ASSESSED VALUE	District No. 1	District No. 2	District No. 3	District No. 4	District No. 5	District No. 6									
																	Rate	Rate	Rate	Rate																				Rate	Rate	Mills	Mills	Mills	Mills	Mills	Mills							
																	Mills	Mills	Mills	Mills																				Mills	Mills	Mills	Mills	Mills	Mills	Mills	Mills							
																	Dollars	Dollars	Dollars	Dollars																				Dollars	Dollars	Dollars	Dollars	Dollars	Dollars	Dollars	Dollars							
<u>Alfred F. Maricela</u>				<u>16.14028</u>	<u>40</u>	<u>211/1</u>			<u>7500</u>			<u>240</u>						<u>240</u>							<u>80</u>									<u>17 18</u>	<u>18</u>	<u>17 36</u>					<u>1 2/01</u>		<u>17 36</u>											
<u>State of Minnesota</u>																																																						
<u>Alfred F. Maricela</u>					<u>40</u>	<u>16</u>						<u>240</u>																																										
<u>State of Minnesota</u>																																																						
<u>George E. Hagen</u>				<u>21/24</u>	<u>20</u>	<u>Yes</u>						<u>100</u>																																										
<u>State of Minnesota</u>																																																						
<u>Archie & Ruth Bishop</u>				<u>2/4</u>	<u>20</u>	<u>Yes</u>						<u>100</u>																																										
<u>State of Minnesota</u>																																																						
<u>Thomas L. & Emma L. Whitman</u>					<u>40</u>	<u>Yes</u>						<u>240</u>	<u>105</u>	<u>100</u>																																								
<u>John Ekdahl</u>					<u>40</u>	<u>Yes</u>						<u>240</u>																																										
<u>State of Minnesota</u>																																																						
<u>State of Minnesota</u>																																																						
<u>State of Minnesota</u>																																																						
<u>State of Minnesota</u>																																																						
					<u>20000</u>				<u>100</u>	<u>105</u>		<u>1305</u>	<u>165</u>	<u>160</u>					<u>165</u>	<u>160</u>						<u>6980</u>	<u>36</u>	<u>7016</u>														<u>4766</u>	<u>773</u>				<u>1482</u>							

Assessment Roll and Tax List of Real Property in the Town of Wabedon

Cass County, Minnesota, for Taxes for the Year 1952.

IN WHOSE NAME ASSESSED	TO WHOM TRANSFERRED	DESCRIPTION OF PROPERTY				TRUE AND FULL VALUATIONS					ASSESSED VALUATIONS					FINAL EQUALIZED VALUE
		SUBDIVISION	Sec. Lot	Town or Block	No. of Acres of Land	LAND Exclusive of Structures and Improvements	BUILDINGS and Other Structures	MACHINERY Permanently Attached to Real Estate	RURAL		ALL OTHER		MACHINERY Permanently Attached to Real Estate 33 1/3%	TOTAL ASSESSED VALUE	Total Assessed Value as Equalized by the Board of Review	
									Homestead Up to \$4,000 20%	Over \$4,000 and Non-Homestead 33 1/3%	Homestead Up to \$4,000 25%	Over \$4,000 and Non-Homestead 40%				
Frank C. & Helen B. Barger		N.E. 1/4 of N.E. 1/4 Lot 7	22	14028	3.75	360	126	486	162			162	160	160		
Edward L. & Mary E. Morage		W. 560' of E. 1/2 of Lot 6				735		855	171			171	171	171		
Louis C. & Inez L. Mathias		S.E. 1/4 of N.E. 1/4 Lot 6				120	700	820	164			164	164	164		
Herman P. & Evelyn E. Pechter		150' of Lot 5			1	29	41	427	143			143	143	143		
Lyle H. & Helen Bradduck		N.E. 1/4 of N.W. 1/4 Lot 1			31	495	700	2175	246	315		561	539	539		
State of Minnesota		N.W. 1/4 of N.W. 1/4														
State of Minnesota		S.W. 1/4 of N.W. 1/4														
Lyle H. & Helen Bradduck		S.E. 1/4 of N.W. 1/4 Lot 2			33	395		395	79			79	79	79		
Lyle H. & Helen Bradduck		Lot 6			1650	250	212	462	154			154	154	154		
Ray F. Mace		N.W. 1/4 of S.W. 1/4 Lot 3			39	480	310	690	230			230	227	227		
"		N.W. 1/4 of S.W. 1/4			40	270		270	90			90	90	90		
Mad. C. & Louise C. Lampman		S.W. 1/4 of S.W. 1/4			40	270	315	270	54			54	54	54		
"		Lot 4			2938	450	3045	1710	153	315		468	450	450		
B. B. Bault		75' of Lot 4			227	60	201	261	97			97	87	87		
Louis F. & Louise M. Houser		N.E. 1/4 of S.E. 1/4 Lot 5			1050	150	575	675	135			135	135	135		
Paul & Clara C. Heavers		N.W. 1/4 of S.E. 1/4 Lot 5			3850	570	675	2145	240	315		555	534	534		
Neil C. & Louise C. Lampman		S.W. 1/4 of S.E. 1/4 Lot 5			1	45	345	45	9			9	9	9		
Harold Lawrence & Hazel Esther Leeper		Lot 6			7	165	330	1140	102	210		312	299	299		
Wabedon Camp		1 acre of Lot 1			32390		7932	12041	1189	2032		3221	3115	3115		

SOLD FOR TAXES	VALIDATIONS BY SCHOOL DISTRICTS AS EQUALIZED BY DEPARTMENT OF TAXATION						Tax including State Homestead	State Tax on Non-Homestead	SPECIAL TAXES	TOTAL TAXES	PAID	WHEN PAID	Number of Receipt	March Settlement 1953	June Settlement 1953	Penalty	November Settlement 1953	Penalty	Collections to First Monday in January 1954	Penalty	Delinquent on First Monday in January 1954	Total Delinquent Tax and Penalty	REMARKS
	District No.	District No.	District No.	District No.	District No.	District No.																	
	Rate	Rate	Rate	Rate	Rate	Rate																	
1						162	3478	36	3514	1 PAID IN FULL	MAY 29 1953	12124		3514									
2										2													
3										3													
4						#171	3672		3672	4													
5						150	3720		3720	5													
6							13166	72	13238	6													
7										7													
8										8													
9						#79	1696		1696	9													
10						154	3306	34	3340	10													
11						230	4938	52	4990	11													
12						90	1932	20	1952	12													
13						#54	1160		1160	13													
14							10984	72	11056	14													
15						#50	1180		1180	15													
16						#135	2898		2898	16													
17							13024	72	13096	17													
18						#9	184		184	18													
19							7322	48	7370	19													
20						#448	44496		44496	20													
						877	28448		28448														
						1325	72944		72944														

TABERN PASS TABERN SPRINGS IOWA PORT WARDNER'S ADDITION

Assessment Roll and Tax List of Real

IN WHOSE NAME ASSESSED	TO WHOM TRANSFERRED	DESCRIPTION OF PROPERTY	Sec. of Lot	Town of Block
			27	140
<i>Salomon Roberstad</i>		Strip 200' wide of Lot 8 between lake and road and lying adjacent to and SW of a line parallel to and 1140' distant from SW line of Lot 1, Plat of Wabedo Pass.		
<i>Verlaunt & Roberstad</i>		All that part of Lot 8 lying SW of a line which is parallel to and 1340' distant from SW line of Lot 1, Plat of Wabedo Pass less to Oltmans.		
<i>Adolph E. & Effie Roberstad</i>		A strip 874' wide of Lot 8, lying adjacent to and SW of extended line parallel to and 266' distant from SW line of Lot 1, Plat of Wabedo Pass less E. 300'		
<i>Lloyd M. & Rose Thorburn</i>		Strip 200' wide of Lot 8 lying between lake and road, and being parallel to and 66' from SW line of Lot 1, Plat of Wabedo Pass. 1.39 acs. Strip 100' of Lot 8 lying between road and north line of I and being parallel to and 66' from extended SW line of Lot 1, Plat of Wabedo Pass. .61 acs.		
<i>Lloyd M. & Rose Thorburn</i>		Strip 100' wide of Lot 8 lying between road north line of Lot 8 and being parallel to and 166' from extended SW line of Lot 1, Plat of Wabedo Pass.		
<i>Linn Castle</i>		Strip 200' wide of Lot 8, between road and W line of Lot 8 and lying adjacent to and SW of an extended line parallel to and 1140' distant from SW line of Lot 1, Plat of Wabedo Pass.		
<i>Linn Oltmans</i>				

Handwritten notes:
 Lloyd M. & Rose Thorburn & Salomon Roberstad
 A strip 300' wide between lake & road
 71. line by lot 8 & 1 being parallel to & 266' from SW line of Lot 1, Plat of Wabedo Pass.
 Part of Lot 8
 Not
 47.17
 62 1058 1113 371
 1000 1062 354
 2575 3272 814
 2450 3167 163 784

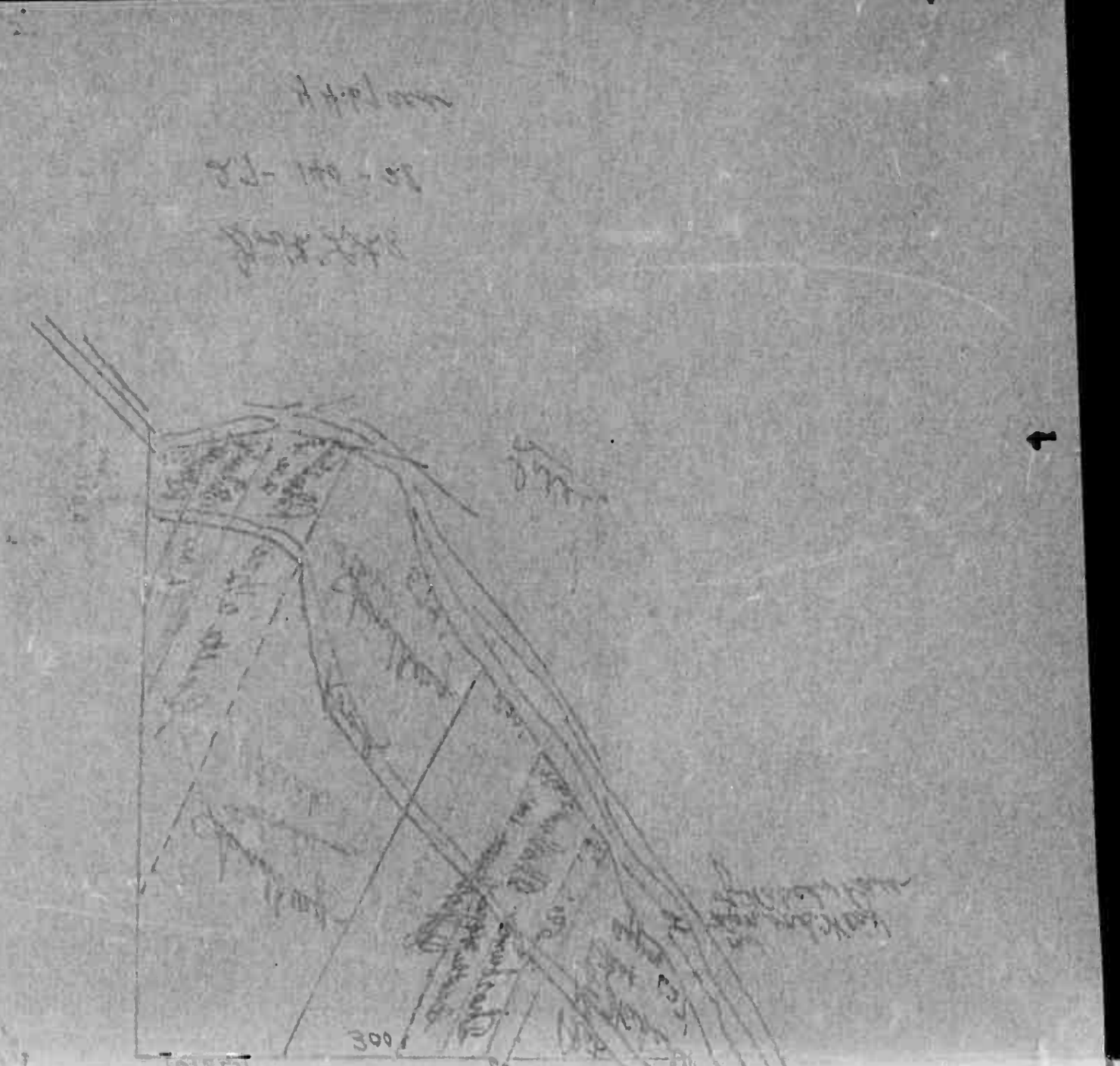

Cass County, Minnesota, for Taxes for the Year 1952.

FINAL EQUALIZED VALUE	SOLD FOR TAXES	VALUATIONS BY SCHOOL DISTRICTS AS ESTABLISHED BY DEPARTMENT OF TAXATION						Tax Including Rate Homestead	State Tax on Non-Homestead	SPECIAL TAXES	TOTAL TAXES	PAID	WHEN PAID	Number of Receipt	March Settlement 1953	June Settlement 1953	Penalty	November Settlement 1953	Penalty	Collections to First Monday in January 1954	Penalty	Delinquent on First Monday in January 1954	Total Delinquent Tax and Penalty	REMARKS
		District No. Rate	District No. Rate	District No. Rate	District No. Rate	District No. Rate	District No. Rate																	
Dollars		Dollars	Dollars	Dollars	Dollars	Dollars	Dollars	\$ cts.	\$ cts.	\$ cts.	\$ cts.	Month Day Year		\$ cts.	\$ cts.	\$ cts.	\$ cts.	\$ cts.	\$ cts.	\$ cts.	\$ cts.	\$ cts.		
	1	10					214	02		216	1	PAID IN FULL MAY 29 1953												
	2																							
	3																							
	4						6454	24		6478	4	PAID IN FULL MAY 29 1953												
	5																							
	6																							
	7						97	22		2104	7	PAID IN FULL MAY 29 1953												
	8																							
	9																							
	10						16	04		348	10	PAID IN FULL JAN 14 1953												
	11																							
	12						195	44		4230	12	PAID IN FULL JAN 24 1953												
	13																							
	14																							
	15																							
	16																							
	17						20	04		434	17													
	18																							
	19																							
	20						371	84		8048	20	PAID IN FULL MAY 20 1953												
							709	784		21858														
							709																	

WABEDO PASS
 WABEDO SPRINGS
 TOWN OF
 WABEDO'S ADDITION

Assessment Roll and Tax List of Real Property in the Town of Naleda

IN WHOSE NAME ASSESSED	TO WHOM TRANSFERRED	DESCRIPTION OF PROPERTY				TRUE AND FULL VALUATIONS										FINAL EQUALIZED VALUE			
		SUBDIVISION	Sec. of Lot	Town of Block	Number of Acres of Land	LAND EXCLUSIVE OF STRUCTURES AND IMPROVEMENTS					BUILDINGS AND OTHER STRUCTURES		MACHINERY PERMANENTLY ATTACHED TO REAL ESTATE		TOTAL TRUE AND FULL VALUE		Total Assessed Value as Equalized by the Board of Review		
						No. School District	Imp. Head Tax	Imp. Rate	Appl. Tax or No.	No. or Yes	Dollars	Dollars	Dollars	Dollars	Dollars			Dollars	Dollars
					Dollars	Dollars	Dollars	Dollars	Dollars	Dollars	Dollars	Dollars	Dollars	Dollars	Dollars				

SOLD FOR TAXES	VALUATIONS BY SCHOOL DISTRICTS AS EQUALIZED BY DEPARTMENT OF TAXATION						Tax Including State Homestead	State Tax on Non-Homestead	SPECIAL TAXES	TOTAL TAXES	PAID	WHEN PAID	Number of Receipt	March Settlement 1953	June Settlement 1953	Penalty	November Settlement 1953	Penalty	Collections to First Monday in January 1954	Penalty	Delinquent on First Monday in January 1954	Total Delinquent Tax and Penalty	REMARKS
	District No.	District No.	District No.	District No.	District No.	District No.																	
	Rate	Rate	Rate	Rate	Rate	Rate																	

MADISON PASS HERO SPRINGS 10A FOR MADSEN'S ADDITION

Assessment Roll and Tax List of Real Property in the Town of *Down* of *Wabeka*

Cass County, Minnesota, for Taxes for the Year 1952.

Form 300 (1952)	IN WHOSE NAME ASSESSED	TO WHOM TRANSFERRED	DESCRIPTION OF PROPERTY			TRUE AND FULL VALUATIONS					ASSESSED VALUATIONS					FINAL EQUALIZED VALUE	SOLD FOR TAXES	VALUATIONS BY SCHOOL DISTRICTS AS EQUALIZED BY DEPARTMENT OF TAXATION						TOTAL TAXES	PAID	WHEN PAID	Number of Receipt	March Settlement 1953	June Settlement 1953	Penalty	November Settlement 1953	Penalty	Collections to First Monday in January 1954	Penalty	Delinquent on First Monday in January 1954	Total Delinquent Tax and Penalty	REMARKS						
						LAND Exclusive of Structures and Improvements	BUILDINGS and Other Structures	MACHINERY Permanently Attached to Real Estate	TOTAL True and Full Value	RURAL		ALL OTHER		MACHINERY Permanently Attached to Real Estate	TOTAL ASSESSED VALUE			Total Assessed Value as Equalized by the Board of Review	District No.	District Rate	District No.	District Rate	District No.															District Rate	District No.	District Rate	Tax including State Homestead	State Tax on Non-Homestead	SPECIAL TAXES
										Homestead Up to \$4,000 20%	Over \$4,000 and Non-Homestead 33 1/3%	Homestead Up to \$4,000 25%	Over \$4,000 and Non-Homestead 40%																														
	State of Minnesota		NE 1/4 of NE 1/4		31 1/2 28																																						
	State of Minnesota		NW 1/4 of NE 1/4																																								
	State of Minnesota		SW 1/4 of NE 1/4																																								
	State of Minnesota		SE 1/4 of NE 1/4																																								
	Franklin Transformer Mfg Co		NE 1/4 of NW 1/4 Lot 1		121	No	180	222	392	134	130	134								2806	30		2906	PAID IN FULL	MAY 29 1953											2906							
	"		NW 1/4 of NW 1/4 Lot 1		875	"	135		135	45	45	45							966	10		976	PAID IN FULL	MAY 29 1953										976									
	"		SW 1/4 of NW 1/4 Lot 2		2265	"	345		345	115	115	115							2468	26		2494	PAID IN FULL	MAY 29 1953										2494									
	"		SE 1/4 of NW 1/4 Lot 3		3958	"	390		390	130	130	130							2790	30		2820	PAID IN FULL	MAY 29 1953	12077								2820										
	State of Minnesota		NE 1/4 of SW 1/4																																								
	Franklin Transformer Mfg Co		NW 1/4 of SW 1/4 Lot 4		2425	No	261		261	87	87	87							1868	20		4888	PAID IN FULL	MAY 29 1953										1888									
	"		SW 1/4 of SW 1/4 Lot 5		34	"	300		300	100	100	100							2146	22		2168	PAID IN FULL	MAY 29 1953									2168										
	Arthur R. Thompson		SE 1/4 of SW 1/4		40	"	240		240	80	80	80							1718	18		1736													1736								
	State of Minnesota		NE 1/4 of SE 1/4																																								
	State of Minnesota		NW 1/4 of SE 1/4																																								
	Arthur R. Thompson		SW 1/4 of SE 1/4		40	"	240		240	80	80	80							1718	18		1736													1736								
	"		SE 1/4 of SE 1/4		40	"	240		240	80	80	80							1718	18		1736																					
					261 15		2331	222	2553	851	847	851							18268	192		18460												13252		3268							

Assessment Roll and Tax List of Real Property in the Town of *Dawn* of *Hakada*

IN WHOSE NAME ASSESSED	TO WHOM TRANSFERRED	DESCRIPTION OF PROPERTY			TRUE AND FULL VALUATIONS				ASSESSED VALUATIONS					FINAL EQUALIZED VALUE
		Subdivision	Sec. of Lot	Town or Block	LAND Exclusive of Structures and Improvements	BUILDINGS and Other Structures	MACHINERY Permanently Attached to Real Estate	TOTAL True and Full Value	RURAL		ALL OTHER		MACHINERY Permanently Attached to Real Estate	
		Acres	100th		Dollars	Dollars	Dollars	Dollars	Homestead Up to \$4,000 20%	Over \$4,000 and Non-Homestead 33 1/3%	Homestead Up to \$4,000 25%	Over \$4,000 and Non-Homestead 40%	Dollars	Dollars
<i>Sheridan Realty Co.</i>	<i>Harold & Norma J. Blakeman</i>	<i>1/2 of lot 1</i>	<i>28</i>	<i>21</i>	<i>435</i>	<i>915</i>	<i>1380</i>	<i>1335</i>		<i>460</i>			<i>460</i>	<i>445</i>
<i>Joshua & Peter Hulett</i>		<i>NW 1/4 of NE 1/4</i>		<i>40</i>	<i>240</i>	<i>315</i>	<i>240</i>	<i>240</i>	<i>48</i>				<i>48</i>	<i>48</i>
<i>Carib & Anna Polka</i>		<i>SW 1/4 of NE 1/4</i>		<i>11.70</i>	<i>240</i>	<i>362</i>	<i>1083</i>	<i>1041</i>	<i>111</i>	<i>176</i>			<i>287</i>	<i>275</i>
<i>Arthur B. & Jennie E. Morrison</i>		<i>SE 1/4 of NE 1/4</i>		<i>11</i>	<i>220</i>	<i>300</i>	<i>1244</i>	<i>1270</i>	<i>107</i>	<i>263</i>			<i>370</i>	<i>354</i>
<i>Sheridan Realty Co.</i>	<i>Harold & Norma J. Blakeman</i>	<i>1/2 of lot 1</i>		<i>29</i>	<i>435</i>		<i>435</i>			<i>145</i>			<i>145</i>	<i>145</i>
<i>Joshua & Peter Hulett</i>		<i>NE 1/4 of NW 1/4</i>		<i>40</i>	<i>240</i>		<i>240</i>		<i>48</i>				<i>48</i>	<i>48</i>
<i>State of Minnesota</i>		<i>NW 1/4 of NW 1/4</i>												
<i>State of Minnesota</i>	<i>Harold & Norma J. Blakeman</i>	<i>SW 1/4 of NW 1/4</i>				<i>105</i>	<i>870</i>						<i>216</i>	
<i>Joshua & Peter Hulett</i>		<i>SE 1/4 of NW 1/4 Lot 3</i>		<i>38.25</i>	<i>450</i>	<i>300</i>	<i>850</i>	<i>850</i>	<i>110</i>	<i>105</i>			<i>210</i>	<i>210</i>
<i>Roscoe & Gladie Murders</i>		<i>NE 1/4 of SW 1/4</i>		<i>23.50</i>	<i>200</i>	<i>210</i>	<i>1355</i>	<i>1360</i>	<i>208</i>	<i>105</i>			<i>313</i>	<i>300</i>
"	"	<i>NW 1/4 of SW 1/4</i>		<i>40</i>	<i>270</i>		<i>270</i>	<i>270</i>	<i>54</i>				<i>54</i>	<i>54</i>
"	"	<i>SW 1/4 of SW 1/4</i>		<i>40</i>	<i>270</i>		<i>270</i>	<i>270</i>	<i>54</i>				<i>54</i>	<i>54</i>
<i>Joe F. & Charlotte P. Roscoe</i>	<i>Harold & Norma J. Blakeman</i>	<i>SE 1/4 of SW 1/4</i>		<i>40</i>	<i>240</i>		<i>240</i>	<i>240</i>		<i>80</i>			<i>80</i>	<i>80</i>
<i>Peter & Joshua Hulett</i>		<i>NE 1/4 of SE 1/4</i>		<i>53.50</i>	<i>750</i>	<i>370</i>	<i>2065</i>	<i>2000</i>	<i>224</i>	<i>315</i>			<i>539</i>	<i>520</i>
<i>Harold E. & Fern Atwood</i>		<i>NW 1/4 of SE 1/4</i>				<i>300</i>	<i>60</i>	<i>60</i>	<i>12</i>				<i>12</i>	<i>12</i>
"	"	<i>SW 1/4 of SE 1/4</i>		<i>36</i>	<i>540</i>		<i>540</i>	<i>540</i>	<i>108</i>				<i>108</i>	<i>108</i>
<i>L. E. & Ruth M. Paulsen</i>		<i>SE 1/4 of SE 1/4</i>		<i>8</i>	<i>240</i>	<i>315</i>	<i>555</i>	<i>540</i>		<i>185</i>			<i>185</i>	<i>180</i>
		<i>base of short lots</i>		<i>431.95</i>	<i>4830</i>	<i>6097</i>	<i>10927</i>	<i>10637</i>	<i>1085</i>	<i>1834</i>			<i>2919</i>	<i>2833</i>

SOLD FOR TAXES	VALUATIONS BY SCHOOL DISTRICTS AS EQUALIZED BY DEPARTMENT OF TAXATION						Tax Including State Homestead	State Tax on Non-Homestead	SPECIAL TAXES	TOTAL TAXES	PAID	WHEN PAID	Number of Receipts	March Settlement 1952	June Settlement 1952	November Settlement 1952	Collectible to First Monday in January 1953	Delinquent on First Monday in January 1954	Total Delinquent Tax and Penalty	REMARKS	
	District No.	District Rate	District No.	District Rate	District No.	District Rate															
1										<i>98.26</i>	<i>204</i>	<i>99.80</i>	<i>1</i>							<i>1587</i> <i>12153</i>	
2										<i>10.30</i>		<i>10.30</i>	<i>2</i>							<i>49.90</i> <i>515</i>	
3										<i>67.36</i>	<i>40</i>	<i>67.76</i>	<i>3</i>							<i>43.72</i> <i>1572</i>	
4										<i>86.84</i>	<i>60</i>	<i>87.44</i>	<i>4</i>							<i>15.72</i> <i>1572</i>	
5										<i>31.12</i>	<i>32</i>	<i>31.44</i>	<i>5</i>							<i>515</i> <i>515</i>	
6										<i>10.30</i>		<i>10.30</i>	<i>6</i>							<i>515</i> <i>515</i>	
7																					
8																					
9										<i>20.70</i>	<i>24</i>	<i>50.94</i>	<i>9</i>							<i>25.47</i> <i>2547</i>	
10																					
11																				<i>3.00 Abated</i>	
12																				<i>3.02</i>	
13																				<i>8.68</i> <i>868</i>	
14																				<i>129</i> <i>129</i>	
15																				<i>129</i> <i>129</i>	
16																				<i>12722</i> <i>12722</i>	
17																				<i>2318</i> <i>2318</i>	
18																				<i>40.14</i> <i>4014</i>	
19																				<i>240.54</i> <i>24054</i>	
20																				<i>6.02</i>	

WABEBO PASS
 HEMO SPRINGS
 JOHN POL
 WARDEN'S ADDITION

Assessment Roll and Tax List of Real Property in the Town of Wabedo

IN WHOSE NAME ASSESSED	TO WHOM TRANSFERRED	DESCRIPTION OF PROPERTY				No. School District	Indicate Homestead Yes or No	Indicate Agricultural Yes or No	TRUE AND FULL VALUATIONS				ASSESSED VALUATIONS					Total Assessed Value as Equalized by the Board of Review	FINAL EQUALIZED VALUE	SOLD FOR TAXES	VALIDATIONS BY SCHOOL DISTRICTS AS EQUALIZED BY DEPARTMENT OF TAXATION						Tax Including State Homestead	State Tax on Non-Homestead	SPECIAL TAXES	TOTAL TAXES	PAID	WHEN PAID	Number of Receipts	March Settlement 1953	June Settlement 1953	Penalty	November Settlement 1953	Penalty	Collection to First Monday in January 1954	Penalty	Delinquent on First Monday in January 1954	Total Delinquent Tax and Penalty	REMARKS			
		SUBDIVISION	Sec. of Lot	Town or Block	Rdg.				Number of Acres of Land	LAND Exclusive of Structures and Improvements	BUILDINGS and Other Structures	MACHINERY Permanently Attached to Real Estate	TOTAL True and Full Value	RURAL		ALL OTHER					MACHINERY Permanently Attached to Real Estate	TOTAL ASSESSED VALUE	District No.	District Rate	District No.	District Rate																		District No.	District Rate	
														Homestead Up to \$4,000 20%	Over \$4,000 and Non-Homestead 33 1/3%	Homestead Up to \$4,000 25%	Over \$4,000 and Non-Homestead 40%																													Dollars
Peter Heach		N 1/4 of N E 1/4	Lot 1	34 140 28	38	700	No		454	209	200	663	221	218	218								1	221	4744	50	4794	1	OCT 31 1953	5864																
		N W 1/4 of N E 1/4	Lot 2		39 95				360			360	120		120								2	170	2576	28	2604	2	MAY 29 1953	1261																
State of Minnesota		S W 1/4 of N E 1/4																					3																							
State of Minnesota		S E 1/4 of N E 1/4																						4																						
State of Minnesota		N E 1/4 of N W 1/4																						5																						
Ralph F. & Louise Felton		N W 1/4 of N W 1/4	Lot 3		23 50		No		90			90	30		30								7	30	644	06	650	7	MAY 11 1953	5778																
W. L. & Irene L. Delford		S W 1/4 of N W 1/4	Lot 4		38		No		390			390	130		130								8	130	2790	30	2820	8																		
State of Minnesota		S E 1/4 of N W 1/4																					9																							
State of Minnesota		N E 1/4 of S W 1/4																					10																							
State of Minnesota		N W 1/4 of S W 1/4																					11																							
State of Minnesota		S W 1/4 of S W 1/4																					12																							
State of Minnesota		S E 1/4 of S W 1/4																					13																							
State of Minnesota		N E 1/4 of S E 1/4																					14																							
State of Minnesota		N W 1/4 of S E 1/4																					15																							
State of Minnesota		S W 1/4 of S E 1/4																					16																							
State of Minnesota		S E 1/4 of S E 1/4																					17																							
State of Minnesota																							18																							
State of Minnesota																							19																							
State of Minnesota																							20																							
										13945			1294	209		1503	501							501		10754	114	10868																		
													1494	200		1494	498							498																						

WABEDO PASS
WABEDO SPRINGS
TOWN FOR WABEDO'S ADDITION

Assessment Roll and Tax List of Real Property in the *Town of Wabedon*

Cass County, Minnesota, for Taxes for the Year 1952.

IN WHOSE NAME ASSESSED	TO WHOM TRANSFERRED	DESCRIPTION OF PROPERTY			TRUE AND FULL VALUATIONS				ASSESSED VALUATIONS				FINAL EQUALIZED VALUE	SOLD FOR TAXES	VALUATIONS BY SCHOOL DISTRICTS AS EQUALIZED BY DEPARTMENT OF TAXATION						Tax Including State Homestead	State Tax on Non-Homestead	SPECIAL TAXES	TOTAL TAXES	PAID	WHEN PAID	Number of Receipt	March Settlement 1953	June Settlement 1953	Penalty	November Settlement 1953	Penalty	Collections to First Monday in January 1954	Penalty	Delinquent on First Monday in January 1954	Total Delinquent Tax and Penalty	REMARKS
					LAND Exclusive of Structures and Improvements	BUILDINGS and Other Structures	MACHINERY Permanently Attached to Real Estate	TOTAL True and Full Value	RURAL		ALL OTHER				MACHINERY Permanently Attached to Real Estate	TOTAL ASSESSED VALUE	Total Assessed Value as Equalized by the Board of Review	District No.	District No.	District No.																	
		Homestead Up to \$4,000	Over \$4,000 and Non-Homestead	Homestead Up to \$4,000					Over \$4,000 and Non-Homestead	Rate	Rate	Rate																									
		Acres	1900's	No. School District	Indicate Homestead Yes or No	Indicate Agricultural Yes or No	Dollars	Dollars	Dollars	Dollars	Dollars	Dollars			Dollars	Dollars	Dollars	Dollars	Dollars	Dollars																	
State of Minnesota		NE 1/4 of NE 1/4	35	140																																	
State of Minnesota		NW 1/4 of NE 1/4																																			
State of Minnesota		SW 1/4 of NE 1/4																																			
State of Minnesota		SE 1/4 of NE 1/4																																			
State of Minnesota		NE 1/4 of NW 1/4																																			
State of Minnesota		NW 1/4 of NW 1/4																																			
State of Minnesota		SW 1/4 of NW 1/4																																			
State of Minnesota		SE 1/4 of NW 1/4																																			
	<i>J. K. Schenk</i>	NE 1/4 of SW 1/4	40				240		240	80		80		1736			1718	18			1736														1736		
State of Minnesota		NW 1/4 of SW 1/4																																			
State of Minnesota		SW 1/4 of SW 1/4																																			
State of Minnesota		SE 1/4 of SW 1/4																																			
State of Minnesota		NE 1/4 of SE 1/4																																			
	<i>V. E. Schumley</i>	NW 1/4 of SE 1/4	40				240		240	80		80		1736			1718	18			1736														1736		
	<i>Verne Schumley</i>	SW 1/4 of SE 1/4	40				240		240	80		80		1736			1718	18			1736														1736		
State of Minnesota		SE 1/4 of SE 1/4																																			
			120	00			720		720	240		240		5208			5154	54			5208														5208		

MAY 1950

MAY 1951

MAY 1952

MAY 1953

MAY 1954

