

Assessment & Tax List - 1961

Turtle Lake

Assessment of T

Form 314 - MILLER-DAY COMPANY, MINNEAPOLIS

COLLECTIONS OF TAXES OF 1961

Town OF Turtle Lake, CASS COUNTY, MINNESOTA

NAME OF OWNER

1

2

3

4

5

6

7

8

FUNDS	MARCH SETTLEMENT 19.62	JUNE SETTLEMENT 19.62	NOV. SETTLEMENT 19.62	Amount Collected from Nov. 1962 to First Monday in Jan. 1963	REDUCTIONS	Total Reductions and Collected	BALANCE UNCOLLECTED	ADDITIONS	Total Uncollected to First Monday in January, 1963
State-Non-Homestead, State-Homestead,	119 08 84 51	259 31 249 63	150 47 154 90	13 30 10 86					
County Revenue, County Road and Bridge, County Welfare, County Bond and Interest, C.H. Bldg. Agn. Bldg. C.W. Bldg. Town Revenue, Town Road and Bridge, Town State Loan,	662 51 359 47 1029 89 19 59 35 95 8 99 11 86 70 82 201 84	1454 41 789 15 2260 92 43 00 78 92 19 73 26 05 155 46 443 11	915 50 496 74 1423 19 27 08 49 67 12 42 16 39 97 86 278 92	66 08 35 86 10 273 1 95 3 59 9 0 1 18 7 06 20 14					
<i>Fire</i>	89 88	197 29	124 19	8 96					
School Local 1 Mill, School Special, School State Loan, Deficiency Tuition C.O. Transportation PERA B.+S. Bldg.	830 36 514 94 700 08 58 41 75 84 233 47	1419 80 1130 47 1536 87 128 24 166 51 512 55	999 97 711 60 967 41 80 72 104 81 322 64	81 63 51 37 69 84 5 83 7 56 23 29					
Well. Ref. PERA	195 73 101 92	429 69 223 72	270 49 140 84	19 52 10 17					
	5405 14	11524 83	7345 81	541 82					

	LOCAL 1 MILL	SPECIAL	STATE LOAN	Deficiency	C.O.	PERA	B.+S.	Bldg.	TOTALS
MARCH SETTLEMENT		6833 76203		7830 43664	10646 59362	888 4953	1153 6431	3550 19797	30900 210410
Totals		83036		51494	70008	5841	7584	23347	241310
JUNE SETTLEMENT									
Totals		141980		113047	153687	12824	16651	51255	489444
NOVEMBER SETTLEMENT									
Totals		99997		71160	96741	8072	10481	32264	318715
NOVEMBER to JANUARY									
Totals		8163		5137	6984	583	756	2329	23952
ADDITIONS									
Totals									
REDUCTIONS									
Totals									

Blue Water Beach
Point
Green Shore
Point
Point

Assessment Roll and Tax List of Real Property in the Town of Turtle Lake, Cass County, Minnesota, for Taxes for the Year 1961.

* Indicate Type of Property: R-Residential, C-Commercial, I-Industrial, U-Utility, F-Farm, L-Lakeshore, T-Timber, M-Mineral

Table with columns: IN WHOSE NAME ASSESSED, DESCRIPTION OF PROPERTY, TRUE AND FULL VALUATIONS, ASSESSED VALUATIONS, VALUATIONS BY SCHOOL DISTRICTS AS EQUALIZED BY DEPARTMENT OF TAXATION, Tax including State Homestead, State Tax on Non-Homestead, SPECIAL TAXES, TOTAL TAXES, PAID, WHEN PAID, Number of Receipt, March Settlement, June Settlement, November Settlement, Collections to First Monday in January, Delinquent on First Monday in January, Total Delinquent Tax and Penalty, REMARKS.

Assessment Roll and Tax List of Real Property in the town of Tuttle Lake,

* Indicate Type of Property: R-Residential, C-Commercial, I-Industrial, U-Utility, F-Farm, L-Lakeshore, T-Timber, M-Mineral

Cass County, Minnesota, for Taxes for the Year 1961.

Form SCD MILLER-DAVIS CO., MINNEAPOLIS

Table with columns: IN WHOSE NAME ASSESSED, DESCRIPTION OF PROPERTY, TRUE AND FULL VALUATIONS, ASSESSED VALUATIONS, VALUATIONS BY SCHOOL DISTRICTS AS EQUALIZED BY DEPARTMENT OF TAXATION, TAX INCLUDING STATE HOMESTEAD, SPECIAL TAXES, TOTAL TAXES, PAID, WHEN PAID, Number of Receipt, March Settlement 1962, June Settlement 1962, Penalty, November Settlement 1962, Collections to First Monday in January 1963, Delinquent on First Monday in January 1963, Total Delinquent Tax and Penalty, REMARKS.

Assessment Roll and Tax List of Real Property in the *Town of Little Lake*

* Indicate Type of Property: R-Residential, C-Commercial, I-Industrial, U-Utility, F-Farm, L-Lakeshore, T-Timber, M-Mineral

Form 500 MILLER-DAVIS CO., MINNEAPOLIS

Table with columns: IN WHOSE NAME ASSESSED, DESCRIPTION OF PROPERTY, TRUE AND FULL VALUATIONS, ASSESSED VALUATIONS, and FINAL EQUALIZED VALUE.

Cass County, Minnesota, for Taxes for the Year 1961.

Table with columns: VALUATIONS BY SCHOOL DISTRICTS AS EQUALIZED BY DEPARTMENT OF TAXATION, TAXES, PAID, WHEN PAID, Number of Receipt, March Settlement, June Settlement, November Settlement, Penalty, Collections to First Monday in January 1963, Delinquent on First Monday in January 1963, Total Delinquent Tax and Penalty, REMARKS.

141-30

141-30

Bush's Point

Kline Green

Rocky Point

Blue Water Beach

Assessment Roll and Tax List of Real Property in the Town of Turtle Lake

* Indicate Type of Property: R-Residential, C-Commercial, I-Industrial, U-Utility, F-Farm, L-Lakeshore, T-Timber, M-Mineral

Cass County, Minnesota, for Taxes for the Year 1961.

Form 500 - MILLER-DAVIS CO., MINNEAPOLIS

Table with columns for IN WHOSE NAME ASSESSED, DESCRIPTION OF PROPERTY, TRUE AND FULL VALUATIONS, ASSESSED VALUATIONS, VALUATIONS BY SCHOOL DISTRICTS AS EQUALIZED BY DEPARTMENT OF TAXATION, and REMARKS. Includes handwritten entries for property owners like Clifford J. Thompson and Paul D. & Lillian Shauer.

Assessment Roll and Tax List of Real Property in the Town of LITTLE LAKE, Cass County, Minnesota, for Taxes for the Year 1961.

* Indicate Type of Property: R-Residential, C-Commercial, I-Industrial, U-Utility, F-Farm, L-Lakeshore, T-Timber, M-Mineral

Form SCD - MILLER-DAVIS CO., MINNEAPOLIS

Table with columns: IN WHOSE NAME ASSESSED, DESCRIPTION OF PROPERTY, TRUE AND FULL VALUATIONS, ASSESSED VALUATIONS, and FINAL EQUALIZED VALUE. Rows 1-20.

Cass County, Minnesota, for Taxes for the Year 1961.

Table with columns: VALUATIONS BY SCHOOL DISTRICTS AS EQUALIZED BY DEPARTMENT OF TAXATION, TAX INCLUDING STATE HOMESTEAD, STATE TAX ON NON-HOMESTEAD, SPECIAL TAXES, TOTAL TAXES, PAID, WHEN PAID, Number of Receipt, March Settlement 1962, June Settlement 1962, November Settlement 1962, Collections to First Monday in January 1963, Delinquent on First Monday in January 1963, Total Delinquent Tax and Penalty, REMARKS. Rows 1-20.

141-30

Bush's Point

Kings Green

Point

Blue Water Beach

9

9

10

11

Assessment Roll and Tax List of Real Property in the

Town of Turtle Lake

Cass County, Minnesota, for Taxes for the Year 1961.

* Indicate Type of Property: R-Residential, C-Commercial, I-Industrial, U-Utility, F-Farm, L-Lakeshore, T-Timber, M-Mineral

Table with columns: IN WHOSE NAME ASSESSED, DESCRIPTION OF PROPERTY, TRUE AND FULL VALUATIONS, ASSESSED VALUATIONS, VALUATIONS BY SCHOOL DISTRICTS AS EQUALIZED BY DEPARTMENT OF TAXATION, TAXES, PAID, WHEN PAID, Number of Receipt, March Settlement 1962, June Settlement 1962, November Settlement 1962, Collections to First Monday in January 1963, Delinquent on First Monday in January 1963, Total Delinquent Tax and Penalty, REMARKS.

(CONT NEXT PAGE)

Blue Water Beach, Point, Rocky, Kings Green, Blue Green, Blue Green, Blue Green

Assessment Roll and Tax List of Real Property in the Town of Little Lake

* Indicate Type of Property: R-Residential, C-Commercial, I-Industrial, U-Utility, F-Farm, L-Lakeshore, T-Timber, M-Mineral

Table with columns: IN WHOSE NAME ASSESSED, DESCRIPTION OF PROPERTY, TRUE AND FULL VALUATIONS, ASSESSED VALUATIONS, and FINAL EQUALIZED VALUE. Includes handwritten entries for Ella Dahly, Raymond & Joyce E. Harris, Arthur N. & Alta Dewey, Crville H. & Laura Harner, Milo R. & Dina Dahly, Oscar H. Hanson, and Milo R. & Lena Dahly.

Cass County, Minnesota, for Taxes for the Year 1961.

Table with columns: SOLD FOR TAXES, VALUATIONS BY SCHOOL DISTRICTS AS EQUALIZED BY DEPARTMENT OF TAXATION, Tax including State Homestead, State Tax on Non-Homestead, SPECIAL TAXES, TOTAL TAXES, PAID, WHEN PAID, Number of Receipt, March Settlement 1962, June Settlement 1962, November Settlement 1962, Collections to First Monday in January 1963, Delinquent on First Monday in January 1963, Total Delinquent Tax and Penalty, and REMARKS. Includes handwritten entries for property numbers 1 through 20.

Assessment Roll and Tax List of Real Property in the Town of Turtle Lake

* Indicate Type of Property: R-Residential, C-Commercial, I-Industrial, U-Utility, F-Farm, L-Lakeshore, T-Timber, M-Mineral

Cass County, Minnesota, for Taxes for the Year 1961.

Form 500 MILLER-DAVIS CO., MINNEAPOLIS

Table with columns: IN WHOSE NAME ASSESSED, DESCRIPTION OF PROPERTY, TRUE AND FULL VALUATIONS, ASSESSED VALUATIONS, VALUATIONS BY SCHOOL DISTRICTS AS EQUALIZED BY DEPARTMENT OF TAXATION, TAX including State Homestead, State Tax on Non-Homestead, SPECIAL TAXES, TOTAL TAXES, PAID, WHEN PAID, Number of Receipt, March Settlement 1962, June Settlement 1962, Penalty, November Settlement 1962, Collections to First Monday in January 1963, Delinquent on First Monday in January 1963, Total Delinquent Tax and Penalty, REMARKS. Includes entries for Nels Bergly, Adolph M. Bredesen, Roy D. + Hattie Helen Ford, Hope Lutheran Church, Milo Oakley + Oscar H. Hanson.

Assessment Roll and Tax List of Real Property in the Town of Turtle Lake

* Indicate Type of Property: R-Residential, C-Commercial, I-Industrial, U-Utility, F-Farm, L-Lakeshore, T-Timber, M-Mineral

Form SCD MILLER-DAVIS CO., MINNEAPOLIS

Cass County, Minnesota, for Taxes for the Year 1961.

Table with columns: IN WHOSE NAME ASSESSED, DESCRIPTION OF PROPERTY, TRUE AND FULL VALUATIONS, ASSESSED VALUATIONS, VALUATIONS BY SCHOOL DISTRICTS AS EQUALIZED BY DEPARTMENT OF TAXATION, TAXES, PAID, WHEN PAID, Number of Receipt, March Settlement 1962, June Settlement 1962, Penalty, November Settlement 1962, Collections to First Monday in January 1963, Delinquent on First Monday in January 1961, Total Delinquent Tax and Penalty, REMARKS.

Vertical text on the right edge of the page: Bush's Point, Kings Green, Rocky Point, Blue Lake Beach.

Assessment Roll and Tax List of Real Property in the Town of Little Lake

* Indicate Type of Property: R-Residential, C-Commercial, I-Industrial, U-Utility, F-Farm, L-Lakeshore, T-Timber, M-Mineral

Form 500 MILLER-DAVIS CO., MINNEAPOLIS

Table with columns: IN WHOSE NAME ASSESSED, SUBDIVISION, No. School District, Indicate Home-Stead Yes or No, Agri. or Seas. Recr. Yes or No, Indicate Type of Property, TRUE AND FULL VALUATIONS (LAND, BUILDINGS, MACHINERY, TOTAL), ASSESSED VALUATIONS (RURAL, ALL OTHER, MACHINERY, Seasonal and Recreational Cabins, TOTAL ASSESSED VALUE, Total Assessed Value as Equalized by the Board of Review), FINAL EQUALIZED VALUE.

Cass County, Minnesota, for Taxes for the Year 1961.

Table with columns: SOLD FOR TAXES, VALUATIONS BY SCHOOL DISTRICTS AS EQUALIZED BY DEPARTMENT OF TAXATION (District No., Rate, Mills), Tax Including State Homestead, State Tax on Non-Homestead, SPECIAL TAXES, TOTAL TAXES, PAID, WHEN PAID (Month, Day, Year), Number of Receipt, March Settlement 1962, June Settlement 1962, Penalty, November Settlement 1962, Collections to First Monday in January 1963, Delinquent on First Monday in January 1963, Total Delinquent Tax and Penalty, REMARKS.

(CONT NEXT PAGE)

31372

141-80

Bush's Point Kings Green Point Blue Water Bath

Assessment Roll and Tax List of Real Property in the Town of Turtle Lake, Cass County, Minnesota, for Taxes for the Year 1961.

* Indicate Type of Property: R-Residential, C-Commercial, I-Industrial, U-Utility, F-Farm, L-Lakeshore, T-Timber, M-Mineral

Table with columns: IN WHOSE NAME ASSESSED, DESCRIPTION OF PROPERTY, TRUE AND FULL VALUATIONS, ASSESSED VALUATIONS, and FINAL EQUALIZED VALUE. Includes handwritten entries for 'Mary Ann Norton' and 'Mary V. & Ronald L. Duck'.

Cass County, Minnesota, for Taxes for the Year 1961.

Table with columns: VALUATIONS BY SCHOOL DISTRICTS AS EQUALIZED BY DEPARTMENT OF TAXATION, TAXES, PAID, WHEN PAID, and REMARKS. Includes handwritten tax amounts and payment dates.

Vertical text on the right edge of the page: Bush's Point, Kings Green, Hocky Point, Blue Water Beach.

Assessment Roll and Tax List of Real Property in the Town of Turtle Lake

Cass County, Minnesota, for Taxes for the Year 1961.

Table with columns: IN WHOSE NAME ASSESSED, DESCRIPTION OF PROPERTY, TRUE AND FULL VALUATIONS, ASSESSED VALUATIONS, VALUATIONS BY SCHOOL DISTRICTS AS EQUALIZED BY DEPARTMENT OF TAXATION, TAXES, PAID, WHEN PAID, etc.

Balance Paid NOV 28 1962 20.94
Part Paid MAY 31 1962 11763
Balance Paid NOV 28 1962
Part Paid MAY 31 1962

Bush's Point
Kings Green
Rocky Point
Blue Water Beach

Assessment Roll and Tax List of Real Property in the Town of Turtle Lake

* Indicate Type of Property: R-Residential, C-Commercial, I-Industrial, U-Utility, F-Farm, L-Lakeshore, T-Timber, M-Mineral

Table with columns: IN WHOSE NAME ASSESSED, SUBDIVISION, No. School District, Indicate Homestead, Indicate or Seasonal, Indicate Type of Property, TRUE AND FULL VALUATIONS, ASSESSED VALUATIONS, and FINAL EQUALIZED VALUE.

Cass County, Minnesota, for Taxes for the Year 1961.

Table with columns: VALUATIONS BY SCHOOL DISTRICTS AS EQUALIZED BY DEPARTMENT OF TAXATION, Tax Including State Homestead, State Tax on Non-Homestead, SPECIAL TAXES, TOTAL TAXES, PAID, WHEN PAID, Number of Receipt, March Settlement, June Settlement, November Settlement, Collections to First Monday in January 1963, Delinquent on First Monday in January 1963, Total Delinquent Tax and Penalty, and REMARKS.

Assessment Roll and Tax List of Real Property in the Town of Partle Lake, * Indicate Type of Property: R-Residential, C-Commercial, I-Industrial, U-Utility, F-Farm, L-Lakeshore, T-Timber, M-Mineral

Form 500 MILLER-DAVIS CO., MINNEAPOLIS

Table with columns: IN WHOSE NAME ASSESSED, DESCRIPTION OF PROPERTY, TRUE AND FULL VALUATIONS (RURAL, ALL OTHER, MACHINERY, Seasonal and Recreational Cabins, TOTAL ASSESSED VALUE), and FINAL EQUALIZED VALUE.

Cass County, Minnesota, for Taxes for the Year 1961.

Table with columns: SOLD FOR TAXES, VALUATIONS BY SCHOOL DISTRICTS AS EQUALIZED BY DEPARTMENT OF TAXATION, Tax including State Homestead, State Tax on Non-Homestead, SPECIAL TAXES, TOTAL TAXES, PAID, WHEN PAID, Number of Receipt, March Settlement 1962, June Settlement 1962, Penalty, November Settlement 1962, Penalty, Collections to First Monday in January 1963, Penalty, Delinquent on First Monday in January 1963, Total Delinquent Tax and Penalty, REMARKS.

(CONT NEXT PAGE)

15508

Vertical text on the right edge of the page: Bush's Point, Kings Green, Rocky Point, Blue Water Beach.

Assessment Roll and Tax List of Real Property in the *Town of Turtle Lake*

* Indicate Type of Property: R-Residential, C-Commercial, I-Industrial, U-Utility, F-Farm, L-Lakeshore, T-Timber, M-Mineral

Form SCD MILLER-DAVIS CO., MINNEAPOLIS

Table with columns: IN WHOSE NAME ASSESSED, DESCRIPTION OF PROPERTY, TRUE AND FULL VALUATIONS, ASSESSED VALUATIONS, and FINAL EQUALIZED VALUE.

Cass County, Minnesota, for Taxes for the Year 1961.

Table with columns: VALUATIONS BY SCHOOL DISTRICTS AS EQUALIZED BY DEPARTMENT OF TAXATION, Tax including State Homestead, State Tax on Non-Homestead, SPECIAL TAXES, TOTAL TAXES, PAID, WHEN PAID, Number of Receipt, March Settlement, June Settlement, November Settlement, Collections to First Monday in January, Delinquent on First Monday in January, Total Delinquent Tax and Penalty, and REMARKS.

Assessment Roll and Tax List of Real Property in the

Town of Turtle Lake

* Indicate Type of Property: R-Residential, C-Commercial, I-Industrial, U-Utility, F-Farm, L-Lakeshore, T-Timber, M-Mineral

Cass County, Minnesota, for Taxes for the Year 1961.

Form 500 - MILLER-DAVIS CO., MINNEAPOLIS

Table with columns for IN WHOSE NAME ASSESSED, DESCRIPTION OF PROPERTY, TRUE AND FULL VALUATIONS, ASSESSED VALUATIONS, VALUATIONS BY SCHOOL DISTRICTS AS EQUALIZED BY DEPARTMENT OF TAXATION, and REMARKS. Includes rows for State of Minnesota, U.S. of America, and various lot descriptions like GOVT LOT 1 through 7.

Vertical text on the right edge: Bush's Print, Kings Green Storage, Rocky Point, Pine Water Beach

Assessment Roll and Tax List of Real Property in the Town of Little Lake,
 * Indicate Type of Property: R-Residential, C-Commercial, I-Industrial, U-Utility, F-Farm, L-Lakeshore, T-Timber, M-Mineral

Form SCD MILLER-DAVIS CO., MINNEAPOLIS

IN WHOSE NAME ASSESSED	DESCRIPTION OF PROPERTY				No. School District	Indicate Homestead Yes or No	Agri. Recr. Yes or No	Indicate Type of Property	TRUE AND FULL VALUATIONS			ASSESSED VALUATIONS									FINAL EQUALIZED VALUE			
	SUBDIVISION	Sec. or Lot	Town or Block	Number of Acres of Land					LAND Exclusive of Structures and Improvements	BUILDINGS and Other Structures	MACHINERY Permanently Attached to Real Estate	TOTAL True and Full Value	RURAL			ALL OTHER			MACHINERY Permanently Attached to Real Estate	Seasonal and Recreational Cabins		TOTAL ASSESSED VALUE	Total Assessed Value as Equalized by the Board of Review	
													Homestead Up to \$4,000 20%	Over \$4,000 and Non-Homestead 33 1/4%	Timber Land Class 3e 20%	Homestead Up to \$4,000 25%	Over \$4,000 and Non-Homestead 40%	33 1/4%						33 1/4%
													Dollars	Dollars	Dollars	Dollars	Dollars	Dollars						Dollars
State of Minnesota	1			GOVT LOT 4 142 30				119																
	2			NW 1/4 of NE 1/4																				
	3			SW 1/4 of NE 1/4																				
	4			SE 1/4 of NE 1/4																				
	5																							
	6			NE 1/4 of NW 1/4																				
	7			NW 1/4 of NW 1/4																				
	8			SW 1/4 of NW 1/4																				
	9			SE 1/4 of NW 1/4																				
	10																							
	11			NE 1/4 of SW 1/4																				
	12			NW 1/4 of SW 1/4																				
	13			SW 1/4 of SW 1/4																				
	14			SE 1/4 of SW 1/4																				
	15																							
	16			NE 1/4 of SE 1/4																				
	17			NW 1/4 of SE 1/4																				
	18			SW 1/4 of SE 1/4																				
	19			SE 1/4 of SE 1/4																				
	20																							

Cass County, Minnesota, for Taxes for the Year 1961.

SOLD FOR TAXES	VALUATIONS BY SCHOOL DISTRICTS AS EQUALIZED BY DEPARTMENT OF TAXATION						Tax including State Homestead	State Tax on Non-Homestead	SPECIAL TAXES	SPECIAL TAXES	TOTAL TAXES	PAID	WHEN PAID	Number of Receipt	March Settlement 1962	June Settlement 1962	Penalty	November Settlement 1962	Penalty	Collections to First Monday in January 1963	Penalty	Delinquent on First Monday in January 1963	Total Delinquent Tax and Penalty	REMARKS			
	District No.	District No.	District No.	District No.	District No.	District No.																					
	Rate	Rate	Rate	Rate	Rate	Rate																					
	Mills	Mills	Mills	Mills	Mills	Mills																					

241-80

Bush's Point
 Kings Green
 Rocky Point
 Blue Water Beach

Assessment Roll and Tax List of Real Property in the Town of Turtle Lake,
* Indicate Type of Property: R-Residential, C-Commercial, I-Industrial, U-Utility, F-Farm, L-Lakeshore, T-Timber, M-Mineral

Form SCD MILLER-DAVIS CO., MINNEAPOLIS

Table with columns: IN WHOSE NAME ASSESSED, DESCRIPTION OF PROPERTY, TRUE AND FULL VALUATIONS, ASSESSED VALUATIONS, and FINAL EQUALIZED VALUE.

Cass County, Minnesota, for Taxes for the Year 1961.

Table with columns: VALUATIONS BY SCHOOL DISTRICTS AS EQUALIZED BY DEPARTMENT OF TAXATION, Tax Including State Homestead, State Tax on Non-Homestead, SPECIAL TAXES, TOTAL TAXES, PAID, WHEN PAID, Number of Receipt, March Settlement 1962, June Settlement 1962, Penalty, November Settlement 1962, Collections to First Monday in January 1963, Delinquent on First Monday in January 1963, Total Delinquent Tax and Penalty, REMARKS.

Leonard P. Peterson

U. S. of America

J. H. & Ella K. Schilder

Leonard P. Peterson

U. S. of America In trust for Chippewa Lake J. Minn.

Bush's Point, Kings Green, Rocky Point, Blue Water Beach

Assessment Roll and Tax List of Real Property in the Town of *Fort Snelle Lake*

* Indicate Type of Property: R-Residential, C-Commercial, I-Industrial, U-Utility, F-Farm, L-Lakeshore, T-Timber, M-Mineral

Form 500 MILLER-DAVIS CO., MINNEAPOLIS

IN WHOSE NAME ASSESSED	DESCRIPTION OF PROPERTY				No. School District	Indicate Homestead Yes or No	Agriculture Recr. Yes or No	Indicate Type of Property	TRUE AND FULL VALUATIONS													FINAL EQUALIZED VALUE			
	SUBDIVISION	Sec. of Lot	Town or Block	Rng.					Number of Acres of Land	RURAL				ALL OTHER				MACHINERY Permanently Attached to Real Estate	Seasonal and Recreational Cabins	TOTAL ASSESSED VALUE	Total Assessed Value as Equalized by the Board of Review				
										Acres	100ths	Homestead Up to \$4,000 20%	Over \$4,000 and Non-Homestead 33 1/2%	Timber Land Class 3e 20%	Homestead Up to \$4,000 25%	Over \$4,000 and Non-Homestead 40%	33 1/2%								
										Dollars		Dollars		Dollars		Dollars									
<i>Willis A Dalton 1/2 Int</i> <i>State of Minnesota - 1/2 Int Rebois 1/2 Int</i>	NE 1/4 of NE 1/4				SOIT LOT 1	9	142 30		119														<i>No Tax for 1961</i>		
	NW 1/4 of NE 1/4																								
	SW 1/4 of NE 1/4																								
	SE 1/4 of NE 1/4																								
	NE 1/4 of NW 1/4																								
	NW 1/4 of NW 1/4																								
	SW 1/4 of NW 1/4																								
	SE 1/4 of NW 1/4																								
	NE 1/4 of SW 1/4																								
	NW 1/4 of SW 1/4																								
	SW 1/4 of SW 1/4																								
	SE 1/4 of SW 1/4																								
	NE 1/4 of SE 1/4																								
	NW 1/4 of SE 1/4																								
	SW 1/4 of SE 1/4																								
	SE 1/4 of SE 1/4																								

Cass County, Minnesota, for Taxes for the Year 1961.

SOLD FOR TAXES	VALUATIONS BY SCHOOL DISTRICTS AS EQUALIZED BY DEPARTMENT OF TAXATION						Tax Including State Homestead	State Tax on Non-Homestead	SPECIAL TAXES	SPECIAL TAXES	TOTAL TAXES	PAID	WHEN PAID	Number of Receipt	March Settlement 1962	June Settlement 1962	Penalty	November Settlement 1962	Penalty	Collections to First Monday in January 1963	Penalty	Delinquent on First Monday in January 1963	Total Delinquent Tax and Penalty	REMARKS				
	District No	District No	District No	District No	District No	District No																						
	Rate	Rate	Rate	Rate	Rate	Rate																						
	Mills	Mills	Mills	Mills	Mills	Mills																						

141-80

Bush's Point Kings Green Rocky Point Blue Water Beach

Assessment Roll and Tax List of Real Property in the Town of Sarge Lake

* Indicate Type of Property: R-Residential, C-Commercial, I-Industrial, U-Utility, F-Farm, L-Lakeshore, T-Timber, M-Mineral

Form 5CD MILLER-DAVIS CO., MINNEAPOLIS

Table with columns: IN WHOSE NAME ASSESSED, SUBDIVISION, Number of Acres of Land, TRUE AND FULL VALUATIONS (LAND, BUILDINGS, MACHINERY, TOTAL), ASSESSED VALUATIONS (RURAL, ALL OTHER, MACHINERY, Seasonal and Recreational Cabins, TOTAL ASSESSED VALUE, Total Assessed Value as Equalized by the Board of Review), FINAL EQUALIZED VALUE.

Chief Aron Christenson

London Mc Curdy + Leslie B. Rhoades

39 25

Cass County, Minnesota, for Taxes for the Year 1961.

Table with columns: VALUATIONS BY SCHOOL DISTRICTS AS EQUALIZED BY DEPARTMENT OF TAXATION, Tax Including State Homestead, State Tax on Non-Homestead, SPECIAL TAXES, TOTAL TAXES, PAID, WHEN PAID (Month Day Year), Number of Receipt, March Settlement 1962, June Settlement 1962, Penalty, November Settlement 1962, Collections to First Monday in January 1963, Delinquent on First Monday in January 1963, Total Delinquent Tax and Penalty, REMARKS.

2nd HALF PAID OCT 22 1962/1936
1st HALF PAID MAY 3 1962/11407

15 60

25046
1510
26556

Bush's Point
King Green Shore
Rocky Point
Blue Water Beach

Assessment Roll and Tax List of Real Property in the Town of Turtle Lake

* Indicate Type of Property: R-Residential, C-Commercial, I-Industrial, U-Utility, F-Farm, L-Lakeshore, T-Timber, M-Mineral

Table with columns: IN WHOSE NAME ASSESSED, DESCRIPTION OF PROPERTY, TRUE AND FULL VALUATIONS, ASSESSED VALUATIONS, and FINAL ADJUSTED VALUE. Includes handwritten entries for property owners like Roy C. & Helen M. Folger and Inga B. Bruh.

141.83

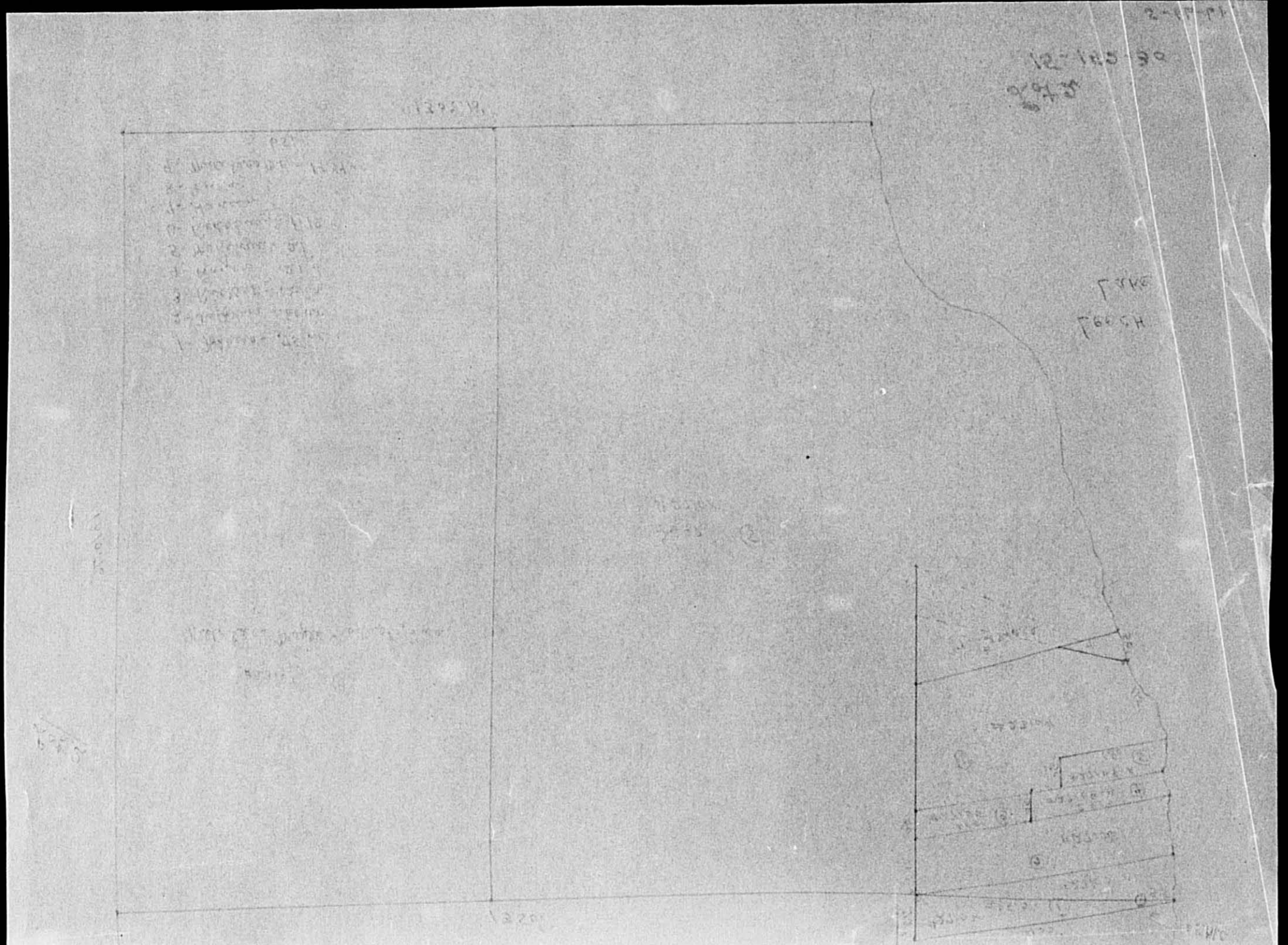

Cass County, Minnesota, for Taxes for the Year 1961.

Table with columns: VALUATIONS BY SCHOOL DISTRICTS AS EQUALIZED BY DEPARTMENT OF TAXATION, TAX INCLUDING STATE HOMESTEAD, SPECIAL TAXES, PAID, WHEN PAID, Number of Receipt, March Settlement, June Settlement, November Settlement, Collections to First Monday in January 1961, Delinquent on First Monday in January 1961, Total Delinquent Tax and Penalty, and REMARKS.

Vertical text on the right edge of the page: Ruler Green, Point, Blue Water, Beach.

Assessment Roll and Tax List of Real Property in the Town of Turtle Lake

* Indicate Type of Property: R-Residential, C-Commercial, I-Industrial, U-Utility, F-Farm, L-Lakeshore, T-Timber, M-Mineral

Form SCD MILLER-DAVIS CO., MINNEAPOLIS

Table with columns: IN WHOSE NAME ASSESSED, DESCRIPTION OF PROPERTY, TRUE AND FULL VALUATIONS, ASSESSED VALUATIONS, and FINAL EQUALIZED VALUE. Includes handwritten entries for Virginia Racchini, Howard Conn, and Harry & Theodore Tobiason.

Cass County, Minnesota, for Taxes for the Year 1961.

Table with columns: VALUATIONS BY SCHOOL DISTRICTS AS EQUALIZED BY DEPARTMENT OF TAXATION, TAXES (SOLD FOR TAXES, SPECIAL, TOTAL), PAID, WHEN PAID, and REMARKS. Includes handwritten calculations and dates like 'PAID IN FULL MAY 14 1962'.

Assessment Roll and Tax List of Real Property in the Town of Turtle Lake

Cass County, Minnesota, for Taxes for the Year 1961.

* Indicate Type of Property: R-Residential, C-Commercial, I-Industrial, U-Utility, F-Farm, L-Lakeshore, T-Timber, M-Mineral

Table with columns for Property Description, Valuations (True and Full, Assessed), Taxes (School Districts, State, Special, Total), and Remarks. Includes handwritten entries for Russell L. Rehn, U.S. of America, Edwin L. & Violet V. Olson, and Leonard P. Peterson.

Assessment Roll and Tax List of Real Property in the Town of Quinte Lake

* Indicate Type of Property: R-Residential, C-Commercial, I-Industrial, U-Utility, F-Farm, L-Lakeshore, T-Timber, M-Mineral

Form 5CD MILLER-DAVIS CO., MINNEAPOLIS

Table with columns: IN WHOSE NAME ASSESSED, DESCRIPTION OF PROPERTY, No. School District, Indicate Homestead, Indicate Agri., Indicate Type of Property, TRUE AND FULL VALUATIONS (LAND, BUILDINGS, MACHINERY, TOTAL True and Full Value), ASSESSED VALUATIONS (RURAL, ALL OTHER, MACHINERY, Seasonal and Recreational Cabins, TOTAL ASSESSED VALUE, Total Assessed Value as Equalized by the Board of Review), FINAL EQUALIZED VALUE.

Handwritten names and addresses in the left margin: J. H. + Anna Mallory, E. V. + Helen Marie Hobbett, H. E. Grant, Loren A. + Eleanor M. Alderson, Vito + Lucrezia Mortale, Alfred C. + Bertha D. Rausch, M. R. + Mary G. Stein, Albert F. + Frances A. Lund, Norma Humphrey, Carlton C. + Rose L. Knutson, Fred P. + Frances Zulmore, J. L. + Billie Moore + Anna Novak + Albert, Edwin E. + Eunice M. Meckelke, Gordon McCurdy McCurdy Bros., Wheeler Lumber Bridge & Supply Co., Clarence E. + Josephine, L. H. Chisholm, Edward + Mae Dean Durgan.

Cass County, Minnesota, for Taxes for the Year 1961.

Table with columns: SOLD FOR TAXES, VALUATIONS BY SCHOOL DISTRICTS AS EQUALIZED BY DEPARTMENT OF TAXATION (District No., Rate, District No., Rate, District No., Rate, District No., Rate), Tax Including State Homestead, State Tax on Non-Homestead, SPECIAL TAXES, TOTAL TAXES, PAID, WHEN PAID (Month Day Year), Number of Receipt, March Settlement 1962, June Settlement 1962, Penalty, November Settlement 1962, Penalty, Collections to First Monday in January 1963, Delinquent on First Monday in January 1963, Total Delinquent Tax and Penalty, REMARKS.

Handwritten notes and calculations in the right margin: \$250, \$186, \$258, \$217, \$344, \$258, \$158, \$576, \$607, \$234, \$160, \$345, \$328, \$110, \$40, \$24, \$68, \$37, \$2286 = 2386, \$2634 = 2722, \$4920 = 6002, \$7490, \$5108, \$7084, \$24146, \$5958, \$10306, \$7084, \$4734, \$35502, \$7010, \$15130, \$43082, \$1098, \$660, \$1868, \$1016, \$147400, \$29876, \$177276, \$7490, \$5228, \$7320, \$24668, \$6156, \$10306, \$7320, \$4734, \$18028, \$3510, \$8370, \$8354, \$44094, \$1134, \$682, \$1930, \$1050, \$180672, \$7490, \$5228, \$7320, \$24668, \$6156, \$10306, \$7320, \$4734, \$18028, \$3510, \$8370, \$8354, \$44094, \$1134, \$682, \$1930, \$1050, \$180672, \$7490, \$5228, \$7320, \$24668, \$6156, \$10306, \$7320, \$4734, \$18028, \$3510, \$8370, \$8354, \$44094, \$1134, \$682, \$1930, \$1050, \$180672.

Assessment Roll and Tax List of Real Property in the Town of Lutske Lake,
 * Indicate Type of Property: R-Residential, C-Commercial, I-Industrial, U-Utility, F-Farm, L-Lakeshore, T-Timber, M-Mineral

Form 5CD MILLER-DAVIS CO., MINNEAPOLIS

IN WHOSE NAME ASSESSED	DESCRIPTION OF PROPERTY				No. School District	Indicate Homestead Yes or No	Agricultural Recr. Yes or No	Indicate Type of Property	TRUE AND FULL VALUATIONS				ASSESSED VALUATIONS								FINAL EQUALIZED VALUE		
	SUBDIVISION	Sec. or Lot	Town or Block	Rng. Acres of Land					LAND Exclusive of Structures and Improvements	BUILDINGS and Other Structures	MACHINERY Permanently Attached to Real Estate	TOTAL True and Full Value	RURAL		ALL OTHER			MACHINERY Permanently Attached to Real Estate	Seasonal and Recreational Cabins	TOTAL ASSESSED VALUE		Total Assessed Value as Equalized by the Board of Review	
													Homestead Up to \$4,000	Over \$4,000 and Non-Homestead	Timber Land Class 3e	Homestead Up to \$4,000	Over \$4,000 and Non-Homestead						Over \$4,000 and Non-Homestead
													20%	33 1/3%	20%	25%	40%						33 1/3%
Acres 100ths				Dollars	Dollars	Dollars	Dollars	Dollars	Dollars	Dollars	Dollars	Dollars	Dollars	Dollars	Dollars	Dollars							
				21 142 30																			
U. S. of America					119																		
U. S. of America				5 1/2 07																			
U. S. of America				8 1/2 07																			
U. S. of America																							

Cass County, Minnesota, for Taxes for the Year 1961.

SOLD FOR TAXES	VALUATIONS BY SCHOOL DISTRICTS AS EQUALIZED BY DEPARTMENT OF TAXATION						Tax Including State Homestead	State Tax on Non-Homestead	SPECIAL TAXES	SPECIAL TAXES	TOTAL TAXES	PAID	WHEN PAID	Number of Receipt	March Settlement 1962	June Settlement 1962	Penalty	November Settlement 1962	Penalty	Collections to First Monday in January 1963	Penalty	Delinquent on First Monday in January 1963	Total Delinquent Tax and Penalty	REMARKS
	District No.	District No.	District No.	District No.	District No.	District No.																		
	Rate	Rate	Rate	Rate	Rate	Rate																		
	Mills	Mills	Mills	Mills	Mills	Mills																		
Dollars		Dollars		Dollars		\$	cts.	\$	cts.	\$	cts.	\$	cts.	cts.	\$	cts.	\$	cts.	\$	cts.	\$	cts.	\$	cts.
1																								
2																								
3																								
4																								
5																								
6																								
7																								
8																								
9																								
10																								
11																								
12																								
13																								
14																								
15																								
16																								
17																								
18																								
19																								
20																								

Bush's Point Kings Green Point Rocky Blue Water Beach

Assessment Roll and Tax List of Real Property in the Town of Turtle Lake

* Indicate Type of Property: R-Residential, C-Commercial, I-Industrial, U-Utility, F-Farm, L-Lakeshore, T-Timber, M-Mineral

Form SCD - MILLER-DAVIS CO., MINNEAPOLIS

Table with columns: IN WHOSE NAME ASSESSED, DESCRIPTION OF PROPERTY, TRUE AND FULL VALUATIONS, ASSESSED VALUATIONS, and FINAL EQUALIZED VALUE.

State of Minnesota

State of Minnesota

John L. Quinn, Greene County Investment Co., Francis E. + Viola Grand, Lillian + Elmer Witte, D. J. + Florence Nelson, Herman H. + Mattie Wallace

Cass County, Minnesota, for Taxes for the Year 1961.

Table with columns: VALUATIONS BY SCHOOL DISTRICTS AS EQUALIZED BY DEPARTMENT OF TAXATION, Tax including State Homestead, State Tax on Non-Homestead, SPECIAL TAXES, TOTAL TAXES, PAID, WHEN PAID, Number of Receipt, March Settlement 1962, June Settlement 1962, Penalty, November Settlement 1962, Collections to First Monday in January 1963, Delinquent on First Monday in January 1963, Total Delinquent Tax and Penalty, REMARKS.

Brush's Point

Kings Green Springs

Rocky Point

Rue Water Beach

89.38 Abated

Assessment Roll and Tax List of Real Property in the

Town of Turtle Lake

* Indicate Type of Property: R-Residential, C-Commercial, I-Industrial, U-Utility, F-Farm, L-Lakeshore, T-Timber, M-Mineral

Cass County, Minnesota, for Taxes for the Year 1961.

Form 500 - MILLER-DAVIS CO., MINNEAPOLIS

IN WHOSE NAME ASSESSED	DESCRIPTION OF PROPERTY				No. School District	Indicate Home-head Yes or No	Agri. or Recr. Yes or No	Indicate Type of Property	TRUE AND FULL VALUATIONS				ASSESSED VALUATIONS								FINAL EQUALIZED VALUE
	SUBDIVISION	Sec. or Lot	Town or Block	Rng.					Number of Acres of Land Acres 100ths	LAND Exclusive of Structures and Improvements	BUILDINGS and Other Structures	MACHINERY Permanently Attached to Real Estate	TOTAL True and Full Value	RURAL		ALL OTHER		MACHINERY Seasonal and Recreational Cabins	TOTAL ASSESSED VALUE	Total Assessed Value as Equalized by the Board of Review	
														Homestead Up to \$4,000 20%	Over \$4,000 and Non-Homestead 33 1/3%	Timber Land Class 3e 20%	Homestead Up to \$4,000 25%				
State of Minnesota	1				NE 1/4 of NE 1/4	28 1/2 30											119				
State of Minnesota	2				S 1/2 of NW 1/4 of NE 1/4																
U. S. of America	3				W 1/2 of SW 1/4 of NE 1/4																
U. S. of America	4				SE 1/4 of NE 1/4																
U. S. of America	5				E 1/2 of SW 1/4 of NE 1/4																
State of Minnesota	6				NE 1/4 of NW 1/4																
State of Minnesota	7				W 1/2 of NW 1/4 of NW 1/4																
<i>Abrahamson</i> <i>Appala Book Inc. W. Schneider</i>	8				SW 1/4 of NW 1/4	20		NO	YES	L											
	10																				
	11				NE 1/4 of SW 1/4																
	12				NW 1/4 of SW 1/4																
U. S. of America	13				SW 1/4 of SW 1/4																
U. S. of America	14				SE 1/4 of SW 1/4																
State of Minnesota	15				N 1/2 of NW 1/4 of SE 1/4																
U. S. of America	16				NE 1/4 of SE 1/4																
U. S. of America	17				NW 1/4 of SE 1/4																
U. S. of America	18				S 1/2 of SW 1/4 of SE 1/4																
U. S. of America	19				SE 1/4 of SE 1/4																
	20																				

SOLD FOR TAXES	VALUATIONS BY SCHOOL DISTRICTS AS EQUALIZED BY DEPARTMENT OF TAXATION						Tax Including State Homestead	State Tax on Non-Homestead	SPECIAL TAXES	SPECIAL TAXES	TOTAL TAXES	PAID	WHEN PAID	Number of Receipt	March Settlement 1962	June Settlement 1962	Penalty	November Settlement 1962	Penalty	Collections to First Monday in January 1963	Penalty	Delinquent on First Monday in January 1963	Total Delinquent Tax and Penalty	REMARKS	
	District No.	District No.	District No.	District No.	District No.	District No.																			
	Rate	Rate	Rate	Rate	Rate	Rate																			
	119																								
	174						4778	158			4936		PAID IN FULL FEB 5 1962	2845	4936									14925	
	174						4778	158			4936														

Fish's Point Kings Green Rocky Point Blue Water Beach

Assessment Roll and Tax List of Real Property in the Town of Gentle Lake of County of Cass, Minnesota
 * Indicate Type of Property: R-Residential, C-Commercial, I-Industrial, U-Utility, F-Farm, L-Lakeshore, T-Timber, M-Mineral

Form SCD MILLER-DAVIS CO., MINNEAPOLIS

IN WHOSE NAME ASSESSED	DESCRIPTION OF PROPERTY	No. School District	Indicate Home-Stead Yes or No	Agr. or Recr. Yes or No	Indicate Type of Property	TRUE AND FULL VALUATIONS			ASSESSED VALUATIONS							Total Assessed Value as Equalized by the Board of Review	FINAL EQUALIZED VALUE	
						LAND Exclusive of Structures and Improvements	BUILDGINGS and Other Structures	MACHINERY Permanently Attached to Real Estate	TOTAL True and Full Value	RURAL		ALL OTHER		MACHINERY Permanently Attached to Real Estate	Seasonal and Recreational Cabins			TOTAL ASSESSED VALUE
										Homestead Up to \$4,000 20%	Over \$4,000 and Non-Homestead 33 1/3%	Timber Land Class 3e 20%	Homestead Up to \$4,000 25%					
						Dollars	Dollars	Dollars	Dollars	Dollars	Dollars	Dollars	Dollars	Dollars	Dollars	Dollars		
H. V. & Agnes R. Brooks	NEW of NE 1/4	110	Yes	Yes	T													
U. S. of America	NW 1/4 of NE 1/4																	
U. S. of America	SW 1/4 of NE 1/4																	
U. S. of America	SE 1/4 of NE 1/4																	
Russell L. Rehm + Richard C. & Harold L. Brown	NEW of NW 1/4	110	No	Yes	T													
Russell L. Rehm	GOVT LOT 1		No	"	"													
"	GOVT LOT 2		No	"	"													
"	SE 1/4 of NW 1/4		No	"	"													
State of Minnesota	NEW of SW 1/4																	
Russell L. Rehm	GOVT LOT 3		No	Yes	T													
State of Minnesota	GOVT LOT 4																	
State of Minnesota	SW 1/4 of SW 1/4																	
State of Minnesota	NEW of SE 1/4																	
State of Minnesota	NW 1/4 of SE 1/4																	
State of Minnesota	SW 1/4 of SE 1/4																	
State of Minnesota	SE 1/4 of SE 1/4																	
		23534																

Cass County, Minnesota, for Taxes for the Year 1961.

SOLD FOR TAXES	VALUATIONS BY SCHOOL DISTRICTS AS EQUALIZED BY DEPARTMENT OF TAXATION						Tax including State Homestead	State Tax on Non-Homestead	SPECIAL TAXES	SPECIAL TAXES	TOTAL TAXES	PAID	WHEN PAID	Number of Receipt	March Settlement 1962	June Settlement 1962	Penalty	November Settlement 1962	Penalty	Collections to First Monday in January 1963	Penalty	Delinquent on First Monday in January 1963	Total Delinquent Tax and Penalty	REMARKS
	District No.	Rate	District No.	Rate	District No.	Rate																		
	Dollars	Mills	Dollars	Mills	Dollars	Mills																		
	Dollars	Mills	Dollars	Mills	Dollars	Mills	\$ cts.	\$ cts.	\$ cts.	\$ cts.	\$ cts.	Month Day Year	\$ cts.	\$ cts.	\$ cts.	\$ cts.	\$ cts.	\$ cts.	\$ cts.	\$ cts.	\$ cts.	\$ cts.	\$ cts.	
1	44	119					1208			1208		PAID IN FULL MAY 3 1 1962	11752		1208								12189	
6	73	119					2004	66		2070		2nd HALF PAID MAY 3 1 1962	11790		1035								21854	
7	100	119					2746	92		2838		1st HALF PAID MAY 3 1 1962	11784		1419		1419						12310	
8	133	119					3652	122		3774		1st HALF PAID MAY 3 1 1962	11798		1887		1887						"	
9	133	119					3652	122		3774		2nd HALF PAID OCT 3 1 1962	11798		1887		1887						"	
12	133	119					3652	122		3774		2nd HALF PAID OCT 3 1 1962	11798		1887		1887						12310	
20	44	572					16914	524		17438					10358		7080							

Assessment Roll and Tax List of Real Property in the Town of Little Lake

* Indicate Type of Property: R-Residential, C-Commercial, I-Industrial, U-Utility, F-Farm, L-Lakeshore, T-Timber, M-Mineral

Form 500 MILLER-DAVIS CO., MINNEAPOLIS

Main assessment table with columns for IN WHOSE NAME ASSESSED, DESCRIPTION OF PROPERTY, TRUE AND FULL VALUATIONS, ASSESSED VALUATIONS (RURAL, ALL OTHER, MACHINERY, etc.), and FINAL EQUALIZED VALUE.

Cass County, Minnesota, for Taxes for the Year 1961.

Tax and payment table with columns for VALUATIONS BY SCHOOL DISTRICTS AS EQUALIZED BY DEPARTMENT OF TAXATION, TAXES (SPECIAL, TOTAL), PAID (WHEN PAID), and REMARKS.

Vertical text on the right edge of the page, including 'Just's Point', 'Kings Green Shore', 'Rocky Point', and 'Blue Water Beach'.

Assessment Roll and Tax List of Real Property in the Town of Turtle Lake

* Indicate Type of Property: R-Residential, C-Commercial, I-Industrial, U-Utility, F-Farm, L-Lakeshore, T-Timber, M-Mineral

Form 5CD MILLER-DAVIS CO., MINNEAPOLIS

Table with columns: IN WHOSE NAME ASSESSED, DESCRIPTION OF PROPERTY, TRUE AND FULL VALUATIONS, ASSESSED VALUATIONS, and FINAL EQUALIZED VALUE.

Cass County, Minnesota, for Taxes for the Year 1961.

Table with columns: VALUATIONS BY SCHOOL DISTRICTS AS EQUALIZED BY DEPARTMENT OF TAXATION, Tax including State Homestead, State Tax on Non-Homestead, SPECIAL TAXES, TOTAL TAXES, PAID, WHEN PAID, Number of Receipt, March Settlement, June Settlement, Penalty, November Settlement, Collections to First Monday in January, Delinquent on First Monday in January, Total Delinquent Tax and Penalty, and REMARKS.

Vertical text on the right edge of the page: Juhl's Point, Kings Green Point, Blue Water Beach.

Assessment Roll and Tax List of Real Property in the Town of Turtle Lake

* Indicate Type of Property: R-Residential, C-Commercial, I-Industrial, U-Utility, F-Farm, L-Lakeshore, T-Timber, M-Mineral

Form 5CD MILLER-DAVIS CO., MINNEAPOLIS

Table with columns: IN WHOSE NAME ASSESSED, DESCRIPTION OF PROPERTY, TRUE AND FULL VALUATIONS, ASSESSED VALUATIONS, FINAL EQUALIZED VALUE. Includes handwritten entries for Benjamin R. + Roberta B. Pateloff, Roy J. + Mavis B. Ahrens, Charles H. Hutchinson, Palmer Haugland, Vernal Pennud, Stanley C. + Anne Louise Peterson, Arthur C. + Anna C. Dallaire, Mary Jane Phelps, Elsie L. + Roy Z. Larson, Edward L. + Elsie Leagle.

(CONT NEXT PAGE)

Cass County, Minnesota, for Taxes for the Year 1961.

Table with columns: SOLD FOR TAXES, VALUATIONS BY SCHOOL DISTRICTS AS EQUALIZED BY DEPARTMENT OF TAXATION, Tax Including State Homestead, State Tax on Non-Homestead, SPECIAL TAXES, TOTAL TAXES, PAID, WHEN PAID, Number of Receipt, March Settlement, June Settlement, November Settlement, Collections to First Monday in January, Delinquent on First Monday in January, Total Delinquent Tax and Penalty, REMARKS. Includes handwritten entries for 10, 11, 12, 13, 14, 15, 16, 17, 18, 19, 20.

Vertical text on the right edge: Bush's Point, Kings Green, Rocky Point, Blue Water Beach

Assessment Roll and Tax List of Real Property in the Town of North Lake, * Indicate Type of Property: R-Residential, C-Commercial, I-Industrial, U-Utility, F-Farm, L-Lakeshore, T-Timber, M-Mineral

FORM 500 MILLER-DAVIS CO., MINNEAPOLIS

Table with columns: IN WHOSE NAME ASSESSED, DESCRIPTION OF PROPERTY, TRUE AND FULL VALUATIONS (LAND, BUILDINGS, MACHINERY, TOTAL), ASSESSED VALUATIONS (RURAL, ALL OTHER, MACHINERY, Seasonal and Recreational Cabins, TOTAL ASSESSED VALUE), and FINAL EQUALIZED VALUE.

Cass County, Minnesota, for Taxes for the Year 1961.

Table with columns: SOLD FOR TAXES, VALUATIONS BY SCHOOL DISTRICTS AS EQUALIZED BY DEPARTMENT OF TAXATION (District No., Rate, Mills), Tax including State Homestead, State Tax on Non-Homestead, SPECIAL TAXES, TOTAL TAXES, PAID, WHEN PAID, Number of Receipt, March Settlement, June Settlement, November Settlement, Collections to First Monday in January, Delinquent on First Monday in January, Total Delinquent Tax and Penalty, and REMARKS.

141-80

Bush's Point

Kings Green Shore

Rocky Point

Blue Water Beach

Assessment Roll and Tax List of Real Property in the Town of Turtle Lake,
* Indicate Type of Property: R-Residential, C-Commercial, I-Industrial, U-Utility, F-Farm, L-Lakeshore, T-Timber, M-Mineral

Form SCD MILLER-DAVIS CO., MINNEAPOLIS

Table with columns: IN WHOSE NAME ASSESSED, DESCRIPTION OF PROPERTY, TRUE AND FULL VALUATIONS (RURAL, ALL OTHER, MACHINERY, Seasonal and Recreational Cabins, TOTAL ASSESSED VALUE, Total Assessed Value as Equalized by the Board of Review, FINAL EQUALIZED VALUE), and various tax-related fields.

Cass County, Minnesota, for Taxes for the Year 1961.

Table with columns: VALUATIONS BY SCHOOL DISTRICTS AS EQUALIZED BY DEPARTMENT OF TAXATION, Tax Including State Homestead, State Tax on Non-Homestead, SPECIAL TAXES, TOTAL TAXES, PAID, WHEN PAID, Number of Receipt, March Settlement, June Settlement, November Settlement, Collections to First Monday in January 1963, Delinquent on First Monday in January 1963, Total Delinquent Tax and Penalty, and REMARKS.

Assessment Roll and Tax List of Real Property in the Town of Turtle Lake

* Indicate Type of Property: R-Residential, C-Commercial, I-Industrial, U-Utility, F-Farm, L-Lakeshore, T-Timber, M-Mineral

Cass County, Minnesota, for Taxes for the Year 1961.

Bush's Point

Table with columns: IN WHOSE NAME ASSESSED, SUBDIVISION, Sec. or Lot, Town or Block, Rng., Number of Acres of Land, No. School District, Indicate of Homestead, Agri. Rec. or No., Indicate Type of Property, TRUE AND FULL VALUATIONS (LAND, BUILDINGS, MACHINERY, TOTAL), ASSESSED VALUATIONS (RURAL, ALL OTHER, MACHINERY, Seasonal and Recreational Cabins, TOTAL ASSESSED VALUE, Total Assessed Value as Equalized by the Board of Review), FINAL EQUALIZED VALUE.

Table with columns: SOLD FOR TAXES, VALUATIONS BY SCHOOL DISTRICTS AS EQUALIZED BY DEPARTMENT OF TAXATION (District No., Rate, Mills), Tax Including State Homestead, State Tax on Non-Homestead, SPECIAL TAXES, TOTAL TAXES, PAID, WHEN PAID (Month, Day, Year), Number of Receipt, March Settlement 1962, June Settlement 1962, November Settlement 1962, Penalty, Collections to First Monday in January 1963, Delinquent on First Monday in January 1963, Total Delinquent Tax and Penalty, REMARKS.

Kings Green Shore

Rocky Point

Blue Water Beach

Assessment Roll and Tax List of Real Property in the Town of Turtle Lake

* Indicate Type of Property: R-Residential, C-Commercial, I-Industrial, U-Utility, F-Farm, L-Lakeshore, T-Timber, M-Mineral

Cass County, Minnesota, for Taxes for the Year 1961.

Form 50 MILLER-DAVIS CO., MINNEAPOLIS

141-80 Bush's Point Kings Green Shore

Albert Thomas

Table with columns: IN WHOSE NAME ASSESSED, SUBDIVISION, Sec. or Lot, Town or Block, Number of Acres of Land, No. School District, Indicate Homestead, Agr. or Recr., Indicate Type of Property, TRUE AND FULL VALUATIONS (LAND, BUILDINGS, MACHINERY, TOTAL), ASSESSED VALUATIONS (RURAL, ALL OTHER, MACHINERY, Seasonal and Recreational Cabins, TOTAL ASSESSED VALUE, Total Assessed Value as Equalized by the Board of Review), FINAL EQUALIZED VALUE.

Table with columns: SOLD FOR TAXES, VALUATIONS BY SCHOOL DISTRICTS AS EQUALIZED BY DEPARTMENT OF TAXATION (District No., Rate, Mills), Tax Including State Homestead, State Tax on Non-Homestead, SPECIAL TAXES, TOTAL TAXES, PAID, WHEN PAID (Month, Day, Year), Number of Receipt, March Settlement 1962, June Settlement 1962, Penalty, November Settlement 1962, Collections to First Monday in January 1963, Delinquent on First Monday in January 1963, Total Delinquent Tax and Penalty, REMARKS.

Rocky Point Blue Water Beach

Assessment Roll and Tax List of Real Property in the Town of Turtle Lake

* Indicate Type of Property: R-Residential, C-Commercial, I-Industrial, U-Utility, F-Farm, L-Lakeshore, T-Timber, M-Mineral

Form 50 MILLER-DAVIS CO., MINNEAPOLIS

Bush's Point Kings Green Shores Rocky Point

Table with columns: IN WHOSE NAME ASSESSED, SUBDIVISION, DESCRIPTION OF PROPERTY, TRUE AND FULL VALUATIONS (RURAL, ALL OTHER, MACHINERY, Seasonal and Recreational Cabins), ASSESSED VALUATIONS, FINAL EQUALIZED VALUE.

Cass County, Minnesota, for Taxes for the Year 1961.

Table with columns: VALUATIONS BY SCHOOL DISTRICTS AS EQUALIZED BY DEPARTMENT OF TAXATION, TAX INCLUDING STATE HOMESTEAD, SPECIAL TAXES, TOTAL TAXES, PAID, WHEN PAID, Number of Receipt, March Settlement, June Settlement, November Settlement, Collections to First Monday in January, Delinquent on First Monday in January, Total Delinquent Tax and Penalty, REMARKS.

Blue Water Beach

* Indicate Type of Property: R-Residential, C-Commercial, I-Industrial, U-Utility, F-Farm, L-Lakeshore, T-Timber, M-Mineral

141-50
Push's Point
Kings Green Shore
Rocky Point
Blue Water Beach

IN WHOSE NAME ASSESSED	Plotted 7-10-61	Harbor Springs Part of lot 4 (9.1 ac) + Part of lot 2 & 4 of 26 1/2 (16.2 ac) Sec. 19 - Tax-30.2	DESCRIPTION OF PROPERTY		TRUE AND FULL VALUATIONS										SOLD FOR TAXES	VALUATIONS BY SCHOOL DISTRICTS AS EQUALIZED BY DEPARTMENT OF TAXATION						TAXES												REMARKS													
			Sec. or Lot	Town or Block	LAND Exclusive of Structures and Improvements	BUILDINGS and Other Structures	MACHINERY Permanently Attached to Real Estate	TOTAL True and Full Value	RURAL			ALL OTHER				TOTAL ASSESSED VALUE	Total Assessed Value as Equalized by the Board of Review	FINAL EQUALIZED VALUE	District						PAID																						
Acres 100ths	No. School District	Indicate Homestead Yes or No	Agr. or Semi-Agr. Yes or No	Indicate Type of Property	Dollars	Dollars	Dollars	Dollars	Dollars	Dollars	Dollars	Dollars	Dollars	Dollars	Dollars	Dollars	Dollars	Dollars	Dollars	Dollars	Dollars	Dollars	Dollars	Dollars	Dollars	Dollars	Dollars	Dollars	Dollars	Dollars	Dollars	Dollars	Dollars	Dollars	Dollars	Dollars	Dollars	Dollars	Dollars	Dollars							
Walter + Viola Ess																																															
Edwin L. + Violet V. Olson																																															
Edwin L. + Violet V. Olson																																															
Wm. C. Selma + Helen V. Selma																																															
Edwin L. + Violet V. Olson																																															
" " "																																															
" " "																																															
" " "																																															
" " "																																															
" " "																																															
" " "																																															
" " "																																															

Valuations carried in original deed. See 19, 20, 30
Lines 14 & 18 page 51

