

Assessment & Tax List - 1954

Trelipe

SUMMARY OF TAX COLLECTION

| | | | |
|---------------------|-----------|--------------|--------------|
| Original Levy | - - - - - | \$ 46,741.22 | |
| Additions | - - - - - | \$ _____ | |
| | | | \$ 46,741.22 |
| Abatements | - - - - - | \$ 44.72 | |
| | | | \$ 46,296.50 |
| COLLECTIONS | | | |
| March Settlement | - - - - - | \$ 802.10 | |
| June Settlement | - - - - - | \$ 2448.00 | |
| November Settlement | - - - - - | \$ 959.68 | |
| January Settlement | - - - - - | \$ 5.00 | \$ 4,214.78 |
| | | | \$ _____ |
| Over Collected | - - - - - | \$ 1.24 | |
| Under Collected | - - - - - | \$ _____ | |
| Delinquent | - - - - - | \$ 414.96 | \$ 414.72 |
| Total | - - - - - | | \$ 46,296.50 |

140-27

Sherris Shores

Birchwood Shores

Brookman's Landing

TABULAR SCHEDULE OF VALUATIONS,

LEVIED IN THE Town OF Lielipe

| School District No. | VALUATION BY SCHOOL DISTRICTS | | | | RATE OF STATE TAXES | | RATE OF COUNTY TAXES | | | | | | RATE OF TOWN TAXES | | | | | | | | | | RATE OF | | | | | | | | | | | | | |
|---------------------|-------------------------------|------------------------|-------------------|--|-------------------------|--------------------------|----------------------|---------|---------|----------------|------------|------------------------|--------------------|---------|------------|------------|---------|----------------|------|-------|---------|------------|------------|---------|----------------|------|-------|---------|------------|------------|---------|----------------|------|--|--|--|
| | Agricultural Lands | Non-Agricultural Lands | Personal Property | Total Value of all Property except Money and Credits | Total Rate of State Tax | Total Rate of County Tax | Rev. | R. & B. | Welfare | Bonds and Int. | R.I.B. Sky | Total Rate of Town Tax | Local | Special | State Loan | Deficiency | Tuition | Transportation | C.O. | Local | Special | State Loan | Deficiency | Tuition | Transportation | C.O. | Local | Special | State Loan | Deficiency | Tuition | Transportation | C.O. | | | |
| Un | 15,188 | 1912 | 4236 | 21,336 | 3.93 | 106.68 | 28.11 | 14.91 | 50.19 | 11.47 | 2. | 21. | 1. | 20. | 40. | 1.5 | 15. | | 1. | 40. | 40. | | | | | 1. | 20. | 40. | 1.5 | 15. | | | | | | |
| Assessed Value | Rural | All Other | Personal Property | Total | N. H. 5.22 9.15 | | | | | | | | | | | | | | | | | | | | | | | | | | | | | | | |
| Homestead | 4028 | | | 4028 | | | | | | | | | | | | | | | | | | | | | | | | | | | | | | | | |
| Non-Homestead | 13072 | | 4236 | 17308 | | | | | | | | | | | | | | | | | | | | | | | | | | | | | | | | |
| Total | 17,100 | | 4236 | 21,336 | | | | | | | | | | | | | | | | | | | | | | | | | | | | | | | | |

RATES AND TAXES

COUNTY OF CASS, STATE OF MINNESOTA

| SCHOOL TAXES | | LOCAL 1 MILL AND SPECIAL SCHOOL TAXES BY DISTRICTS | | | | | | | | | | ALL OTHER TAXES | | |
|-------------------------|-------------------------|--|---------|------------|-------|---------|------|--------------------|-------------------------|------|---------|-----------------|--|--|
| Total Rate of Sch'l Tax | Total Rate of all Taxes | Local 1 Mill | Special | State Loan | Ref. | Transp. | C.O. | Total School Taxes | FUNDS | Rate | Amounts | | | |
| 77.5 | 209.11 | 15.19 | 303.76 | 60.752 | 22.78 | 22.782 | | 117707 | State - Non-Homestead | | 8980 | | | |
| 97.5 | 229.11 | 6.15 | 245.92 | 245.92 | 922 | 9222 | | 59943 | State - Homestead | | 8385 | | | |
| | | 2134 | 54968 | 85344 | 3200 | 32004 | | 177650 | County Revenue, | | 59965 | | | |
| | | | | | | | | | County Road and Bridge, | | 31812 | | | |
| | | | | | | | | | County Welfare, | | 107085 | | | |
| | | | | | | | | | Bonds and Interest | | 24472 | | | |
| | | | | | | | | | R + B Sinking | | 4267 | | | |
| | | | | | | | | | | | 227601 | | | |
| | | | | | | | | | Town Revenue, | | 10668 | | | |
| | | | | | | | | | Town Road and Bridge, | | 32004 | | | |
| | | | | | | | | | Town Drag, | | 2134 | | | |
| | | | | | | | | | Town State Loan, | | 44806 | | | |
| | | | | | | | | | School Local 1 Mill, | | 2134 | | | |
| | | | | | | | | | School Special, | | 54968 | | | |
| | | | | | | | | | School State Loan, | | 85344 | | | |
| | | | | | | | | | Deficiency | | | | | |
| | | | | | | | | | Tuition | | | | | |
| | | | | | | | | | Transportation | | 3200 | | | |
| | | | | | | | | | Capital Outlay | | 32004 | | | |
| | | | | | | | | | | | 177650 | | | |

Total Taxes Real Estate 3681.64
 Pers. Prop. 992.58
 Total 4674.22

Total Number of Acres 8890.69
 State of Minnesota, }
 COUNTY OF CASS } ss.
 I, L. C. Peterson
 Auditor of said County and State aforesaid, do hereby certify that the foregoing is a true and correct Schedule, showing the valuation of all the taxable property, in the County of Lielipe, in said County, the several rates of Taxation and Totals of the several Tax Funds levied thereon for the year A. D. 1954.
 Witness my hand and official seal, this 17th day of December A. D. 1954.
L. C. Peterson County Auditor
 By Helen Billen Deputy

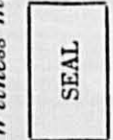

Assessment Roll and Tax List of Real Property in the Town of Duluth

Cass County, Minnesota, for Taxes for the Year 1954.

*Indicate Type of Property: R-Residential, C-Commercial, I-Industrial, U-Utility, F-Farm

Table with columns: IN WHOSE NAME ASSESSED, TO WHOM TRANSFERRED, DESCRIPTION OF PROPERTY, TRUE AND FULL VALUATIONS, ASSESSED VALUATIONS, VALUATIONS BY SCHOOL DISTRICTS AS EQUALIZED BY DEPARTMENT OF TAXATION, TAXES, PAID, WHEN PAID, etc.

1.39-27 1.40-27

Iwer's Shores Birchwood Shores Brocken's Idyll

Assessment and Tax List of Real Property in the Township of Isabel, Cass County, Minnesota, for Taxes for the Year 1954.

Cass County, Minnesota, for Taxes for the Year 1954.

Form SCD (54) BILLS-GATE COMPANY, MINNEAPOLIS

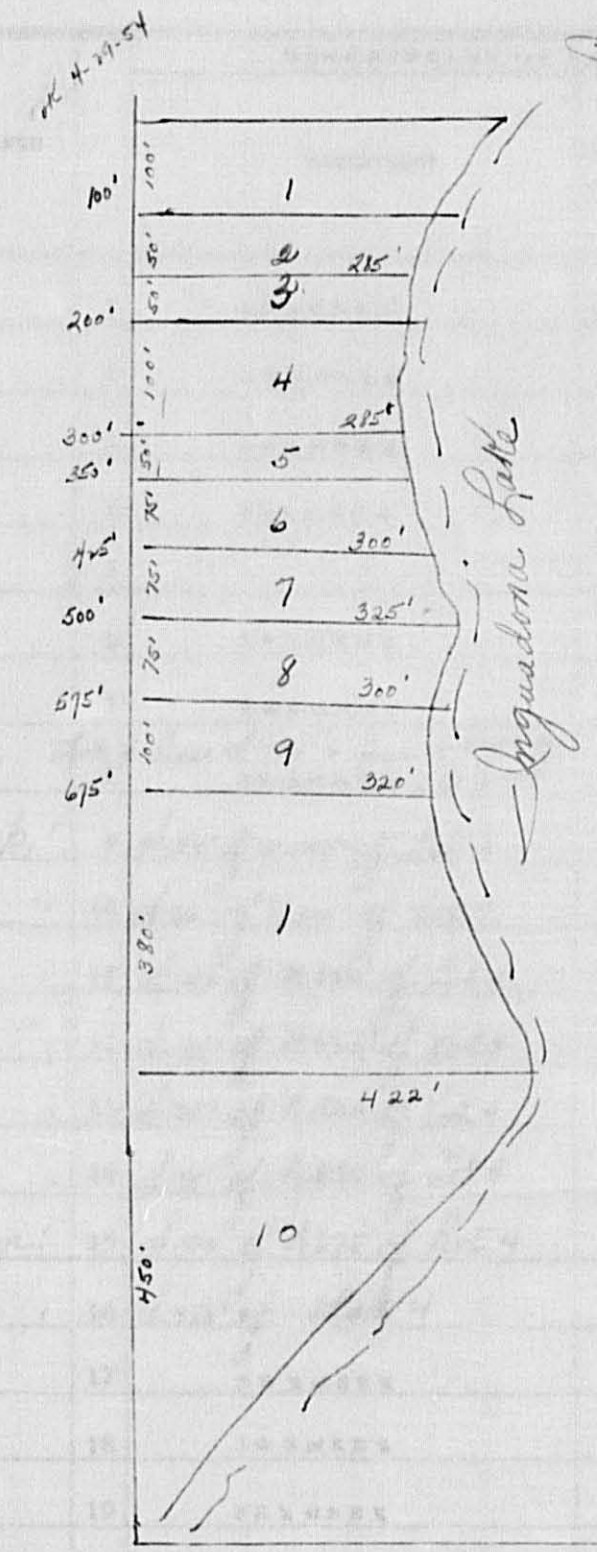

- Sec 5-140-27
Lot 4
1. Roland Edwards 6.0 ac
 2. Clarence & Elizabeth Strain 7.5 ac
 3. " " .25 "
 4. Guy Wm. & Bella Thompson .50 "
 5. " " .25 "
 6. Dorothy E. Workman .50 "
 7. " " 1.0 "
 8. " " .50 "
 9. Marvin Olson & Iris Larson .75 "
 10. Byron & Arma Sherwood 2.00 "

Roland Edwards
Clarence E. & Elizabeth M. Strain
" " "
Guy Wm. & Bella Thompson
Dorothy E. Workman
" " "
Marvin Olson & Iris Larson
Byron & Arma Sherwood

| SECTION | TOTAL True and Full Value | ASSESSED VALUATIONS | | | | MACHINERY Permanently Attached to Real Estate | TOTAL ASSESSED VALUE | Total Assessed Value as Equalized by the Board of Review | FINAL EQUALIZED VALUE |
|---------|---------------------------|-----------------------------------|--|---------------------------------------|--|---|----------------------|--|-----------------------|
| | | RURAL Homestead Up to \$4,000 20% | RURAL Over \$4,000 and Non-Homestead 33 1/3% | ALL OTHER Homestead Up to \$4,000 25% | ALL OTHER Over \$4,000 and Non-Homestead 40% | | | | |
| 1 | | | | | | | | | |
| 2 | | | | | | | | | |
| 3 | | | | | | | | | |
| 4 | | | | | | | | | |
| 5 | | | | | | | | | |
| 6 | | | | | | | | | |
| 7 | | | | | | | | | |
| 8 | | | | | | | | | |
| 9 | 40 | 8 | | | | 8 | | | |
| 10 | 15 | | 5 | | | 5 | | | |
| 1 | 195 | | 65 | | | 65 | | | |
| 2 | 201 | | 67 | | | 67 | | | |
| 3 | 201 | | 67 | | | 67 | | | |
| 4 | 174 | | 58 | | | 58 | | | |
| 5 | 54 | | 18 | | | 18 | | | |
| 6 | 51 | | 17 | | | 17 | | | |
| 7 | 546 | | 182 | | | 182 | | | |
| 8 | | | | | | | | | |
| 9 | | | | | | | | | |
| 10 | | | | | | | | | |
| TOTAL | 656 | | 426 | 1051 | | 1477 | 8 | 479 | 487 |

| SOLD FOR TAXES | VALUATIONS BY SCHOOL DISTRICTS AS EQUALIZED BY DEPARTMENT OF TAXATION | | | | | | Tax including State Homestead Mills | State Tax on Non-Homestead Mills | SPECIAL TAXES | TOTAL TAXES | PAID | WHEN PAID | Number of Receipt | March Settlement 1955 | June Settlement 1955 | Penalty | November Settlement 1955 | Penalty | Collections to First Monday in January 1956 | Penalty | Delinquent on First Monday in January 1956 | Total Delinquent Tax and Penalty | REMARKS |
|----------------|---|-------------------------|-------------------------|-------------------------|-------------------------|-------------------------|-------------------------------------|----------------------------------|---------------|-------------|------|-----------|-------------------|-----------------------|----------------------|---------|--------------------------|---------|---|---------|--|----------------------------------|---------|
| | District No. Rate Mills | District No. Rate Mills | District No. Rate Mills | District No. Rate Mills | District No. Rate Mills | District No. Rate Mills | | | | | | | | | | | | | | | | | |
| 1 | | | | | | | | | | | | | | | | | | | | | | | |
| 2 | | | | | | | | | | | | | | | | | | | | | | | |
| 3 | | | | | | | | | | | | | | | | | | | | | | | |
| 4 | | | | | | | | | | | | | | | | | | | | | | | |
| 5 | | | | | | | | | | | | | | | | | | | | | | | |
| 6 | | | | | | | | | | | | | | | | | | | | | | | |
| 7 | | | | | | | | | | | | | | | | | | | | | | | |
| 8 | | | | | | | | | | | | | | | | | | | | | | | |
| 9 | | | | | | | | | | | | | | | | | | | | | | | |
| 10 | | | | | | | | | | | | | | | | | | | | | | | |
| 11 | | | | | | | | | | | | | | | | | | | | | | | |
| 12 | | | | | | | | | | | | | | | | | | | | | | | |
| 13 | | | | | | | | | | | | | | | | | | | | | | | |
| 14 | | | | | | | | | | | | | | | | | | | | | | | |
| 15 | | | | | | | | | | | | | | | | | | | | | | | |
| 16 | | | | | | | | | | | | | | | | | | | | | | | |
| 17 | | | | | | | | | | | | | | | | | | | | | | | |
| 18 | | | | | | | | | | | | | | | | | | | | | | | |
| 19 | | | | | | | | | | | | | | | | | | | | | | | |
| 20 | | | | | | | | | | | | | | | | | | | | | | | |
| TOTAL | | | | | | | | | | | | | | | | | | | | | | | |

8
297
305

= 8
182 = 479
182 = 487

na 4170
6380 248
10550

10266 532

Assessment Roll and Tax List of Real Property in the Town of Delphi, Cass County, Minnesota

*Indicate Type of Property: R-Residential, C-Commercial, I-Industrial, U-Utility, F-Farm

Table with columns: IN WHOSE NAME ASSESSED, TO WHOM TRANSFERRED, DESCRIPTION OF PROPERTY, TRUE AND FULL VALUATIONS, ASSESSED VALUATIONS, VALUATIONS BY SCHOOL DISTRICTS, TAXES, PAID, WHEN PAID, Number of Receipt, March Settlement 1955, June Settlement 1955, November Settlement 1955, Collections to First Monday in January 1956, Delinquent on First Monday in January 1956, Total Delinquent Tax and Penalty, REMARKS.

Assessment Roll and Tax List of Real Property in the Town of Delisle, of Des Moines, Iowa

*Indicate Type of Property: R-Residential, C-Commercial, I-Industrial, U-Utility, F-Farm

Table with columns: IN WHOSE NAME ASSESSED, TO WHOM TRANSFERRED, SUBDIVISION, TRUE AND FULL VALUATIONS, ASSESSED VALUATIONS, FINAL EQUALIZED VALUE. Includes handwritten entries for Wesley E. & Marjorie Carpenter, Eldon R. & Martha Oberfell, and Lewis H. & Mayme Wheeler.

Table with columns: SOLD FOR TAXES, VALUATIONS BY SCHOOL DISTRICTS AS EQUALIZED BY DEPARTMENT OF TAXATION, Tax including State Homestead, State Tax on Non-Homestead, SPECIAL TAXES, TOTAL TAXES, PAID, WHEN PAID, Number of Receipt, March Settlement 1955, June Settlement 1955, November Settlement 1955, Collections to First Monday in January 1956, Delinquent on First Monday in January 1956, Total Delinquent Tax and Penalty, REMARKS.

140-27

Ivor's Shores

Birchwood Shores

Brookman's Landing

Assessment Roll and Tax List of Real Property in the Town of Delpe,
*Indicate Type of Property: R-Residential, C-Commercial, I-Industrial, U-Utility, F-Farm

Form 503 (54) VALUATION SUMMARY, MINNESOTA

Cass County, Minnesota, for Taxes for the Year 1954.

| IN WHOSE NAME ASSESSED | TO WHOM TRANSFERRED | SUBDIVISION | Sec. of Lot | Town or Block | Rog | Number of Acres of Land | TRUE AND FULL VALUATIONS | | | ASSESSED VALUATIONS | | | | | FINAL EQUALIZED VALUE | SOLD FOR TAXES | VALUATIONS BY SCHOOL DISTRICTS AS EQUALIZED BY DEPARTMENT OF TAXATION | | | | | | Tax including State Homestead | State Tax on Non-Homestead | SPECIAL TAXES | TOTAL TAXES | PAID | WHEN PAID | Number of Receipt | March Settlement 1955 | June Settlement 1955 | Penalty | November Settlement 1955 | Penalty | Collections to First Monday in January 1956 | Penalty | Delinquent on First Monday in January 1956 | Total Delinquent Tax and Penalty | REMARKS | | | | | | |
|-----------------------------------|---------------------|------------------|-------------|---------------|-----|-------------------------|---|--------------------------------|---|---------------------------|---------|-----------|---|----------------------|-----------------------|----------------|---|--------------|---------------|--------------|---------------|--------------|-------------------------------|----------------------------|---------------|-------------|---------------------------------|-----------|-------------------|-----------------------|----------------------|---------|--------------------------|---------|---|---------|--|----------------------------------|--------------------------------|---------------|--------------|---------------|------|------|------|
| | | | | | | | LAND Exclusive of Structures and Improvements | BUILDINGS and Other Structures | MACHINERY Permanently Attached to Real Estate | TOTAL True and Full Value | RURAL | ALL OTHER | MACHINERY Permanently Attached to Real Estate | TOTAL ASSESSED VALUE | | | Total Assessed Value as Equalized by the Board of Review | District No. | District Rate | District No. | District Rate | District No. | | | | | | | | | | | | | | | | | | District Rate | District No. | District Rate | | | |
| | | | | | | Acres | Dollars | Dollars | Dollars | Dollars | Dollars | Dollars | Dollars | Dollars | Dollars | Dollars | \$ | cts. | \$ | cts. | \$ | cts. | \$ | cts. | Month | Day | Year | \$ | cts. | \$ | cts. | \$ | cts. | \$ | cts. | \$ | cts. | | | | | | | | |
| Ralph L. Marc John & Alice Gilmer | | NE 1/4 of NE 1/4 | 14 | 140 | 27 | 40 | 180 | | | | 180 | 36 | | | 36 | | | | | | | | | | | | | | | | | | | | | | | | | | | | | | |
| State of Minnesota | | NW 1/4 of NE 1/4 | | | | | | | | | | | | | | | | | | | | | | | | | | | | | | | | | | | | | | | | | | | |
| State of Minnesota | | SW 1/4 of NE 1/4 | | | | | | | | | | | | | | | | | | | | | | | | | | | | | | | | | | | | | | | | | | | |
| John A. & Alice F. Gilmer | | SE 1/4 of NE 1/4 | | | | 40 | 200 | | | | 200 | 40 | | | 40 | | | | | | 836 | | | | | | | | | | | | | | | | | | 836 | 920 | | | | | |
| State of Minnesota | | NE 1/4 of NW 1/4 | | | | | | | | | | | | | | | | | | | | | | | | | | | | | | | | | | | | | | | | | | | |
| State of Minnesota | | NW 1/4 of NW 1/4 | | | | | | | | | | | | | | | | | | | | | | | | | | | | | | | | | | | | | | | | | | | |
| State of Minnesota | | SW 1/4 of NW 1/4 | | | | | | | | | | | | | | | | | | | | | | | | | | | | | | | | | | | | | | | | | | | |
| State of Minnesota | | SE 1/4 of NW 1/4 | | | | | | | | | | | | | | | | | | | | | | | | | | | | | | | | | | | | | | | | | | | |
| State of Minnesota | | NE 1/4 of SW 1/4 | | | | | | | | | | | | | | | | | | | | | | | | | | | | | | | | | | | | | | | | | | | |
| State of Minnesota | | NW 1/4 of SW 1/4 | | | | | | | | | | | | | | | | | | | | | | | | | | | | | | | | | | | | | | | | | | | |
| State of Minnesota | | SW 1/4 of SW 1/4 | | | | | | | | | | | | | | | | | | | | | | | | | | | | | | | | | | | | | | | | | | | |
| Ernest H. & Eva Hoppe | | SE 1/4 of SW 1/4 | | | | 40 | 160 | | | | 160 | 32 | | | 32 | | | | | | 670 | | | | | | 2nd Half Paid OCT 31 1955 15821 | | | | | | | | | | | | 1st Half Paid MAY 31 1955 6428 | | 335 | 335 | | | |
| John A. & Alice F. Gilmer | | NE 1/4 of SE 1/4 | | | | 40 | 220 | | | | 220 | 44 | | | 44 | | | | | | 920 | | | | | | 2nd Half Paid OCT 31 1955 15821 | | | | | | | | | | | | | | 920 | 1012 | | | |
| Ernest & Eva Hoppe | | NW 1/4 of SE 1/4 | | | | 40 | 200 | | | | 200 | 40 | | | 40 | | | | | | 836 | | | | | | 1st Half Paid MAY 31 1955 6428 | | | | | | | | | | | | | 418 | 418 | | | | |
| " | | SW 1/4 of SE 1/4 | | | | 39 | 220 | 245 | | | 465 | 93 | | | 93 | | | | | | 1944 | | | | | | 2nd Half Paid OCT 31 1955 15821 | | | | | | | | | | | | | | 972 | 972 | | | |
| John Gilmer | | SE 1/4 of SE 1/4 | | | | 40 | 220 | 200 | | | 420 | 84 | | | 84 | | | | | | 1756 | | | | | | 1st Half Paid MAY 31 1955 6428 | | | | | | | | | | | | | | 1756 | 1932 | | | |
| | | | | | | | | | | | | | | | | | | | | | | | | | | | | | | | | | | | | | | | | | | | | | |
| | | | | | | 79 | 1400 | 445 | | | 1845 | 369 | | | 369 | | | | | | 7714 | | | | | | | | | | | | | | | | | | | | | | 1725 | 1725 | 4264 |

Assessment Roll and Tax List of Real Property in the *Town* of *Delpre*

*Indicate Type of Property: R-Residential, C-Commercial, I-Industrial, U-Utility, F-Farm

| IN WHOSE NAME ASSESSED | TO WHOM TRANSFERRED | DESCRIPTION OF PROPERTY | | | | | TRUE AND FULL VALUATIONS | | | | | | | | | | FINAL EQUALIZED VALUE Dollars | | | | | |
|--------------------------|---------------------|-------------------------|-------------|------------------|-----|---|--------------------------|------------------------------|---------------------------------|-----------------------------|---|--------------------------------|---|---------------------------|-------------------|--------------------------------|----------------------------------|-------------------|------------------------------------|---|----------------------|--|
| | | SUBDIVISION | Sec. of Lot | Town or Block | Rng | Number of Acres of Land Acres 100ths | No. School District | Indicate Homestead Yes or No | Indicate Agricultural Yes or No | * Indicate Type of Property | LAND Exclusive of Structures and Improvements | BUILDINGS and Other Structures | MACHINERY Permanently Attached to Real Estate | TOTAL True and Full Value | RURAL | | | ALL OTHER | | MACHINERY Permanently Attached to Real Estate | TOTAL ASSESSED VALUE | Total Assessed Value as Equalized by the Board of Review |
| | | | | | | | | | | | Dollars | Dollars | Dollars | Dollars | Homestead | Over \$4,000 and Non-Homestead | | Homestead | Over \$4,000 and Non-Homestead | Dollars | Dollars | |
| | | | | | | | | | | | | | | | Up to \$4,000 20% | 33 1/8 % | | Up to \$4,000 25% | Over \$4,000 and Non-Homestead 40% | 33 1/8 % | | |
| State of Minnesota | | 1 | | NE 1/4 of NE 1/4 | | 15140.27 | | | | | | | | | | | | | | | | |
| State of Minnesota | | 2 | | NW 1/4 of NE 1/4 | | | | | | | | | | | | | | | | | | |
| State of Minnesota | | 3 | | SW 1/4 of NE 1/4 | | | | | | | | | | | | | | | | | | |
| State of Minnesota | | 4 | | SE 1/4 of NE 1/4 | | | | | | | | | | | | | | | | | | |
| State of Minnesota | | 5 | | | | | | | | | | | | | | | | | | | | |
| State of Minnesota | | 6 | | NE 1/4 of NW 1/4 | | | | | | | | | | | | | | | | | | |
| State of Minnesota | | 7 | | NW 1/4 of NW 1/4 | | | | | | | | | | | | | | | | | | |
| State of Minnesota | | 8 | | SW 1/4 of NW 1/4 | | | | | | | | | | | | | | | | | | |
| State of Minnesota | | 9 | | SE 1/4 of NW 1/4 | | | | | | | | | | | | | | | | | | |
| | | 10 | | | | | | | | | | | | | | | | | | | | |
| <i>The Homestead Co.</i> | | 11 | | NE 1/4 of SW 1/4 | | | no year | T | 198 | | | | 198 | | 66 | | | | 66 | | | |
| " | " | 12 | | NW 1/4 of SW 1/4 | | | " | T | 198 | | | | 198 | | 66 | | | | 66 | | | |
| " | " | 13 | | SW 1/4 of SW 1/4 | | | " | T | 198 | | | | 198 | | 66 | | | | 66 | | | |
| " | " | 14 | | SE 1/4 of SW 1/4 | | | " | T | 198 | | | | 198 | | 66 | | | | 66 | | | |
| State of Minnesota | | 15 | | | | | | | | | | | | | | | | | | | | |
| State of Minnesota | | 16 | | NE 1/4 of SE 1/4 | | | | | | | | | | | | | | | | | | |
| State of Minnesota | | 17 | | NW 1/4 of SE 1/4 | | | | | | | | | | | | | | | | | | |
| State of Minnesota | | 18 | | SW 1/4 of SE 1/4 | | | | | | | | | | | | | | | | | | |
| State of Minnesota | | 19 | | SE 1/4 of SE 1/4 | | | | | | | | | | | | | | | | | | |
| | | 20 | | | | | | | | | | | | | | | | | | | | |

160 792 792 264 264

Cass County, Minnesota, for Taxes for the Year 1954.

| SOLD FOR TAXES | VALUATIONS BY SCHOOL DISTRICTS AS EQUALIZED BY DEPARTMENT OF TAXATION | | | | | | Tax including State Homestead | State Tax on Non-Homestead | SPECIAL TAXES | TOTAL TAXES | PAID | WHEN PAID | Number of Receipt | March Settlement 1955 | June Settlement 1955 | Penalty | November Settlement 1955 | Penalty | Collections to First Monday in January 1956 | Penalty | Delinquent on First Monday in January 1956 | Total Delinquent Tax and Penalty | REMARKS |
|----------------|---|--------------|--------------|--------------|--------------|--------------|-------------------------------|----------------------------|---------------|-------------|------|-----------|-------------------|-----------------------|----------------------|---------|--------------------------|---------|---|---------|--|----------------------------------|---------|
| | District No. | District No. | District No. | District No. | District No. | District No. | | | | | | | | | | | | | | | | | |
| | Rate | Rate | Rate | Rate | Rate | Rate | | | | | | | | | | | | | | | | | |
| | Mills | Mills | Mills | Mills | Mills | Mills | | | | | | | | | | | | | | | | | |
| | | | | | | | | | | | | | | | | | | | | | | | |
| | | | | | | | | | | | | | | | | | | | | | | | |
| | | | | | | | | | | | | | | | | | | | | | | | |
| | | | | | | | | | | | | | | | | | | | | | | | |
| | | | | | | | | | | | | | | | | | | | | | | | |
| | | | | | | | | | | | | | | | | | | | | | | | |
| | | | | | | | | | | | | | | | | | | | | | | | |
| | | | | | | | | | | | | | | | | | | | | | | | |
| | | | | | | | | | | | | | | | | | | | | | | | |
| | | | | | | | | | | | | | | | | | | | | | | | |
| | | | | | | | | | | | | | | | | | | | | | | | |
| | | | | | | | | | | | | | | | | | | | | | | | |
| | | | | | | | | | | | | | | | | | | | | | | | |
| | | | | | | | | | | | | | | | | | | | | | | | |
| | | | | | | | | | | | | | | | | | | | | | | | |
| | | | | | | | | | | | | | | | | | | | | | | | |
| | | | | | | | | | | | | | | | | | | | | | | | |
| | | | | | | | | | | | | | | | | | | | | | | | |
| | | | | | | | | | | | | | | | | | | | | | | | |

5656

264 5320 136 5656

Assessment Roll and Tax List of Real Property in the Town of Delphi,

*Indicate Type of Property: R-Residential, C-Commercial, I-Industrial, U-Utility, F-Farm

Table with columns: IN WHOSE NAME ASSESSED, TO WHOM TRANSFERRED, DESCRIPTION OF PROPERTY (SUBDIVISION, Acres, 100ths), TRUE AND FULL VALUATIONS (LAND, BUILDINGS, MACHINERY, TOTAL), ASSESSED VALUATIONS (RURAL, ALL OTHER, MACHINERY, TOTAL), and FINAL EQUALIZED VALUE.

Cass County, Minnesota, for Taxes for the Year 1954.

Table with columns: VALUATIONS BY SCHOOL DISTRICTS AS EQUALIZED BY DEPARTMENT OF TAXATION (District No., Rate), TAX INCLUDING STATE HOMESTEAD, SPECIAL TAXES, TOTAL TAXES, PAID, WHEN PAID (Month Day Year), Number of Receipt, March Settlement 1955, June Settlement 1955, Penalty, November Settlement 1955, Collections to First Monday in January 1956, Penalty, Delinquent on First Monday in January 1956, Total Delinquent Tax and Penalty, REMARKS.

Assessment Roll and Tax List of Real Property in the Dow of Delphi,
 *Indicate Type of Property: R-Residential, C-Commercial, I-Industrial, U-Utility, F-Farm

| IN WHOSE NAME ASSESSED | TO WHOM TRANSFERRED | DESCRIPTION OF PROPERTY | | | | TRUE AND FULL VALUATIONS | | | | | | | | FINAL EQUALIZED VALUE | | | | |
|------------------------------|---------------------|-------------------------|-------------|---------------|-----|--------------------------|---|--------------------------------|---|---------------------------|-------|--------|-----------------------------|-----------------------|---|----------------------|--|--|
| | | SUBDIVISION | Sec. or Lot | Town or Block | Rng | Number of Acres of Land | LAND Exclusive of Structures and Improvements | BUILDINGS and Other Structures | MACHINERY Permanently Attached to Real Estate | TOTAL True and Full Value | RURAL | | ALL OTHER | | MACHINERY Permanently Attached to Real Estate | TOTAL ASSESSED VALUE | Total Assessed Value as Equalized by the Board of Review | |
| | | | | | | | | | | | Acres | 100ths | Homestead Up to \$1,000 20% | | | | | Over \$1,000 and Non-Homestead 33 1/3% |
| State of Minnesota | | NE 1/4 of NE 1/4 | | | | | | | | | | | | | | | | |
| H.E. Hall Northwest Paper Co | | NW 1/4 of NE 1/4 | | | | 40 | | | 198 | | | | 66 | | 66 | | | |
| " | | SW 1/4 of NE 1/4 | | | | 40 | | | 198 | | | | 66 | | 66 | | | |
| " | | SE 1/4 of NE 1/4 | | | | 40 | | | 198 | | | | 66 | | 66 | | | |
| State of Minnesota | | NE 1/4 of NW 1/4 | | | | | | | | | | | | | | | | |
| State of Minnesota | | NW 1/4 of NW 1/4 | | | | | | | | | | | | | | | | |
| State of Minnesota | | SW 1/4 of NW 1/4 | | | | | | | | | | | | | | | | |
| H.E. Hall Northwest Paper Co | | SE 1/4 of NW 1/4 | | | | 40 | | | 198 | | | | 66 | | 66 | | | |
| " | | NE 1/4 of SW 1/4 | | | | | | | 198 | | | | 66 | | 66 | | | |
| State of Minnesota | | NW 1/4 of SW 1/4 | | | | | | | | | | | | | | | | |
| State of Minnesota | | SW 1/4 of SW 1/4 | | | | | | | | | | | | | | | | |
| H.E. Hall Northwest Paper Co | | SE 1/4 of SW 1/4 | | | | 40 | | | 198 | | | | 66 | | 66 | | | |
| H.E. Hall | | NE 1/4 of SE 1/4 | | | | 40 | | | 198 | | | | 66 | | 66 | | | |
| " | | NW 1/4 of SE 1/4 | | | | 40 | | | 198 | | | | 66 | | 66 | | | |
| " | | SW 1/4 of SE 1/4 | | | | 40 | | | 198 | | | | 66 | | 66 | | | |
| " | | SE 1/4 of SE 1/4 | | | | 40 | | | 198 | | | | 66 | | 66 | | | |
| | | | | | | 360 | | | 1980 | | | | 660 | | 660 | | | |

Cass County, Minnesota, for Taxes for the Year 1954.

| SOLD FOR TAXES | VALUATIONS BY SCHOOL DISTRICTS AS EQUALIZED BY DEPARTMENT OF TAXATION | | | | | | Tax including State Homestead | State Tax on Non-Homestead | SPECIAL TAXES | TOTAL TAXES | PAID | WHEN PAID | Number of Receipt | March Settlement 1955 | June Settlement 1955 | Penalty | November Settlement 1955 | Penalty | Collections to First Monday in January 1956 | Penalty | Delinquent on First Monday in January 1956 | Total Delinquent Tax and Penalty | REMARKS |
|----------------|---|--------------|--------------|--------------|--------------|--------------|-------------------------------|----------------------------|---------------|-------------|--------------------------|-----------|-------------------|-----------------------|----------------------|---------|--------------------------|---------|---|---------|--|----------------------------------|---------|
| | District No. | District No. | District No. | District No. | District No. | District No. | | | | | | | | | | | | | | | | | |
| | Rate | Rate | Rate | Rate | Rate | Rate | | | | | | | | | | | | | | | | | |
| | Mills | Mills | Mills | Mills | Mills | Mills | | | | | | | | | | | | | | | | | |
| 1 | | | | | | | | | | | | | | | | | | | | | | | |
| 2 | | | | | | 66 | 1380 | 34 | 1414 | 2 | PAID IN FULL OCT 8 1955 | | | | | | | | | | | | |
| 3 | | | | | | 66 | 1380 | 34 | 1414 | 3 | PAID IN FULL OCT 8 1955 | 1374 | | | | | | | | 424 | 148 | | |
| 4 | | | | | | 66 | 1380 | 34 | 1414 | 4 | PAID IN FULL OCT 8 1955 | | | | | | | | | | | | |
| 5 | | | | | | | | | | | | | | | | | | | | | | | |
| 6 | | | | | | | | | | | | | | | | | | | | | | | |
| 7 | | | | | | | | | | | | | | | | | | | | | | | |
| 8 | | | | | | | | | | | | | | | | | | | | | | | |
| 9 | | | | | | 66 | 1380 | 34 | 1414 | 9 | PAID IN FULL OCT 8 1955 | 1374 | | | | | | | | 1414 | 49 | | |
| 10 | | | | | | | | | | | | | | | | | | | | | | | |
| 11 | | | | | | 66 | 1380 | 34 | 1414 | 11 | PAID IN FULL OCT 8 1955 | 1374 | | | | | | | | 1414 | 49 | | |
| 12 | | | | | | | | | | | | | | | | | | | | | | | |
| 13 | | | | | | | | | | | | | | | | | | | | | | | |
| 14 | | | | | | 66 | 1380 | 34 | 1414 | 14 | PAID IN FULL OCT 8 1955 | 574 | | | | | | | | 1414 | 49 | | |
| 15 | | | | | | | | | | | | | | | | | | | | | | | |
| 16 | | | | | | 66 | 1380 | 34 | 1414 | 16 | PAID IN FULL OCT 13 1955 | | | | | | | | | 1414 | | | |
| 17 | | | | | | 66 | 1380 | 34 | 1414 | 17 | PAID IN FULL OCT 13 1955 | 1404 | | | | | | | | 1414 | | | |
| 18 | | | | | | 66 | 1380 | 34 | 1414 | 18 | PAID IN FULL OCT 13 1955 | | | | | | | | | 1414 | | | |
| 19 | | | | | | 66 | 1380 | 34 | 1414 | 19 | PAID IN FULL OCT 8 1955 | 1374 | | | | | | | | 1414 | 51 | | |
| 20 | | | | | | | | | | | | | | | | | | | | | | | |
| | | | | | | 660 | 13800 | 340 | 14140 | | | | | | | | | | | | 14140 | | |

Assessment Roll and Tax List of Real Property in the Town of Dreize

* Indicate Type of Property: R-Residential, C-Commercial, I-Industrial, U-Utility, F-Farm

Form 5CD (54) MINN-DAY COMPANY, MINNEAPOLIS

Table with columns: IN WHOSE NAME ASSESSED, TO WHOM TRANSFERRED, DESCRIPTION OF PROPERTY, TRUE AND FULL VALUATIONS, ASSESSED VALUATIONS, and FINAL EQUALIZED VALUE.

Cass County, Minnesota, for Taxes for the Year 1954.

Table with columns: VALUATIONS BY SCHOOL DISTRICTS AS EQUALIZED BY DEPARTMENT OF TAXATION, TAXES, PAID, WHEN PAID, Number of Receipt, March Settlement 1955, June Settlement 1955, Penalty, November Settlement 1955, Penalty, Collections to First Monday in January 1956, Penalty, Delinquent on First Monday in January 1956, Total Delinquent Tax and Penalty, REMARKS.

139-27, 140-27

Town's Shares, Birchwood Shares, Brookman's 1/28ths

Assessment Roll and Tax List of Real Property in the Town of Delisle

*Indicate Type of Property: R-Residential, C-Commercial, I-Industrial, U-Utility, F-Farm

Table with columns: IN WHOSE NAME ASSESSED, TO WHOM TRANSFERRED, DESCRIPTION OF PROPERTY, TRUE AND FULL VALUATIONS, ASSESSED VALUATIONS, FINAL EQUALIZED VALUE.

Cass County, Minnesota, for Taxes for the Year 1954.

Table with columns: SOLD FOR TAXES, VALUATIONS BY SCHOOL DISTRICTS AS EQUALIZED BY DEPARTMENT OF TAXATION, Tax including State Homestead, State Tax on Non-Homestead, SPECIAL TAXES, TOTAL TAXES, PAID, WHEN PAID, Number of Receipt, March Settlement 1955, June Settlement 1955, November Settlement 1955, Penalty, Collections to First Monday in January 1956, Delinquent on First Monday in January 1956, Total Delinquent Tax and Penalty, REMARKS.

Assessment Roll and Tax List of Real Property in the *Town of Delisle* of *Dakota*

*Indicate Type of Property: R-Residential, C-Commercial, I-Industrial, U-Utility, F-Farm

Form SCD-154- WILHELM BAYER COMPANY, MINNEAPOLIS

Table with columns: IN WHOSE NAME ASSESSED, TO WHOM TRANSFERRED, DESCRIPTION OF PROPERTY (Subdivision, Sec. of Lot, Town or Block, Ring, Acres, 1000s), TRUE AND FULL VALUATIONS (LAND, BUILDINGS, MACHINERY, TOTAL), ASSESSED VALUATIONS (RURAL, ALL OTHER, MACHINERY, TOTAL ASSESSED), and FINAL EQUALIZED VALUE.

Table with columns: VALUATIONS BY SCHOOL DISTRICTS AS EQUALIZED BY DEPARTMENT OF TAXATION (District No., Rate, etc.), Tax including State Homestead, State Tax on Non-Homestead, SPECIAL TAXES, TOTAL TAXES, PAID, WHEN PAID, Number of Receipt, March Settlement, June Settlement, November Settlement, Penalty, Collections to First Monday in January, Delinquent on First Monday in January, Total Delinquent Tax and Penalty, REMARKS.

139-27
140-27

Year's Shares
Birchwood Shares
Brookman's 1788th

Assessment Roll and Tax List of Real Property in the *Town* of *Drelipe*, *Indicate Type of Property: R-Residential, C-Commercial, I-Industrial, U-Utility, F-Farm

Table with columns: IN WHOSE NAME ASSESSED, TO WHOM TRANSFERRED, DESCRIPTION OF PROPERTY, TRUE AND FULL VALUATIONS, ASSESSED VALUATIONS, and FINAL EQUALIZED VALUE.

Cass County, Minnesota, for Taxes for the Year 1954.

Table with columns: VALUATIONS BY SCHOOL DISTRICTS AS EQUALIZED BY DEPARTMENT OF TAXATION, Tax including State Homestead, State Tax on Non-Homestead, SPECIAL TAXES, TOTAL TAXES, PAID, WHEN PAID, Number of Receipt, March Settlement, June Settlement, November Settlement, Penalty, Collections to First Monday in January 1956, Delinquent on First Monday in January 1956, Total Delinquent Tax and Penalty, and REMARKS.

Assessment Roll and Tax List of Real Property in the Town of Delisle

*Indicate Type of Property: R-Residential, C-Commercial, I-Industrial, U-Utility, F-Farm

Form SCD (54) JULY 1954 EDITION, MINNESOTA

Table with columns: IN WHOSE NAME ASSESSED, TO WHOM TRANSFERRED, DESCRIPTION OF PROPERTY, TRUE AND FULL VALUATIONS, ASSESSED VALUATIONS, FINAL EQUALIZED VALUE.

Cass County, Minnesota, for Taxes for the Year 1954.

Table with columns: VALUATIONS BY SCHOOL DISTRICTS AS EQUALIZED BY DEPARTMENT OF TAXATION, Tax including State Homestead, State Tax on Non-Homestead, SPECIAL TAXES, TOTAL TAXES, PAID, WHEN PAID, Number of Receipt, March Settlement 1955, June Settlement 1955, Penalty, November Settlement 1955, Penalty, Collections to First Monday in January 1956, Penalty, Delinquent on First Monday in January 1956, Total Delinquent Tax and Penalty, REMARKS.

139-27
140-27

Ever's Stores
Birchwood Stores
Brookman's Liquor

Assessment Roll and Tax List of Real Property in the Town of Delisle

*Indicate Type of Property: R-Residential, C-Commercial, I-Industrial, U-Utility, F-Farm

Table with columns: IN WHOSE NAME ASSESSED, TO WHOM TRANSFERRED, SUBDIVISION, TRUE AND FULL VALUATIONS (LAND, BUILDINGS, MACHINERY, TOTAL), ASSESSED VALUATIONS (RURAL, ALL OTHER, MACHINERY, TOTAL ASSESSED VALUE), FINAL EQUALIZED VALUE.

Cass County, Minnesota, for Taxes for the Year 1954.

Table with columns: VALUATIONS BY SCHOOL DISTRICTS AS EQUALIZED BY DEPARTMENT OF TAXATION, Tax including State Homestead, State Tax on Non-Homestead, SPECIAL TAXES, TOTAL TAXES, PAID, WHEN PAID, Number of Receipt, March Settlement 1955, June Settlement 1955, Penalty, November Settlement 1955, Collections to First Monday in January 1956, Delinquent on First Monday in January 1956, Total Delinquent Tax and Penalty, REMARKS.

Assessment Roll and Tax List of Real Property in the Town of Ingle, Cass County, Minnesota, for Taxes for the Year 1954.

*Indicate Type of Property: R-Residential, C-Commercial, I-Industrial, U-Utility, F-Farm

Table with columns: IN WHOSE NAME ASSESSED, TO WHOM TRANSFERRED, DESCRIPTION OF PROPERTY, TRUE AND FULL VALUATIONS, ASSESSED VALUATIONS, and FINAL EQUALIZED VALUE. Includes handwritten entries for 'The Northwest Paper Co' and 'State of Minnesota'.

Cass County, Minnesota, for Taxes for the Year 1954.

Table with columns: VALUATIONS BY SCHOOL DISTRICTS AS EQUALIZED BY DEPARTMENT OF TAXATION, Tax including State Homestead, State Tax on Non-Homestead, SPECIAL TAXES, TOTAL TAXES, PAID, WHEN PAID, Number of Receipt, March Settlement 1955, June Settlement 1955, Penalty, November Settlement 1955, Penalty, Collections to First Monday in January 1956, Penalty, Delinquent on First Monday in January 1956, Total Delinquent Tax and Penalty, REMARKS.

139-27
140-27

Shores
Shores
Shores

Assessment Roll and Tax List of Real Property in the Town of Delisle

*Indicate Type of Property: R - Residential, C - Commercial, I - Industrial, U - Utility, F - Farm

Form SCD (54) MILLER-SAYRE COMPANY, MINNEAPOLIS

Table with columns: IN WHOSE NAME ASSESSED, TO WHOM TRANSFERRED, DESCRIPTION OF PROPERTY, TRUE AND FULL VALUATIONS, ASSESSED VALUATIONS, and FINAL EQUALIZED VALUE. Includes handwritten entries for 'The Northwest Paper Co.', 'Eugene G. Wherry', 'Margaret C. Crause', 'Katter & Violet Putman', 'F. W. Nordblom', and 'Ray & Marie Brostrom'.

Handwritten summary totals at the bottom of the table, including '301 31', 'Less for', and various numerical values.

Cass County, Minnesota, for Taxes for the Year 1954.

Table with columns: SOLD FOR TAXES, VALUATIONS BY SCHOOL DISTRICTS AS EQUALIZED BY DEPARTMENT OF TAXATION, SPECIAL TAXES, TOTAL TAXES, PAID, WHEN PAID, Number of Receipt, March Settlement 1955, June Settlement 1955, November Settlement 1955, Penalty, Collections to First Monday in January 1956, Delinquent on First Monday in January 1956, Total Delinquent Tax and Penalty, and REMARKS. Includes handwritten entries for 'PAID IN FULL' and 'SOLD FOR TAXES'.

Handwritten summary totals at the bottom of the second table, including '7110', '112', and '7222'.

Assessment Roll and Tax List of Real Property in the *Lower* of *Dodge*,

*Indicate Type of Property: R-Residential, C-Commercial, I-Industrial, U-Utility, F-Farm

| IN WHOSE NAME ASSESSED | TO WHOM TRANSFERRED | DESCRIPTION OF PROPERTY | | | | | | TRUE AND FULL VALUATIONS | | | | | | | | | | | FINAL EQUALIZED VALUE Dollars |
|---|---------------------|-------------------------|-------------|---------------|-----|-------------------------|--------|---|--------------------------------|---|---------------------------|-----------------------------|--|-----------------------------|------------------------------------|---|----------------------|--|----------------------------------|
| | | SUBDIVISION | Sec. or Lot | Town or Block | Rng | Number of Acres of Land | | LAND Exclusive of Structures and Improvements | BUILDINGS and Other Structures | MACHINERY Permanently Attached to Real Estate | TOTAL True and Full Value | RURAL | | ALL OTHER | | MACHINERY Permanently Attached to Real Estate | TOTAL ASSESSED VALUE | Total Assessed Value as Equalized by the Board of Review | |
| | | | | | | Acres | 100ths | | | | | Homestead Up to \$4,000 20% | Over \$4,000 and Non-Homestead 33 1/3% | Homestead Up to \$4,000 25% | Over \$4,000 and Non-Homestead 40% | | | | |
| <i>H. E. Hall the Northwest Paper Co.</i> | | NE 1/4 of NE 1/4 | | 32140 | 27 | 40 | | 198 | | | 198 | | | | | 66 | 66 | | |
| <i>The Northwest Paper Co.</i> | | NW 1/4 of NE 1/4 | | | | 40 | | 198 | | | 198 | | | | | 66 | 66 | | |
| " | " | SW 1/4 of NE 1/4 | | | | 40 | | 198 | | | 198 | | | | | 66 | 66 | | |
| <i>H. E. Hall the Northwest Paper Co.</i> | | SE 1/4 of NE 1/4 | | | | 40 | | 198 | | | 198 | | | | | 66 | 66 | | |
| State of Minnesota | | NE 1/4 of NW 1/4 | | | | | | | | | | | | | | | | | |
| State of Minnesota | | NW 1/4 of NW 1/4 | | | | | | | | | | | | | | | | | |
| State of Minnesota | | SW 1/4 of NW 1/4 | | | | | | | | | | | | | | | | | |
| State of Minnesota | | SE 1/4 of NW 1/4 | | | | | | | | | | | | | | | | | |
| State of Minnesota | | NE 1/4 of SW 1/4 | | | | | | | | | | | | | | | | | |
| State of Minnesota | | NW 1/4 of SW 1/4 | | | | | | | | | | | | | | | | | |
| State of Minnesota | | SW 1/4 of SW 1/4 | | | | | | | | | | | | | | | | | |
| State of Minnesota | | SE 1/4 of SW 1/4 | | | | | | | | | | | | | | | | | |
| <i>The Northwest Paper Co.</i> | | NE 1/4 of SE 1/4 | | | | 40 | | 198 | | | 198 | | | | | 66 | 66 | | |
| " | " | NW 1/4 of SE 1/4 | | | | 40 | | 198 | | | 198 | | | | | 66 | 66 | | |
| State of Minnesota | | SW 1/4 of SE 1/4 | | | | | | | | | | | | | | | | | |
| <i>The Northwest Paper Co.</i> | | SE 1/4 of SE 1/4 | | | | 40 | | 198 | | | 198 | | | | | 66 | 66 | | |
| | | | | | | 280 | | 1386 | | | 1386 | | | | | 462 | 462 | | |

Cass County, Minnesota, for Taxes for the Year 1954.

| SOLD FOR TAXES | VALUATIONS BY SCHOOL DISTRICTS AS EQUALIZED BY DEPARTMENT OF TALENTION | | | | | | Tax including State Homestead | State Tax on Non-Homestead | SPECIAL TAXES | TOTAL TAXES | PAID | WHEN PAID | Number of Receipt | March Settlement 1955 | June Settlement 1955 | Penalty | November Settlement 1955 | Penalty | Collections to First Monday in January 1956 | Penalty | Delinquent on First Monday in January 1956 | Total Delinquent Tax and Penalty | REMARKS |
|----------------|--|----------------|----------------|----------------|----------------|----------------|-------------------------------|----------------------------|---------------|-------------|--------------|-------------|-------------------|-----------------------|----------------------|---------|--------------------------|---------|---|---------|--|----------------------------------|---------|
| | District No. | District No. | District No. | District No. | District No. | District No. | | | | | | | | | | | | | | | | | |
| | Rate.....Mills | Rate.....Mills | Rate.....Mills | Rate.....Mills | Rate.....Mills | Rate.....Mills | | | | | | | | | | | | | | | | | |
| | | | | | | | | | | | | | | | | | | | | | | | |
| | | | | | | | 1380 | 34 | 1414 | 1 | PAID IN FULL | MAY 31 1955 | 6551 | | 1414 | | | | | | | | |
| | | | | | | | 1380 | 34 | 1414 | 2 | PAID IN FULL | MAY 31 1955 | 6551 | | 1414 | | | | | | | | |
| | | | | | | | 1380 | 34 | 1414 | 3 | PAID IN FULL | MAY 31 1955 | 6551 | | 1414 | | | | | | | | |
| | | | | | | | 1380 | 34 | 1414 | 4 | PAID IN FULL | MAY 31 1955 | 6551 | | 1414 | | | | | | | | |
| | | | | | | | | | | 5 | | | | | | | | | | | | | |
| | | | | | | | | | | 6 | | | | | | | | | | | | | |
| | | | | | | | | | | 7 | | | | | | | | | | | | | |
| | | | | | | | | | | 8 | | | | | | | | | | | | | |
| | | | | | | | | | | 9 | | | | | | | | | | | | | |
| | | | | | | | | | | 10 | | | | | | | | | | | | | |
| | | | | | | | | | | 11 | | | | | | | | | | | | | |
| | | | | | | | | | | 12 | | | | | | | | | | | | | |
| | | | | | | | | | | 13 | | | | | | | | | | | | | |
| | | | | | | | | | | 14 | | | | | | | | | | | | | |
| | | | | | | | | | | 15 | | | | | | | | | | | | | |
| | | | | | | | | | | 16 | | | | | | | | | | | | | |
| | | | | | | | | | | 17 | | | | | | | | | | | | | |
| | | | | | | | | | | 18 | | | | | | | | | | | | | |
| | | | | | | | | | | 19 | | | | | | | | | | | | | |
| | | | | | | | | | | 20 | | | | | | | | | | | | | |
| | | | | | | | | | | | 9660 | 238 | 9898 | | | | | | | | | | |

139-27
140-27

Sherrill's Stores
Birchwood Stores
Brookman's Lumber

Assessment Roll and Tax List of Real Property in the Town of Delisle, Cass County, Minnesota, for Taxes for the Year 1954.

Table with columns: IN WHOSE NAME ASSESSED, TO WHOM TRANSFERRED, DESCRIPTION OF PROPERTY, TRUE AND FULL VALUATIONS, ASSESSED VALUATIONS, FINAL EQUALIZED VALUE. Includes handwritten entries for 'The Northwest Paper Co.' and various land parcels.

Cass County, Minnesota, for Taxes for the Year 1954.

Table with columns: VALUATIONS BY SCHOOL DISTRICTS AS EQUALIZED BY DEPARTMENT OF TAXATION, TAX INCLUDING STATE HOMESTEAD, SPECIAL TAXES, TOTAL TAXES, PAID, WHEN PAID, Number of Receipt, March Settlement 1955, June Settlement 1955, November Settlement 1955, Penalty, Collections to First Monday in January 1956, Delinquent on First Monday in January 1956, Total Delinquent Tax and Penalty, REMARKS. Includes handwritten entries for 'PAID IN FULL MAY 31 1955' and '5656'.

Assessment Roll and Tax List of Real Property in the Town of *Dawn* of *Duluth*

*Indicate Type of Property: R-Residential, C-Commercial, I-Industrial, U-Utility, F-Farm

| IN WHOSE NAME ASSESSED | TO WHOM TRANSFERRED | DESCRIPTION OF PROPERTY | Sec. of Lot | Town or Block | Rng | Number of Acres of Land | No. School District | Indicate Homestead Yes or No | Indicate Agricultural Yes or No | Indicate Type of Property | TRUE AND FULL VALUATIONS | | | | ASSESSED VALUATIONS | | | | | | FINAL EQUALIZED VALUE | |
|--|---------------------|---|-------------|---------------|-----|-------------------------|---------------------|------------------------------|---------------------------------|---------------------------|---|--------------------------------|---|---------------------------|-----------------------------|--|-----------------------------|------------------------------------|---|----------------------|-----------------------|--|
| | | | | | | | | | | | LAND Exclusive of Structures and Improvements | BUILDINGS and Other Structures | MACHINERY Permanently Attached to Real Estate | TOTAL True and Full Value | RURAL | | ALL OTHER | | MACHINERY Permanently Attached to Real Estate | TOTAL ASSESSED VALUE | | Total Assessed Value as Equalized by the Board of Review |
| | | | | | | | | | | | | | | | Homestead Up to \$4,000 20% | Over \$4,000 and Non-Homestead 33 1/3% | Homestead Up to \$4,000 25% | Over \$4,000 and Non-Homestead 40% | | | | |
| <i>Frank & Mary Gilmer</i> | | NE 1/4 of NE 1/4 | | | | 35 1/2 27 | 40 | | | F | 220 | 400 | | 620 | 124 | | | 124 | | | | |
| State of Minnesota | | NW 1/4 of NE 1/4 | | | | | | | | | | | | | | | | | | | | |
| State of Minnesota | | SW 1/4 of NE 1/4 | | | | | | | | | | | | | | | | | | | | |
| State of Minnesota | | SE 1/4 of NE 1/4 | | | | | | | | | | | | | | | | | | | | |
| State of Minnesota | | NE 1/4 of NW 1/4 | | | | | | | | | | | | | | | | | | | | |
| State of Minnesota | | NW 1/4 of NW 1/4 | | | | | | | | | | | | | | | | | | | | |
| State of Minnesota | | SW 1/4 of NW 1/4 | | | | | | | | | | | | | | | | | | | | |
| State of Minnesota | | SE 1/4 of NW 1/4 | | | | | | | | | | | | | | | | | | | | |
| State of Minnesota | | NE 1/4 of SW 1/4 | | | | | | | | | | | | | | | | | | | | |
| State of Minnesota | | NW 1/4 of SW 1/4 | | | | | | | | | | | | | | | | | | | | |
| State of Minnesota | | SW 1/4 of SW 1/4 | | | | | | | | | | | | | | | | | | | | |
| State of Minnesota | | SE 1/4 of SW 1/4 | | | | | | | | | | | | | | | | | | | | |
| State of Minnesota | | NE 1/4 of SE 1/4 | | | | | | | | | | | | | | | | | | | | |
| State of Minnesota | | NW 1/4 of SE 1/4 | | | | | | | | | | | | | | | | | | | | |
| State of Minnesota | | SW 1/4 of SE 1/4 | | | | | | | | | | | | | | | | | | | | |
| <i>James H. Haug, Donald B. & Rose Marie</i> | | SE 1/4 of SE 1/4 <i>less E 20 rods of S 16 rods</i> | | | | 38 | | No | | T | 90 | | | 90 | 30 | | | 30 | | | | |
| <i>William Knutson</i> | | E 20 rods of S 16 rods of S 1/4 of S 1/4 | | | | 2 | | | | T | 18 | | | 18 | 6 | | | 6 | | | | |
| | | | | | | 80 | | | | | 328 | 400 | | 728 | 124 | 36 | | 160 | | | | |

| SOLD FOR TAXES | VALUATIONS BY SCHOOL DISTRICTS AS EQUALIZED BY DEPARTMENT OF TAXATION | | | | | | Tax including State Homestead | State Tax on Non-Homestead | SPECIAL TAXES | TOTAL TAXES | PAID | WHEN PAID | Number of Receipt | March Settlement 1955 | June Settlement 1955 | Penalty | November Settlement 1955 | Penalty | Collections to First Monday in January 1956 | Penalty | Delinquent on First Monday in January 1956 | Total Delinquent Tax and Penalty | REMARKS |
|----------------|---|--------------|--------------|--------------|--------------|--------------|-------------------------------|----------------------------|---------------|-------------|------|-----------|-------------------|-----------------------|----------------------|---------|--------------------------|---------|---|---------|--|----------------------------------|---------|
| | District No. | District No. | District No. | District No. | District No. | District No. | | | | | | | | | | | | | | | | | |
| | Rate | Rate | Rate | Rate | Rate | Rate | | | | | | | | | | | | | | | | | |
| | | | | | | | | | | | | | | | | | | | | | | | |
| 1 | | | | | | | | | | | | | | | | | | | | | | | |
| 2 | | | | | | | | | | | | | | | | | | | | | | | |
| 3 | | | | | | | | | | | | | | | | | | | | | | | |
| 4 | | | | | | | | | | | | | | | | | | | | | | | |
| 5 | | | | | | | | | | | | | | | | | | | | | | | |
| 6 | | | | | | | | | | | | | | | | | | | | | | | |
| 7 | | | | | | | | | | | | | | | | | | | | | | | |
| 8 | | | | | | | | | | | | | | | | | | | | | | | |
| 9 | | | | | | | | | | | | | | | | | | | | | | | |
| 10 | | | | | | | | | | | | | | | | | | | | | | | |
| 11 | | | | | | | | | | | | | | | | | | | | | | | |
| 12 | | | | | | | | | | | | | | | | | | | | | | | |
| 13 | | | | | | | | | | | | | | | | | | | | | | | |
| 14 | | | | | | | | | | | | | | | | | | | | | | | |
| 15 | | | | | | | | | | | | | | | | | | | | | | | |
| 16 | | | | | | | | | | | | | | | | | | | | | | | |
| 17 | | | | | | | | | | | | | | | | | | | | | | | |
| 18 | | | | | | | | | | | | | | | | | | | | | | | |
| 19 | | | | | | | | | | | 628 | 16 | | 644 | | | | | | | | | 644 708 |
| 20 | SOLD FOR TAXES | | | | | | | | | | 126 | 04 | | 130 | | | | | | | | | 130 143 |
| | | | | | | | | | | | 3346 | 20 | | 3366 | | | | | | | | | 774 |

Ther's Stores
Birchwood Stores
Brookman's Lumber

1952 350 425
1953 346 394

Assessment Roll and Tax List of Real Property in the Town of Phelps, of Phelps, Minn.

*Indicate Type of Property: R-Residential, C-Commercial, I-Industrial, U-Utility, F-Farm

Cass County, Minnesota, for Taxes for the Year 1954.

Form SCD (54) MILLER-BAYNE COMPANY, MINNEAPOLIS

Table with columns: IN WHOSE NAME ASSESSED, TO WHOM TRANSFERRED, DESCRIPTION OF PROPERTY (SUBDIVISION, Sec. of Lot, Town of Block, Rng, Number of Acres of Land), TRUE AND FULL VALUATIONS (LAND, BUILDINGS, MACHINERY, TOTAL), ASSESSED VALUATIONS (RURAL, ALL OTHER, MACHINERY, TOTAL ASSESSED VALUE, FINAL EQUALIZED VALUE), VALUATIONS BY SCHOOL DISTRICTS AS EQUALIZED BY DEPARTMENT OF TAXATION, TAXES (SOLD FOR TAXES, District No., Rate, Mills, Tax including State Homestead, State Tax on Non-Homestead, SPECIAL TAXES, TOTAL TAXES), PAID, WHEN PAID, Number of Receipt, March Settlement 1955, June Settlement 1955, Penalty, November Settlement 1955, Penalty, Collections to First Monday in January 1956, Penalty, Delinquent on First Monday in January 1956, Total Delinquent Tax and Penalty, REMARKS.

State of Minnesota

State of Minnesota

State of Minnesota

State of Minnesota

State of Minnesota

Albert Zumbrenner

State of Minnesota

State of Minnesota

State of Minnesota

State of Minnesota

State of Minnesota

State of Minnesota

State of Minnesota

State of Minnesota

State of Minnesota

State of Minnesota

State of Minnesota

State of Minnesota

State of Minnesota

State of Minnesota

Tree's Stores

Birchwood Stores

Brookman's Lumber

Assessment Roll and Tax List of Real Property in the Town of Duluth, Minnesota

*Indicate Type of Property: R-Residential, C-Commercial, I-Industrial, U-Utility, F-Farm

Table with columns: IN WHOSE NAME ASSESSED, TO WHOM TRANSFERRED, SUBDIVISION, DESCRIPTION OF PROPERTY, TRUE AND FULL VALUATIONS (RURAL, ALL OTHER, MACHINERY), ASSESSED VALUATIONS, FINAL EQUALIZED VALUE.

Cass County, Minnesota, for Taxes for the Year 1954.

Table with columns: SOLD FOR TAXES, VALUATIONS BY SCHOOL DISTRICTS AS EQUALIZED BY DEPARTMENT OF TAXATION, Tax including State Homestead, State Tax on Non-Homestead, SPECIAL TAXES, TOTAL TAXES, PAID, WHEN PAID, Number of Receipt, March Settlement 1955, June Settlement 1955, November Settlement 1955, Penalty, Collections to First Monday in January 1956, Delinquent on First Monday in January 1956, Total Delinquent Tax and Penalty, REMARKS.

140-27, 140-27, Ever's Shores, Birchwood Shores, Brookman's Linden Beach

405 759 1164 388 398

388 8112 204 8316 6772 1544

