

ASSESSMENT & TAX LIST

Trelipe

1947

List of Lands in the _____ of _____, County of _____, Minn., for the Year 19____, Which have Become Homesteads or Ceased to be Homesteads
 SINCE THE LAST REAL ESTATE ASSESSMENT DATE

Form 256 Miller-Davis Company, Minneapolis, State Form No. 61

LANDS BECOMING HOMESTEADS					LANDS CEASING TO BE HOMESTEADS				
NAME OF OWNER	School District	DESCRIPTION OF PROPERTY		Number of Acres of Land	NAME OF OWNER	School District	DESCRIPTION OF PROPERTY		Number of Acres of Land
		Subdivision	Sec. or Lot				Town or Block	Range	
				Acres 100ths					Acres 100ths

INCREASE OR DECREASE in Value of Property Heretofore Assessed, by the Erection or Destruction of Buildings or Structures Thereon

Platted Property Assessed at 40 Per Cent of True and Full Value.
 (Homesteads up to \$4,000 True and Full Value 25 Per Cent.)

Unplatted Property Assessed at 33 1/2 Per Cent of True and Full Value.
 (Homesteads up to \$4,000 True and Full Value 20 Per Cent.)

NAMES OF PROPERTY OWNERS	DESCRIPTION	Sec. or Lot	Town or Block	Rng.	True and Full Value of Structures with more than \$100 each Dollars	KIND OF STRUCTURES	Assessed Value of Additional Structures Dollars	Reduction of Assessed Value on Account of Loss occasioned by Fire, Flood or otherwise Dollars
		6	140	27	51	"	17	✓

Assessment of

Form 314

NAME OF OWNER

1
2
3
4
5
6
7
8

Treasurer's Office, Cass County, Minnesota

RECEIVED this 1st Monday (being the 5th day) of January, A. D. 1948, of L. C. Peterson Auditor of said County, Minnesota, the Tax List of all Taxable Real and Personal Property in the Town of Trelipe in said County for the year A. D. 1947, as specified above and amounting to 100 Dollars.

Paul A. Jewell
County Treasurer.

Auditor's Office, Cass County, Minnesota

I, _____ Auditor of said County, and State of Minnesota, do hereby certify that the following is a correct list of the Taxes levied on the Real and Personal Property in the _____ of _____ for the year 1947.

WITNESS my hand with official seal, this _____ day of _____ 1948.

(SEAL) _____ County Auditor.

JAN - 3 1948 194

Office of County Treasurer, Cass County, Minnesota

To L. C. Peterson County Auditor:

With return to you the Tax List for the Town of Trelipe in said County for the year 1947, heretofore received from you. I certify that I have compared the same with the duplicate receipts in your office, and have written opposite the amount of each tax so receipted the words "First Quarter Paid", "Second Quarter Paid", "Third Quarter Paid" or "Paid in full" as the case may be, and the number of my receipt given in discharge of said tax, and each tract or lot of real property against which the taxes remain unpaid is delinquent for said year.

Yours respectfully,
Paul A. Jewell
County Treasurer.

Auditor's Office, Cass County, Minnesota

I hereby certify that on the first Monday in January 1948, I received of _____ County Treasurer, the Tax List of the _____ of _____ in said County for the year 1947; that I have compared the said list with the Statements receipted for by said Treasurer, which are on file in my office, and that each tract or lot of real property therein against which the taxes, or any part thereof, remains unpaid are delinquent for said year.

(SEAL) _____ County Auditor.

Assessment of

TABULAR SCHEDULE OF VALUATIONS,
LEVIED IN THE Township OF Deluge

RATES AND TAXES
COUNTY OF CASS, STATE OF MINNESOTA

184.12
4.07
188.19

School District No.	VALUATION BY SCHOOL DISTRICTS					RATE OF STATE TAXES					RATE OF COUNTY TAXES					RATE OF TOWN TAXES					Total Rate of Town Tax	
	Dollars	Dollars	Dollars	Dollars	Dollars	Mills	Mills	Mills	Mills	Mills	Mills	Mills	Mills	Mills	Mills	Mills	Mills	Mills	Mills	Mills		Mills
1			21516	706	2807	25029	3.02	22	7.2	48	18	95.2	5	15	1							21
2																						
3			Rural 21516	Urban 706	P.P. 2807	Total 25029																
4			4248																			
5			17974																			
6			2807																			
7			25029																			
8																						

Real Estate H 4248
P.P. Prop. 2807
25029

N.H. 407
709

RATE OF SCHOOL TAXES										TAXES LEVIED									
LOCAL 1 MILL AND SPECIAL SCHOOL TAXES BY DISTRICTS										ALL OTHER TAXES									
Local 1 Mill	Special	State Loan	Transp.	C.O.	Brd.	Total Rate of Sch'l Tax	Total Rate of all Taxes	Local 1 Mill	Special	Transp.	C.O.	Brd.	Total School Taxes	FUNDS	Rate	Amounts			
1. 15	15	15	18	5	27.1	649	184.12	2152	32274	32274	3873	10758	58308	State Revenue,					
1. 30	15	15	18	5	27.1	749	199.12	351	10539	5270	632	1756	9520	State School,					
								2503	42813	37544	4505	12514	67828	Teachers Insurance,					
														State Debt—Non-Homestead,					
														State Debt—Homestead,					
														County Revenue,					
														County Road and Bridge,					
														County Welfare,					
														Bonds and Interest					
														Town Revenue,					
														Town Road and Bridge,					
														Town Drag,					
														Town State Loan,					
														School Local 1 Mill,					
														School Special,					
														School State Loan,					
														Def.					
														Transp.					
														C.O.					
														Brd.					

Total Levied, \$47450
82.62
76.94
55064
18020
120139
45052
2382.75
12515
37544
2503
525.62
2503
42813
37544
4505
12514
67828
167707

Total Number of Acres
State of Minnesota,
COUNTY OF CASS
Auditor of said County and State aforesaid, do hereby certify that the foregoing is a true and correct Schedule, showing the valuation of all the taxable property, in the year 1947, in said County, the several rates of Taxation and several Tax Funds levied thereon for the year A. D. 1947.
Witness my hand and official seal, this 15 day of July, A. D. 1947.

L. C. Peterson
County Auditor

SEAL

474500
Chas. Est. P.P.
4174.66
570.34
4745.00

Assessment Roll and Tax List of Real Property in the

Town of *Trelipe*

Cass County, Minnesota, for Taxes for the Year 1947.

Form 4 CD

139-27

IN WHOSE NAME ASSESSED	TO WHOM TRANSFERRED	DESCRIPTION OF PROPERTY				TRUE AND FULL VALUATIONS										FINAL EQUALIZED VALUE	
		SUBDIVISION	Sec. or Lot	Town or Block	Number of Acres of Land	LAND Exclusive of Structures and Improvements	BUILDINGS and Other Structures	MACHINERY Permanently Attached to Real Estate	TOTAL True and Full Value	RURAL		ALL OTHER		MACHINERY Permanently Attached to Real Estate	TOTAL ASSESSED VALUE		Total Assessed Value as Equalized by the Board of Review
										Acres	100ths	Homestead Up to \$4,000 20%	Over \$4,000 and Non-Homestead 33 1/3%				
<i>James Knutson</i>	<i>Donald B. & Clifton E. Wilson</i>	NE 1/4 of NE 1/4 Lot 1	2	139	27	41	49	1/4									
State of Minnesota		NW 1/4 of NE 1/4 ~ 2															
State of Minnesota		SW 1/4 of NE 1/4															
<i>Moneta Improvement Co.</i>		SE 1/4 of NE 1/4			40												
		NE 1/4 of NW 1/4 ~ 3			41	44											
		NW 1/4 of NW 1/4 ~ 4			41	41											
		SW 1/4 of NW 1/4			40												
State of Minnesota		SE 1/4 of NW 1/4															
State of Minnesota																	
State of Minnesota		NE 1/4 of SW 1/4															
State of Minnesota		NW 1/4 of SW 1/4															
State of Minnesota		SW 1/4 of SW 1/4															
State of Minnesota		SE 1/4 of SW 1/4															
<i>Moneta Improvement Co.</i>		NE 1/4 of SE 1/4			40												
State of Minnesota		NW 1/4 of SE 1/4															
State of Minnesota		SW 1/4 of SE 1/4															
<i>Ewald B. & Bertha Nelson</i>		N. 30 acs. SE 1/4 of SE 1/4			30												
State of Minnesota		SE 1/4 of SE 1/4															
<i>Lewis Lieske</i>		S. 10 acs. of SE 1/4 of SE 1/4			10												
					28	134											

SOLD FOR TAXES	VALUATIONS BY SCHOOL DISTRICTS AS EQUALIZED BY DEPARTMENT OF TAXATION						Tax including State Homestead	State Tax on Non-Homestead	SPECIAL TAXES	TOTAL TAXES	PAID	WHEN PAID	Number of Receipts	March Settlement 1948	June Settlement 1948	November Settlement 1948	Penalty	Collections to First Monday in January 1949	Penalty	Delinquent on First Monday in January 1949	Total Delinquent Tax and Penalty	REMARKS
	District No.	District No.	District No.	District No.	District No.	District No.																
	Rate	Rate	Rate	Rate	Rate	Rate																
1	H 84						1546		1546	1st Half Paid MAY 29 1948	29 1948	1										
2										2nd Half Paid AUG 20 1948	20 1948	2										
3												3										
4	H 44						810	18	828	1st Half Paid JUL 21 1948	21 1948	4										
5										2nd Half Paid OCT 30 1948	30 1948	5										
6	H 44						810	18	828	1st Half Paid JUL 21 1948	21 1948	6										
7	H 44						810	18	828	2nd Half Paid OCT 30 1948	30 1948	7										
8	H 44						810	18	828	1st Half Paid JUL 21 1948	21 1948	8										
9										2nd Half Paid OCT 30 1948	30 1948	9										
10												10										
11												11										
12												12										
13												13										
14												14										
15												15										
16	H 44						810	18	828	1st Half Paid JUL 21 1948	21 1948	16										
17										2nd Half Paid OCT 30 1948	30 1948	17										
18												18										
19	H 93						1712		1712	1st Half Paid OCT 29 1948	29 1948	19										
20	H 96						224	06	300	2nd Half Paid MAY 29 1948	29 1948	20										
	H 171						7602	96	7698	Forfeited												
	H 236																					
	H 473																					

3.00 Cancelled

Assessment Roll and Tax List of Real Property in the

Town of Trelise

Cass County, Minnesota, for Taxes for the Year 1947.

IN WHOSE NAME ASSESSED		DESCRIPTION OF PROPERTY			TRUE AND FULL VALUATIONS				ASSESSED VALUATIONS					SOLD FOR TAXES	VALUATIONS BY SCHOOL DISTRICTS AS EQUALIZED BY DEPARTMENT OF TAXATION						TAX INCLUDING STATE HOMESTEAD	STATE TAX ON NON-HOMESTEAD	SPECIAL TAXES	TOTAL TAXES	PAID	WHEN PAID	Number of Receipt	March Settlement 1948	June Settlement 1948	Penalty	November Settlement 1948	Penalty	Collections to First Monday in January 1949	Penalty	Delinquent on First Monday in January 1949	Total Delinquent Tax and Penalty	REMARKS		
TO WHOM TRANSFERRED	SUBDIVISION	Sec. of Lot	Town or Block	King.	Number of Acres of Land	LAND Exclusive of Structures and Improvements	BUILDINGS and Other Structures	MACHINERY Permanently Attached to Real Estate	TOTAL True and Full Value	R U R A L		ALL OTHER			MACHINERY Permanently Attached to Real Estate	TOTAL ASSESSED VALUE	Total Assessed Value as Equalized by the Board of Review	FINAL EQUALIZED VALUE																					
					Acres 100ths	Dollars	Dollars	Dollars	Dollars	Homestead Up to \$4,000 20%	Over \$4,000 and Non-Homestead 33 1/4%	Homestead Up to \$4,000 25%	Over \$4,000 and Non-Homestead 40%		Dollars 33 1/4%	Dollars	Dollars	Dollars	Dollars	Dollars																		Dollars	Dollars
State of Minnesota		1	NE 1/4 of NE 1/4			7 139 27																																	
State of Minnesota		2	NW 1/4 of NE 1/4																																				
State of Minnesota		3	SW 1/4 of NE 1/4																																				
State of Minnesota		4	SE 1/4 of NE 1/4																																				
		5																																					
State of Minnesota		6	NE 1/4 of NW 1/4																																				
State of Minnesota		7	NW 1/4 of NW 1/4																																				
State of Minnesota		8	SW 1/4 of NW 1/4																																				
State of Minnesota		9	SE 1/4 of NW 1/4																																				
		10																																					
State of Minnesota		11	NE 1/4 of SW 1/4																																				
State of Minnesota		12	NW 1/4 of SW 1/4																																				
State of Minnesota		13	SW 1/4 of SW 1/4																																				
State of Minnesota		14	SE 1/4 of SW 1/4																																				
		15																																					
State of Minnesota		16	NE 1/4 of SE 1/4																																				
State of Minnesota		17	NW 1/4 of SE 1/4																																				
State of Minnesota		18	SW 1/4 of SE 1/4																																				
State of Minnesota		19	SE 1/4 of SE 1/4																																				
		20																																					

139-27

140-27

Assessment Roll and Tax List of Real Property in the Town of Trelise

Form 4-CD

IN WHOSE NAME ASSESSED	TO WHOM TRANSFERRED	SUBDIVISION	Sec. or Lot	Town or Block	Range	Number of Acres of Land	Neighboring District	Indicate Homestead Yes or No	Indicate Agricultural Yes or No	TRUE AND FULL VALUATIONS				ASSESSED VALUATIONS					Total Assessed Value as Equalized by the Board of Review	FINAL EQUALIZED VALUE						
										LAND Exclusive of Structures and Improvements	BUILDINGS and Other Structures	MACHINERY Permanently Attached to Real Estate	TOTAL True and Full Value	RURAL		ALL OTHER		MACHINERY Permanently Attached to Real Estate			TOTAL ASSESSED VALUE	Dollars	Dollars	Dollars	Dollars	
										Dollars	Dollars	Dollars	Dollars	Homestead Up to \$4,000 20%	Over \$4,000 and Non-Homestead 33 1/4%	Homestead Up to \$4,000 25%	Over \$4,000 and Non-Homestead 40%	Dollars	Dollars	Dollars	Dollars	Dollars				
State of Minnesota		1 NE 1/4 of NE 1/4				11 139.27																				
State of Minnesota		2 NW 1/4 of NE 1/4																								
State of Minnesota		3 SW 1/4 of NE 1/4																								
State of Minnesota		4 SE 1/4 of NE 1/4																								
		5																								
State of Minnesota		6 NE 1/4 of NW 1/4																								
State of Minnesota		7 NW 1/4 of NW 1/4																								
State of Minnesota		8 SW 1/4 of NW 1/4																								
State of Minnesota		9 SE 1/4 of NW 1/4																								
		10																								
State of Minnesota		11 NE 1/4 of SW 1/4																								
State of Minnesota		12 NW 1/4 of SW 1/4																								
State of Minnesota		13 SW 1/4 of SW 1/4																								
State of Minnesota		14 SE 1/4 of SW 1/4																								
		15																								
State of Minnesota	<u>(Cont. to Ewald B. Nelson)</u>	16 NE 1/4 of SE 1/4				40																				
State of Minnesota		17 NW 1/4 of SE 1/4																								
State of Minnesota		18 SW 1/4 of SE 1/4																								
	<u>(Cont. to Ewald B. Nelson)</u>	19 SE 1/4 of SE 1/4				40																				
		20																								

Cass County, Minnesota, for Taxes for the Year 1947.

SOLD FOR TAXES	VALUATIONS BY SCHOOL DISTRICTS AS EQUALIZED BY DEPARTMENT OF TAXATION						Tax Including State Homestead	State Tax on Non-Homestead	SPECIAL TAXES	TOTAL TAXES	PAID	WHEN PAID	Number of Receipt	March Settlement 1948	June Settlement 1948	Penalty	November Settlement 1948	Penalty	Collections to First Monday in January 1949	Penalty	Delinquent on First Monday in January 1949	Total Delinquent Tax and Penalty	REMARKS		
	District No.	District No.	District No.	District No.	District No.	District No.																			
	Rate	Rate	Rate	Rate	Rate	Rate																			
	18 1/2																								
	10 12								10 12																
	10 12								10 12																
	20 24								20 24																

139-27

140-27

Assessment Roll and Tax List of Real Property in the

Town of *Trelipe*

Cass County, Minnesota, for Taxes for the Year 1947.

IN WHOSE NAME ASSESSED	TO WHOM TRANSFERRED	DESCRIPTION OF PROPERTY					TRUE AND FULL VALUATIONS				ASSESSED VALUATIONS					FINAL EQUALIZED VALUE
		Subdivision	Sec. of Lot	Town or Block	R.R.	Number of Acres of Land	LAND Exclusive of Structures and Improvements	BUILDINGS and Other Structures	MACHINERY Permanently Attached to Real Estate	TOTAL True and Full Value	RURAL Homestead Up to \$4,000 20%	Over \$4,000 and Non-Homestead 33 1/4%	ALL OTHER Homestead Up to \$4,000 25%	Over \$4,000 and Non-Homestead 40%	MACHINERY Permanently Attached to Real Estate 33 1/4%	
<i>Cleveland Land Co.</i>	<i>State of Minnesota</i>	NE 1/4 of NE 1/4				22 139 27 40										
<i>State of Minnesota</i>		NW 1/4 of NE 1/4														
<i>State of Minnesota</i>		SW 1/4 of NE 1/4														
<i>Cleveland Land Co.</i>		SE 1/4 of NE 1/4				40										
<i>State of Minnesota</i>																
<i>State of Minnesota</i>		NE 1/4 of NW 1/4														
<i>State of Minnesota</i>		NW 1/4 of NW 1/4														
<i>State of Minnesota</i>		SW 1/4 of NW 1/4														
<i>State of Minnesota</i>		SE 1/4 of NW 1/4														
<i>State of Minnesota</i>																
<i>State of Minnesota</i>		NE 1/4 of SW 1/4														
<i>State of Minnesota</i>		NW 1/4 of SW 1/4														
<i>State of Minnesota</i>		SW 1/4 of SW 1/4														
<i>State of Minnesota</i>		SE 1/4 of SW 1/4														
<i>Cleveland Land Co.</i>	<i>State of Minnesota</i>	NE 1/4 of SE 1/4				40										
<i>Moneta Impr. Co.</i>	<i>State of Minnesota</i>	NW 1/4 of SE 1/4				40										
<i>State of Minnesota</i>		SW 1/4 of SE 1/4														
<i>State of Minnesota</i>		SE 1/4 of SE 1/4														
						160										

SOLD FOR TAXES	VALIDATIONS BY SCHOOL DISTRICTS AS EQUALIZED BY DEPARTMENT OF TAXATION						Tax including State Homestead	State Tax on Non-Homestead	SPECIAL TAXES	TOTAL TAXES	PAID	WHEN PAID	Number of Receipt	March Settlement 1948	June Settlement 1948	Penalty 1948	November Settlement 1948	Penalty 1948	Collections to First Monday in January 1949	Penalty 1949	Delinquent on First Monday in January 1949	Total Delinquent Tax and Penalty	REMARKS
	District No. Rate	District No. Rate	District No. Rate	District No. Rate	District No. Rate	District No. Rate																	
1 SOLD FOR TAX	66						1216	26		1242	1										1242		
2											2												
3											3												
4 SOLD FOR TAX	66						1216	26		1242	4										1242		
5											5												
6											6												
7											7												
8											8												
9											9												
10											10												
11											11												
12											12												
13											13												
14											14												
15											15												
16 SOLD FOR TAX	66						1216	26		1242	16										1242		
17											17												
18							1266	26		1292	18												
19											19												
20							4864	104		4968	20												

1st Half Paid JUL 21 1948
2nd Half Paid OCT 30 1948

Assessment Roll and Tax List of Real Property in the Town of *Trelize*

Cass County, Minnesota, for Taxes for the Year 1947.

Table with columns for Assessed Valuations (True and Full, Assessed), Final Equalized Value, Sold For Taxes, Valuations by School Districts, and tax payment details (Total Taxes, Paid, When Paid, Number of Receipt, Settlements, Penalties, Collections, Delinquent, Total Delinquent Tax and Penalty). Includes handwritten entries like '29 139 27' and 'the'.

Assessment Roll and Tax List of Real Property in the

Town of Treliya

Cass County, Minnesota, for Taxes for the Year 1947.

Table with columns for 'IN WHOSE NAME ASSESSED', 'TO WHOM TRANSFERRED', 'DESCRIPTION OF PROPERTY', 'TRUE AND FULL VALUATIONS', 'ASSESSED VALUATIONS', 'VALUATIONS BY SCHOOL DISTRICTS AS EQUALIZED BY DEPARTMENT OF TAXATION', 'SOLD FOR TAXES', 'PAID', 'WHEN PAID', 'Number of Receipts', 'March Settlement 1948', 'June Settlement 1948', 'Penalty 1948', 'November Settlement 1948', 'Penalty 1948', 'Collections to First Monday in January 1949', 'Penalty 1949', 'Delinquent on First Monday in January 1949', 'Total Delinquent Tax and Penalty', and 'REMARKS'. Includes handwritten entries for 'State of Minnesota' and 'Alice M. H. Boylan'.

IN WHOSE NAME ASSESSED	TO WHOM TRANSFERRED	DESCRIPTION OF PROPERTY					TRUE AND FULL VALUATIONS							ASSESSED VALUATIONS											SOLD FOR TAXES	VALUATIONS BY SCHOOL DISTRICTS AS EQUALIZED BY DEPARTMENT OF TAXATION						PAID	WHEN PAID	Number of Receipt	March Settlement 1948	June Settlement 1948	Penalty	November Settlement 1948	Penalty	Collections to First Monday in January 1949	Penalty	Delinquent on First Monday in January 1949	Total Delinquent Tax and Penalty	REMARKS											
		SUBDIVISION	Sec. of Lot	Town or Block	Rng.	Number of Acres of Land	LAND Exclusive of Structures and Improvements	BUILDINGS and Other Structures	MACHINERY Permanently Attached to Real Estate	TOTAL True and Full Value	RURAL		ALL OTHER		MACHINERY Permanently Attached to Real Estate	TOTAL ASSESSED VALUE	Total Assessed Value as Equalized by the Board of Review	FINAL EQUALIZED VALUE	District	District	District	District	District	District		Tax Including State Homestead	State Tax on Non-Homestead	SPECIAL TAXES	TOTAL TAXES	PAID	WHEN PAID														Number of Receipt	March Settlement 1948	June Settlement 1948	Penalty	November Settlement 1948	Penalty	Collections to First Monday in January 1949	Penalty	Delinquent on First Monday in January 1949	Total Delinquent Tax and Penalty	REMARKS
											No.	No.	No.	No.					No.	No.	Rate	Rate	Rate	Rate																															
State of Minnesota		1				NE 1/4 of NE 1/4																																																	

36 139 27

the

140-27

Assessment Roll and Tax List of Real Property in the Town of Felipe

IN WHOSE NAME ASSESSED	TO WHOM TRANSFERRED	DESCRIPTION OF PROPERTY				TRUE AND FULL VALUATIONS				ASSESSED VALUATIONS					FINAL EQUALIZED VALUE		
		SUBDIVISION	Sec. of Lot	Town or Block	Number of Acres of Land	LAND Exclusive of Structures and Improvements	BUILDINGS and Other Structures	MACHINERY Permanently Attached to Real Estate	TOTAL True and Full Value	R U R A L		ALL OTHER		MACHINERY Permanently Attached to Real Estate		TOTAL ASSESSED VALUE	Total Assessed Value as Equalized by the Board of Review
										Acres	100ths	Homestead Up to \$4,000 20%	Over \$4,000 and Non-Homestead 33 1/4 %				
State of Minnesota		1 NE 1/4 of NE 1/4			4.14027												
State of Minnesota		2 NW 1/4 of NE 1/4															
State of Minnesota		3 SW 1/4 of NE 1/4															
State of Minnesota		4 SE 1/4 of NE 1/4															
State of Minnesota		5															
State of Minnesota		6 NE 1/4 of NW 1/4		2													
	Agnes Woodley	7 NW 1/4 of NW 1/4		4											36.99		
	Harold & Leola Blumentritt	8 SW 1/4 of NW 1/4													40		
	State of Minnesota	9 SE 1/4 of NW 1/4															
	Lee & Virgie Garner	10															
State of Minnesota		11 NE 1/4 of SW 1/4															
	Williams Lang	12 NW 1/4 of SW 1/4													40		
State of Minnesota		13 SW 1/4 of SW 1/4															
State of Minnesota		14 SE 1/4 of SW 1/4															
State of Minnesota		15															
State of Minnesota		16 NE 1/4 of SE 1/4															
State of Minnesota		17 NW 1/4 of SE 1/4															
State of Minnesota		18 SW 1/4 of SE 1/4															
State of Minnesota		19 SE 1/4 of SE 1/4															
State of Minnesota		20															

Cass County, Minnesota, for Taxes for the Year 1947.

SOBO FOR TAXES	VALUATIONS BY SCHOOL DISTRICTS AS EQUALIZED BY DEPARTMENT OF TAXATION						Tax including State Homestead	State Tax on Non-Homestead	SPECIAL TAXES	TOTAL TAXES	PAID	WHEN PAID	Number of Receipt	March Settlement 1948	June Settlement 1948	Penalty	November Settlement 1948	Penalty	Collections to First Monday in January 1949	Penalty	Delinquent on First Monday in January 1949	Total Delinquent Tax and Penalty	REMARKS
	District No.	District No.	District No.	District No.	District No.	District No.																	
	Rate	Rate	Rate	Rate	Rate	Rate																	
1																							
2																							
3																							
4																							
5																							
6																							
7								736	736	736													
8								1216	26	1242													
9																							
10																							
11																							
12								1216	26	1242													
13																							
14																							
15																							
16																							
17																							
18																							
19																							
20																							

139-27
140-27

139-27
140-27

Rolan
L. M.
Hal L.
List
Russel
Jerom
Char
Verna
Byron
Lot 4 - Dec 5-140-27

- 1. Roland Edwards 6000
- 2. L. M. Acharz 25.00
- 3. Hal Lansing 25.00
- 4. Great + Olive Bank 50.00
- 5. 25.00
- 6. Russell E. Southworth 250.00
- 7. Jerome Benson 1.00
- 8. Charles LaFroth 50.00
- 9. Ver Ner Gustafson 21.00
- 10. Byron Sherwood 200.00
- Total 12.50 ac

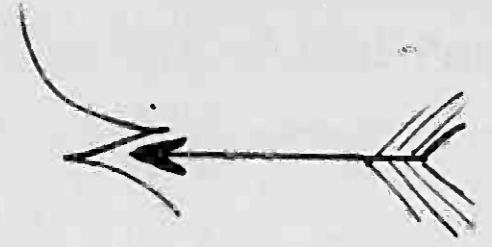
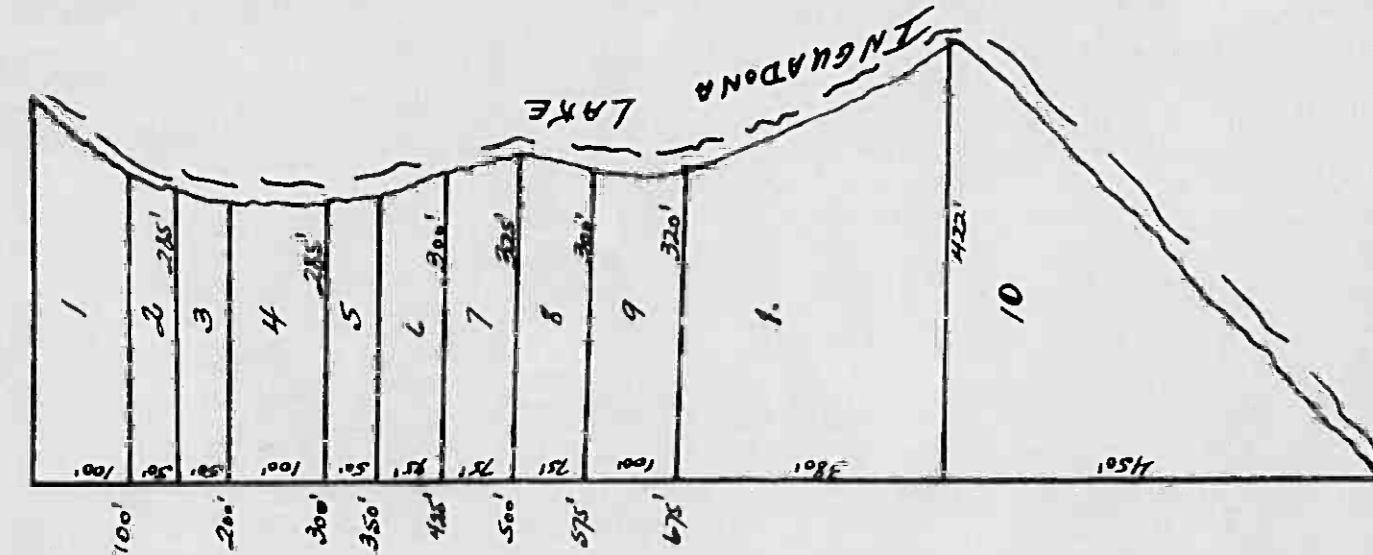

12.50

of Dulips

TOTAL True and Full Value	RURAL				MACHINERY Permanently Attached to Real Estate 33 1/2%	TOTAL ASSESSED VALUE	Total Assessed Value as Equalized by the Board of Review	FINAL EQUALIZED VALUE
	Homestead Up to \$4,000 20%	Over \$4,000 and Non-Homestead 33 1/2%	Homestead Up to \$4,000 25%	Over \$4,000 and Non-Homestead 40%				
Dollars	Dollars	Dollars	Dollars	Dollars	Dollars	Dollars	Dollars	Dollars

17 called

SOLD FOR TAXES	VALUATIONS BY SCHOOL DISTRICTS AS EQUALIZED BY DEPARTMENT OF TAXATION						Tax including State Homestead	State Tax on Non-Homestead	SPECIAL TAXES	TOTAL TAXES	PAID	WHEN PAID	Number of Receipt	March Settlement 1948	June Settlement 1948	Penalty	November Settlement 1948	Penalty	Collections to First Monday in January 1949	Penalty	Delinquent on First Monday in January 1949	Total Delinquent Tax and Penalty	REMARKS	
	District No. Rate	District No. Rate	District No. Rate	District No. Rate	District No. Rate	District No. Rate																		
18	H 8						148			148		2nd Half Paid OCT 30 1948												
35							644	08		340	1st Half Paid JUL 12 1948	9938												
9							166	04		170	PAID IN FULL JUN 22 1948													
10							184	04		188	PAID IN FULL JUN 22 1948	9802												
										100	PAID IN FULL OCT 21 1948	12071						100	04					
							406	08		414	PAID IN FULL APR 21 1948	465												
							56	02		58	PAID IN FULL JUL 12 1948	9935												
										100														
79							1454	32		1486	PAID IN FULL JUL 12 1948	9930												

H 8
125
131

3334
70

3404
70

PAID in full 1/8/48

Journal of Trelige

Cass County, Minnesota, for Taxes for the Year 1947.

IN WHOSE NAME ASSESSED	TO WHOM TRANSFERRED	DESCRIPTION OF PROPERTY	Acres	TRUE AND FULL VALUATIONS				ASSESSED VALUATIONS					TOTAL ASSESSED VALUE	Total Assessed Value as Equivalant by the Board of Review	FINAL EQUALIZED VALUE	VALUATIONS BY SCHOOL DISTRICTS AS EQUALIZED BY DEPARTMENT OF TAXATION						TOTAL TAXES	PAID	WHEN PAID	Number of Receipt	March Settlement 1948	June Settlement 1948	November Settlement 1948	Penalty	Collections to First Monday in January 1949	Penalty	Delinquent on First Monday in January 1949	Total Delinquent Tax and Penalty	REMARKS																					
				LAND	BUILDINGS	MACHINERY	TOTAL	RURAL	ALL OTHER	MACHINERY	TOTAL	District No.				District No.	District No.	District No.	District No.	District No.	District No.														District No.	District No.	District No.	District No.	District No.	District No.	District No.	District No.	District No.	District No.	District No.	District No.	District No.	District No.	District No.	District No.					
		1 NE 1/4 of NE 1/4	5.14027																																																				
		2 NW 1/4 of NE 1/4																																																					
		3 SW 1/4 of NE 1/4																																																					
Rolando Edwards	John + Hal Elansing	4 SE 1/4 of NE 1/4																																																					
L. M. Schatz		5 SE 1/4 of NE 1/4																																																					
Hal Lansing		6 NE 1/4 of NW 1/4																																																					
First + Other Books		7 NW 1/4 of NW 1/4																																																					
Russell E. Southworth		8 SW 1/4 of NW 1/4																																																					
Jerome Benson		9 SE 1/4 of NW 1/4																																																					
Charles L. Froth		10 SE 1/4 of NW 1/4																																																					
Vernon Gustafson		11 NE 1/4 of SW 1/4																																																					
Byron L. Herwood		12 NW 1/4 of SW 1/4																																																					
		13 SW 1/4 of SW 1/4																																																					
		14 SE 1/4 of SW 1/4																																																					
		15																																																					
		16 NE 1/4 of SE 1/4																																																					
		17 NW 1/4 of SE 1/4																																																					
		18 SW 1/4 of SE 1/4																																																					
		19 SE 1/4 of SE 1/4																																																					
		20																																																					

do 1148 Book
do 1148 Book
do 1148 Book

12.50

4 8
1.75
1.51

3334

70

3404

Handwritten notes and signatures in the bottom right corner of the page.

Assessment Roll and Tax List of Real Property in the Town of *Felipe*

IN WHOSE NAME ASSESSED	TO WHOM TRANSFERRED	DESCRIPTION OF PROPERTY				TRUE AND FULL VALUATIONS										FINAL EQUALIZED VALUE											
		SUBDIVISION	Sec. or Lot	Town or Block	Reg.	Number of Acres of Land	No. School District	Indicate Homesteaded Yes or No	Indicate Agricultural Yes or No	LAND Exclusive of Structures and Improvements		BUILDINGS and Other Structures	MACHINERY Permanently Attached to Real Estate	TOTAL True and Full Value	RURAL		ALL OTHER		MACHINERY Permanently Attached to Real Estate	TOTAL ASSESSED VALUE	Total Assessed Values Equalized by the Board of Review						
										Dollars	Dollars	Dollars	Dollars	Dollars	Dollars		Dollars	Dollars	Dollars	Dollars	Dollars	Dollars	Dollars	Dollars	Dollars	Dollars	Dollars
<i>Ralph C. Marrs</i>		1				14 140 27	40	<i>Un</i>																			
<i>A. W. Wieneke</i>		2					40																				
<i>"</i>		3					40																				
<i>John A. & Alice F. Hilmer</i>		4					40																				
<i>"</i>		5																									
<i>A. W. Wieneke</i>		6					40																				
<i>"</i>		7					40																				
State of Minnesota		8																									
<i>A. W. Wieneke</i>		9					40																				
<i>"</i>		10																									
<i>"</i>		11					40																				
State of Minnesota		12																									
State of Minnesota		13																									
<i>A. W. Wieneke</i>		14					40																				
<i>"</i>		15																									
<i>John A. & Alice F. Hilmer</i>		16					40																				
<i>Ernest & Eva Hoppe</i>		17					40																				
<i>"</i>		18					37 20																				
<i>Lena Klein Nelson</i>		19					40																				
<i>"</i>		20																									

Cass County, Minnesota, for Taxes for the Year 1947.

SOLD FOR TAXES	VALIDATIONS BY SCHOOL DISTRICTS AS EQUALIZED BY DEPARTMENT OF TAXATION						Tax including State Homestead	State Tax on Non-Homestead	SPECIAL TAXES	TOTAL TAXES	PAID	WHEN PAID	Number of Receipt	March Settlement 1948	June Settlement 1948	Penalty 1948	November Settlement 1948	Penalty 1948	Collections to First Monday in January 1949	Penalty 1949	Delinquent on First Monday in January 1949	Total Delinquent Tax and Penalty	REMARKS
	District No.	District No.	District No.	District No.	District No.	District No.																	
	Rate	Rate	Rate	Rate	Rate	Rate																	
	Mills	Mills	Mills	Mills	Mills	Mills																	
1	<i>H 40</i>						736		736		<i>2nd Half Paid OCT 30 1948</i>												
2	<i>66</i>						1216	26	1242		<i>1st Half Paid MAY 26 1948</i>												
3	<i>66</i>						1216	26	1242														
4	<i>H 40</i>						736		736		<i>2nd Half Paid OCT 30 1948</i>												
5																							
6	<i>66</i>						1216	26	1242														
7	<i>66</i>						1216	26	1242														
8																							
9	<i>66</i>						1216	26	1242														
10																							
11	<i>66</i>						1216	26	1242														
12																							
13																							
14	<i>66</i>						1216	26	1242														
15																							
16	<i>H 54</i>						994		994		<i>2nd Half Paid OCT 30 1948</i>												
17	<i>H 40</i>						736		736		<i>Balance Paid DEC 10 1948</i>												
18	<i>H 84</i>						1546		1546		<i>Balance Paid DEC 10 1948</i>												
19	<i>H 84</i>						1546		1546		<i>Balance Paid DEC 10 1948</i>												
20	<i>H 342</i>						74806	182	14988		<i>PAID IN FULL MAR 22 1949</i>												

Collect from John Hilmer if he offers to pay

Cass County, Minnesota, for Taxes for the Year 1947.

Assessment Roll and Tax List of Real Property in the Town of *Jules*

Form 4-CD

IN WHOSE NAME ASSESSED	TO WHOM TRANSFERRED	DESCRIPTION OF PROPERTY					No. School District	Indicate Homestead Yes or No	Indicate Agricultural Yes or No	TRUE AND FULL VALUATIONS								FINAL EQUALIZED VALUE Dollars			
		SUBDIVISION	Sec. or Lot	Town or Block	Number of Acres of Land					LAND Exclusive of Structures and Improvements	BUILDINGS and Other Structures	MACHINERY Permanently Attached to Real Estate	TOTAL True and Full Value	R U R A L		ALL OTHER			MACHINERY Permanently Attached to Real Estate	TOTAL ASSESSED VALUE	Total Assessed Value as Equalized by the Board of Review
					Acres	00ths								Homestead Up to \$4,000 20%	Over \$4,000 and Non-Homestead 33 1/3%	Homestead Up to \$4,000 25%	Over \$4,000 and Non-Homestead 40%				
State of Minnesota		1 NE 1/4 of NE 1/4			15 140 27																
State of Minnesota		2 NW 1/4 of NE 1/4																			
State of Minnesota		3 SW 1/4 of NE 1/4																			
State of Minnesota		4 SE 1/4 of NE 1/4																			
State of Minnesota		6 NE 1/4 of NW 1/4																			
State of Minnesota		7 NW 1/4 of NW 1/4																			
State of Minnesota		8 SW 1/4 of NW 1/4																			
State of Minnesota		9 SE 1/4 of NW 1/4																			
State of Minnesota		10																			
<i>The Homestead Co.</i>		11 NE 1/4 of SW 1/4			40																
"		12 NW 1/4 of SW 1/4			40																
"		13 SW 1/4 of SW 1/4			40																
"		14 SE 1/4 of SW 1/4			40																
State of Minnesota		16 NE 1/4 of SE 1/4																			
State of Minnesota		17 NW 1/4 of SE 1/4																			
State of Minnesota		18 SW 1/4 of SE 1/4																			
State of Minnesota		19 SE 1/4 of SE 1/4																			
State of Minnesota		20																			

SOLD FOR TAXES	VALUATIONS BY SCHOOL DISTRICTS AS EQUALIZED BY DEPARTMENT OF TAXATION						Tax including State Homestead	State Tax on Non-Homestead	SPECIAL TAXES	TOTAL TAXES	PAID	WHEN PAID	Number of Receipt	March Settlement 1948	June Settlement 1948	Penalty	November Settlement 1948	Collections to First Monday in January 1949	Penalty	Delinquent on First Monday in January 1949	Total Delinquent Tax and Penalty	REMARKS
	District No.	District No.	District No.	District No.	District No.	District No.																
	Rate	Rate	Rate	Rate	Rate	Rate																
1																						
2																						
3																						
4																						
5																						
6																						
7																						
8																						
9																						
10																						
11										66		42.16	26	12.42								PAID IN FULL FEB 14 1948
12										66		12.16	26	12.42								PAID IN FULL FEB 14 1948
13										66		12.16	26	12.42								PAID IN FULL FEB 14 1948
14										66		12.16	26	12.42								PAID IN FULL FEB 14 1948
15																						
16																						
17																						
18																						
19																						
20												264	48.64	1.04	49.68							

140-27

Assessment Roll and Tax List of Real Property in the Town of Trilipe

FORM 4 CEN. SELLER'S USE COMPANY, MINNEAPOLIS

IN WHOSE NAME ASSESSED	TO WHOM TRANSFERRED	DESCRIPTION OF PROPERTY				No. School District	Indicate Homesteaded Yes or No	Indicate Agricultural Yes or No	TRUE AND FULL VALUATIONS										FINAL EQUALIZED VALUE	
		SUBDIVISION	Sec. or Lot	Town or Block	Number of Acres of Land				LAND Exclusive of Structures and Improvements	BUILDINGS and Other Structures	MACHINERY Permanently Attached to Real Estate	TOTAL True and Full Value	RURAL		ALL OTHER		MACHINERY Permanently Attached to Real Estate	TOTAL ASSESSED VALUE		Total Assessed Value as Equalized by the Board of Review
													Homestead Up to \$4,000 20%	Over \$4,000 and Non-Homestead 33 1/4%	Homestead Up to \$4,000 25%	Over \$4,000 and Non-Homestead 40%				
<i>Frank Warner Robert Mif</i>		1	NE 1/4	NE 1/4	Lot 1	24.14	27	25.50												
		2	NW 1/4	NE 1/4	" 2			23.25												
		3	SW 1/4	of	NE 1/4															
		4	SE 1/4	of	NE 1/4															
		5																		
<i>Frank Warner Robert Mif</i>		6	NE 1/4	of	NW 1/4	3		31.25												
		7	NW 1/4	of	NW 1/4	4		20.50												
<i>Alice P. & George A. Barnes</i>		8	SW 1/4	of	NW 1/4	5 less 2.52 ac.		8.48												
		9	SE 1/4	of	NW 1/4															
<i>Le Roy Ewer</i> State of Minnesota	<i>Township of Trilipe</i>	10	2.52 ac.	of	Lot 5		2.52													
		11	NE 1/4	of	SW 1/4	Lot 7														
		12	NW 1/4	of	SW 1/4	6 Exempt														
		13	SW 1/4	of	SW 1/4	"														
		14	SE 1/4	of	SW 1/4	"														
State of Minnesota		16	NE 1/4	of	SE 1/4	9														
State of Minnesota		17	NW 1/4	of	SE 1/4	8														
<i>Ralph C. Marr</i> State of Minnesota		18	SW 1/4	of	SE 1/4															
		19	SE 1/4	of	SE 1/4			40												
		20																		

151.50

Cass County, Minnesota, for Taxes for the Year 1947.

SOLD FOR TAXES	VALUATIONS BY SCHOOL DISTRICTS AS EQUALIZED BY DEPARTMENT OF TAXATION						Tax including State Homestead	State Tax on Non-Homestead	SPECIAL TAXES	TOTAL TAXES	PAID	WHEN PAID	Number of Receipt	March Settlement 1948	June Settlement 1948	Penalty	November Settlement 1948	Penalty	Collections to First Monday in January 1949	Penalty	Delinquent on First Monday in January 1949	Total Delinquent Tax and Penalty	REMARKS
	District No.	District No.	District No.	District No.	District No.	District No.																	
	Rate	Rate	Rate	Rate	Rate	Rate																	
1	44						8.10	18	8.28	4	PAID IN FULL	NOV 8											
2	44						8.10	18	8.28	2	PAID IN FULL	NOV 18											
3										3													
4										4													
5										5													
6	66						12.16	26	12.42	6	PAID IN FULL	NOV 18											
7	22						4.06	08	4.14	7	PAID IN FULL	NOV 18											
8	446						8.46		8.46	8	PAID IN FULL	JUN 10 1948	1346		846								
9										9													
10	422						4.06		4.06	10	PAID IN FULL	OCT 1 1948	1159		203								
11										11													
12										12													
13										13													
14										14													
15										15													
16										16													
17										17													
18	SOLD FOR TAXES	66					12.16	26	12.42	18													
19										19													
20		68					57.10	96	58.06	20													

3312 265

1242

Cass County, Minnesota, for Taxes for the Year 1947.

Assessment Roll and Tax List of Real Property in the Town of Irelife

Form 1-CD, Miller-Guyton Company, Minneapolis

IN WHOSE NAME ASSESSED	TO WHOM TRANSFERRED	DESCRIPTION OF PROPERTY		TRUE AND FULL VALUATIONS											FINAL EQUALIZED VALUE Dollars		
				ASSESSED VALUATIONS				RURAL			ALL OTHER			MACHINERY		TOTAL ASSESSED VALUE	Total Assessed Value as Equalized by the Board of Review Dollars
				LAND Exclusive of Structures and Improvements Dollars	BUILDINGS and Other Structures Dollars	MACHINERY Permanently Attached to Real Estate Dollars	TOTAL True and Full Value Dollars	Homestead	Over \$1,000 and Non-Homestead	Homestead	Over \$4,000 and Non-Homestead	Permanently Attached to Real Estate	TOTAL ASSESSED VALUE Dollars				
								Up to \$4,000 20%	33 1/4%	Up to \$1,000 25%	40%	33 1/4%					
Acres	100ths	No. School District	Indicate Homestead by H or No	Indicate Agricultural Use by A or No													
State of Minnesota		1 NE 1/4 of NE 1/4	36 1/2 27	Un													
State of Minnesota		2 NW 1/4 of NE 1/4															
State of Minnesota		3 SW 1/4 of NE 1/4															
State of Minnesota		4 SE 1/4 of NE 1/4															
	Albert Zumbrennen	6 NE 1/4 of NW 1/4	40														
	"	7 NW 1/4 of NW 1/4	40														
State of Minnesota		8 SW 1/4 of NW 1/4															
State of Minnesota		9 SE 1/4 of NW 1/4															
State of Minnesota		11 NW 1/4 of SW 1/4															
State of Minnesota		12 NW 1/4 of SW 1/4															
State of Minnesota		13 SW 1/4 of SW 1/4															
State of Minnesota		14 SE 1/4 of SW 1/4															
State of Minnesota		16 NE 1/4 of SE 1/4															
State of Minnesota		17 NW 1/4 of SE 1/4															
		18 SW 1/4 of SE 1/4															
		19 SE 1/4 of SE 1/4															
		20															

80
Grand Total 13,390.80

SOLD FOR TAXES	VALIDATIONS BY SCHOOL DISTRICTS AS EQUALIZED BY DEPARTMENT OF TAXATION						Tax Including State Homestead Mills	State Tax on Non-Homestead Mills	SPECIAL TAXES	TOTAL TAXES	PAID	WHEN PAID Month Day Year	Number of Receipts	March Settlement 1948	June Settlement 1948	Penalty	November Settlement 1948	Penalty	Collections to First Monday in January 1949	Penalty	Delinquent on First Monday in January 1949	Total Delinquent Tax and Penalty	REMARKS
	District No.	District No.	District No.	District No.	District No.	District No.																	
	Rate	Rate	Rate	Rate	Rate	Rate																	
	Mills	Mills	Mills	Mills	Mills	Mills																	
SOLD FOR TAXES	11						736		736														
SOLD FOR TAXES	11						736		736														

Balance Paid SEP 30 1948
JUL 19 1948
Balance Paid JUL 19 1948

Red line 672

