

Assessment & Tax List - 1961  
Thunder Lake





















Assessment Roll and Tax List of Real Property in the Town of Thunder Lake

\* Indicate Type of Property: R-Residential, C-Commercial, I-Industrial, U-Utility, F-Farm, L-Lakeshore, T-Timber, M-Mineral

Cass County, Minnesota, for Taxes for the Year 1961.

Table with columns: IN WHOSE NAME ASSESSED, DESCRIPTION OF PROPERTY, TRUE AND FULL VALUATIONS, ASSESSED VALUATIONS, VALUATIONS BY SCHOOL DISTRICTS AS EQUALIZED BY DEPARTMENT OF TAXATION, TAXES, PAID, WHEN PAID, Number of Receipt, March Settlement, June Settlement, Penalty, November Settlement, Penalty, Collections to First Monday in January 1963, Delinquent on First Monday in January 1963, Total Delinquent Tax and Penalty, REMARKS.

(CONT ON NEXT PAGE)

12062























Assessment Roll and Tax List of Real Property in the Town of South Thunder Lake

\* Indicate Type of Property: R-Residential, C-Commercial, I-Industrial, U-Utility, F-Farm, L-Lakeshore, T-Timber, M-Mineral

Table with columns: IN WHOSE NAME ASSESSED, DESCRIPTION OF PROPERTY, TREE AND FULL VALUATIONS, ASSESSED VALUATIONS, and FINAL EQUALIZED VALUE. Includes handwritten entries for Mrs. Hugo Eisenach, Irvin & Eleonora Becker, Cecil A. Bluhm, etc.

Cass County, Minnesota, for Taxes for the Year 1961.

Table with columns: VALUATIONS BY SCHOOL DISTRICTS AS EQUALIZED BY DEPARTMENT OF TAXATION, TAX INCLUDING STATE HOMESTEAD, SPECIAL TAXES, TOTAL TAXES, PAID, WHEN PAID, Number of Receipt, March Settlement, June Settlement, November Settlement, Collections to First Monday in January, Delinquent on First Monday in January, Total Delinquent Tax and Penalty, and REMARKS. Includes handwritten entries for school districts #113, #46, #70, #106, #52, #60, #31, #32, #83, #437, #48.

Vertical text on the right edge of the page: Cooley Trail, Oak Park, Oak Lawn, Birchwood, Del Ray Point, List of P. J. G.







Assessment Roll and Tax List of Real Property in the Town of Thunder Lake

\* Indicate Type of Property: R-Residential, C-Commercial, I-Industrial, U-Utility, F-Farm, L-Lakeshore, T-Timber, M-Mineral

IN WHOSE NAME ASSESSED	DESCRIPTION OF PROPERTY				No. School District	Indicate House Stand Yes or No	Agricultural Use Yes or No	Indicate 2 1/2% of Property	TRUE AND FULL VALUATIONS										TOTAL ASSESSED VALUE	70% Assessed Value as Equalized by the Board of Review	FINAL EQUALIZED VALUE
	SUBDIVISION	Sec. of Land	Town or Block	No. of Acres					LAND EXCLUSIVE OF STRUCTURES AND IMPROVEMENTS				ASSESSED VALUATIONS								
									DOLLARS	DOLLARS	DOLLARS	DOLLARS	Homestead Up to \$1,000 20%	Over \$1,000 and Non-Homestead 33 1/3%	Timber Land Class 2c 20%	Homestead Up to \$4,000 25%	Over \$4,000 and Non-Homestead 40%	WAGNER Permanent Attached to Real Estate 33 1/3%			
✓ Eleanor S. Blukem	TRACT "A" OF GOVT LOT 2+3 6	140.26	17	118	No	Yes	L														
✓ Emma A. + James V. Morse	TRACT "G" OF GOVT LOT 2+3	.14	No	"	"	"	"														
✓ Emma A. Morse	TRACT "7" OF GOVT LOT 2+3	.14	No	"	"	"	"														
✓ Arthur P. Blukem	TRACT "G" OF GOVT LOT 2+3	.14	No	"	"	"	"														
✓ Howard C. Blukem	TRACT "A" OF GOVT LOT 2+3	.14	No	No	"	"	"														
6	N E 1/4 N W 1/4																				
7	N W 1/4 N W 1/4																				
8	S W 1/4 N W 1/4																				
9	S E 1/4 N W 1/4																				
10																					
11	N E 1/4 S W 1/4																				
12	N W 1/4 S W 1/4																				
13	S W 1/4 S W 1/4																				
14	S E 1/4 S W 1/4																				
15																					
16	N E 1/4 S E 1/4																				
17	N W 1/4 S E 1/4																				
18	S W 1/4 S E 1/4																				
19	S E 1/4 S E 1/4																				
20																					

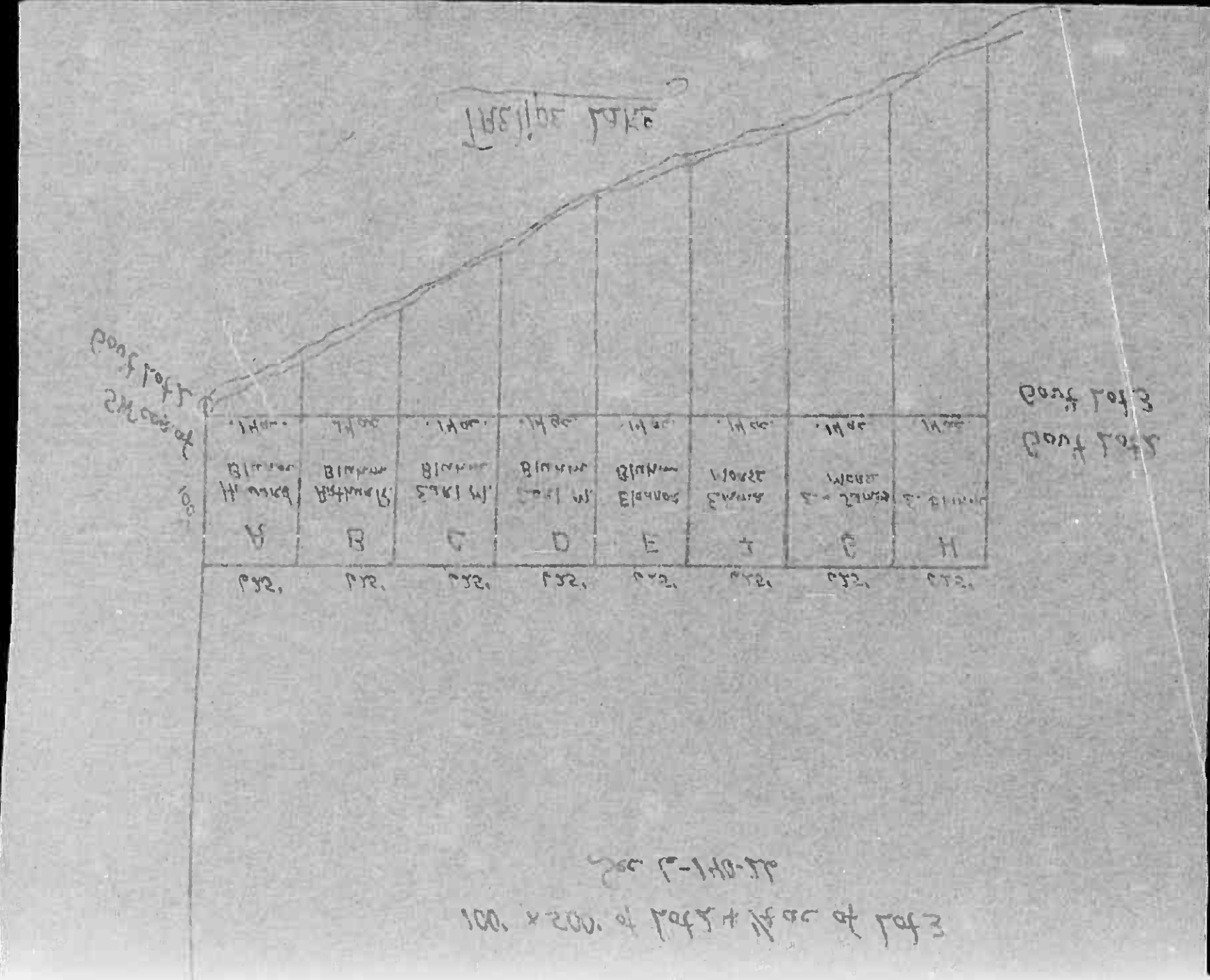

Cass County, Minnesota, for Taxes for the Year 1961.

SOLD FOR TAXES	VALUATIONS BY SCHOOL DISTRICTS AS EQUALIZED BY DEPARTMENT OF TAXATION						Tax Including State Homestead	State Tax on Non-Homestead	SPECIAL TAXES	SPECIAL TAXES	TOTAL TAXES	PAID	WHEN PAID	Number of Receipt	March Settlement 1961	June Settlement 1961	November Settlement 1961	Penalty	Collections to First Monday in January 1963	Penalty	Delinquent on First Monday in January 1963	Total Delinquent Tax and Penalty	REMARKS		
	District No.	District No.	District No.	District No.	District No.	District No.																			
	Rate	Rate	Rate	Rate	Rate	Rate																			
1							246	08			254	PAID IN FULL	MAY 8 1962	8633									11935		
2							246	08			254	PAID IN FULL	MAY 3 1962	14898		15874							11932		
3							1282	48			1330	PAID IN FULL	MAY 3 1962	8655		254							11921		
4							246	08			254	PAID IN FULL	MAY 9 1962										11921		
5							246	08			254	PAID IN FULL	MAY 15 1962	8960		254							11921		
6																									
7																									
8																									
9																									
10																									
11																									
12																									
13																									
14																									
15																									
16																									
17																									
18																									
19																									
20																									

Cass County, Minnesota, for Taxes for the Year 1961. Thunder Lake, Minnesota, for Taxes for the Year 1961.























Assessment Roll and Tax List of Real Property in the town of Thunder Lake

Cass County, Minnesota, for Taxes for the Year 1961.

\* Indicate Type of Property: R-Residential, C-Commercial, I-Industrial, U-Utility, F-Farm, L-Lakeshore, T-Timber, M-Mineral

Table with columns: IN WHOSE NAME ASSESSED, DESCRIPTION OF PROPERTY, ASSESSED VALUATIONS (TRUE AND FULL VALUATIONS), VALUATIONS BY SCHOOL DISTRICTS AS EQUALIZED BY DEPARTMENT OF TAXATION, TAX INCLUDING STATE HOMESTEAD, SPECIAL TAXES, PAID, WHEN PAID, Number of Receipt, March Settlement 1962, June Settlement 1962, Penalty, November Settlement 1962, Collections to First Monday in January 1963, Delinquent on First Monday in January 1963, Total Delinquent Tax and Penalty, REMARKS.

Clifford H. & Hagley C. Thomas  
Lawrence J. & Loma Lynch  
Louis L. Pintok

State of Minnesota  
Lawrence Lynch  
John D. & Christine M. Brigham  
Frank M. Steiner, Trustee

Raymond M. & Elizabeth C. Hammerel  
That part of Gov't Lot 3, Sec. 10-140-26, desc. as follows: Starting at a pt. on the E. shore of Big Thunder Lake where St. Hy #6 leaves said lake, going in a NW'ly direction, thence along the lake shore in a NW'ly direction a distance of 100', thence N. parallel with the W. line of said Lot 3, to said Hy. #6, thence S'ly along said Hy. #6, to place of beginning.

Raymond M. & Elizabeth C. Hammerel  
Gov't Lot 3, desc. as fol: Beg. on the lake shore of Big Thunder Lake, 100' NW of the pt. where St. Hy #6 leaves the lake as the pt. of beg., thence NW'ly along the shore of said Big Thunder Lake to the W. line of said Lot 3, Approx. 170' thence N. along the W. line of said Lot 3 to R/W of St. Hy #6, thence S. and S'ly along the W. side of said new St. Hy #6 to the NW cor. of Theodore Hanson tract, thence S'ly along W. side of Theo. Hanson tract to pt. of beginning

(CONT ON NEXT PAGE)

140.40 Reduction Val  
59.54 abated  
140.40 assessed



Assessment Roll and Tax List of Real Property in the Town of Thunder Lake

Cass County, Minnesota, for Taxes for the Year 1961.

\* Indicate Type of Property: R-Residential, C-Commercial, I-Industrial, U-Utility, F-Farm, L-Lakeshore, T-Timber, M-Mineral

Table with columns: IN WHOSE NAME ASSESSED, DESCRIPTION OF PROPERTY, ASSESSED VALUATIONS (RURAL, ALL OTHER, MACHINERY, Seasonal and Recreational Cabins, TOTAL ASSESSED VALUE), VALUATIONS BY SCHOOL DISTRICTS, TAX INCLUDING STATE HOMESTEAD, SPECIAL TAXES, TOTAL TAXES, PAID, WHEN PAID, Number of Receipt, March Settlement 1962, June Settlement 1962, Penalty, November Settlement 1962, Collections to First Monday in January 1963, Delinquent on First Monday in January 1963, Total Delinquent Tax and Penalty, REMARKS.

Edward G. & Jennie J. Adams  
J. C. Huffman & H. N. Bloom  
George & Helen Lowe

Ambrose Schibilla  
Oscar M. L. & Luella A. Olson  
John C. & Louise E. Loring  
Edwin J. & Reak M. Miller

Bennett & Mary Kruse  
James J. McBride

Cooley Trail  
Oak Park  
Del Ray Point  
Plat of P. F. G.



















Assessment Roll and Tax List of Real Property in the Town of Thunder Lake

\* Indicate Type of Property: R-Residential, C-Commercial, I-Industrial, U-Utility, F-Farm, L-Lakeshore, T-Timber, M-Mineral

Form SCD MILLER-DAVIS CO. MINNEAPOLIS

Table with columns: IN WHOSE NAME ASSESSED, DESCRIPTION OF PROPERTY, TRUE AND FULL VALUATIONS (RURAL, ALL OTHER, MACHINERY, etc.), ASSESSED VALUATIONS, FINAL EQUALIZED VALUE, and various tax-related fields.

(CONT. ON NEXT PAGE)

266 20

Cass County, Minnesota, for Taxes for the Year 1961.

Table with columns: VALUATIONS BY SCHOOL DISTRICTS AN EQUALIZED BY DEPARTMENT OF TAXATION, Tax including State Homestead, State Tax on Non-Homestead, SPECIAL TAXES, TOTAL TAXES, PAID, WHEN PAID, Number of Receipt, March Settlement, June Settlement, Penalty, November Settlement, Penalty, Collections to First Monday in January 1963, Delinquent on First Monday in January 1963, Total Delinquent Tax and Penalty, and REMARKS.

Color Trail, Oak Park, Oak Lawn, Birch, Del Ray Point, Plat of P. J. G.



Assessment Roll and Tax List of Real Property in the Town of Thunder Lake

\* Indicate Type of Property: R-Residential, C-Commercial, I-Industrial, U-Utility, F-Farm, L-Lakeshore, T-Timber, M-Mineral

Form 300-MILLER-DAVIS CO., MINNEAPOLIS

Table with columns: IN WHOSE NAME ASSESSED, DESCRIPTION OF PROPERTY, TRUE AND FULL VALUATIONS, ANSESSED VALUATIONS, FINAL EQUALIZED VALUE.

Cass County, Minnesota, for Taxes for the Year 1961.

Table with columns: SOLD FOR TAXES, VALUATIONS BY SCHOOL DISTRICTS AS EQUALIZED BY DEPARTMENT OF TAXATION, Tax Including State Homestead, SPECIAL TAXES, TOTAL TAXES, PAID, WHEN PAID, Number of Receipt, March Settlement 1962, June Settlement 1962, November Settlement 1962, Collections to First Monday in January 1963, Delinquent on First Monday in January 1963, Total Delinquent Tax and Penalty, REMARKS.

Cooley Trail, Oak Park, Oak Lawn, Birchwood, Del Ray Point, Flat of P. F. G.







































Assessment Roll and Tax List of Real Property in the

Source of Thunder Lake  
\* Indicate Type of Property: R-Residential, C-Commercial, I-Industrial, U-Utility, F-Farm, L-Lakeshore, T-Timber, M-Mineral

Table with columns: IN WHOSE NAME ASSESSED, DESCRIPTION OF PROPERTY, TRUE AND FULL VALUATIONS, ASSESSED VALUATIONS, FINAL EQUALIZED VALUE. Includes handwritten entries for 'Jana Minisig Co.' and '160'.

Cass County, Minnesota, for Taxes for the Year 1961.

Table with columns: VALUATIONS BY SCHOOL DISTRICTS AS EQUALIZED BY DEPARTMENT OF TAXATION, Tax Including State Homestead, SPECIAL TAXES, TOTAL TAXES, PAID, WHEN PAID, Number of Receipt, March Settlement, June Settlement, November Settlement, Delinquent on First Monday in January, Total Delinquent Tax and Penalty, REMARKS. Includes handwritten entries for '107', '2640', '98', '2738', '10560', '392', '10962', '5476', '5076'.

Cooley Trail  
Oak Park  
Reaches  
Oak Park  
Oak Lawn  
Beach  
Birchwood  
Del Ray Point  
Flat of P. J. G.











Assessment Roll and Tax List of Real Property in the Town of Thunder Lake

Cass County, Minnesota, for Taxes for the Year 1961.

Table with columns: IN WHOSE NAME ASSESSED, DESCRIPTION OF PROPERTY, TRUE AND FULL VALUATIONS, ASSESSED VALUATIONS, VALUATIONS BY SCHOOL DISTRICTS AS EQUALIZED BY DEPARTMENT OF TAXATION, TAX INCLUDING STATE HOMESTEAD, SPECIAL TAXES, TOTAL TAXES, PAID, WHEN PAID, Number of Receipt, March Settlement 1962, June Settlement 1962, November Settlement 1962, Collections to First Monday in January 1963, Delinquent on First Monday in January 1963, Total Delinquent Tax and Penalty, REMARKS.

(CONT ON NEXT PAGE)

Cooley Trail, Oak Park, Oak Lawn, Birchwood, Del Ray Point, Plat of P. P. G.























Assessment Roll and Tax List of Real Property in the Town of Thunder Lake

\* Indicate Type of Property: R-Residential, C-Commercial, I-Industrial, U-Utility, F-Farm, L-Lakeshore, T-Timber, M-Mineral

Table with columns: IN WHOSE NAME ASSESSED, DESCRIPTION OF PROPERTY, TRUE AND FULL VALUATIONS, ASSESSED VALUATIONS, and FINAL EQUALIZED VALUE.

Cass County, Minnesota, for Taxes for the Year 1961.

Table with columns: VALUATIONS BY SCHOOL DISTRICTS AS EQUALIZED BY DEPARTMENT OF TAXATION, TAX INCLUDING STATE HOMESTEAD, SPECIAL TAXES, TOTAL TAXES, PAID, WHEN PAID, Number of Receipt, March Settlement, June Settlement, November Settlement, Collections to First Monday in January 1963, Delinquent on First Monday in January 1963, Total Delinquent Tax and Penalty, REMARKS.

Colony Well, Oak Park, Oak Lawn, Birchwood, Del Ray Point, Plat of P. 1. 6







Assessment Roll and Tax List of Real Property in the Town of Hundred Lake

\* Indicate Type of Property: R-Residential, C-Commercial, I-Industrial, U-Utility, F-Farm, L-Lakeshore, T-Timber, M-Mineral

Table with columns: IN WHOSE NAME ASSESSED, DESCRIPTION OF PROPERTY, TRUE AND FULL VALUATIONS, ASSESSED VALUATIONS, and FINAL EQUALIZED VALUE. Includes handwritten entries for various property owners like Clarence Johannessen and Franklin M. Friedrich.

Cass County, Minnesota, for Taxes for the Year 1961.

Table with columns: VALUATIONS BY SCHOOL DISTRICTS AS EQUALIZED BY DEPARTMENT OF TAXATION, TAXES, PAID, WHEN PAID, and REMARKS. Includes handwritten entries for tax amounts and payment dates.

Vertical text on the right edge of the page: Coley Trail, Oak Park, Oak Lawn, Birchwood, Dal Ray Point, Plat of P. F. 6











Assessment Roll and Tax List of Real Property in the \_\_\_\_\_ of \_\_\_\_\_,  
 \* Indicate Type of Property: R-Residential, C-Commercial, I-Industrial, U-Utility, F-Farm, L-Lakeshore, T-Timber, M-Mineral

TWIN-SCD-MILLER-DAVIS CO.-MINNEAPOLIS

IN WHOSE NAME ASSESSED	DESCRIPTION OF PROPERTY				No. School District	Indicate Homestead Yes or No	Agricultural Yes or No	Indicate Type of Property	TRUE AND FULL VALUATIONS											FINAL EQUALIZED VALUE			
	SUBDIVISION	Sec. or Lot	Town or Block	Number of Acres of Land Reg. Acres 100ths					LAND Structures and Improvements	BUILDINGS and Other Structures	MACHINERY Permanently Attached to Real Estate	TOTAL True and Full Value	RURAL			ALL OTHER					TOTAL ASSESSED VALUE	Total Assessed Value as Equalized by the Board of Review	
													Homestead Up to \$4,000 20%	Over \$4,000 and Non-Homestead 33 1/2%	Timber Land Class 3e 20%	Homestead Up to \$4,000 25%	Over \$4,000 and Non-Homestead 40%	MACHINERY Permanently Attached to Real Estate 33 1/2%	Seasonal and Recreational Cabins 33 1/2%				
									Dollars	Dollars	Dollars	Dollars	Dollars	Dollars	Dollars	Dollars	Dollars	Dollars	Dollars	Dollars	Dollars	Dollars	
1	N E W of N E W																						
2	N W W of N E W																						
3	S W W of N E W																						
4	S E W of N E W																						
5																							
6	N E W of N W W																						
7	N W W of N W W																						
8	S W W of N W W																						
9	S E W of N W W																						
10																							
11	N E W of S W W																						
12	N W W of S W W																						
13	S W W of S W W																						
14	S E W of S W W																						
15																							
16	N E W of S E W																						
17	N W W of S E W																						
18	S W W of S E W																						
19	S E W of S E W																						
20																							

Cass County, Minnesota, for Taxes for the Year 1961.

SOLD FOR TAXES	VALUATIONS BY SCHOOL DISTRICTS AS EQUALIZED BY DEPARTMENT OF TAXATION						Tax Including State Homestead	State Tax on Non-Homestead	SPECIAL TAXES	SPECIAL TAXES	TOTAL TAXES	PAID	WHEN PAID	Number of Receipt	March Settlement 1962	June Settlement 1962	Penalty	November Settlement 1962	Penalty	Collections to First Monday in January 1963	Penalty	Delinquent on First Monday in January 1963	Total Delinquent Tax and Penalty	REMARKS
	District No.	District No.	District No.	District No.	District No.	District No.																		
	Rate	Rate	Rate	Rate	Rate	Rate																		
1																								
2																								
3																								
4																								
5																								
6																								
7																								
8																								
9																								
10																								
11																								
12																								
13																								
14																								
15																								
16																								
17																								
18																								
19																								
20																								

Cooley Trail  
 Oak Park  
 Beeches  
 Oak Park  
 Oak Lawn  
 Birchwood  
 Del Ray Point  
 Plat of P. F. G.















Assessment Roll and Tax List of Real Property in the Town of Shawnee Lake

\* Indicate Type of Property: R-Residential, C-Commercial, I-Industrial, U-Utility, F-Farm, L-Lakeshore, T-Timber, M-Mineral

Cass County, Minnesota, for Taxes for the Year 1961.

Cooley Trail Duck Pass  
Oak Park Beaches

IN WHOSE NAME ASSESSED	DESCRIPTION OF PROPERTY				No. School District	Indicate Home-stead Yes or No	Agricultural Use Yes or No	Indicate Type of Property	TRUE AND FULL VALUATIONS				ASSESSED VALUATIONS						FINAL EQUALIZED VALUE		
	SUBDIVISION	Sec. or Lot	Town or Block	Number of Acres of Land					LAND Exclusive of Structures and Improvements	BUILDINGS and Other Structures	MACHINERY Permanently Attached to Real Estate	TOTAL True and Full Value	RURAL		ALL OTHER		MACHINERY Permanently Attached to Real Estate	Seasonal and Recreational Cabins		TOTAL ASSESSED VALUE	Total Assessed Value as Equalized by the Board of Review
													Acres 100ths	Homestead Up to \$4,000 20%	Over \$4,000 and Non-Homestead 33 1/3%	Timber Land Class 3e 20%					
Clara P. Romain	Oak Park Beaches	N 1/2 07	20	1	118	YES	NO	L													
Clara Romain			21			YES	"	"													
Edwina S. Romain & Charlotte Romain			22			NO	YES	R													
Dickney Olson			23			NO	NO	L													
"			24			NO	"	"													
R. G. & Hattie M. Brown			25			YES	NO	L													
"			26			YES	"	"													
"			27			YES	"	"													
"			28			YES	"	"													
Raymond C. & Robert N. Campbell			29			NO	YES	"													
"			30			NO	NO	L													
"			31			NO	YES	"													
Edwin P. Rickhardt, Roy C. Takikson, & Boyd M. Fredens			32			NO	NO	"													
"			33			NO	"	"													
Ellen L. Elliott			34			NO	"	"													
"			35			NO	NO	L													
"			36			NO	"	"													
State of Minnesota		OUTLOT B																			

SOLD FOR TAXES	VALUATIONS BY SCHOOL DISTRICTS AS EQUALIZED BY DEPARTMENT OF TAXATION						Tax Including State Homestead	State Tax on Non-Homestead	SPECIAL TAXES	SPECIAL TAXES	TOTAL TAXES	PAID	WHEN PAID	Number of Receipt	March Settlement 1962	June Settlement 1962	Penalty	November Settlement 1962	Penalty	Collections to First Monday in January 1963	Penalty	Delinquent on First Monday in January 1963	Total Delinquent Tax and Penalty	REMARKS
	District No.	District No.	District No.	District No.	District No.	District No.																		
	Rate	Rate	Rate	Rate	Rate	Rate																		
	118	118	118	118	118	118	9.12																	
1							162			162		PAID IN FULL	MAY 9 1962	8674	162								12092	
2							1304			1304		PAID IN FULL	MAY 9 1962		1304								"	
3	95						2344	86		2430		PAID IN FULL	MAY 31 1962		2430								12036	
4							272	08		280		PAID IN FULL	MAY 31 1962	14885	280								"	
5							272	08		280		PAID IN FULL	MAY 31 1962		280								"	
6							162			162		PAID IN FULL	MAY 24 1962										12089	
7							162			162		PAID IN FULL	MAY 24 1962										"	
8							4754			4754		PAID IN FULL	MAY 24 1962	12294	5240								"	
9							162			162		PAID IN FULL	MAY 24 1962										"	
10	51						1258	46		1304		PAID IN FULL	MAY 31 1962										12055	
11							272	08		280		PAID IN FULL	MAY 31 1962	14840	1838								"	
12	10						246	08		254		PAID IN FULL	MAY 31 1962										"	
13							272	10		282		PAID IN FULL	MAY 9 1962	8671	282								12088	
14							4890	164		5054		PAID IN FULL	MAY 9 1962		5054								"	
15							272	10		282		PAID IN FULL	MAY 31 1962										12090	
16							272	10		282		PAID IN FULL	MAY 2 1962	14933	846								"	
17							272	10		282		PAID IN FULL	MAY 31 1962										"	
18																								
19																								
20							13509	368		17176					17716									

1st Adm. Birchwood Terrace  
2nd Oak Lawn and Beach  
3rd Oak Lawn and Beach  
4th Oak Lawn and Beach  
5th Oak Lawn and Beach  
6th Oak Lawn and Beach  
7th Oak Lawn and Beach  
8th Oak Lawn and Beach  
9th Oak Lawn and Beach  
10th Oak Lawn and Beach  
11th Oak Lawn and Beach  
12th Oak Lawn and Beach  
13th Oak Lawn and Beach  
14th Oak Lawn and Beach  
15th Oak Lawn and Beach  
16th Oak Lawn and Beach  
17th Oak Lawn and Beach  
18th Oak Lawn and Beach  
19th Oak Lawn and Beach  
20th Oak Lawn and Beach



































Assessment Roll and Tax List of Real Property in the Town of Thunder Lake

\* Indicate Type of Property: R-Residential, C-Commercial, I-Industrial, U-Utility, F-Farm, L-Lakeshore, T-Timber, M-Mineral

Form 50 MILLER-DAVIS CO. MINNEAPOLIS

Coolly Trail Duck Pass, Oak Park Beaches, Oak Lawn Beach, Birchwood Terrace, Del Ray Point

Table with columns: IN WHOSE NAME ASSESSED, SUBDIVISION, Description of Property, True and Full Valuations (Rural, All Other, Machinery, Seasonal and Recreational Cabins), Total Assessed Value, Final Equalized Value.

Cass County, Minnesota, for Taxes for the Year 1961.

Table with columns: SOLD FOR TAXES, VALUATIONS BY SCHOOL DISTRICTS AS EQUALIZED BY DEPARTMENT OF TAXATION, Tax Including State Homestead, State Tax on Non-Homestead, SPECIAL TAXES, TOTAL TAXES, PAID, WHEN PAID, Number of Receipt, March Settlement, June Settlement, November Settlement, Collections to First Monday in January, Delinquent on First Monday in January, Total Delinquent Tax and Penalty, REMARKS.

1st Add'n, Birchwood Terrace, Bay Shores, Peters, Sand Beach, Felipe, Plat of P. 1. 6



























