

ASSESSMENT & TAX LIST - 1956

Thunder Lake

INDEX TO SECTIONS

SECTION PAGE

Sec. 1.....	
" 2.....	
" 3.....	
" 4.....	
" 5.....	
" 6.....	
" 7.....	
" 8.....	
" 9.....	
" 10.....	
" 11.....	
" 12.....	
" 13.....	
" 14.....	
" 15.....	
" 16.....	
" 17.....	
" 18.....	
" 19.....	
" 20.....	
" 21.....	
" 22.....	
" 23.....	
" 24.....	
" 25.....	
" 26.....	
" 27.....	
" 28.....	
" 29.....	
" 30.....	
" 31.....	
" 32.....	
" 33.....	
" 34.....	
" 35.....	
" 36.....	

For Convenience of Auditor in Showing Boundaries of School Districts

Township No. 140 Range No. 26 Mer. P. M.

*All Thunder Lake Sup.
joined sch. Dist # C 1
8-1951*

Returns Showing Grain Received in or Handled by Elevators, Warehouses and Mills in the _____ of _____ in the County of _____ for the Year Ending May 1, 1956.

NAMES OF OWNERS	ADDRESS	Bushels of Wheat	Bushels of Soy Beans	Bushels of Flax	Total No. of Bushels of Wheat, Soy Beans and Flax	★ Tax of 1/8 Mill per Bushel		Bushels of Corn	Bushels of Barley	Bushels of Rye	Bushels of Oats	Bushels of Buckwheat	Bushels of all Other Grains	Total No. Bushels Corn, Barley, Rye, Oats, Buckwheat and all Other Grains	★ Tax of 1/8 Mill Per Bushel		★ Total Tax		REMARKS		
						Dollars	Cts.								Dollars	Cts.	Dollars	Cts.			

Note ★ Assessors will not fill these Columns

Real Estate
Dooler Trail
Duck Pass
Mills
Oak Park Beaches
Lamm Beach
Birchwood Terrace
F. J. Ray Po

NAMES OF OWNERS	DESCRIPTION				No. of Acres	FOR WHAT PURPOSE USED	TRUE AND FULL VALUATIONS				ASSESSED VALUATIONS		REMARKS
	SUBDIVISION	Sec. or Lot	Town or Block	Range			LAND Exclusive of Structures and Improvements	BUILDINGS and Other Structures	MACHINERY Permanently Attached to Real Estate	TOTAL True and Full Value	Rural Including Machinery 33 1/3%	All Other 40%	

SUMMARY OF TAX COLLECTION

Original Levy	- - - -	=	\$ 11,069.64
Additions	- - - -	=	\$
			\$ 11,069.64
Abate ments	- - - -	=	\$ 573.12
			\$ 10,496.52
COLLECTIONS			
March Settlement	- - - -	=	\$ 1624.59
June Settlement	- - - -	=	\$ 5698.53
November Settlement	- - - -	=	\$ 2496.11
January Settlement	- - - -	=	\$ 189.54
			\$ 10,008.77
Over Collected	- - - -	=	\$ 43.32
Under Collected	- - - -	=	\$ 04
Delinquent	- - - -	=	\$ 830.93
			\$ 787.75
Total	- - - -	=	\$ 10,796.52

Real Estate
 JOEL FEIL
 JACK JESS
 Oak Park Beaches & Lamm Beach
 Birchwood Terrace
 F. & Del Ray Point E

Assessor's Return

NAMES OF OWNERS

TABULAR SCHEDULE OF VALUATIONS,

LEVIED IN THE Town OF Thunder Lake

School District No.	VALUATION BY SCHOOL DISTRICTS				RATE OF STATE TAXES	RATE OF COUNTY TAXES					RATE OF TOWN TAXES					RATE OF							
	Agri-cultural Lands	Non-Agri-cultural Lands	Personal Property	Total Value of all Property except Money and Credits		Total Rate of State Tax	Rev.	R. & B.	Wel-fare	Bonds and Int.	Total Rate of County Tax	Rev.	R. & B.	Drag Tax	State Loan	Total Rate of Town Tax	Local	Spe-cial	State Loan	Defi-cien-cy	Tui-tion	Trans-porta-tion	C.O.
	Dollars	Dollars	Dollars	Dollars	Mills	Mills	Mills	Mills	Mills	Mills	Mills	Mills	Mills	Mills	Mills	Mills	Mills	Mills	Mills	Mills	Mills	Mills	Mills
C 1	27,091	18,854	1166	52,175	3.81	27.08	14.18	47.70	7.74	2.00	1.5	106.42	6.71	1.0	29.2	1.25	20.7	20.7	.73	.73	9.6	9.6	
			77,506.4																				
					N. H.	5.34																	
						9.15																	

Assessed Value	Rural	All Other	Personal Property	Total
Homestead	10,899			10,899
Non-Homestead	35,046		6230	41,276
Total	45,945		6230	52,175

RATES AND TAXES

COUNTY OF CASS, STATE OF MINNESOTA

SCHOOL TAXES		LOCAL 1 MILL AND SPECIAL SCHOOL TAXES BY DISTRICTS										ALL OTHER TAXES		
Total Rate of Sch'l Tax	Total Rate of all Taxes	Local 1 Mill	Special	State Loan	Def. Fund	Town C.O.	Total School Taxes	KUNDS	Rate	Amounts				
57.03	196.46	2826	706.42				1611.50	State - Non-Homestead		221.02				
82.03	221.46	2392	1195.90				1961.99	State - Homestead		198.79				
		5218	1902.32				2573.49	County Revenue,		1413.00				
								County Road and Bridge,		739.94				
								County Welfare,		2488.85				
								Bonds and Interest		403.90				
								R. & B. Bldg.		104.35				
								Case Co. Reg. Assn.		26.09				
								Welfare Ref.		376.74				
								Town Revenue,		349.57				
								Town Road and Bridge,		600.01				
								Town Drag,		52.18				
								Town State Loan,		52.175				
								Here		1523.51				
								School Local 1 Mill,		52.18				
								School Special,		1902.32				
								School State Loan,						
								Deficiency		1080.02				
								Tuition						
								Transportation		380.9				
								Capital Outlay		500.88				
										3573.49				

221.46
57.03
226.80

Total Number of Acres 7,118.36
 State of Minnesota, }
 COUNTY OF CASS, } ss.
 Auditor of said County and State aforesaid, do hereby certify that the foregoing is a true and correct Schedule, showing the valuation of all the taxable property, in the Town of Thunder Lake, in said County, the several rates of Taxation and Totals of the several Tax Funds levied thereon for the year A. D. 1956.
 Witness my hand and official seal, this 3rd day of January A. D. 1957.

L. C. Peterson
 County Auditor
By Helen Peterson, Deputy



1106964
 Total Taxes Real Estate 9685.76
 Pers. Prop. 1383.88
 Total 11069.64

Assessor's Return

COLLECTIONS OF TAXES OF 1956

Town

OF Thunder Lake

CASS COUNTY, MINNESOTA

FUNDS	MARCH SETTLEMENT	JUNE SETTLEMENT	NOV. SETTLEMENT	Amount Collected from Nov. 19, 1957, to First Monday in Jan. 1958	REDUCTIONS	Total Reductions and Collected	BALANCE UNCOLLECTED	ADDITIONS	Total Uncollected to First Monday in January, 1958
	1957	1957	1957						
State-Non-Homestead	3622	10345	4582	226					
State-Homestead	2824	11289	4438	338					
County Revenue	20070	73494	31543	2349					
County Road and Bridge	10509	38483	16517	2231					
County Welfare	55352	129455	55562	4137					
County Bond and Interest	5736	21006	9015	622					
R. + B. Bell	1482	5428	2380	173					
Well. Bell	5352	19595	8418	626					
Cash. Co. Legue.	371	1357	582	23					
Town Revenue	4966	18183	7804	552					
Town Road and Bridge	8523	31213	13395	997					
Town Drag	741	2715	1165	86					
Town State Loan									
Fire	741	27140	11649	867					
School Local Mill	741	2714	1164	88					
School Special	31761	93230	45309	3857					
School State Loan									
Deficiency	15342	56178	24110	1795					
Tuition									
Transportation	541	1982	852	63					
C.O.	715	26054	11184	832					
	162459	569853	249611	18954					

SCHOOL DISTRICT NO.	LOCAL 1 MILL	SPECIAL	STATE LOAN	Deficiency Transp.	C.O.	TOTALS
MARCH SETTLEMENT						
School District No. A C I	212	5295		4384	2033	12079
Na C I	529	26466		10954	586	43421
Totals	741	31761		15342	7115	55500
JUNE SETTLEMENT						
School District No. A C I	1699	82466		35762	1280	96877
Na C I	1015	50764		21016	742	83284
Totals	2714	93230		56778	1982	180159
NOVEMBER SETTLEMENT						
School District No. A C I	517	12931		10706	378	29498
Na C I	647	32579		13404	474	53121
Totals	1164	45309		24110	852	82619
NOVEMBER to JANUARY						
School District No. A C I	19	480		397	14	184
Na C I	69	3377		1398	49	648
Totals	88	3857		1795	63	832
ADDITIONS						
School District No.						6635
Totals						
REDUCTIONS						
School District No.						
Totals						

Real Estate
 Oak Park Beaches & Lam Beach
 Birchwood Terrace
 Del Ray Point

Assessment Roll and Tax List of Real Property in the town of Thunder Lake

Indicate Type of Property: R-Residential, C-Commercial, I-Industrial, U-Utility, F-Farm, L-Lakeshore, T-Timber, M-Mineral

Cass County, Minnesota, for Taxes for the Year 1956.

Table with columns: IN WHOSE NAME ASSESSED, TO WHOM TRANSFERRED, DESCRIPTION OF PROPERTY, TRUE AND FULL VALUATIONS, ASSESSED VALUATIONS, VALUATIONS BY SCHOOL DISTRICTS AS EQUALIZED BY DEPARTMENT OF TAXATION, SOLD FOR TAXES, PAID, WHEN PAID, etc.

100' x 500' of Lot 2 + 1/4 ac. of Lot 3

Sec-6-140-26

625'	625'	625'	625'	625'	625'	625'	625'
A	B	C	D	E	F	G	H
Howard Bluhm	Arthur R. Bluhm	Earl M. Bluhm	Earl M. Bluhm	Eleanor Bluhm	Emma Morse	Ruben Mey	Thora J. Whaler
.14 ac.	.14 ac.	.14 ac.	.14 ac.	.14 ac.	.14 ac.	.14 ac.	.14 ac.

100'
S.W. cor. of
Grant Lot 2

Grant Lot 2
Grant Lot 3

Indigo Lake

Unit Lot 4
 Sec. 9-140-26

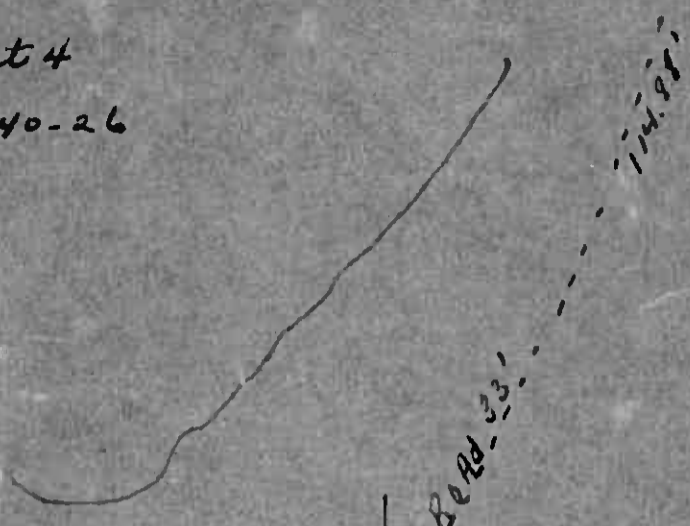

Graded Exp. Road

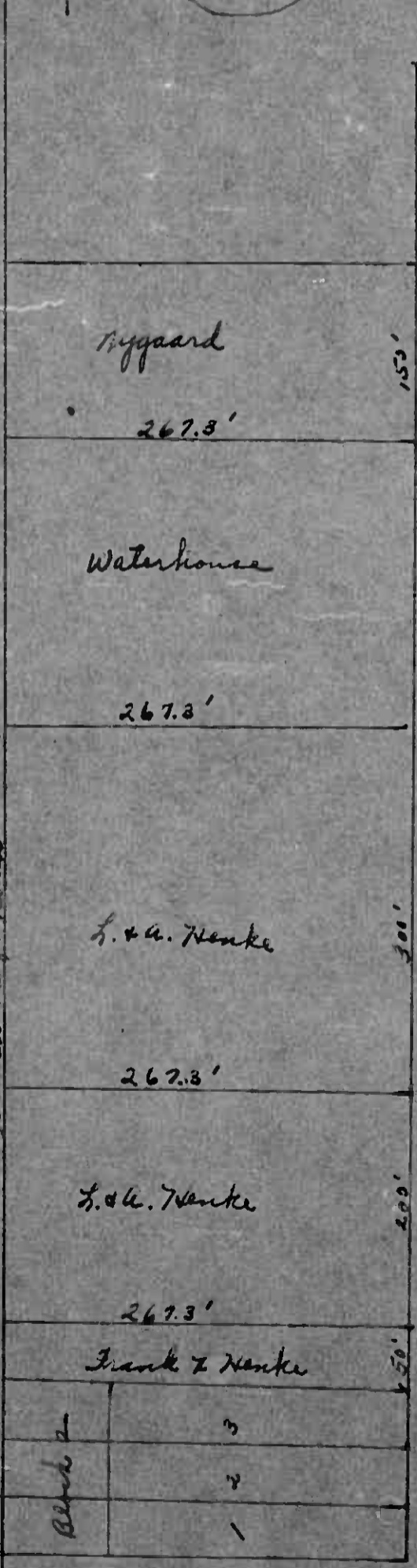

Thunder Cove.

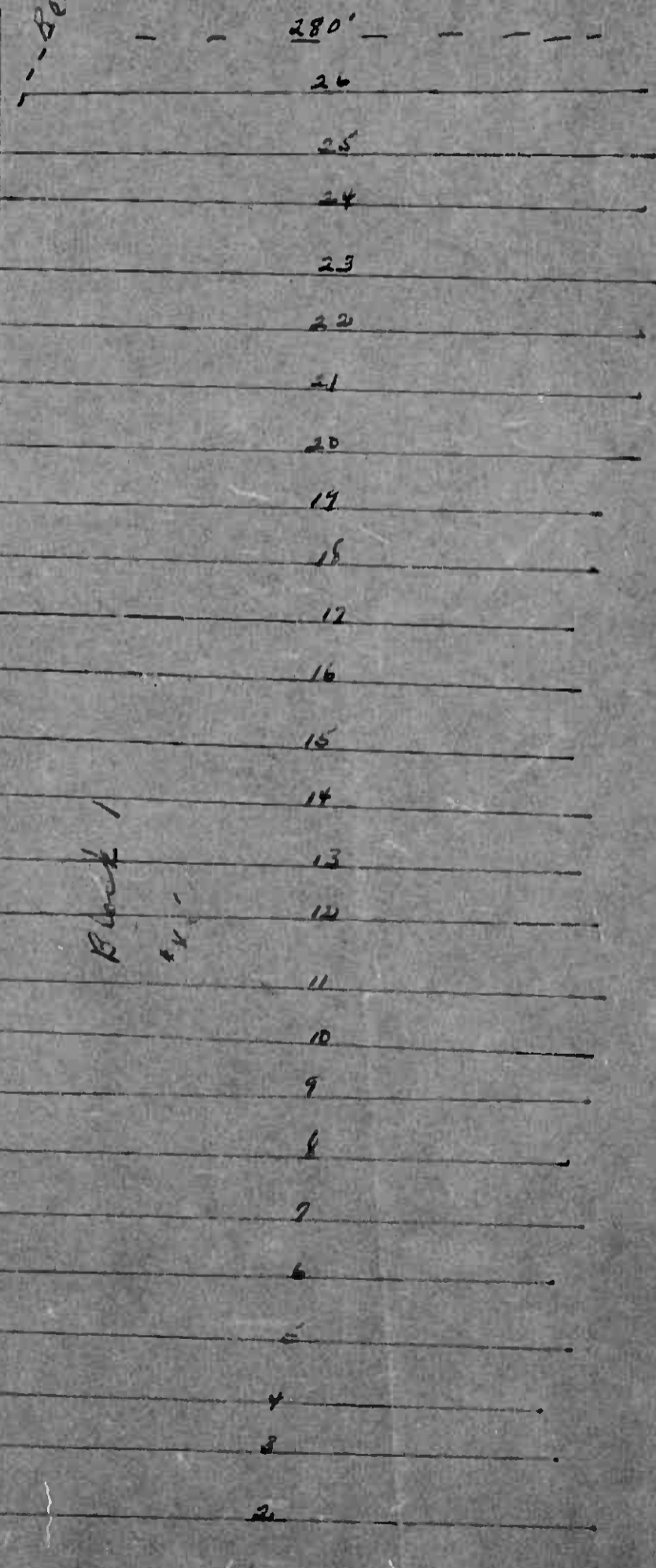

Block 1

44'

Assessment Roll and Tax List of Real Property in the Town of Thunder Lake

Cass County, Minnesota, for Taxes for the Year 1956.

Indicate Type of Property: R-Residential, G-Commercial, I-Industrial, U-Utility, F-Farm, L-Lakeshore, T-Timber, M-Mineral

Main table with columns: IN WHOSE NAME ASSESSED, TO WHOM TRANSFERRED, DESCRIPTION OF PROPERTY, TRUED AND FULL VALUATIONS (LAND, BUILDINGS, MACHINERY, TOTAL), ASSESSED VALUATIONS (RURAL, ALL OTHER, TOTAL), and FINAL EQUALIZED VALUE.

Tax and payment table with columns: SOLD FOR TAXES, VALUATIONS BY SCHOOL DISTRICTS AS EQUALIZED BY DEPARTMENT OF TAXATION, Tax including State Homestead, State Tax on Non-Homestead, SPECIAL TAXES, TOTAL TAXES, PAID, WHEN PAID, Number of Receipt, March Settlement 1957, June Settlement 1957, Penalty, November Settlement 1957, Penalty, Collections to First Monday in January 1958, Delinquent on First Monday in January 1958, Total Delinquent Tax and Penalty, REMARKS.

Handwritten names and details of property owners including Evelyn H. Lundstrom, George R. & Laurence M. D. Steiner, C.P. Gerber, etc.

Handwritten descriptions of property, including subdivisions, acreage, and other specific details for each lot.

Handwritten tax amounts, payment dates, and settlement details for each property entry.

Vertical text on the far right edge of the page, including 'Oak Park Beaches & Lawn Beach' and 'Briarwood Terrace'.

14.58 ac. - 7000
plant of P. F. 6

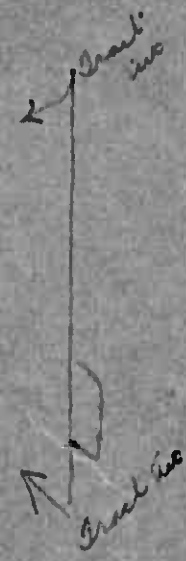

Sec. 9-140-26
Cont. not 3

Cont. not 3

10320

True north

1/2 in. Plot founded in place

Section

Assessment Roll and Tax List of Real Property in the Town of Thunder Lake

Cass County, Minnesota, for Taxes for the Year 1956.

Main table with columns: IN WHOSE NAME ASSESSED, TO WHOM TRANSFERRED, DESCRIPTION OF PROPERTY, TRUE AND FULL VALUATIONS, ASSESSED VALUATIONS, VALUATIONS BY SCHOOL DISTRICTS AS EQUALIZED BY DEPARTMENT OF TAXATION, SOLD FOR TAXES, PAID, WHEN PAID, Number of Receipt, March Settlement 1957, June Settlement 1957, November Settlement 1957, Collections to First Monday in January 1958, Delinquent on First Monday in January 1958, Total Delinquent Tax and Penalty, REMARKS.

Raymond M. & Elizabeth C. Hammond: That part of Lot 3 Sec. 10-140-26 Des. as follows: starting at a pt. on the E. Shore of Big Thunder Lake where Hy# 6 leaves said Lake, going in NW'ly. direction, thence along the lake shore in a NW'ly. direction, a distance of 100', thence N. parallel with the W. line of said lot 3, to said Hy# 6, thence SE'ly along said Hy. # 6 to beginning.

Emmett & Mary Knise: NE 1/4 of SE 1/4: That part of lot 3 Sec. 10-140-26 described as follows: Beg. on the lake shore of Big Thunder Lake 100' NW of the pt. where Rt. Wy. of new Hy# 6 leaves the lake as pt. of begin. thence NW'ly. along shore of said Big Thunder Lake to the W. line of said lot 3, Approx. 170'; thence N. along the W. line of said lot 3 to Rt. Wy. of Hy #6 thence S. and SE'ly along W. side of said Hy #6 to the NW. Cor. of Theodore Hanson tract; thence S'ly along W. side of Theo. Hanson tract to pt. of beginning.

Vertical text on the right edge: Oak Park Beaches & Lawn Beach, Birchwood Terrace, F. Del Ray Point

Assessment Roll and Tax List of Real Property in the Town of Thunder Lake

Cass County, Minnesota, for Taxes for the Year 1956.

Table with columns for IN WHOSE NAME ASSESSED, TO WHOM TRANSFERRED, DESCRIPTION OF PROPERTY, TRUE AND FULL VALUATIONS (RURAL, ALL OTHER), VALUATIONS BY SCHOOL DISTRICTS, SOLD FOR TAXES, SPECIAL TAXES, TOTAL TAXES, PAID, WHEN PAID, and REMARKS. Includes handwritten entries for Edward Tourant, Arthur & Dolores Corlan, and various tax payment dates and amounts.

Assessment Roll and Tax List of Real Property in the Town of ... of ...

Cass County, Minnesota, for Taxes for the Year 1956.

Form 502 (56) MINN-DAY'S COMPANY, MINNEAPOLIS

Indicate Type of Property: R-Residential, C-Commercial, I-Industrial, U-Utility, F-Farm, L-Lakeshore, T-Timber, M-Mineral

Table with columns: IN WHOSE NAME ASSESSED, TO WHOM TRANSFERRED, DESCRIPTION OF PROPERTY, TRUE AND FULL VALUATIONS, ASSESSED VALUATIONS, VALUATIONS BY SCHOOL DISTRICTS AS EQUALIZED BY DEPARTMENT OF TAXATION, PAID, WHEN PAID, etc.

Ad 7 Oak Park Beaches & Lawn Beach Birchwood Terrace P. Del Ray Point

Assessment Roll and Tax List of Real Property in the Town of Thunder Lake

Cass County, Minnesota, for Taxes for the Year 1956.

Table with columns: IN WHOSE NAME ASSESSED, TO WHOM TRANSFERRED, DESCRIPTION OF PROPERTY, TRUE AND FULL VALUATIONS, ASSESSED VALUATIONS, VALUATIONS BY SCHOOL DISTRICTS AS EQUALIZED BY DEPARTMENT OF TALLATION, SOLD FOR TAXES, PAID, WHEN PAID, Number of Receipt, March Settlement 1957, June Settlement 1957, Penalty, November Settlement 1957, Collections to First Monday in January 1958, Delinquent on First Monday in January 1958, Total Delinquent Tax and Penalty, REMARKS.

James J. Mc Bride
Gordon W. Gieske
Clarence & Gladys Hopper
Arnold C. Stanson
Charles W. Miles
Clyde C. Mohr
Henry S. & Julia Hanson
H.W. Cady, Jr.
John W. Poore & Emma Brundage
Cara Lillian Jensen Erickson
Charles M. Miles
Ethel & Milan R. Biggerstaff
John R. McKay
E. C. Miles
Frederick M. & Florence M. Erickson

minn. B. Knudsen
4948 Refill Ave. S.W. 1956

000 Duc
Oak Park Beaches & Lam Beach
Birchwood Terrace
F. J. Ray Point

Assessment Roll and Tax List of Real Property in the Town of Thunder Lake

Indicate Type of Property: R-Residential, C-Commercial, I-Industrial, U-Utility, F-Farm, L-Lakeshore, T-Timber, M-Mineral

Table with columns: IN WHOSE NAME ASSESSED, TO WHOM TRANSFERRED, DESCRIPTION OF PROPERTY, TRUE AND FULL VALUATIONS (LAND, BUILDINGS, MACHINERY, TOTAL), ASSESSED VALUATIONS (RURAL, ALL OTHER), and FINAL EQUALIZED VALUE.

Cass County, Minnesota, for Taxes for the Year 1956.

Table with columns: SOLD FOR TAXES, VALUATIONS BY SCHOOL DISTRICTS AS EQUALIZED BY DEPARTMENT OF TAXATION, Tax including State Homestead, State Tax on Non-Homestead, SPECIAL TAXES, TOTAL TAXES, PAID, WHEN PAID, Number of Receipt, March Settlement 1957, June Settlement 1957, November Settlement 1957, Collections to First Monday in January 1958, Delinquent on First Monday in January 1958, Total Delinquent Tax and Penalty, REMARKS.

Assessment Roll and Tax List of Real Property in the Town of Shander Lake, Cass County, Minnesota, for Taxes for the Year 1956.

Cass County, Minnesota, for Taxes for the Year 1956.

Table with multiple columns: IN WHOSE NAME ASSESSED, TO WHOM TRANSFERRED, DESCRIPTION OF PROPERTY, TRUE AND FULL VALUATIONS, ASSESSED VALUATIONS, VALUATIONS BY SCHOOL DISTRICTS AS EQUALIZED BY DEPARTMENT OF TAILATION, TAXES, PAID, WHEN PAID, and REMARKS. Includes handwritten entries for Henry Johnson, U.S. of America, Chas. R. Cavanaugh, and State of Minnesota.

Geo. Decker

Edna Terrace

Oak Park Beaches & Lawn Beach

Hirchwood Terrace

F. J. Ray Print

Assessment Roll and Tax List of Real Property in the Town of Thunder Lake, Cass County, Minnesota, for Taxes for the Year 1956.

Table with columns: IN WHOSE NAME ASSESSED, TO WHOM TRANSFERRED, DESCRIPTION OF PROPERTY, TRUE AND FULL VALUATIONS, ASSESSED VALUATIONS, VALUATIONS BY SCHOOL DISTRICTS AS EQUALIZED BY DEPARTMENT OF TAXATION, SOLD FOR TAXES, PAID, WHEN PAID, Number of Receipt, March Settlement 1957, June Settlement 1957, November Settlement 1957, Collections to First Monday in January 1958, Delinquent on First Monday in January 1958, Total Delinquent Tax and Penalty, REMARKS.

Assessment Roll and Tax List of Real Property in the Town of Thunder Lake

*Indicate Type of Property: R-Residential, C-Commercial, I-Industrial, U-Utility, F-Farm, L-Lakeshore, T-Timber, M-Mineral

Cass County, Minnesota, for Taxes for the Year 1956.

Table with columns: IN WHOSE NAME ASSESSED, TO WHOM TRANSFERRED, DESCRIPTION OF PROPERTY, TRUE AND FULL VALUATIONS, ASSESSED VALUATIONS, VALUATIONS BY SCHOOL DISTRICTS AS EQUALIZED BY DEPARTMENT OF TAXATION, TAXES, PAID, WHEN PAID, Number of Receipt, March Settlement 1957, June Settlement 1957, November Settlement 1957, Collections to First Monday in January 1958, Delinquent on First Monday in January 1958, Total Delinquent Tax and Penalty, REMARKS.

1st 1/2 mile Oak Park Beaches to Farm Beach Birchwood Terrace F. 1st Ray Point

* Indicate Type of Property: R-Residential, C-Commercial, I-Industrial, U-Utility, F-Farm, L-Lakeshore, T-Timber, M-Mineral

IN WHOSE NAME ASSESSED	TO WHOM TRANSFERRED	DESCRIPTION OF PROPERTY				No. School District	Indicate Homestead or No	Indicate Agricultural or No	Indicate Type of Property	TRUE AND FULL VALUATIONS				ASSESSED VALUATIONS						FINAL EQUALIZED VALUE	SOLD FOR TAXES	VALUATIONS BY SCHOOL DISTRICTS AS EQUALIZED BY DEPARTMENT OF TAXATION						Tax including State Homestead	State Tax on Non-Homestead	SPECIAL TAXES	TOTAL TAXES	PAID	WHEN PAID	Number of Receipt	March Settlement 1957	June Settlement 1957	Penalty	November Settlement 1957	Penalty	Collections to First Monday in January 1958	Penalty	Delinquent on First Monday in January 1958	Total Delinquent Tax and Penalty	REMARKS		
		SUBDIVISION	Sec or Lot	Town or Block	Range					Number of Acres of Land	LAND Exclusive of Structures and Improvements	BUILDINGS and Other Structures	MACHINERY Permanently Attached to Real Estate	TOTAL True and Full Value	RURAL		ALL OTHER		MACHINERY Permanently Attached to Real Estate			TOTAL ASSESSED VALUE	Total Assessed Value as Equalized by the Board of Review	District No.	District No.	District No.	District No.																		District No.	District No.
															Homestead Up to \$1,000 20%	Over \$4,000 and Non-Homestead 33 1/3%	Timber Land Class 2e 20%	Homestead Up to \$1,000 25%																												
State of Minnesota		N E 1/4 of N E 1/4	23	140	26			21																																						
State of Minnesota		N W 1/4 of N E 1/4																																												
<i>Jena Mining Co.</i>		S W 1/4 of N E 1/4		40				70	321			107			321				107			2102	58		2160															2nd Half Paid OCT 31 1957						
"		S E 1/4 of N E 1/4		40				"	330			110			330				110			2162	58		2220															1st Half Paid MAY 31 1957						
State of Minnesota		N E 1/4 of N W 1/4																																												
State of Minnesota		N W 1/4 of N W 1/4 <i>See Map</i>																																												
State of Minnesota		S W 1/4 of N W 1/4																																												
State of Minnesota		S E 1/4 of N W 1/4																																												
State of Minnesota		N E 1/4 of S W 1/4																																												
State of Minnesota		N W 1/4 of S W 1/4 <i>See Map</i>																																												
State of Minnesota		S W 1/4 of S W 1/4																																												
State of Minnesota		S E 1/4 of S W 1/4																																												
<i>Jena Mining Co.</i>		N E 1/4 of S E 1/4		40				70	321			107			321				107			2102	58		2160																	2nd Half Paid OCT 31 1957				
State of Minnesota		N W 1/4 of S E 1/4																																									1st Half Paid MAY 31 1957			
State of Minnesota		S W 1/4 of S E 1/4																																												
State of Minnesota		S E 1/4 of S E 1/4																																												
								120							972					972			6366	174		6540																		3270		
																																											3270			

Map Terra Oak Park Beaches & Lawn Beach Birchwood Terrace F. J. Ray Point

Assessment Roll and Tax List of Real Property in the Town of Lawrence of Henderson Lake

* Indicate Type of Property: R-Residential, C-Commercial, I-Industrial, U-Utility, F-Farm, L-Lakeshore, T-Timber, M-Mineral

IN WHOSE NAME ASSESSED	TO WHOM TRANSFERRED	DESCRIPTION OF PROPERTY					TRUE AND FULL VALUATIONS										FINAL EQUALIZED VALUE							
		SUBDIVISION	Sec. or Lot	Town or Block	Rang.	Number of Acres of Land Acres 100ths	No. Section District	Indicate Homestead Tax or No.	Indicate Agricultural Tax or No.	Indicate Type of Property	LAND EXCLUSIVE OF STRUCTURES AND IMPROVEMENTS		BUILDINGS AND OTHER STRUCTURES	MACHINERY Permanently Attached to Real Estate	TOTAL True and Full Value	ASSESSED VALUATIONS					TOTAL ASSESSED VALUE	Total Assessed Value as Equalized by the Board of Review		
											Dollars	Dollars	Dollars	Dollars	Dollars	Dollars		Dollars	Dollars	Dollars			Dollars	Dollars
State of Minnesota		NE 1/4 of NE 1/4		24																				
State of Minnesota		NW 1/4 of NE 1/4																						
State of Minnesota		SW 1/4 of NE 1/4																						
State of Minnesota		SE 1/4 of NE 1/4																						
State of Minnesota																								
State of Minnesota		NE 1/4 of NW 1/4																						
State of Minnesota		NW 1/4 of NW 1/4																						
State of Minnesota		SW 1/4 of NW 1/4																						
State of Minnesota		SE 1/4 of NW 1/4																						
Jena Mining Co		NE 1/4 of SW 1/4			40			No 40	T		321			321	107					107				
"		NW 1/4 of SW 1/4			40			"	"		270			270	90					90				
"		SW 1/4 of SW 1/4			40			"	"		321			321	107					107				
"		SE 1/4 of SW 1/4			40			"	"		270			270	90					90				
State of Minnesota		NE 1/4 of SE 1/4																						
State of Minnesota		NW 1/4 of SE 1/4																						
State of Minnesota		SW 1/4 of SE 1/4																						
State of Minnesota		SE 1/4 of SE 1/4																						
					160					1182			1182	394						394				

Cass County, Minnesota, for Taxes for the Year 1956.

SOLD FOR TAXES	VALUATIONS BY SCHOOL DISTRICTS AS EQUALIZED BY DEPARTMENT OF TAXATION						Tax Including State Homestead	State Tax on Non-Homestead	SPECIAL TAXES	TOTAL TAXES	PAID	WHEN PAID	Number of Receipt	March Settlement 1957	June Settlement 1957	November Settlement 1957	Penalty	Collections to First Monday in January 1958	Penalty	Delinquent on First Monday in January 1958	Total Delinquent Tax and Penalty	REMARKS	
	District No. Rate	District No. Rate	District No. Rate	District No. Rate	District No. Rate	District No. Rate																	
1																							
2																							
3																							
4																							
5																							
6																							
7																							
8																							
9																							
10																							
11									107		2160	58	2160	11	1st Half Paid	OCT 31 1957							
12									90		1768	48	1816	12	1st Half Paid	OCT 31 1957							
13									107		2102	58	2160	13	1st Half Paid	OCT 31 1957	12846			3976	3976		
14									90		1768	48	1816	14	2nd Half Paid	OCT 31 1957	17029						
15																							
16																							
17																							
18																							
19																							
20									394		7740	2182	7952								3976	3976	

Edin, Terry Oak Park, Beaches, Kirk, Lam, Beach, Birchwood, Park ace, F. Del Ray Point

Assessment Roll and Tax List of Real Property in the Town of Thunder Lake

Cass County, Minnesota, for Taxes for the Year 1956.

Indicate Type of Property: R-Residential, C-Commercial, I-Industrial, U-Utility, F-Farm, L-Lakeshore, T-Timber, M-Mineral

Table with columns: IN WHOSE NAME ASSESSED, TO WHOM TRANSFERRED, DESCRIPTION OF PROPERTY, TRUE AND FULL VALUATIONS, ASSESSED VALUATIONS, VALUATIONS BY SCHOOL DISTRICTS AS EQUALIZED BY DEPARTMENT OF TAXATION, TAXES, PAID, WHEN PAID, Number of Receipt, March Settlement 1957, June Settlement 1957, Penalty, November Settlement 1957, Penalty, Collections to First Monday in January 1958, Penalty, Delinquent on First Monday in January 1958, Total Delinquent Tax and Penalty, REMARKS.

Melvin J. & Velma E. Smith
State of Minnesota
State of Minnesota
State of Minnesota
State of Minnesota
State of Minnesota
State of Minnesota
State of Minnesota
State of Minnesota
State of Minnesota
State of Minnesota
State of Minnesota
State of Minnesota
State of Minnesota
State of Minnesota
State of Minnesota
State of Minnesota
State of Minnesota
State of Minnesota

1 NE 1/4 of NE 1/4 26 140 26 40 C 1 1/2 1/2 F 275 330 605 121 121
2 NW 1/4 of NE 1/4 40 390 390 78 78
3 SW 1/4 of NE 1/4
4 SE 1/4 of NE 1/4
5
6 NE 1/4 of NW 1/4
7 NW 1/4 of NW 1/4 less 1/2 ac.
8 SW 1/4 of NW 1/4
9 SE 1/4 of NW 1/4
10
11 NE 1/4 of SW 1/4
12 NW 1/4 of SW 1/4 less 1/2 ac. 20 4 1/2 1/2 T 100 100 20 20 20
13 SW 1/4 of SW 1/4 40 300 300 60 60
14 SE 1/4 of SW 1/4
15 1/2 of NW 1/4 of SW 1/4 less 1/2 ac. 20 200 410 122 122
16 NE 1/4 of SE 1/4
17 NW 1/4 of SE 1/4
18 SW 1/4 of SE 1/4
19 SE 1/4 of SE 1/4
20 120 1265 740 2005 401 401

1 SOLD FOR TAXES 121 2378 2378 1
2 SOLD FOR TAXES 78 1532 1532 2
3
4
5
6
7
8
9
10
11
12 20 392 392 12 PAID IN FULL JAN 3 1958 392 31
13 60 1178 1178 13 PAID IN FULL JAN 3 1958 1178 94
14
15 122 2396 2396 15 PAID IN FULL MAY 31 1956 2396
16
17
18
19
20 401 7876 7876 2396 1570 3910

Vertical text on the right margin: Coolidge, Duck, Terrace, Oak Park Beaches, Lam Beach, Birchwood Terrace, F. J. Jay Point

Sec. 27. 140-26

Lat 5

NE 1/4 of SE 1/4

3.00 acs. E. Lester Thrall

4.00 acs. F. C. White

5.5 acs.

Willis + Alta H. Copeman

14.00 acs.

Assessment Roll and Tax List of Real Property in the Town of Thunder Lake

Cass County, Minnesota, for Taxes for the Year 1956.

* Indicate Type of Property: R-Residential, C-Commercial, I-Industrial, U-Utility, F-Farm, L-Lakeshore, T-Timber, M-Mineral

Table with columns: IN WHOSE NAME ASSESSED, TO WHOM TRANSFERRED, DESCRIPTION OF PROPERTY, TRUE AND FULL VALUATIONS, ASSESSED VALUATIONS, VALUATIONS BY SCHOOL DISTRICTS AS EQUALIZED BY DEPARTMENT OF TAXATION, TAXES, PAID, WHEN PAID, Number of Receipt, March Settlement 1957, June Settlement 1957, November Settlement 1957, Collections to First Monday in January 1958, Delinquent on First Monday in January 1958, Total Delinquent Tax and Penalty, REMARKS.

Edna Terrill Oak Park Beaches Lakewood Birchwood Terrace F. Del Ray Point

Assessment Roll and Tax List of Real Property in the Town of Thunder Lake

Cass County, Minnesota, for Taxes for the Year 1956.

Indicate Type of Property: R-Residential, C-Commercial, I-Industrial, U-Utility, F-Farm, L-Lakeshore, T-Timber, M-Mineral

Main data table with columns: IN WHOSE NAME ASSESSED, TO WHOM TRANSFERRED, DESCRIPTION OF PROPERTY, TRUE AND FULL VALUATIONS, ASSESSED VALUATIONS, VALUATIONS BY SCHOOL DISTRICTS AS EQUALIZED BY DEPARTMENT OF TAXATION, SOLD FOR TAXES, SPECIAL TAXES, TOTAL TAXES, PAID, WHEN PAID, Number of Receipt, March Settlement 1957, June Settlement 1957, November Settlement 1957, Collections to First Monday in January 1958, Delinquent on First Monday in January 1958, Total Delinquent Tax and Penalty, REMARKS.

Daisy S. Coffey

Clifford C. & Jean Smith

Orville A. & Gladys A. Glary

John R. & James A. Rolfe

State of Minnesota

State of Minnesota

Daisy S. Coffey

State of Minnesota

State of Minnesota

State of Minnesota

State of Minnesota

Franklin M. Bedricks

Emmett Todd

Gordon Haalleins

Eli C. & Ruth P. Steffy

Vertical text on the right edge: Oak Park Beaches, Lamm Beach, Birchwood Terrace, F. Jay Point

Assessment Roll and Tax List of Real Property in the Town of Thunder Lake

Cass County, Minnesota, for Taxes for the Year 1956.

Indicate Type of Property: R-Residential, C-Commercial, I-Industrial, U-Utility, F-Farm, L-Lakeshore, T-Timber, M-Mineral

Oak Park Terrace

Oak Park Terrace

Main table with columns: IN WHOSE NAME ASSESSED, TO WHOM TRANSFERRED, DESCRIPTION OF PROPERTY, TRUE AND FULL VALUATIONS, ASSESSED VALUATIONS, VALUATIONS BY SCHOOL DISTRICTS AS EQUALIZED BY DEPARTMENT OF TAXATION, SOLD FOR TAXES, PAID, WHEN PAID, SPECIAL TAXES, TOTAL TAXES, etc.

1st Add'n to Birchwood Terrace, Oak Lawn Beach, Birchwood Terrace, F. del Ray Point

State of Minnesota

Abundant Park

1140

Handwritten summary totals: 167, 208, 375, 8308, 118, 8426, 7286

